

WPC Slat Panel

Note: This installation method is for reference only. You can complete this product installation according to your own experience and actual situation.

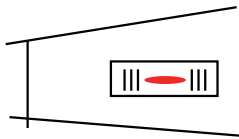

2 Please make sure the wall is flat before installation to ensure that the panels fits horizontally during installation.

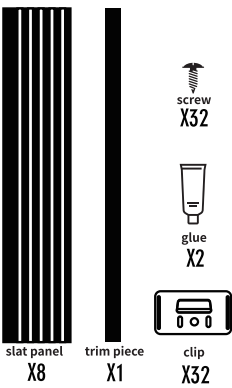
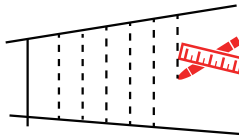

3 Measure the wall before installation and make a plan, work out the number of panels needed.

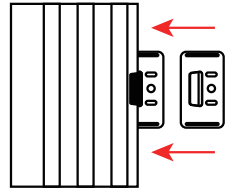
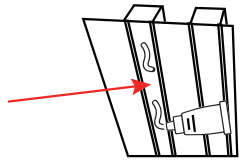

4 Install the first panel. Apply appropriate glue in 4 small sections at equal distances onto the panel's back of tongue side. Snap the 4 metal fastening clips into the slot

1 Upon receiving the package, open and check if you get the correct item and quantity. If you encounter any quality problems, please contact us.

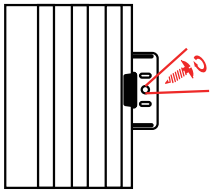

5 Position the wall panel as planned and secure the metal clip with screws. The starting wall panel installation is complete.

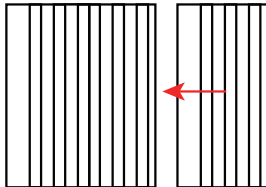

6 Install the subsequent panels. Insert 4 metal clips into the slot at equal distances. Insert the tongue of the 2nd panel into the slot of the started panel to lock and secure. Secure the metal clips attached to the 2nd panel with given screws. Repeat this process to install the rest slat panels

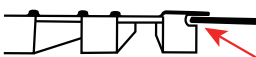
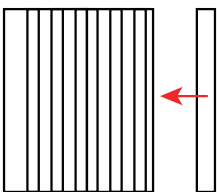
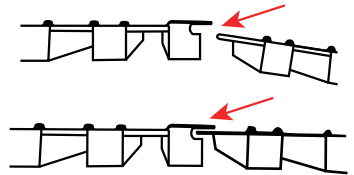

7 We provide trim piece to trim the slot of last panel. Apply appropriate glue along the back of trim piece and insert the thinner edge to the slot of last panel



8 If cut needed, use a circular saw, or table saw cut from the front side of the panel

About Us

Art3d's journey began with a simple yet powerful idea: to create stylish, innovative, and easy-to-DIY wall decor that would transform any space. They poured their hearts and souls into developing a range of products that would reflect their trendy-decor vision and push the boundaries of what was possible. They experimented with various materials, colors, and shapes, striving to create something truly unique and captivating.

However, the road to success was not without its challenges and setbacks. Despite moments of doubt and frustration, the team at Art3d remained committed to their mission of bringing creativity and beauty to people's homes through their innovative products. One of the biggest challenges they faced was figuring out how to combine the highest quality materials with reasonable costs to make their products affordable to the masses. They worked with different suppliers, tested various materials, and carefully selected qualified suppliers to be Art3d's long-term partners.

Another challenge was maintaining high-quality standards while scaling up production. The team adapted state-of-the-art equipment, recruited employees who shared their vision, and systematically trained them. They studied all the indices and set out production regulations rigorously.

Despite these challenges, Art3d's commitment to quality and innovation paid off. Their products gained popularity, and the brand established itself as a leader in the home decor industry. Today, Art3d is a successful brand known for its unique and creative products. Whether you're looking to update your home decor or add a touch of elegance to a new space, Art3d has a product that will meet your needs.

While the journey was not easy, Art3d is a testament to what can be achieved with hard work, dedication, and a passion for innovation.