

Installation Instruction

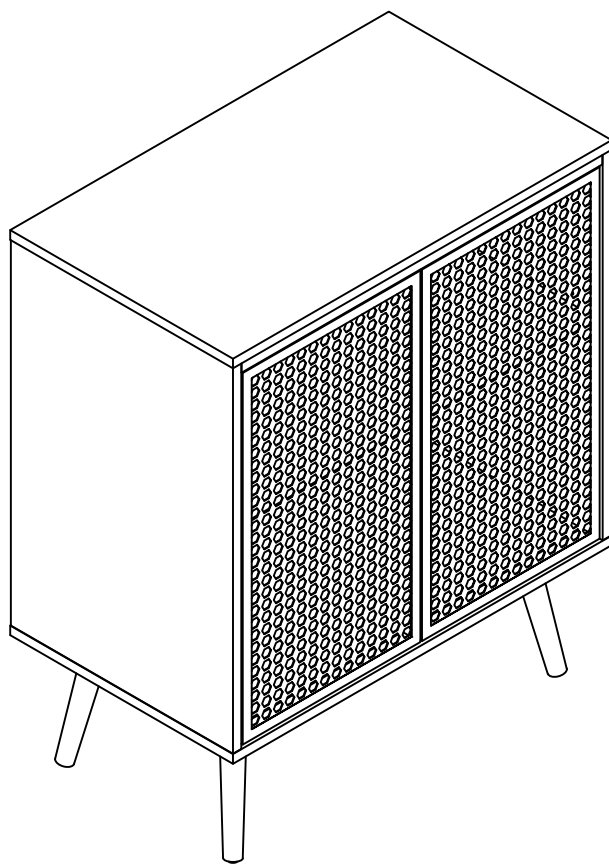

Assembling

Estimated time for assembly



45 : 00

What you need

- Use the packaging carton as a working surface to prevent product damage during assembly
- Phillips head screwdriver

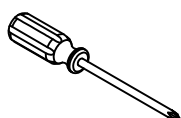

Weight Limitation



100

lbs table top

| 35

lbs per

What' included

Code Description	Qty
A Cam Bolt M6X35MM	8
B Cam Lock 15X12MM	8
C Wooden Dowel M8X30MM	8
D Screw M4X40MM	6
E Screw M3.5X14MM	22
F The metal plate	4
G Nylon Strap	2
H Screw M3.5X14MM	18
I The bolt	4
J The back button	12
K Anchor	2
L MATS	4
M Door Rebound Device	2
N Door Rebound Device Holder	2
O Screw M4X25MM	6
P Door Rebound Device	4

The Hardwares

Ⓐ

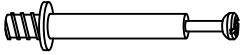

Ⓑ



Ⓒ

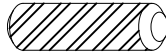

Ⓓ

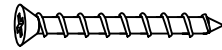

Ⓔ



Ⓕ

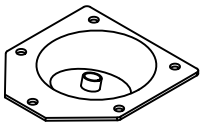

Ⓖ

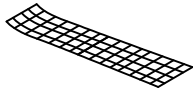

Ⓗ



Ⓘ



Ⓙ

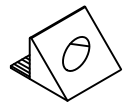

Ⓚ

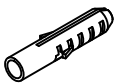

Ⓛ



Ⓜ

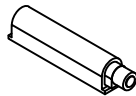

Ⓝ

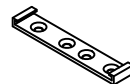

Ⓞ

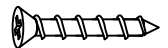

Ⓟ



IMPORTANT:

1. Do not tighten bolts / screws completely until all bolts / screws are lined up and inserted into holes.
2. Do not over tighten screws and bolts to avoid stripping
3. Please use hand tools to assemble this product. Do not use power tools.

Included Accessories

Code	Description	Qty
1	Cabinet Top	1
2	Bottom Panel	1
3	Left Side Panel	1
4	Right Side Panel	1
5	Back Panel	2
6	Shelf	1
7	Front Support Bar	1
8	Back reinforcement plate	2
9	Metal Door	2
10	Solid wood feet	4

The Accessoriess

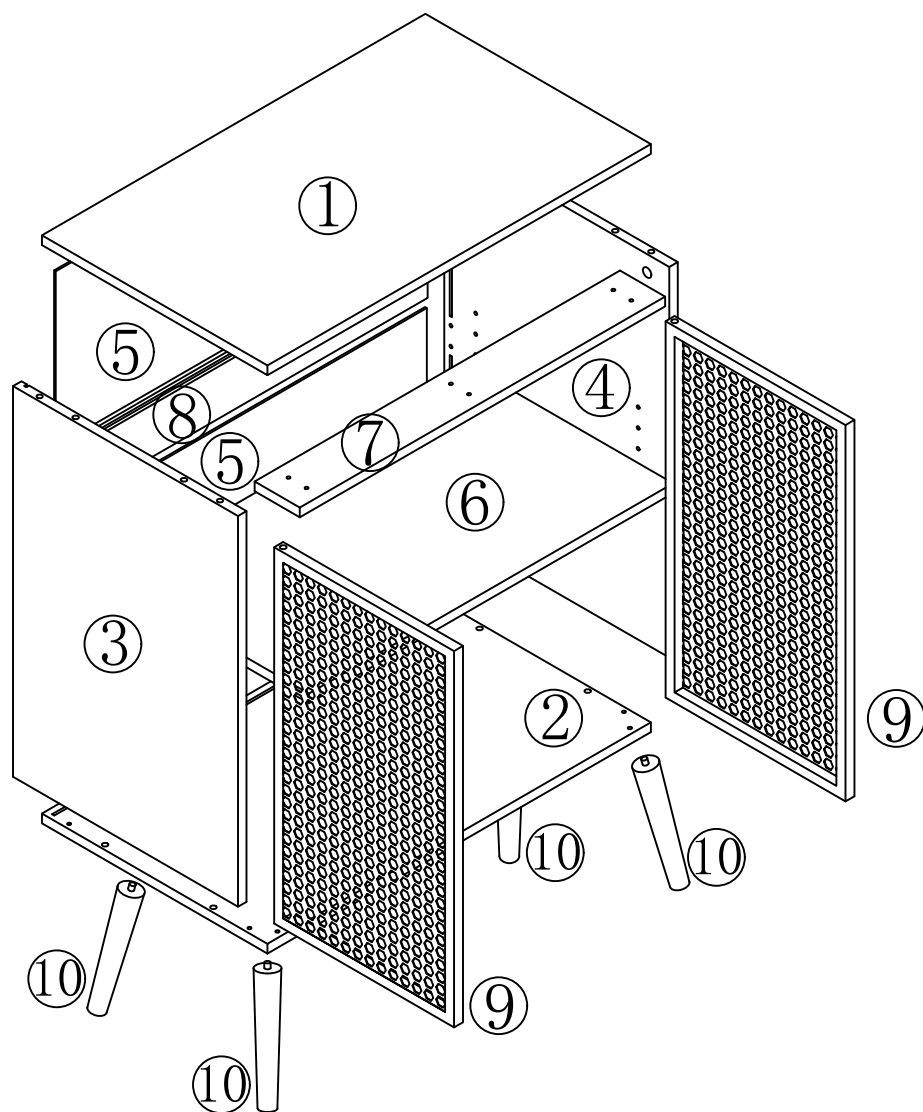

Step 1

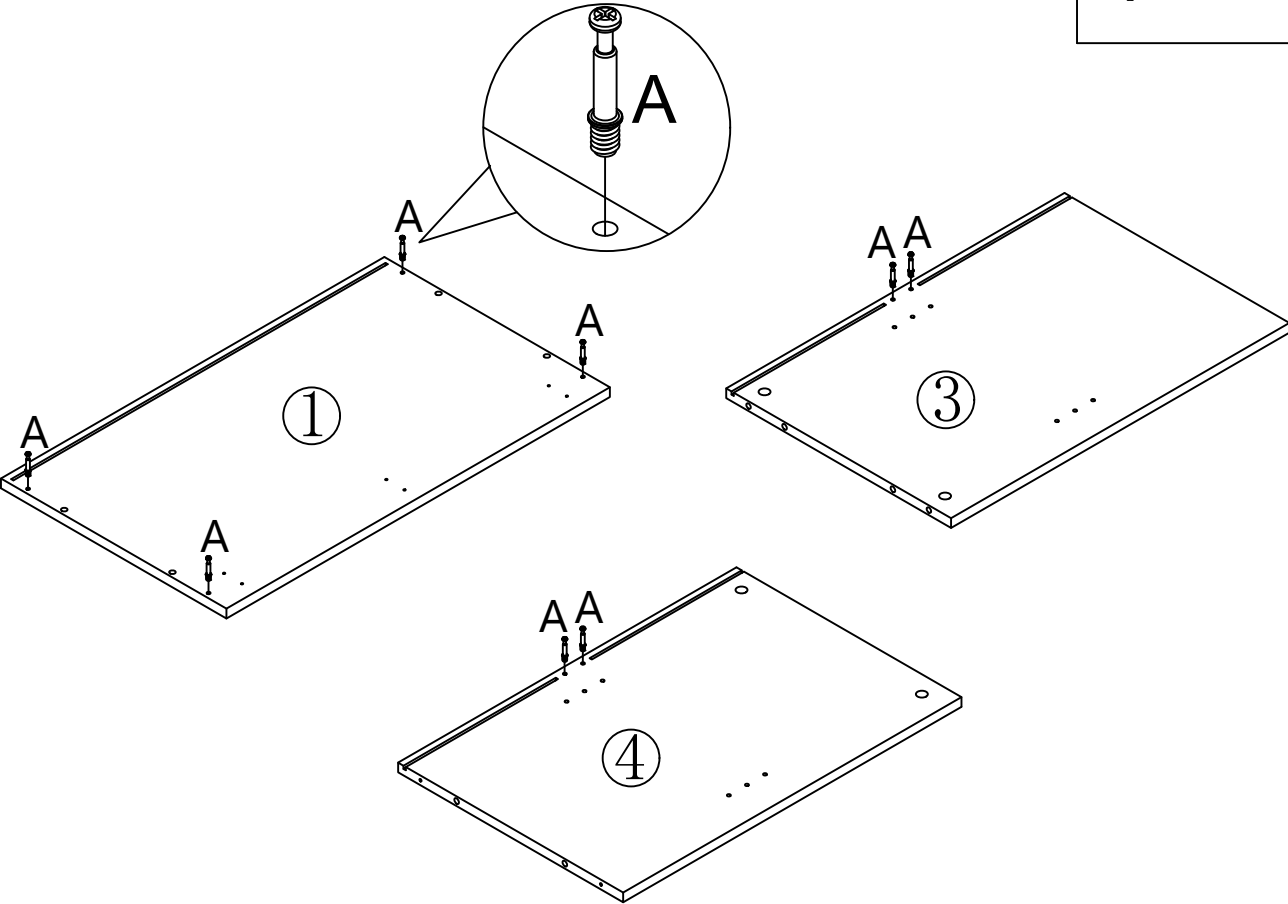
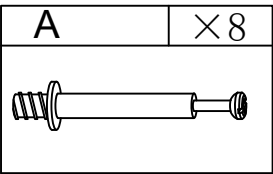

Step 2

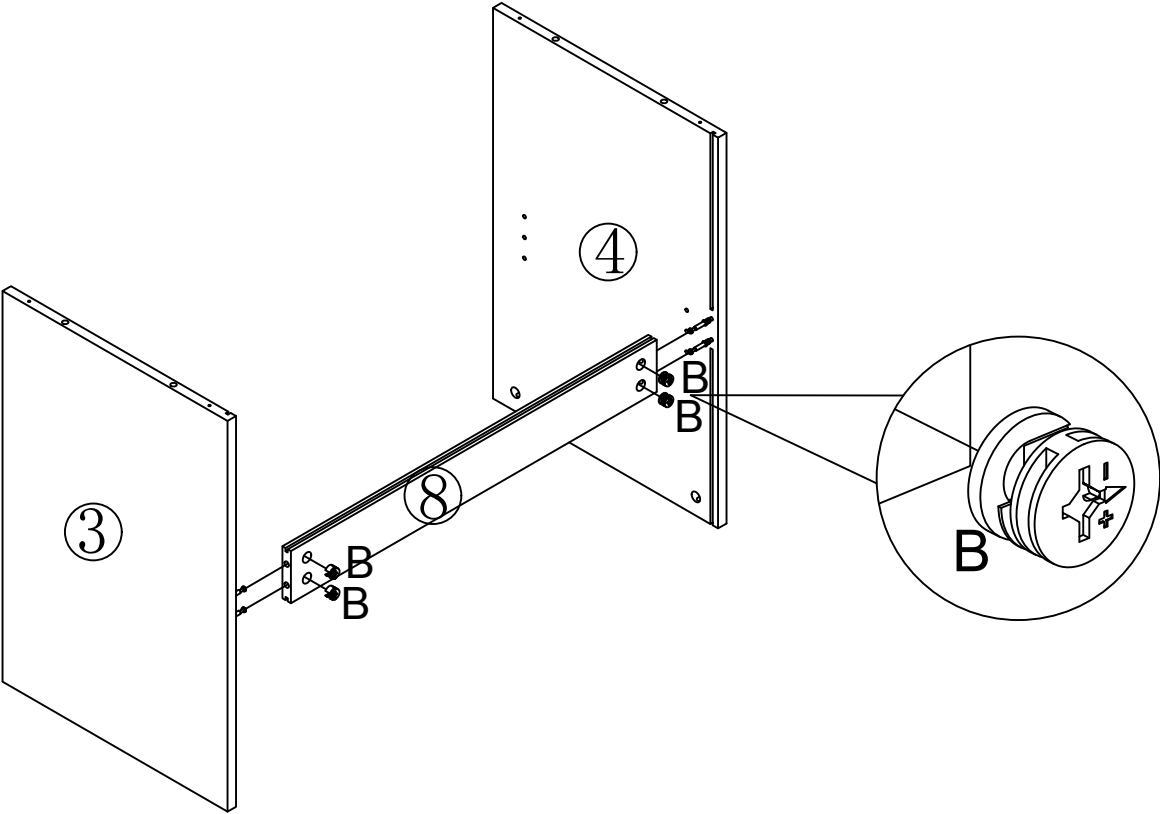
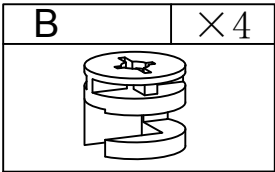

Step 3

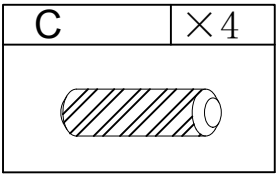
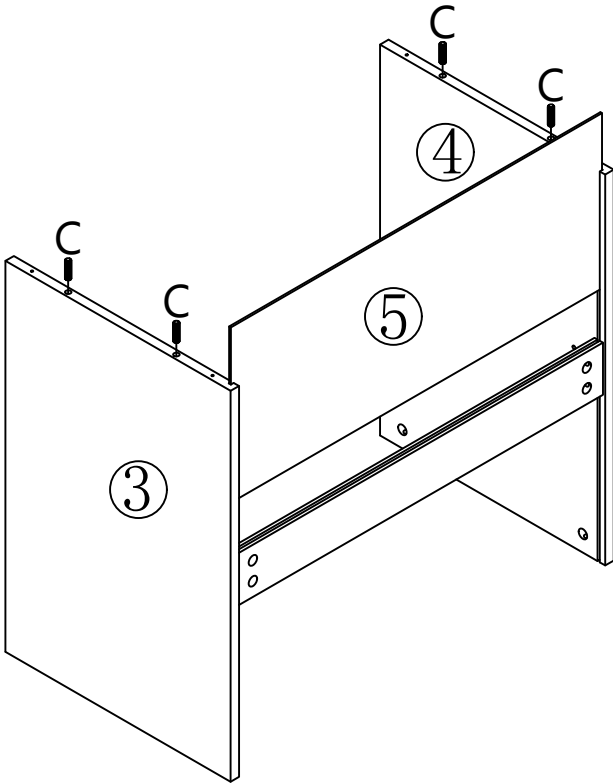

Step 4

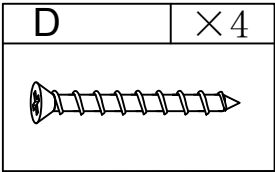
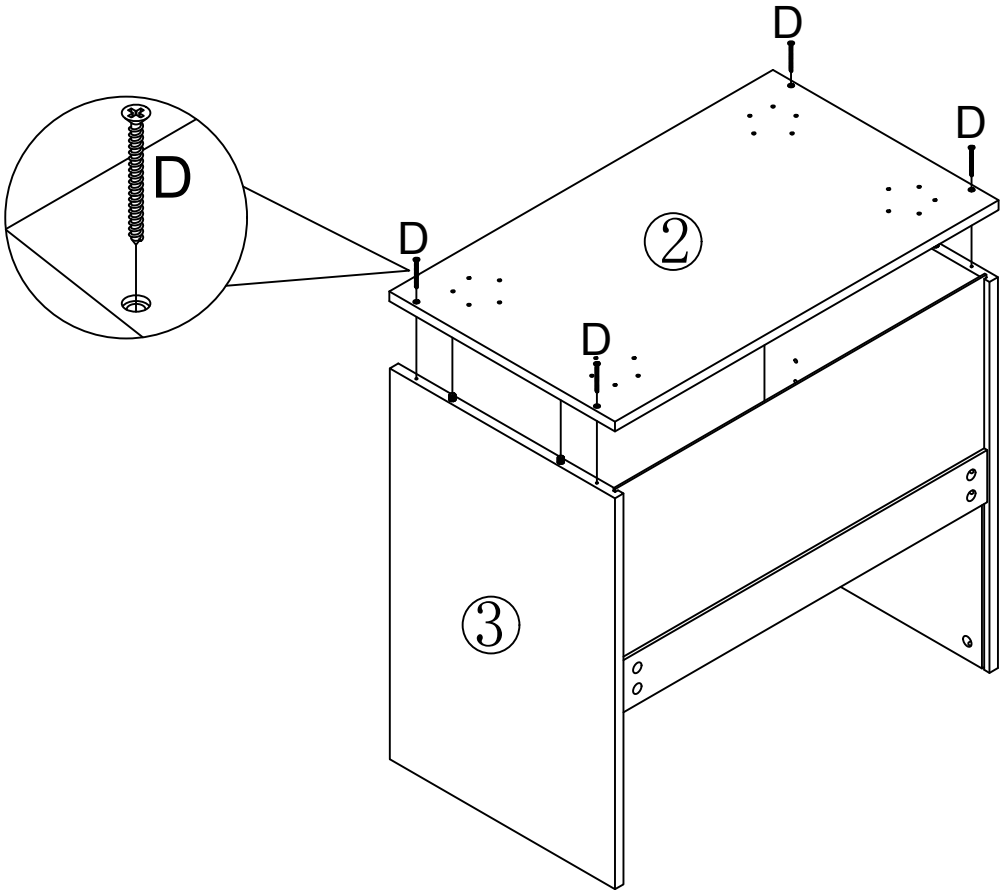

Step 5

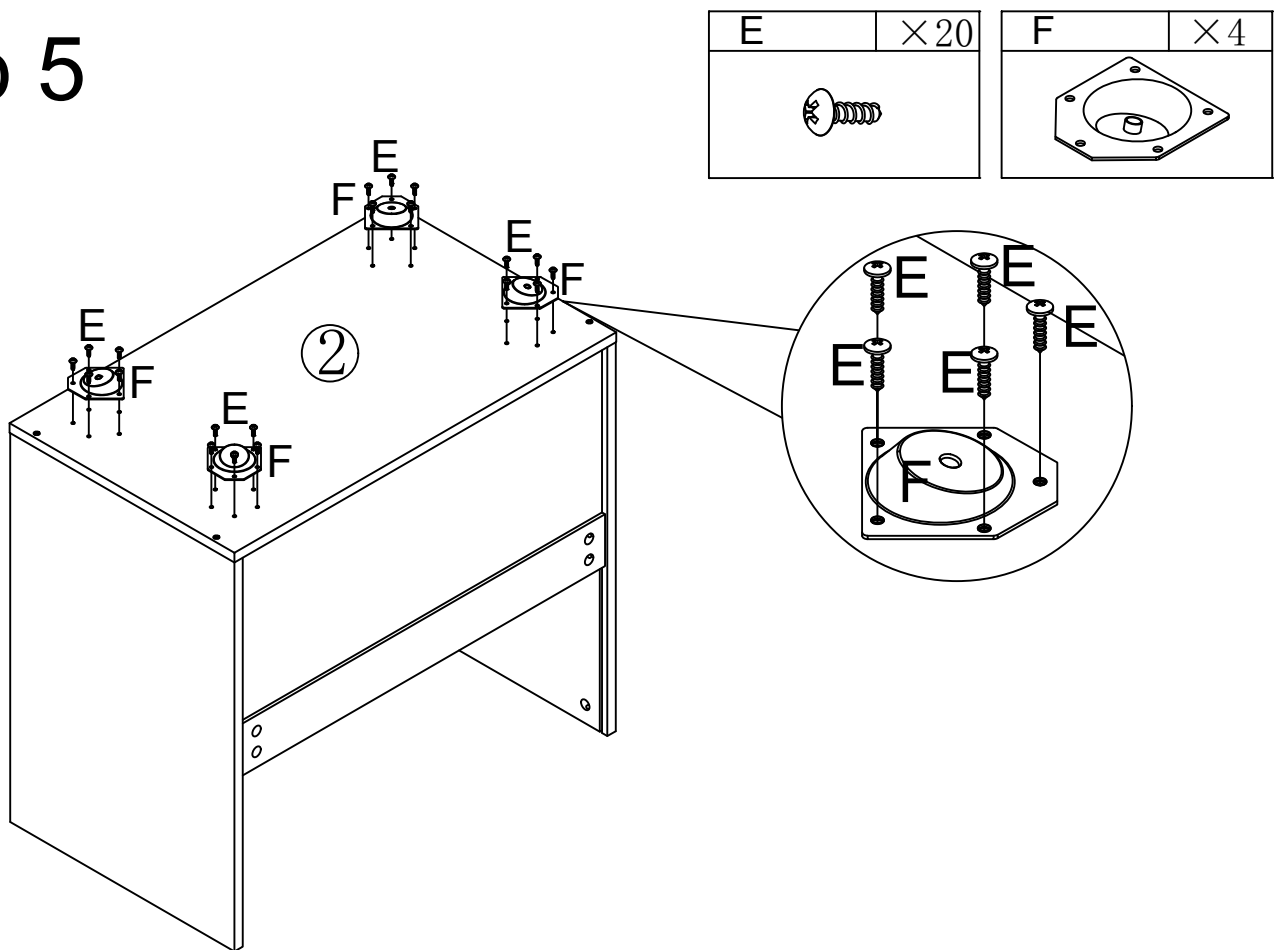

Step 6

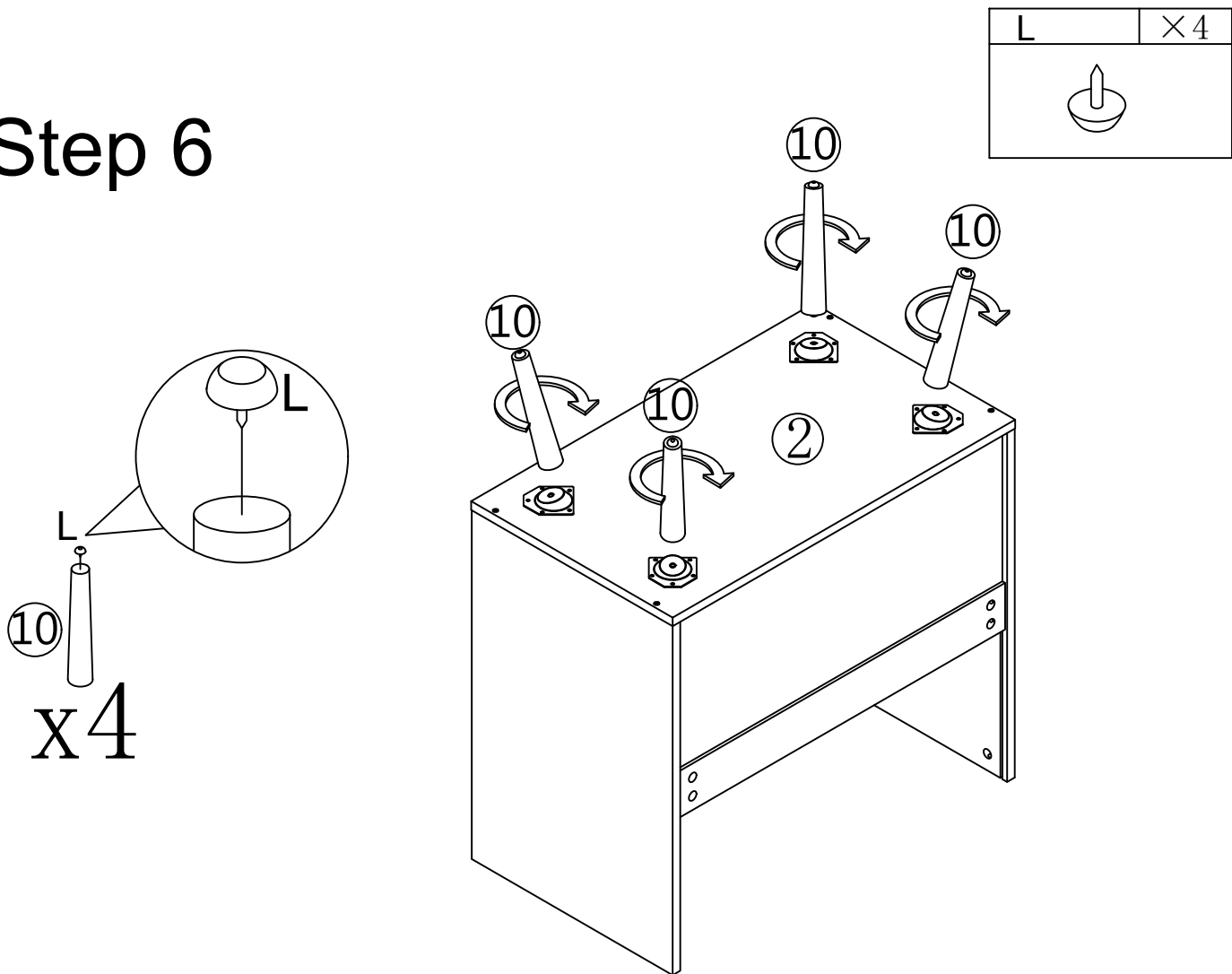

Step 7

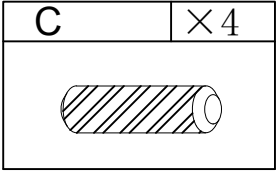
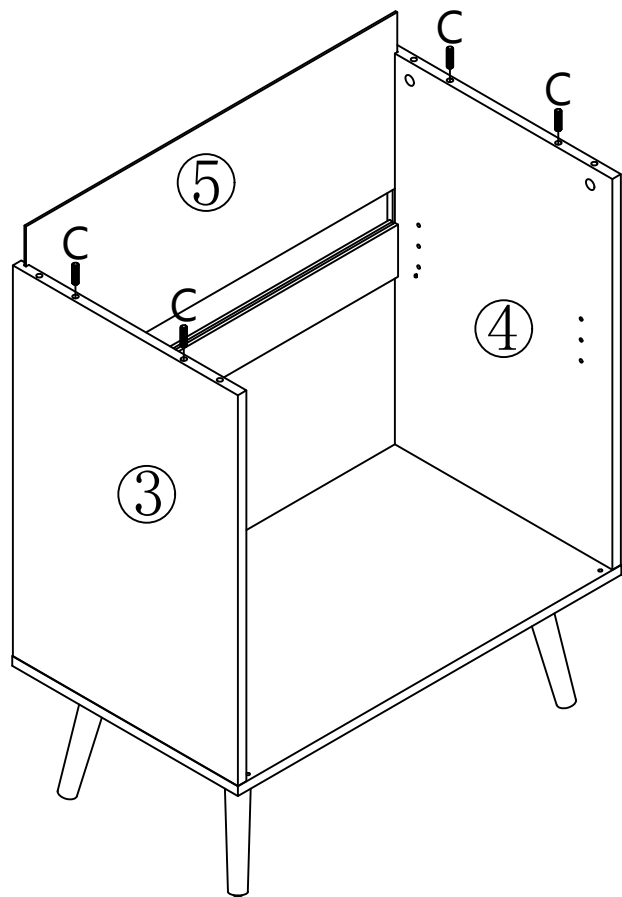

Step 8

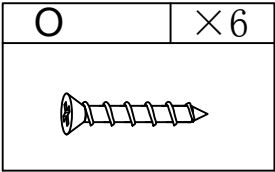
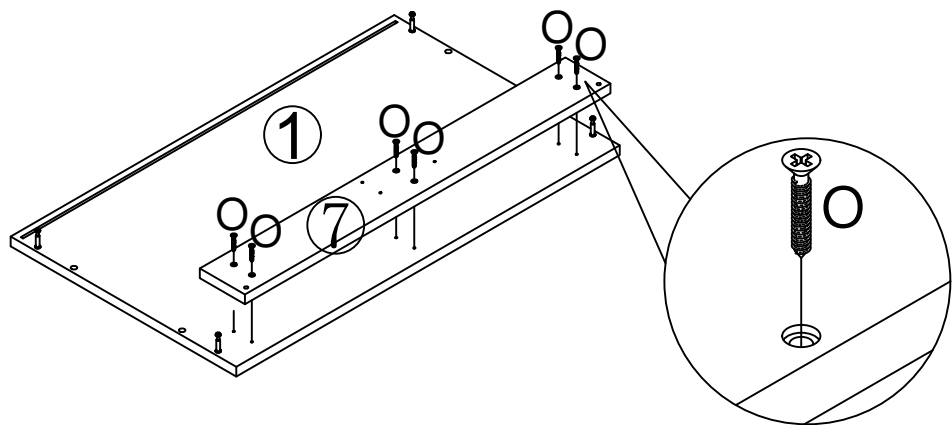

Step 9

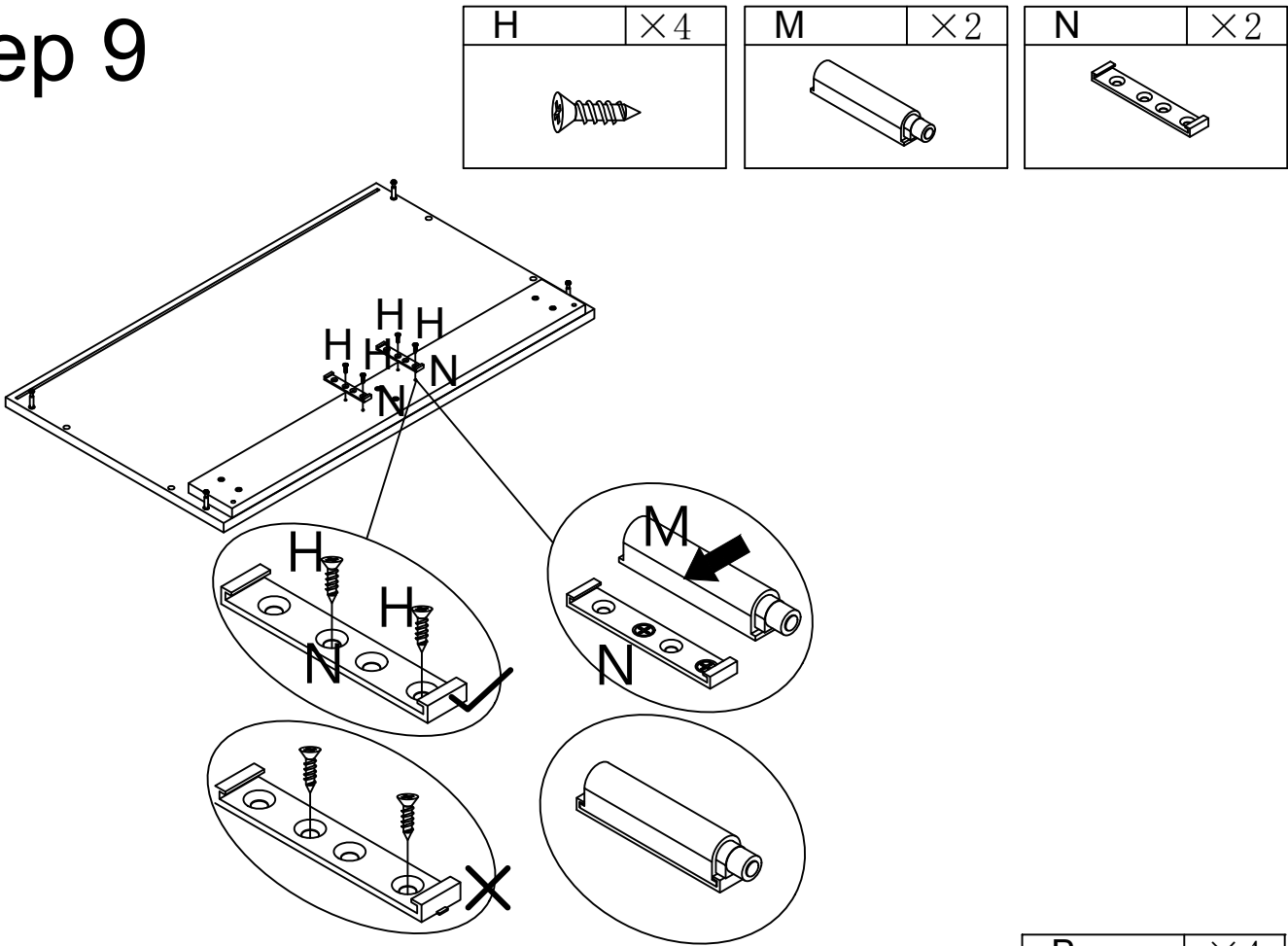

Step 10

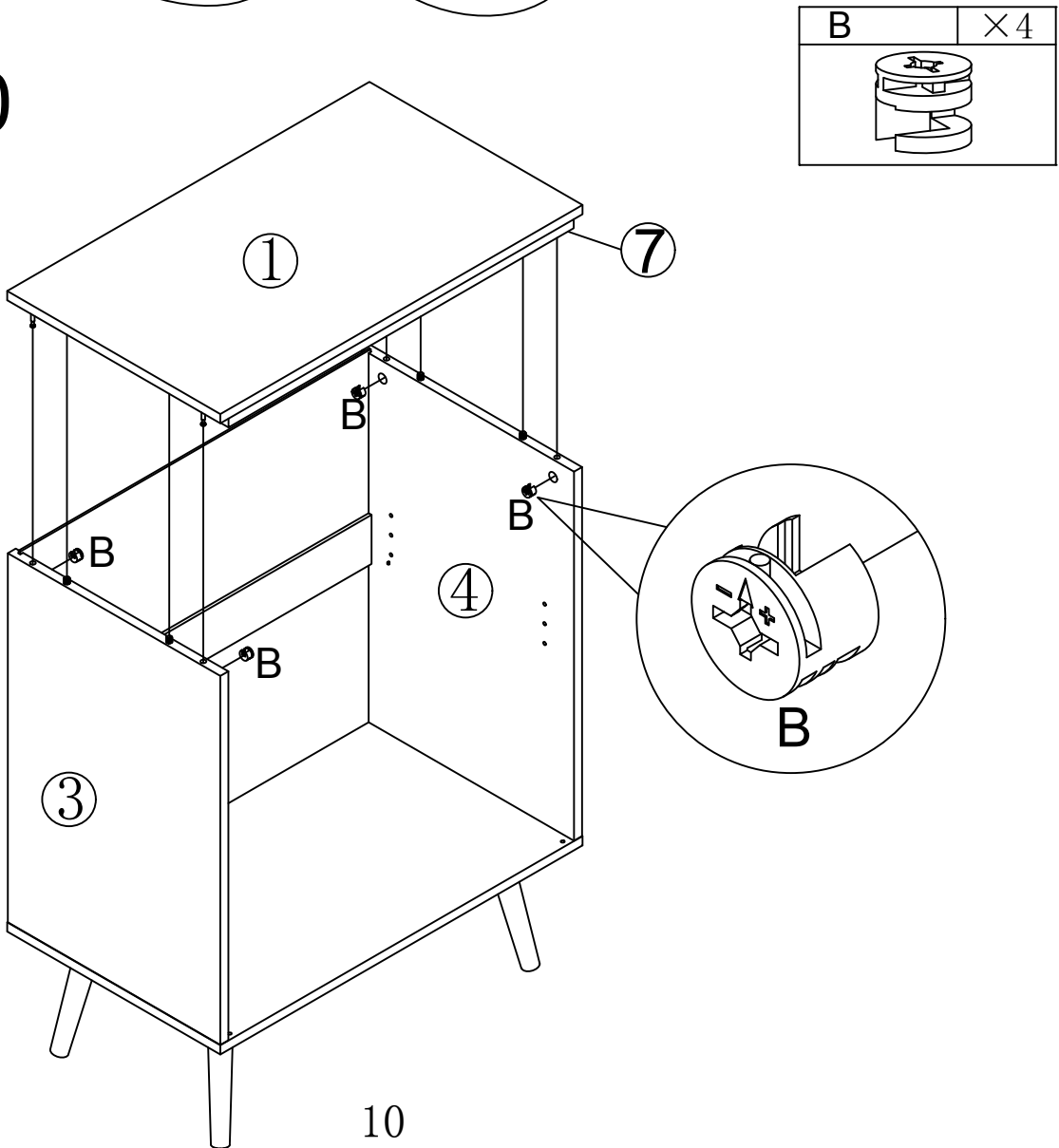

Step 11

P	×4
	

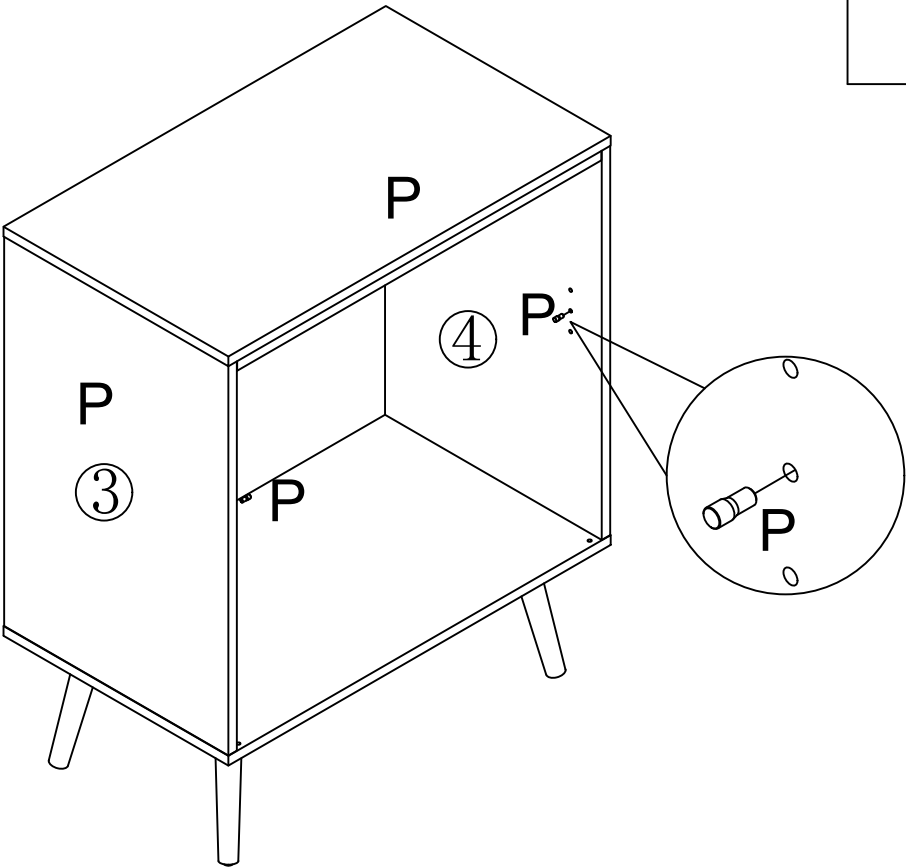

Step12

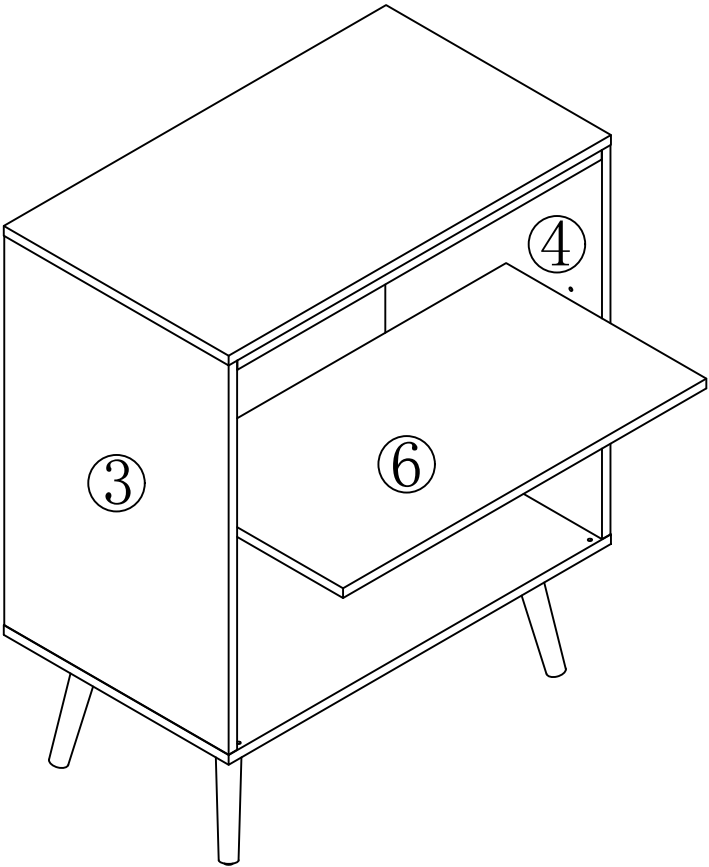

Step 13

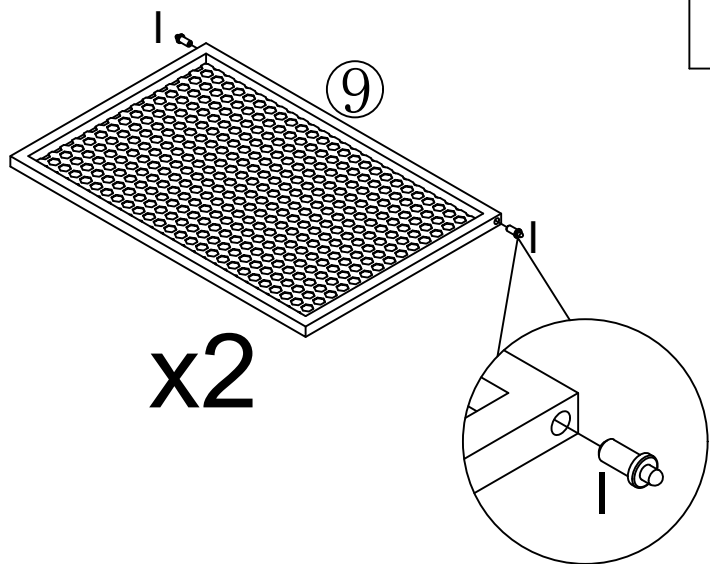

Step 14

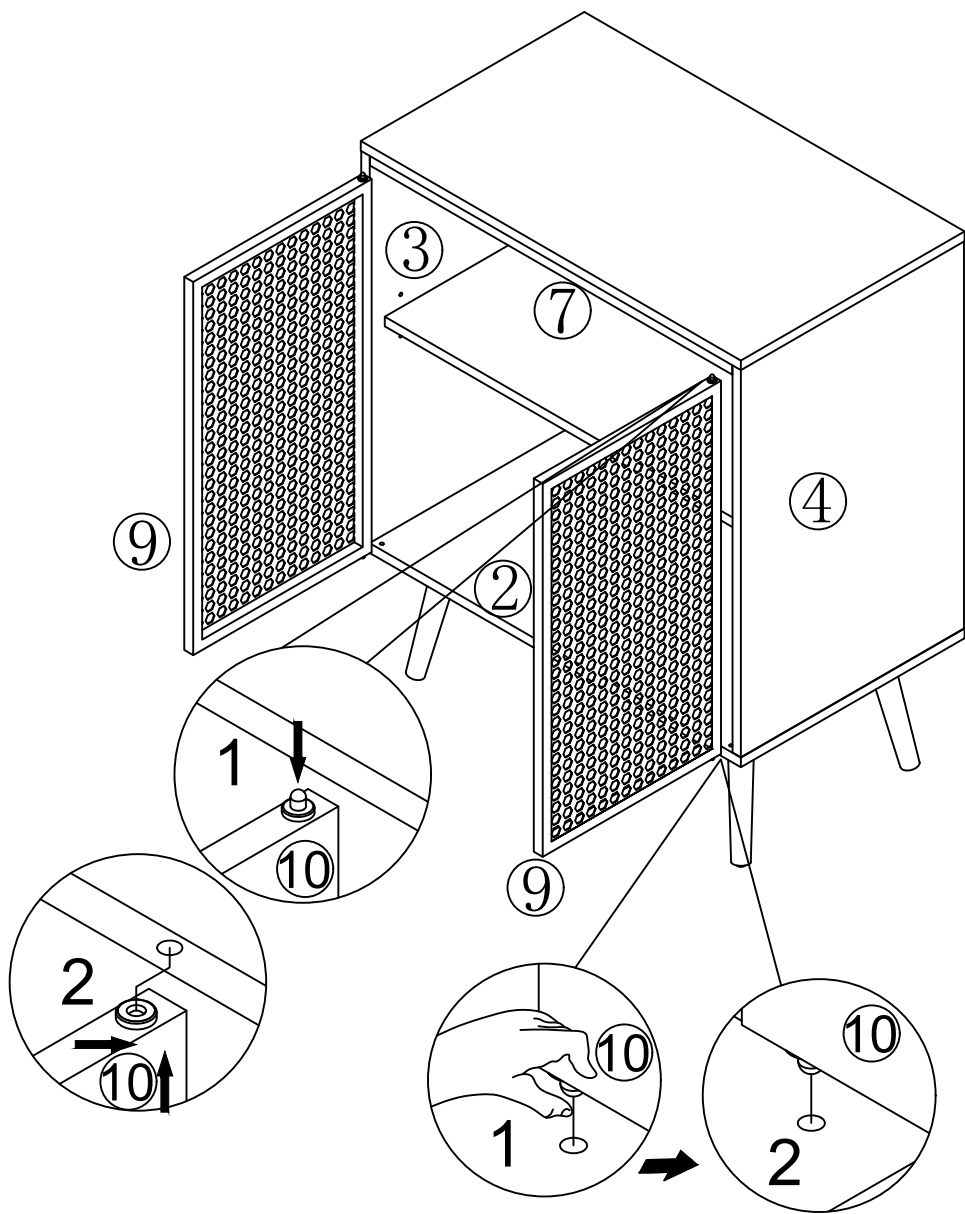

Step15

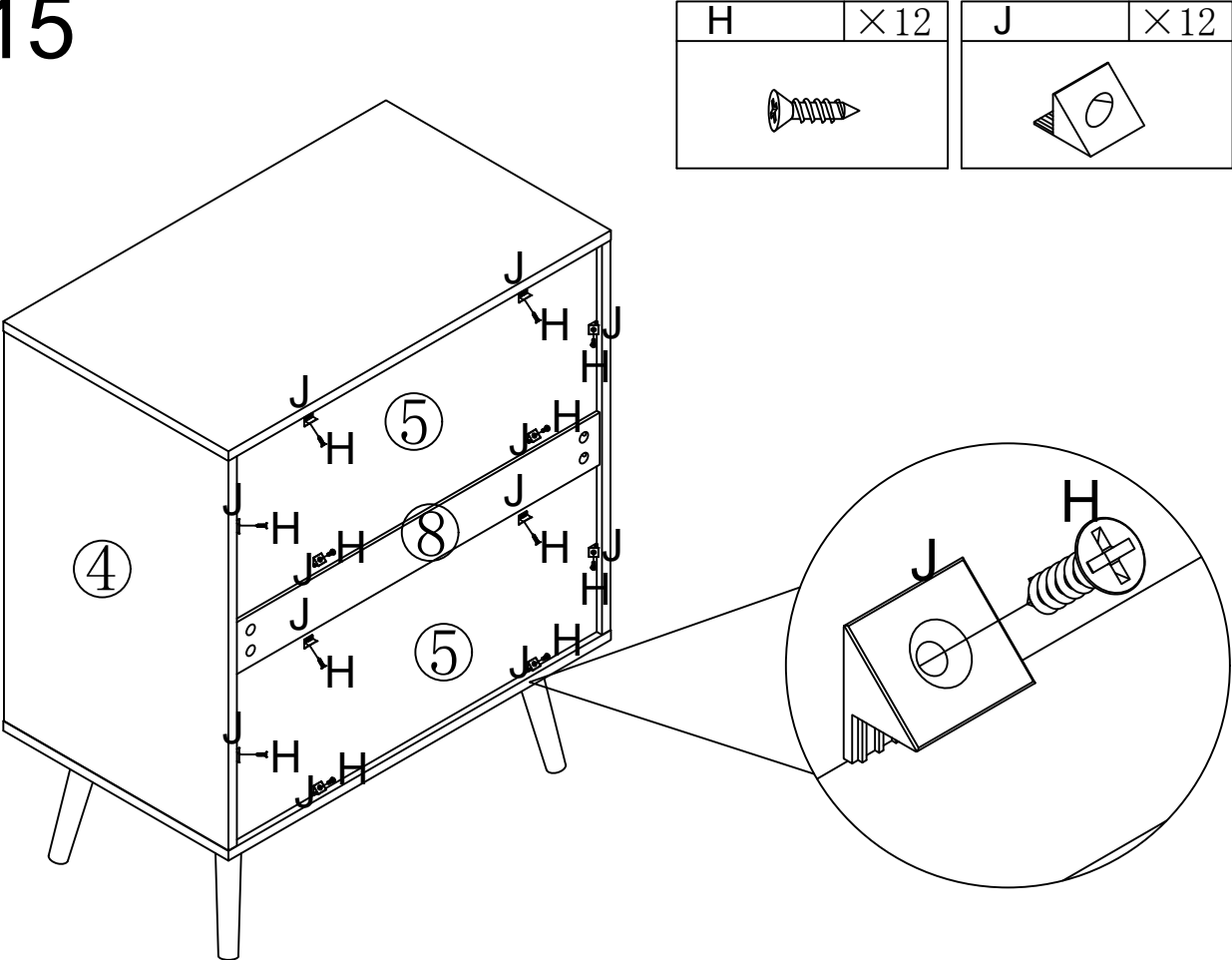

Step16

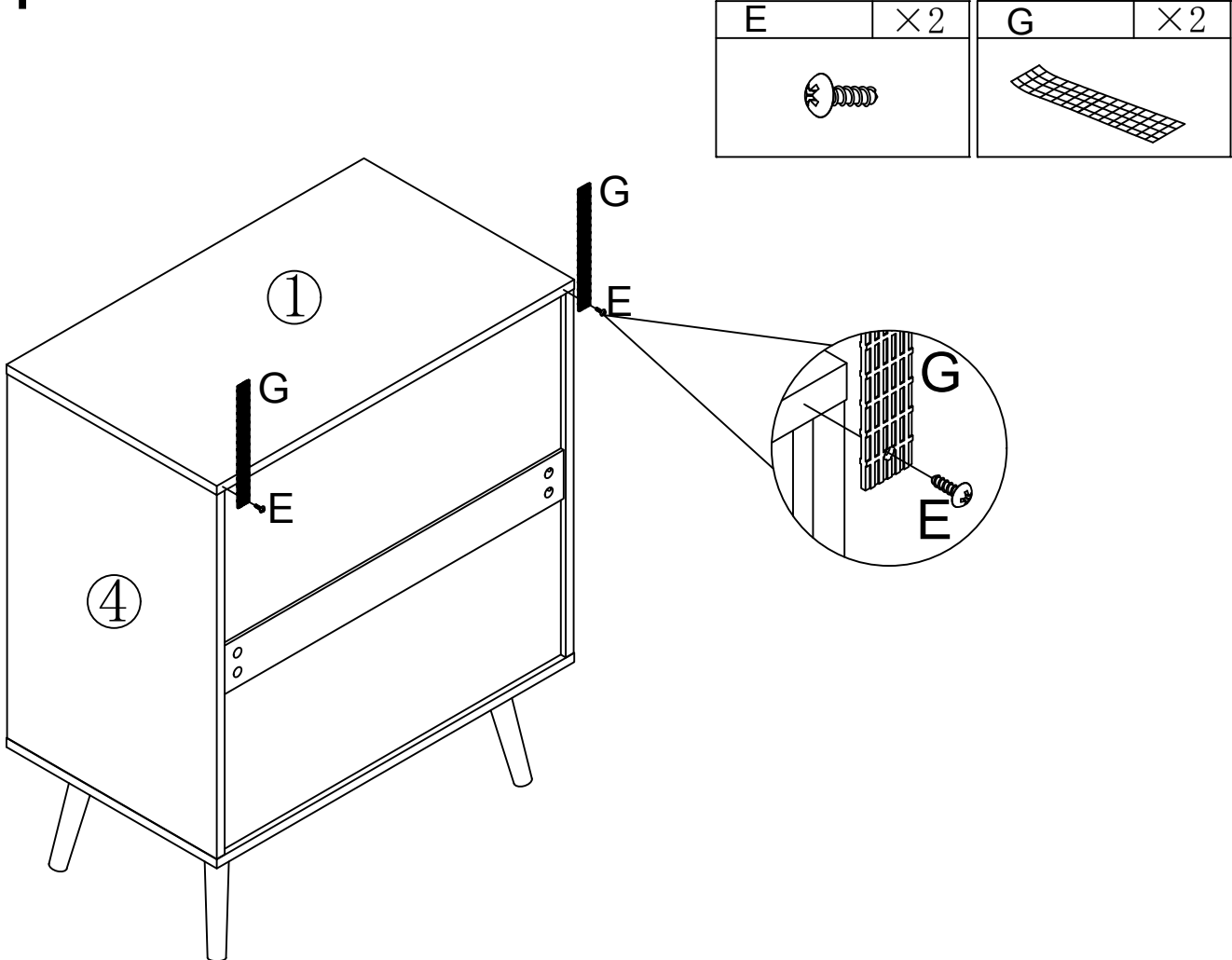

Step17

