



INLIGHT is registered trademarks of Inlight Co. Ltd. All Rights Reserved.

# Installation Guide

## Line Voltage LED Puck Light Kit



### Questions, problems, missing parts?

Contact the customer service department at [info@getinlight.com](mailto:info@getinlight.com)

We commit to respond to emails within 24 hours - and sooner, if possible!

We are devoted to solving problems and offering the best service to our customers.

Model #

IN-0106-3-XX-XX



**PLEASE READ THESE INSTRUCTIONS BEFORE COMMENCING INSTALLATION AND RETAIN FOR FUTURE REFERENCE.**



**ATTACH YOUR RECEIPT HERE**

Purchase Date \_\_\_\_\_

### Package Contents

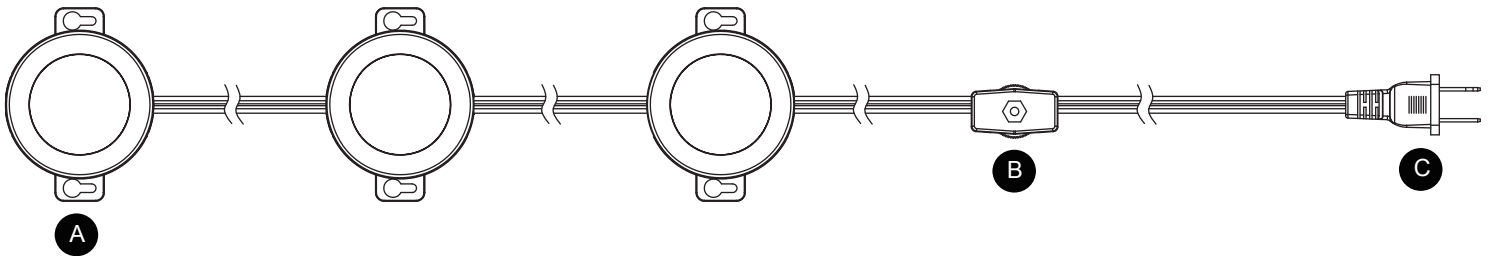

| Piece | Description   | Quantity |
|-------|---------------|----------|
| A     | Puck Light    | 3        |
| B     | On/Off Switch | 1        |
| C     | Power Plug    | 1        |

### Hardware Contents

### Tools Required

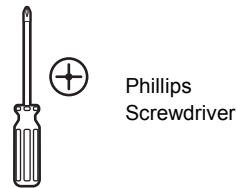

### Warning

These products may represent a possible shock or fire hazard if improperly installed or attached in any way. Products should be installed in accordance with these instructions, current electrical codes and/or current National Electric Code (NEC). To reduce shock of fire, electric shock or injury to persons, use only insulated staples or plastic ties to secure cords, route and secure cords so that they will not be pinched or damaged when the cabinet is pushed to the wall, position the portable cabinet light with respect to the cabinet so the lamp replacement marking are able to read during relamping. Not intended for installation in ceilings or soffits. The National Electrical Code (NEC) does not permit cords to be concealed where damage to insulation may go unnoticed. To prevent fire danger, do not run cord behind walls, ceilings, soffits or cabinets where it may be inaccessible for examination, cords should be examined periodically and immediately replaced when any damage is noted. To reduce the risk of fire, do not install in a compartment smaller than 6" X 6" X 6".

### Warranty

Inlight offers a warranty of 1 year for the LED puck lights from the date of purchase that cover repair or replacement of defective parts of the housing, optics, and electronics. To contact Inlight customer service send an e-mail to [info@getinlight.com](mailto:info@getinlight.com). For more information on technical specifications and additional accessories visit our website: [www.getinlight.com](http://www.getinlight.com)

## Installation

### 1 Locate the desired positions for all units

- Locate the desired positions where the LED puck lights (A) are to be mounted.
- Measure and mark the corresponding placement on the mounting surface for all units. Make sure everything is properly spaced before drilling screw holes into the cabinets.

**Note:**

Ensure the on/off switch (B) is within 42 in. of an electrical outlet and the puck lights (A) are located within 18 in. of the on/off switch (B).

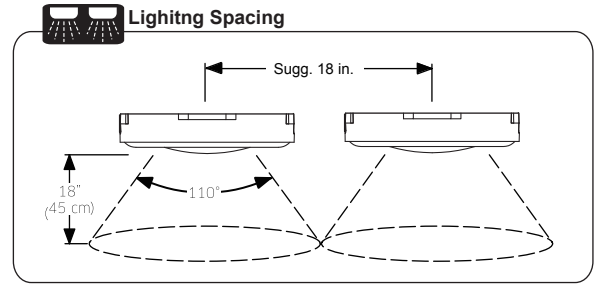
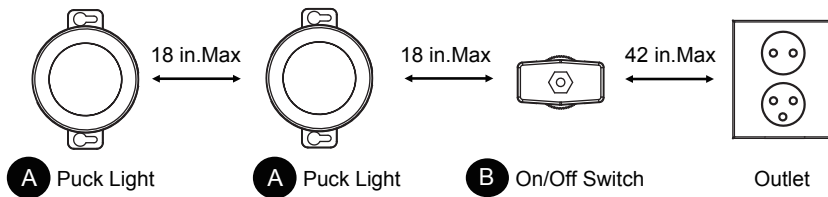

### 2 Install the puck lights

- Install the puck lights (A) to the bottom side of the cabinet by inserting two mounting screws (AA) into the mounting holes on the bottom of each puck light (A).

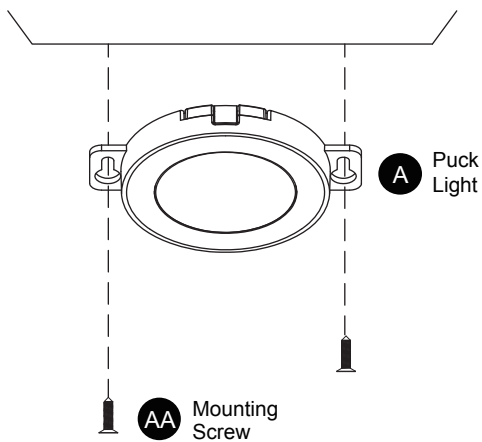

### 3 Secure the cords

- Excess puck light cords and power cord can be secured using the cord mounting clips (BB)

**Note:**

Proceed with caution when attaching the cord clips to the cabinet, make sure the metal nail does not pierce through the cord.

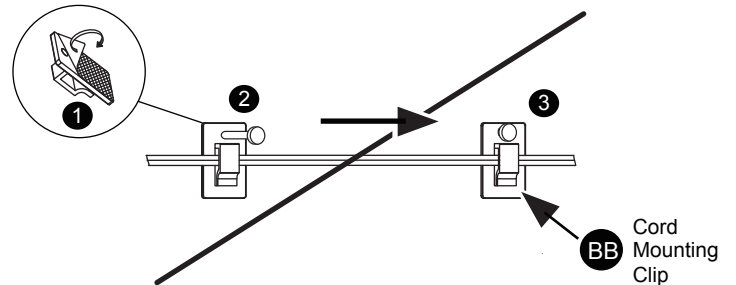

### 4 Connecting the LED puck lights

- Insert the power plug (C) into an electrical outlet and installation is now complete.

