

Thank You for Your Purchase!

We appreciate your business and hope you enjoy your new mantel. Below are the basic instructions for installation. Please read through them carefully before beginning.

**⚠ Caution:**

Use care when handling the mantel. As with any distressed wood product, splinters may be present.

**🔥 Important:**

Before installation, please check with your local building and safety codes regarding the minimum allowable clearance between the mantel and the fireplace opening.

**Tools and Parts Needed:**

- Power drill with appropriate drill bits
- Level
- Tape measure
- Screwdriver
- Pencil
- 2x4 or 2x6 (mantels with 7" face height) to be used as a ledger (not included)
- 2x2 for floating shelves with 3.5" face height

**Mounting Hardware:**

- (3) 3" wood screws – for mounting the ledger to wood studs
- (3) 1/4" wood screws – for securing the top of the mantel to the ledger
- (2) 1 5/8" wood screws – for the bottom of the mantel (do not overtighten)
- (3) Red Head Polyset anchors – for brick installation (see diagram)



Installation Instructions—Instrucciones de instalación  
Read these instructions carefully. Failure to follow these instructions can result in serious personal injury. Si no sigue estas instrucciones pueden producirse lesiones serias.

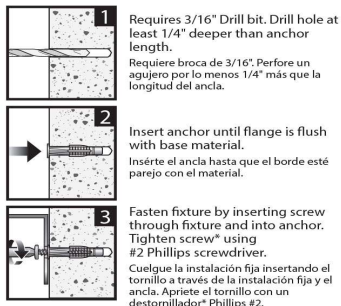

\*For drywall applications, tighten screw additional turns as indicated in "Poly-Set" Anchor Installation Information."  
\*Para las aplicaciones de tabla roca, apriete el tornillo unas vueltas más como indica la información de la instalación del ancla Poly-Set\*.

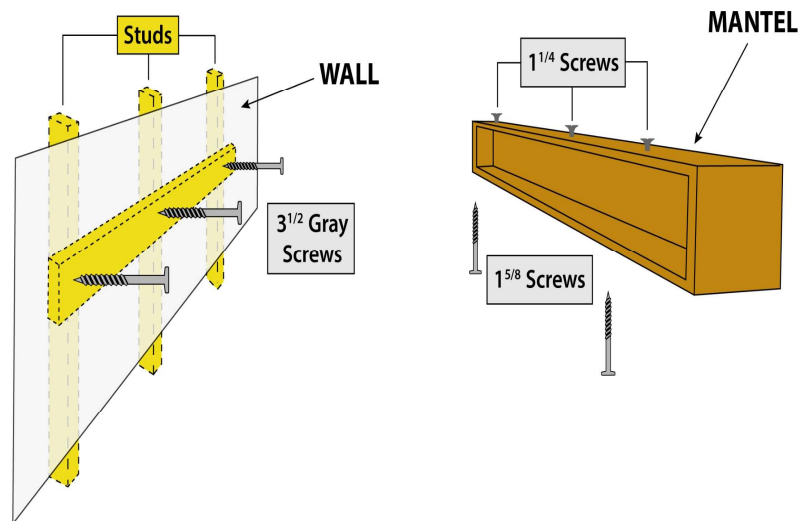

**Step 1: Position and Prepare the Ledger**

1. Position the mantel against the wall where it will be installed. Mark the top edge of the mantel on the wall, then set the mantel aside.
2. From the top mark, measure 3/4 inch downward and make a second mark—this indicates where the top of the ledger board will be mounted.
3. If you haven't done so already, cut a 2x4 or 2x6 (recommended for mantels with a 7" height) to a length that is 2–3 inches shorter than the mantel. This allows room for horizontal adjustment during installation.
4. Position the ledger on the wall, ensuring it is level.
5. Securely mount the ledger to the wall using appropriate screws or anchors for your wall type (e.g., drywall, plaster, masonry).
  - Note: It is critical that the ledger is firmly attached, as it will support the weight of the mantel.

**Step 2: Mount the Mantel**

1. Carefully place the mantel over the ledger, ensuring the top lip fits securely over the top edge.
2. Drill pilot holes through the mantel into the ledger to prevent splitting.
3. Fasten the mantel to the ledger using 2–3 wood screws—positioned at the top and/or bottom of the mantel.
  - Use longer screws for the bottom if additional support is needed, but be careful not to over-tighten.

**Final Step: Enjoy Your New Mantel!**