

ASSEMBLY INSTRUCTIONS

CHAIR



Read instruction carefully prior for assembly

Thank you for purchasing this quality product. check carefully for small parts which may have come loose during shipment. Remove all components from pack and place on soft surface to prevent scratching the finish during assembly. Identify and count all parts as specified below.

Hardware List

No.	Item	Picture	Q'ty
1	Bolt Ø5/16"*38mm		2
2	Bolt Ø5/16"*50mm		4
3	Bolt Ø5/16"*70mm		4
4	Flat Washer Ø21/64"*19*2		12
5	Lock Washer Ø21/64"*13.2*1.8		12
6	Screw Ø5/32" x 40mm		6
7	Allen Key M4		1

Part List

No.	Item	Picture	Q'ty
A	Chair Back		1
B	Seat Frame		1
C	Right Leg		1
D	Left Leg		1
E	Right Side Stretcher		1
F	Left Side Stretcher		1
G	Center Stretcher		1

STEP 1

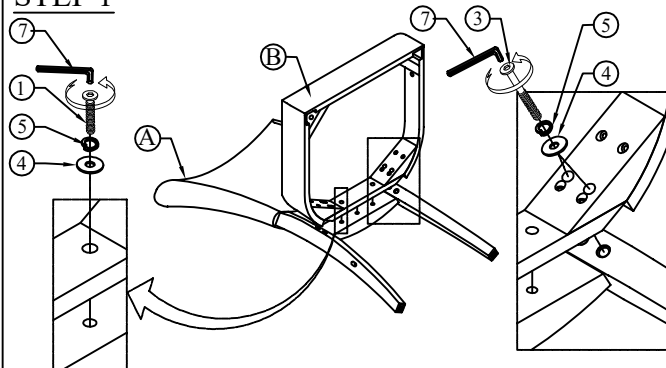

Align Seat Frame (B) to Chair Back (A), and secure in place as shown

STEP 2

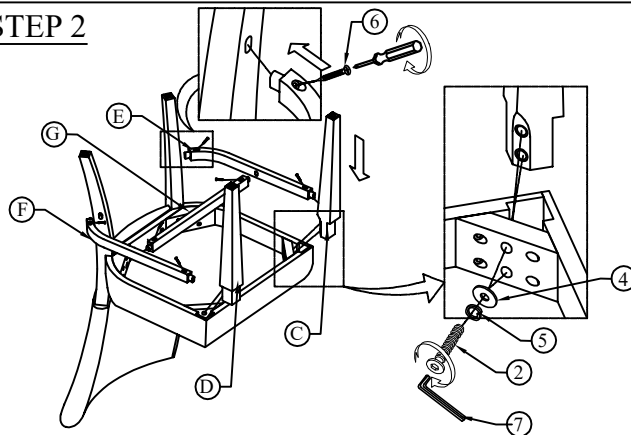

Assemble Right/Left Leg(D)(C) to Seat frame (B). Do not tighten
Assemble Stretcher (E)(F)(G) before attaching to Chair Leg

Make sure to level chair before tightening all the bolts
Complete.

