

Instruction for Remote Control:

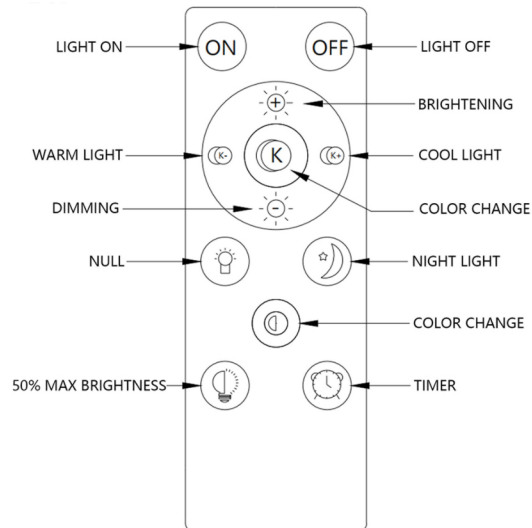

1. The button with MOON and STAR PATTERN represents "Night Mode" feature, which is able to reset the brightness and color of the lamp to default and make it suitable for sleeping.
 2. Press the timer button, if the lamp flashes, it indicates that 30mins timing function has been activated. Press it twice, if the lamp flashes twice consecutively, it indicates that 60mins timing function has been activated.
 3. Pairing should be performed before using the remote when it is unable to control the light, please complete the following steps below:
 - ①. Power on the lamp and press the "ON" button twice ("ON" button should be pressed within 3 seconds after the lamp turned on).
 - ②. If the light flashes 3 times after step 1, it indicates that the remote is successfully paired with the lamp.
 4. Depairing: Press the "ON" button five times consecutively within 3 seconds after the lamp turned on. If the lamp flashes swiftly 6 times, it indicates the lamp has been unpaired with the remote.
- Note: Please ensure that the FOOT SWITCH is ON before use remote control.
Batteries are not included in the remote control. Batteries are two AAA batteries.

Assembly Instruction:

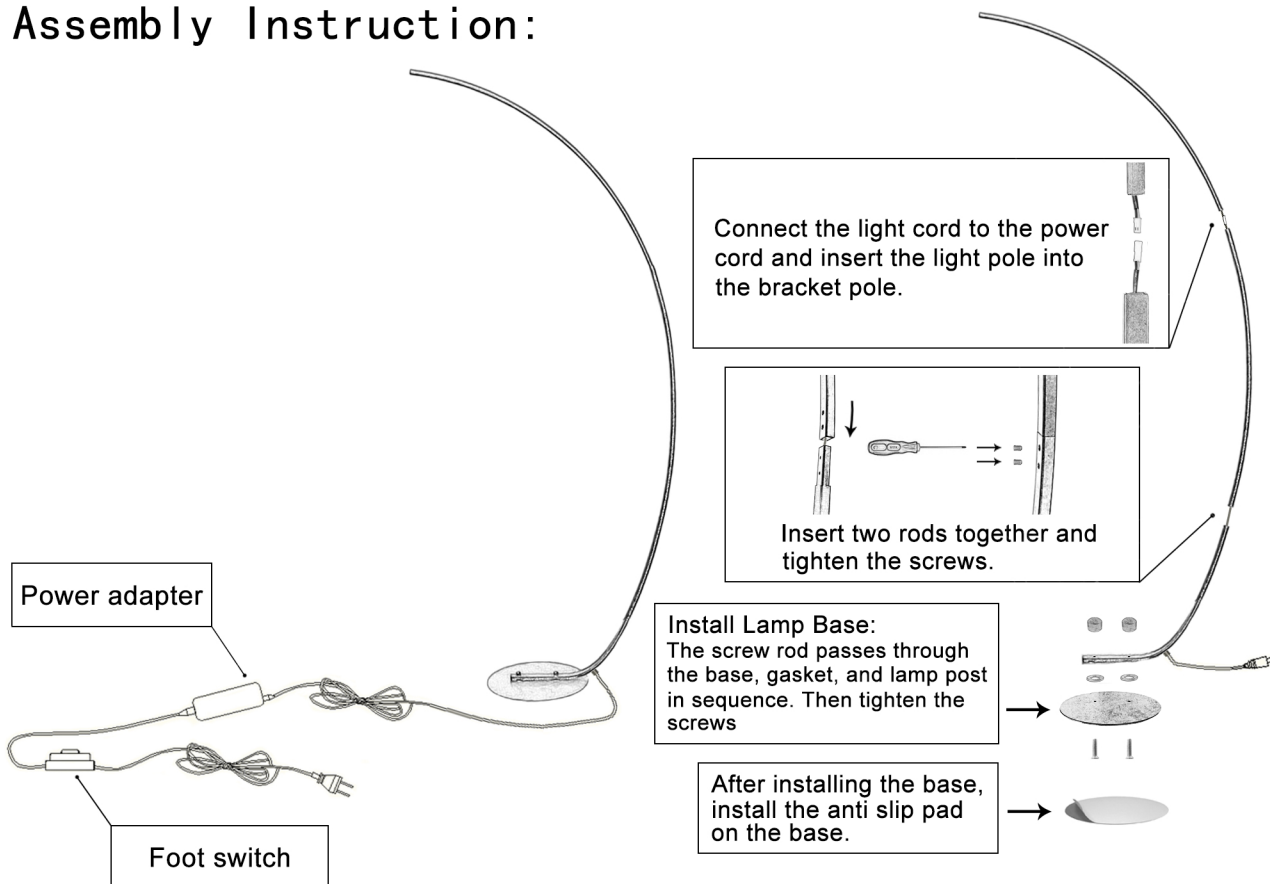

- Note:
1. All operations must be performed only after switching off or powering off.
 2. It is normal that yellow light spots appear from the light strip after brightness is adjusted to the minimum.
 3. The minimum brightness is not equal to 0% brightness.
 4. The lampshade may be slightly separated during transportation, which results in light leakage, it can be easily fixed by pushing it gently by hand.