

ASSEMBLY INSTRUCTION

Description : EK SIDE RAILS

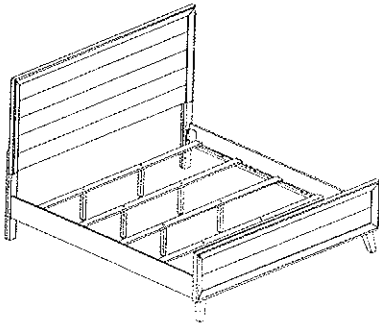

IMPORTANT NOTE :

- Place all wooden parts on a clean and smooth surface such as a rug or carpet to avoid the parts from being scratched.
- Check to be sure that you have all parts and hardware.
- Remove all wrapping materials, including staples & packing straps before you start to assemble.
- Do not tighten all screws / bolts until all completely assembled.
- Keep all hardware parts out of reach of children.

SIDE RAIL

COMPONENT LIST		
NO	DESCRIPTION	QTY/PCS
1	SIDE RAIL	2 PCS
2	SLAT	4 PCS
3	SUPPORT LEG	8 PCS

SIDE RAIL

HARDWARE LIST		
NO	DESCRIPTION	QTY/PCS
A	JCBB SCREW M8 x 25	8 PCS
B	SPRING WASHER 5/16"	8 PCS
C	FLAT WASHER M8 x 16	8 PCS
D	ALLEN KEY M5	1 PC
E	SCREW M4 x 32	8 PCS

NOTE : YOU WILL ALSO NEED A PHILIP SCREW DRIVER (NOT PROVIDED)

STEP 1

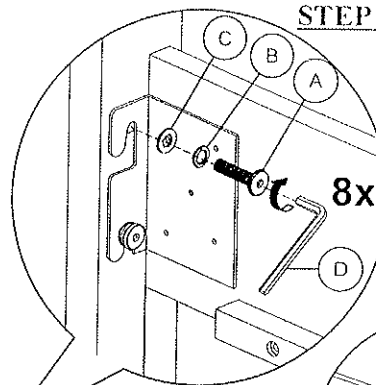

STEP 2

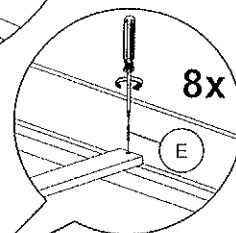

STEP 3

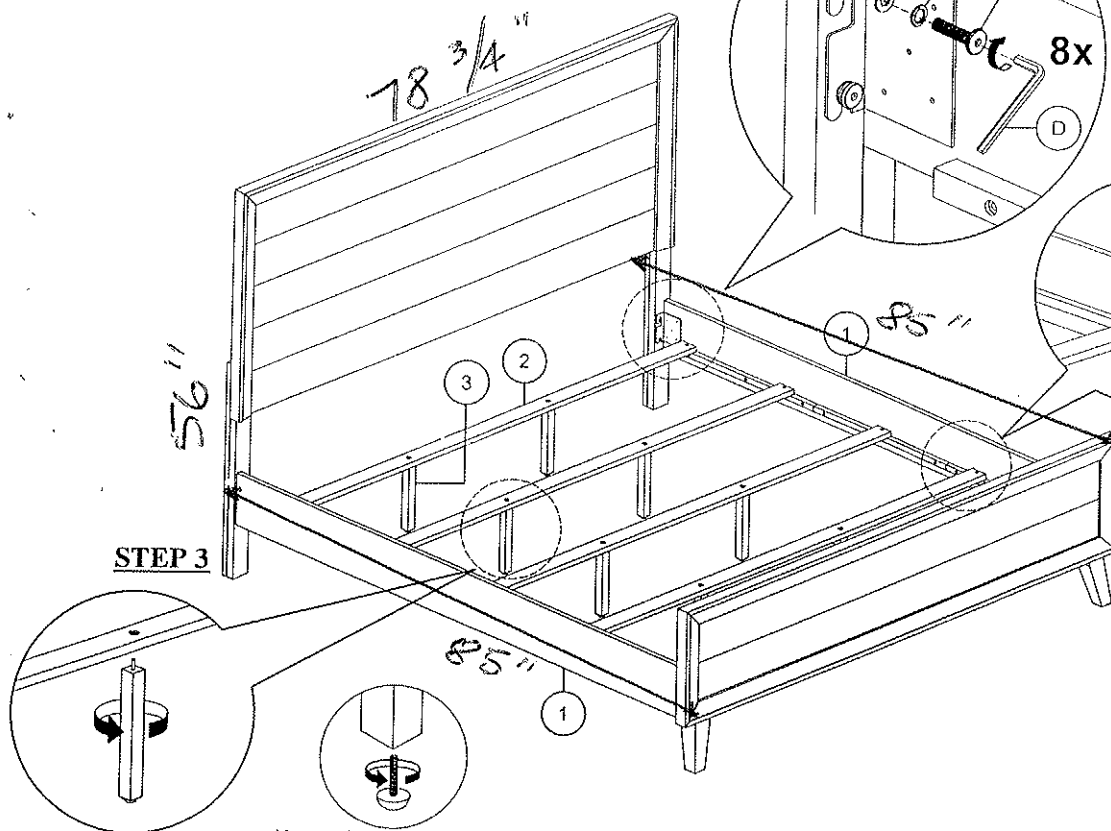

Note : Adjust leveller to stabilize