

Assembly Instructions

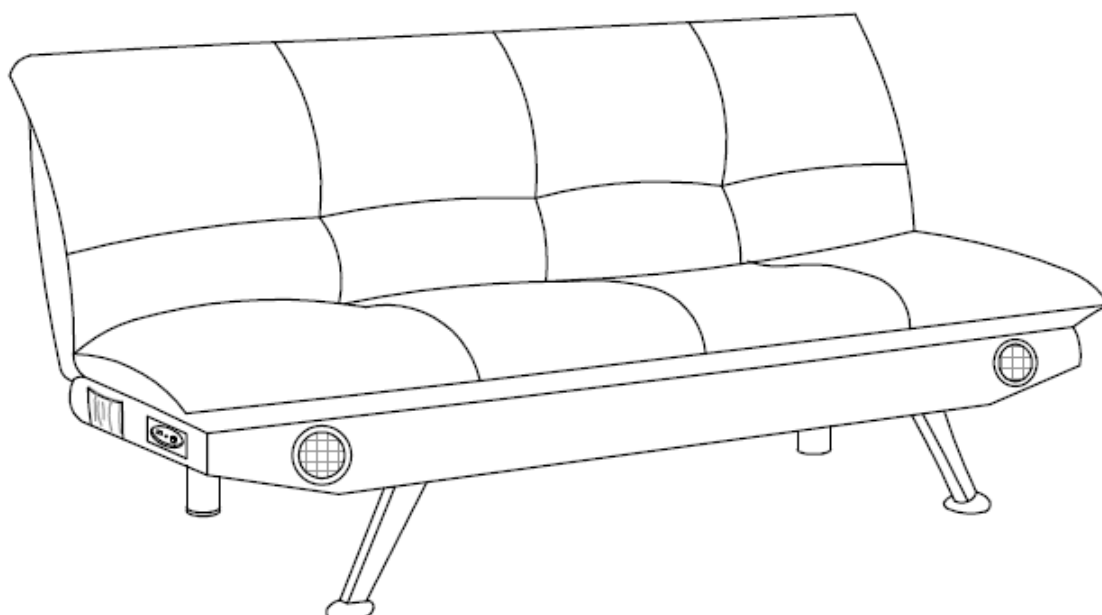

ASSEMBLY RATING

The Assembly Rating is a 5-point system that shows the degree of effort needed in assembling a specific product (with 1 being easy and 5 being difficult). For some products, two persons are recommended.

EASY  DIFFICULT

Tools Required for Assembly:

Allen Wrench



(Included)

Phillips Screwdriver



(Not Included)



2 PERSONS RECOMMENDED

ASSEMBLY & CARE ADVICE

FOR YOUR FURNITURE TO LAST, CORRECT ASSEMBLY AND PROPER MAINTENANCE ARE NECESSARY.
PLEASE FOLLOW THE INFORMATION PROVIDED BELOW TO FULLY ENJOY YOUR FURNITURE.

BASIC ASSEMBLY TECHNIQUES

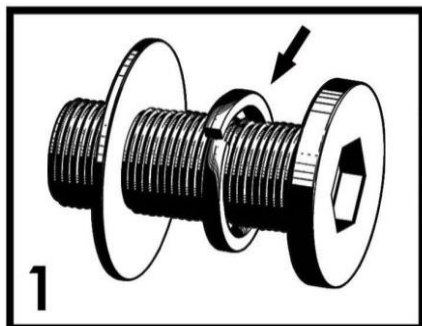

When lock or spring washer is used in an assembly, please make sure the lock or spring washer is placed between the larger flat washer and the head of the screw or bolt.

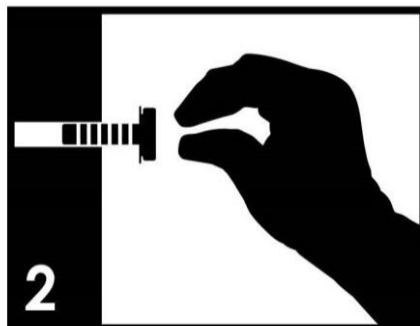

Position each part correctly and insert screws or bolts into their respective holes by hand tighten or using the proper hand tool. Only tighten when step is completed or when instructed to do so.

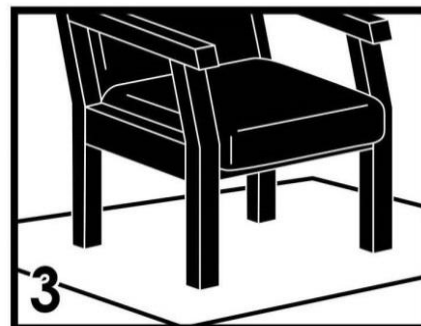

Use cardboard or carpet area when assembling furniture to prevent scratches. Make sure the furniture rests on a flat and level surface with each leg evenly touching the floor.

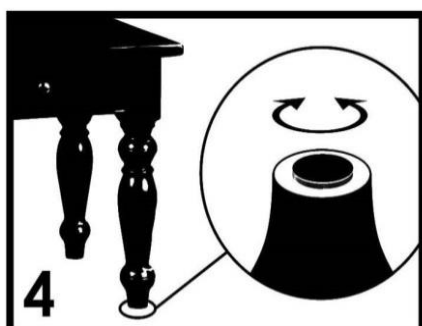

Some furniture comes with height adjustment knobs underneath each leg. To lower or to raise each leg, you need to turn clockwise or counterclockwise, respectively.

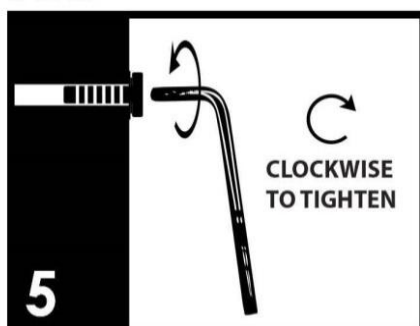

Make sure all parts are properly aligned, then use the appropriate hand tool to completely tighten the bolts or screws. Do not use power tools and do not overtighten.

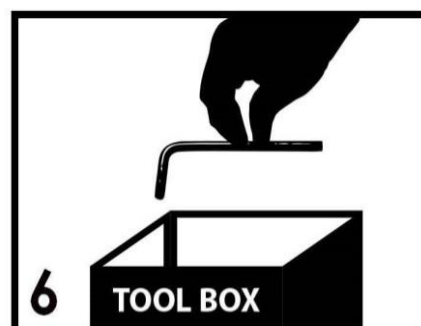

Save the instructions and store the Allen wrench or any supplied tool for later maintenance. After two weeks, check and tighten any loose hardware and repeat again every six months thereafter.

IT IS THE USER'S RESPONSIBILITY TO MAINTAIN THE FURNITURE. THE HARDWARE MAY LOOSEN OVER TIME AND MAY CAUSE THE FURNITURE TO BE WOBBLY AND UNABLE TO SUPPORT ITS INTENDED WEIGHT CAPACITY. THIS MAY LEAD TO COLLAPSE AND MAY CAUSE SERIOUS INJURY.



FAILURE TO FOLLOW THE GUIDELINES ABOVE MAY
RESULT IN INJURY AND/OR PROPERTY DAMAGE.

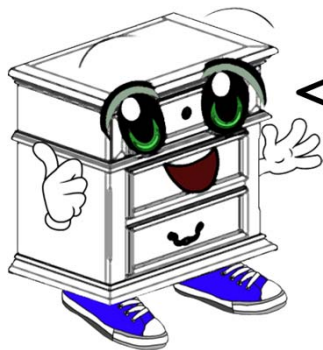

Before you begin, please read Page 2 of “Assembly and Care Advice”.

And remember, do not tighten until each step is completed or instructed.

MD

Parts List

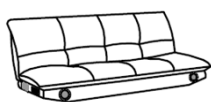

#1 x 1 pc
Futon

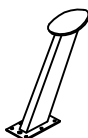

#2 x 2 pcs
Front Leg



#3 x 2 pcs
Rear Leg



#4 x 1 pc
Power Adapter

Hardware List



#A x 4 pcs
Bolt 1/4"x1"



#B x 1 pc
Allen Wrench



#C x 20 pcs
Screw

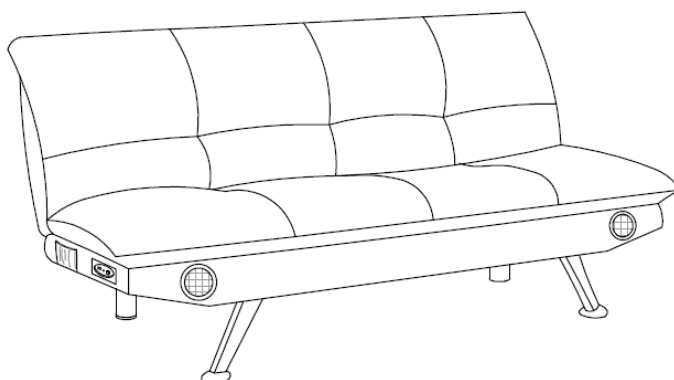

Due to the size and/or weight of this product, it is highly recommended that the assembly should be done near the area of its intended location. Make sure you have enough space to move around during the assembly. ALWAYS have at least two people to help with transporting and assembling the product to avoid any potential injury and/or damage.



With the help of another person, carefully place the futon (#1) facing down on a protective surface. Remove the 2 front legs (#2) and the 2 rear legs (#3) located inside the futon (#1).

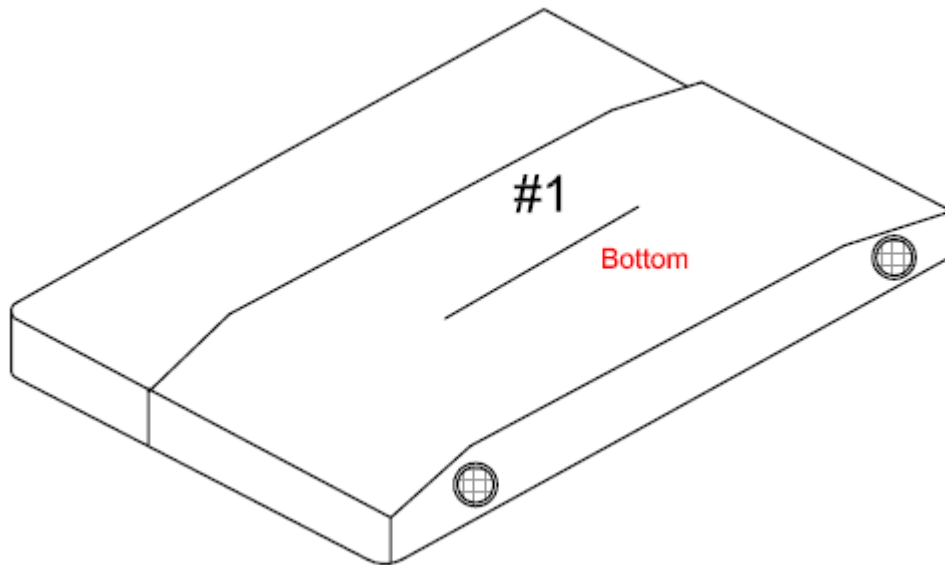

#A x 4 pcs
#C x 20 pcs

- I. Align the rear legs (#3) to the pre-drilled holes located along the bottom/rear side of the futon. Insert 4 screws (#C) into each rear leg and secure using a Phillips screwdriver.
- II. Align the front legs (#2) along the bottom/front side of the futon (#1). Insert 2 bolts (#A) into each leg and secure using the Allen wrench. Note, insert bolts into the two end pre-drilled holes. Then insert 6 screws (#C) into the remaining holes along the sides of the front legs.

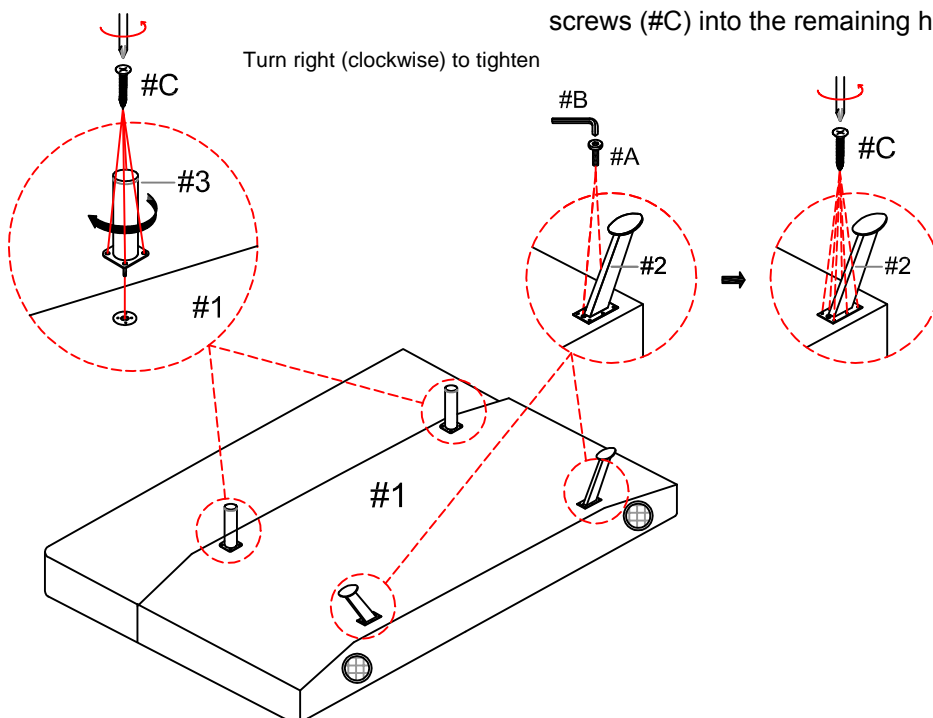



Carefully turn the futon upright. Make sure the futon is rested on a flat surface and does not feel loose or wobbly. If it does, double check that the bolts/screws are secured and properly tightened.

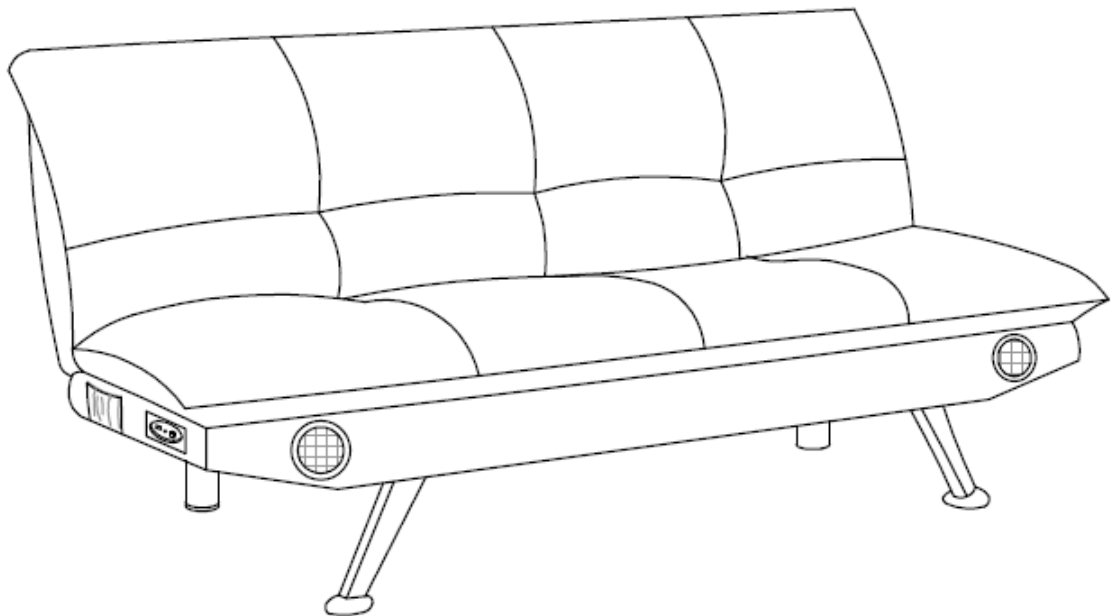

To supply power to the unit, plug the barrel pin connector of the power adapter (#4) to the connection port of the futon and the metal prongs of the power adapter (#4) into the AC wall outlet.

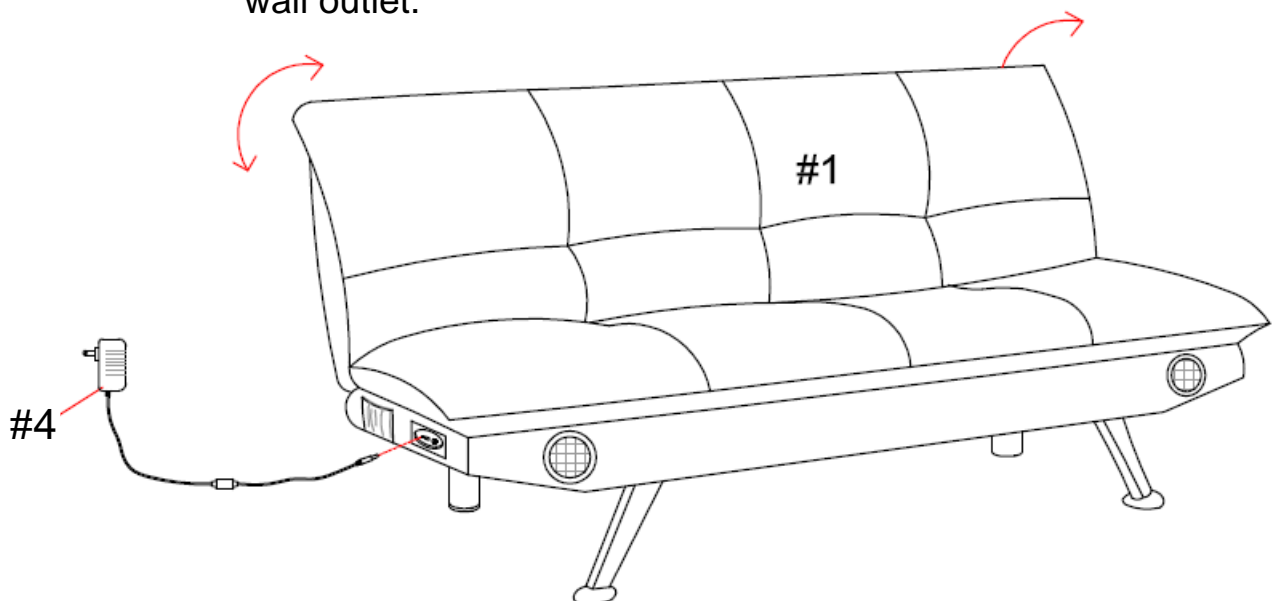

ASSEMBLY IS COMPLETED