

ASSEMBLY INSTRUCTIONS

Storage Cabinet

ASSEMBLY REQUIREMENTS:

2-Person
Assembly

1.5 Hours
Assembly Time
(Approximate)

Tools
Required:(Not
Provided)

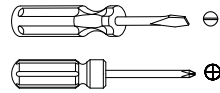

Thank you for purchasing our product!

Please refer and use this assembly instruction to assemble the product.
Contact our customer service department in case there are any missing or
damage parts or hardware. Replacement parts are normally shipped
within 2 or 3 days.

Within 30 days from delivery date

We appreciate your business!

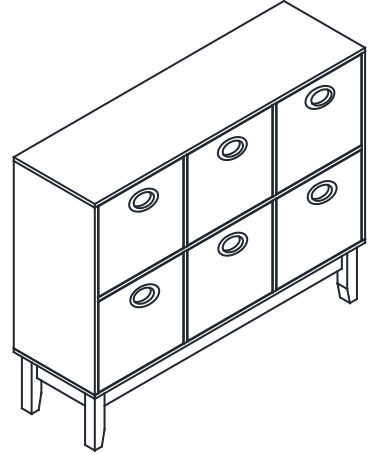

ASSEMBLY PREPARATION

1. Remove all packaging materials, staples and packing straps from the carton.
2. Refer to Parts List and Hardware List and ensure they are complete before you start assembling.
3. Place all wooden parts on a clean, flat and soft surface (e.g. carpet or rug) to prevent parts from getting scratched.

SAFETY PRECAUTION

1. KEEP ALL HARDWARE PARTS OUT OF REACH OF CHILDREN.
2. DISPOSE PLASTIC PACKAGING MATERIAL IMMEDIATELY TO AVOID ANY RISK OF SUFFOCATION TO CHILDREN AND ANIMALS.

TIPS FOR ASSEMBLY

1. Allow ample room for assembly and in close proximity to where product will be placed.
2. Assemble the product on a surface that does not scratch or damage the exterior gloss and finish of the furniture.
3. Please check all of the parts and quantities are included before assembly. Contact customer service for missing parts.
4. Identify all of the parts, hardware and quantities required for each step.
5. During assembly, do not over-tighten any fittings as this may cause damage.
6. DO NOT USE POWER TOOLS TO ASSEMBLE THIS PRODUCT.
7. Always place the product on a flat surface.
8. Do not sit or stand on the partially assembled product; only use the product for which it is intended.

CARE AND MAINTENANCE

- Use a slightly damp cloth to clean the product. Do not use bleach or abrasive cleaning material.
- Check all the fittings periodically and re-tighten as necessary. Do not use the product if any of the parts is damaged or broken.
- Never allow any kind of liquid to remain on your furniture. Absorption can cause wood to warp or delaminate.
- Do not place hot items (e.g. hot drinks) directly onto the wood surface.
- Do not drag and/or pull the furniture.

This product is for indoor and household use only - not for commercial use.

ASSEMBLY INSTRUCTIONS

Storage Cabinet

PARTS LIST

Part #	Part Name	Quantity
(1)	Middle Panel	1
(2)	Left Vertical Panel	1
(3)	Right Vertical Panel	1
(4L)	Left Panel	1
(4R)	Right Panel	1
(5)	Top Panel	1
(6)	Top Back Panel	1
(7)	Cabinet Bottom	1
(8)	Left & Center Door	4
(9)	Right Door	2
(10)	Wooden Legs	2
(11)	Bottom Back Panel	1
(12)	Wooden Legs	2

Parts Assembly Overview

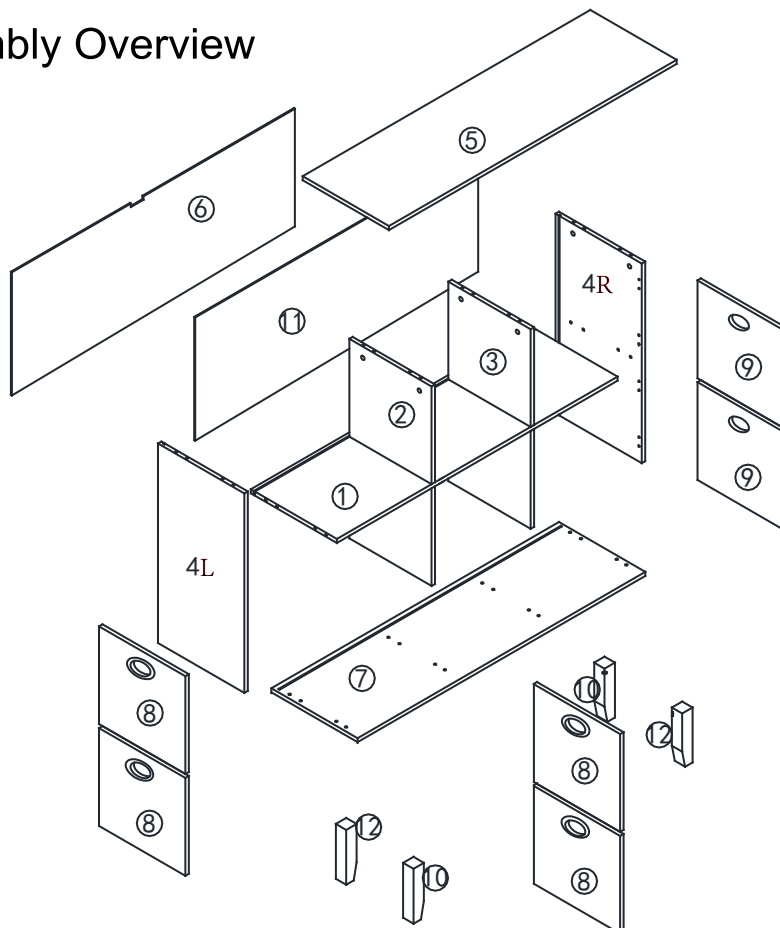

ASSEMBLY INSTRUCTIONS

Storage Cabinet

HARDWARE LIST



Ax12PCS

Cam-bolt



Bx12PCS

Cam-lock



Cx20PCS

Wood Dowel
M6x30MM

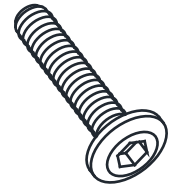

Dx4PCS

Bolt
M6x50MM



Ex4PCS

Spring Washer



Fx4PCS

Washers



Gx1PC

Allen Key



Hx18PCS

Screw
M3x14MM



Ix6PCS

Magnetic Catch

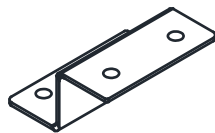

Jx12PCS

Hinge



Kx54PCS

Screw
M3x12MM



Lx6PCS

Metal Clasp



Mx9PCS

Screw
M4x35MM



Nx1PC

Screw
M4x10MM



Ox1PC

Safety Strap
L157xW25MM



Px1PC

Plastic Wall
Anchor



Qx6PCS

Panel Stopper

Instructions For Fastening CAM-BOLT and CAM-LOCK

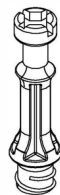

CAM-BOLT



CAM-LOCK

CAM-BOLT

Insert Cam-bolt into the pre-drilled hole. Use a Phillips Screwdriver to tighten until shoulder is snug and flushed with the panel. See illustrations below.

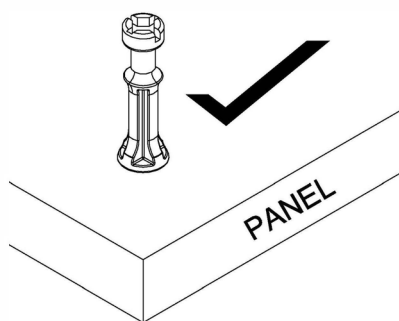

Shoulder is flushed (on the same level) with the panel.

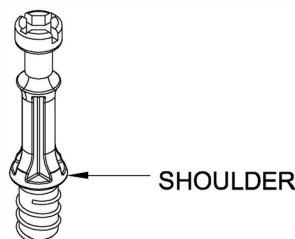

SHOULDER

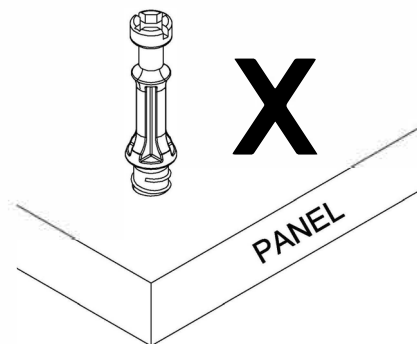

Shoulder is above the panel.

CAM-LOCK

Align the arrow on the Cam-lock to the Cam-bolt head and insert the Cam-lock.

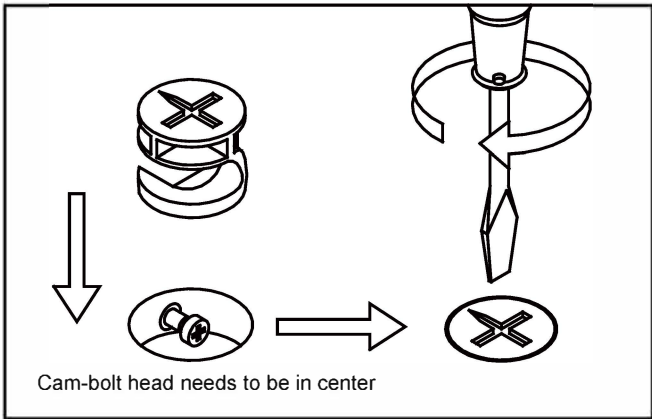
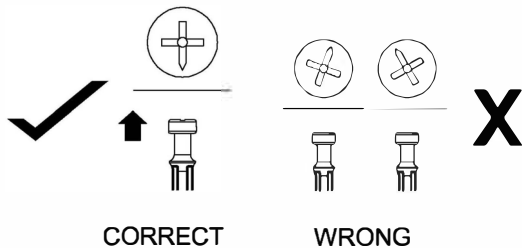

Use a Flat-head Screwdriver to turn Cam-lock clockwise to lock onto the head of the Cam-bolt. Turn until it is snug (about one half a turn) -- over-tightening could damage Cam-lock or/and Cam-bolt.

ASSEMBLY INSTRUCTIONS

Storage Cabinet

STEP 1

- a) Locate pilot holes on the bottom-side of (1) for Magnetic Catch(I). Use a Phillips Screwdriver to drive Screw(H) to affix (I) to (1). Do not tighten the screws until both screws are in place.
- b) Fit Left and Right Vertical Panels(2&3) to Middle Panel(1) by inserting into the slots on the respective panels.

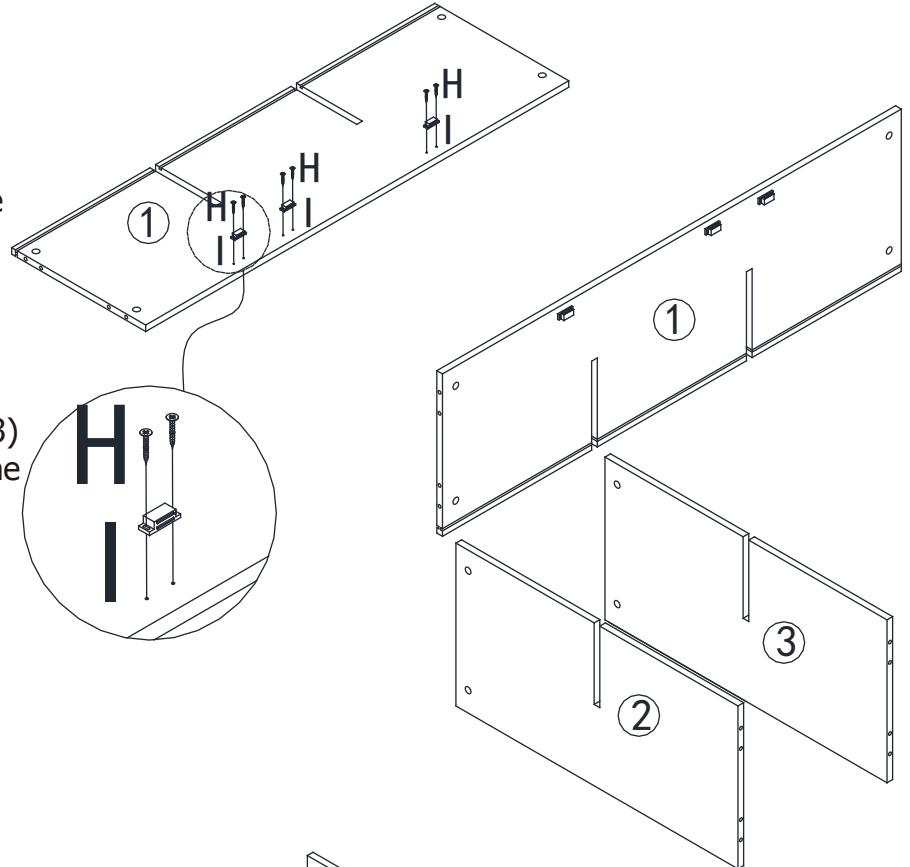

STEP 2

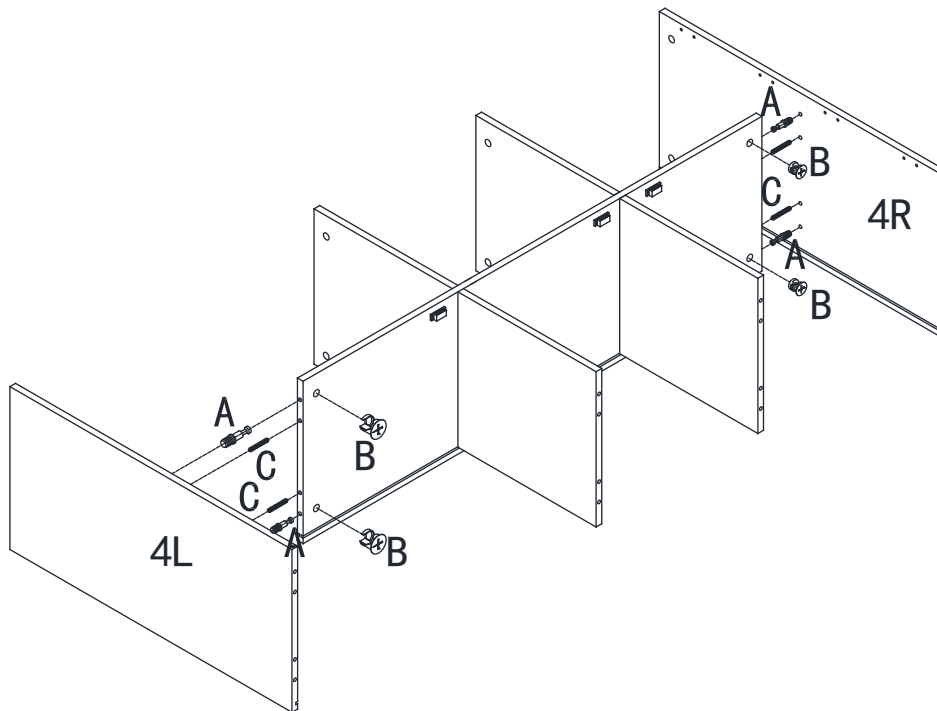

- a) Screw in Cam-bolt (A) into the designated holes on Right Panel (4R) - refer to page 4 for instruction on fastening Cam-bolts. (Note: It is easier to screw in (A) with (4R) laid flat down. Take care not to scratch or damage its exterior surface.)
- b) Insert Wood Dowel (C) into designated holes between Cam-bolts on (4R).
- c) Attach (4R) to right edge of Middle Panel (1) via (A) and (C).
- d) Insert Cam-lock (B) into designated holes near the right edge of (1) and turn (B) clockwise to lock onto Cam-bolt. Refer to page 4 for instruction on inserting and fastening Cam-lock.
- e) Use the above procedures to fasten Left Panel (4L) to Middle Panel (1).

ASSEMBLY INSTRUCTIONS

Storage Cabinet

STEP 3

Fit Bottom Back Panel(11) by inserting the side edges of (11) into the groove on Left&Right Panels(4L&4R).Check that the bottom edge of (11) also fits into the groove of Middle Panel(1).

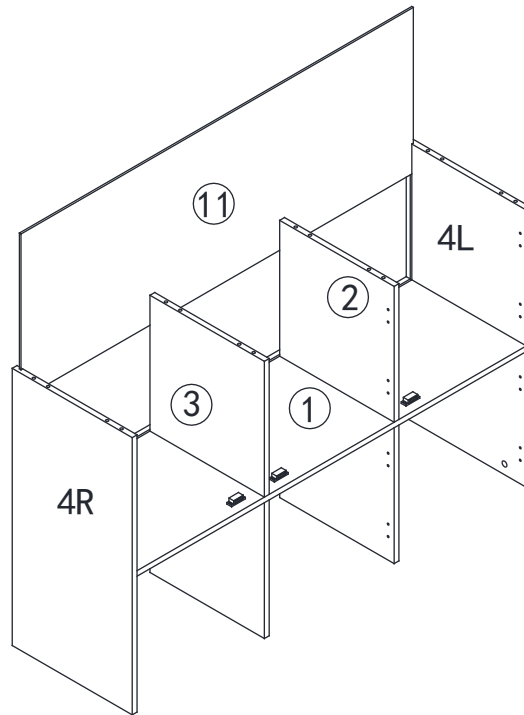

STEP 4

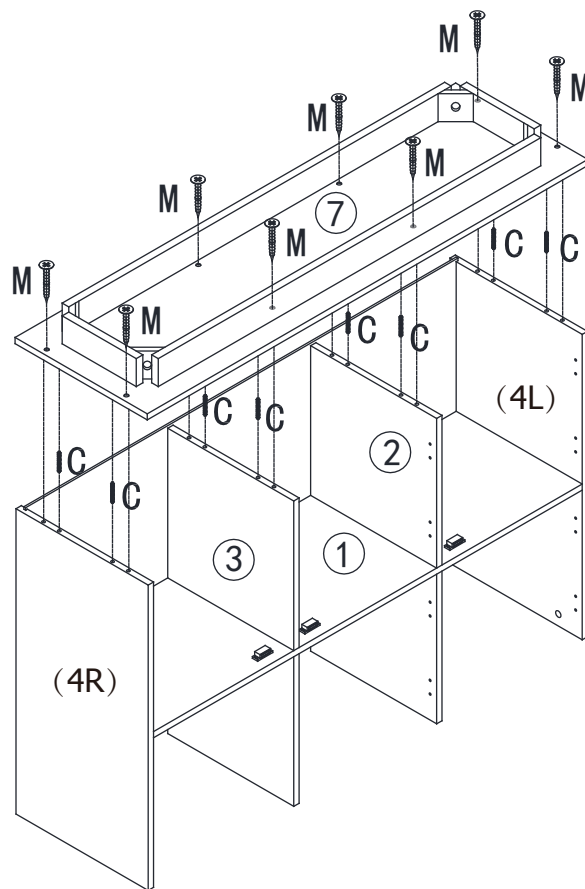

- Insert Wood Dowel (C) into designated (inner 2) holes on Panels (4L, 2, 3 & 4R) as shown.
- Attach Cabinet Bottom (7) to by fitting the designated holes for Wood Dowels on (7) to the Wood Dowels on Panels (4L, 2, 3 & 4R). Check to ensure the Bottom Panel (11) fits into the groove on Cabinet Bottom.
- Use a Phillip Screwdriver to drive Screw (M) to fasten Cabinet Bottom to Panels (4L, 2, 3 & 4R).

ASSEMBLY INSTRUCTIONS

Storage Cabinet

STEP 5

Position Wooden Legs(10&12) against the corner block on the rail of the Cabinet Bottom and align the bolt hole on (10&12) to the bolt hole on the corner block. Next, insert Bolt(D) fitted with Spring Washer(E) and Flat Washer(F) into each hole. Use Allen Key(G) to drive (D) to corner block. Do not over-tighten.

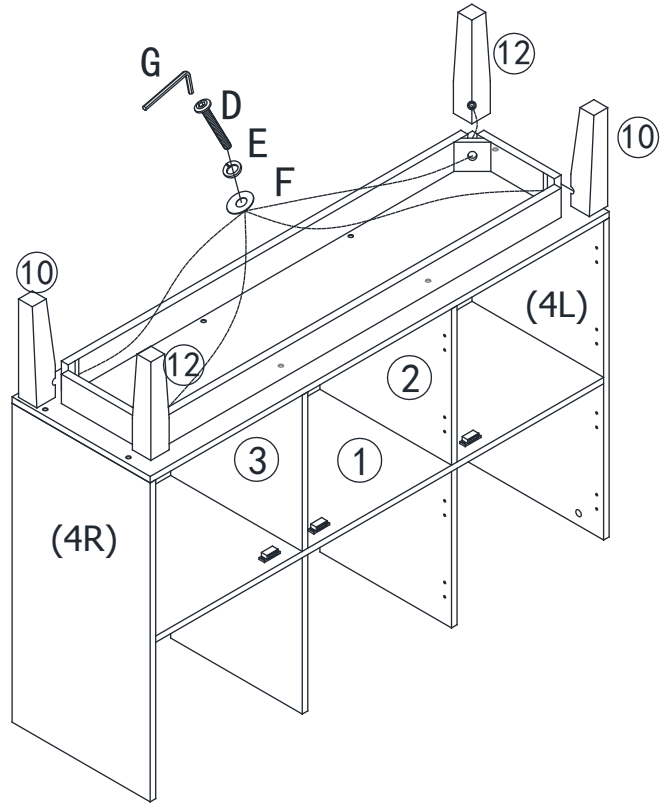

STEP 6

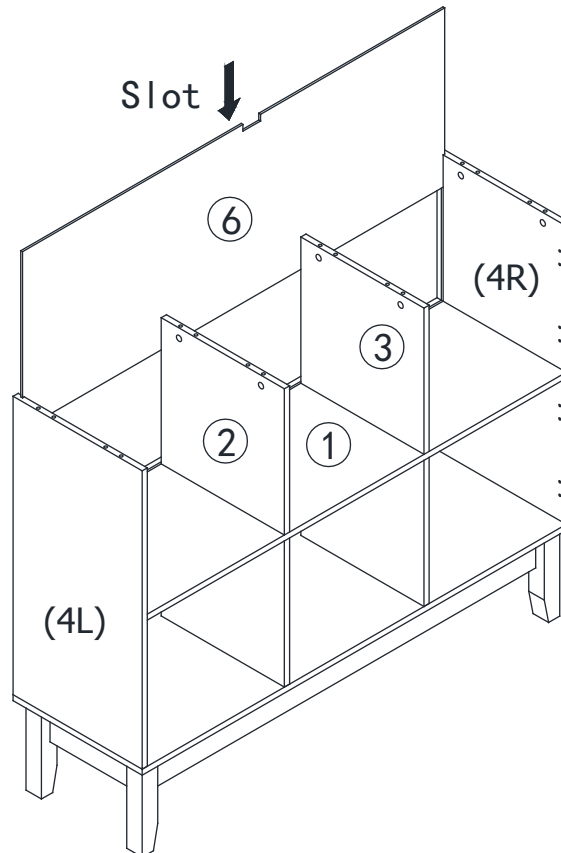

Fit Top Back Panel(6) by inserting the side edges of (6) into the groove on Left&Right Panels(4L&4R). Note the slot on (6) has to be on top. Check that the bottom edge of (6) fits into the groove of Middle Panel(1).

ASSEMBLY INSTRUCTIONS

Storage Cabinet

STEP 7

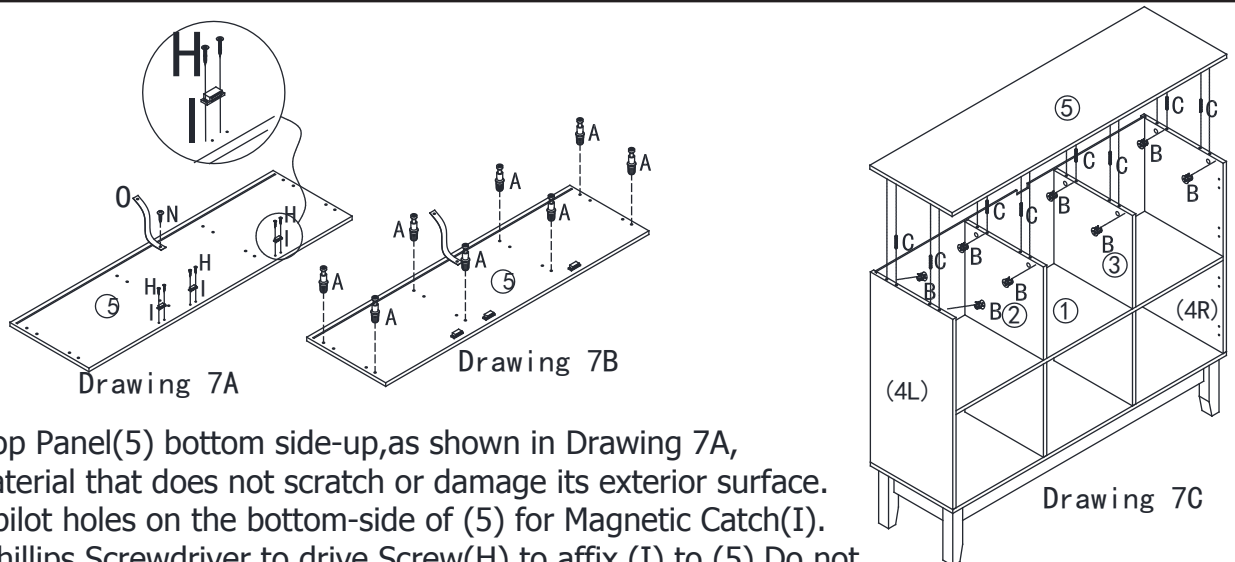

- Place Top Panel(5) bottom side-up, as shown in Drawing 7A, on a material that does not scratch or damage its exterior surface.
- Locate pilot holes on the bottom-side of (5) for Magnetic Catch(I). Use a Phillips Screwdriver to drive Screw(H) to affix (I) to (5). Do not tighten the screws until both screws are in place. Use a Phillips Screwdriver to drive Screw(N) to fasten Safety Strap(O) into the designated hole at the center of the groove/back edge of (5).
- Screw in Cam-blot(A) into the designated(outer) holes.
- Insert Wood Dowels(C) into the Inner holes beside(A).
- Attach Top Panel(5) to assemble In Step 7B by fitting the Cam-bolts and Wood Dowels on (5) to the designated holes on Panel (4L, 2, 3 & 4R) as shown in Drawing 7C, check to ensure Top Back Panel(6) fits into the groove on (5).
- Insert Cam-bolt(B) into the designated holes near the top edge of (4L, 2, 3 & 4R) and turn clockwise to lock on Cam-blot.

STEP 8

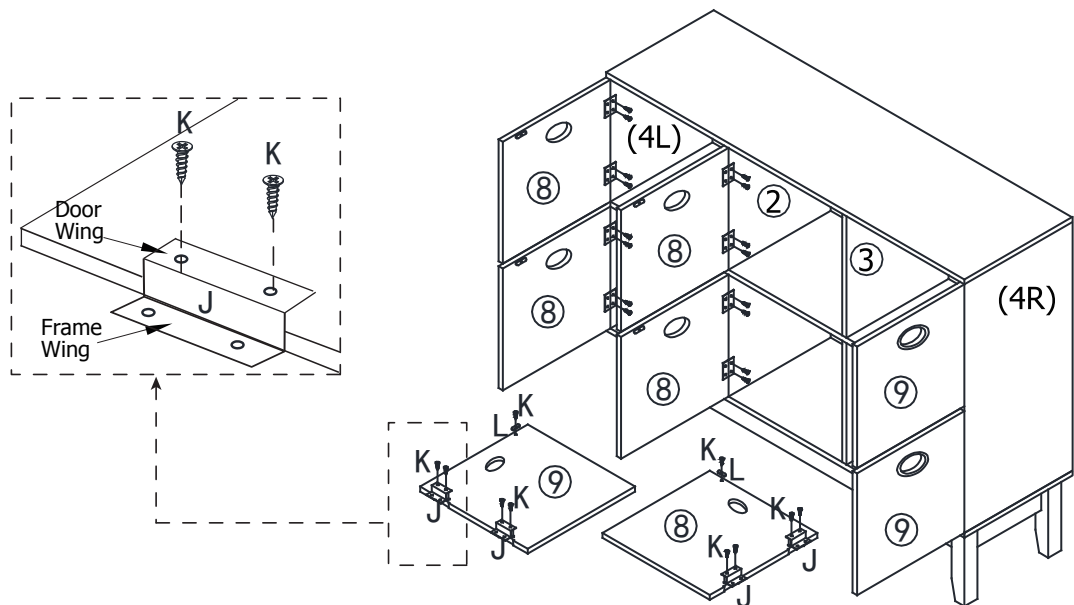

- Lay inside-face of Left & Center Door (8) and Right Door (9) facing up, on a material that does not scratch or damage its exterior surface.
- Place Hinge (J) on Door (8 & 9) as shown - refer to the enlarged drawing for guidance - and align screw holes on Door Wing of Hinge to screw holes on Door.
- Use a Phillips Screwdriver to drive Screw (K) to fasten (J) to Door. Do not tighten completely until both screws are in place on each Door Wing of Hinge.
- Identify pilot hole on the upper corner of each door for Metal Clasp (L). Use Screw (K) to affix (L) to each door.
- Locate pilot holes on Panels (4L, 2 & 4R) to fasten Frame Wing of Hinge. Position each Door (8 or 9) as shown and align screw holes on Frame Wing to pilot holes on the respective Panel. Use a Phillips Screwdriver to drive Screw (K) to fasten Frame Wing to the respective Panel.

ASSEMBLY INSTRUCTIONS

Storage Cabinet

STEP 9

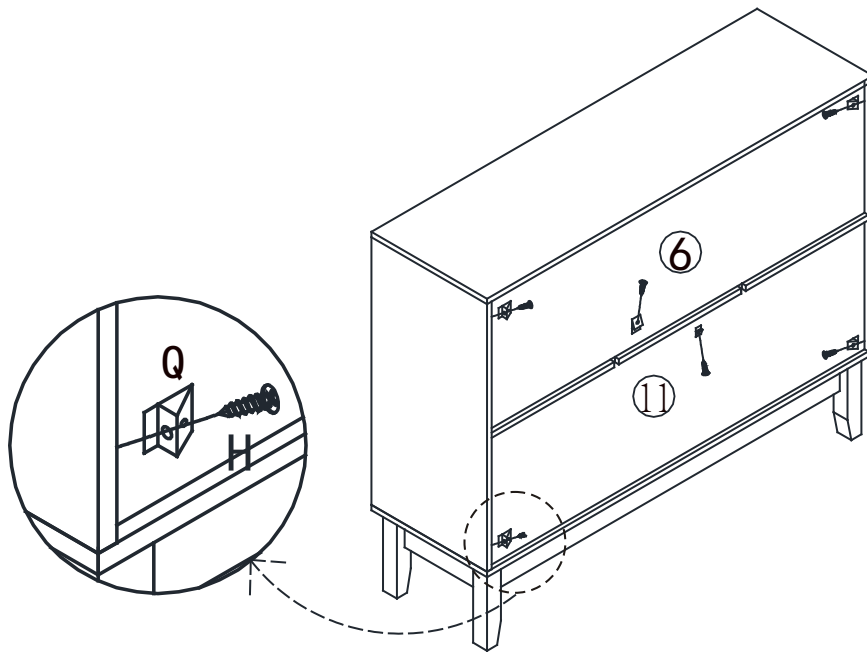

Use a Phillips Screwdriver to drive Top Back Screw (H) to affix Panel Stopper (Q) at the designated location on Top and Bottom Back Panel (6 & 11).

STEP 10

Secure Cabinet to Wall
(Do not skip this Step)

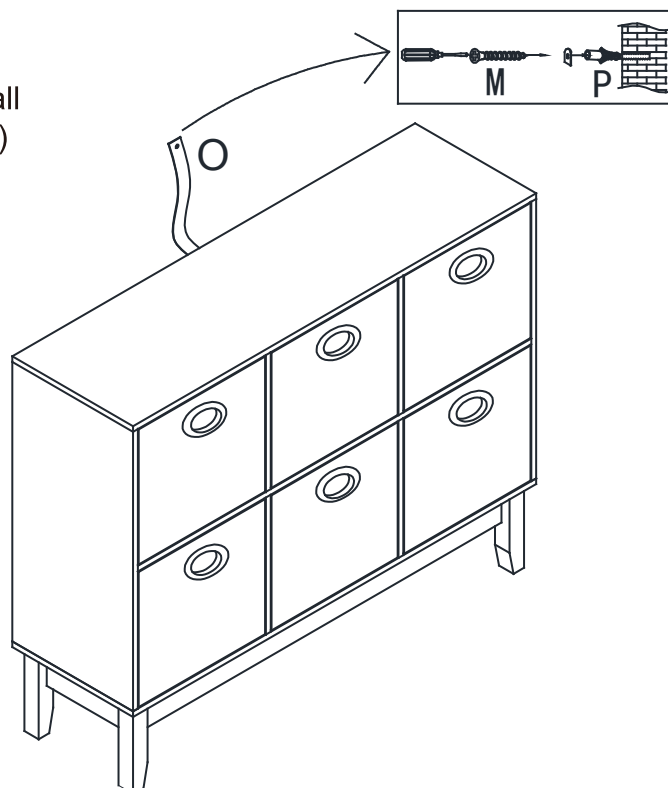

- a) Determine location to mount Wall Anchor. Mark location on the wall where the other end of (O) will be fixed. Drill a hole to fix Wall Anchor (P). Use Screw (M) to secure this end of (O) to (P).

The assembly of the file cabinet is complete.