

PRECAUTIONS

FOR SAFE USAGE PLEASE OBSERVE THE FOLLOWING:

FOR INDOOR STORAGE USE ONLY

- Keep product on a flat, stable surface.
- Do not use on balconies; especially in high-rise buildings.
- Do not use near stove or other sources of fire.
- Please observe weight tolerance and do not overload product.
- Balance hanging objects evenly on product for even weight distribution.
- Please check that screws are properly tightened after installation. Screws may loosen over time; re-tighten as needed.

When moving products:

- Remove all items and lift evenly from both sides.
- Hold lower pipes when moving up and down steps.

For safety:

- Do not allow children to play with product.
- Do not hang on product or apply unnecessary weight.
- Pipe edges may be sharp: be careful not to cut hands

To avoid damage to product:

- Keep away from direct sunlight or high humidity.
- Wipe away any water, oil, or soap immediately.
- Do not place hot or wet items on the product.
- Do not place stickers or tape on product.
- Wipe off any excess grease from pipes

CLEANING METHOD

TO MAINTAIN HIGH PERFORMANCE OF THE PRODUCT, PLEASE MAKE SURE TO OBSERVE THE FOLLOWING:

- For hard to remove stains, wipe with diluted dish soap on damp cloth and dry thoroughly
- Do not use cleaning products such as alcohol, gasoline, bleach or detergent powder.

GARMENT RACK

SINGLE SHELF

GENERAL INSTRUCTIONS

Thank you for purchasing this product.  
Please read these instructions carefully before use.  
Keep these instructions for future reference.

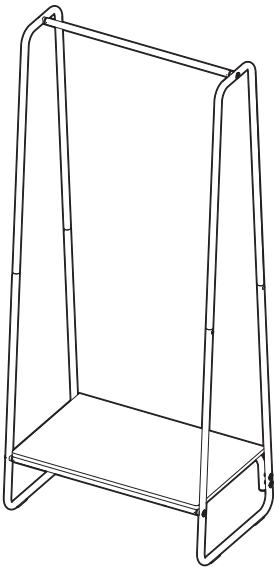

MADE IN CHINA

- REQUIRED TOOL: NO. 2 PHILLIPS HEAD SCREWDRIVER

● Assembly by 2 people is recommended

WARNING

In order to avoid damage,  
do not use an impact driver.

PRODUCT SIZE (cm/in)	64cm W x 40cm D x 150cm H	25.5" W x 15.75" D x 59" H
MATERIALS	Epoxy coated steel and finished particleboard	
WEIGHT CAPACITY (kg/lbs)	Hanger Rod: 10kg/22lbs    Shelf Board: 10kg/22lbs	

\* WEIGHT CAPACITY IS MEASURED VALUE, NOT GUARANTEED VALUE.  
\* PRODUCT SPECIFICATIONS ARE SUBJECT TO CHANGE WITHOUT NOTICE.

PARTS

- PLEASE CONFIRM THE FOLLOWING PARTS ARE INCLUDED BEFORE ASSEMBLING.
- PACKAGING MATERIAL IS NOT MARKED. EXTRA HARDWARE INCLUDED FOR CONVENIENCE.

The side with the hole is the underside

underside

front

Shelf Board (1)

The side with the rounded corners is the front

Upper Pipes (2)

Lower Pipes (2)

Hanger Rod (1)

Rack Pipe (1)

2 holes

U-Shaped Pipe (1)

Felt Stickers (5)

This part is already installed in to the hanger rack pipes.

Long Bolts (4)

Short Bolts (5)

Screws (5)

Spacers (5)

# ASSEMBLY METHOD

- RECOMMENDED TO ASSEMBLE WITH 2 PEOPLE
- IF ASSEMBLING INDOORS, BE WARY OF UNEVEN SURFACES SCRATCHING THE FLOORING.

- GLOVES SUGGESTED TO AVOID INJURY DURING ASSEMBLY.
- ASSEMBLE NEAR LOCATION OF INTENDED USE.

1

Insert the Upper Pipes and adhere Felt Stickers to bottom of Lower Pipes.  
Use the diagram below as reference and be mindful of the direction the pipes are facing, with indented holes facing out of Upper Pipes and 2 holes in back of Lower Pipes.

## CAUTION

Be mindful of your fingers when inserting pipes.

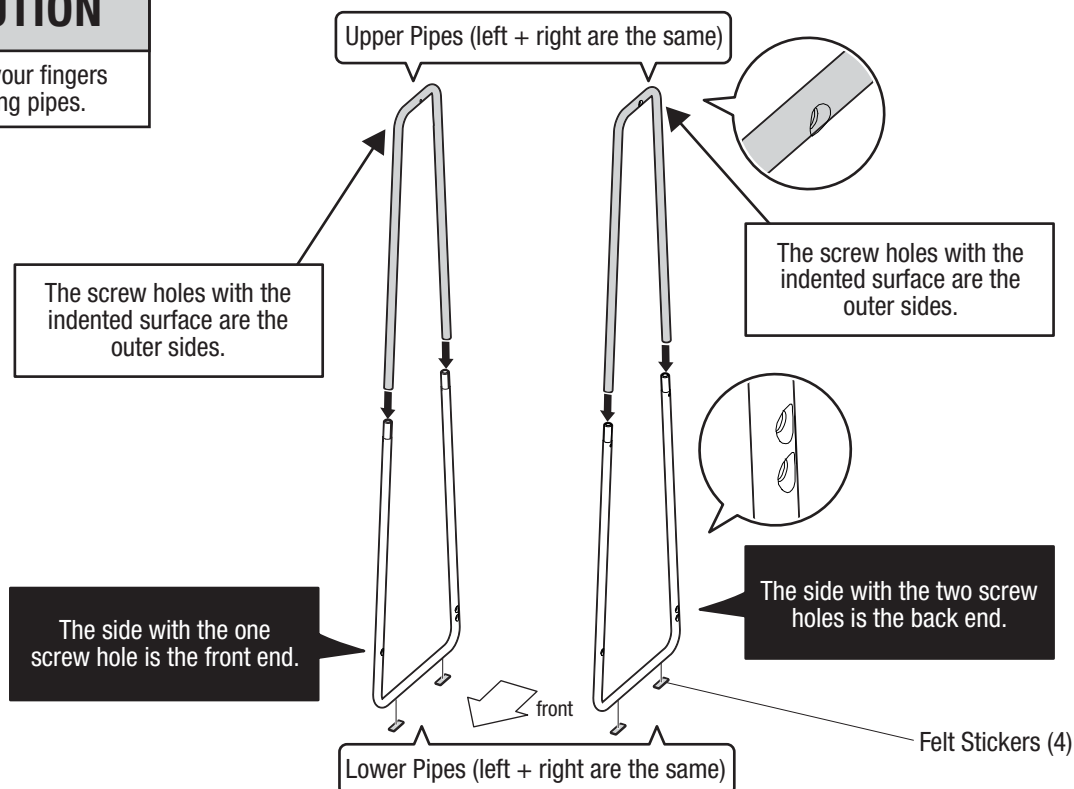

2

Install the U-Shape Pipe and Hanger on ①

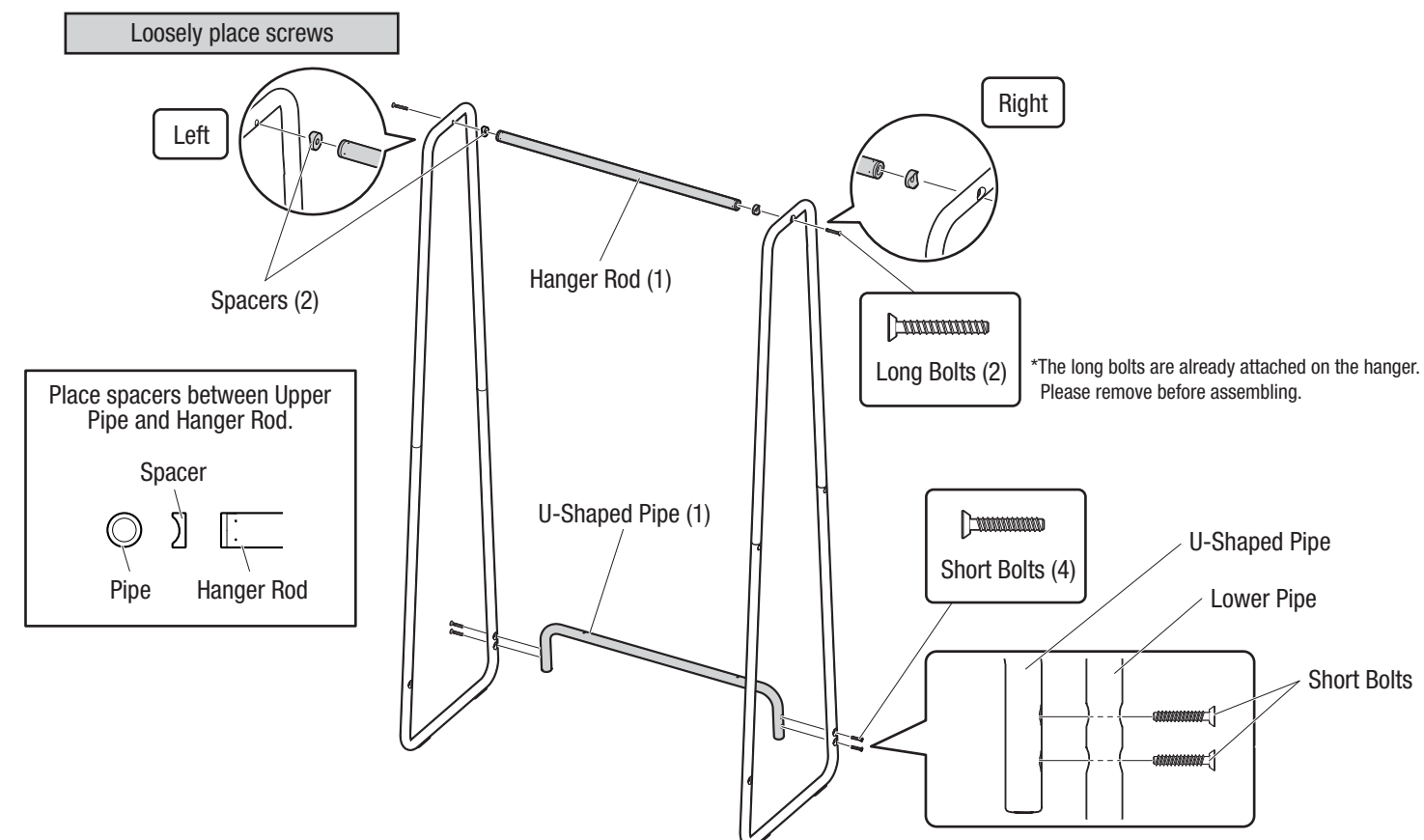

3

Attach the Rack Pipe on to the Board.  
Fasten screws from below.

Secure the screws tightly.

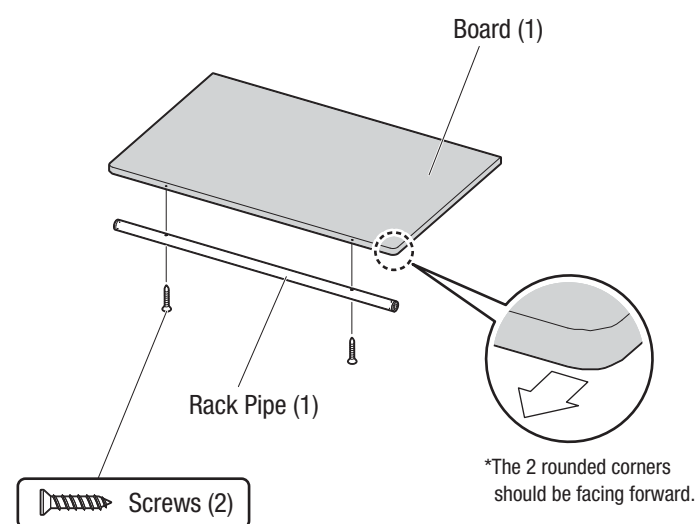

4

Attach section ③ to section ② with bolts and screws.

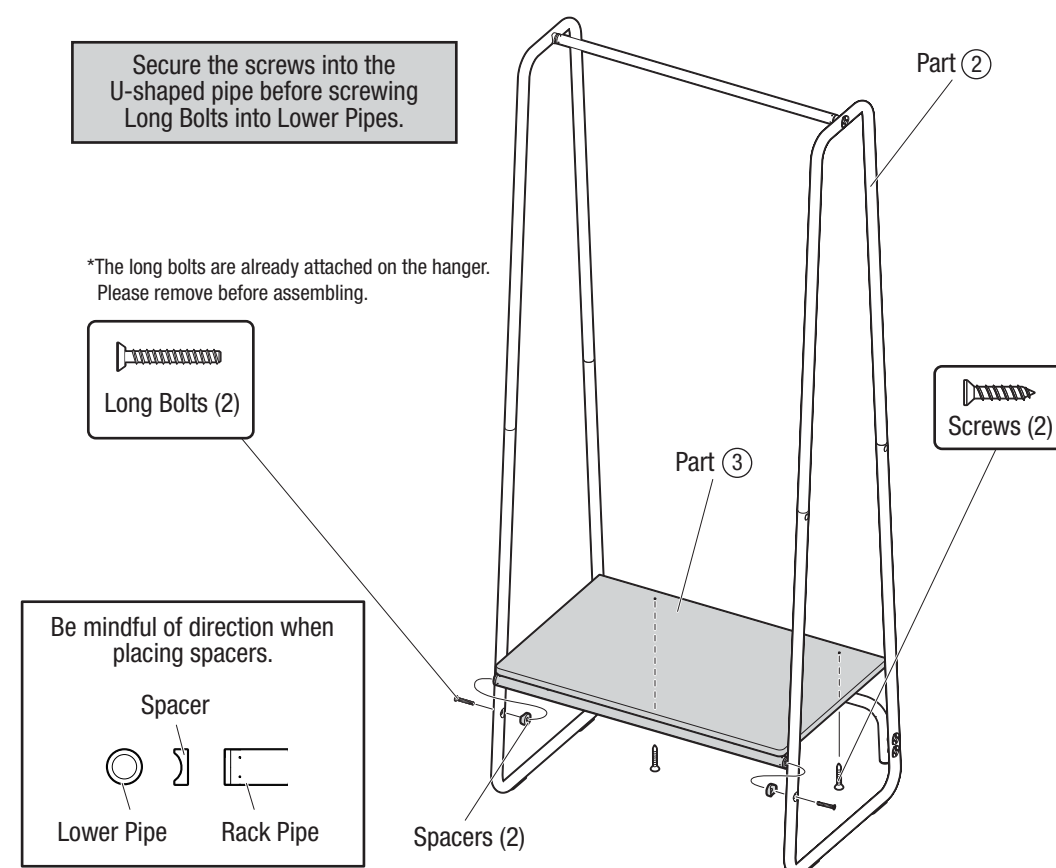

5

Make sure all screws are tightly secure.

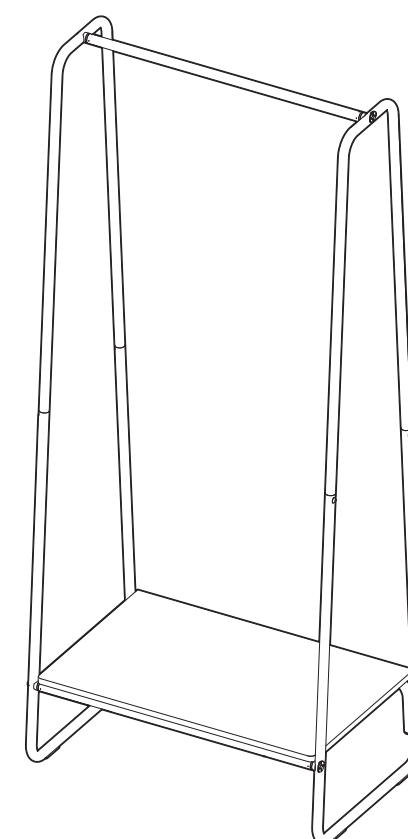

## WARNING

- Tighten and secure screws properly
- Make sure product is straight and sturdy
- All feet are equally on the ground