

INSTRUCTION MANUAL

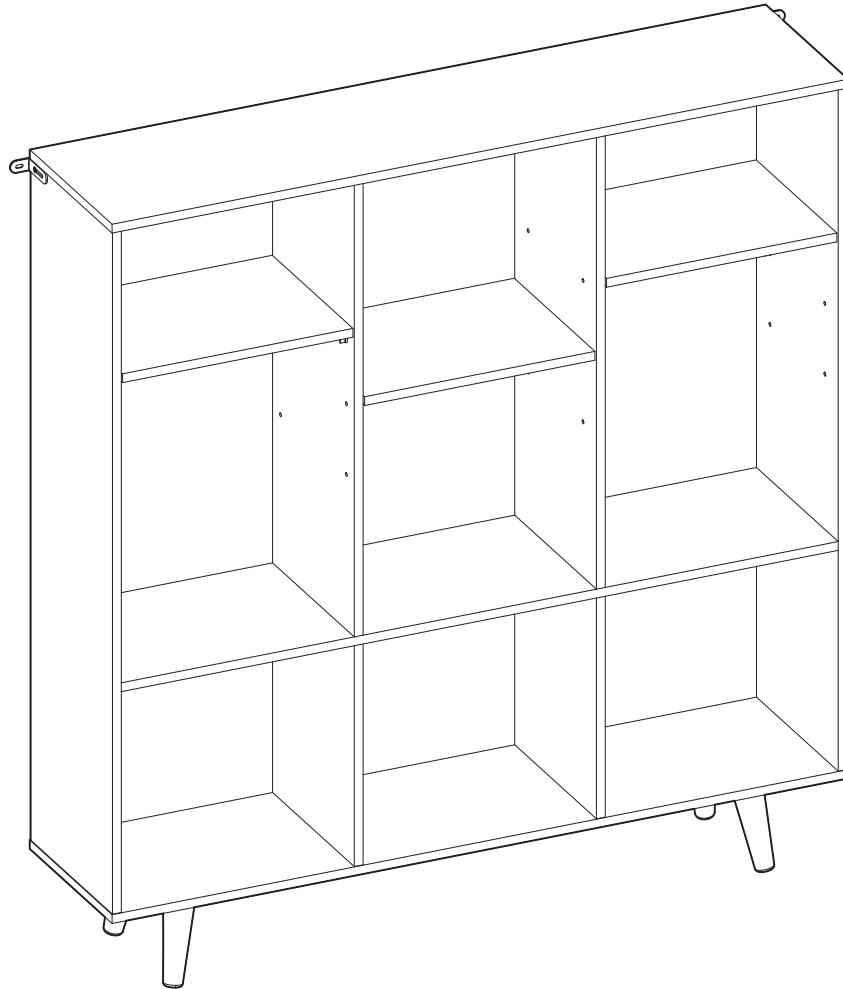

Bookcase

Important Safety Information

- Please carefully read all instructions before attempting installation. If you have any questions or concerns, please call technical support or email customer service.
- **CAUTION:** Avoid potential injuries and property damage!
- DO NOT use this product for any purpose that is NOT explicitly specified in this manual. We are NOT liable for damage or injury caused by improper mounting, incorrect assembly or inappropriate use.
- **WARNING:** This product contains small parts that may pose a choking hazard.
- Before starting assembly, verify all parts are included and undamaged. DO NOT use damaged or defective parts. If you require replacement parts, please call technical support or email customer service.
- **NOTE:** NOT all hardware included in this package will be used.
- To prevent the bookcase from tipping over, this product must be used with the wall attachment device provided.

Weight Restriction

Verify that the items you intend to store. Do not exceed the listed weight capacity.

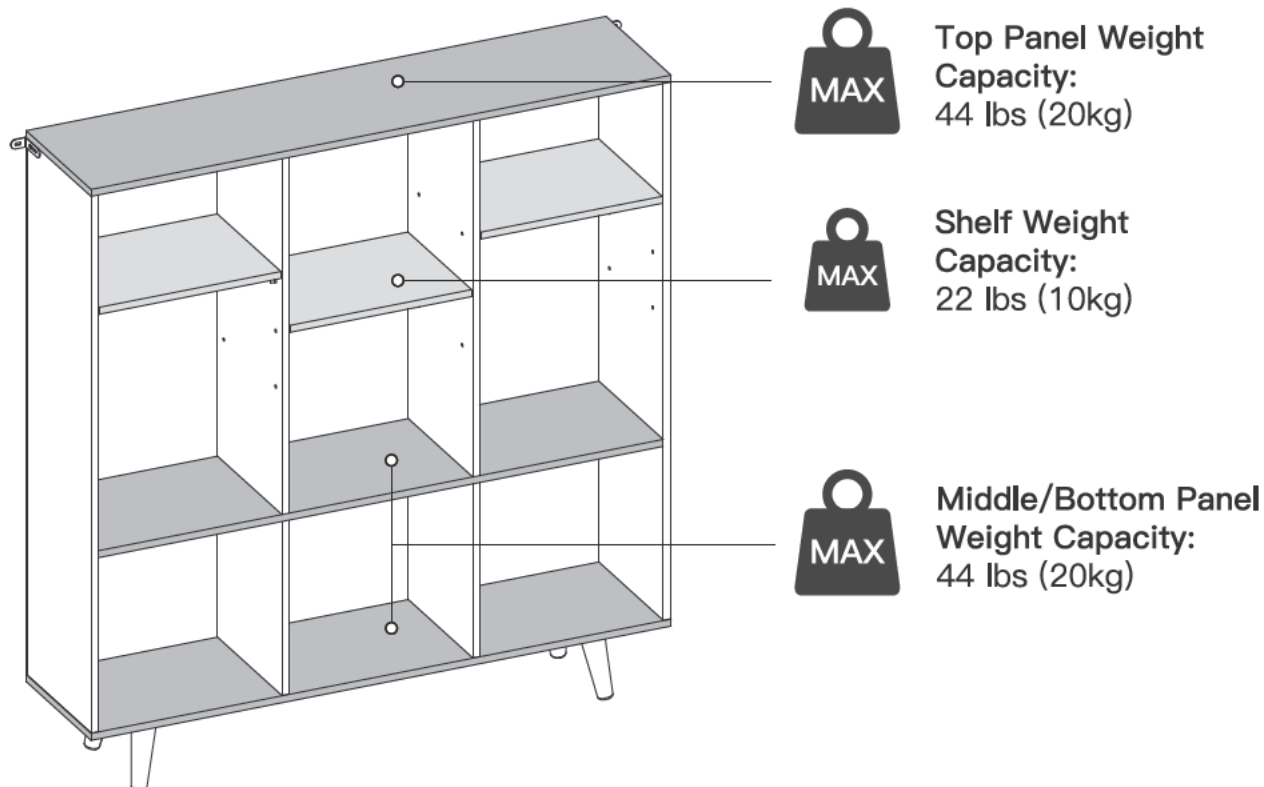

Tools Needed (NOT Included)

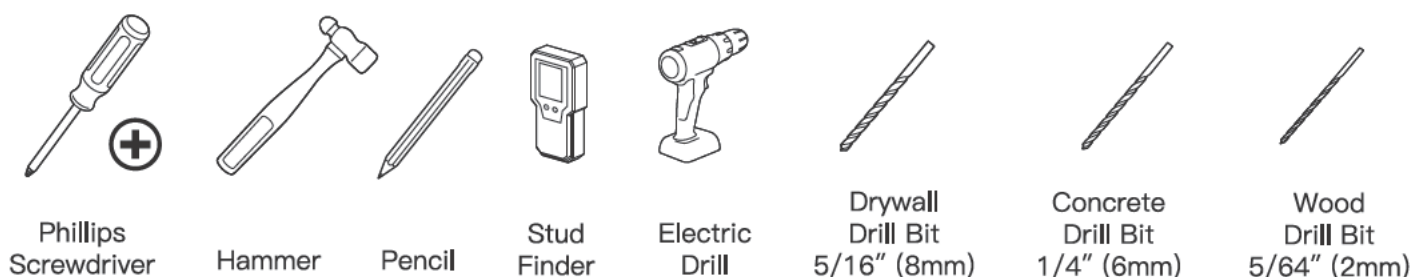

Supplied Parts and Hardware

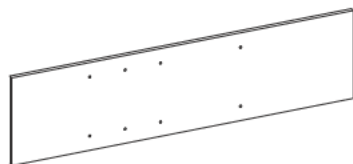
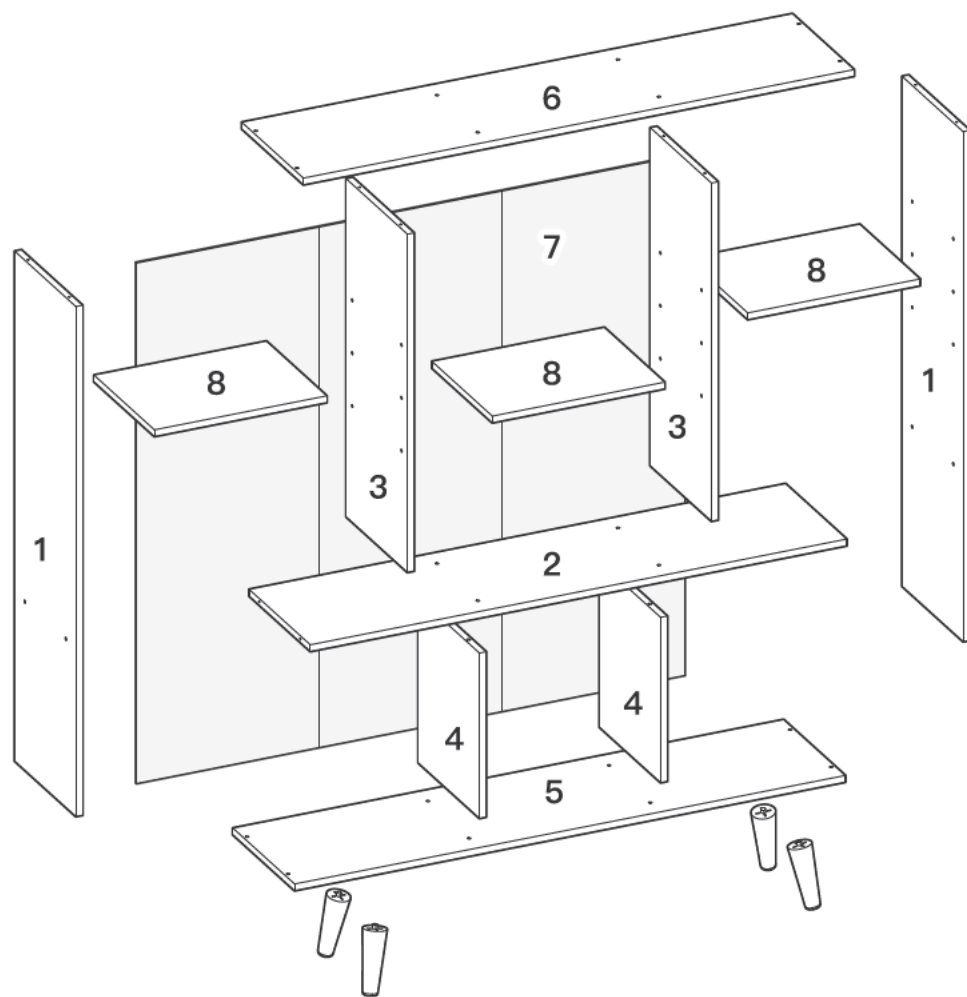

Side Panel
[1] x 2

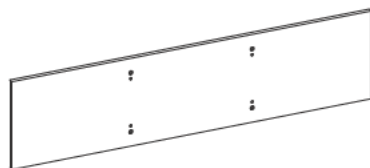

Middle Panel
[2] x 1

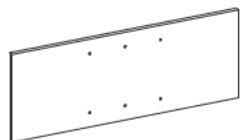

Upper Vertical Panel
[3] x 2

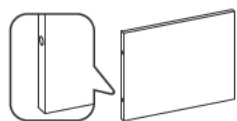

Lower Vertical Panel
[4] x 2

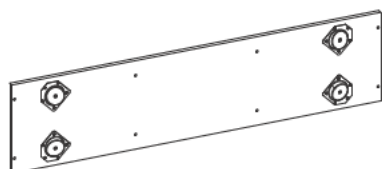

Bottom Panel
[5] x 1

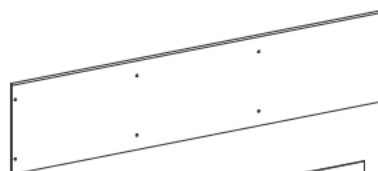

Top Panel
[6] x 1

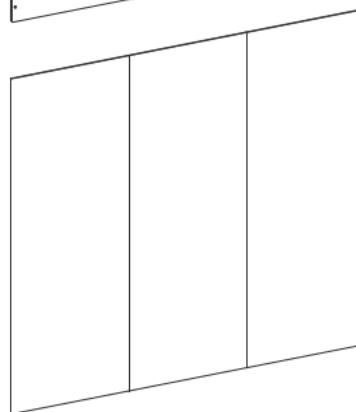

Back Panel
[7] x 1



Shelf
[8] x 3



M5 x 40mm
Bolt
[A] x 24



Wood Dowel
[B] x 4



Leg
[C] x 4



Φ1.2 x 20mm
Nail
[D] x 48



Shelf Support
[E] x 12

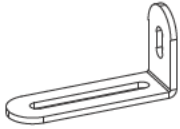

Bracket
[F] x 2



M3.5 x 14mm
Screw
[G] x 2

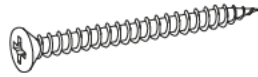

M4 x 50mm
Screw
[H] x 2

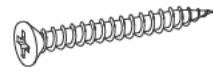

M4 x 40mm
Screw
[I] x 2

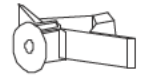

Drywall Anchor
[J] x 2



Anchor
[K] x 2



1/8" (3mm)
Allen Key
[L] x 1



Sticker
[M] x 12



IMPORTANT INSTALLATION TIP:
Align and loosely thread all bolts into the corresponding holes before fully tightening each bolt one by one.

Loosely
Thread

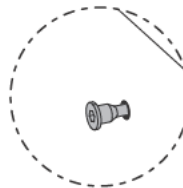

Fully
Tighten

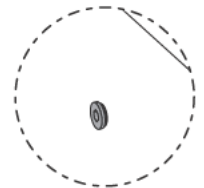

Step 1

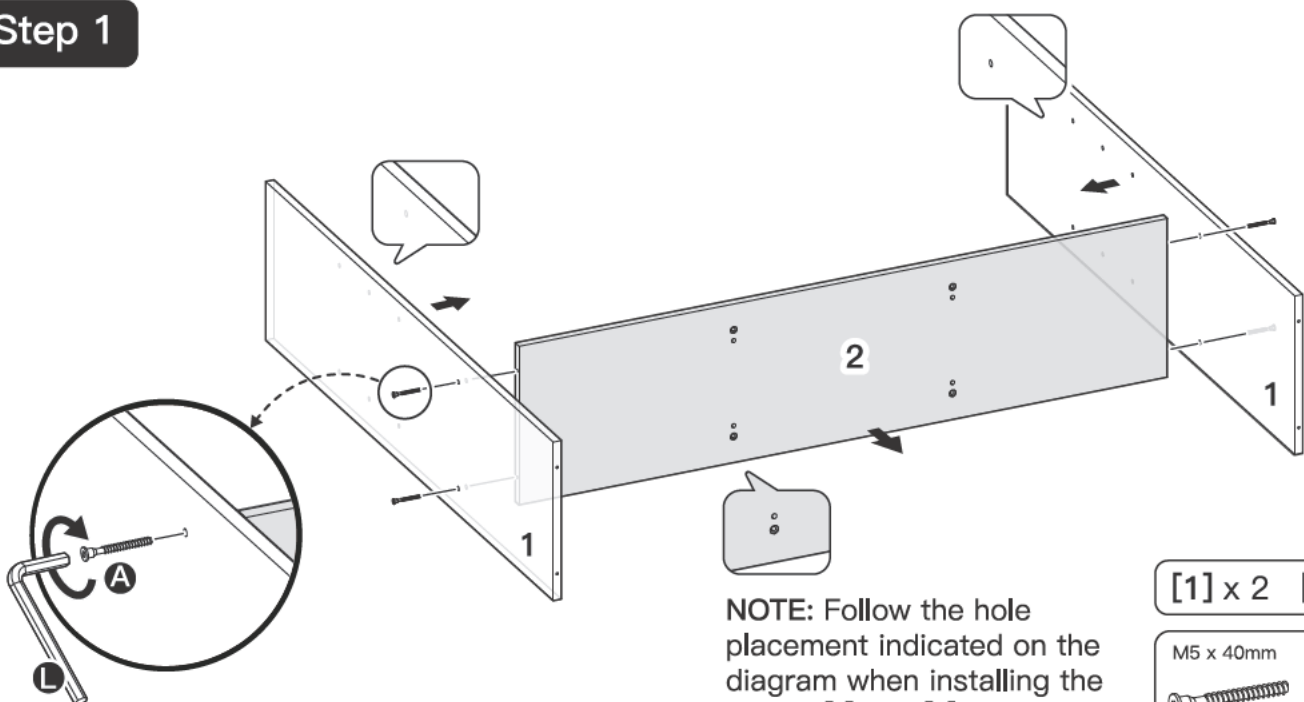

NOTE: Follow the hole placement indicated on the diagram when installing the panels [1] and [2].

[1] x 2 [2] x 1

M5 x 40mm

[A] x 4 [L] x 1

Step 2

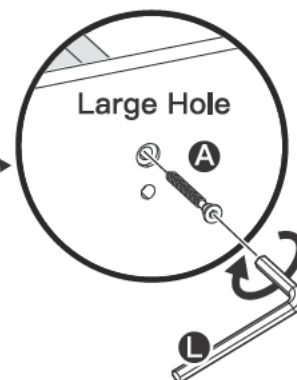
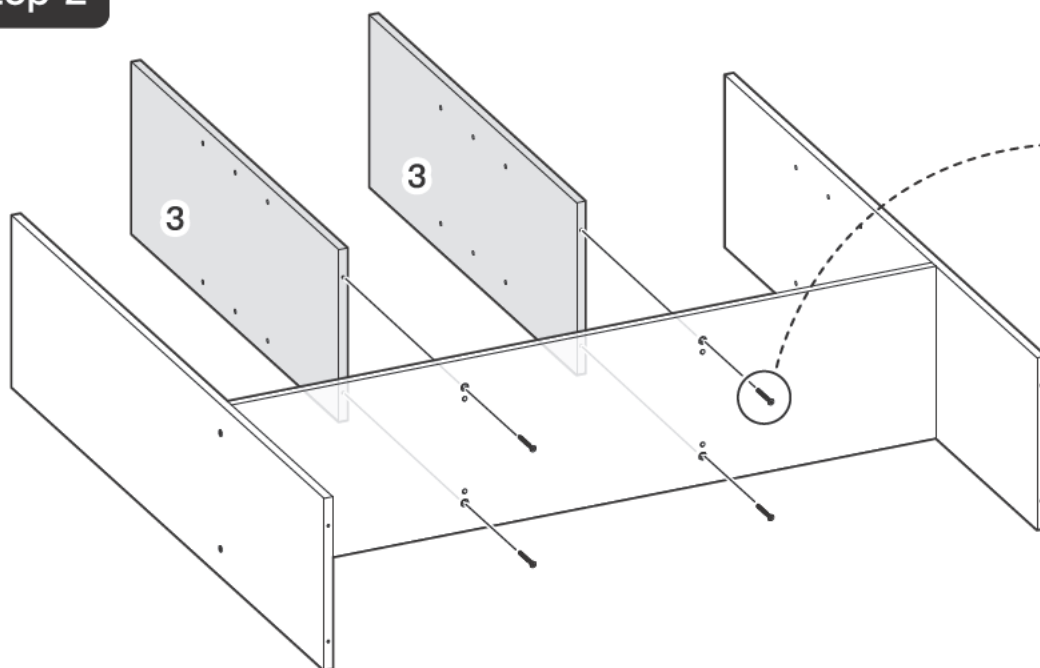

[3] x 2

M5 x 40mm



[A] x 4 [L] x 1

Step 3

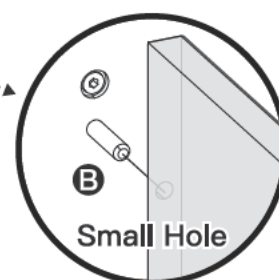
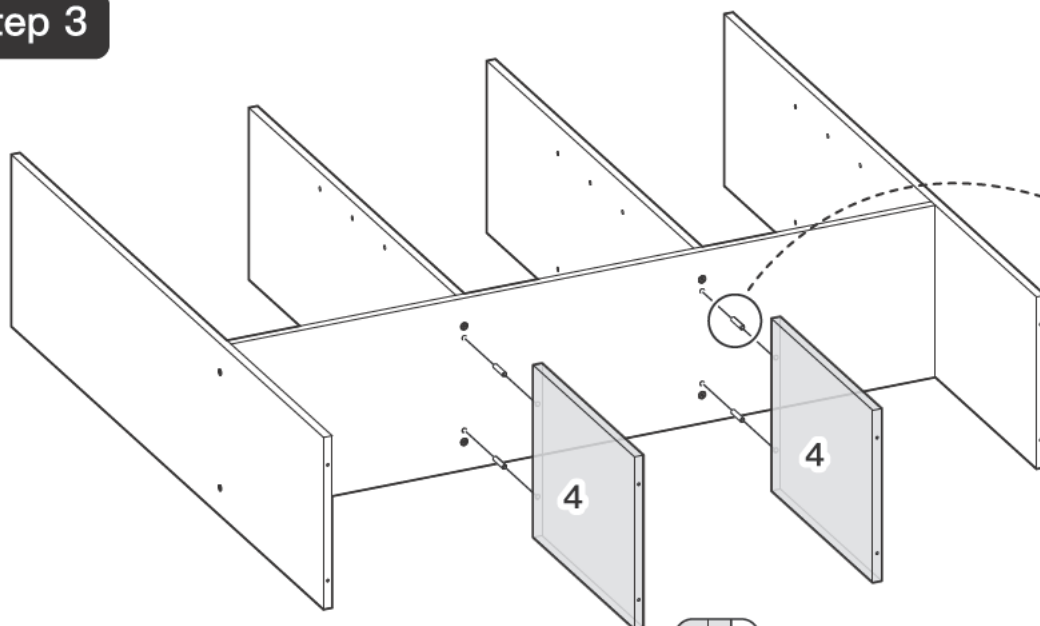

[4] x 2



NOTE: The smaller holes on the panels [4] should face out in this step.



[B] x 4

Step 4

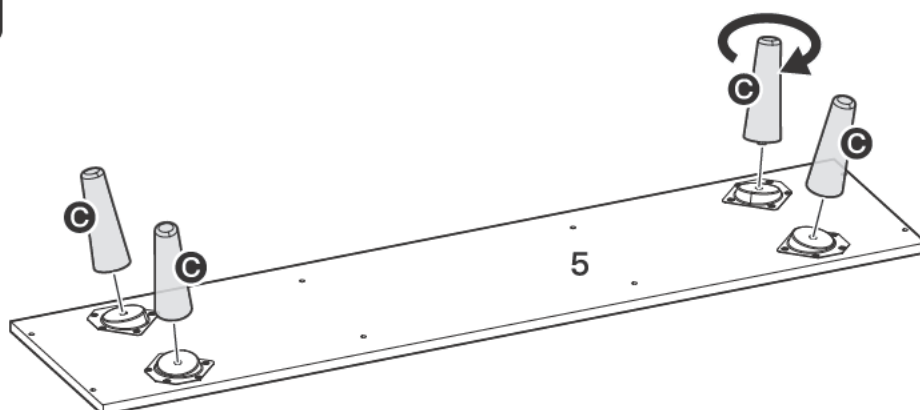

[5] x 1



[C] x 4

Step 5

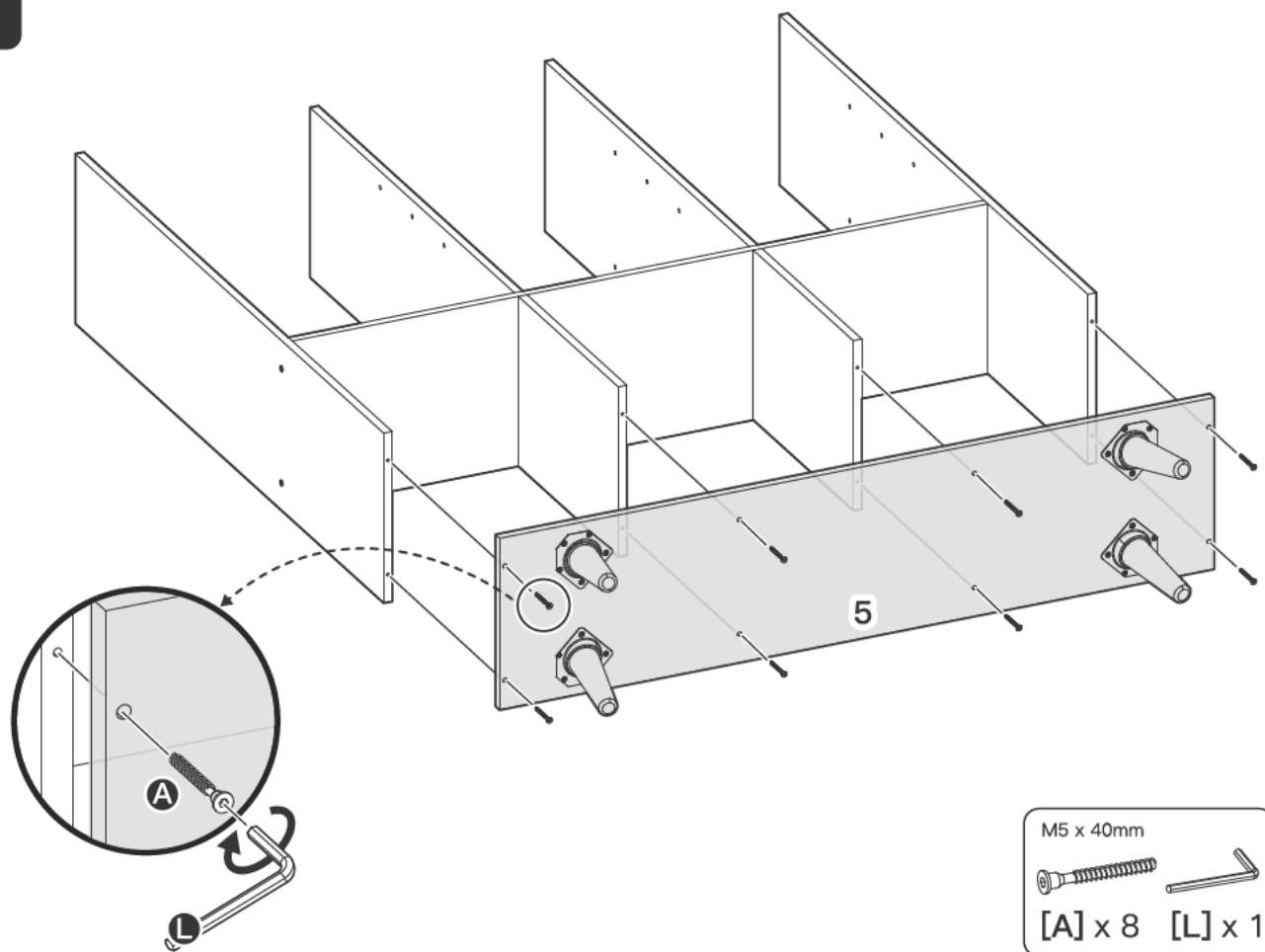

Step 6

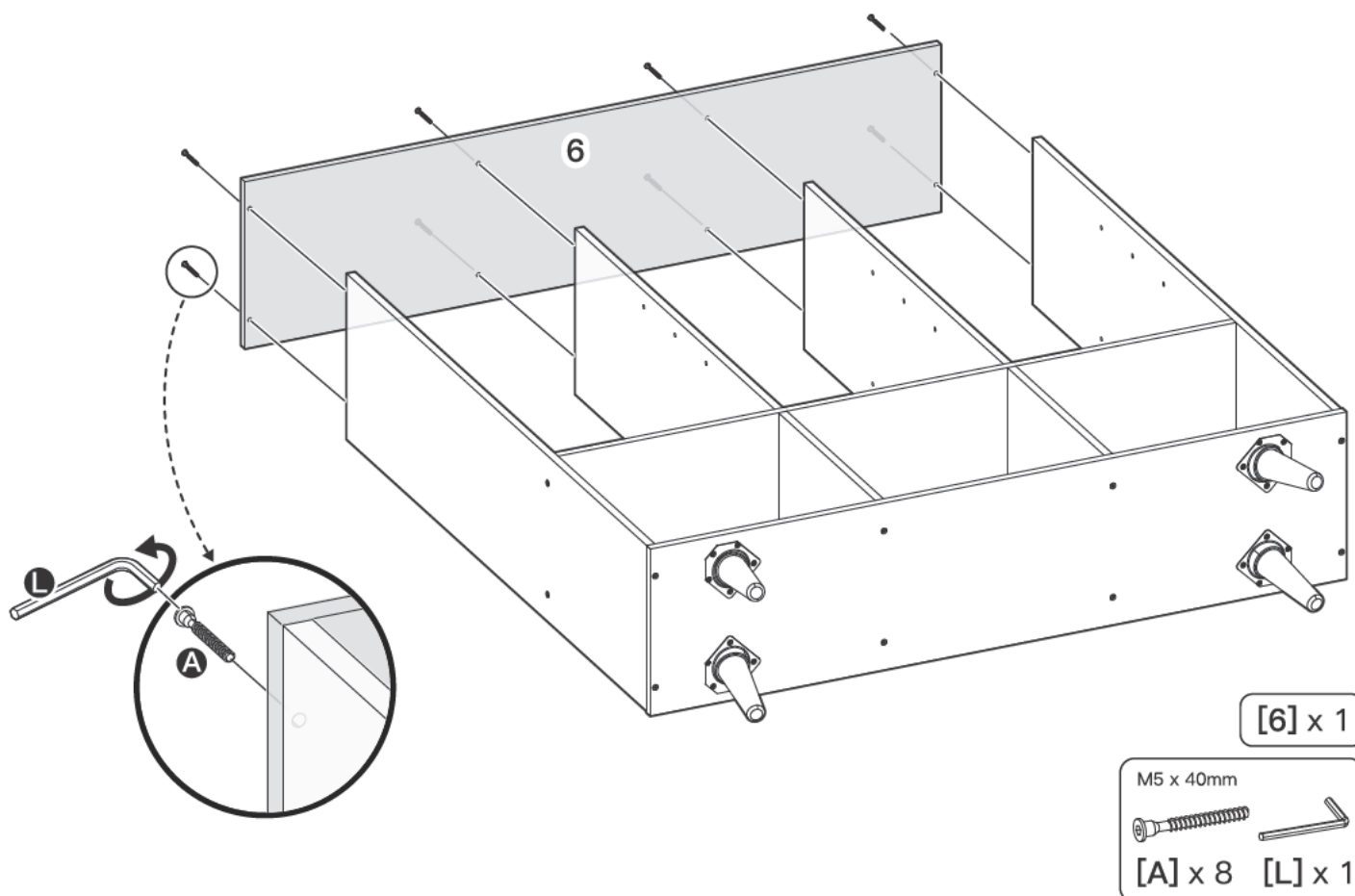

Step 7



NOTE: The side with adhesive tape should face out.

[7] x 1

Φ1.2 x 20mm



[D] x 48



Hammer
(NOT Included)

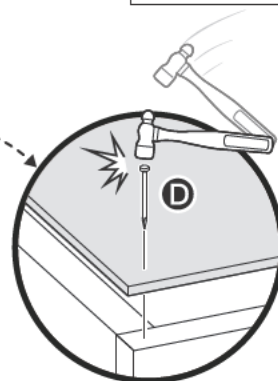
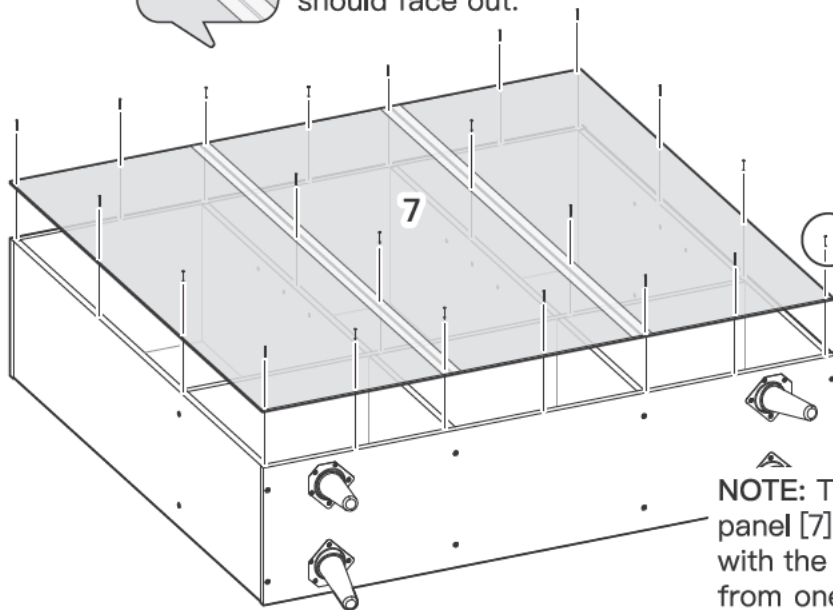

NOTE: There are no pre-drilled holes for back panel [7] on the bookcase. Align the panel edge with the bookcase frame, then tap the nails [D] from one panel to the other. Choose a proper amount of nails. NOT all nails will be required.

Remember to fully tighten all bolts and screws after Step 7 is finished.

Step 8



You may need assistance with this step.

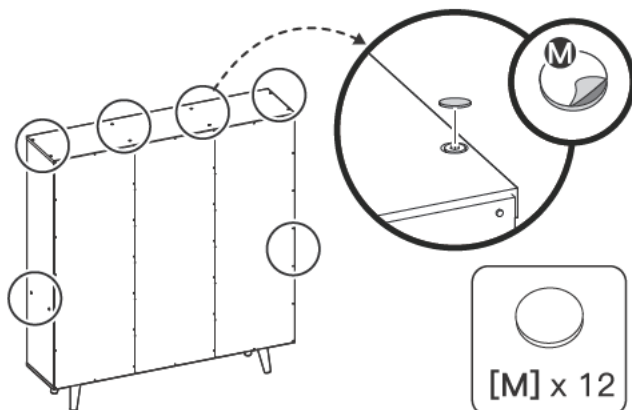
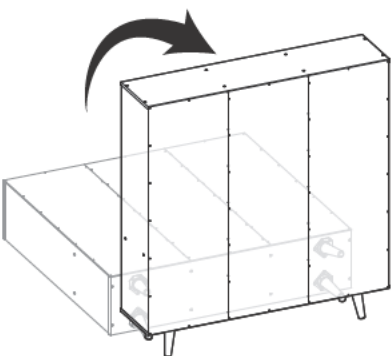

[M] x 12

Step 9

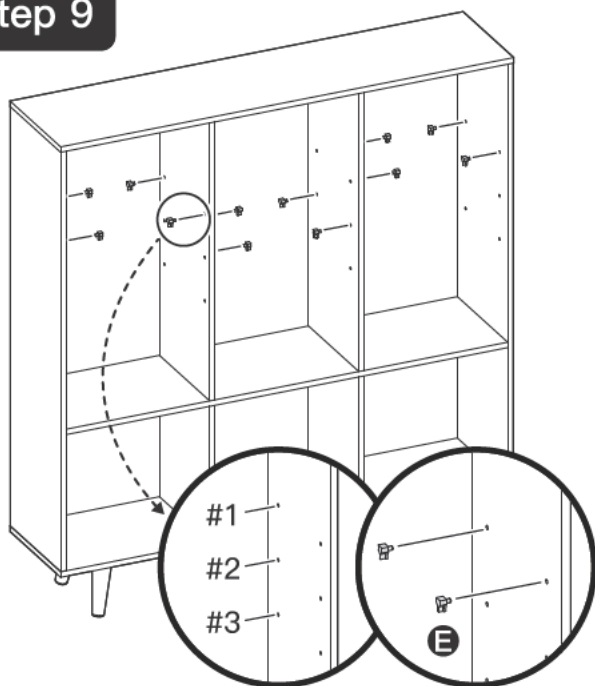

3 Height Options

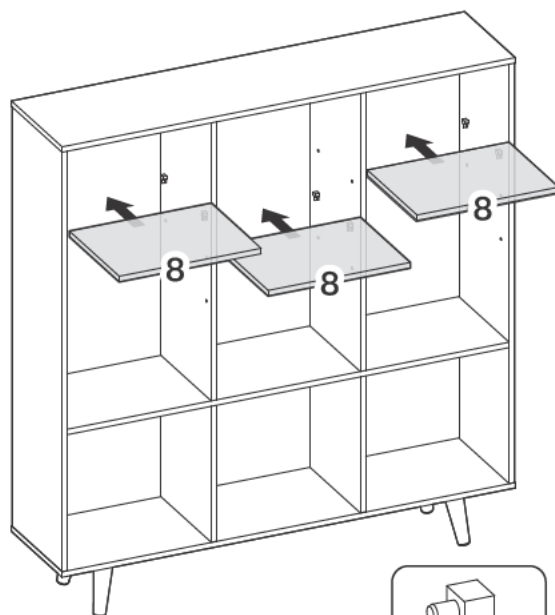

[8] x 3



[E] x 12

Step 10

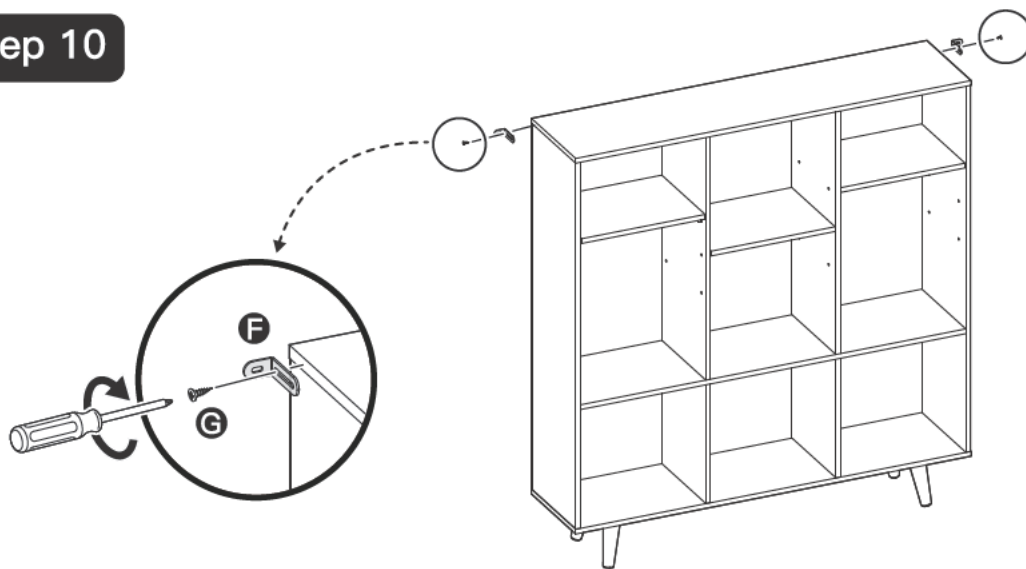

Phillips Screwdriver
(NOT Included)



M3.5 x 14mm

[F] x 2 [G] x 2

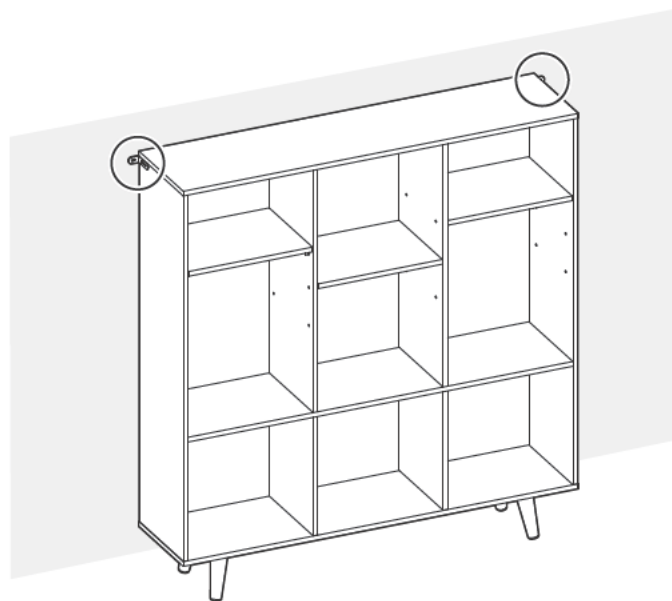

Wood Studs



2" (50mm)
ø5/64" (2mm)

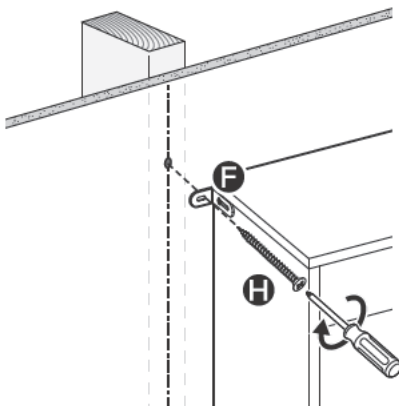

[H] x 2



Drywall

1 3/16" (30mm)
ø5/16" (8mm)

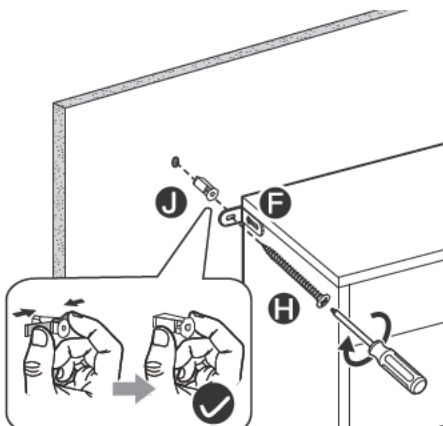

[H] x 2 [J] x 2



Solid Concrete



1 3/4" (45mm)
ø1/4" (6mm)

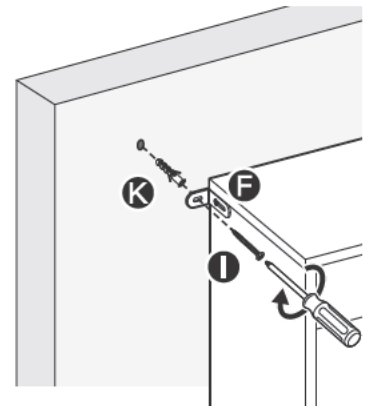

[I] x 2 [K] x 2

