

Assembly Instruction

COFFEE TABLE

0.5 hr

APPROXIMATE ASSEMBLY TIME

2 PERSON ASSEMBLY

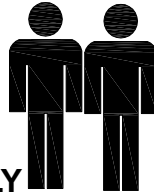

FLOOR AREA
1.5MX1.5M

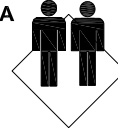

REQUIRED ASSEMBLY SPACE

REQUIRED ASSEMBLY TOOLS

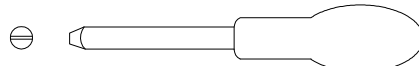

SLOTTED SCREWDRIVER (Not Provided)

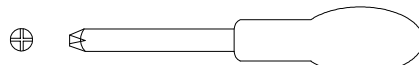

POZI SCREWDRIVER (Not Provided)

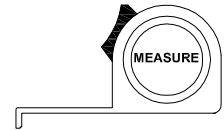

MEASURING TAPE (Not Provided)

ASSEMBLED DIMENSIONS

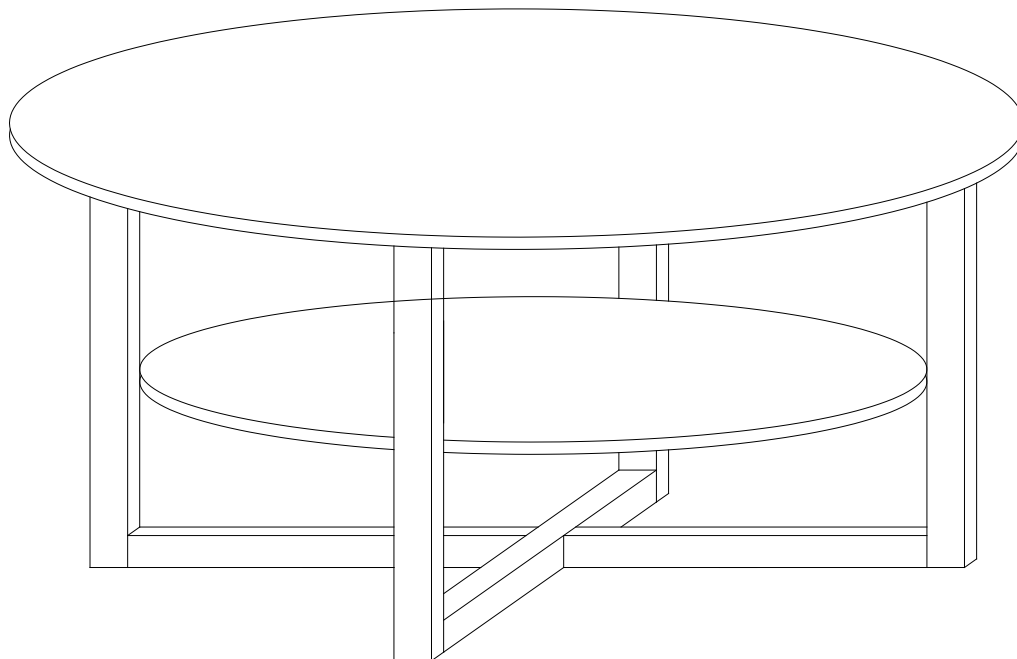

Remark: Table top max load 20kgs
Under shelf max load 15kgs

MODEL NAME:

COFFEE TABLE

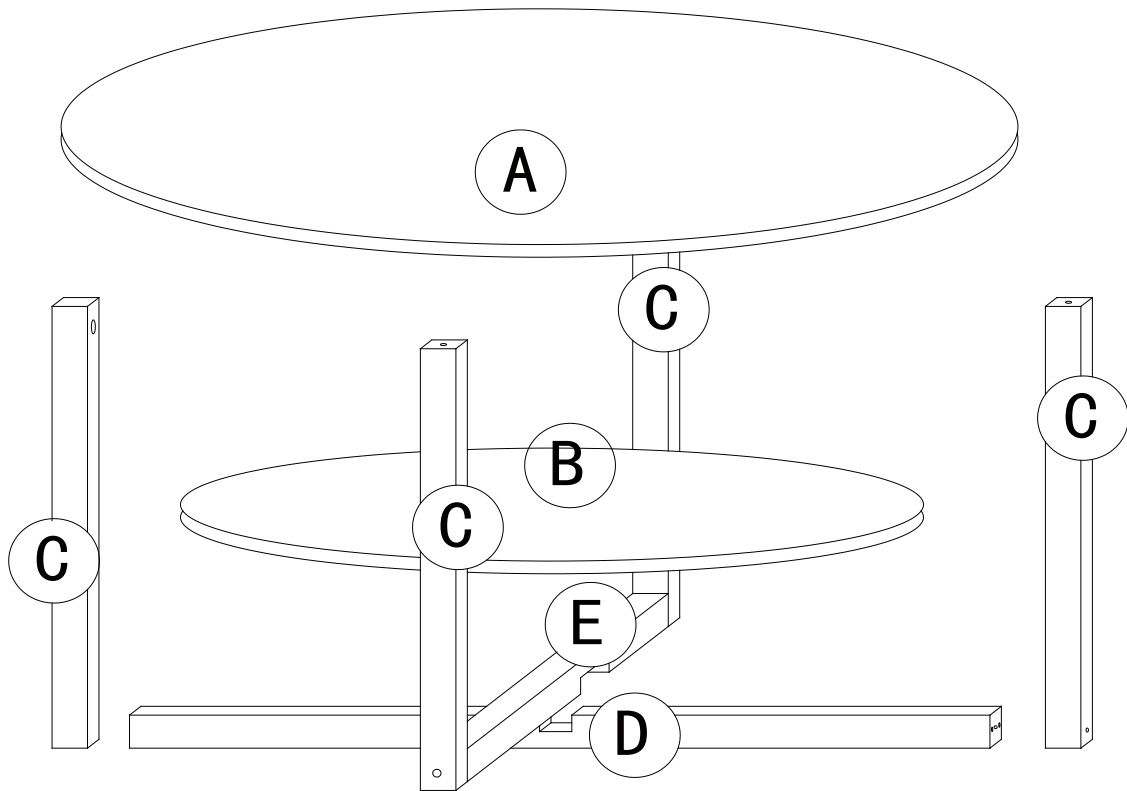

PARTS LIST

NO	PART	QTY
A	TOP PANEL	1
B	MIDDLE SHELF	1
C	LEG	4
D	BOTTOM LONG SLAT	1
E	BOTTOM SHORT SLAT	1

MODEL NAME:

COFFEE TABLE

HARDWARE LIST

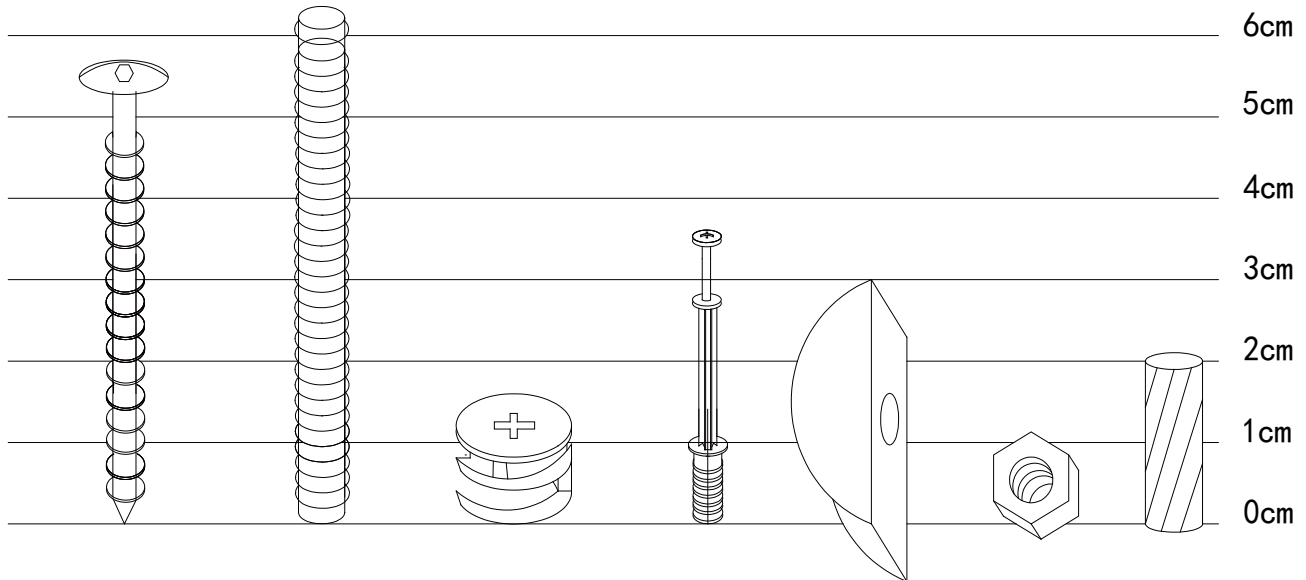

4x

4x

4x

4x

4x

4x

16x

M3. 5*55MM

Dia6*60MM

Dia. 15MM

M6MM

M30MM

Dia10MM

Dia6MM*20

Screw Bolt

Long Bolt

Camlock

Camlock
bolt

Half-round
Nut

Hexagon
Nut

Wooden
Dowel

1

2

3

4

5

6

7

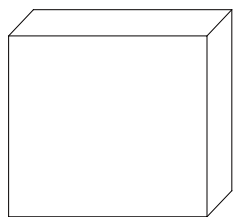

4x

Dia30MM

EVA Mat

8

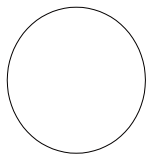

4x

Dia15MM

PVC sticker

9

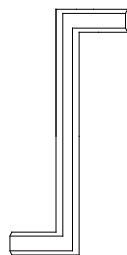

1x

Allen Key

10

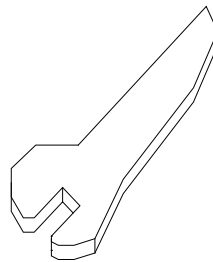

1x

Spanner

11

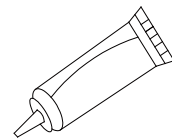

1x

Glue

12

MODEL NAME:

COFFEE TABLE

SPECIAL TIPS FOR FITTING CAM-LOCKS AND QUICKFIT

CAM-LOCK

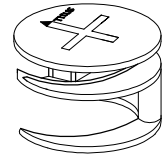

WHEN FITTING CAMLOCK
ENSURE STARTING POSITION IS CORRECT
BEFORE YOU INSERT CONNECTING QUICKFIT
TURN CLOCKWISE UNTIL SECURE

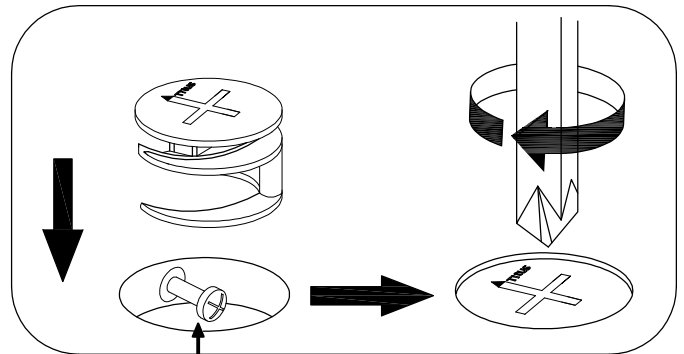
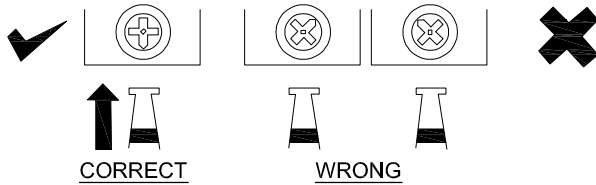

Quickfit head needs to be in centre

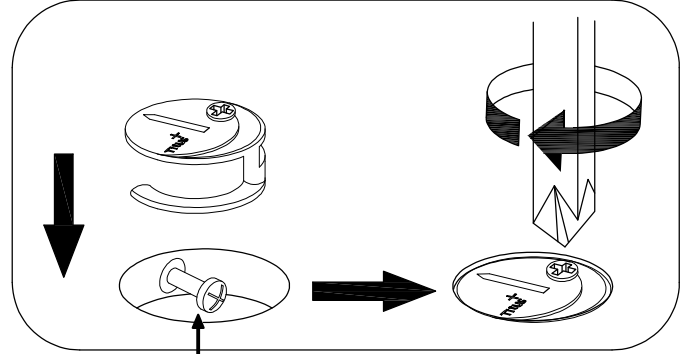

Quickfit head needs to be in centre

**DRAWER
CAM-LOCK**

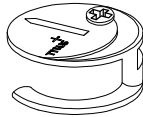

QUICKFIT

Tighten until shoulder is flush with panel. Do not overtighten or undertighten (see example below)

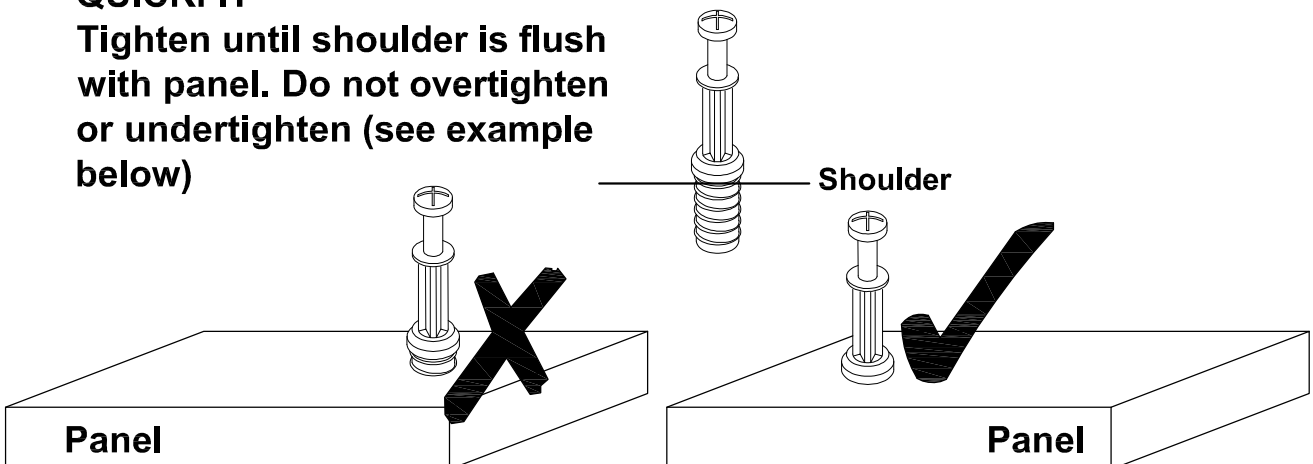

MODEL NAME:
COFFEE TABLE

STEP 1

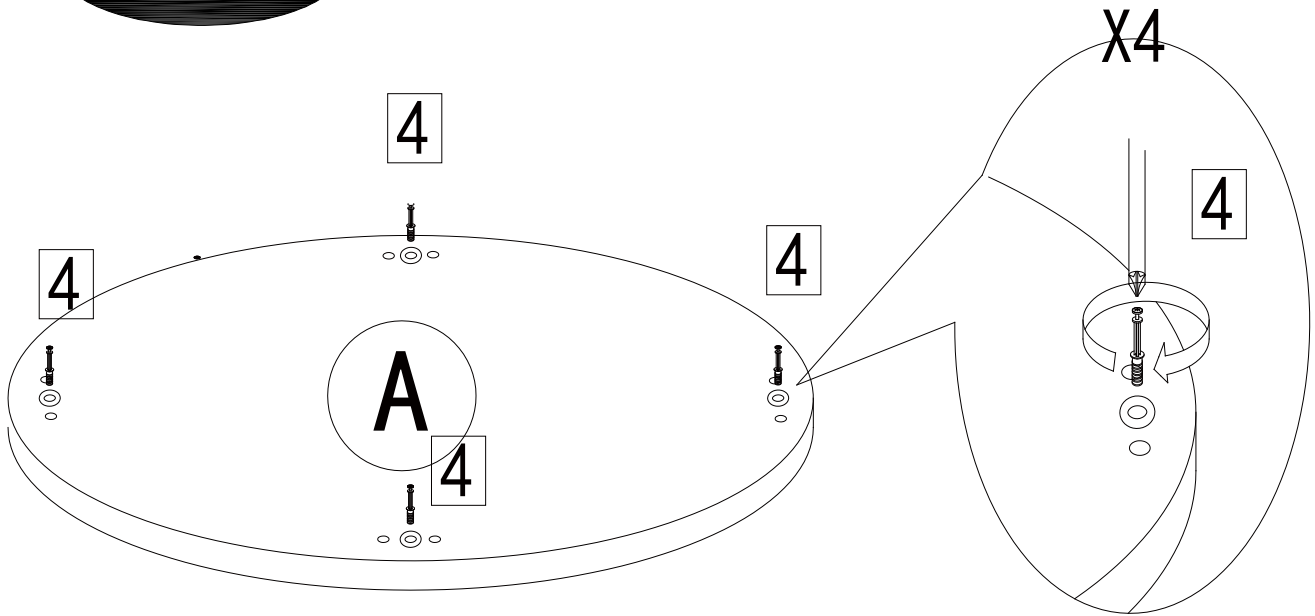

STEP 2

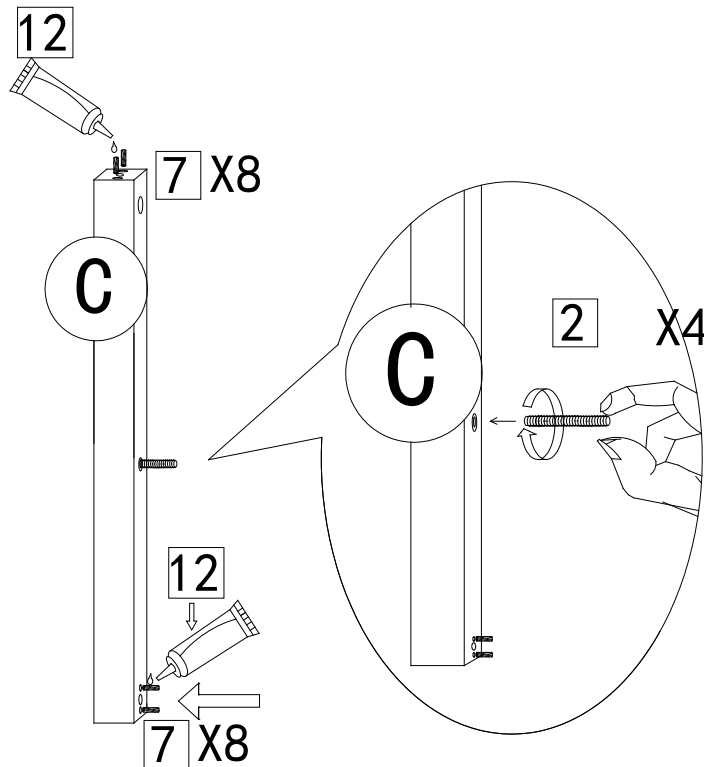

Remark: Fill the wooden dowel holes with the Glue

MODEL NAME:

COFFEE TABLE

STEP 3

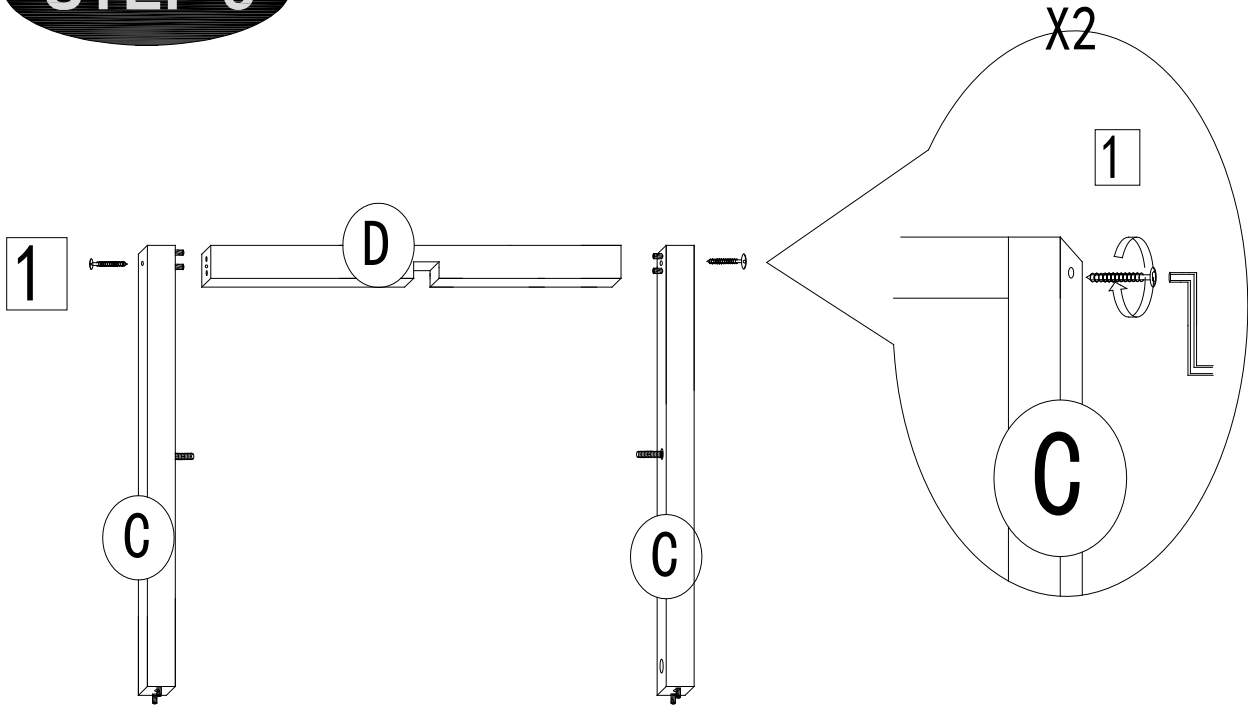

STEP 4

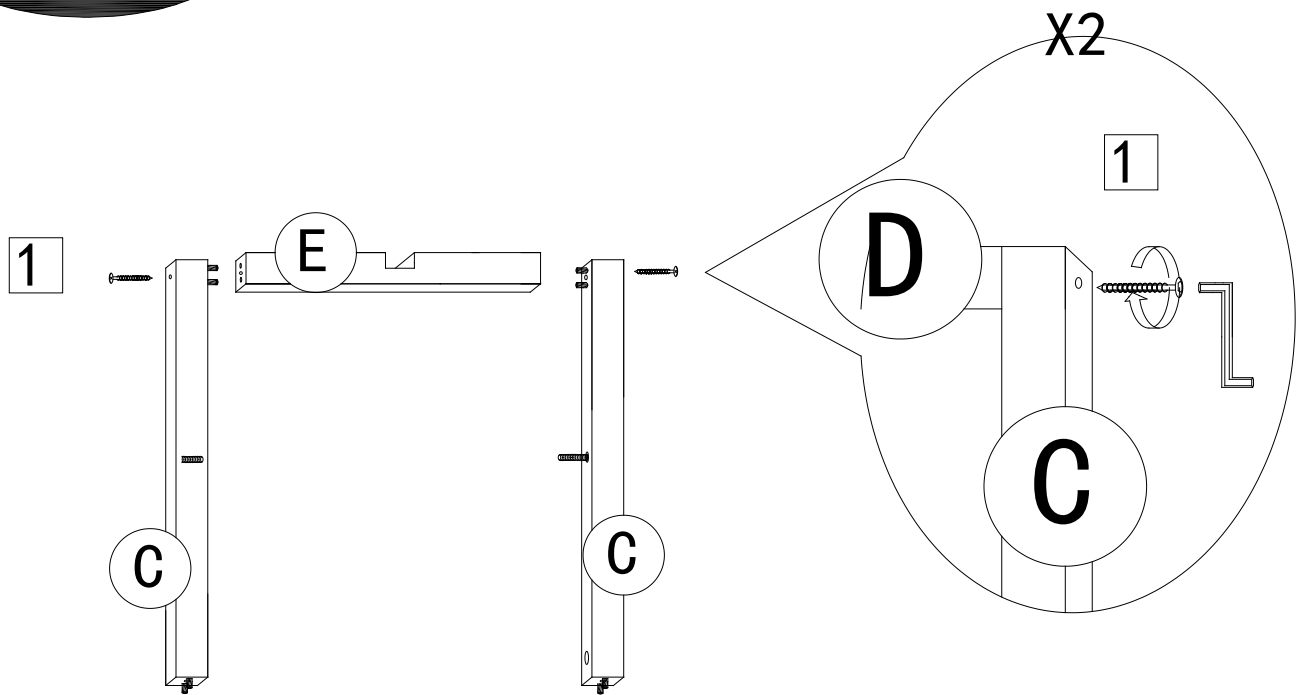

MODEL NAME:

COFFEE TABLE

STEP 5

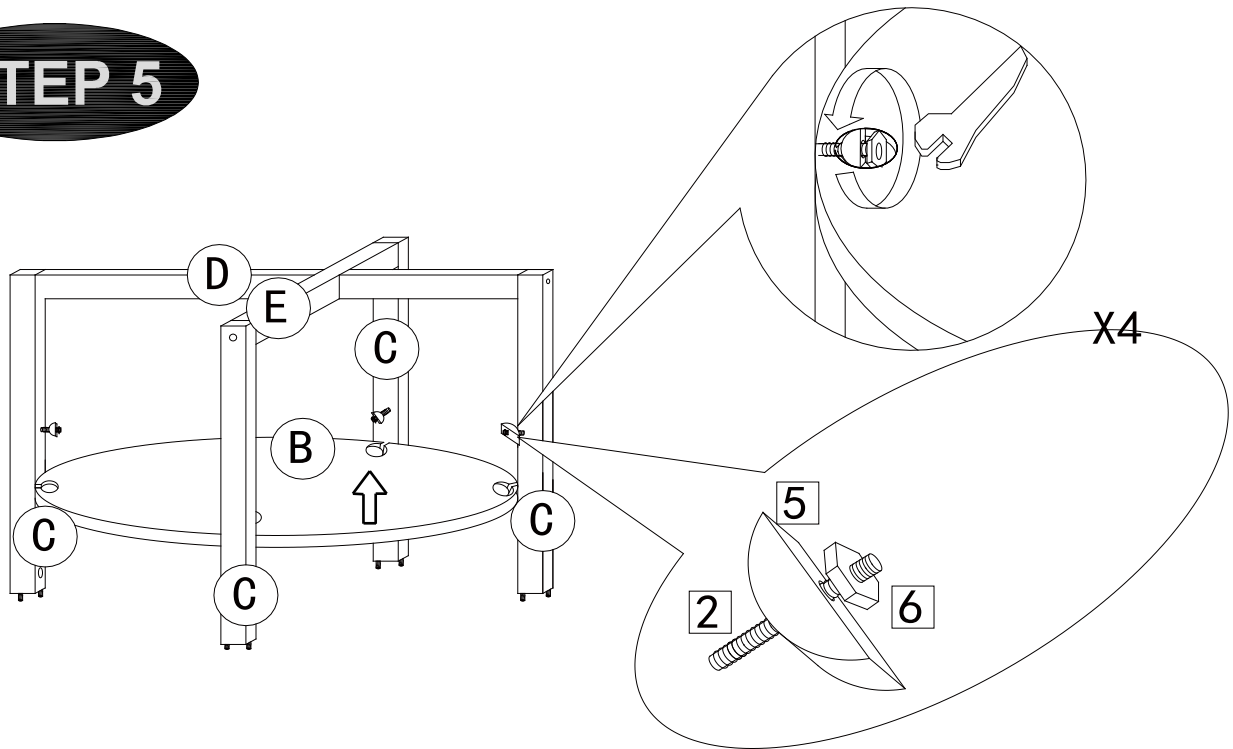

STEP 6

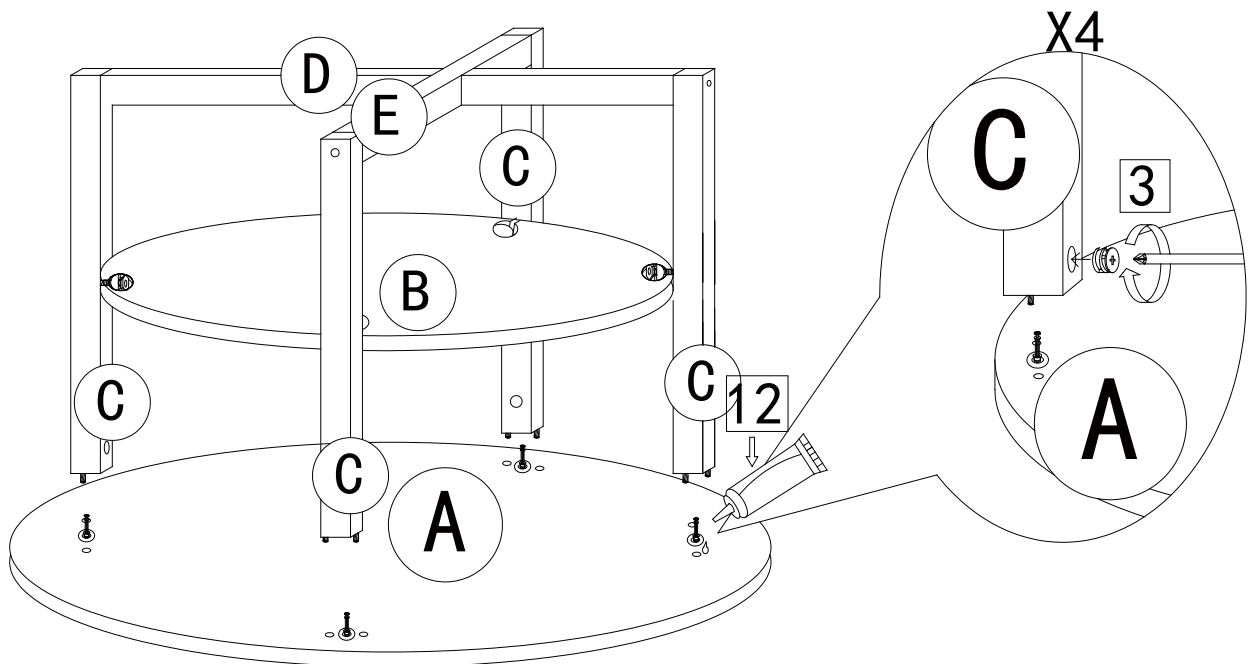

Remark: Fill the wooden dowel holes with the Glue

MODEL NAME:

COFFEE TABLE

STEP 7

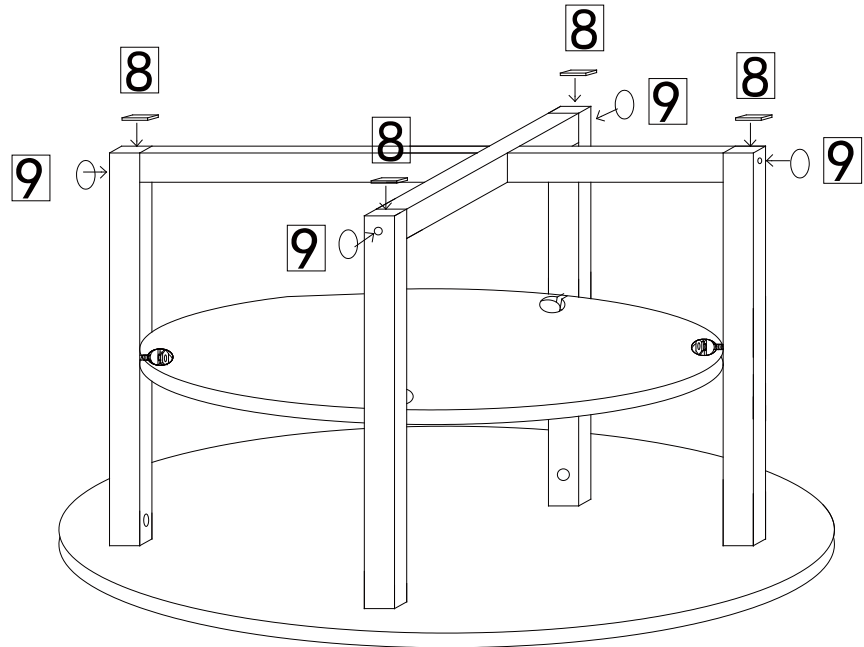

STEP 8

