

## How to Install

1. Cut off the power.
2. Drill a small hole in the wall.
3. Fix the hanging bracket with the included self-tapping screws.
4. Connect live, neutral, and ground to main power.
5. Fasten the wall lamp to the bracket on the wall with black screws.
6. Turn on the power and turn on the lights.

## Specifications

Color: Black, White

Material: Iron, Acrylic

Process: High-temperature Painting

Shape: Rectangle

Feature: **Waterproof**

Mounting Type: Wall-mounted

Installation: Hard-wired

Room Type: Entryway, Garage, Porch

Usage: Indoor&Outdoor Use

Power Source: AC, Corded-electric

Light Fixture Form: Wall Sconce

Lighting Method: Downlight

Light Source: 18W LED Chip

Efficiency: E

Lifespan: 50,000H

Voltage: 90-260V

Lumen: 3250Lumen

Color Temperature: 3000K Warm Light

Illumination Area: 15-20m<sup>2</sup>/161.4-215.3ft<sup>2</sup>

Base Size (L\*W): 4.6\*3cm/1.81\*1.18inch

Product Size (L\*W): 80\*8cm/31.5\*3.15inch

## Package Included

1\* Wall Lamp

Other Accessories for Assembly

## Application

It is suitable for aisles, garages, porches, patios, front doors, hallways, doorways, verandas, courtyards, entryways, corridors, backyards, sunrooms, bathrooms, sheds, and any other indoor/outdoor places. And its illumination area is about 161.4-215.3ft<sup>2</sup>.

## Notes

1. Please check the size of the lamp before purchasing, and compare the specific conditions of the installation location to see if it is appropriate.

2. It's best to space them 6 to 8 feet apart and not near other light sources (such as streetlights) to ensure a good lighting effect.
3. Please cut off the power before installation. It is recommended to be installed by a professional electrician.
4. It is **waterproof**, but it cannot be soaked in water.
5. The wall lamp is not dimmable. It is directly wired for use.
6. Please allow the slight color difference caused by the shooting light and 1-3cm error due to manual measurement, and make sure you do not mind before you order.

#### Installation Procedures:

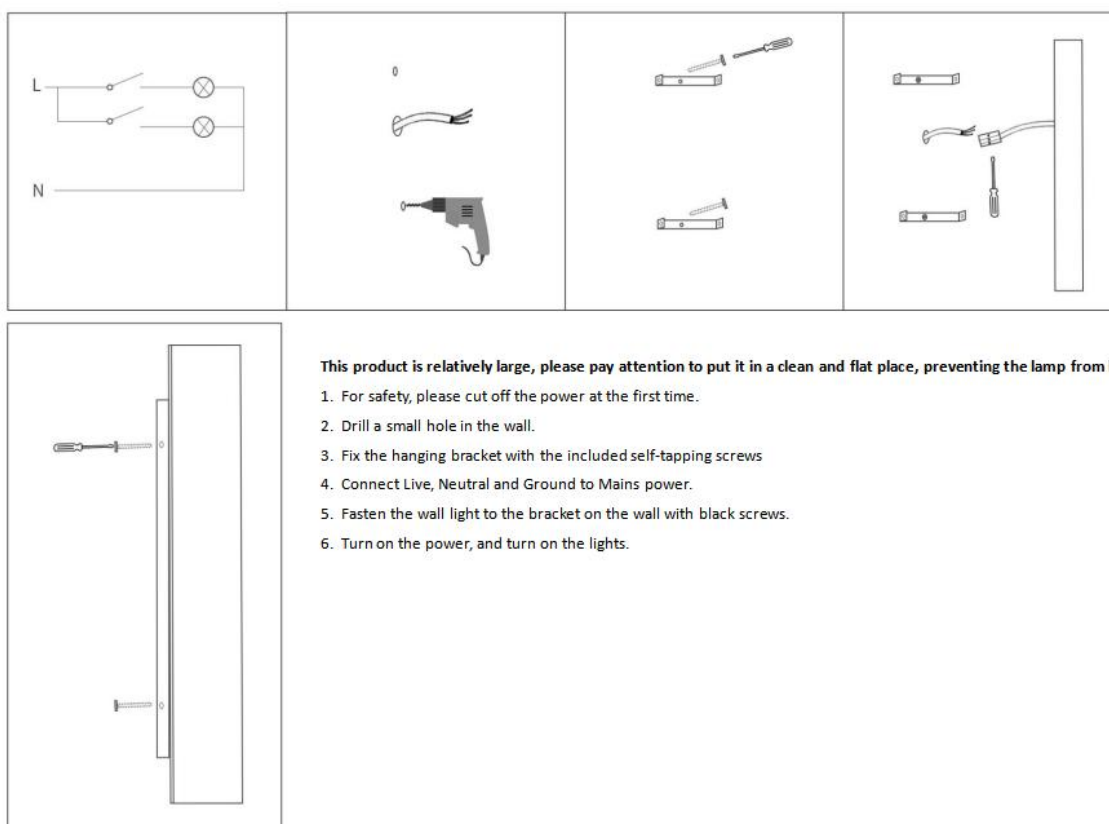

**This product is relatively large, please pay attention to put it in a clean and flat place, preventing the lamp from being scratched.**

1. For safety, please cut off the power at the first time.
2. Drill a small hole in the wall.
3. Fix the hanging bracket with the included self-tapping screws
4. Connect Live, Neutral and Ground to Mains power.
5. Fasten the wall light to the bracket on the wall with black screws.
6. Turn on the power, and turn on the lights.