

6-drawer Dresser

Commode 6 tiroirs

Cómoda de 6 cajones

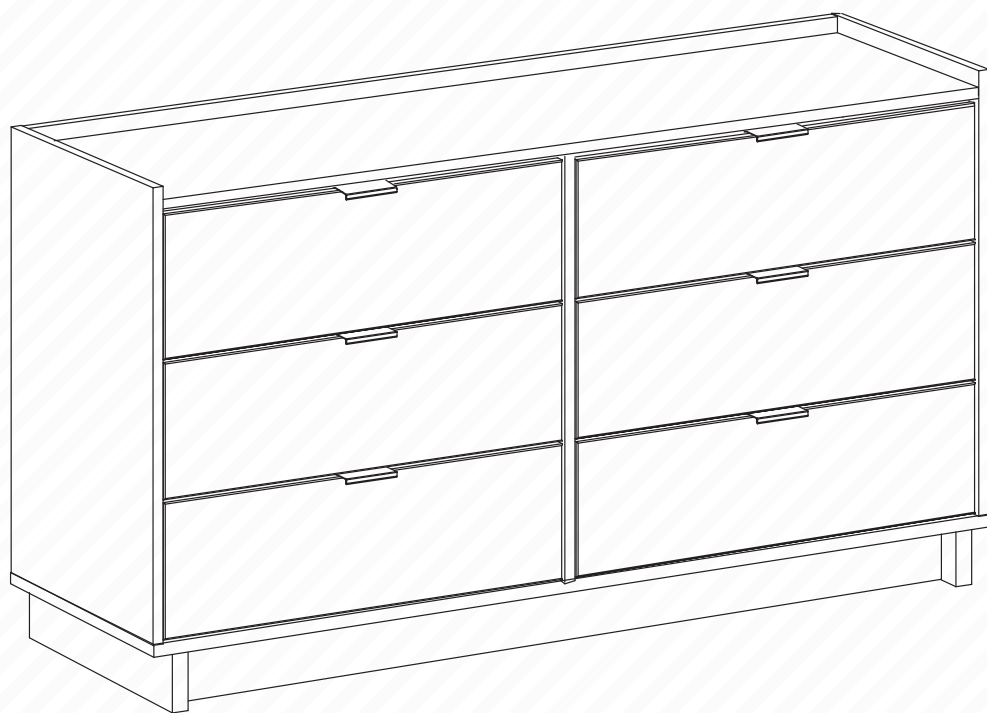

Tools

Vous aurez besoin / Necesitarás

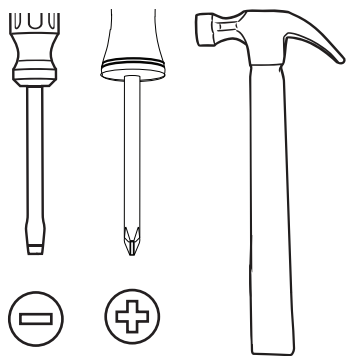

2 person recommended

2 personnes recommandées /

2 personas recomendadas

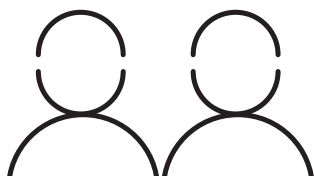

Parts

Pièces

Piezas

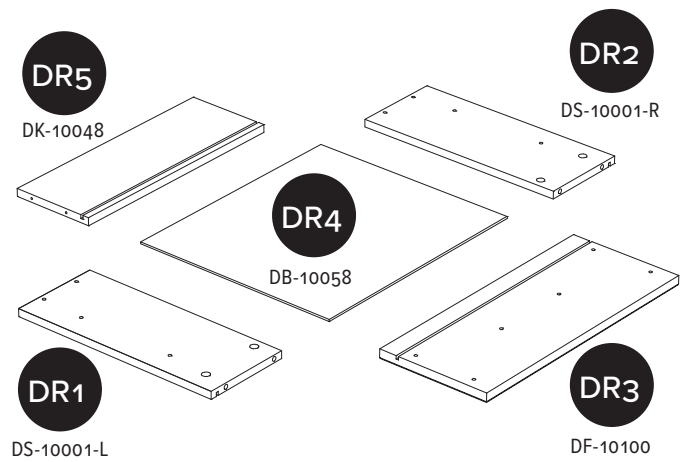
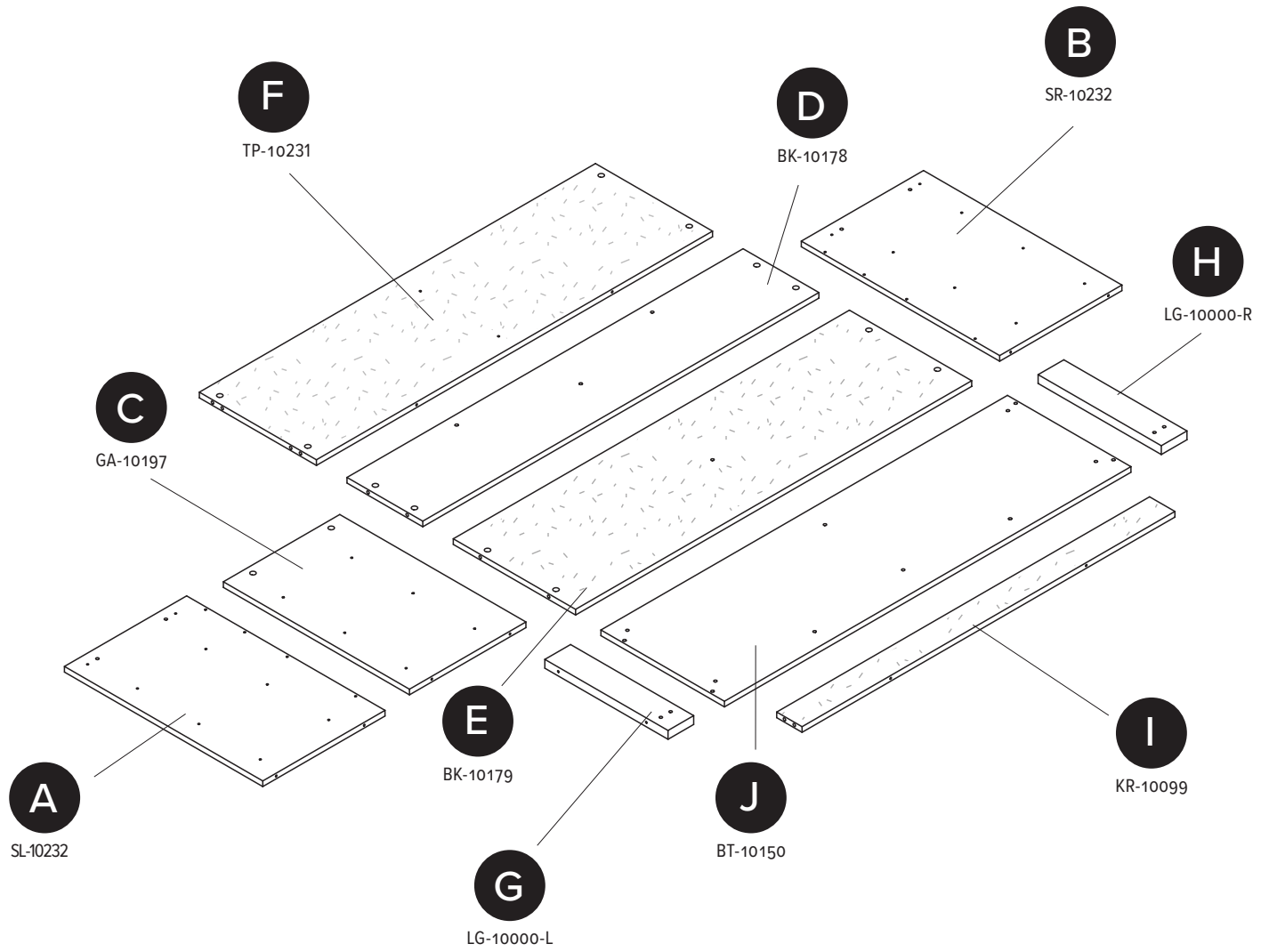

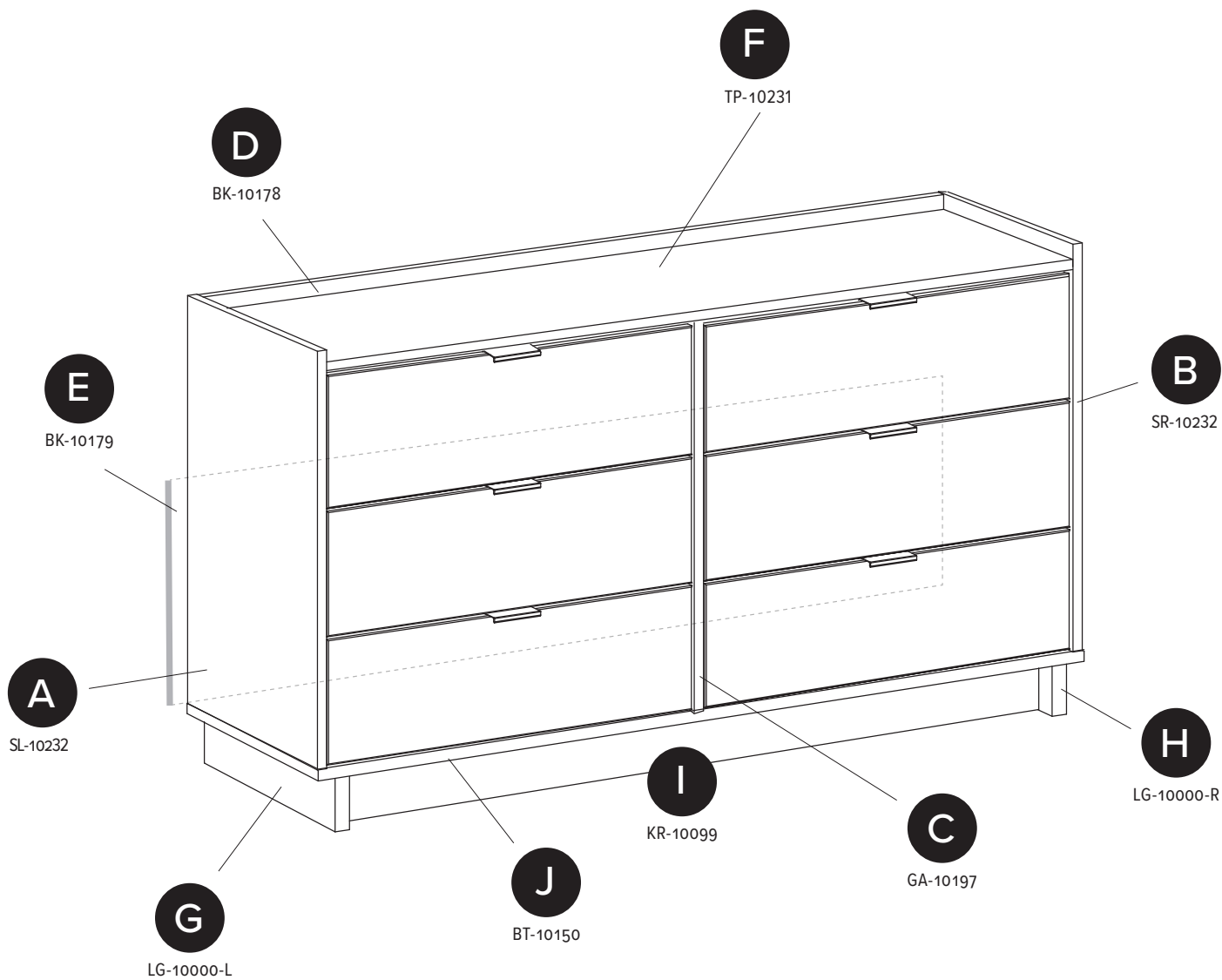

Calling us for parts?
We will need the part number
with colour code added

Si vous devez commander des pièces chez nous, ajoutez un code de couleur au numéro de pièce /
 Si necesita pedirnos piezas, añada el código de color al número de pieza



Part Number
 Numéro de pièce /
 Número de pieza

Color Code
 Code couleur /
 Código de color

Colour Code Lookup

Recherche de code couleur / Búsqueda de código de color

B for Black
 pour Noir / para Negro

W for White
 pour Blanc / para Blanco

D for Drifted Gray
 pour Gris vieilli /
 para Gris madera

CN for Cherry
 pour Cerise / para Cereza

A for Washed White
 pour Blanc lavé /
 para Blanco lavado

O for Natural Oak
 pour Chêne naturel /
 para Roble Natural

Hardware

Quincaillerie

Piezas de Conexión

14 X



RM-0103

16 X



RM-0001

14 X

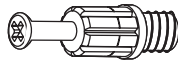

RM-0501

48 X



RM-0457

8 X

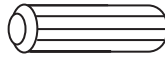

RM-0069

24 X



RM-0715

24 X



RM-0504

24 X

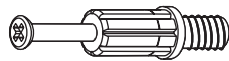

RM-0500

12 X

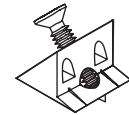

RM-0839

6 X

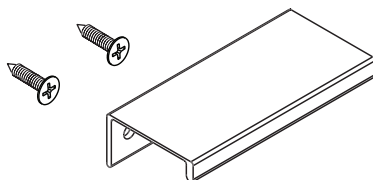

RM-0908-B

6X Drawer Slides Set (Blue Wheels)

Ensemble de glissières de tiroir (roues bleues)

Juego de guías para cajones (ruedas azules)

RM-0469-G

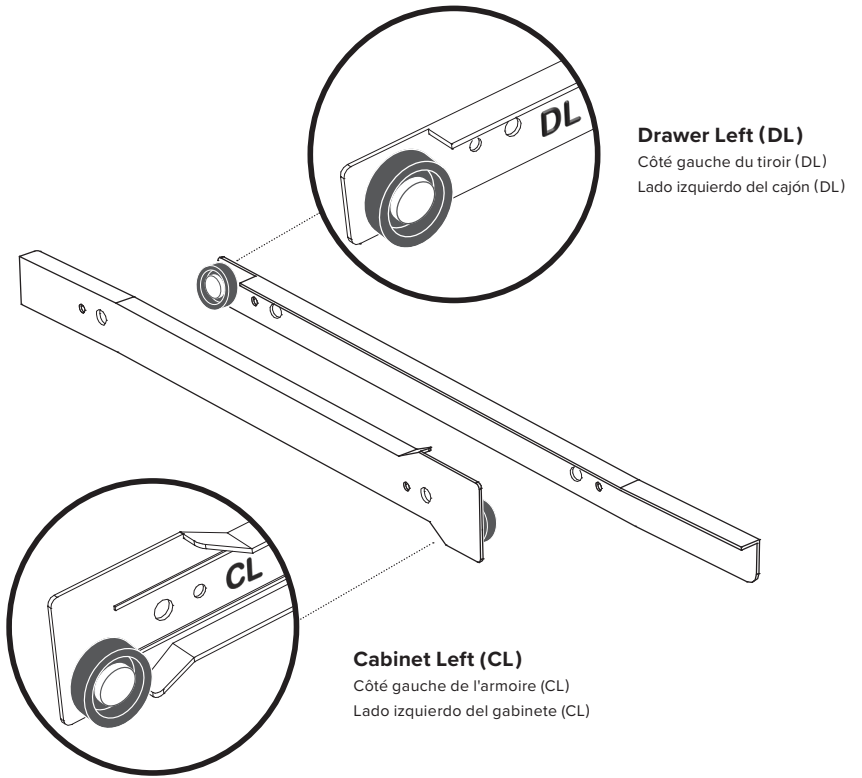

6X Drawer Slides Set (Red Wheels)

Ensemble de glissières de tiroir (roues rouges)

Juego de guías para cajones (ruedas rojas)

RM-0469-G

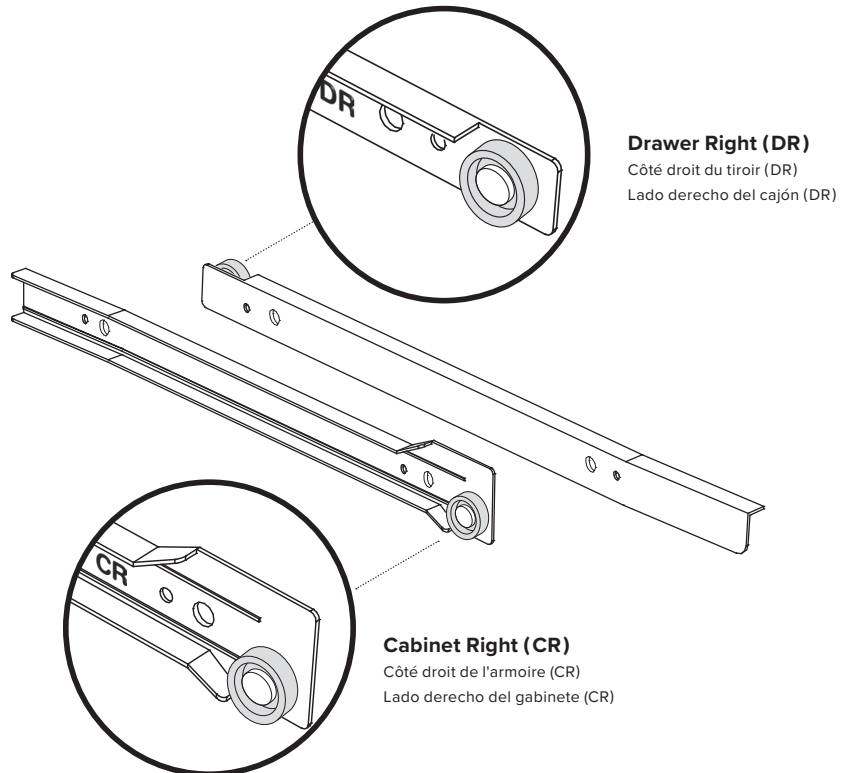

1X Tipover Restraint Kit

Kit anti-basculament

Kit de sujeción contra volcaduras

HP-1088

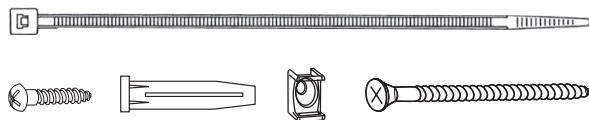

Assemble in 21 steps

Assemblage en 21 étapes

Montar en 21 pasos



45 mins

**Let's
start!**

Commençons!

¡Comencemos!

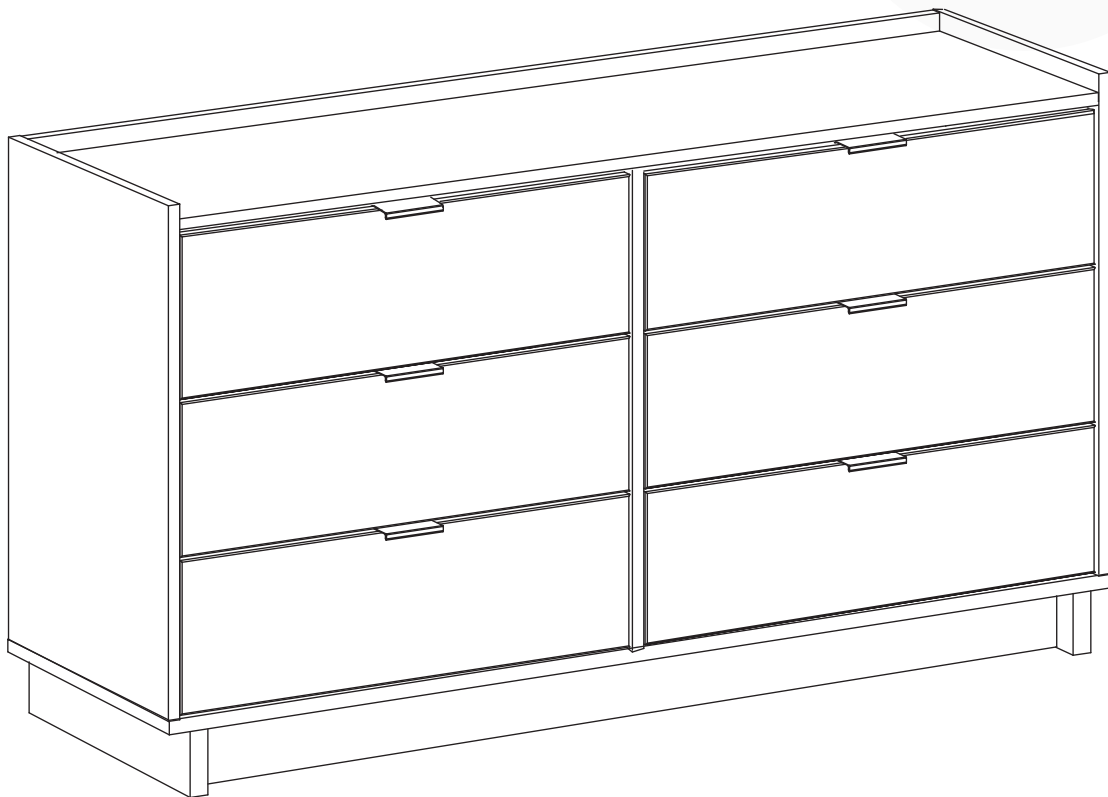

1

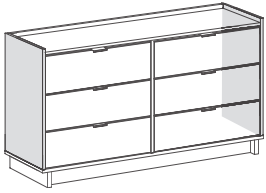

12X



RM-0457

3X

Blue Wheel Slider Cabinet Left (CL)

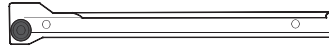

3X

Red Wheel Slider Cabinet Right (CR)

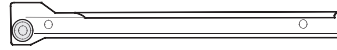

Blue Wheel Slider
Cabinet Left (CL)

Red Wheel Slider
Cabinet Right (CR)

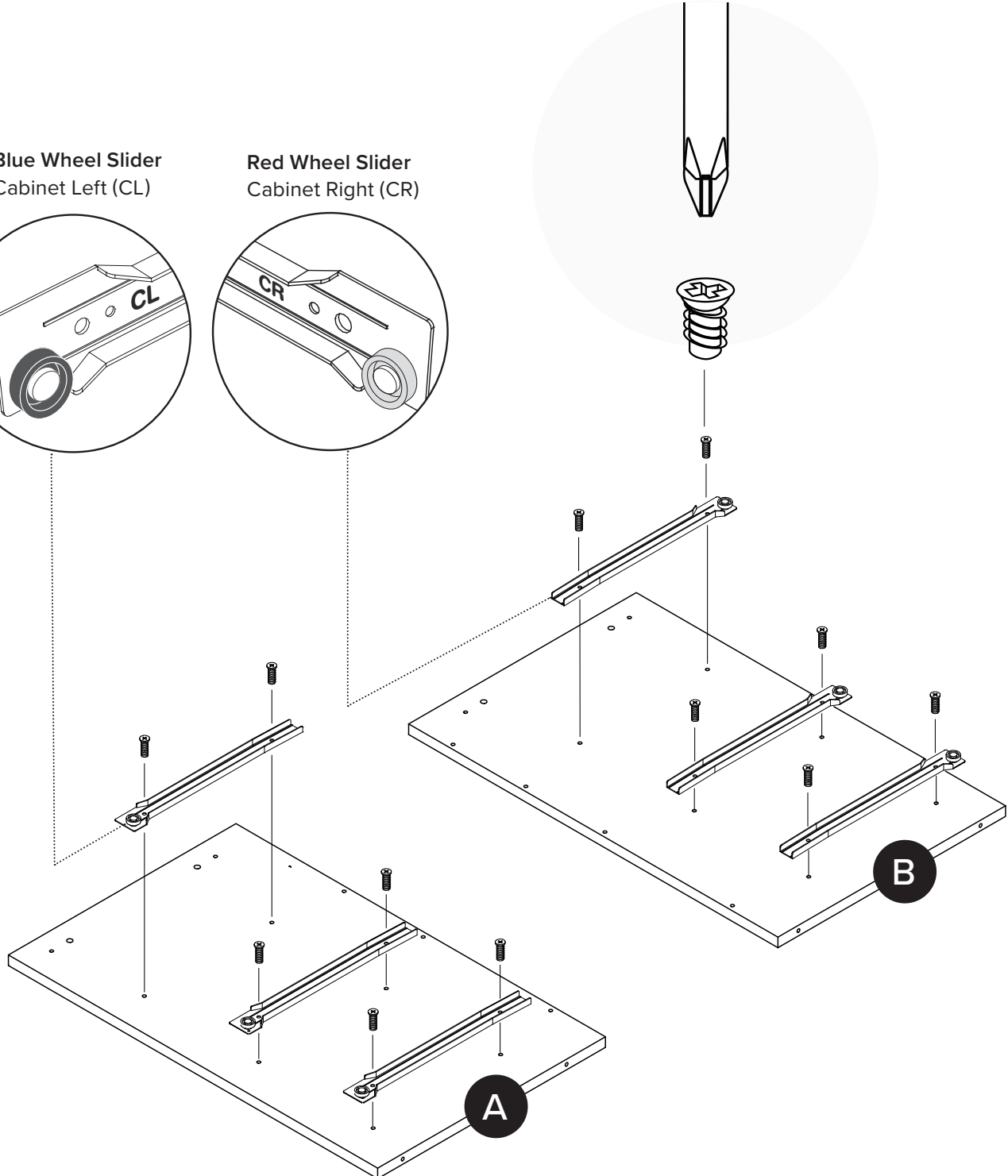
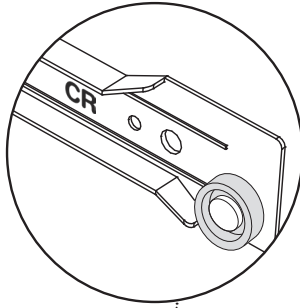
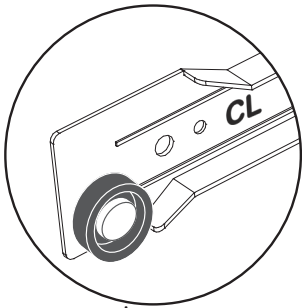

2

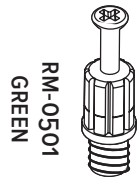
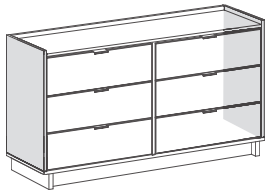

12X **4X**

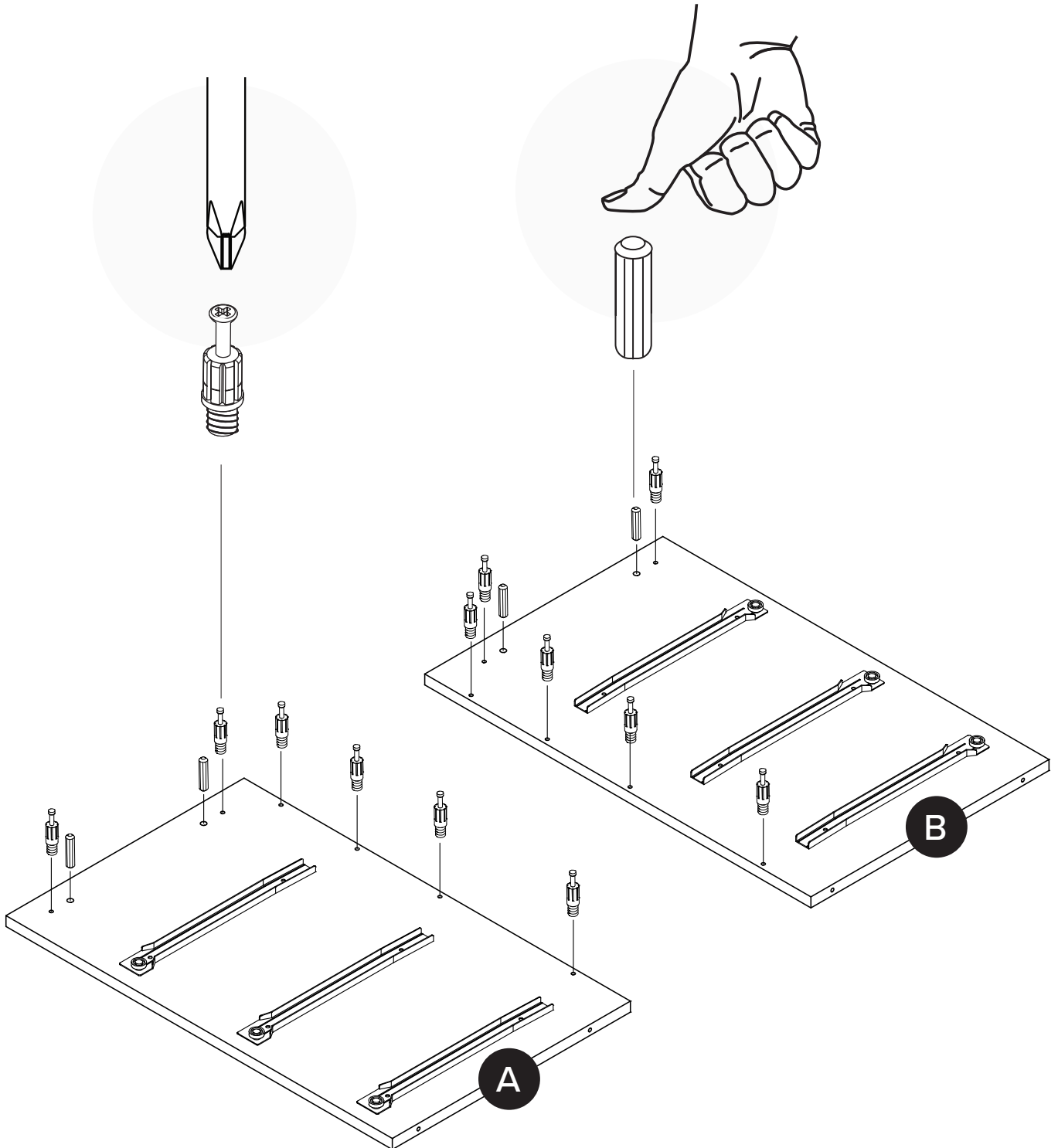

4

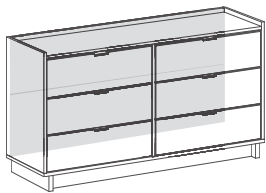

RM-0103



8X

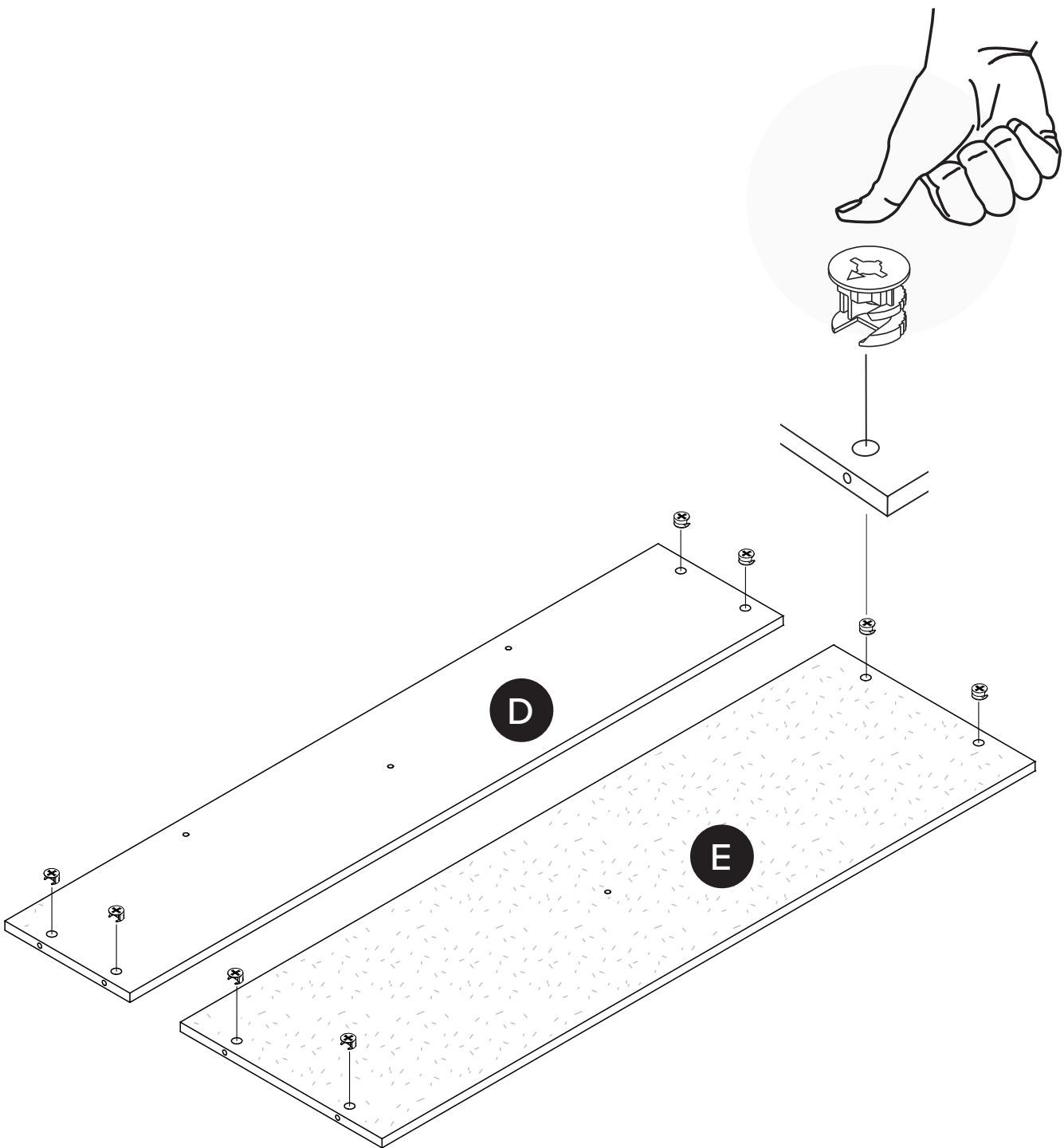

5

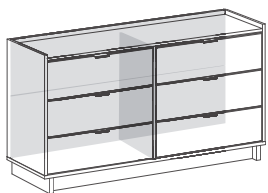

RM-0001

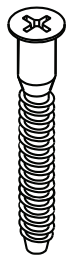

2X

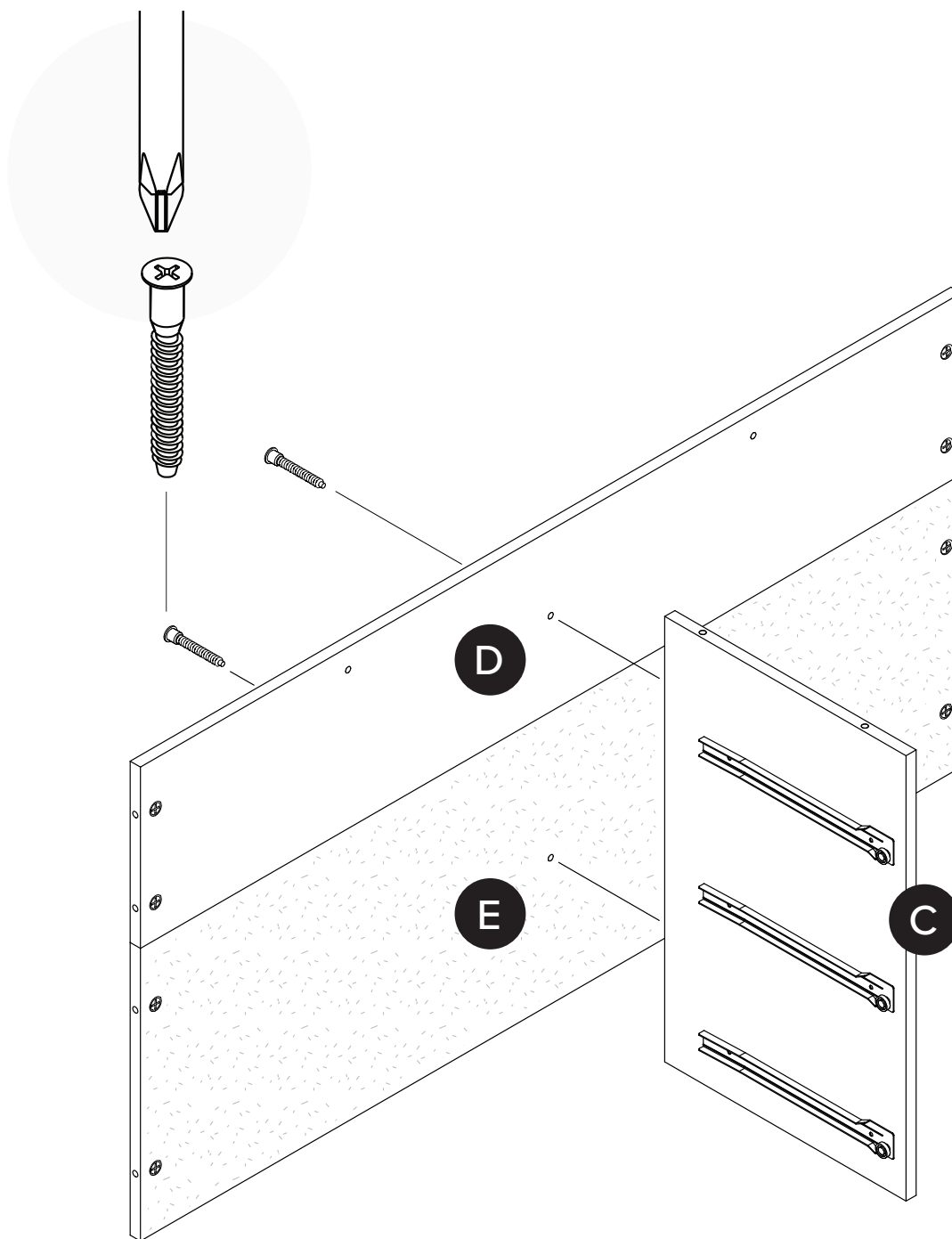

6

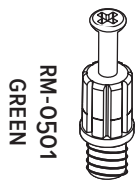
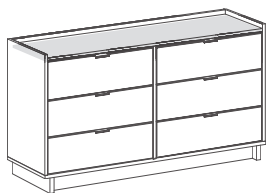

2X



4X

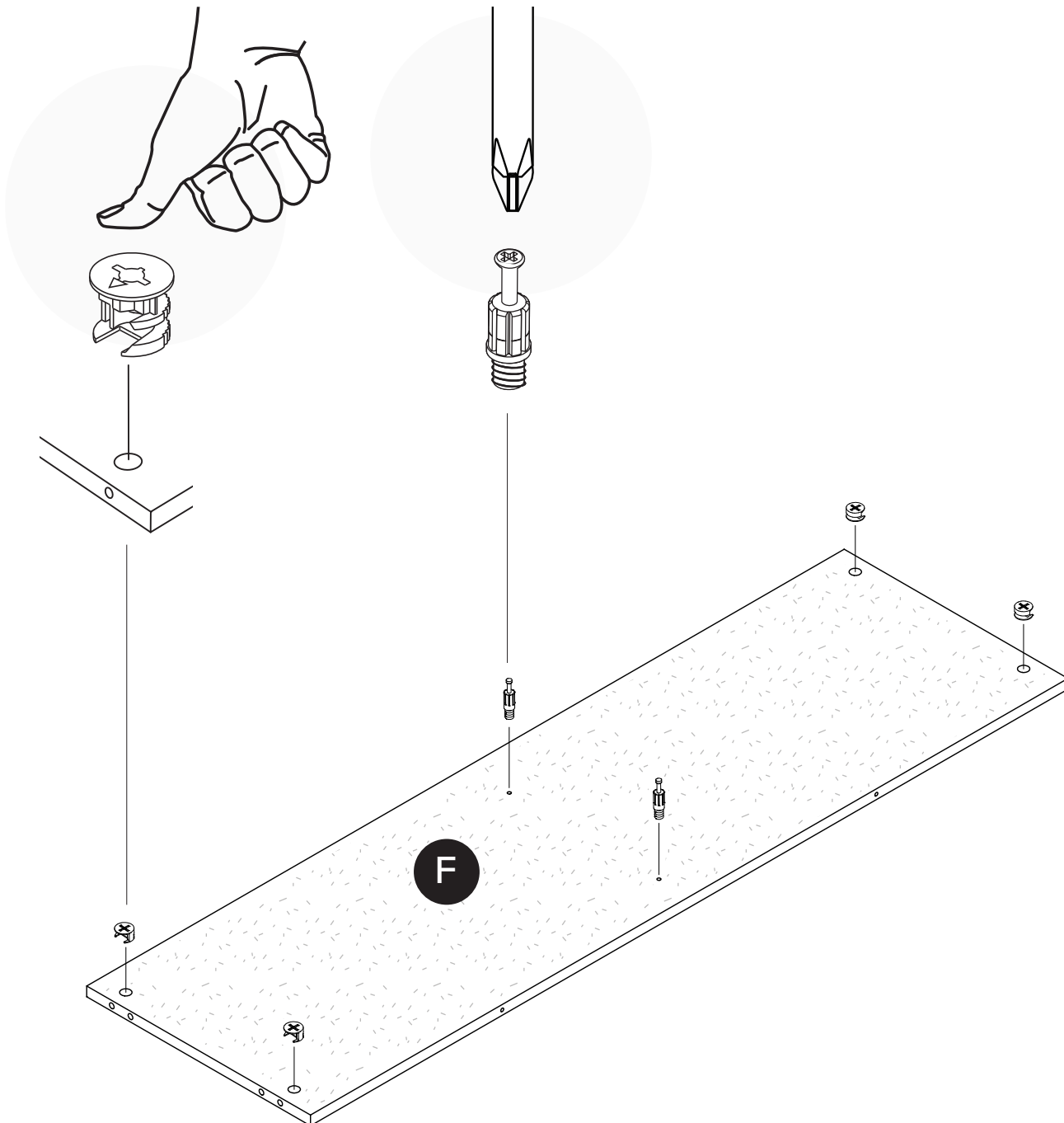

7

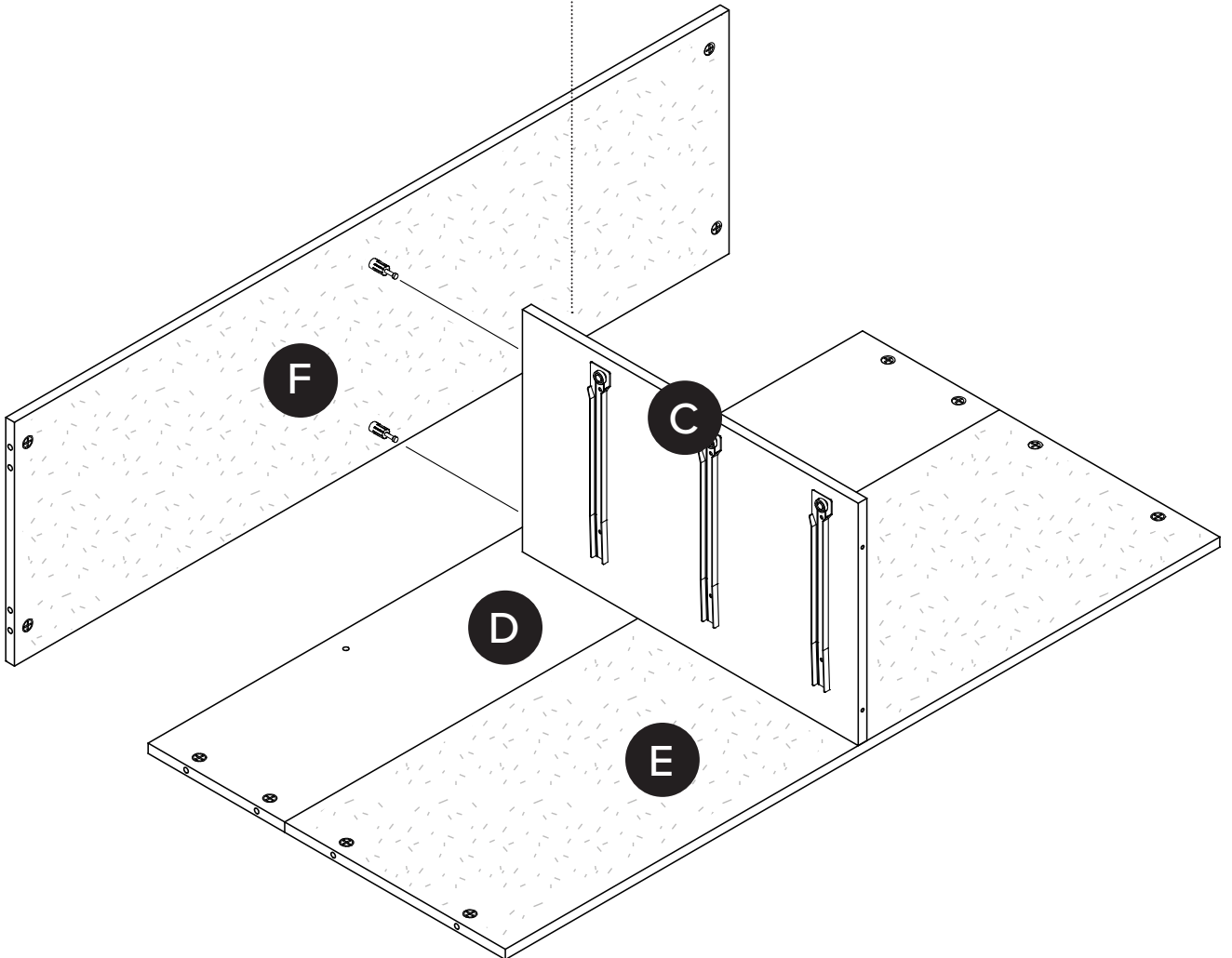
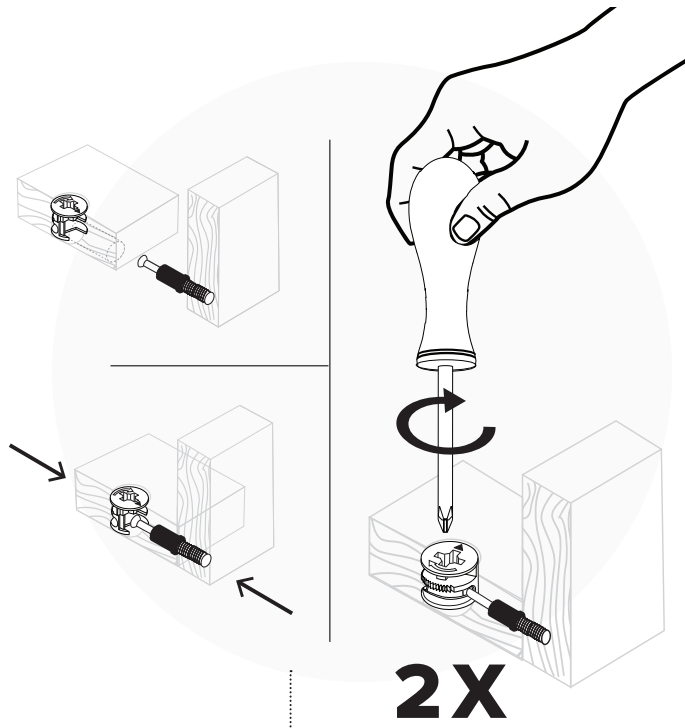
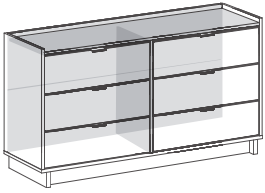

8

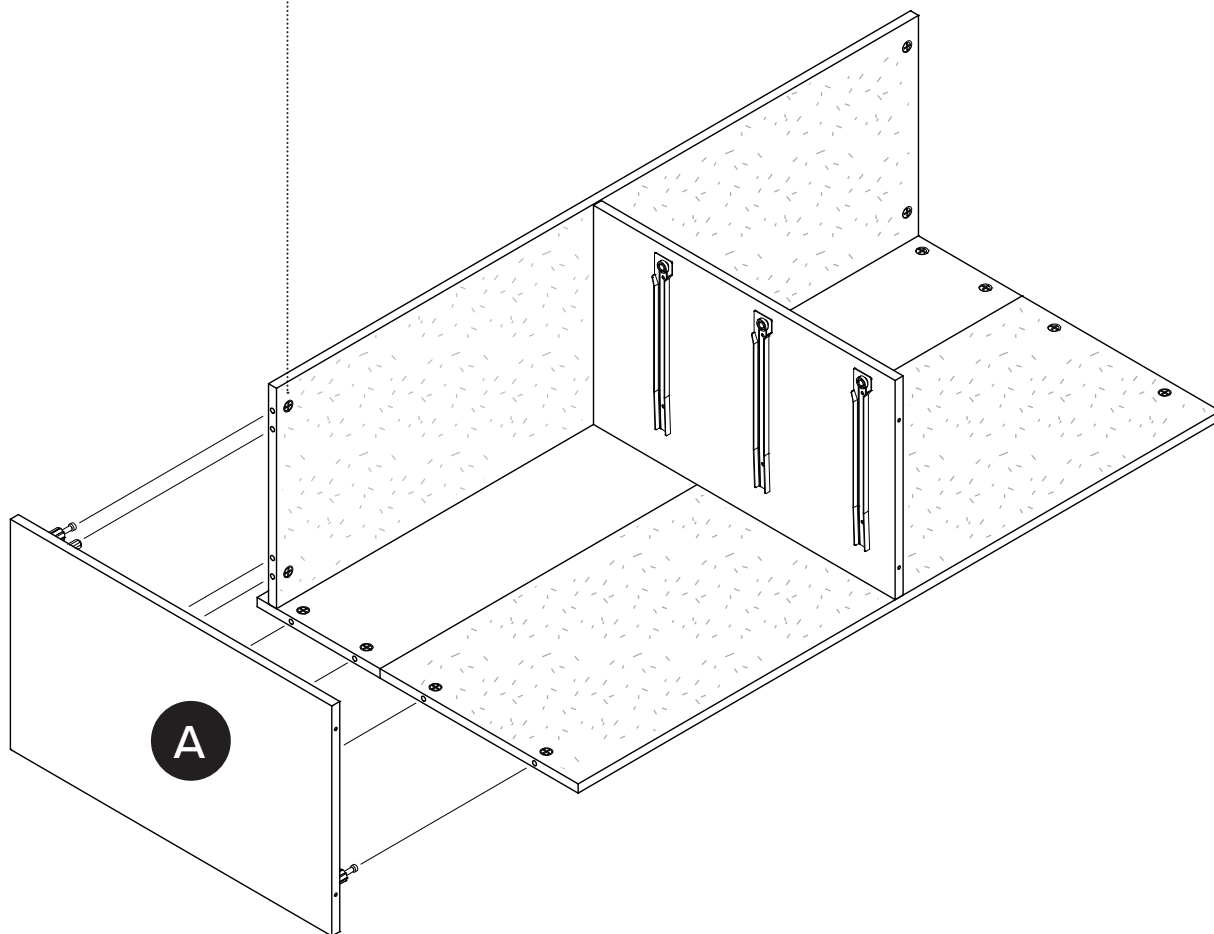
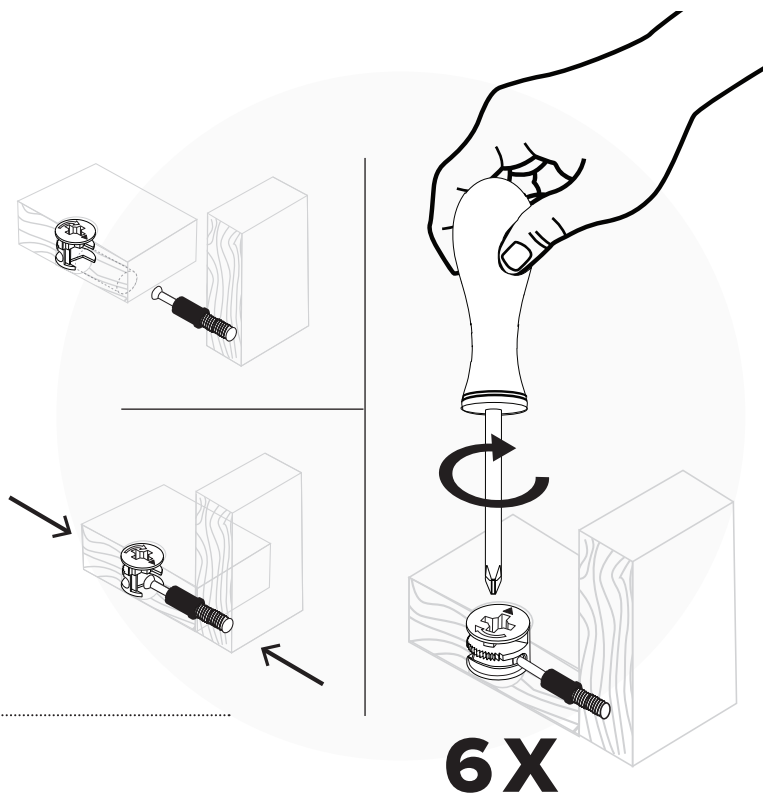
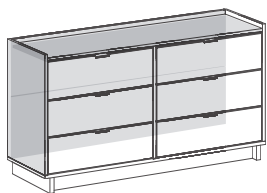

9

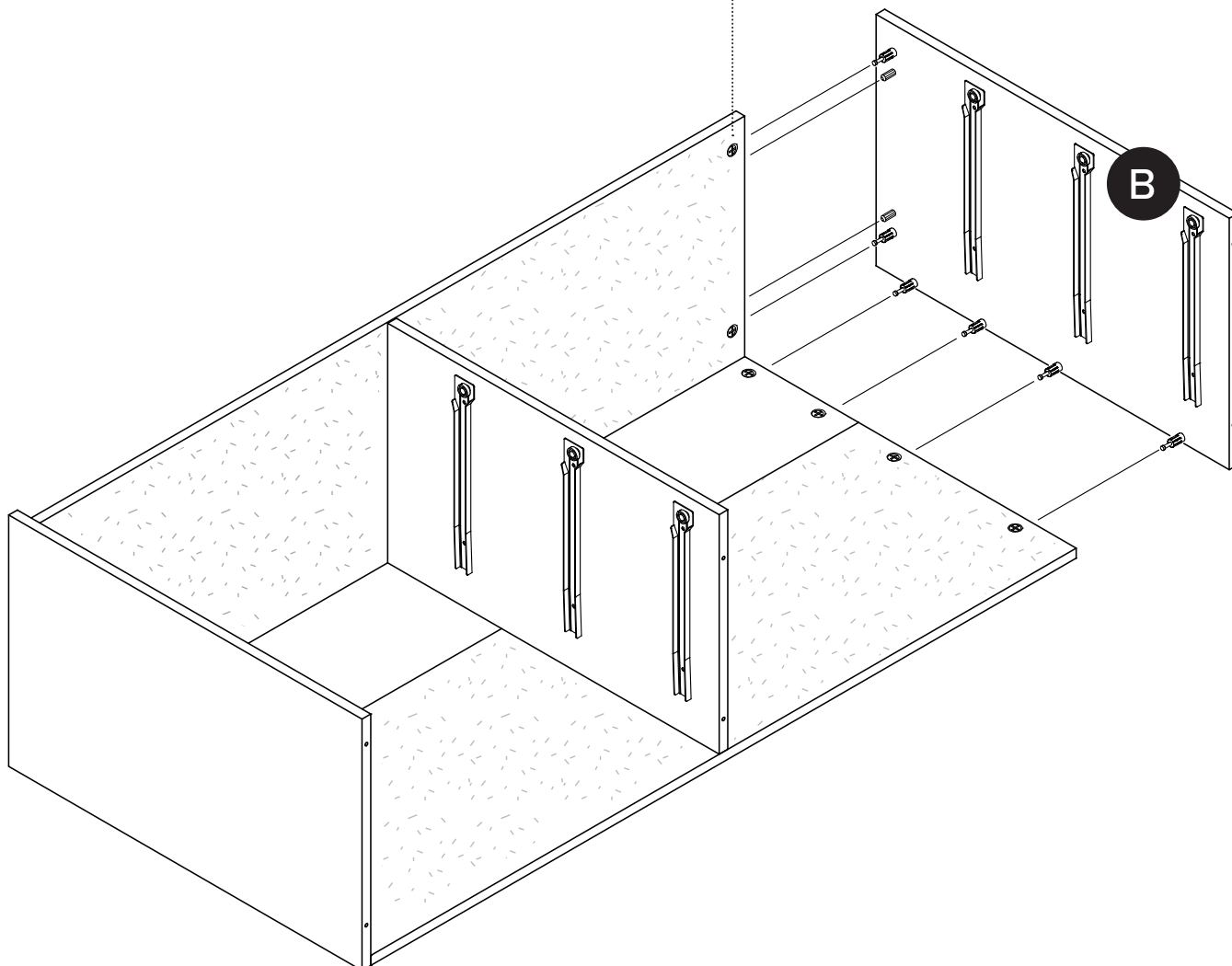
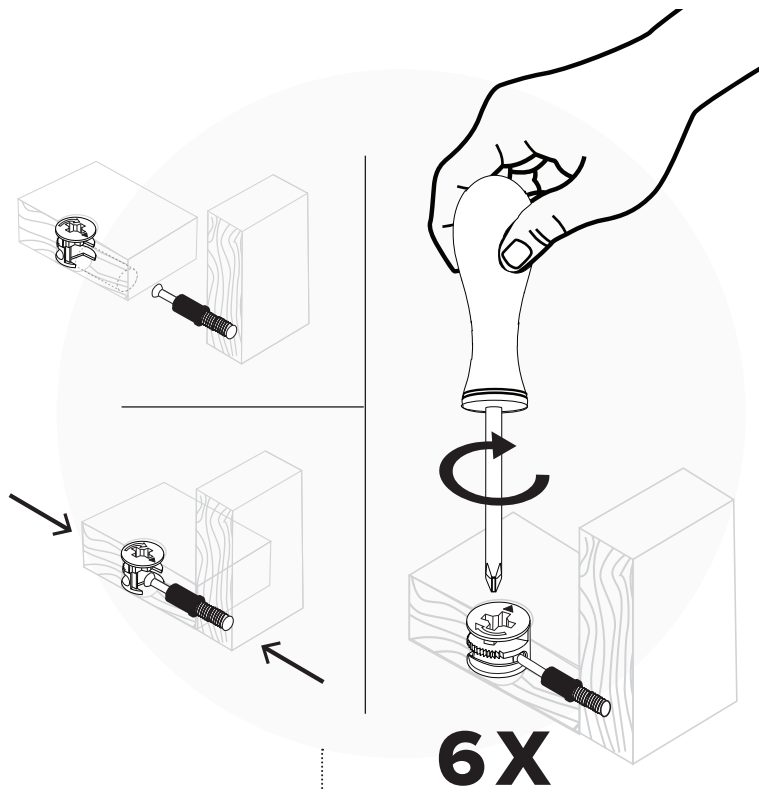
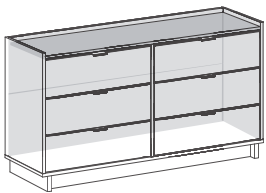

10

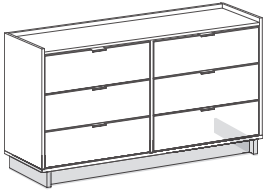

RM-0069



4X

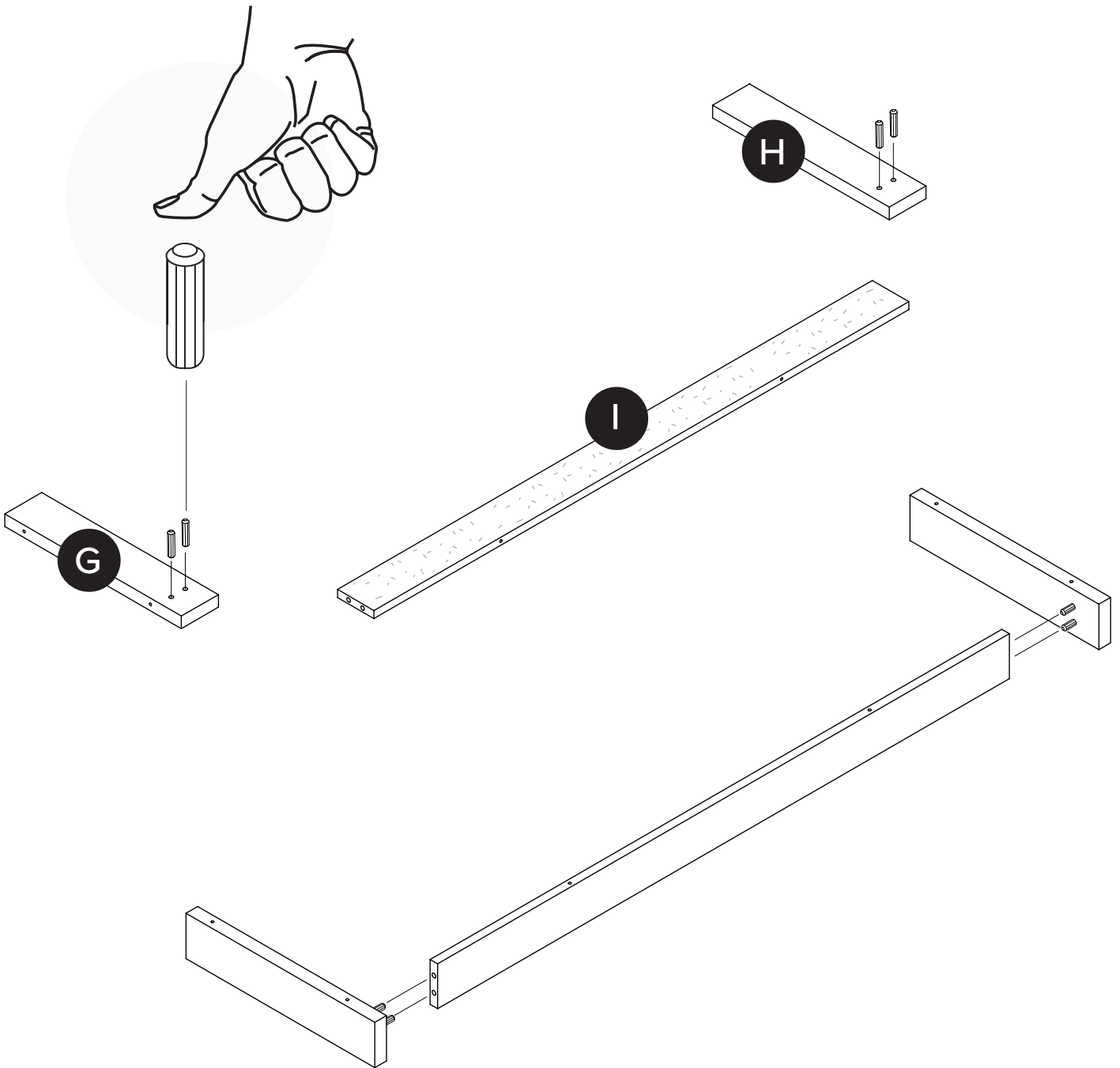

11

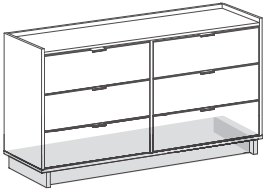

RM-0001

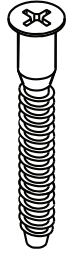

6X

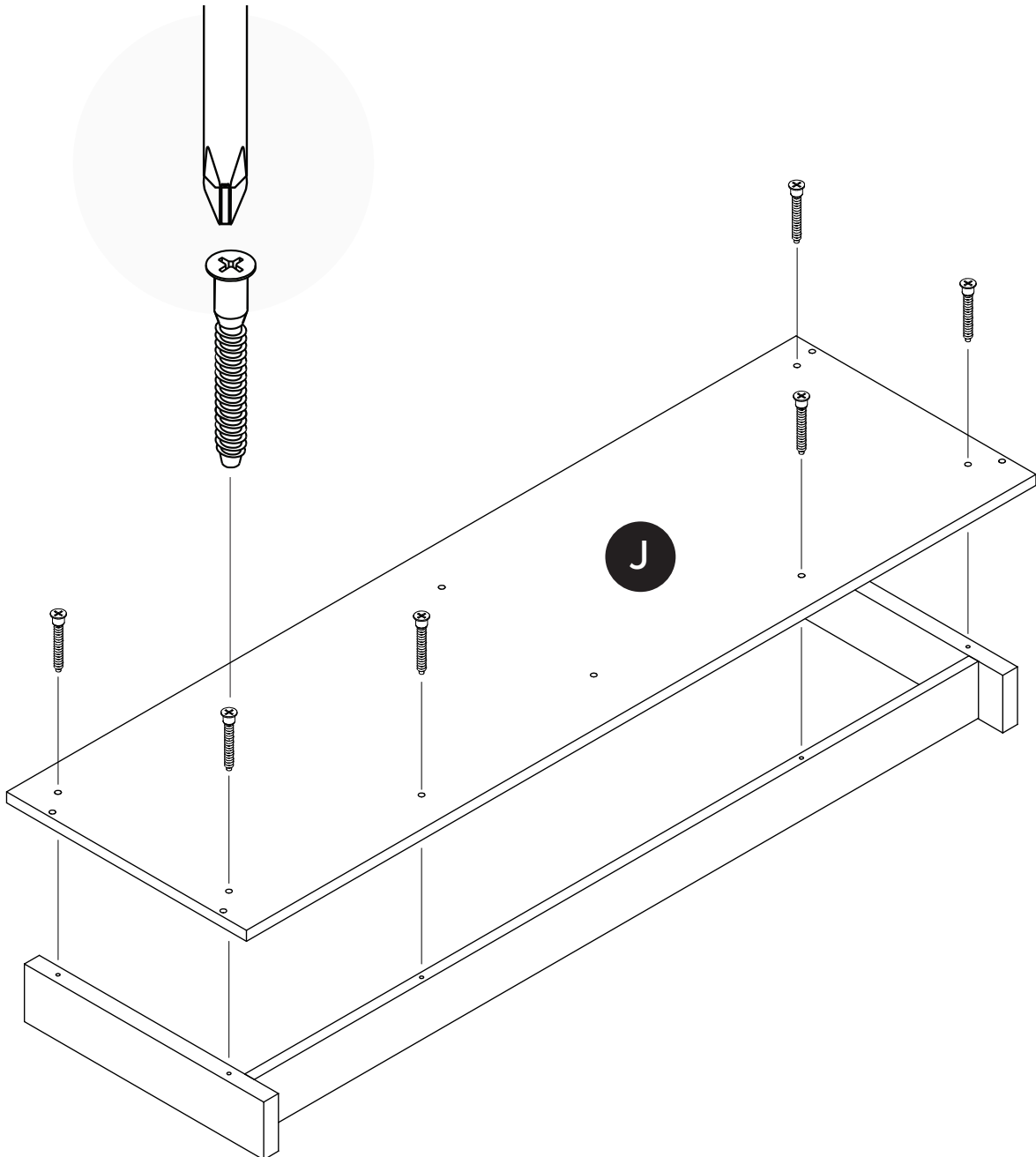

12

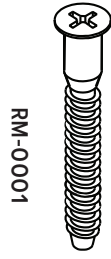
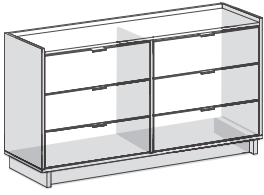

RM-0001

6X

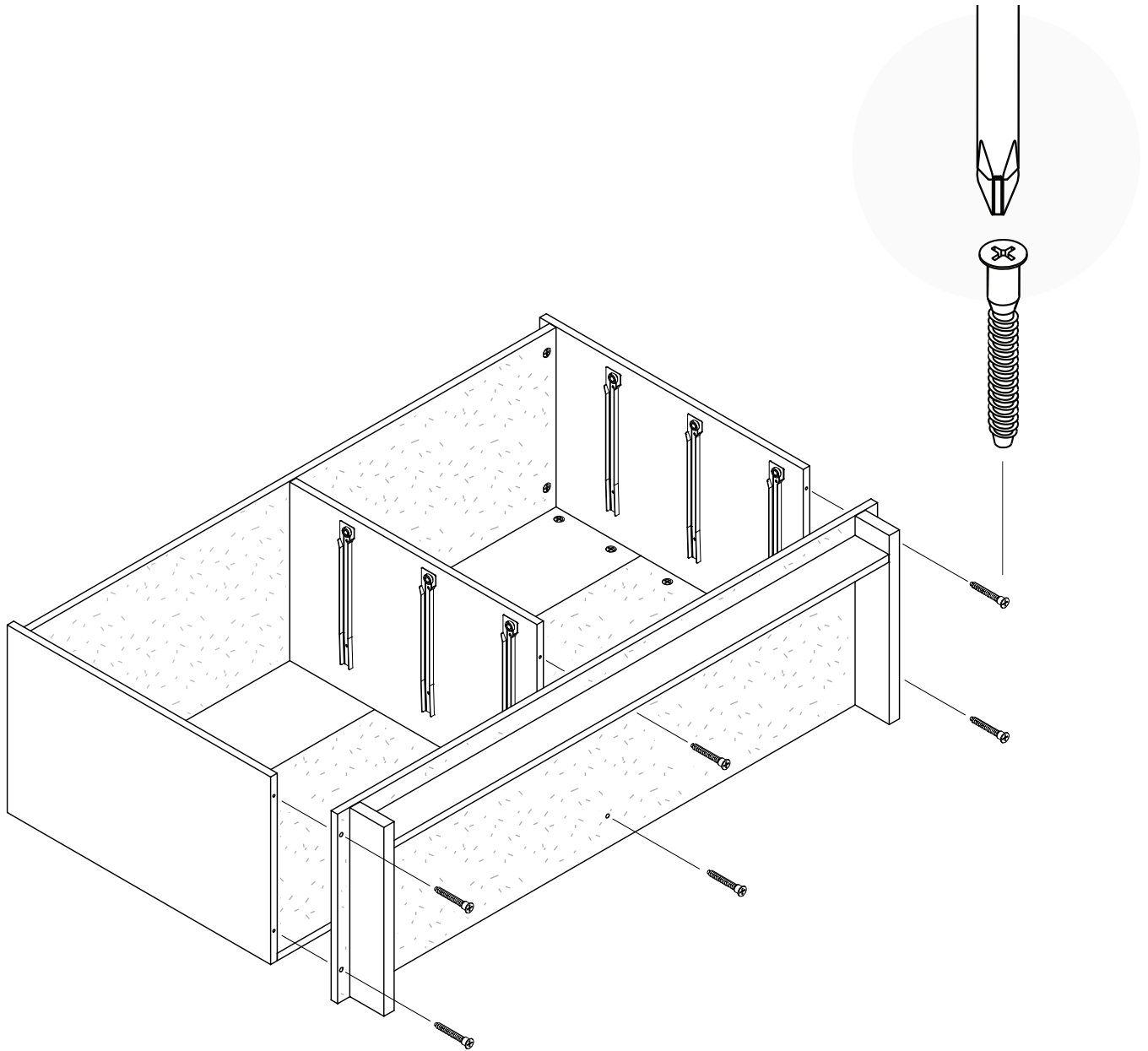

13

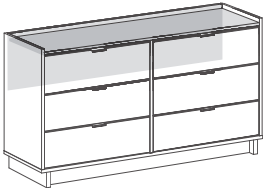

RM-0001

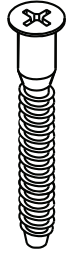

2X

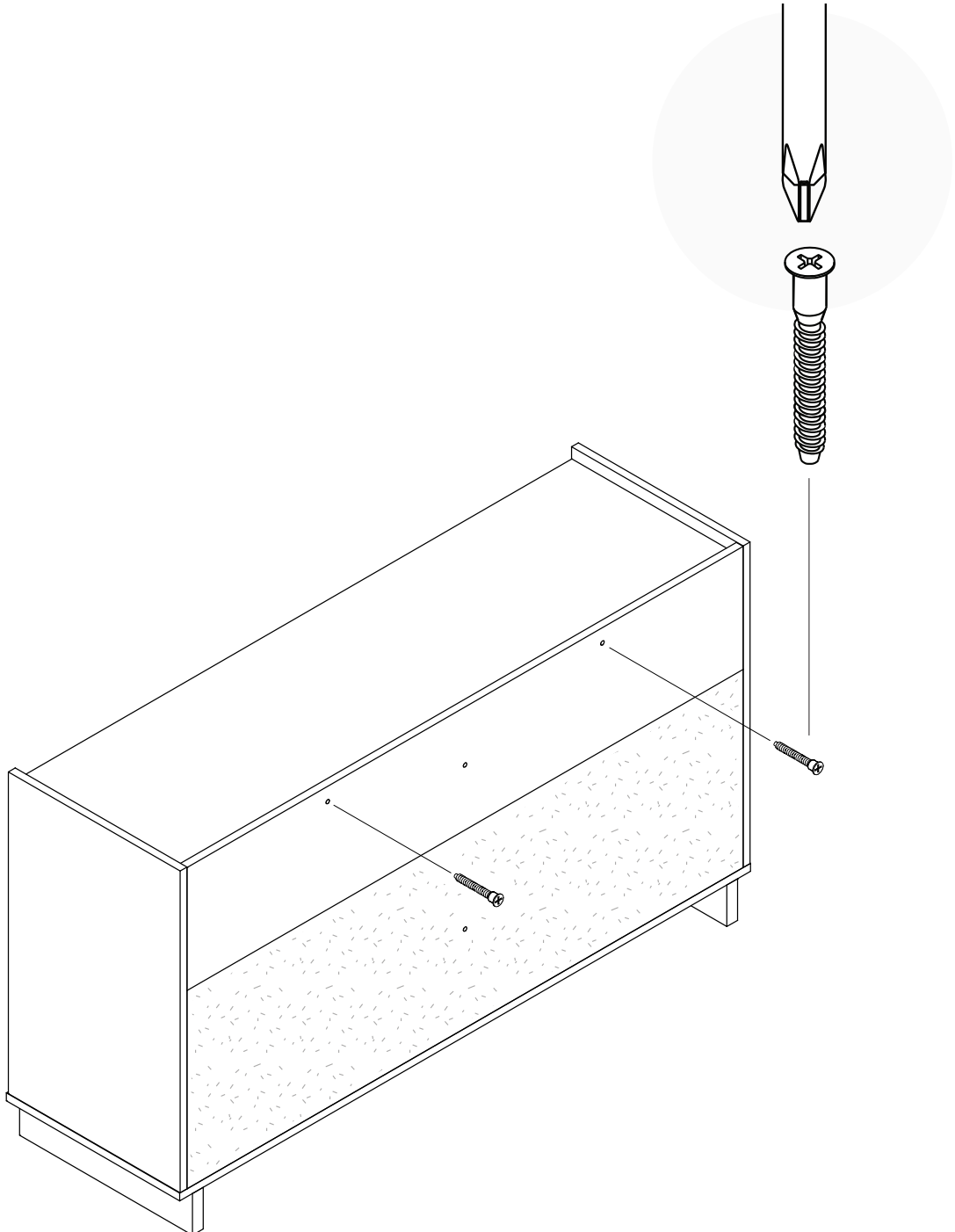

14

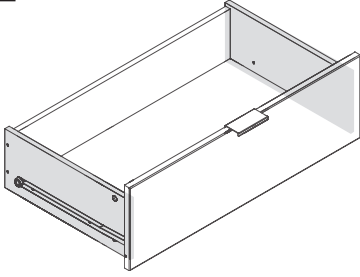

4X



RM-0457

1X

Blue Wheel Slider (Drawer Side)

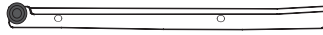

1X

Red Wheel Slider (Drawer Side)

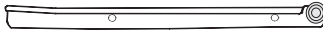

Blue Wheel Slider
Drawer Left (DL)

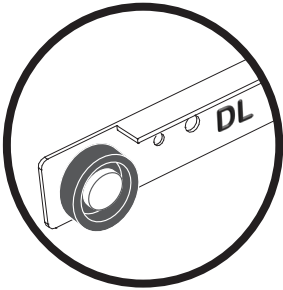

Red Wheel Slider
Drawer Right (DR)

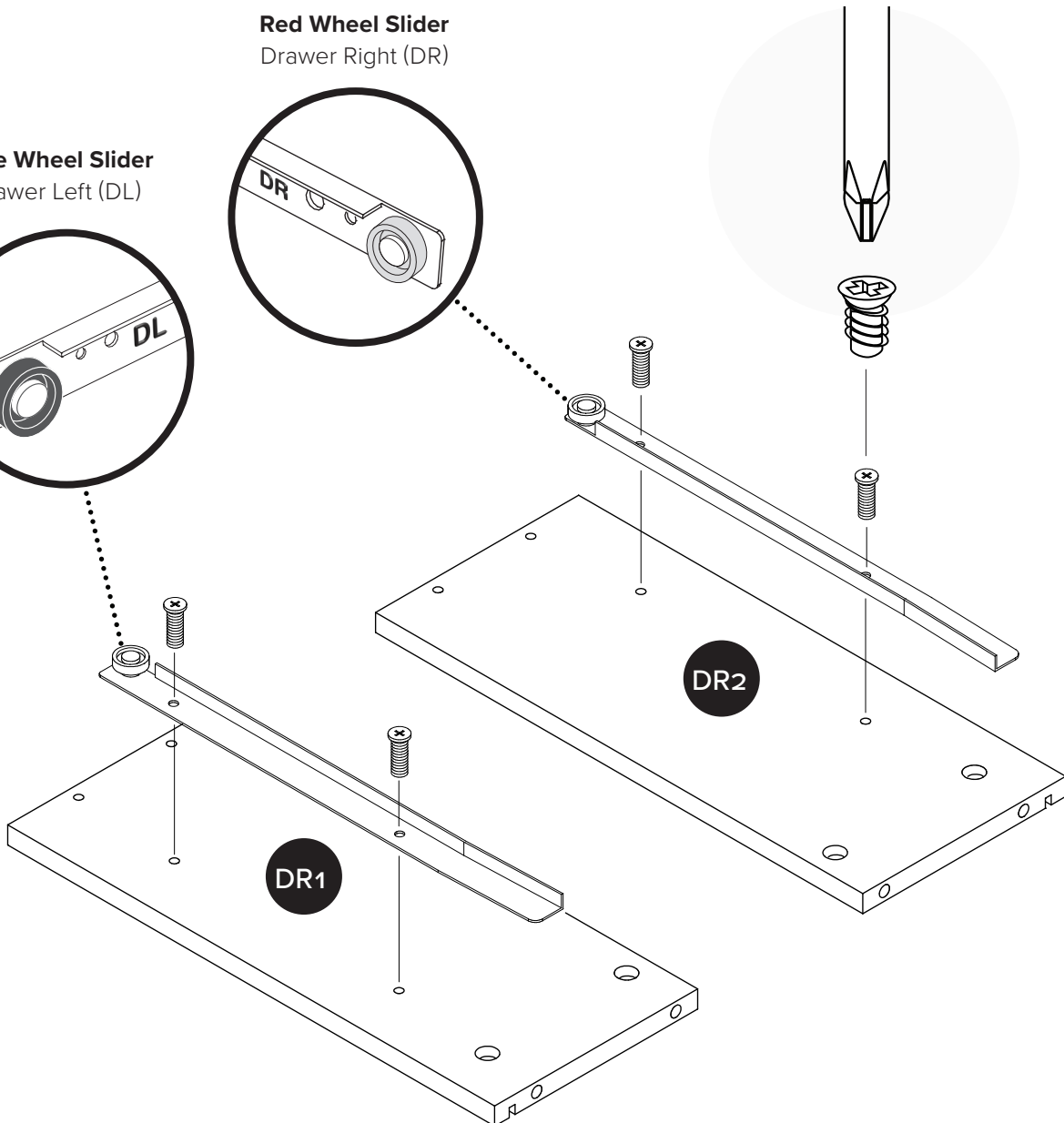
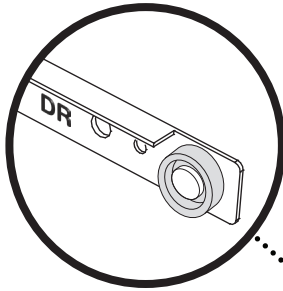

15

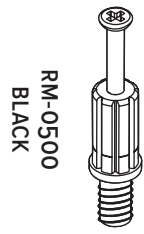
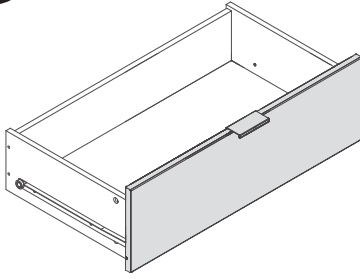

RM-0500
BLACK

4X

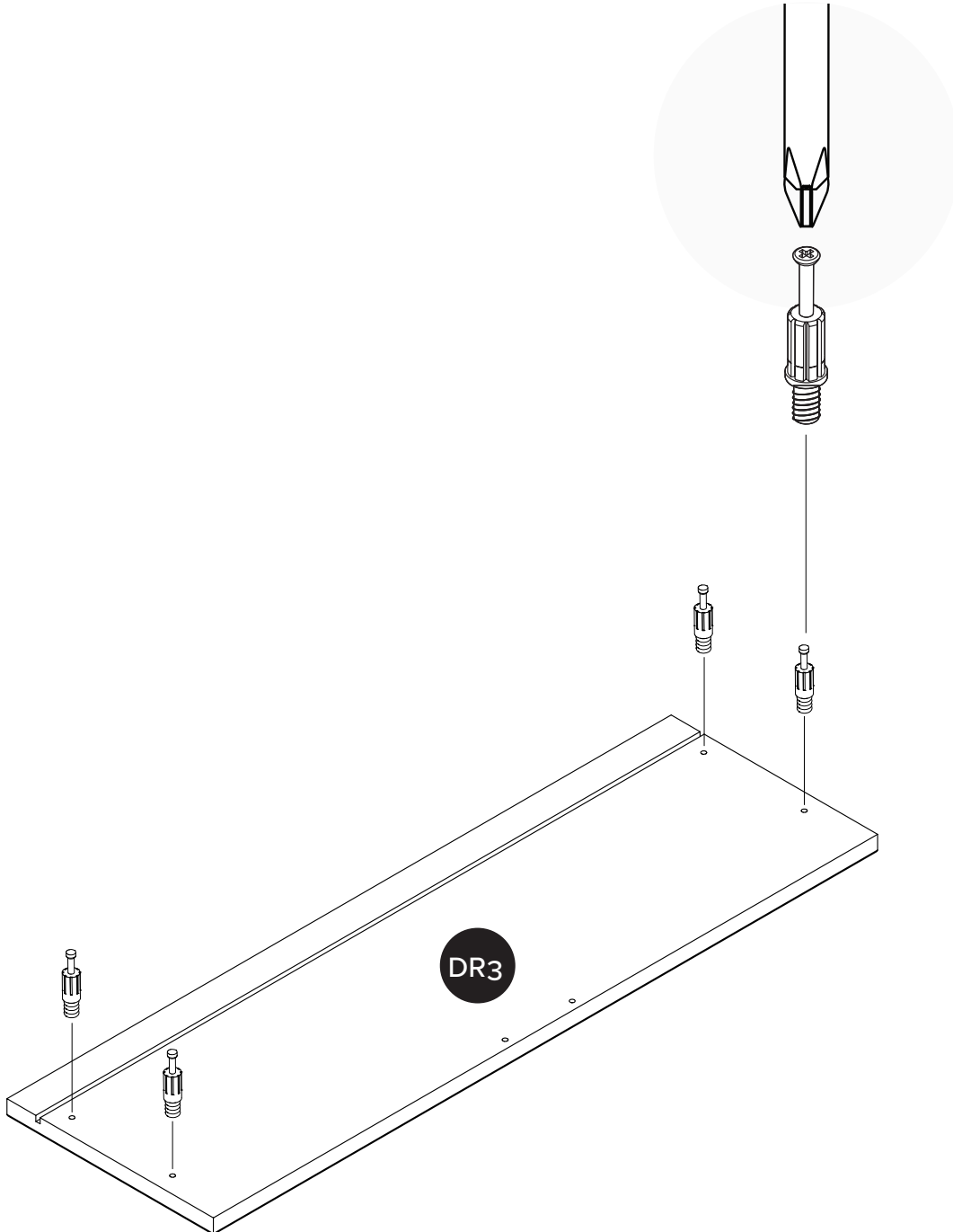

16

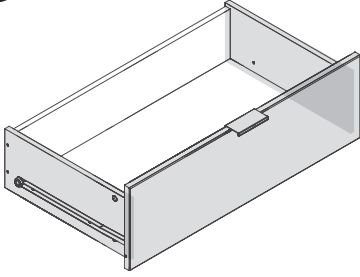

RM-0715



4X

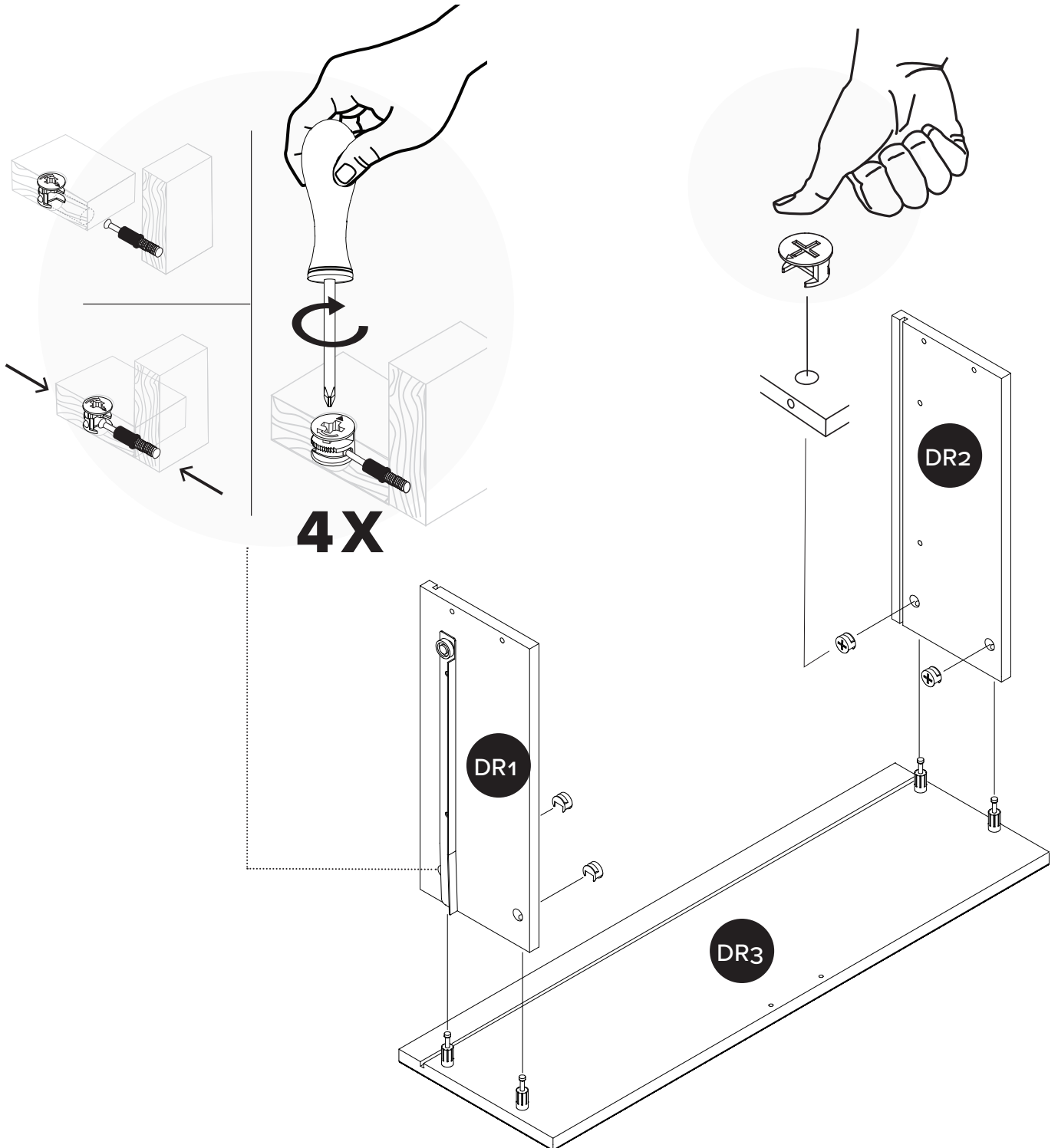

17

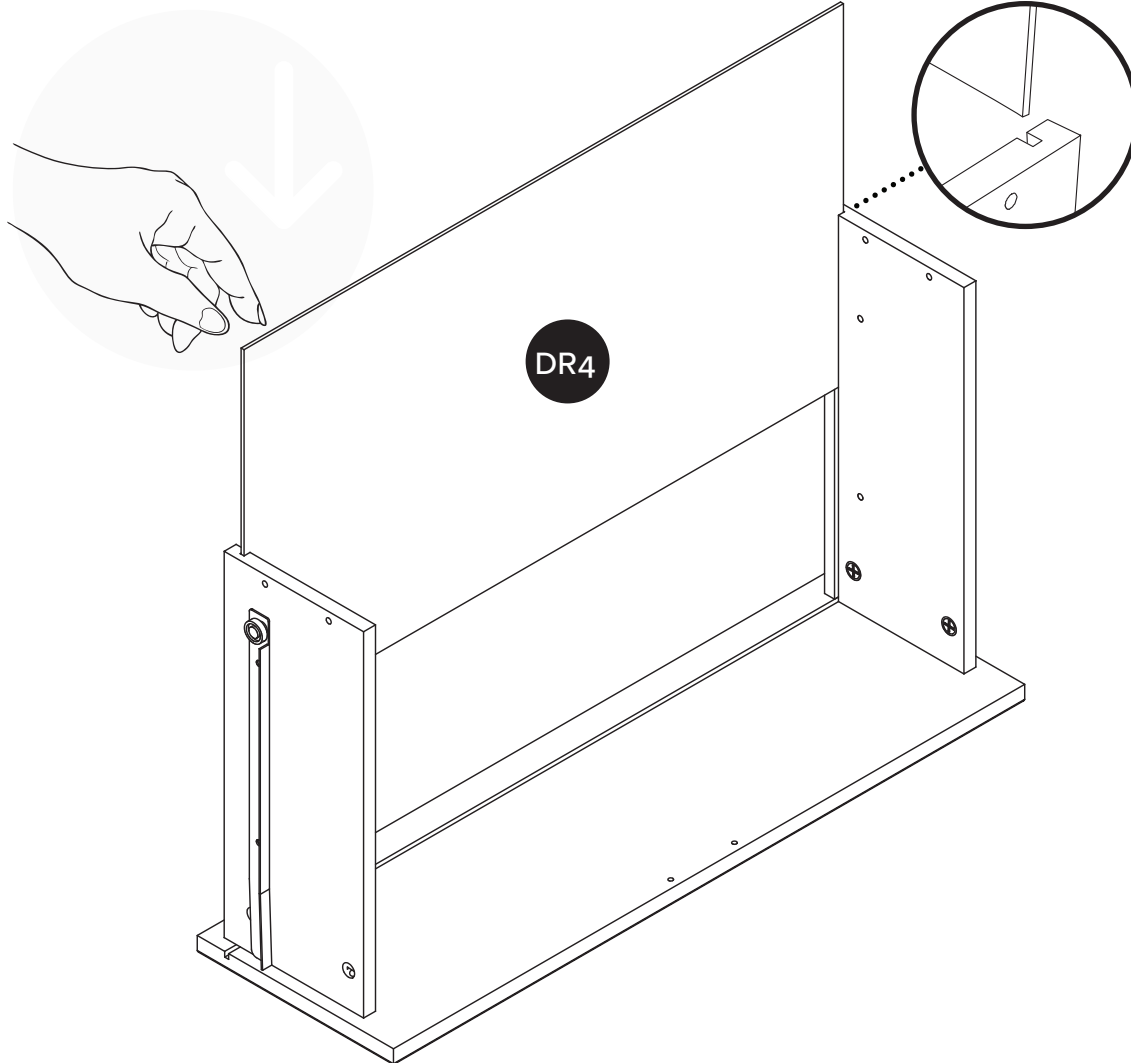
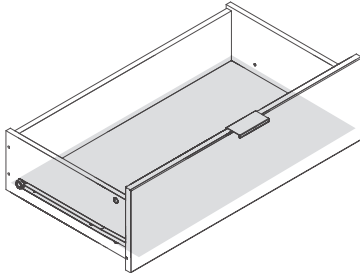

18

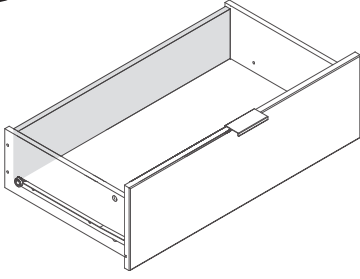

4X

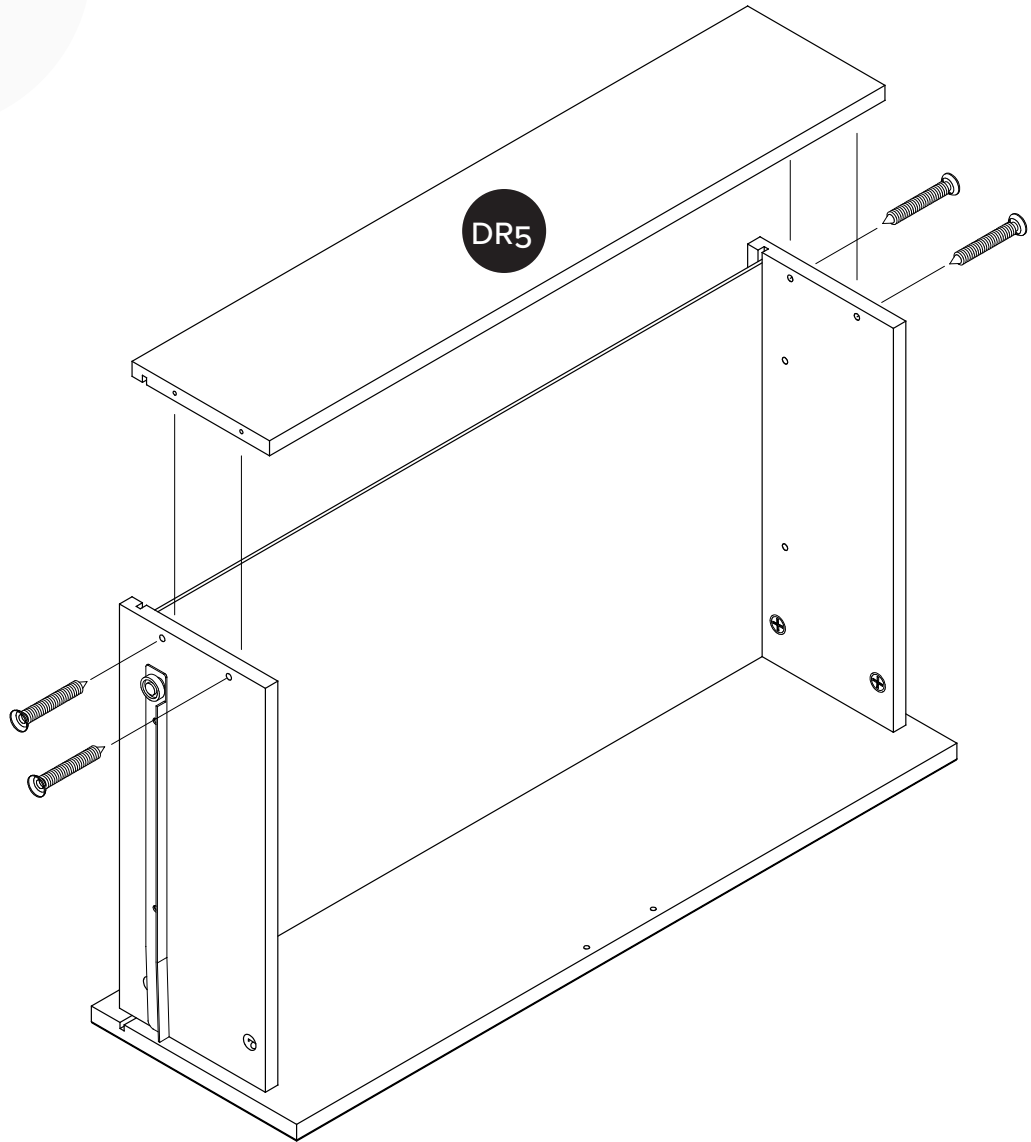
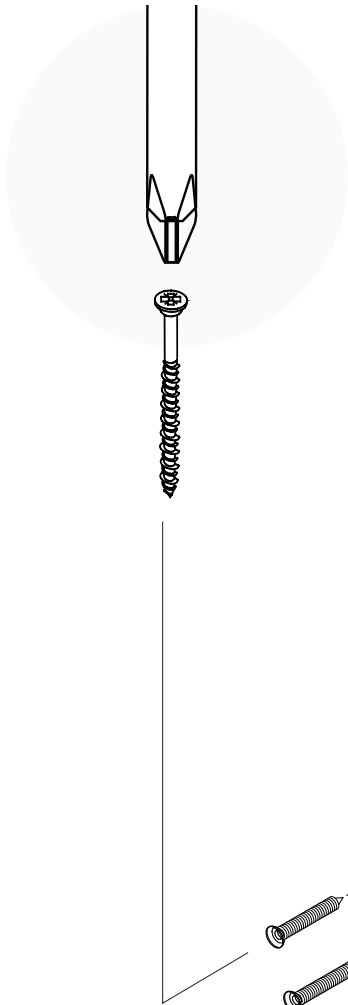

19

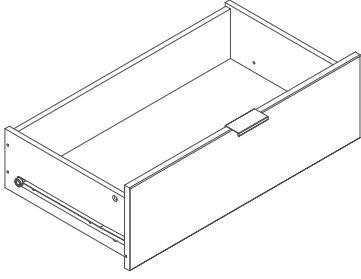

RM-0839



2X

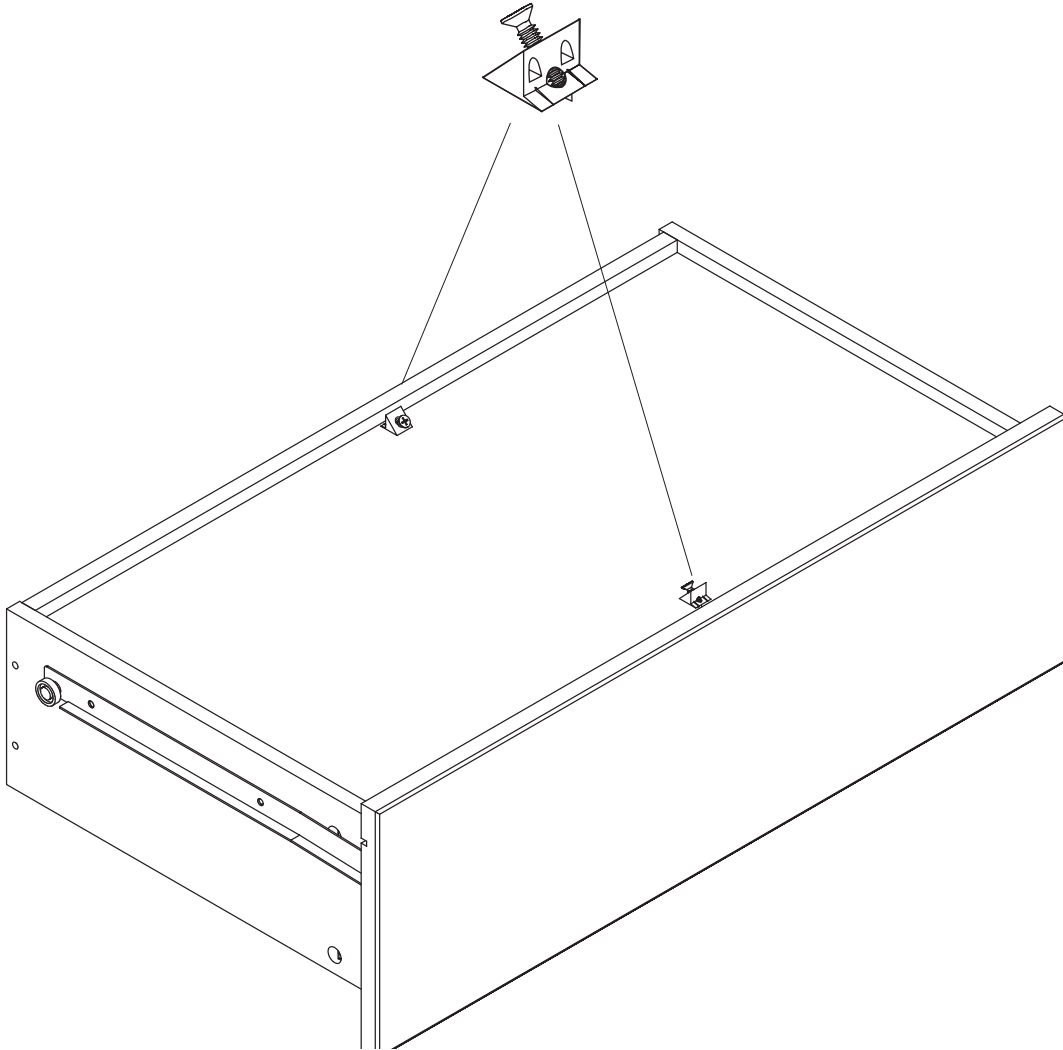

20

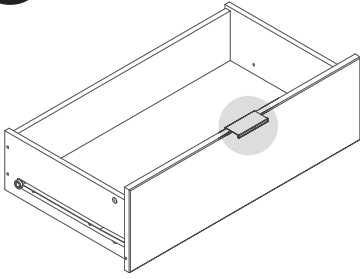

RM-0908-B

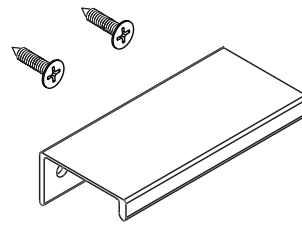

1X

▲ WARNING	
	<p>Children have died from furniture tipover. To reduce the risk of furniture tipover:</p> <ul style="list-style-type: none">• ALWAYS install tipover restraint provided.• NEVER put a TV on this product.• NEVER allow children to stand, climb or hang on drawers, doors, or shelves.• NEVER open more than one drawer at a time.• Place heaviest items in the lowest drawers. <p><i>This is a permanent label. Do not remove!</i></p>
	

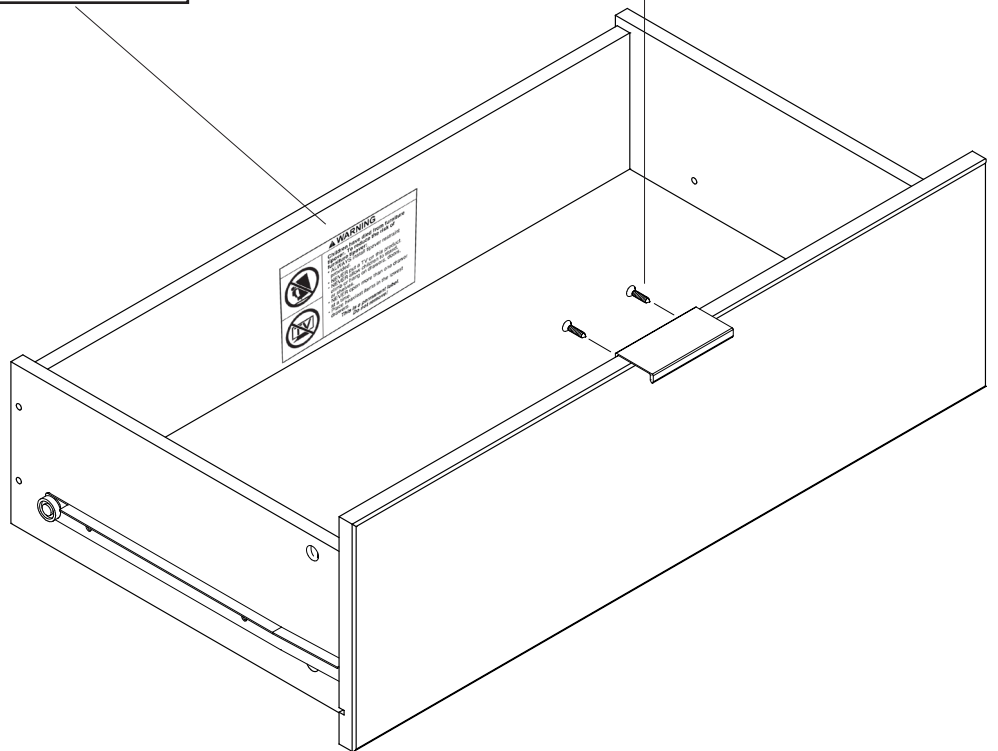
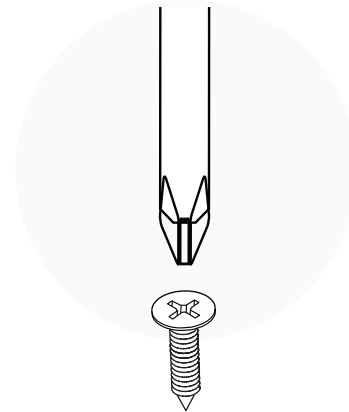

6X



Repeat step 14–20 for 6 drawers

Répétez l'étape 14–20 pour 6 tiroirs

Repita los pasos 14–20 para 6 cajones

21

Red Wheels for the right side

Roues rouges pour le côté droit

Ruedas rojas para el lado derecho

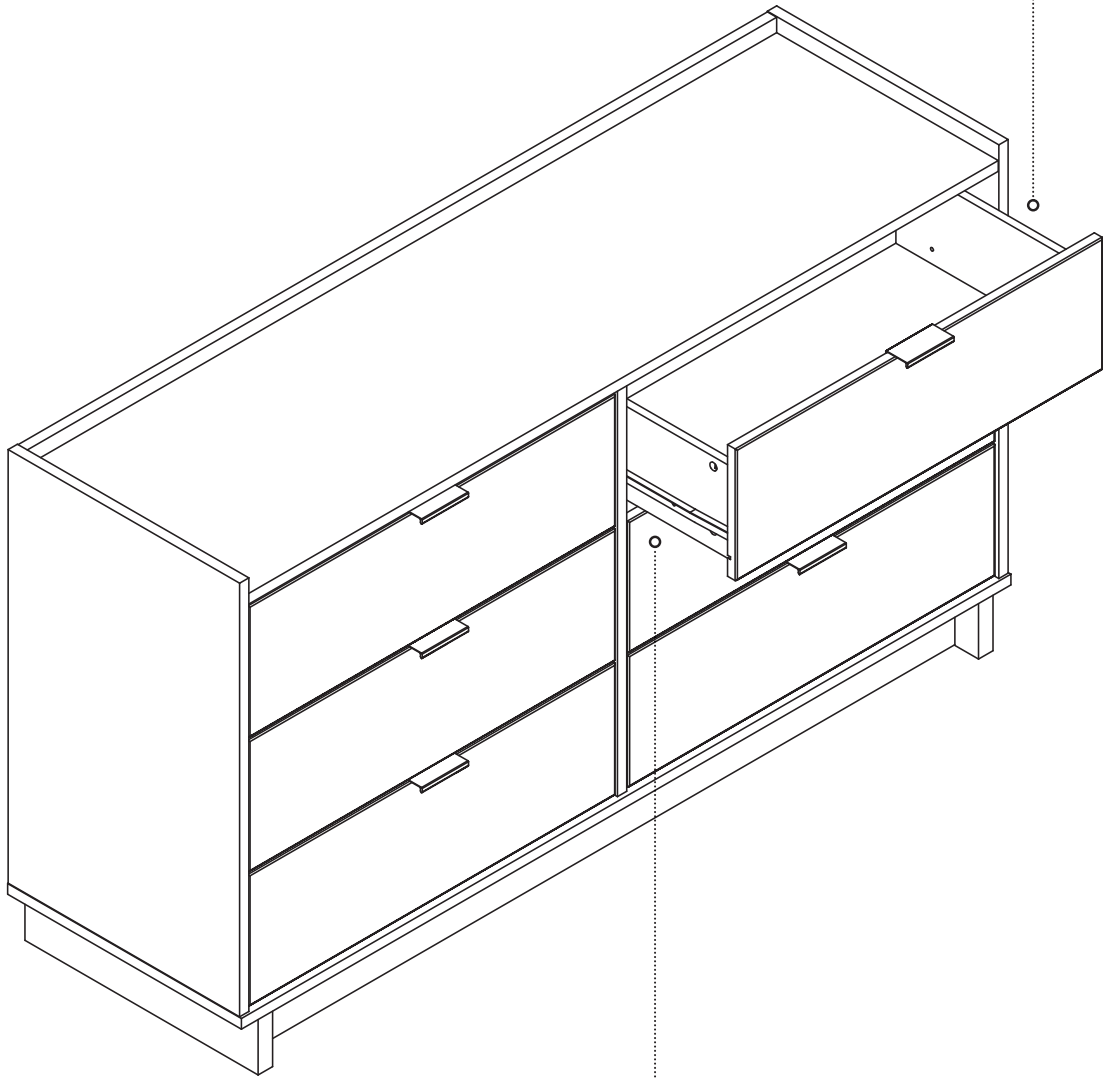
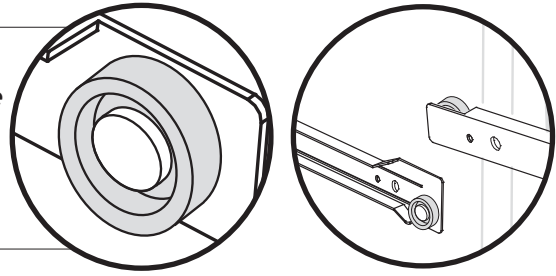

Blue Wheels for the left side

Roues bleues pour le côté gauche

Ruedas azules para el lado izquierdo

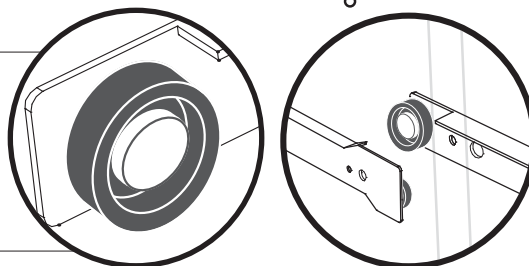

All done!
Good job!

Tout est fait! Bon travail!

¡Todo listo! ¡Buen trabajo!

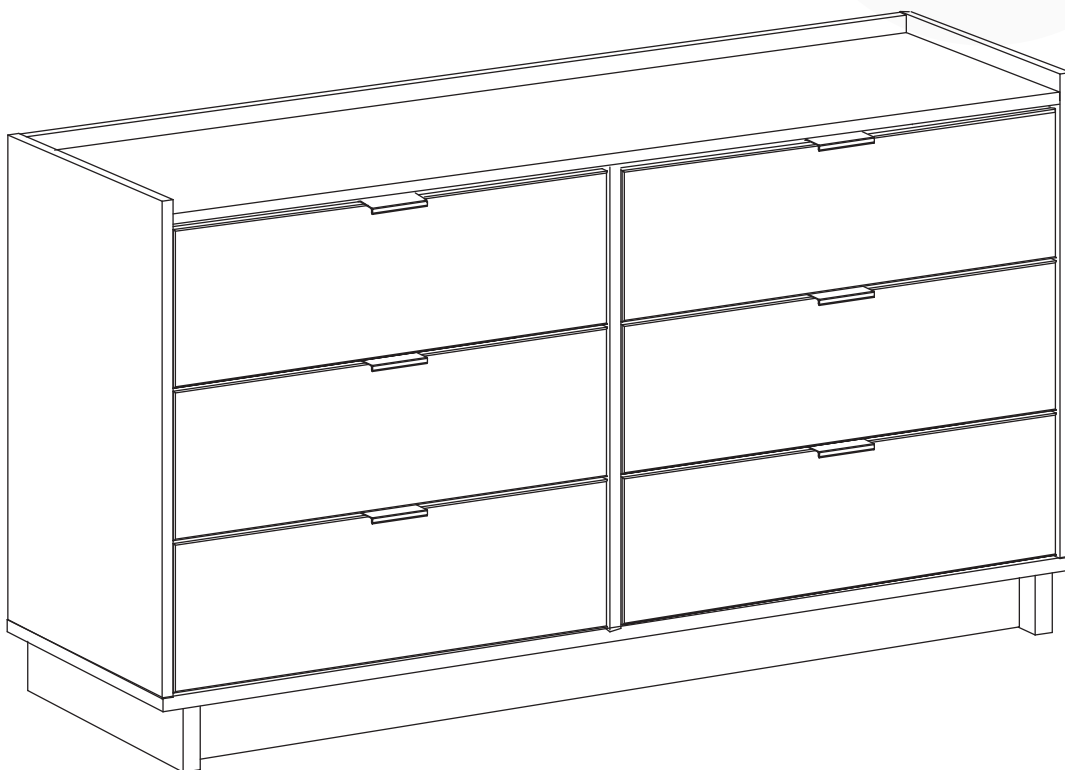

Tipover Restraint Device

Fixation du dispositif de retenue
Instalando la correa de seguridad

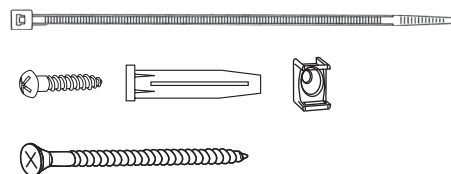

HP-1088

Safety Notice

We recommend anchoring furniture in homes where children live or visit and has included an easy to install safety device. Please make sure that it is installed according to the following instructions.

Noticia de seguridad

recomienda anclar muebles en hogares donde viven niños o ellos visitan.

ha incluido un dispositivo de seguridad de facil instalacion. Por favor seguresse de que esta instalado de acuerdo a las siguientes instrucciones.

Avis de sécurité

recommande l'ancrage des meubles dans les domiciles où habitent ou visitent des enfants, d'où l'inclusion d'un dispositif de sécurité facile à installer.

Veillez vous assurer que ce dernier est installé conformément aux présentes instructions.

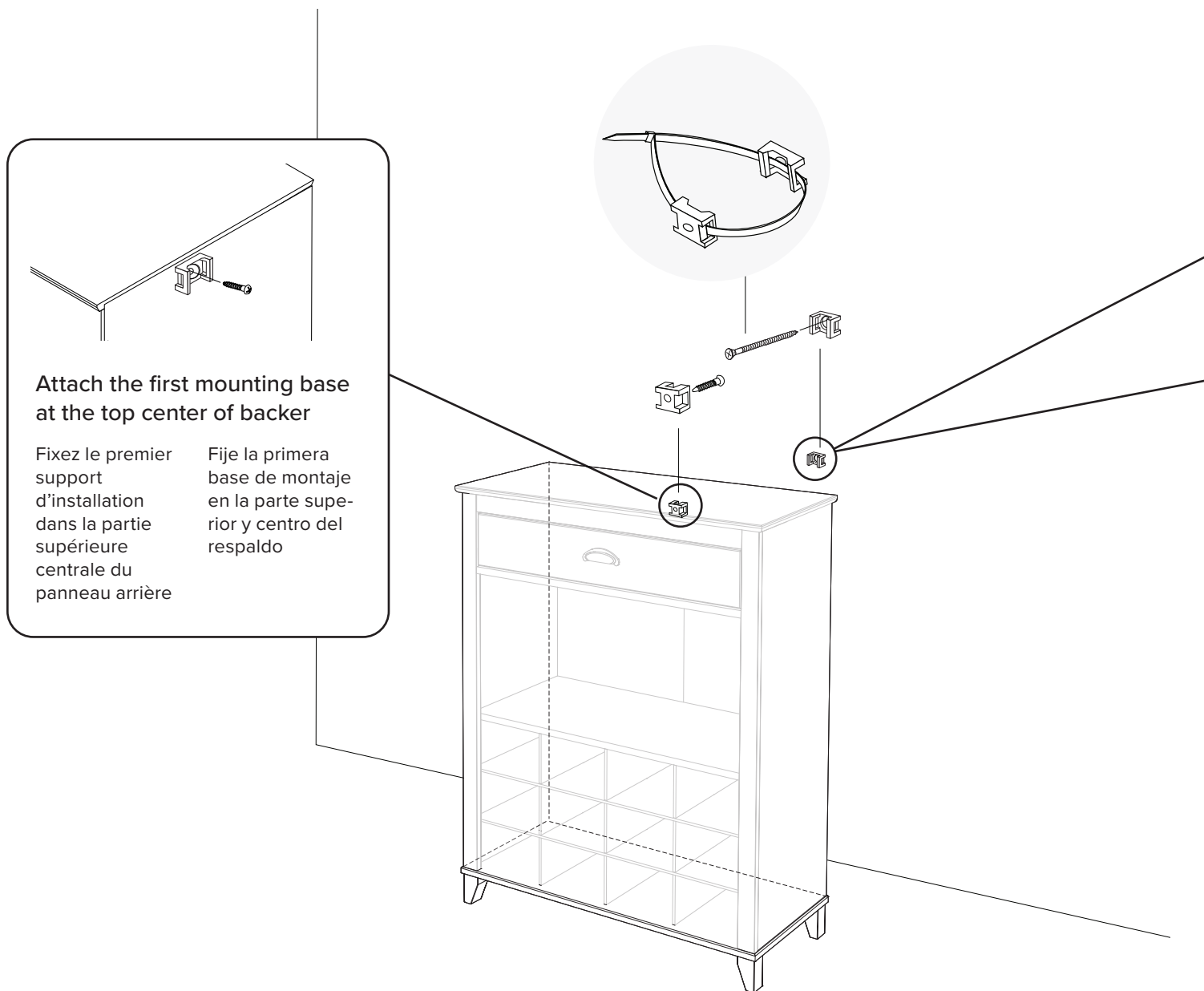

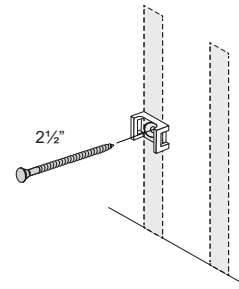
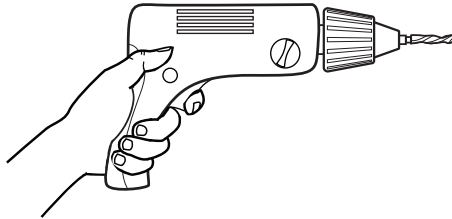
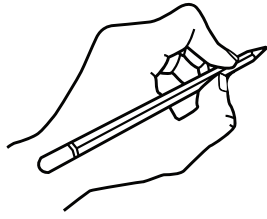

For walls constructed of wood with drywall

Pour les murs en cloison sèche avec montants en bois
Para paredes construidas de madera con paneles prefabricados

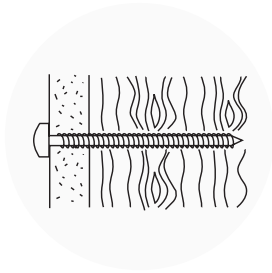

1. With a pencil mark location of second mounting base position
2. Drill pilot hole using an 1/8 inch drill bit 2 inches deep
3. Attach mounting base to wall using the 2 1/2 inch screw provided

1. À l'aide d'un crayon, marquez l'emplacement du deuxième support
2. Percez un avant-trou de 2 po de profondeur avec une mèche de 1/8 po
3. Vissez le support dans le mur à l'aide des vis de 2 1/2 po fournies

1. Con un lápiz marcar la ubicación de la segunda base de montaje
2. Perforar el agujero usando una broca de 1/8 pulgadas 2 pulgadas de profundidad
3. Montar el soporte a la pared utilizando los 2 tornillos de 2 1/2 pulgadas proporcionados

For walls constructed of drywall (unable to hit a stud)

Pour les murs en cloison sèche (où il est impossible de visser dans un montant en bois)
Para muros construidos de drywall (Sin travesaño)

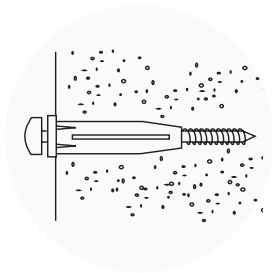

1. Drill pilot hole using a 5/16 inch drill bit only to the depth of drywall thickness
2. Using a rubber mallet or hammer insert wall anchor into drywall
3. Attach holder to wall anchor using 2 1/2 inch screw provided

1. Percez un avant-trou à l'aide d'une mèche de 5/16 po sans dépasser la profondeur de la cloison sèche
2. À l'aide d'un maillet en caoutchouc ou d'un marteau, insérez l'ancrage mural dans la cloison sèche
3. Vissez le support dans l'ancrage mural à l'aide des vis de 2 1/2 po fournies

1. Perforar el agujero utilizando una broca de 5/16 pulgadas solo a la profundidad del grosor del panel de yeso
2. Utilizando un martillo de goma o un martillo insertar el anclaje en pared de yeso
3. Fije el soporte de anclaje a la pared utilizando el tornillo de 2 1/2 pulgadas incluido

For walls constructed of concrete

Pour les murs en béton
Para muros construidos de hormigón

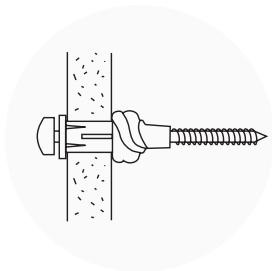

1. Drill pilot hole using a 5/16 inch drill bit 2 3/4 inches deep
2. Using a rubber mallet or hammer insert wall anchor into predrilled hole
3. Attach holder to wall anchor using 2 1/2 inch screw provided

1. Percez un avant-trou de 2 3/4 po de profondeur avec une mèche de 5/16 po
2. À l'aide d'un maillet en caoutchouc ou d'un marteau, insérez l'ancrage mural dans le trou
3. Vissez le support dans l'ancrage mural à l'aide des vis de 2 1/2 po fournies

1. Perforar un agujero de 2 3/4 de profundidad utilizando una broca de 5/16 pulgadas
2. Utilizando un martillo de goma o un martillo insertar el anclaje en el agujero preperforado
3. Fije el soporte de anclaje a la pared utilizando el tornillo de 2 1/2 pulgadas incluido

6-drawer Dresser

Commode 6 tiroirs

Cómoda de 6 cajones

