

# ASSEMBLY INSTRUCTIONS

## NIGHTSTAND

### Step 1

Knobs are attached inside the drawers for safe shipping .Open the drawers and unscrew each knob and turn to face front .

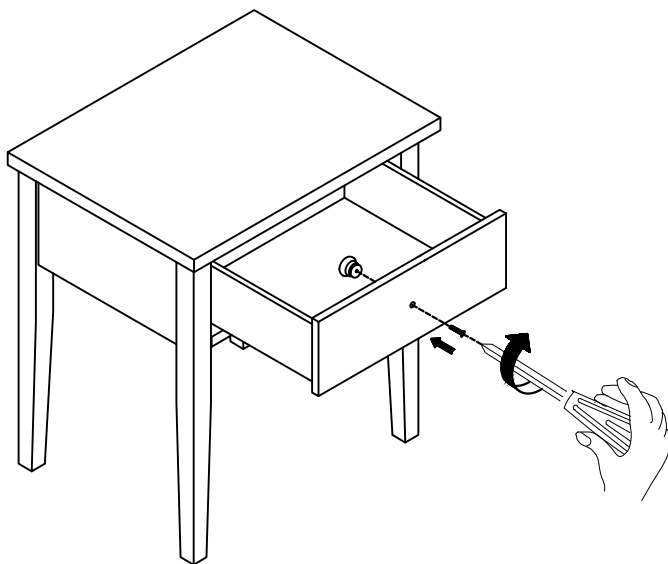

NOTE: Screwdriver (Not Included)

### Step 2

Attach knobs to the drawer's front with included pan head screws as shown below. Tighten with a screwdriver (Not Included)

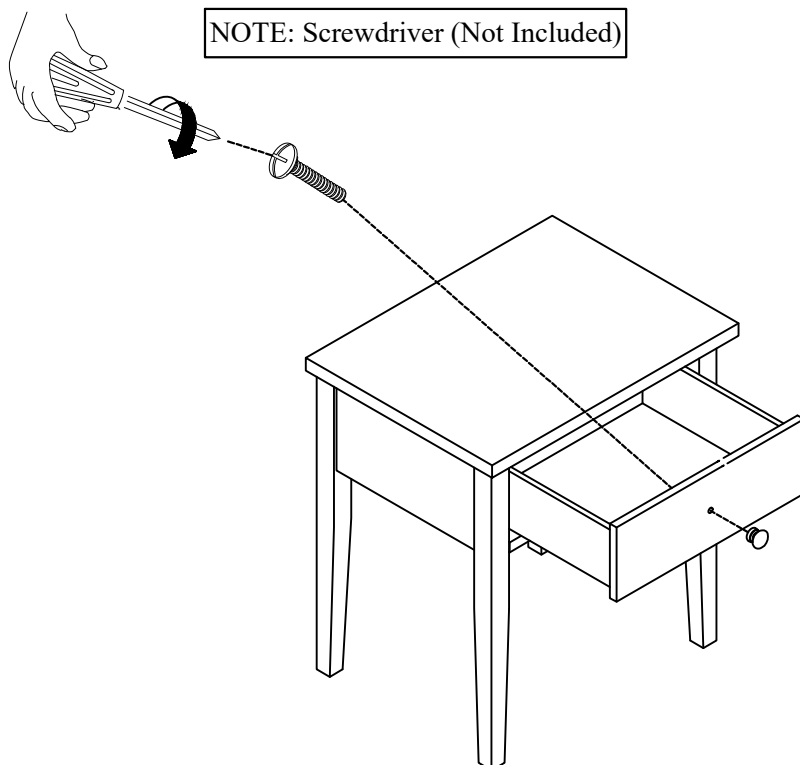

NOTE: Screwdriver (Not Included)