

Features

- *ExoCrylic™*
- *Drop-in or three-wall alcove*
- *Molded lumbar support and armrests for comfort*
- *Optional K-1283 removable apron*
- *Optional K-1491 removable pillow*
- *72" (1829 mm) x 42" (1067 mm) x 20-1/8" (511 mm)*

Codes/Standards Applicable

Specified model meets or exceeds the following:

- *CSA B45.5/IAPMO Z124*

BATH
K-1132
ALSO K-1132-F

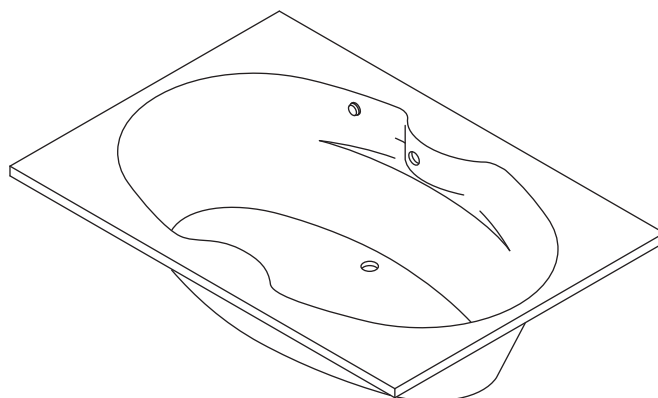

Colors/Finishes

- 0: White
- Other: Refer to Price Book for additional colors/finishes

Accessories

- 0: White
- CP: Polished Chrome
- PB: Vibrant® Polished Brass
- Other: Refer to Price Book for additional colors/finishes

Specified Model

Model	Description	Colors/Finishes	
K-1132	Bath – drop-in (shown)	<input type="checkbox"/> 0	<input type="checkbox"/> Other_____
K-1132-F	Bath – tile flange	<input type="checkbox"/> 0	<input type="checkbox"/> Other_____

Recommended Accessories

K-11677	Swiftflo™ bath drain	<input type="checkbox"/> CP	<input type="checkbox"/> PB
---------	----------------------	-----------------------------	-----------------------------

Optional Accessories

K-1283	Removable apron	<input type="checkbox"/> 0	<input type="checkbox"/> Other_____
K-1491	Removable bath pillow	<input type="checkbox"/> 0	<input type="checkbox"/> Other_____

Product Specification

The ExoCrylic bath shall be 72" (1829 mm) in length, 42" (1067 mm) in width, and 20-1/8" (511 mm) in height. Bath shall be for drop-in [K-1132] or three-wall alcove [K-1132-F] installation. Bath shall feature molded lumbar support and armrests for comfort. Bath shall feature optional K-1283 removable apron and K-1491 removable bath pillow. Bath shall be Kohler Model K-1132-____ or K-1132-F-____.

PROFLEX® 7242

Technical Information

Fixture*:	
Bathing well:	
Basin area, bottom	53" (1346 mm) x 26" (660 mm)
Basin area, top	65" (1651 mm) x 34" (864 mm)
Weight	51 lbs (23.1 kg)
To overflow:	
Water depth	15" (381 mm)
Capacity	78 gal (295.3 L)
* Approximate measurements for comparison only.	
Drop-in cutout	70-1/2" (1791 mm) x 40-1/2" (1029 mm)

Installation Notes

Install this product according to the installation guide.

Floor support under bath must provide for a minimum of 35 lbs/square foot (169 kg/square meter) loading.

The apron must be installed before the finished floor and wall materials are installed.

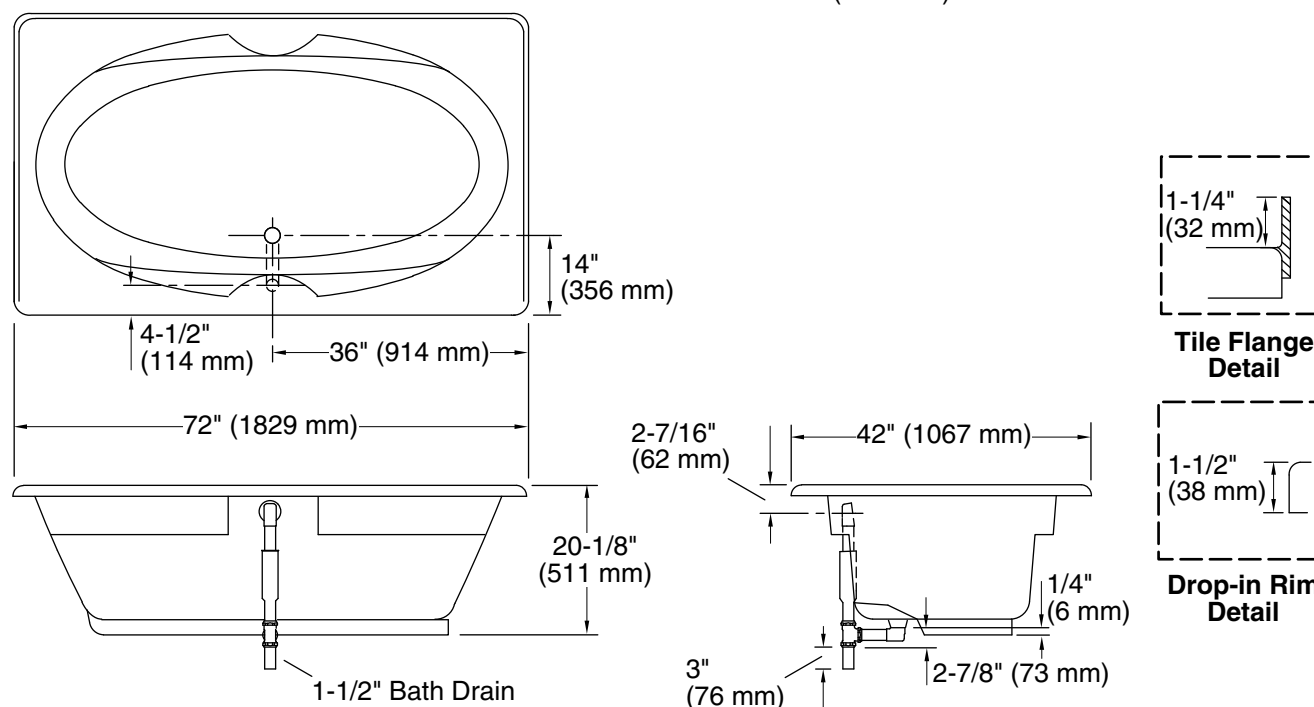

Product Diagram