

POLY & BARK

Assembly Instructions

Padua Bookshelf

V1.10.27.25 | ITEM# LR-K033

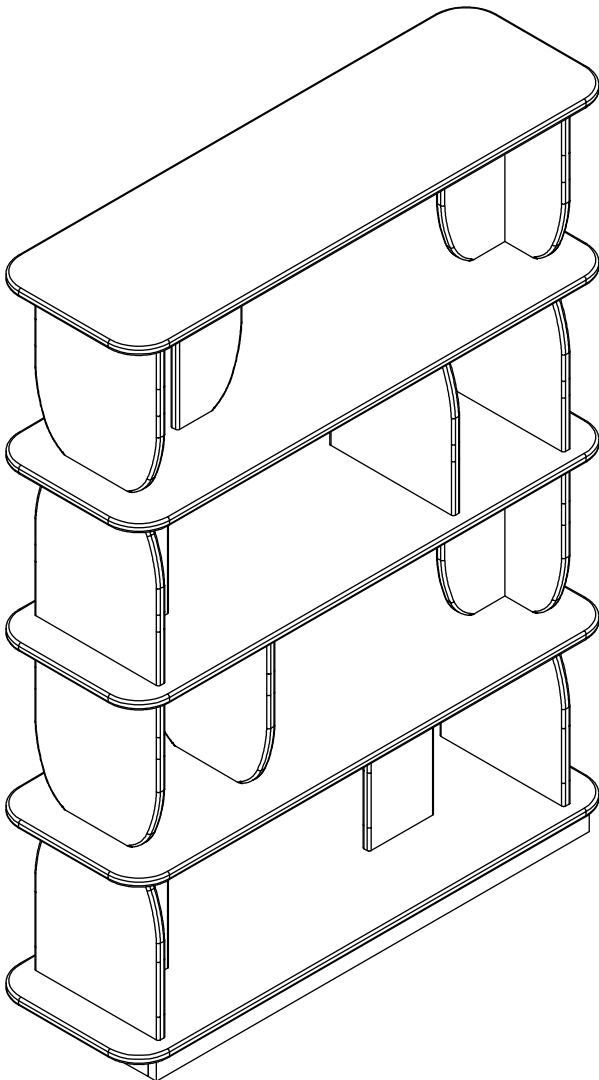

Padua Bookshelf

ASSEMBLY REQUIREMENTS

2 PEOPLE ASSEMBLY | 15 MINUTES ASSEMBLY TIME (APPROXIMATE)

TOOLS REQUIRED: ALLEN WRENCH *(for assembly - provided)*

DRILL, HAMMER, AND PHILLIPS SCREWDRIVER *(for wall anchoring – not provided)*

ASSEMBLY PREPARATION

1. Remove all packaging materials, staples and packaging straps from carton.
2. Refer to Parts Checklist and ensure they are complete before you start assembling.
3. Place all components on a clean, flat and soft surface (e.g., carpet or rug) to prevent parts from getting scratched.

TIPS FOR ASSEMBLY

1. Allow ample room for assembly and in close proximity to where product will be placed.
2. Assemble the product on a surface that does not scratch or damage the exterior and finish of the furniture.
3. During assembly, do not over-tighten any fittings as this may cause damage.
4. **DO NOT USE POWER TOOLS TO ASSEMBLE THIS PRODUCT.**
5. Do not sit or stand on the partially assembled product. Only use the product for which it is intended.
6. This product must be anchored to the wall to reduce the risk of tipping. Use anchors appropriate for your wall construction. If unsure, consult a professional.

CARE AND USE

- Recommended for indoor and residential use only.
- Please exercise caution when placing food or drinks on the surface. Use of a coaster or placemat is highly recommended to avoid damage to surface.
- Never allow any kind of liquid to remain on your furniture. Absorption can cause surface to warp or delaminate.
- Do not place hot items (e.g., hot drinks) directly onto the surface.
- Wipe with a soft, dry cloth. Do not use harsh abrasives or household cleaners as they may damage the finish.
- Check all the fittings periodically and re-tighten as necessary. Do not use the product if any of the parts are damaged or broken.
- Distribute weight evenly. Heavier items on lower shelves. Do not climb or allow children to climb.
- Do not drag and/or pull the furniture.

SAFETY PRECAUTIONS: 1. KEEP ALL HARDWARE PARTS OUT OF REACH OF CHILDREN. 2. DISPOSE OF PLASTIC PACKAGING MATERIAL IMMEDIATELY TO AVOID ANY RISK OF SUFFOCATION TO CHILDREN AND ANIMALS.

PARTS CHECKLIST

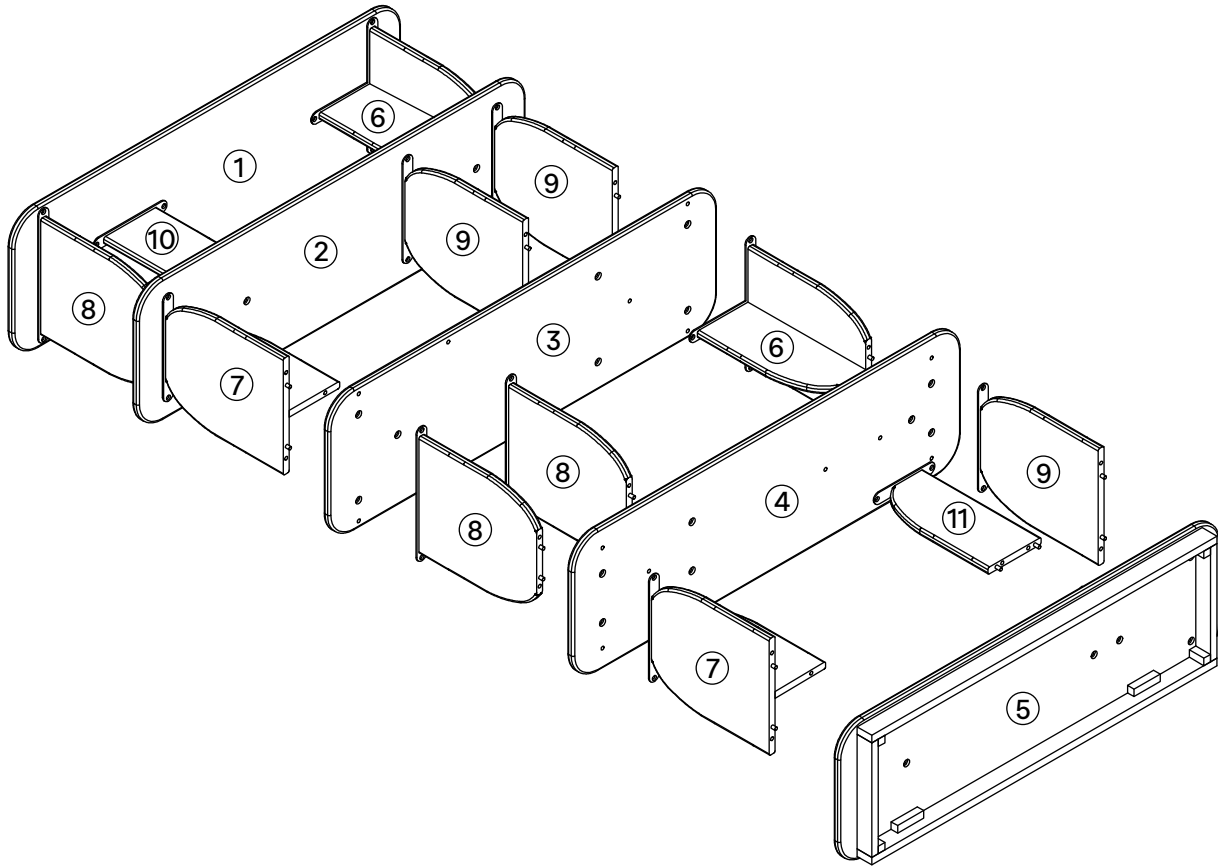

- | | | |
|---|--|--|
| <p>① Top Panel</p> <p>② Top Middle Panel</p> <p>③ Center Panel</p> <p>④ Bottom Middle Panel</p> | <p>⑤ Bottom Panel</p> <p>⑥ x2 Right Support Panels</p> <p>⑦ x2 Left Support Panels</p> <p>⑧ x3 Left Support Panels</p> | <p>⑨ x3 Right Support Panels</p> <p>⑩ Divider Board</p> <p>⑪ Divider Board</p> |
|---|--|--|



Allen Wrench



x27 Bolts
(ø1/4"x30mm)



x28 Crush Washers
(ø6x12mm)



x29 Washers
(ø6x16mm)



x29 Bolts
(ø1/4"x15mm)

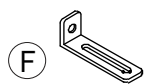

Metal Plate
(70x20mm)

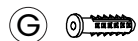

Anchor
(ø9x35mm)



Screw
(M4x30mm)



x4 Levelers
(20x20mm)

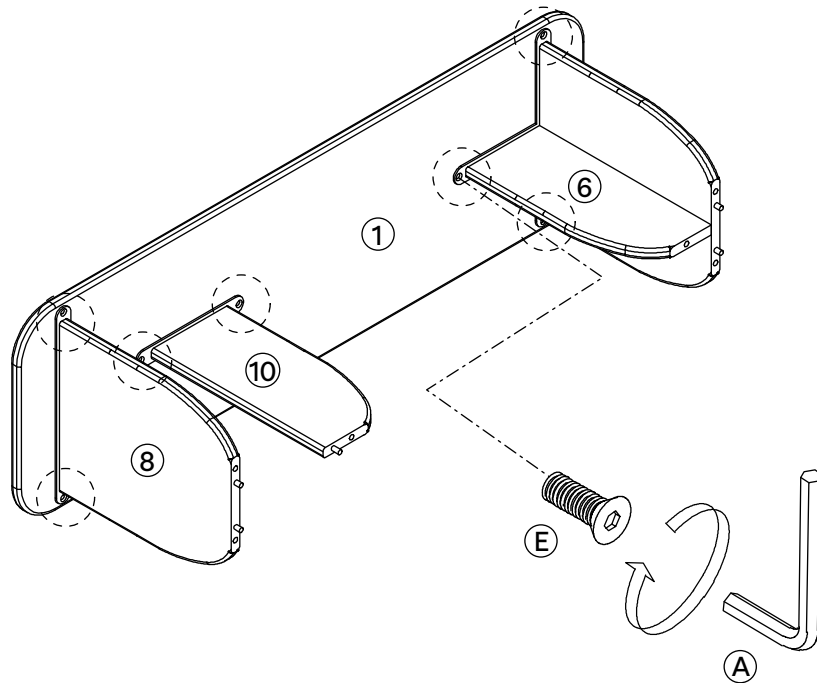

STEP 1.

Attach the Support Panels (6), (8), and Divider Board (10) to the Top Panel (1) using Bolt E. Hand-tighten first, then fully tighten with Allen Wrench A.

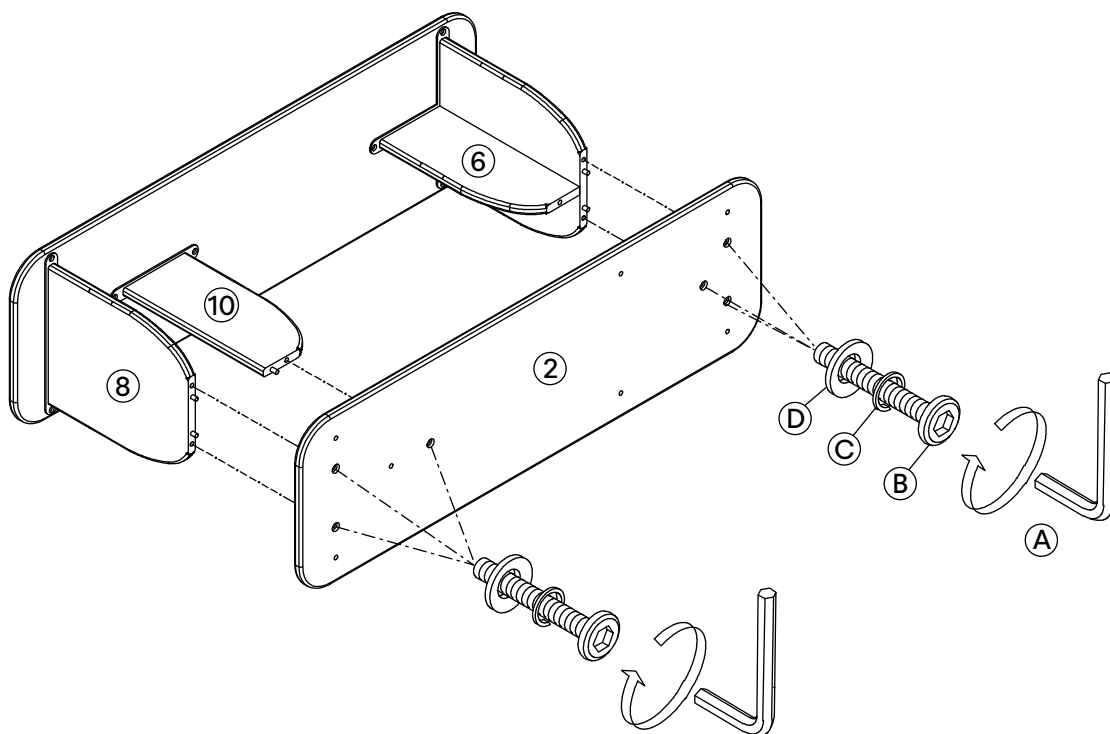

STEP 2.

Attach the Top Middle Panel (2) to the Support Panels (6), (8), and Divider Board (10) using Bolt B, Crush Washer C, and Washer D. Hand-tighten first, then fully tighten with Allen Wrench A.

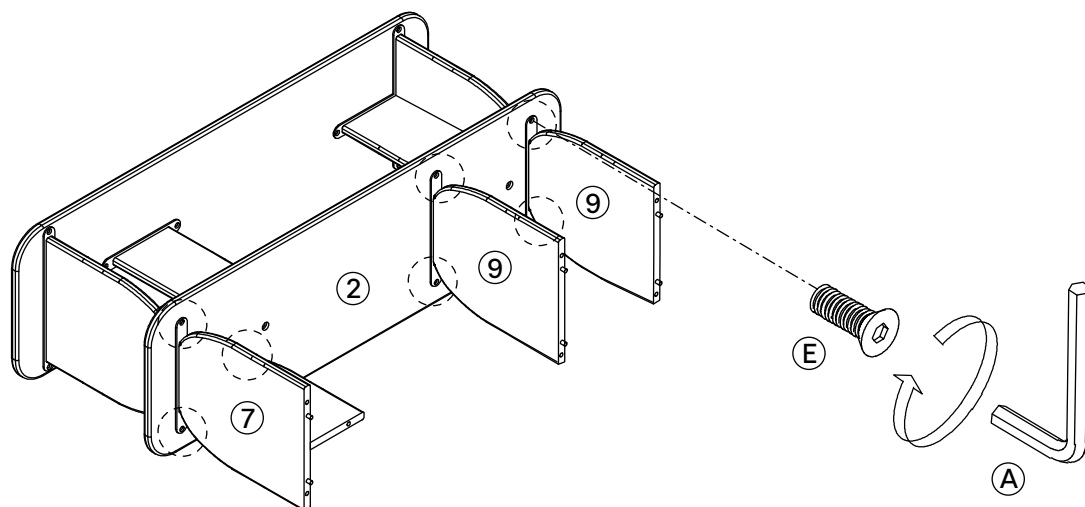

STEP 3.

Attach the Support Panels (7) and (9) to the Top Middle Panel (2) using Bolt E. Hand-tighten first, then fully tighten with Allen Wrench A.

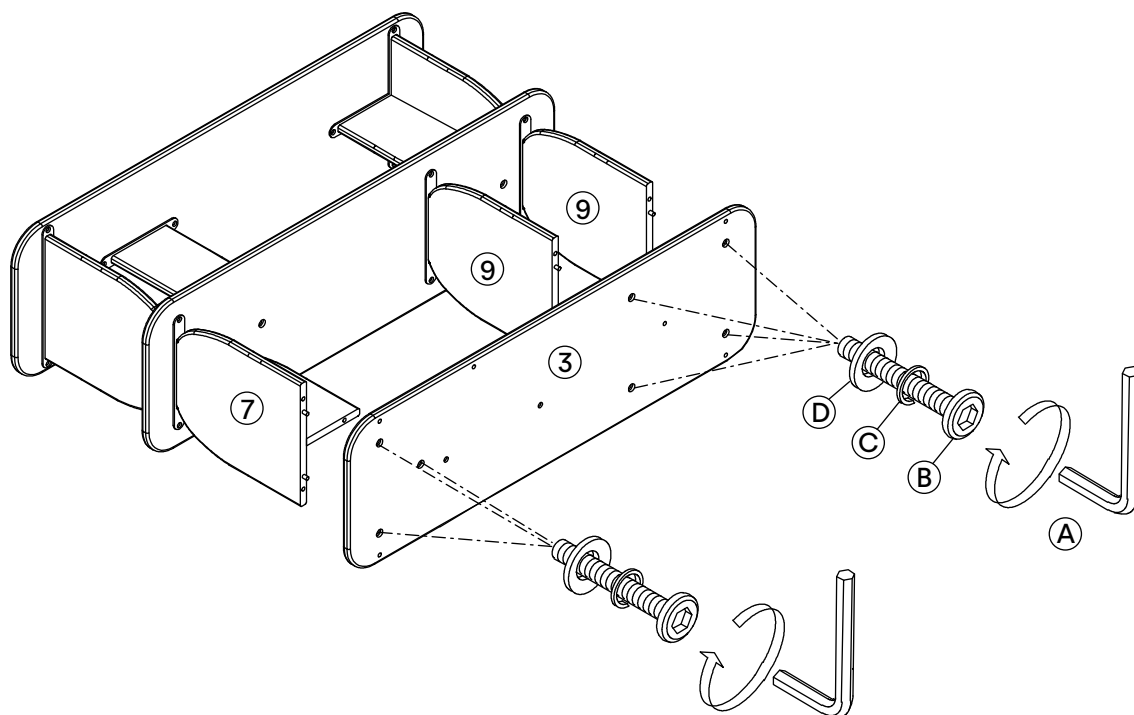

STEP 4.

Attach the Center Panel (3) to the Support Panels (7) and (9) using Bolt B, Crush Washer C, and Washer D. Hand-tighten first, then fully tighten with Allen Wrench A.

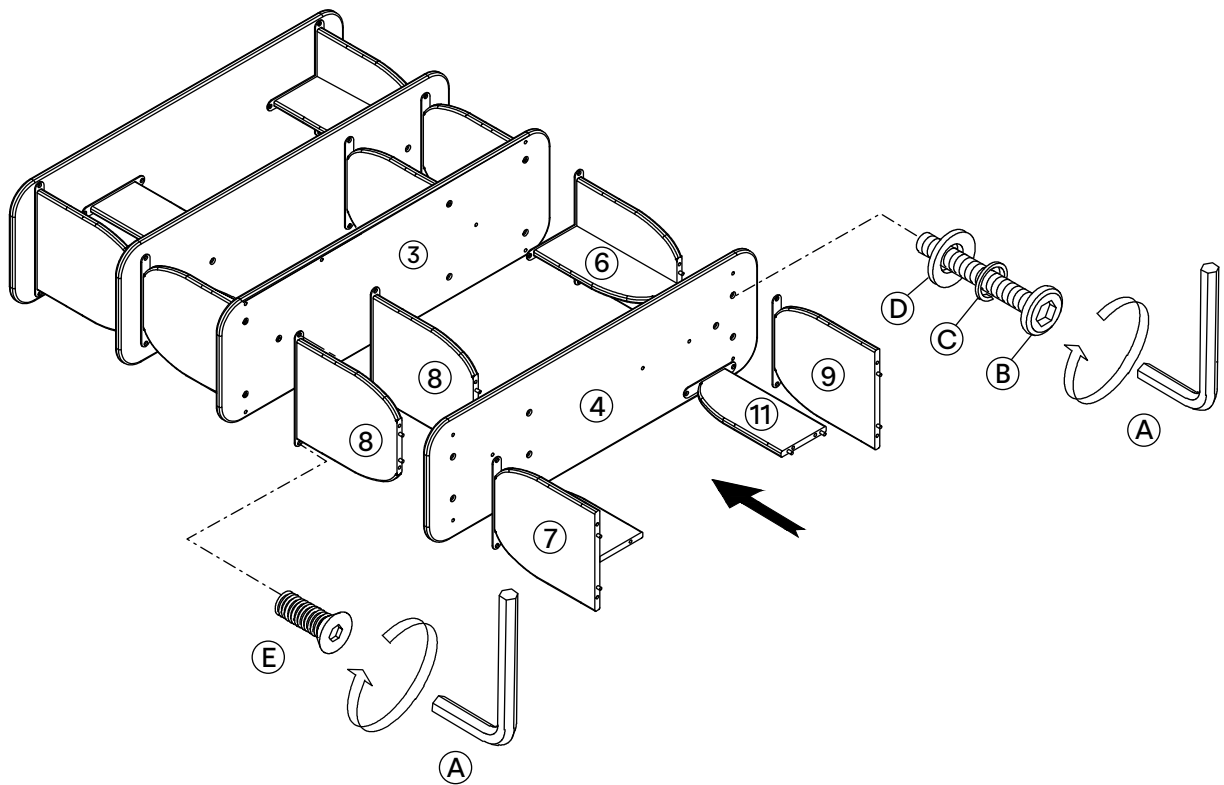

STEP 5.

Repeat Steps 1 – 3 to assemble the remaining sections of the bookshelf, as shown.

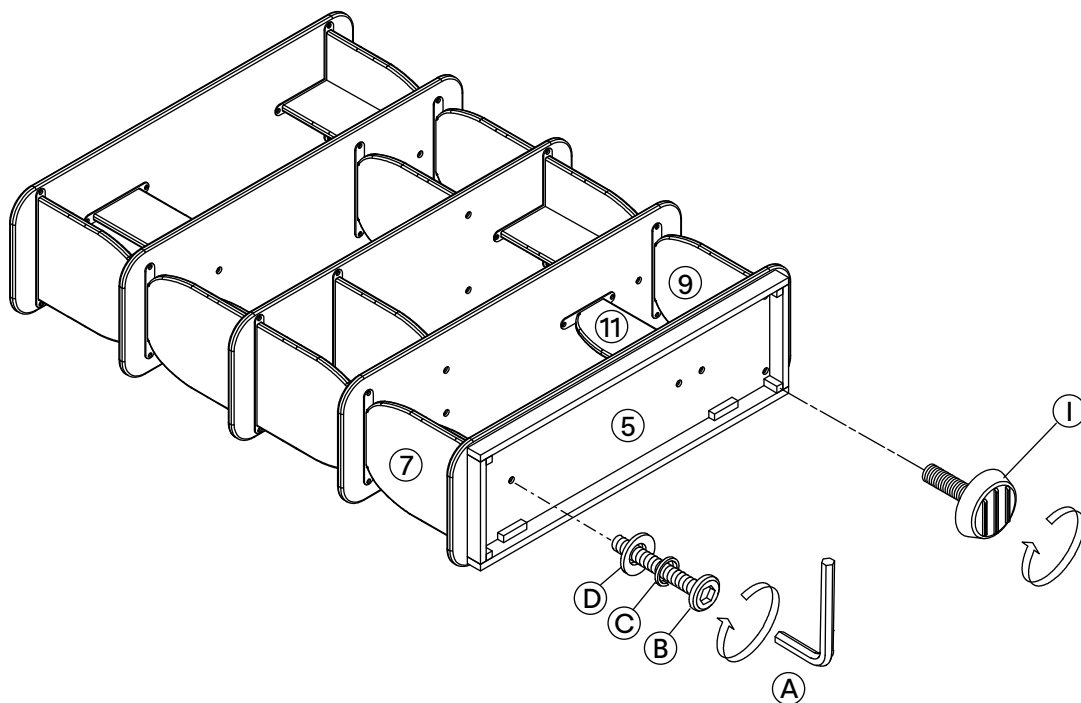

STEP 6.

Attach the Bottom Panel (5) to the Support Panel (7), (9) and Divider Board (11) using Bolt B, Crush Washer C, and Washer D. Hand-tighten first, then fully tighten with Allen Wrench A. Insert Levelers I into the Bottom Panel (5) by turning them clockwise. To adjust the height, turn the levelers counterclockwise to extend their length as needed.

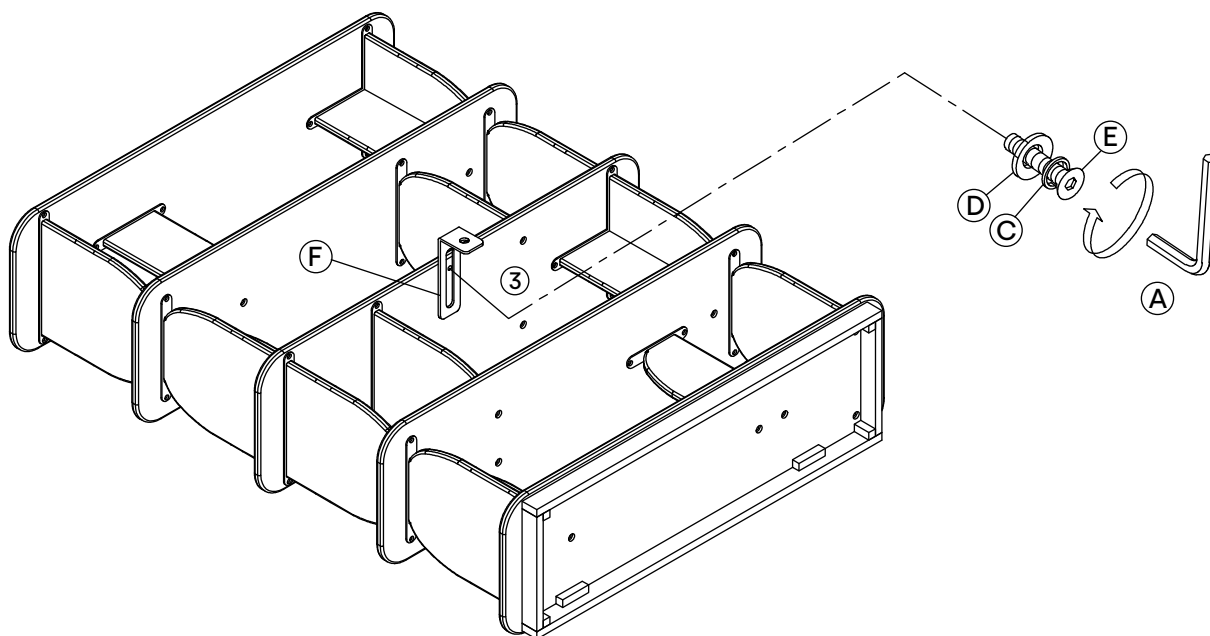

STEP 7.

Attach Metal Plate **F** to the Center Panel (**3**) using Bolt **E**, Crush Washer **C**, and Washer **D**. Hand-tighten first, then fully tighten with Allen Wrench **A**. With the help of another person, carefully lift and place the bookshelf upright.

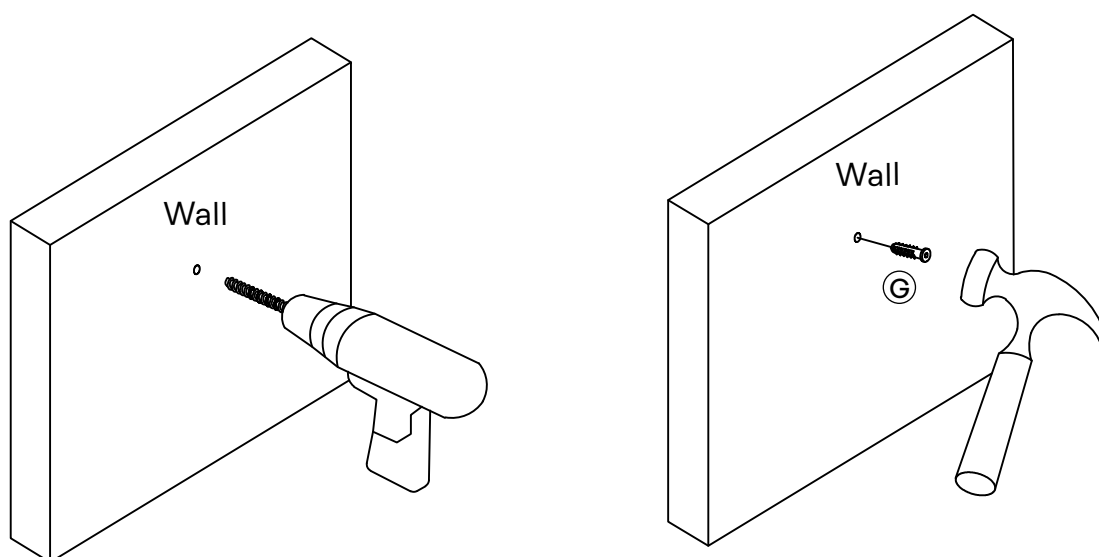

STEP 8.

Measure the height of the Metal Plate **F** and drill a hole in the wall accordingly. Insert Anchor **G** into the hole using a Hammer, as shown.

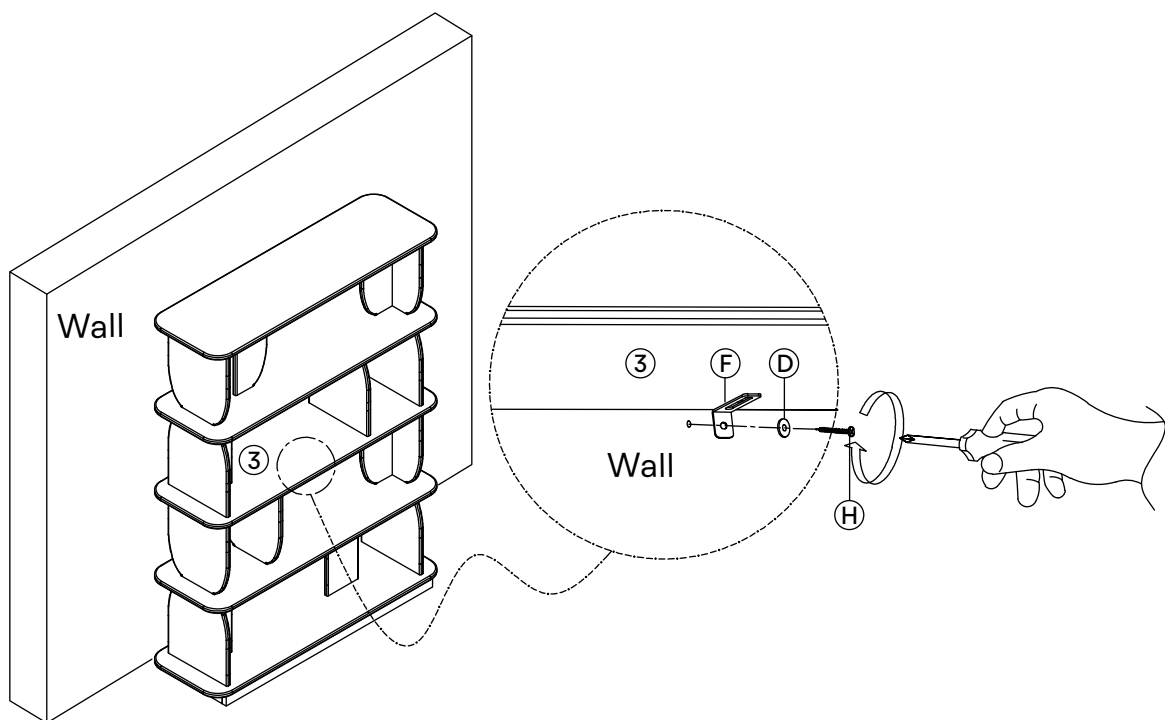

STEP 9.

Attach the shelf to the wall through the Metal Plate **F** using Screw **H**, Washer **D**. Tighten them securely with a Phillips screwdriver.

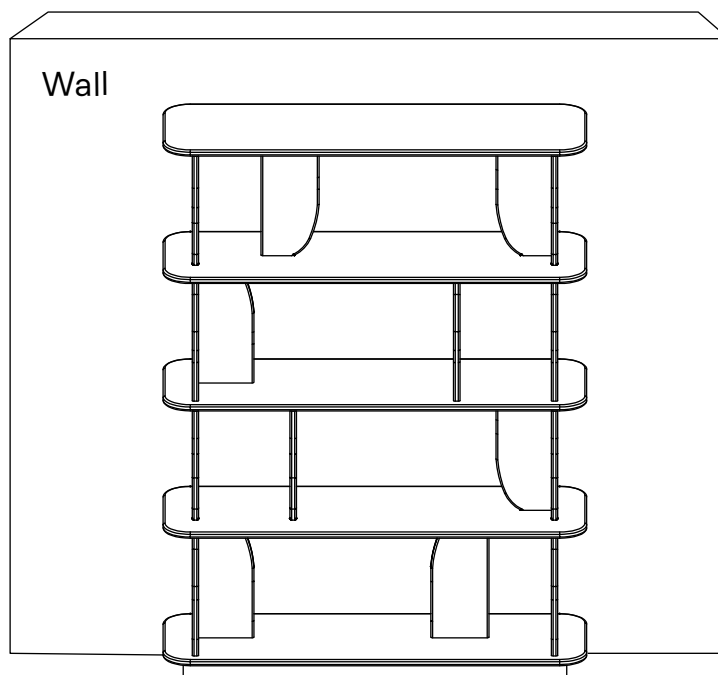

STEP 10.

Admire your hard work! Load your books and decor items onto the shelf, placing heavier items on the lower shelves, and enjoy your new bookshelf!

Missing something?

We work very hard to ship a perfect product but sometimes furniture or hardware goes missing or gets damaged in transit.

Please contact us and we'll quickly make it right.



Need some help? Our support team is here for you.

 help@polyandbark.com

 1 (855) 310-1450

 polyandbark.com