

Mobile Easel TV Stand with Shelf

SKU: STAND-TV75R/B

Instruction Manual

Assembly Video & Product Info
www.vivo-us.com/products/stand-tv75r



! CAUTION! !

If you do not understand these directions, or if you have any doubts about the safety of the installation, please contact our product support team at 309-278-5303 or help@vivo-us.com for further assistance. Check carefully to make sure there are no missing or defective parts. Improper installation may cause damage or serious injury. Do not use this product for any purpose that is not explicitly specified in this manual. Do not exceed weight capacity. We cannot be liable for damage or injury caused by improper mounting, incorrect assembly or inappropriate use.



WARNING: CHOKING HAZARD

SMALL PARTS - NOT FOR CHILDREN UNDER 3 YEARS. ADULT SUPERVISION IS REQUIRED.



DO NOT EXCEED WEIGHT CAPACITY

FAILURE TO DO SO MAY RESULT IN SERIOUS INJURY.



TIPOVER WARNING

**SERIOUS OR FATAL CRUSHING INJURIES CAN OCCUR FROM TIPOVER.
TO HELP PREVENT TIPOVER:**

- NEVER ALLOW CHILDREN TO CLIMB, STAND, HANG, OR PLAY ON ANY PART OF TV OR TV CART
- USE TIPOVER RESTRAINT OR ANCHOR STAND TO WALL

USE OF TIPOVER RESTRAINTS MAY ONLY REDUCE, BUT NOT ELIMINATE RISK OF TIPOVER.

We're Here for You

Open **Monday - Friday 7:00am - 7:00pm CST**, our dedicated support team can offer immediate assistance with rapid response times. If any parts are received damaged or defective, please contact us. We are happy to replace parts to ensure you have a fully functioning product.



Give us a Call:
309-278-5303

AVG. RESOLUTION TIME (*within office hrs*): **5M 4S**



Chat Us:
www.vivo-us.com

AVG. RESOLUTION TIME (*within office hrs*): **< 15 M**



Email Us:
help@vivo-us.com

AVG. RESPONSE TIME (*within office hrs*): **1HR 8M**

- 23% within < 15m
- 38% within < 30m
- 61% within < 1hr
- 83% within < 2hr
- 92% within < 3hr

Package Contents

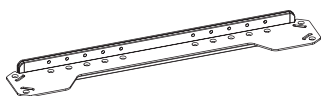

A (x1)
Upper Shelf

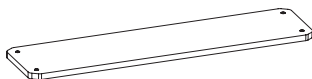

B (x1)
Lower Shelf



C (x4)
Leg

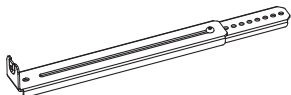

D (x2)
VESA Bracket



E (x4)
Shelf Bracket



F (x4)
Caster



G (x1)
Left Pad



H (x1)
Right Pad

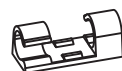

I (x4)
Cable Clip

Included Hardware & Tools



S-A (x2)
M8 Nut



S-B (x4)
M8x16mm Screw



S-C (x4)
ST4.2x12mm Screw



S-D (x2)
M8x12mm Screw



S-E (x2)
M8x30mm Screw



S-F (x4)
M6x12mm
Screw



M-A (x4)
M6x35mm Screw



M-B (x4)
M6x45mm Screw

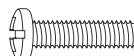

M-C (x4)
M8x35mm Screw

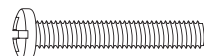

M-D (x4)
M8x50mm Screw



M-E (x4)
M8 Washer



M-F (x8)
Small Spacer



M-G (x8)
Large Spacer



T-A (x1)
5mm Allen Wrench

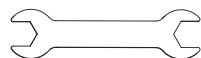

T-B (x1)
Wrench

Tools Needed:



**Phillips
Screwdriver**

Weight Capacity:



**88lbs
(40kg)**

TV



**22lbs
(10kg)**

Shelf

ASSEMBLY STEPS

STEP 1

Install Legs (C) to Upper Shelf (A) using M8x16mm Screws (S-B) and 5mm Allen Wrench (T-A). Remove protective film from Left and Right Pads (G,H) and place them above the previously installed screws.

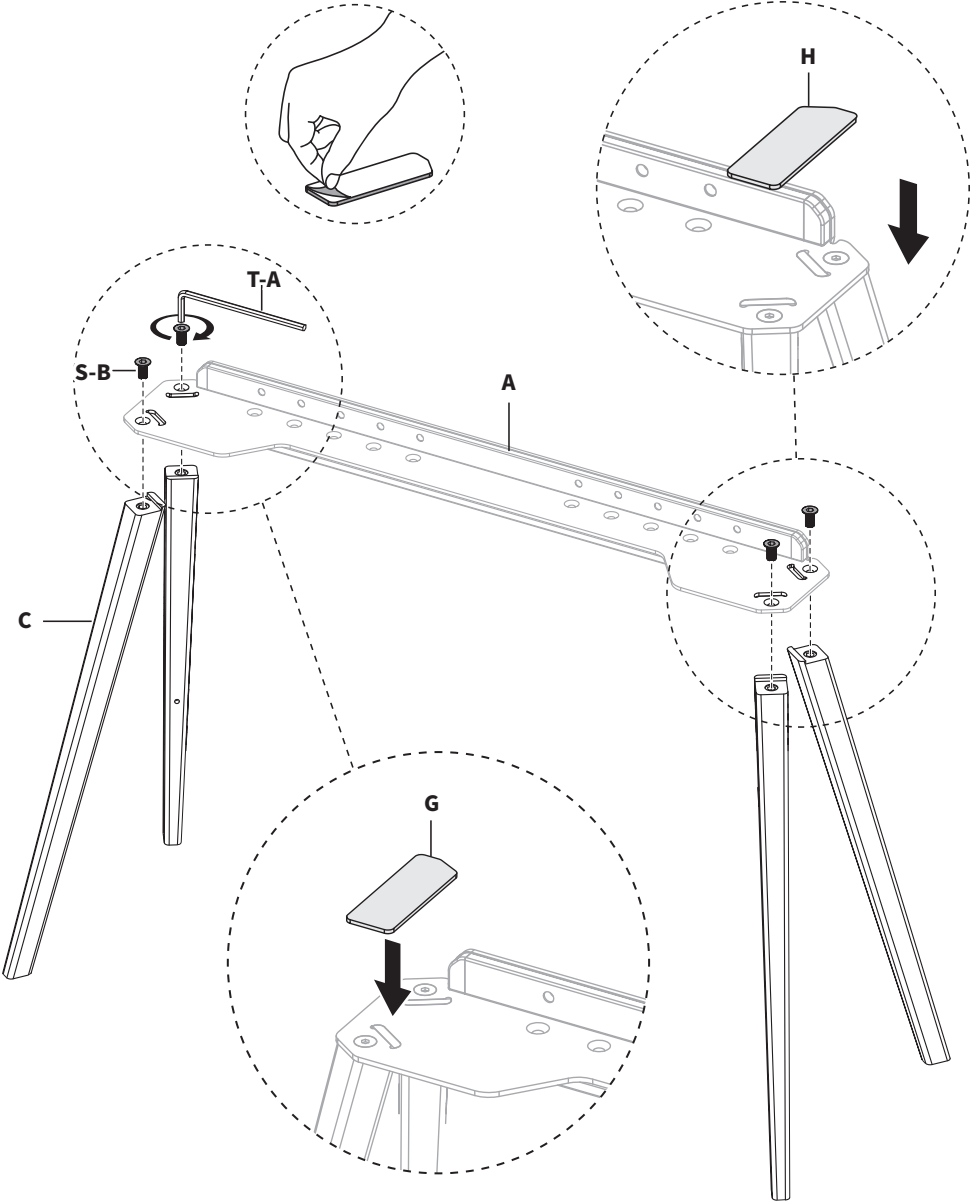

STEP 2

Secure Shelf Brackets (**E**) to the underside of Lower Shelf (**B**) by partially installing M6x12mm Screw (**S-F**) using Phillips screwdriver, leaving a small gap. Screws will be fully secured in a later step.

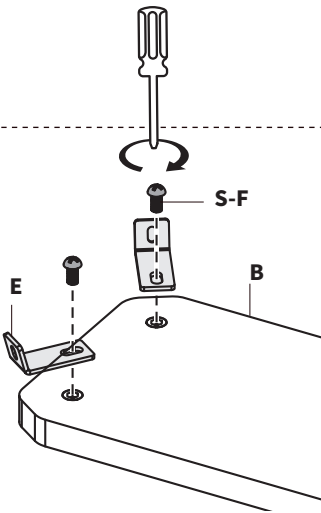
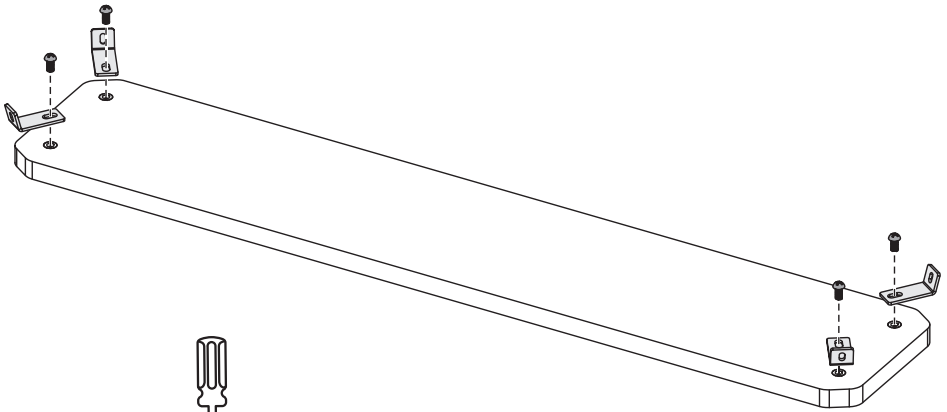

Shelf Brackets should be angled to overhang the Shelf corners, as shown above.

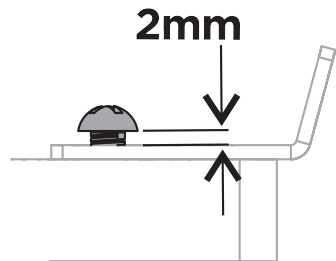

Allow a small gap when securing screws to allow free movement in the brackets; screws will be fully secured in the next step .

STEP 3

Flip assembly over onto a soft surface. Following sub-steps below to secure Lower Shelf (B) to Legs (C).

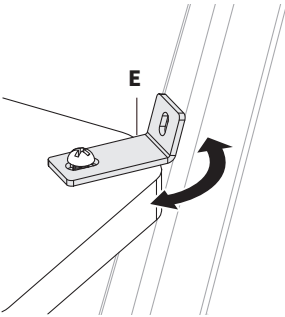
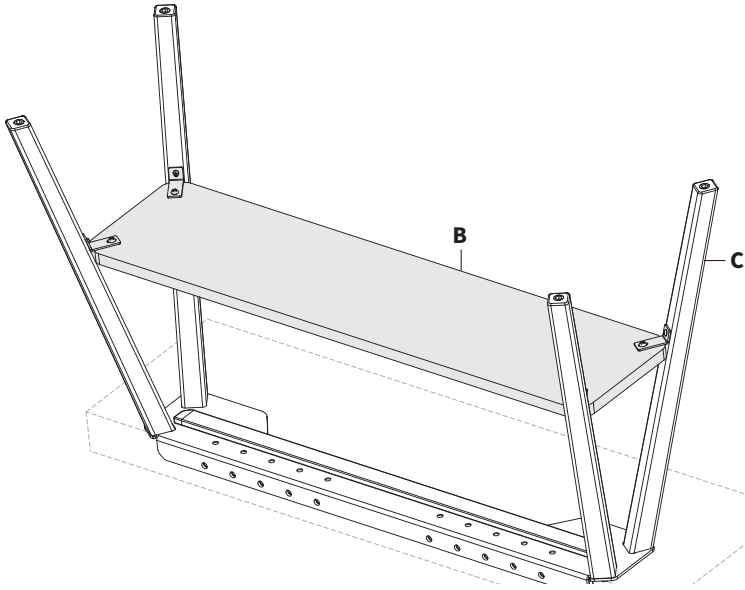

3.1 Align Shelf Brackets (E) with the angle of each Leg (C).

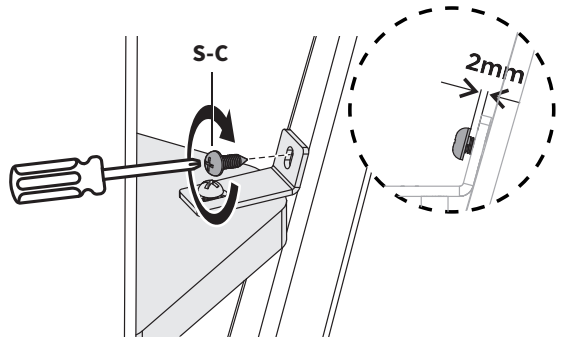

3.2 Secure Shelf Brackets (E) to Legs (C) using ST4.2x12mm Screws (S-C) and a Phillips screwdriver.

3.3 Fully tighten all Screws on each bracket using a Phillips screwdriver.

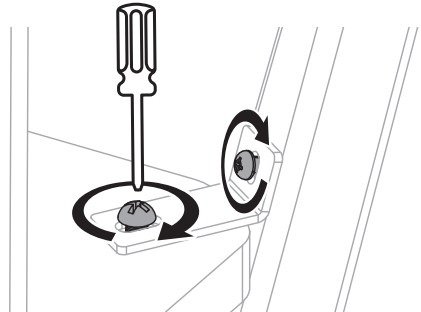

STEP 4

Thread Casters (**F**) into the bottom of Legs (**C**). Tighten Casters (**F**) using Wrench (**T-B**).

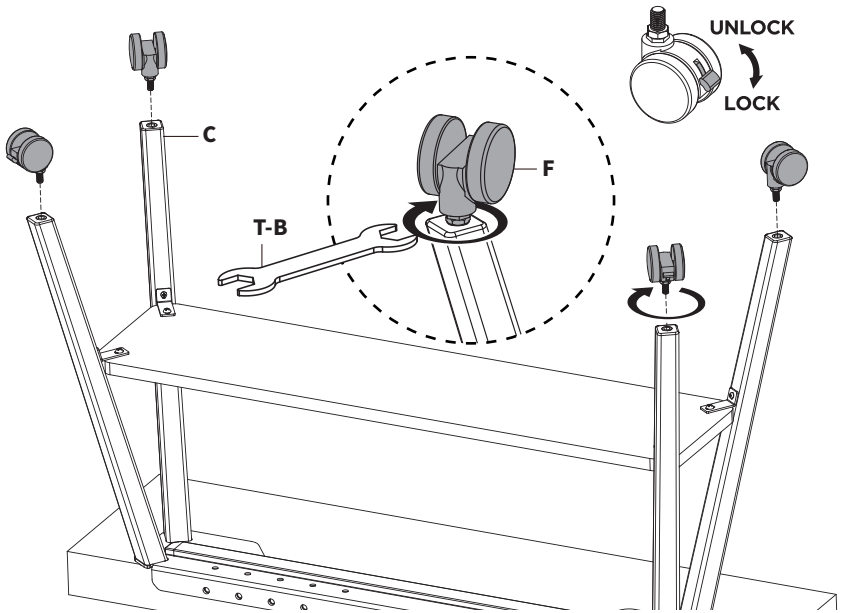

STEP 5

Loosen nuts on VESA Brackets (**D**) using 5mm Allen Wrench (**T-A**) and Wrench (**T-B**). Fully extend VESA Brackets (**D**) and tighten the screws.

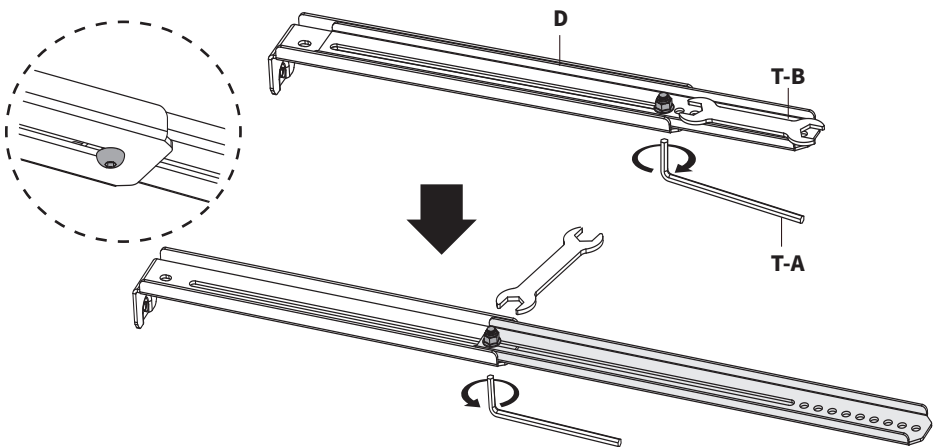

STEP 6

Determine the width of your TV's VESA pattern and use the corresponding holes on Upper Shelf **(A)**.

Install VESA Brackets **(D)** onto Upper Shelf **(A)** using M8x12mm Screws **(S-D)** and 5mm Allen Wrench **(T-A)**. Install M8x30mm Screws **(S-E)** and M8 Nuts **(S-A)** using 5mm Allen Wrench **(T-A)**, and Wrench **(T-B)**.

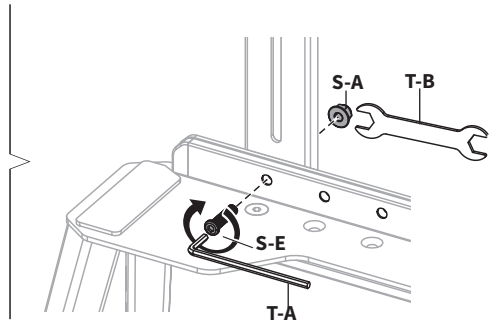
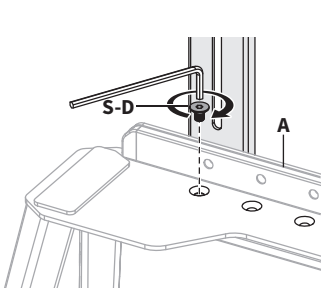
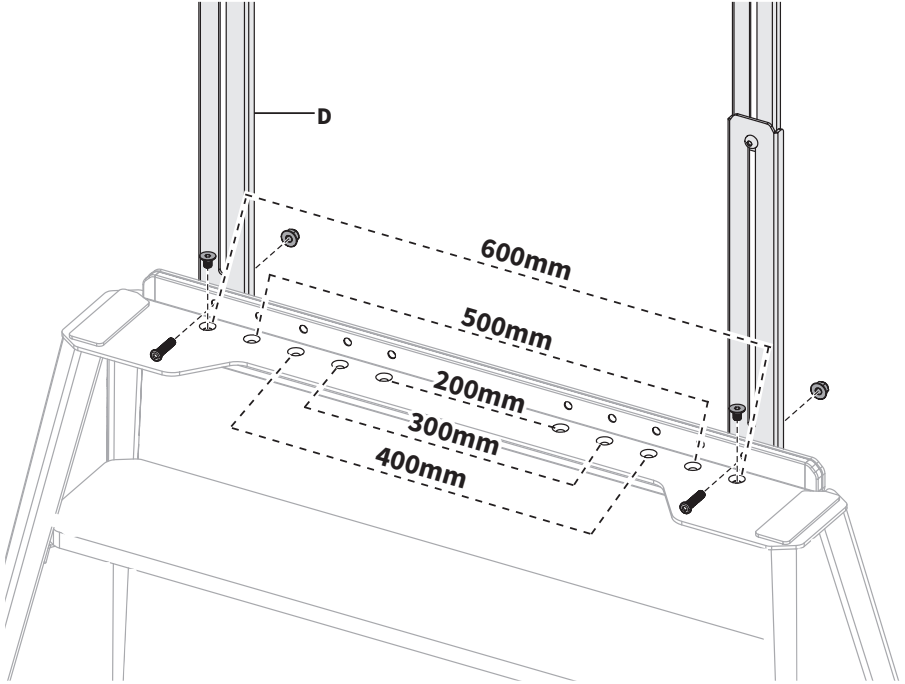

STEP 7

Assemble TV to VESA Brackets (**D**) using Screws (**M-A through M-D**) with M8 Washers (**M-E**) and Spacers (**M-F, M-G**) and Phillips screwdriver.

Install top two holes at desired height then install the bottom two holes.

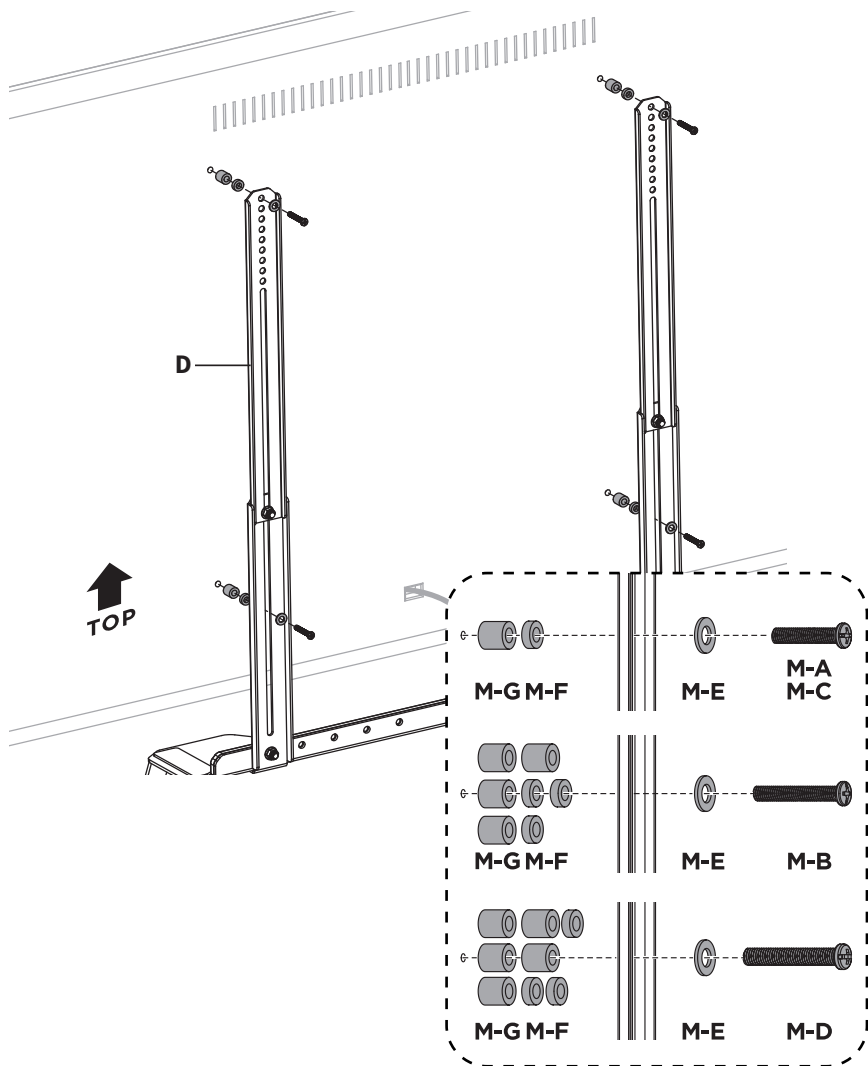

STEP 8

Remove adhesive backing from Cable Clips (**I**) and install them onto the back of Legs (**C**).

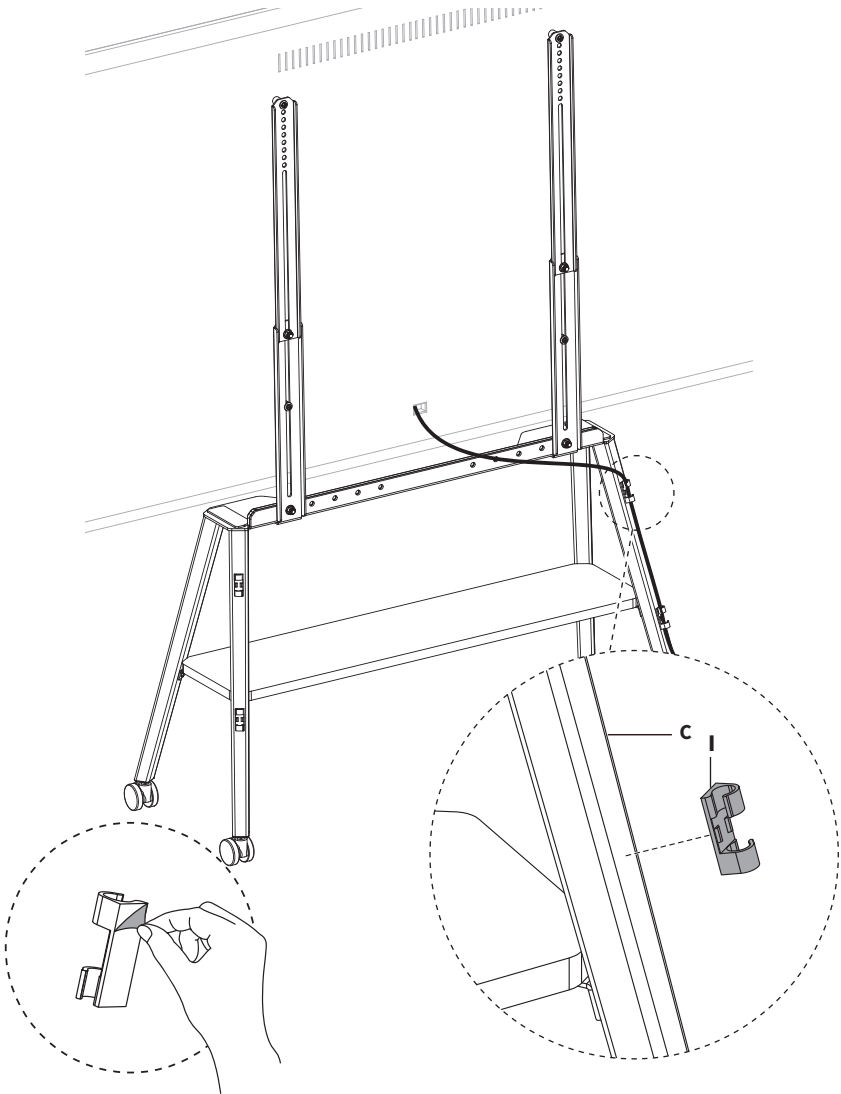

[THIS PAGE HAS BEEN INTENTIONALLY LEFT BLANK]

LAST UPDATED: 03/04/25

REV3.1

STAND-TV75R: v1.3

STAND-TV75RB: v1.0



Need Help? Get In Touch

Monday-Friday from 7:00am-7:00pm CST



help@vivo-us.com



www.vivo-us.com

Chat live with an agent!



309-278-5303



VIVO-us @vivo_us

FOR MORE GREAT VIVO PRODUCTS,
CHECK OUT OUR WEBSITE AT: WWW.VIVO-US.COM