

Fiama Suspension

700FIA24, 700FIA30, SLCH14930, 700FIA48 | 1.1

VISUAL COMFORT & Co.

MODERN COLLECTION

GENERAL PRODUCT INFORMATION:

These fixtures are intended to be installed utilizing NEC compliant junction boxes.



This product is suitable for damp locations.

This product can be dimmed with most ELV, TRIAC, or 0-10V dimmers.

This instruction shows a typical installation.

CAUTION - RISK OF FIRE

This product must be installed in accordance with the applicable installation code by a person familiar with the construction and operation of the product and the hazards involved.

Use minimum 90°C supply conductors.

SAVE THESE INSTRUCTIONS!

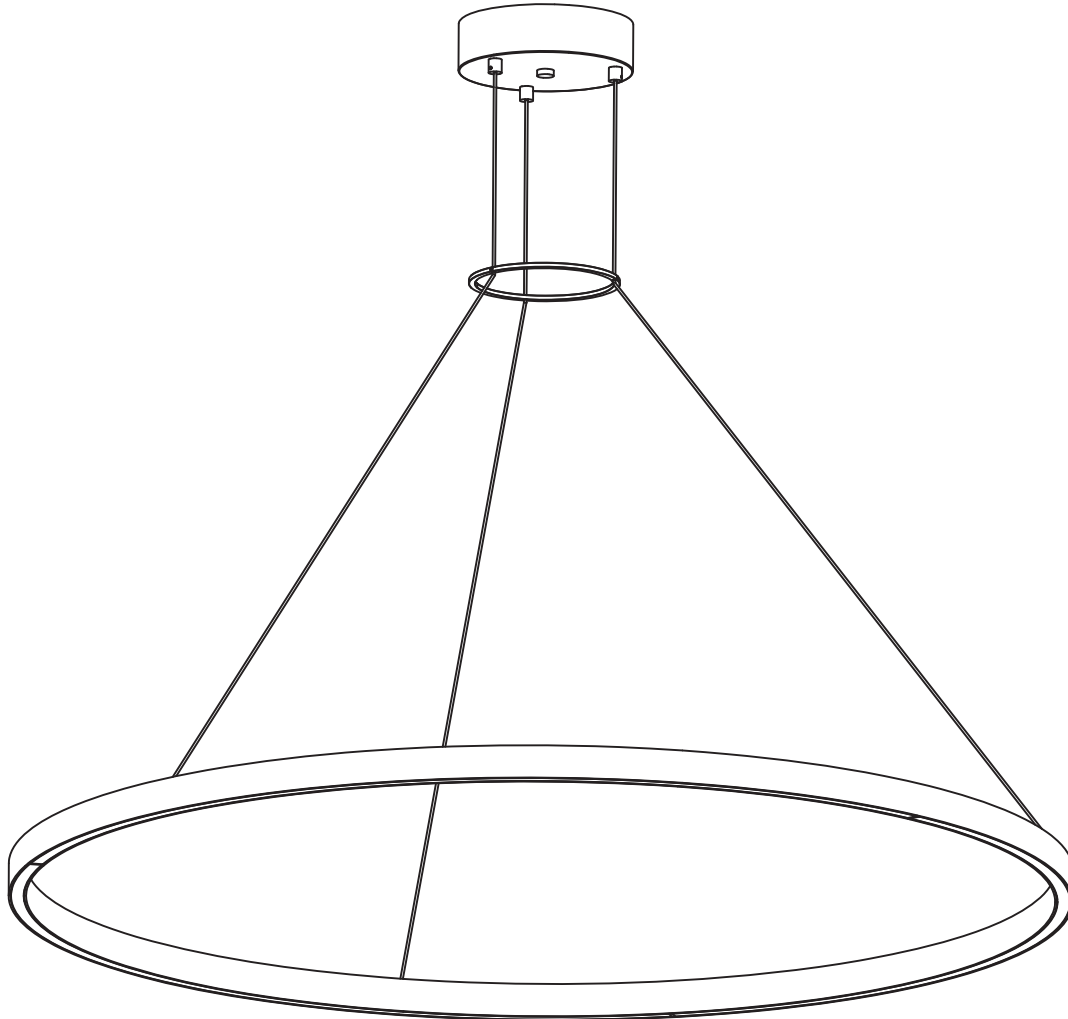

Install the Fixture

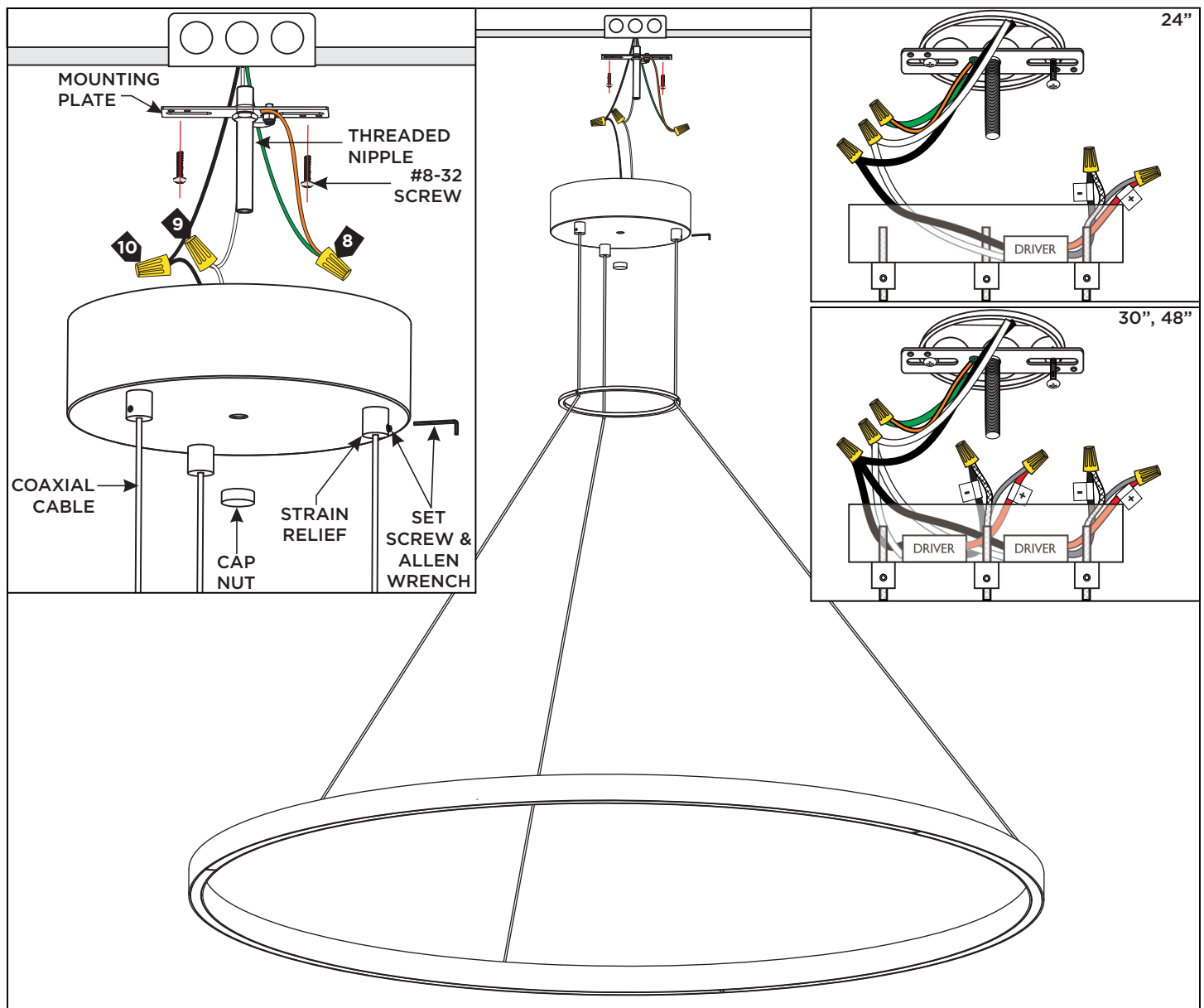

- 1** Separate the mounting plate from the canopy by unscrewing/removing the cap nut from the threaded nipple.
- 2** Secure the mounting plate to the electrical box with the two #8-32 screws provided.
- 3** Place the fixture on a level surface.
- 4** With the provided Allen wrench, loosen (do not remove) the set screws on the strain reliefs.
- 5** Evenly pull the coaxial cables up through the strain reliefs to raise the fixture to the desired height.
NOTE: Take caution to not remove the inner bushing from inside the strain relief while pulling the coaxial cord through.
- 6** Ensure that the canopy is level and re-tighten the set screws on the strain reliefs.
- 7** **SHORTENING THE COAXIAL CORDS (See next page for minimum overall length chart):**
 - A** If shortening of the coaxial cords is necessary, take note of the wire connections from the coaxial cables to the driver(s) and remove the wire nuts.
 - B** Leave 6" behind for wire connections, cut off the excess cord.
 - C** From the end of the cord, strip the insulation 4" using a sharp knife. Make sure not to nick the inner wires.
 - D** Strip the ends of the wires and reconnect the wires to their original connections using the wire nuts.
- 8** Connect the fixture to a suitable ground in accordance with local electrical codes.
- 9** Connect the white driver wire(s) to the neutral power line wire with a wire nut.
- 10** Connect the black driver wire(s) to the hot power line wire with a wire nut.
- 11** Place the canopy onto the threaded nipple and secure it in place by screwing the cap nut onto the threaded nipple.

MINIMUM OVERALL LENGTH (OAL.) CHART

FIAMA 24	FIAMA 30	FIAMA 36	FIAMA 48
Min/Max OAL. Approx. 14"/ 147"	Min/Max OAL. Approx. 17"/ 148"	Min/Max OAL. Approx. 20"/ 148"	Min/Max OAL. Approx. 26"/ 148"
With Choker Ring 9"from Ring to fixture MINIMUM.	With Choker Ring 12"from Ring to fixture MINIMUM.	With Choker Ring 15"from Ring to fixture MINIMUM.	With Choker Ring 21"from Ring to fixture MINIMUM.

