

# Product Installation Instructions

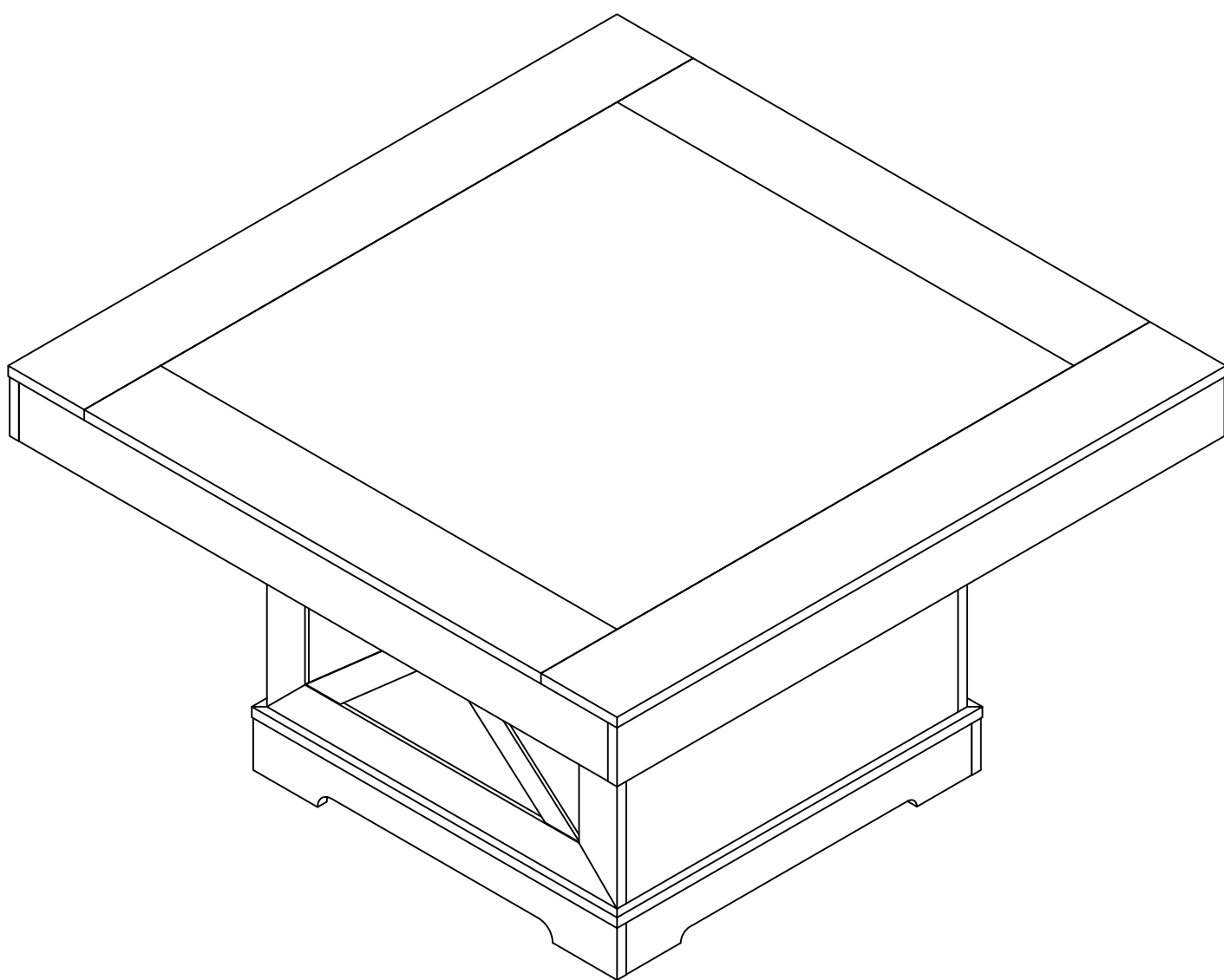

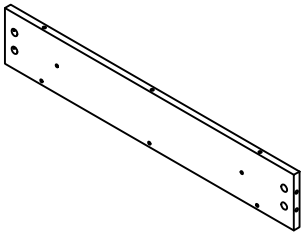

1x2

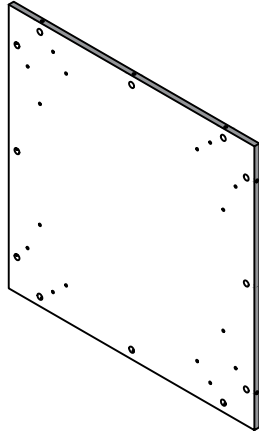

2x1

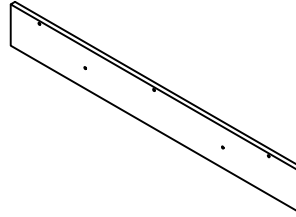

3x2

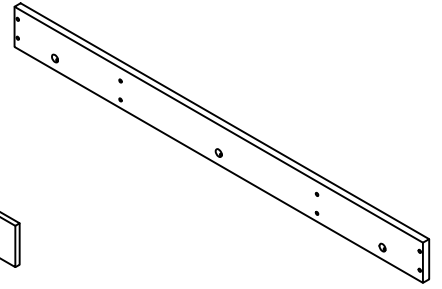

4x2

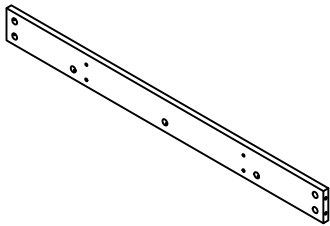

5x2

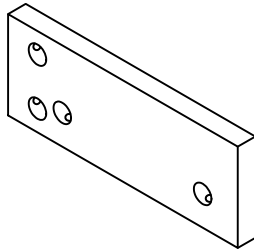

6x8

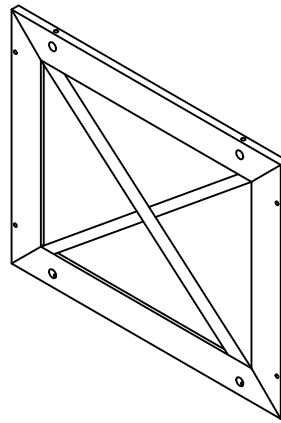

7x2

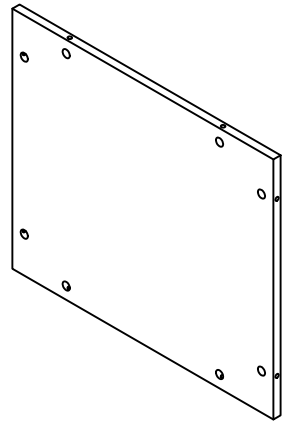

8x2

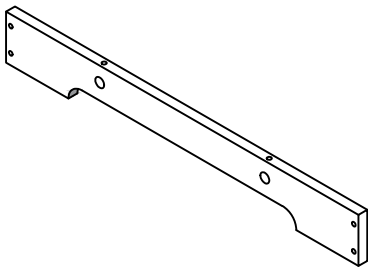

9x2

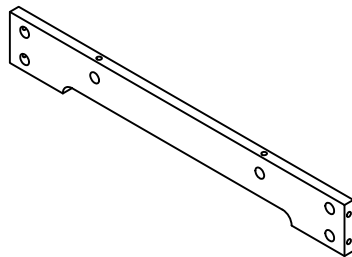

10x2

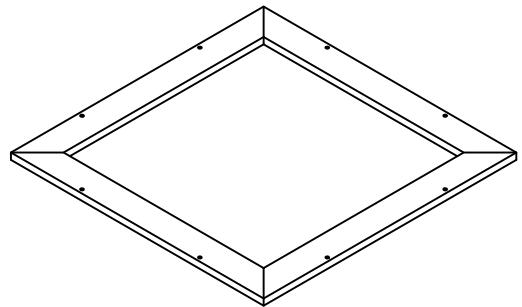

11x1

**A**

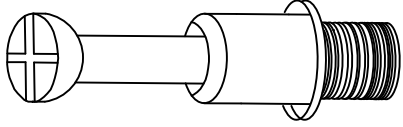

Two In One Screw  
(6x28mm)

112 Pcs  
+4 Pcs

**B**

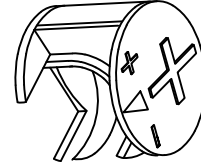

Two In One Nut  
(10x12mm)

112 Pcs  
+4 Pcs

**C**



Non-slip pads

8 Pcs  
+2 Pcs

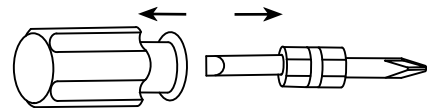
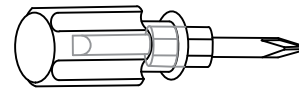

Double-head screwdriver, use as required

1 pcs

2

# Product structure decomposition

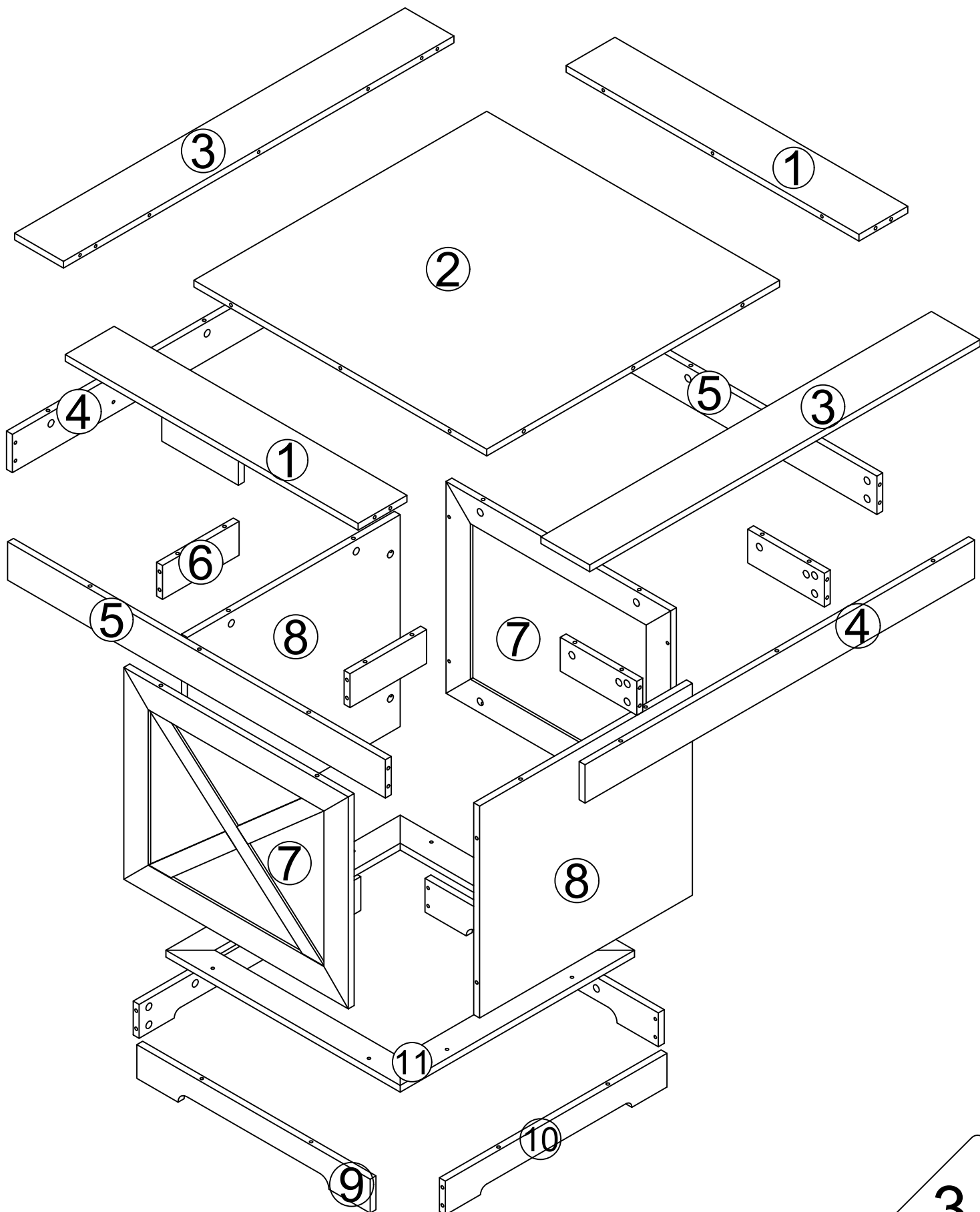

A

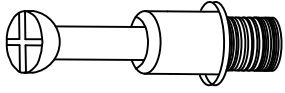

80 Pcs

B

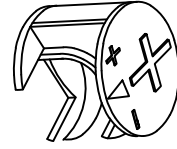

72 Pcs

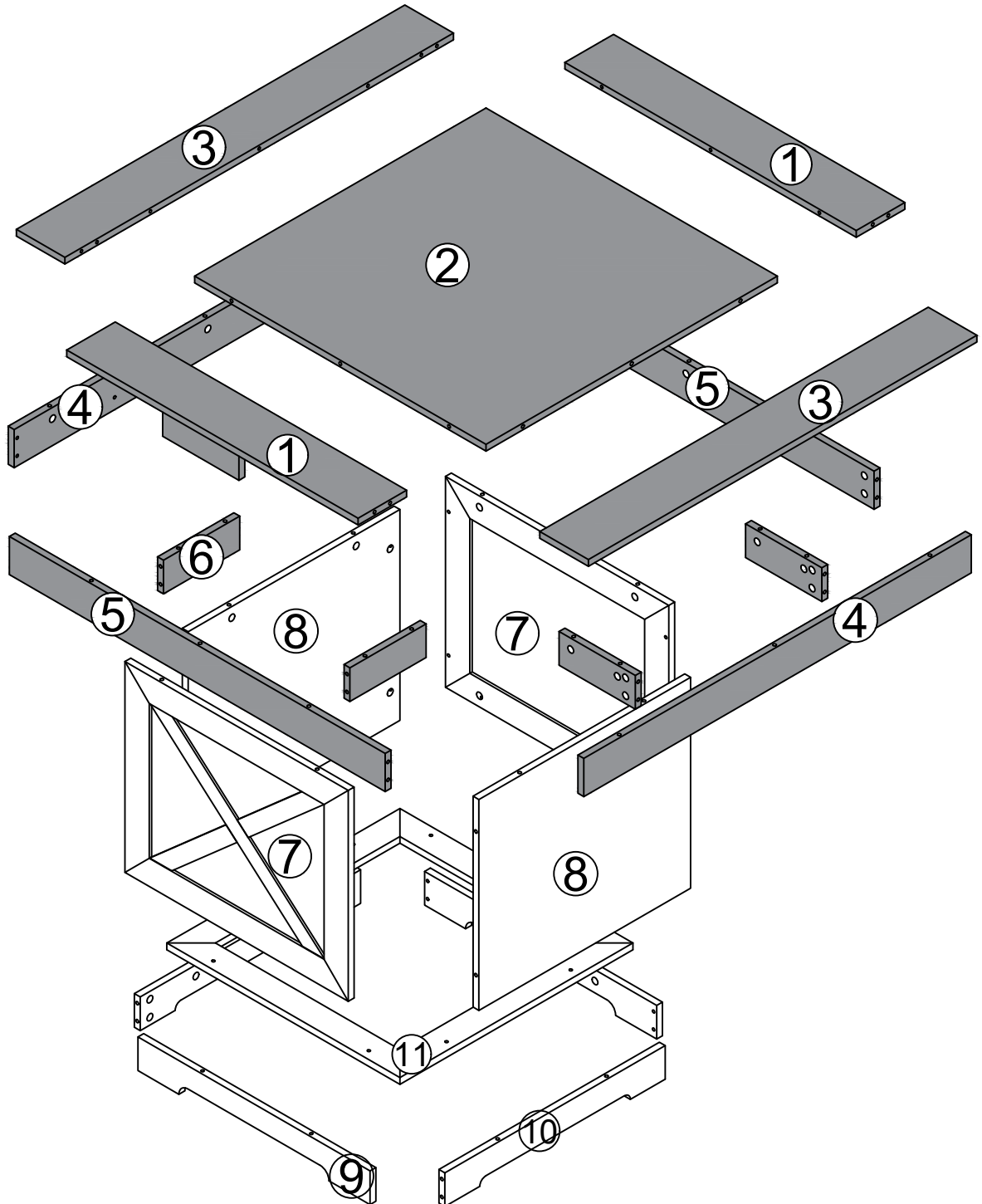

# Use parts A and B

Step1

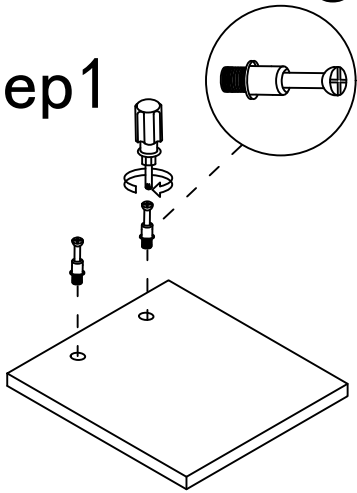

Step2

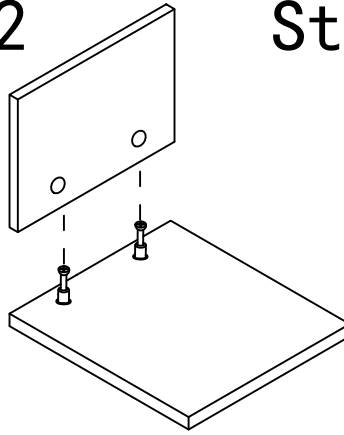

Step3

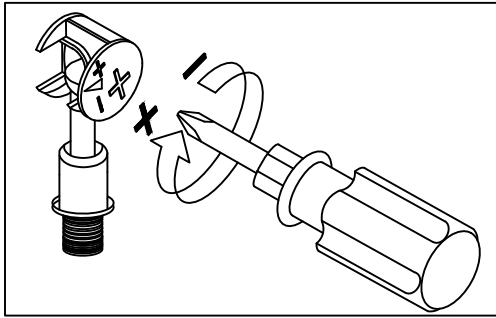
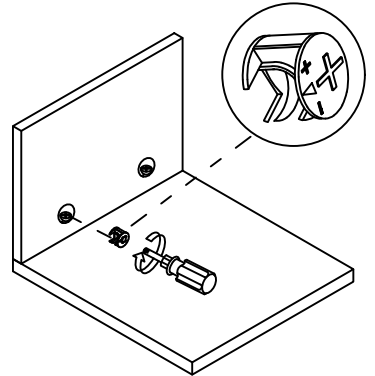

Use a screwdriver to lock in the direction of the "+" sign

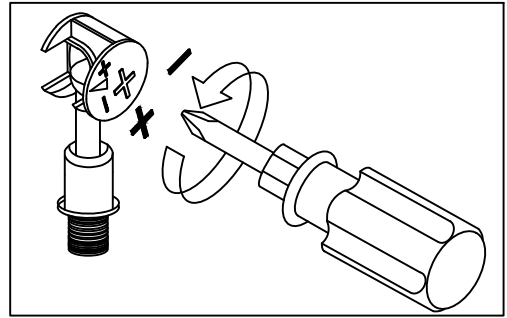

Disassemble along the direction of "-" sign

Step 1

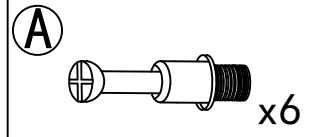
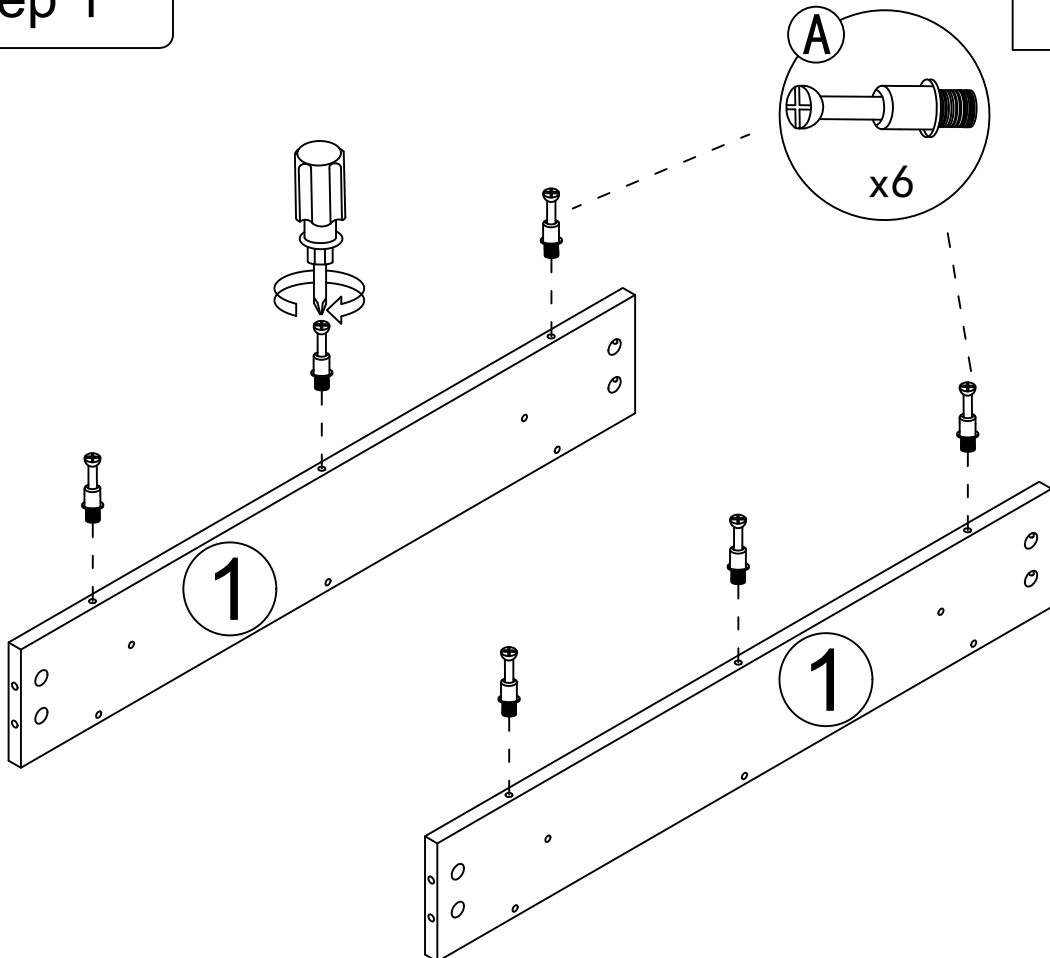

Step 2

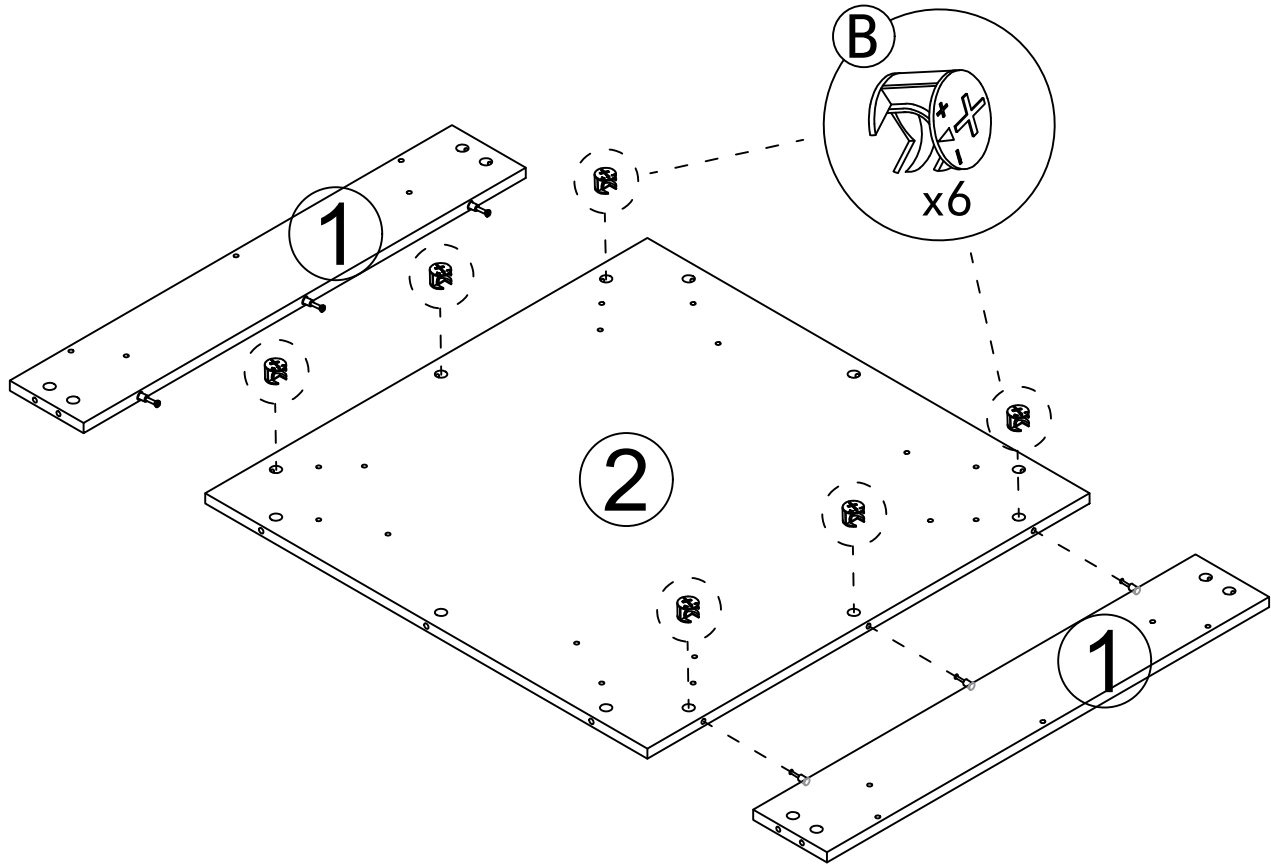

Step 3

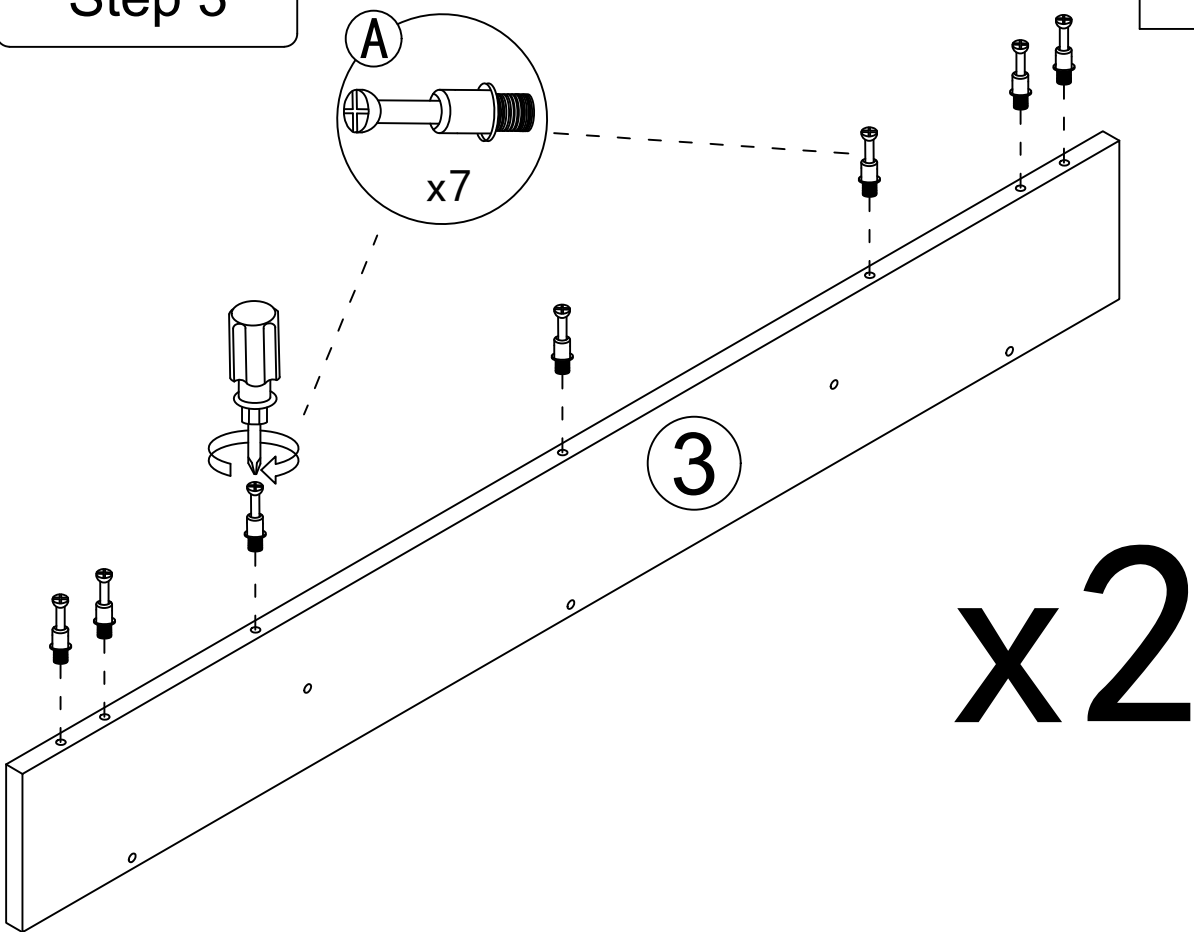
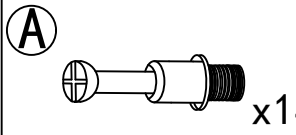

# Step 4

**B**



x14

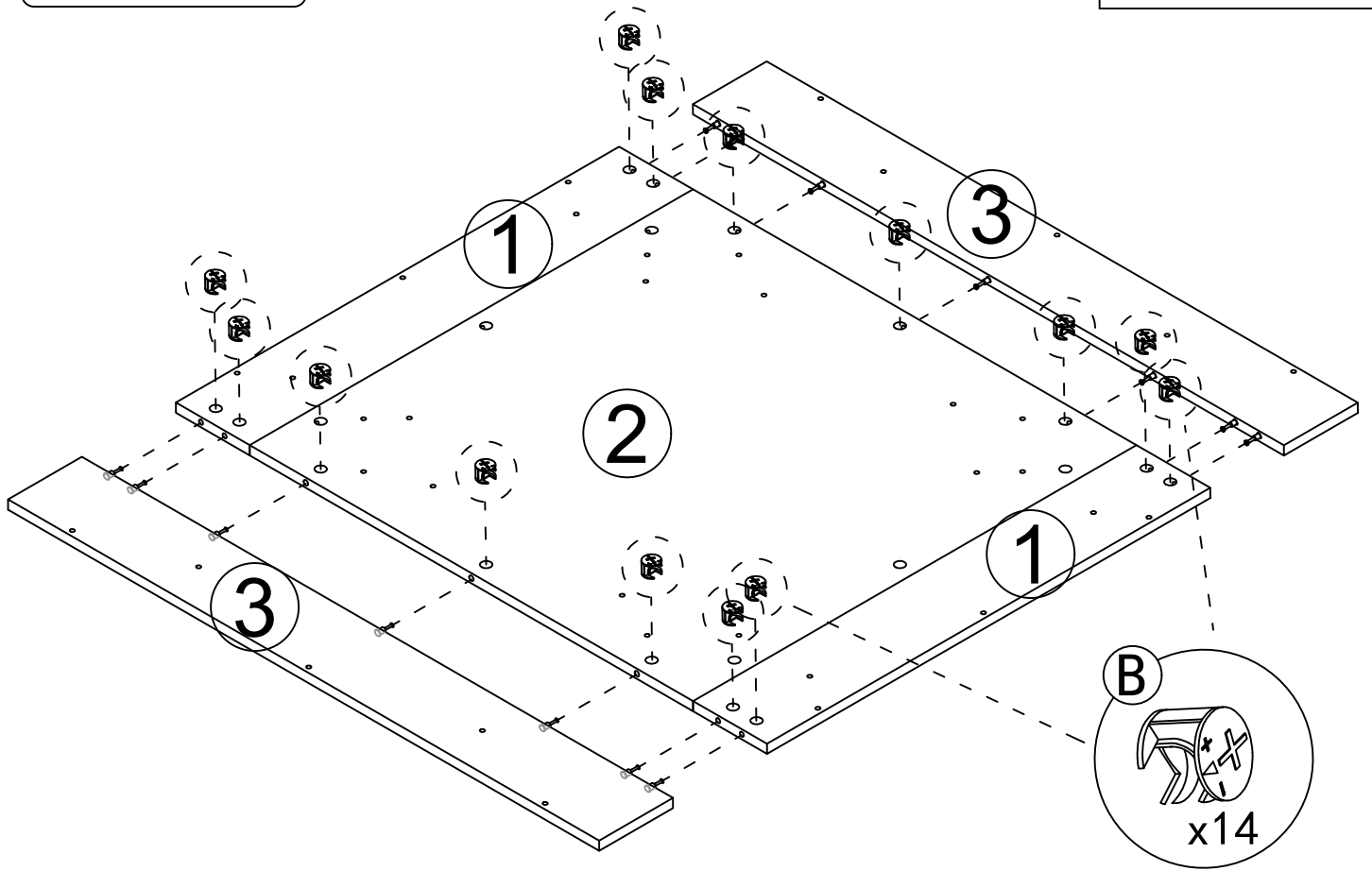

**B**



x14

# Step 5

**A**

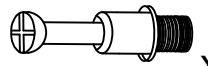

x36

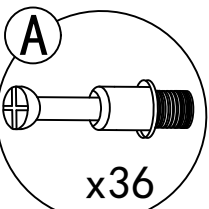
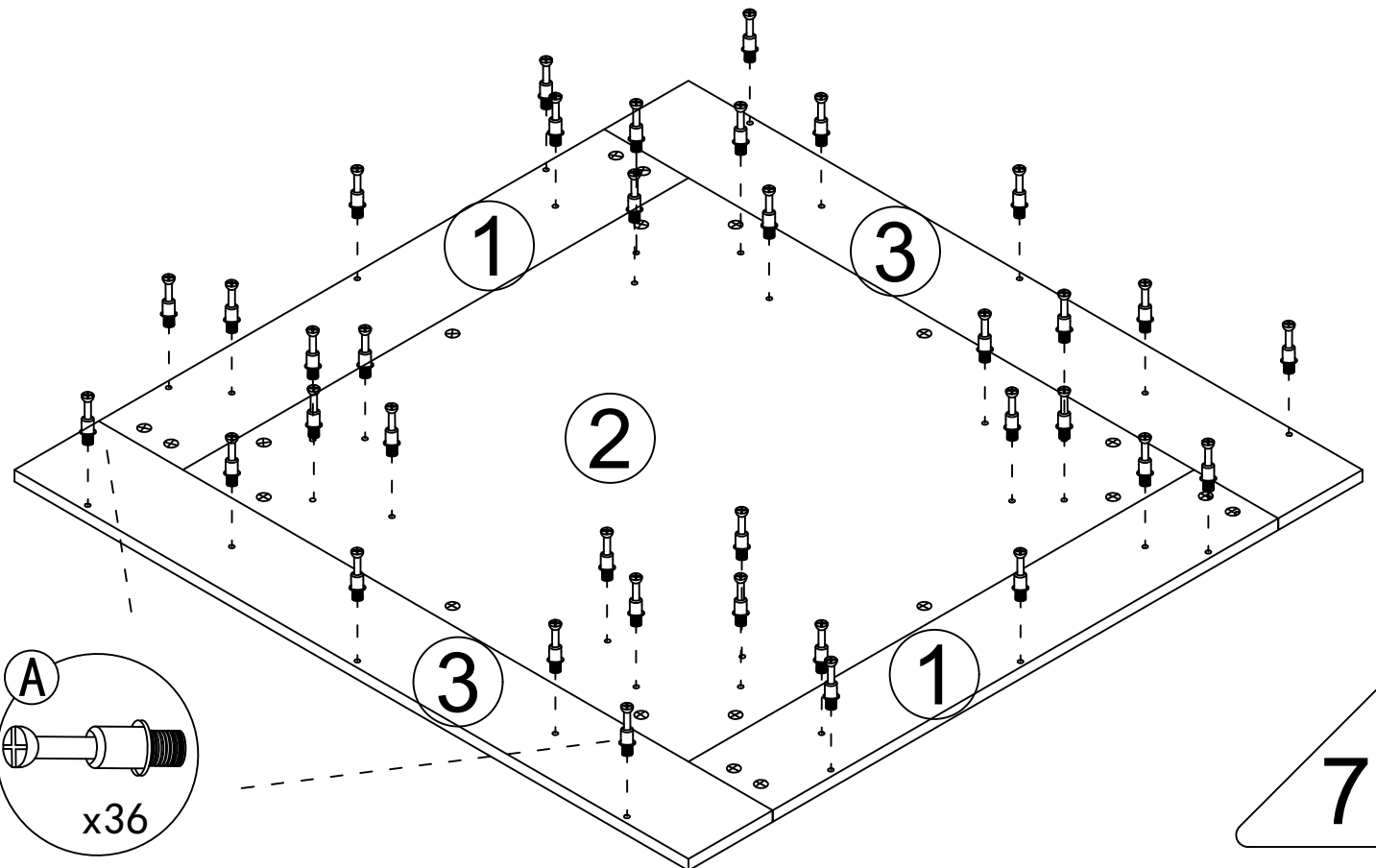

x36

7

Step 6

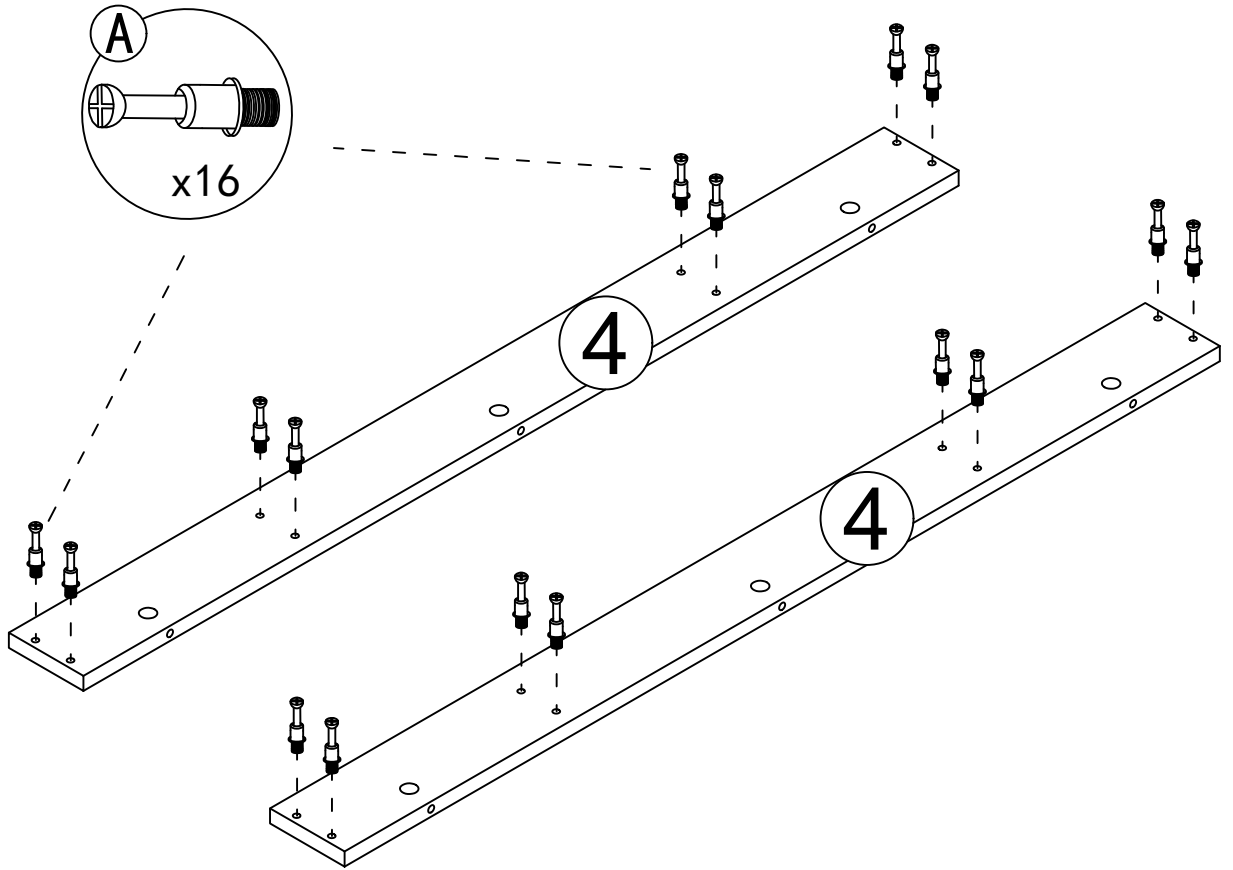
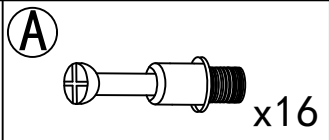

Step 7

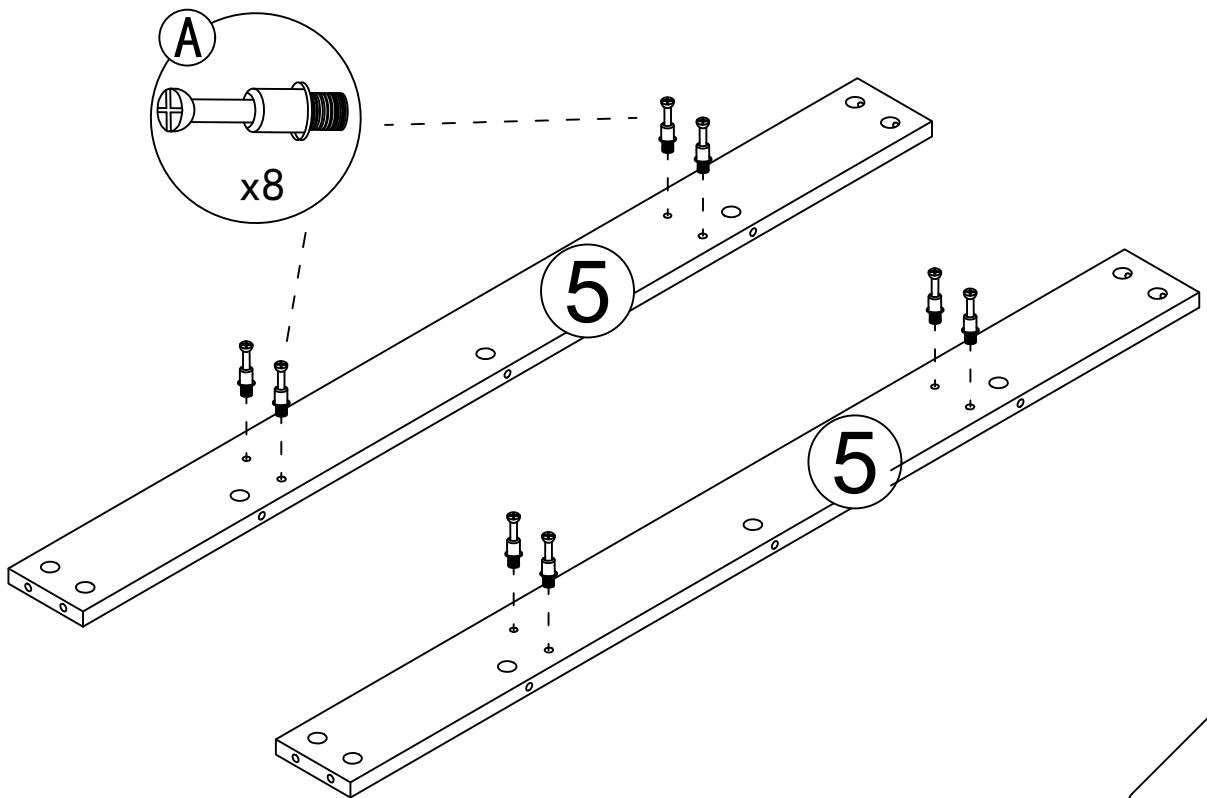
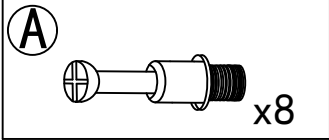

Step 8

**B**  x4

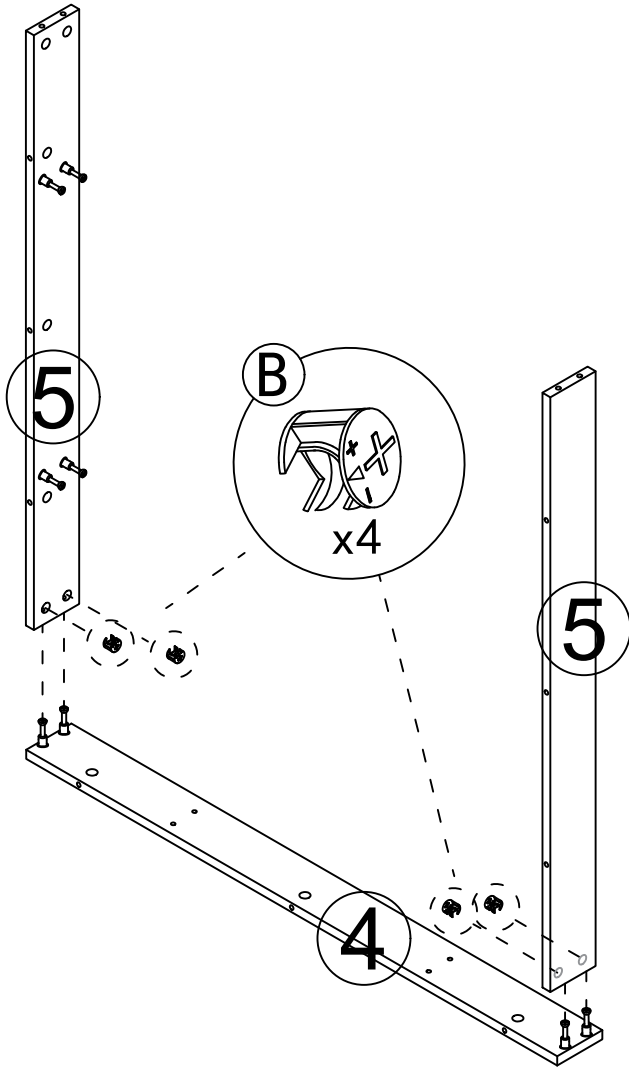

Step 9

**B**  x4

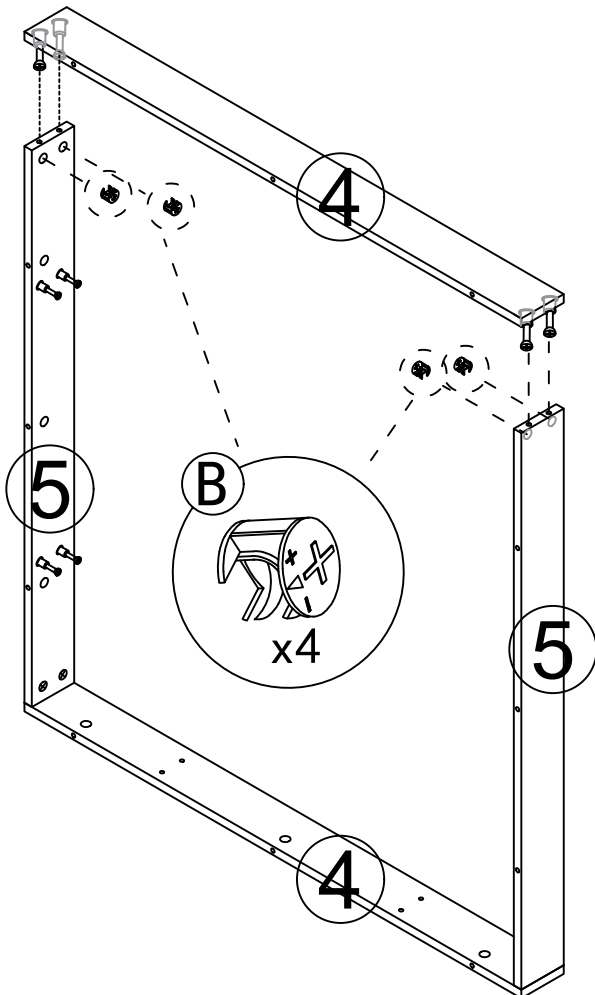

Step 10

**(B)**  x8

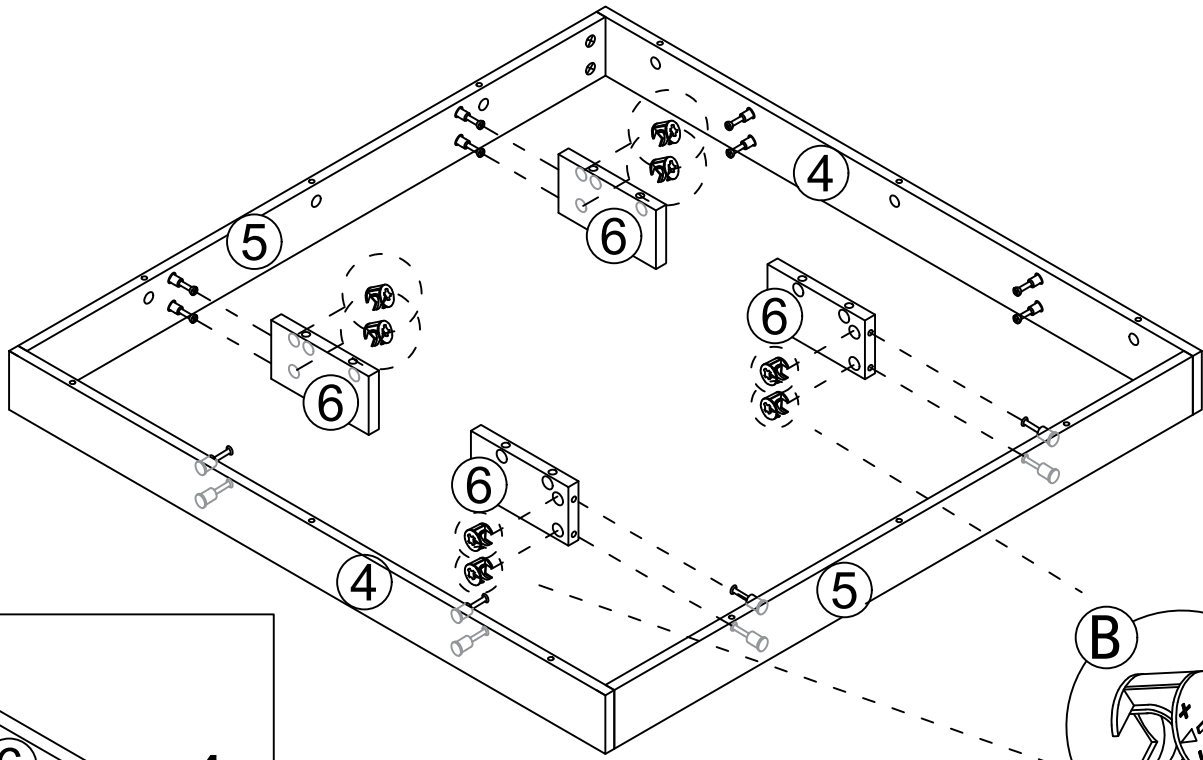

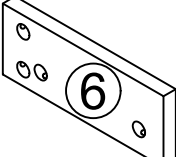
 x4

**(B)**  x8

Step 11

**(B)**  x8

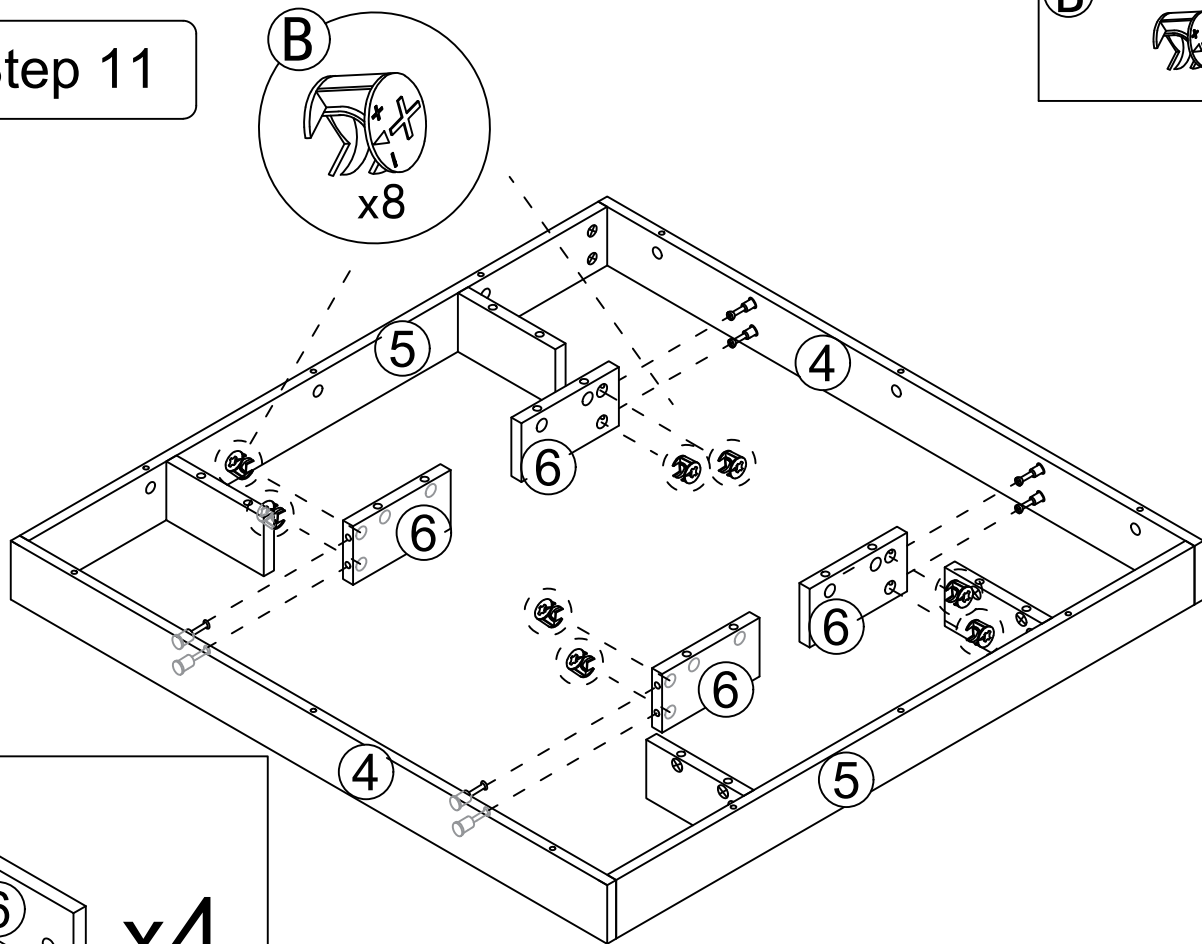

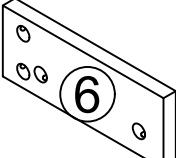
 x4

10

Step 12

Attention, the hole is facing downwards

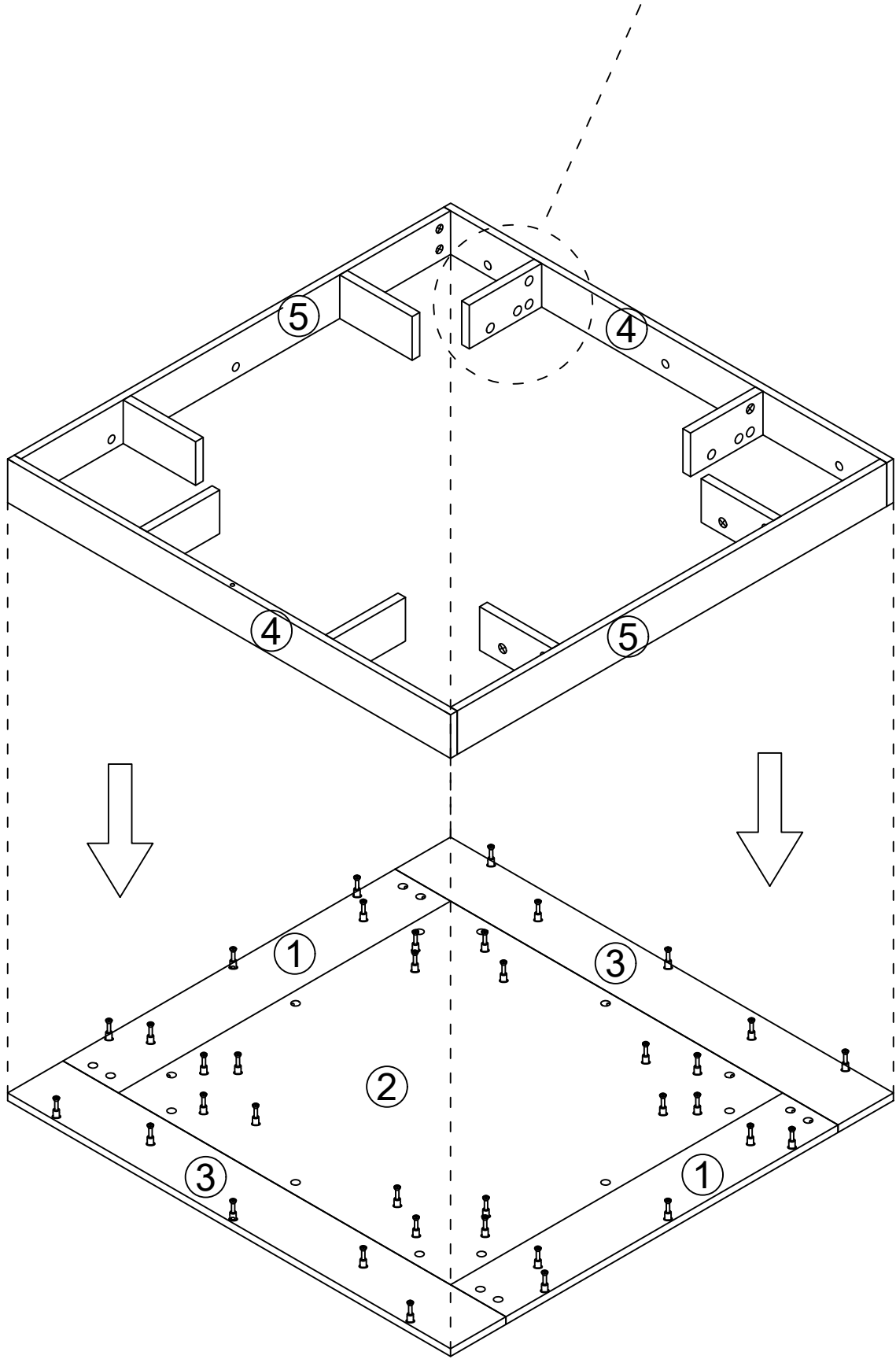

Step 13

**B**  x12

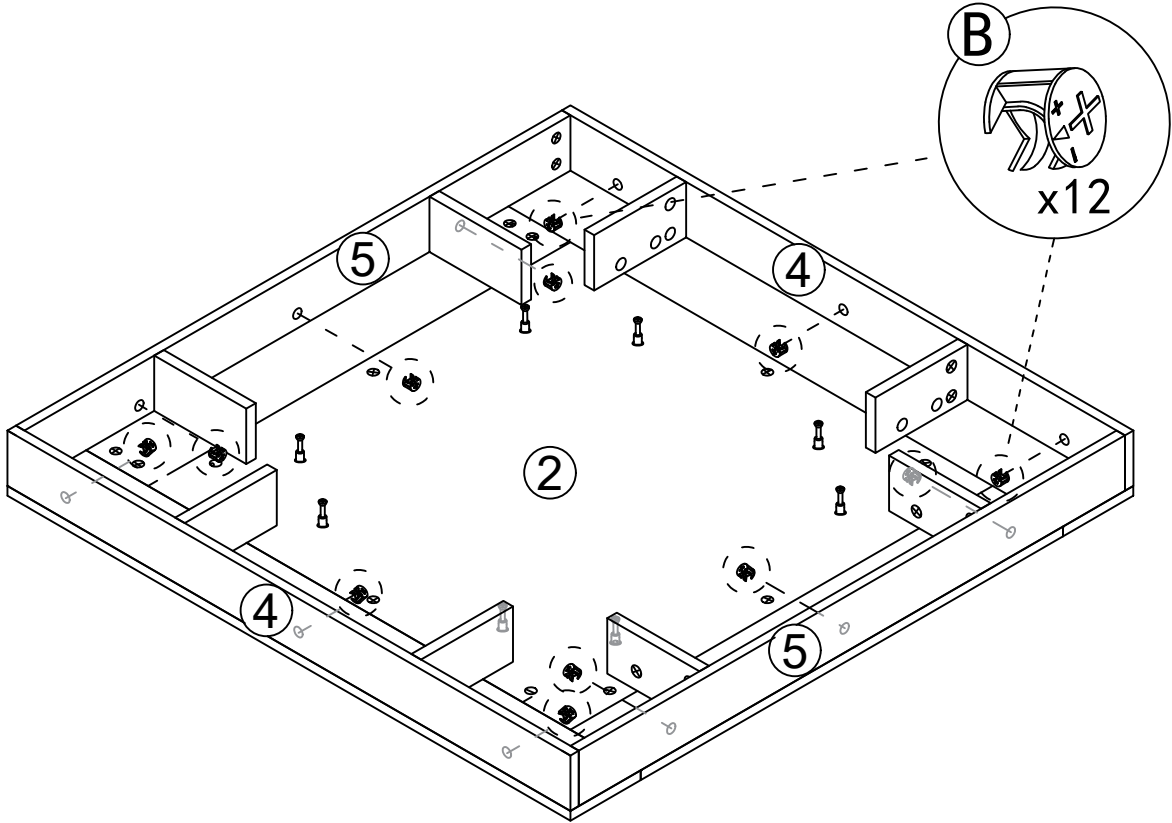

Step 14

**B**  x16

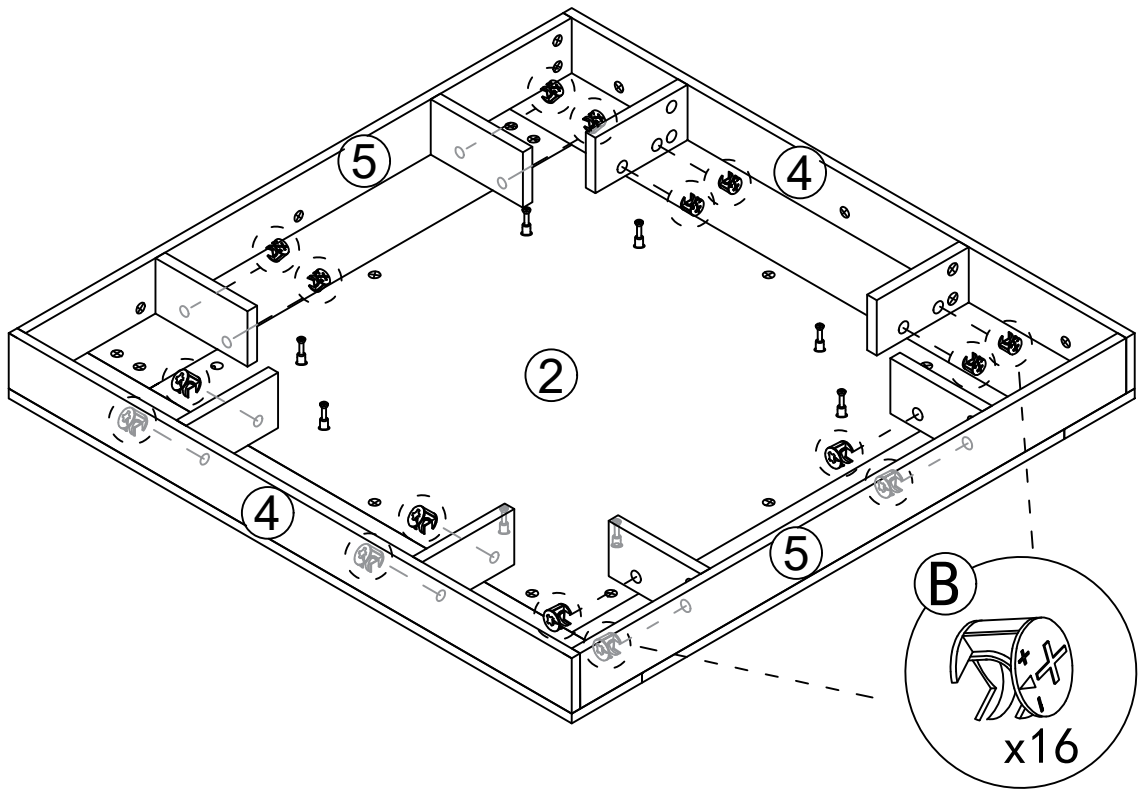

A

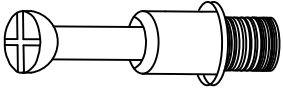

32 Pcs

B

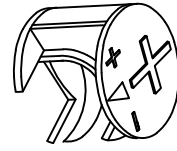

40 Pcs

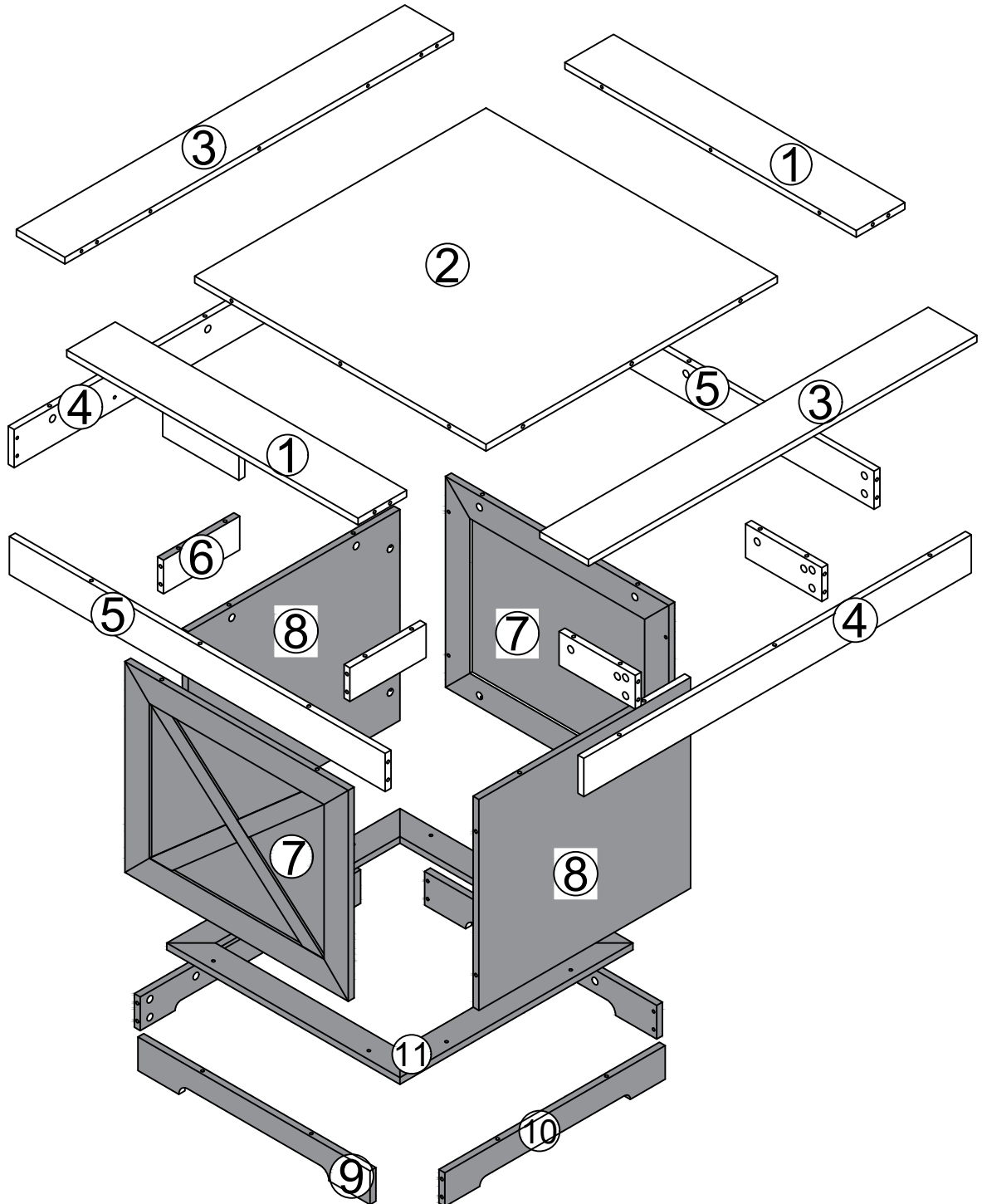

Step 15

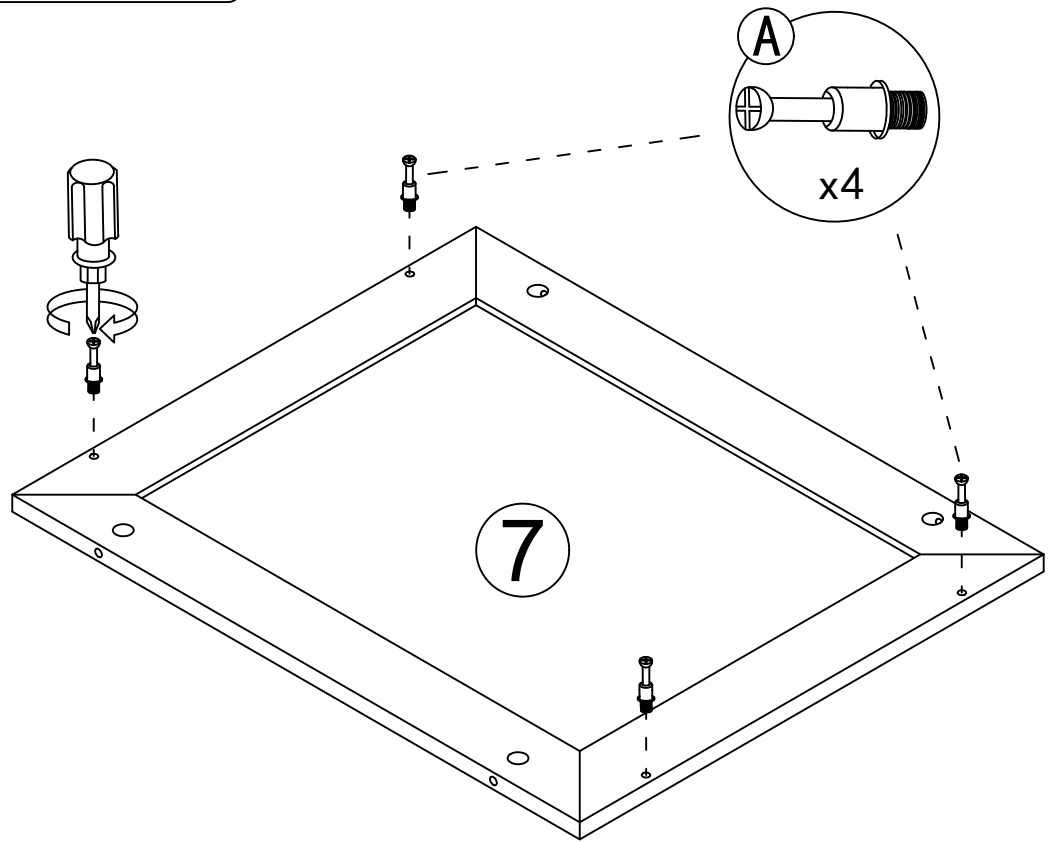
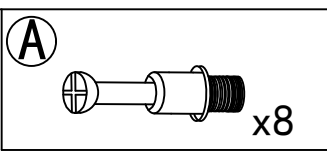

x2

Step 16

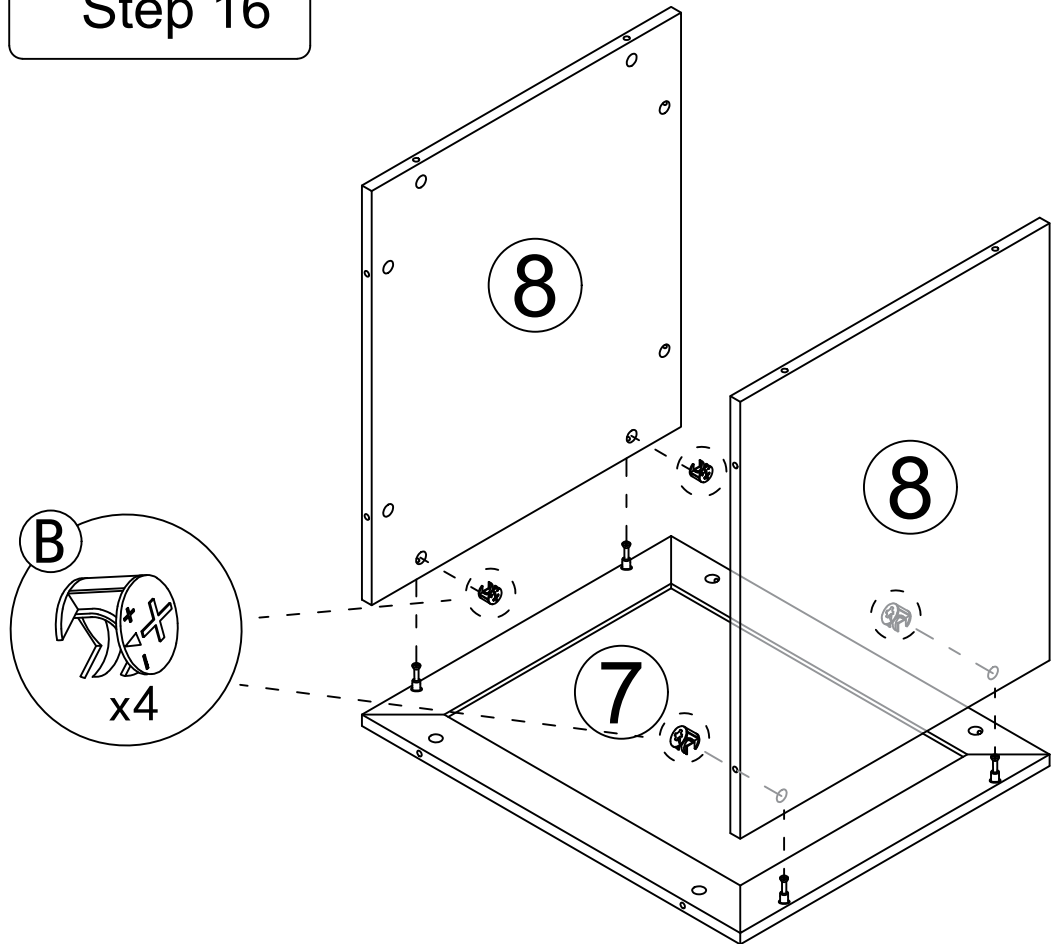
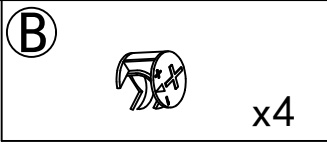

Step 17

B



x4

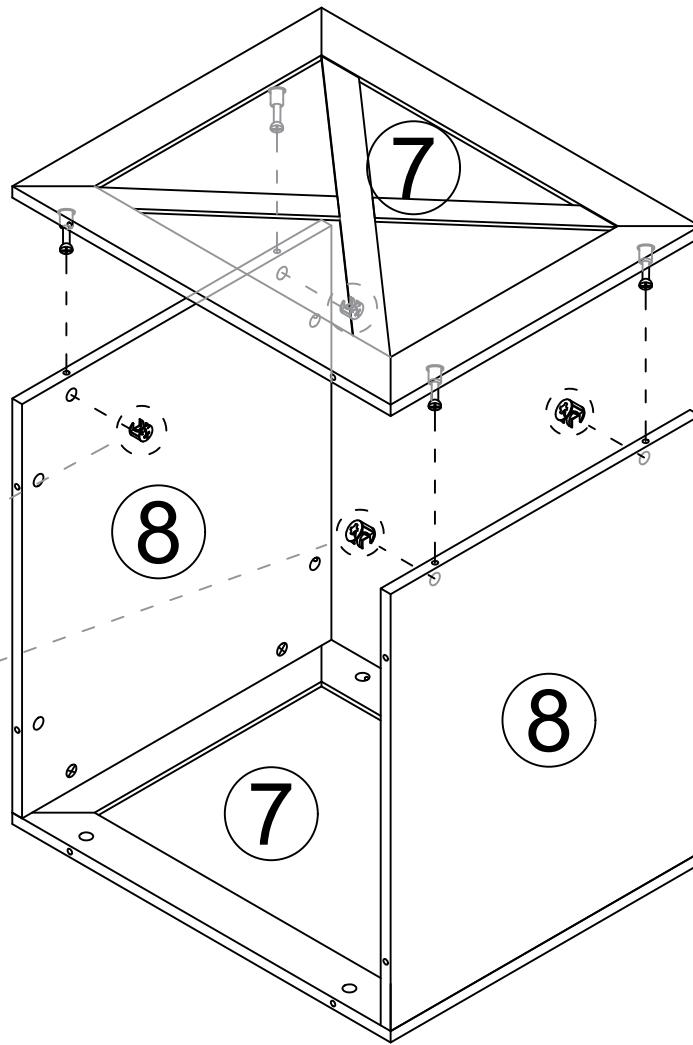
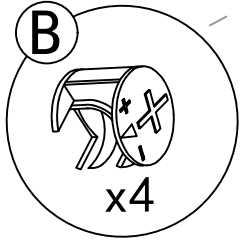

Step 18

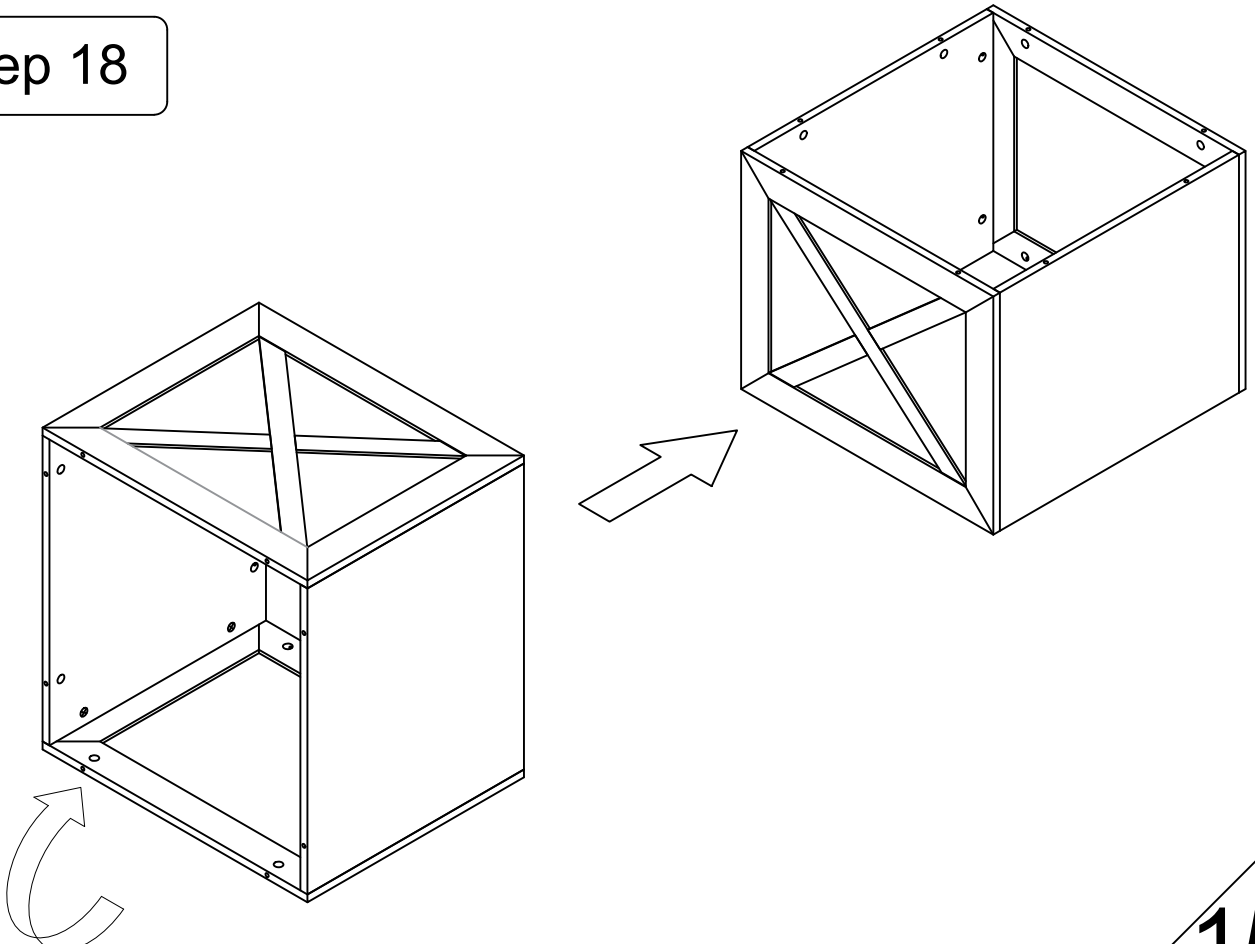

Step 19

B



x8

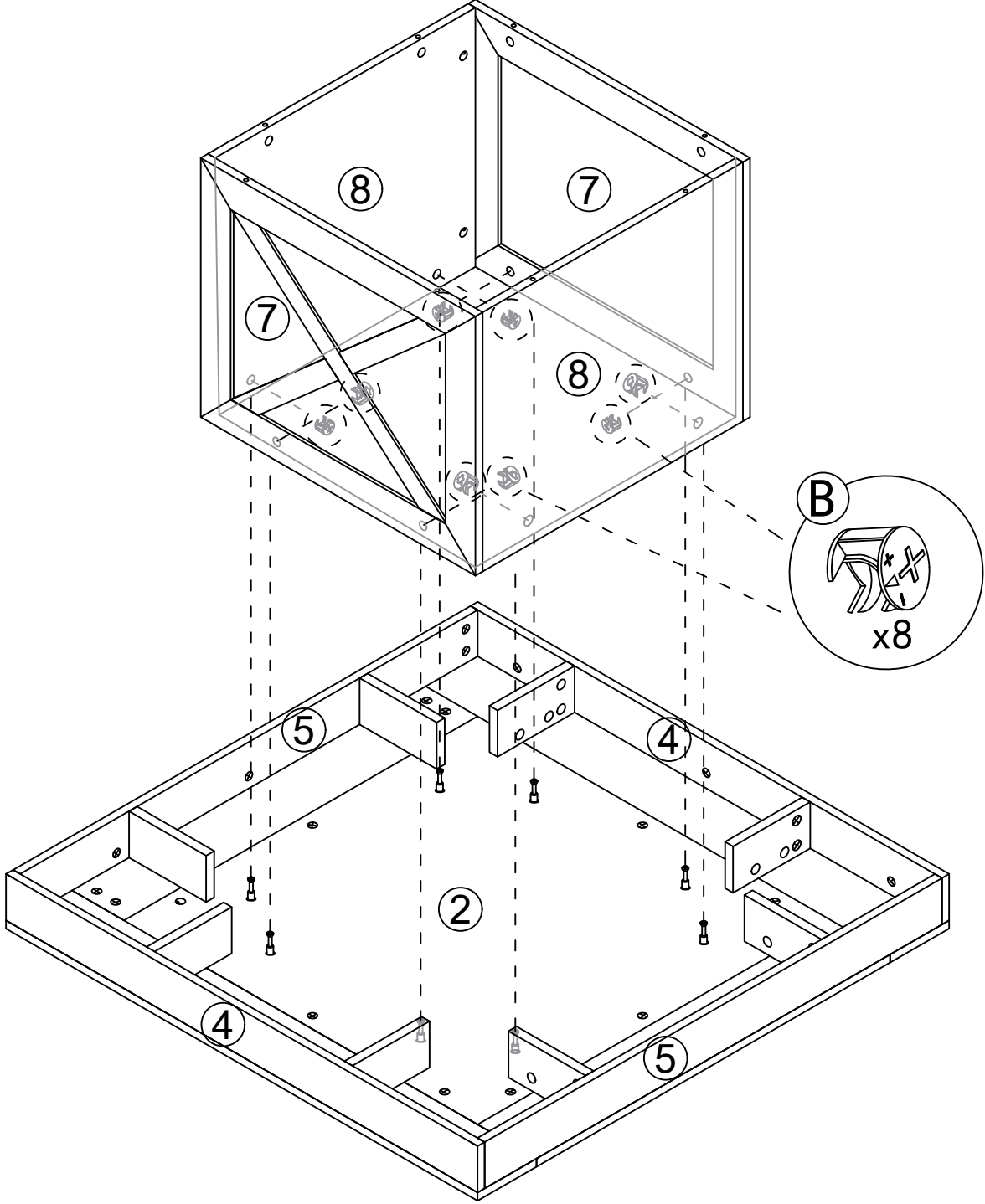

Step 20

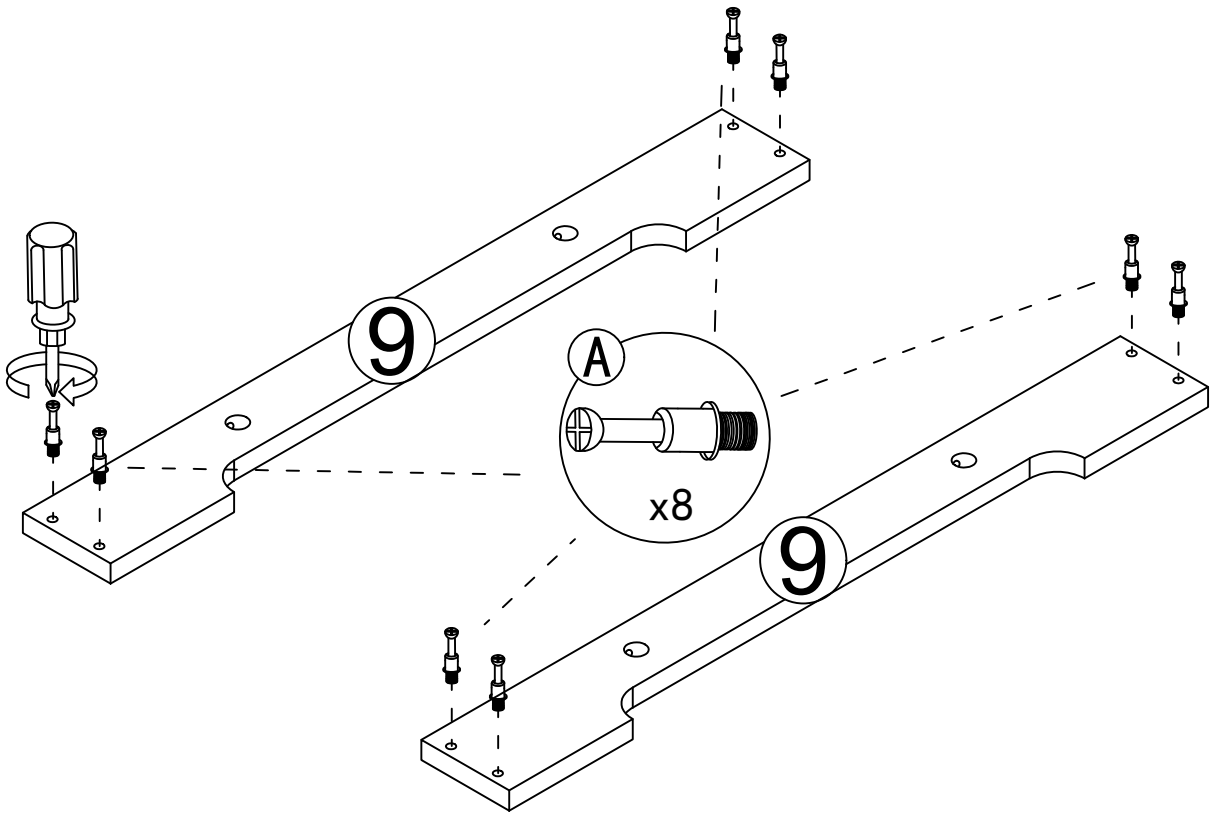
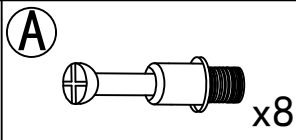

Step 21

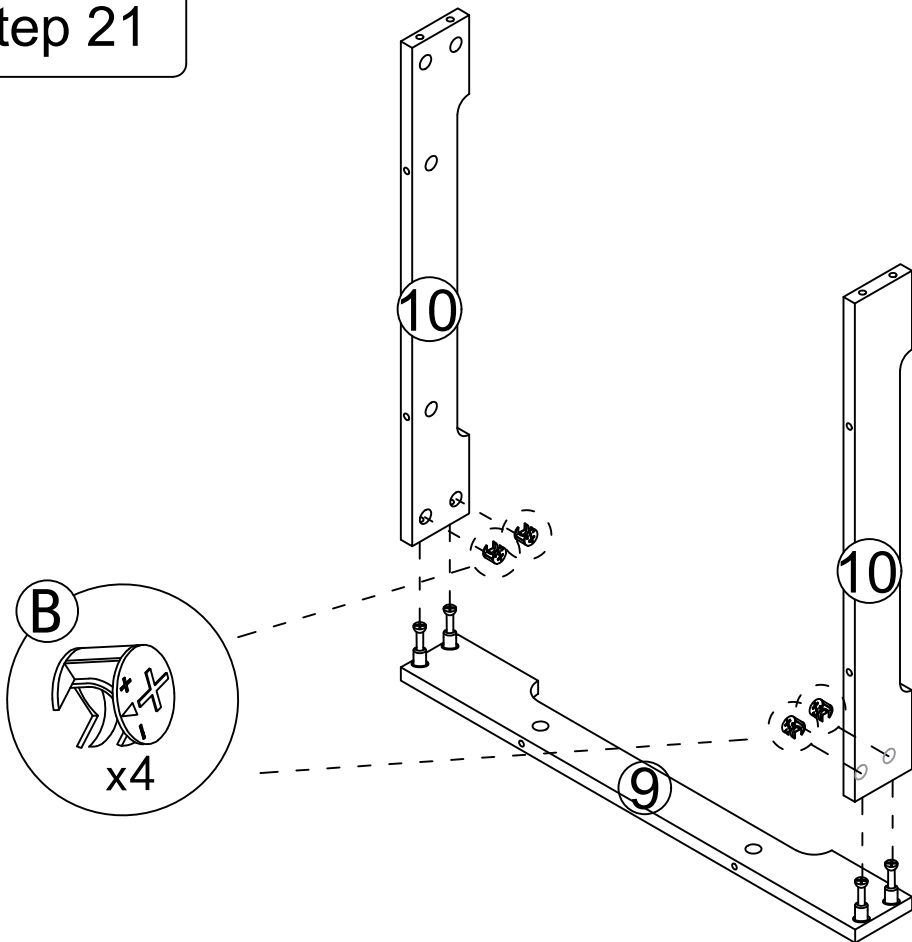
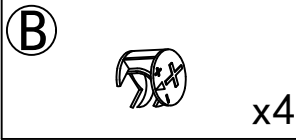

# Step 22

(B)



x4

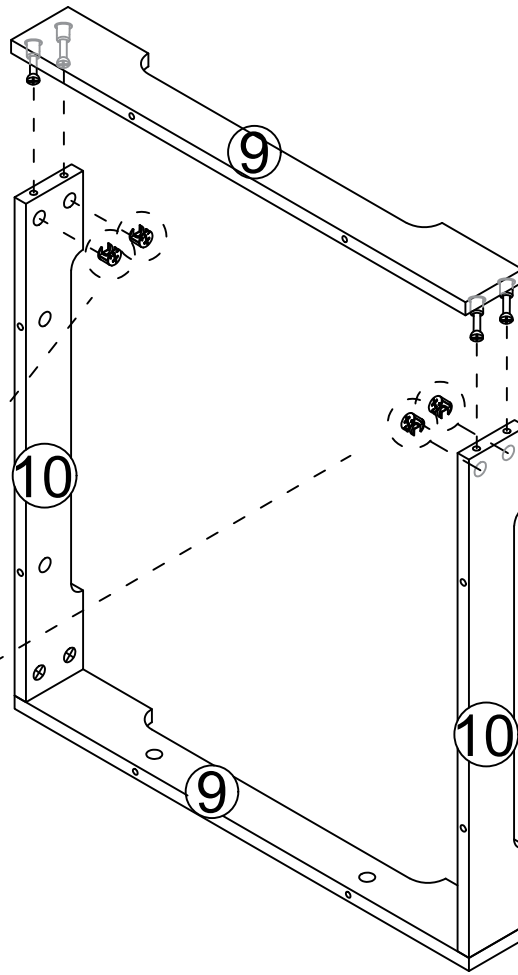
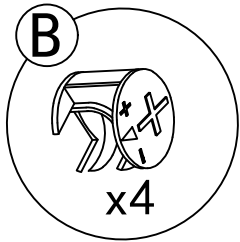

# Step 23

(A)

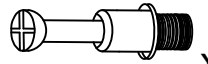

x8

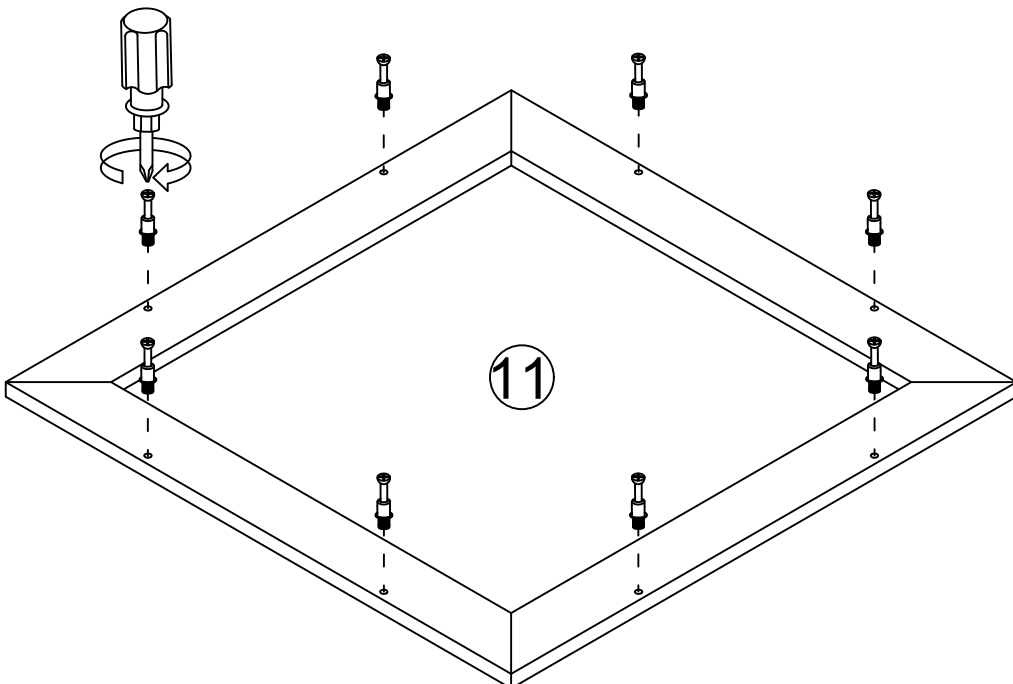

Step 24

B



x8

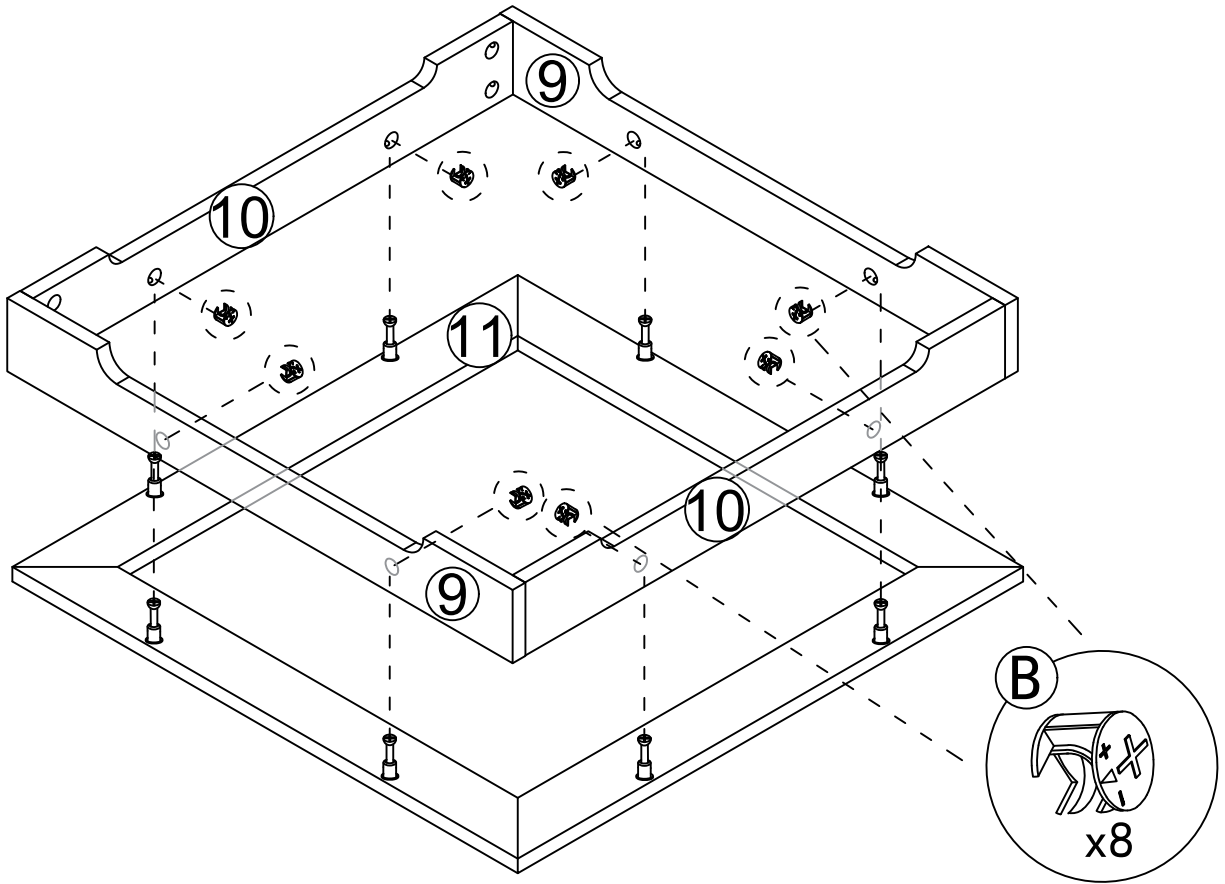

Step 25

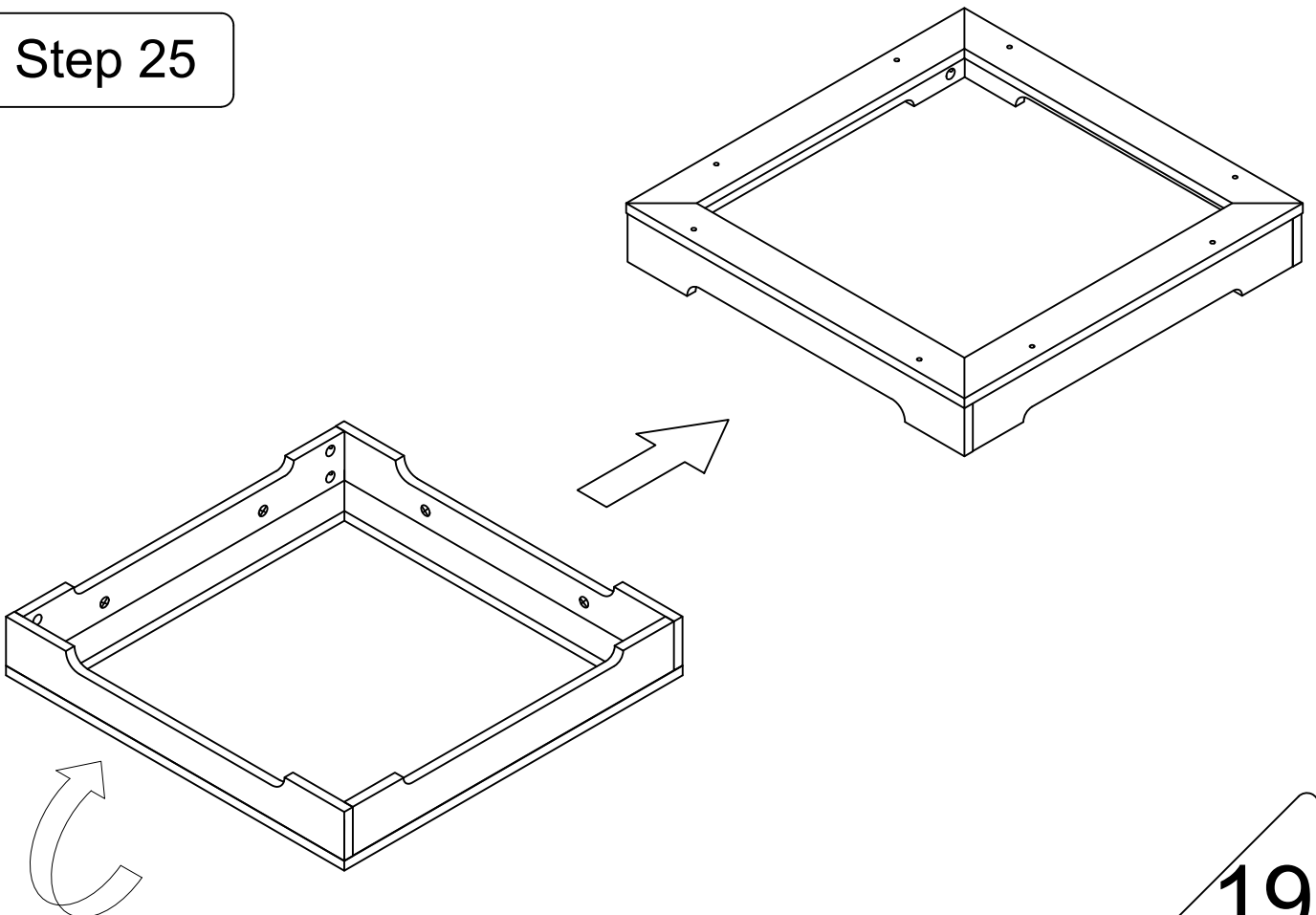

Step 26

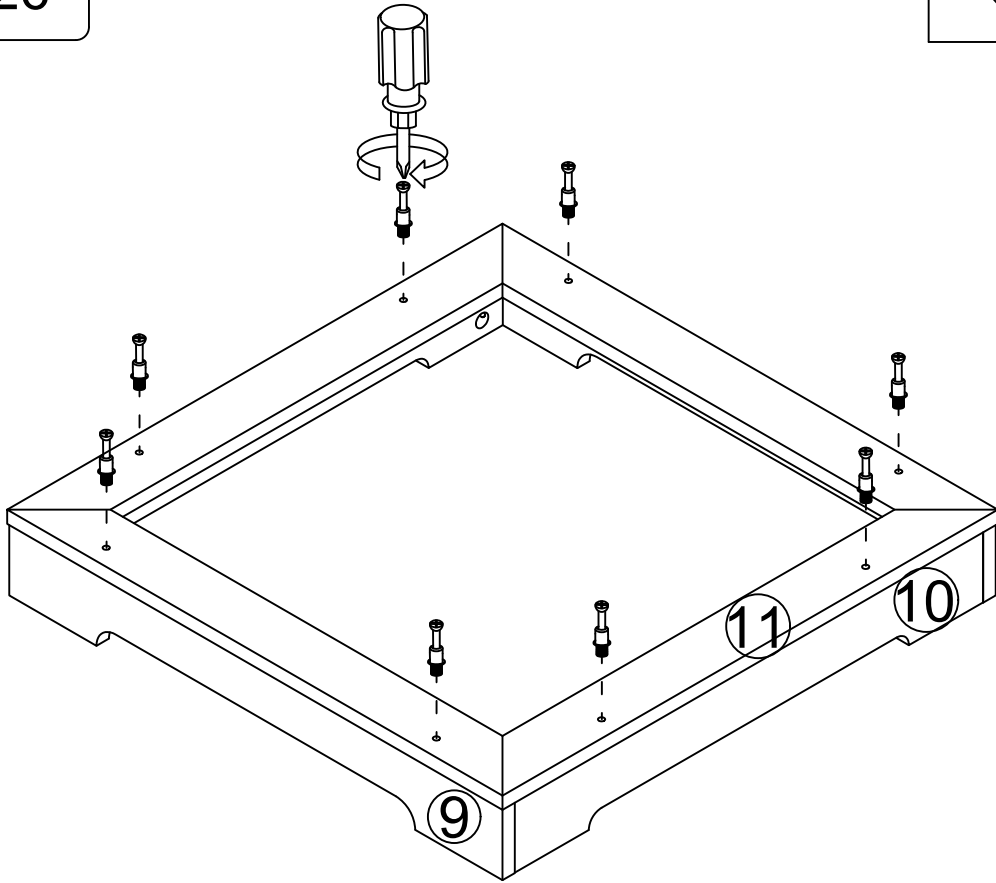
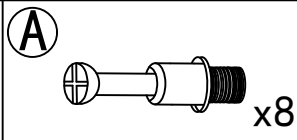

Step 27

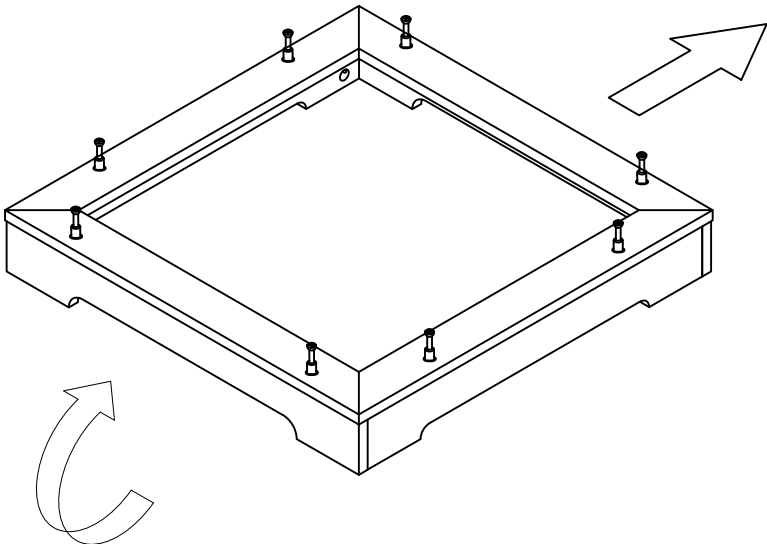
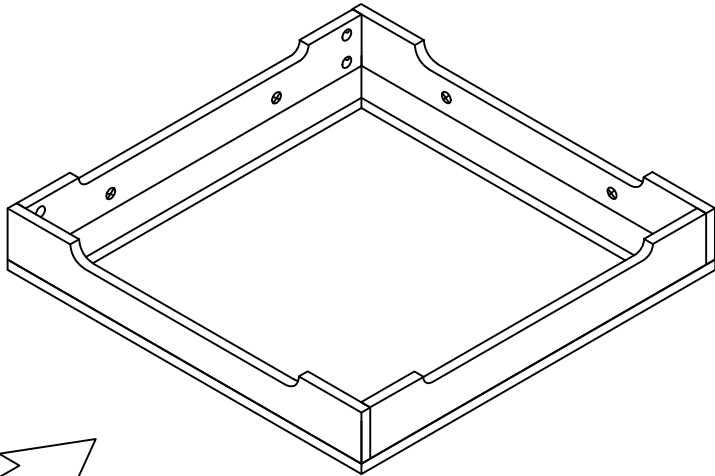

Step 28

B



x8

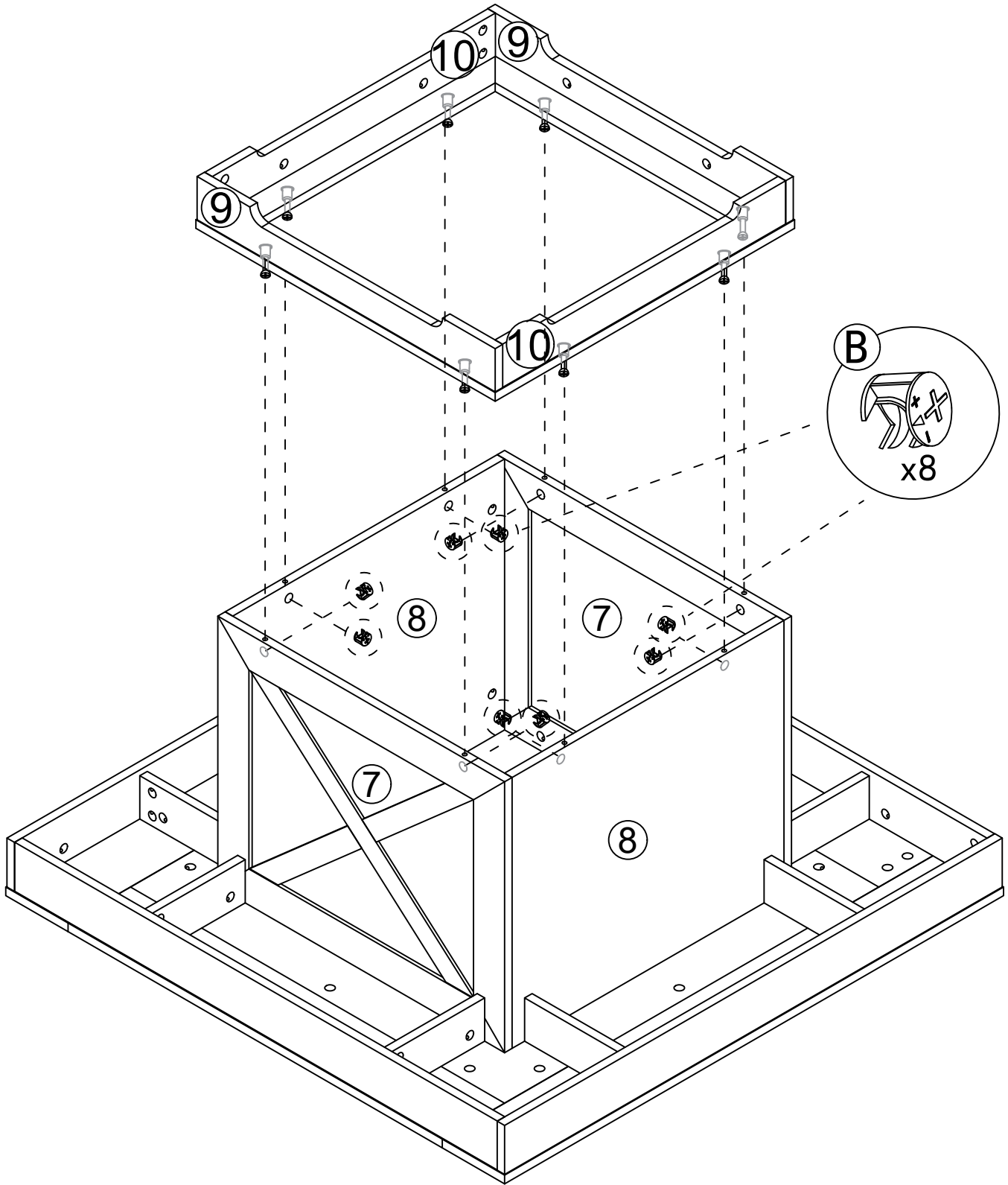

# Step 29

**C**  x8  
Tear off release paper and stick the black foot pad on the board

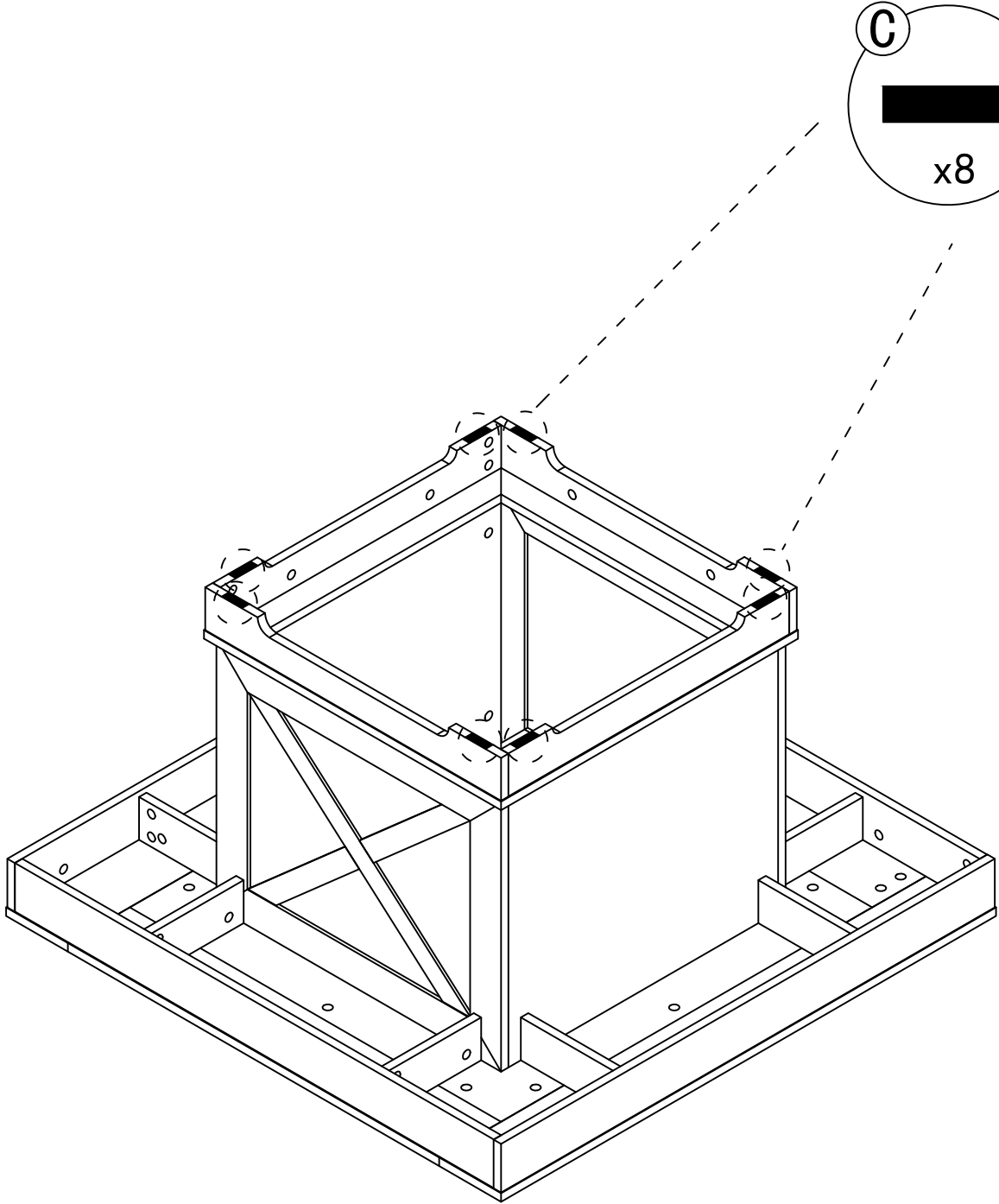

Step 30

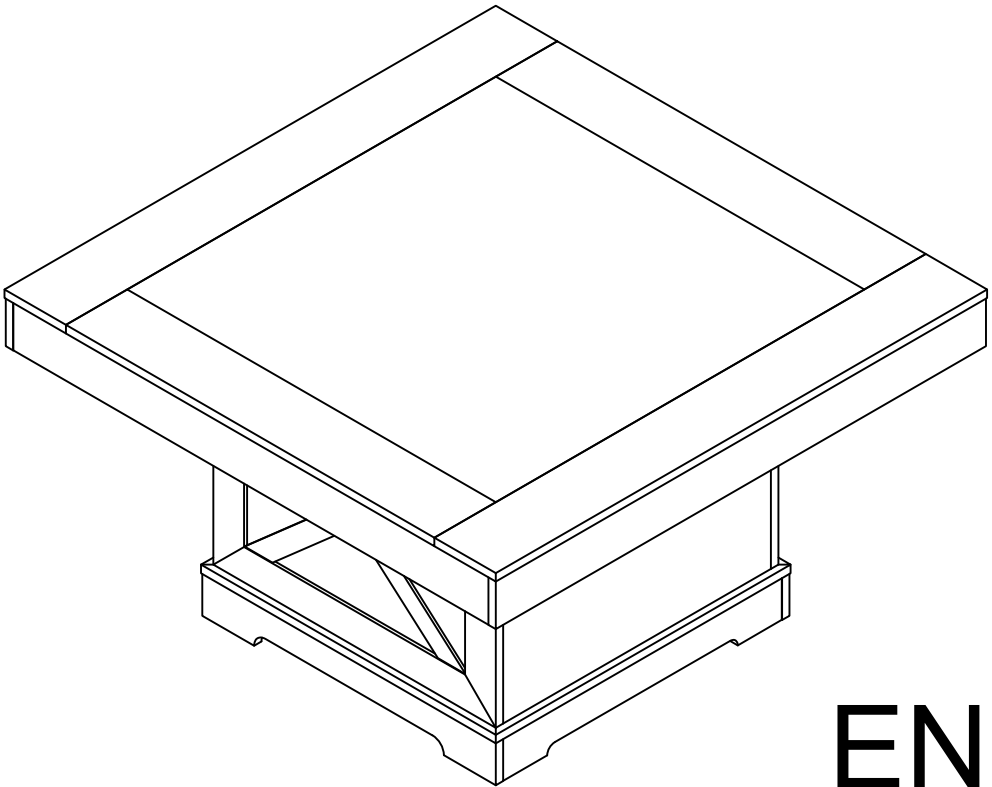
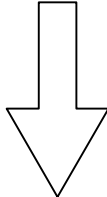
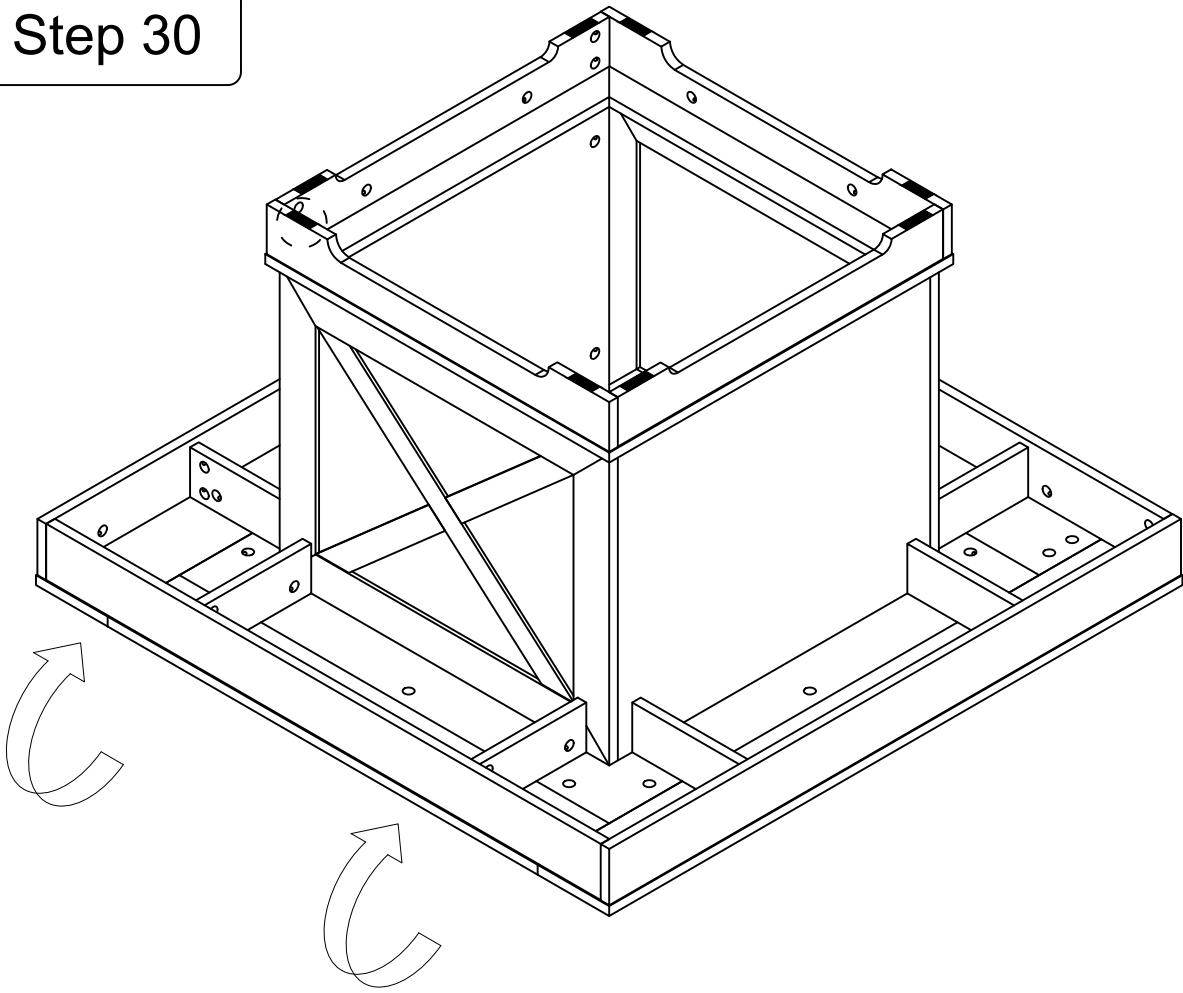

**END**