

KIDS SLIDE

Instruction manual

FE-HT-XXX06

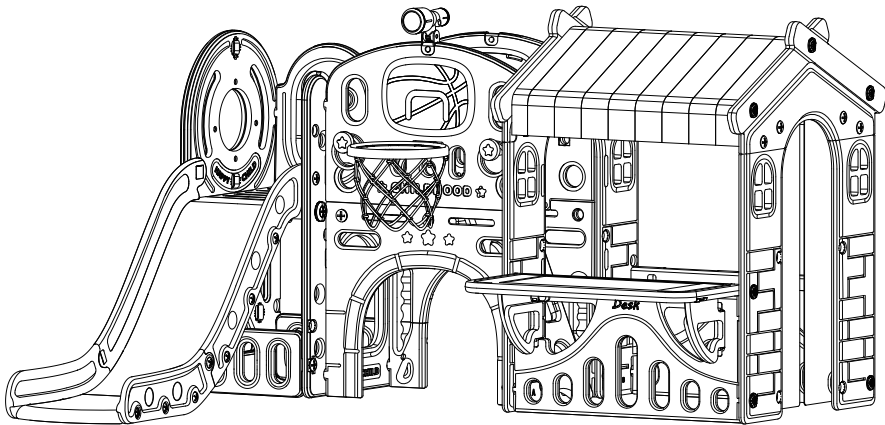

THANK YOU

Thank you for purchasing the kid slide from our store. If you experience any problem while using it, please feel free to contact us. We will solve the problem for you quickly and provide the best customer service!

E-mail Service : toddlerslide@gmail.com

This product conforms to the safety requirements of CPSIA, ASTM F963-17

Please read and keep the manual properly, it contains important information.

E-mail Service : toddlerslide@gmail.com

MAINTENANCE INSTRUCTIONS

1. Check the product regularly to prevent loose and broken components.
2. Use mild soap and water for daily cleaning.
3. The following examines are required at the beginning of each season (twice a month)

- (1)Check if any parts are missing or broken.
- (2)Check if all the connection parts are tight.

WARNING

- 1.CHOKING HAZARD-Small parts. Sharp points.Only for adults assemble it and the product should be used under the supervision of an adult.
- 2.Children on this product should not wear scarf, gloves, cloak or any clothes with long strip.
- 3.Children on this product should not wear necklace or hang anything around the neck.
4. MAKE SURE the surface of the product is dry and free of foreign objects before use Stay away from fire
5. MAKE SURE all the connection parts are tightly assembled before allowing children to play on it.
- 6.DO NOT cut, heat or change the shape of the product.
- 7.DO NOT use jump rope, clothes line, etc. to hang items not specially designed for this product.
- 8.DO NOT place the product in direct sunlight to reduce the risk of sunburn.
- 9.DO NOT use the product in an unintended way.
- 10.DO NOT use the product when it it wet or in a snow day.
- 11.Falling to a hard ground like concrete floor may cause severe injury or even death.Close supervision of an adult is required during use.
- 12.Stop using the product when the temperature is below 32°F (0°C), because the plastic material may get more fragile and easier to broken.

INFORMATION BEFORE ASSEMBLING

Check if following spare parts are in the box:

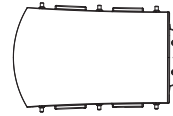

① Buffer plate*1

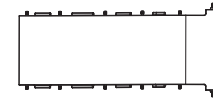

② Slide*1

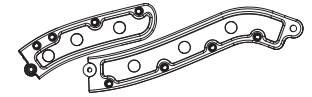

③ Each slide handrail*2

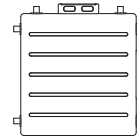

④ 2-ear platform*1



⑤ Folding basketball hoop*1

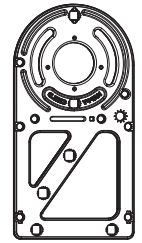

⑥ Large side panel*1

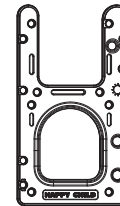

⑦ U-shaped side panel*1

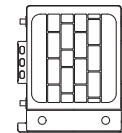

⑧ Aisle platform*1



⑨ Aisle side panel*2



⑩ Stickers*1 set

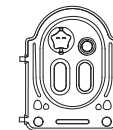

⑪ Star bezel*1

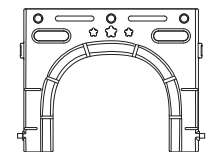

⑫ Aisle U-shaped side panel*2

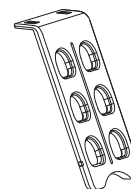

⑬ Climbing*1

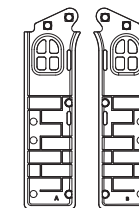

⑭ Side A/B of vertical board with window*2 each

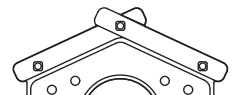

⑮ House roof*2

INFORMATION BEFORE ASSEMBLING

Check if following spare parts are in the box:

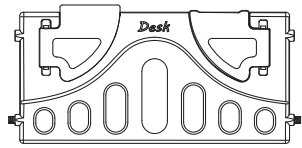

⑯ Horizontal board under the table with two supports*1



⑰ Roof support rod*3



⑱ Desktop*1

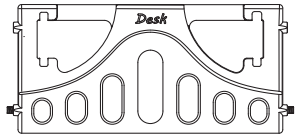

⑲ Under table horizontal panel*1

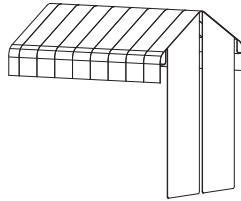

⑳ Tent cloth*1



㉑ Basketball*1



㉒ Basketball net*1

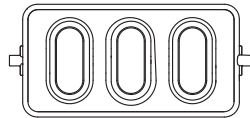

㉓ Three-hole baffle*2

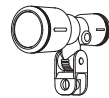

㉔ Telescope*1



㉕ Nose*2

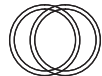

㉖ Ferrule*8



㉗ Screw*1



㉘ Small cross nut*16



㉙ Little Prodigy Nut*37



㉚ Flower nut*2



㉛ Square screws*10



㉜ Rectangular screw*2



㉝ Snap nut*12



㉞ Plastic screwdriver*1

ASSEMBLING

STEP 1

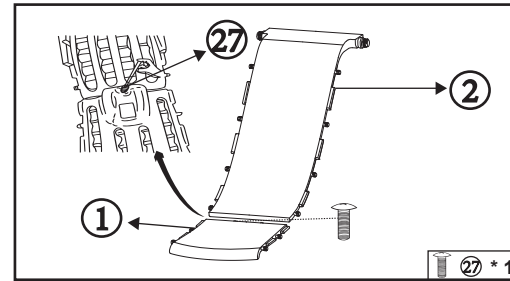

Buffer plate and slidaway assembly.

STEP 2

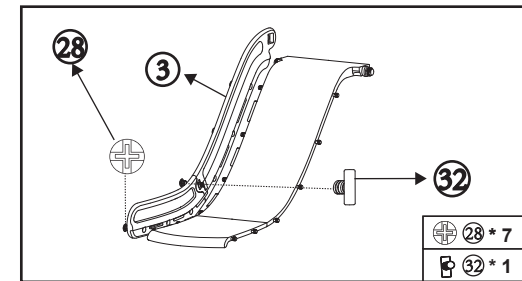

Install the handrail on one side of the slide.

STEP 3

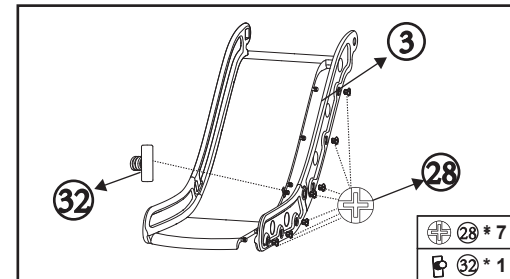

Fix the other side of the slide rail.

STEP 4

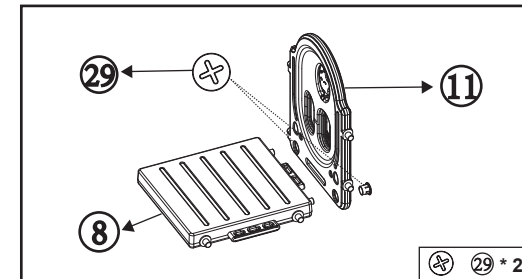

2-ear platform and star baffle assembly.

STEP 5

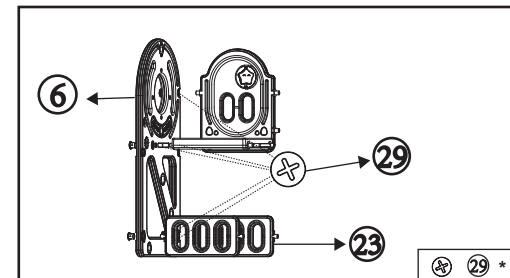

Assemble the assembled platform and three-hole baffle with the large side plate.

STEP 6

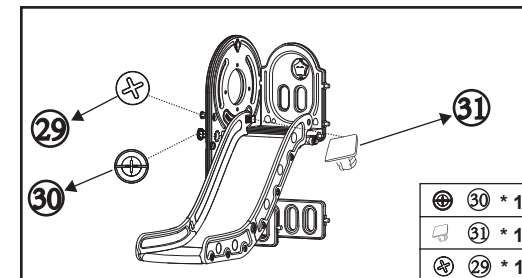

ASSEMBLING

STEP 7

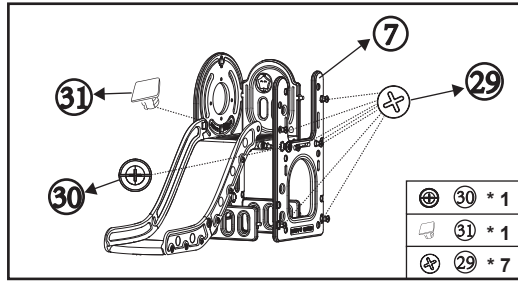

Install the U-shaped side panel on the other side.

STEP 8

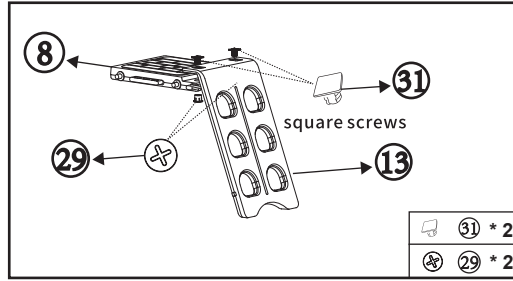

Aisle platform and climbing assembly and tightening the little prodigy nut.

ASSEMBLING

STEP 13

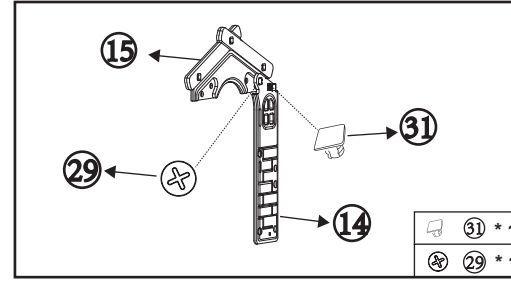

Assemble side B of the vertical board with windows to the roof.

STEP 14

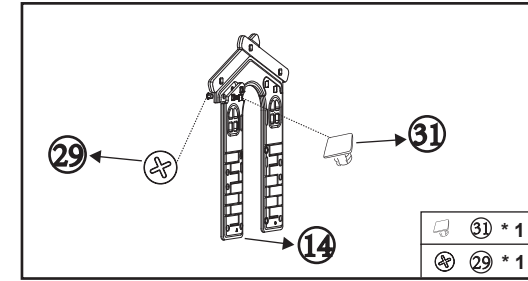

Assemble side A of another vertical panel with windows to the other side of the roof.

STEP 9

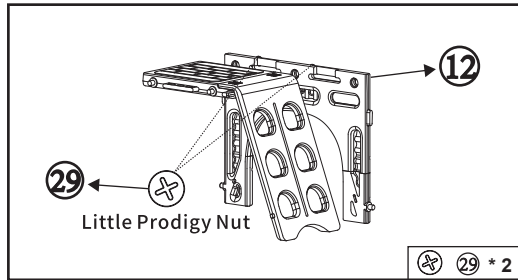

Climbing and fixing the assembled aisle platform strap to the U-shaped side panel of the aisle.

STEP 10

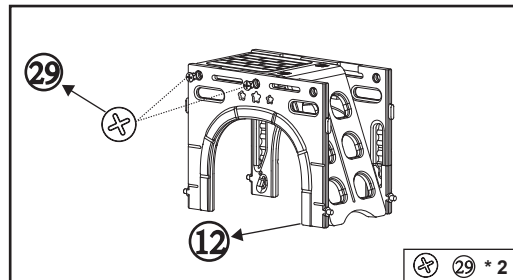

Use small prodigy nuts to fix the U-shaped side panel of the aisle on the other side.

STEP 15

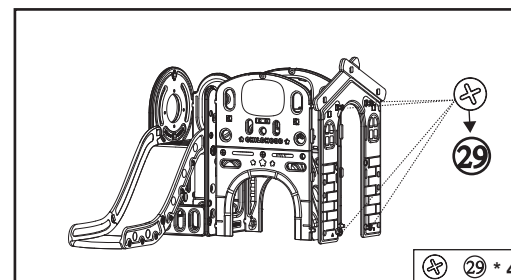

Fix the assembled window riser A/B sides to the other side of the aisle.

STEP 16

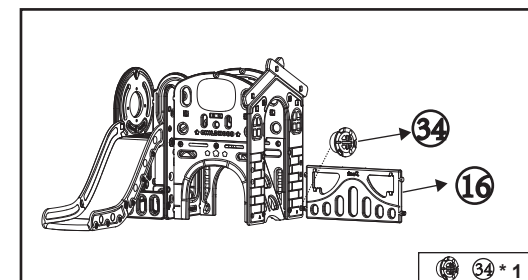

Use snap nuts to fix the horizontal plate under the table to surface B of the vertical plate with window.

STEP 11

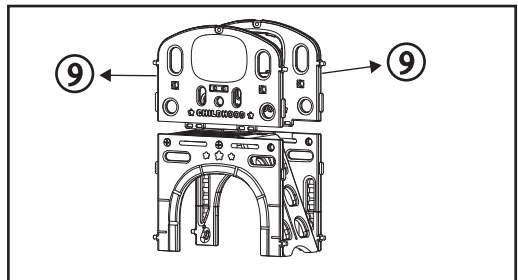

Insert aisle side panels.

STEP 12

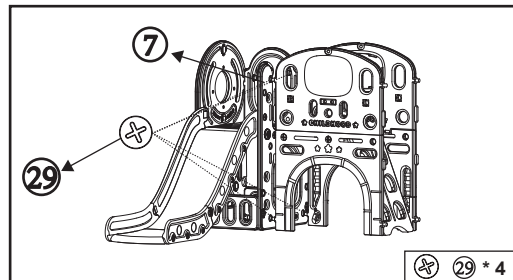

Connect the assembled aisle to the U-shaped side panel of the slide.

STEP 17

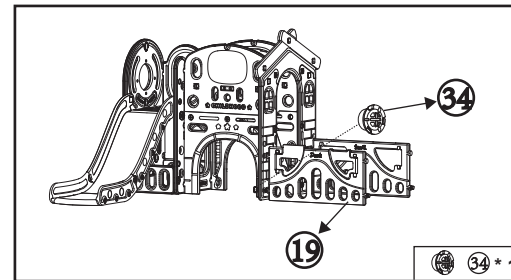

Assemble the horizontal plate under the table with two supports and the vertical plate with window A side.

STEP 18

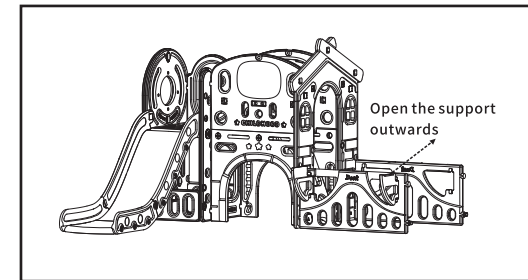

Open the two supports of the horizontal board under the table outwards.

ASSEMBLING

STEP 19

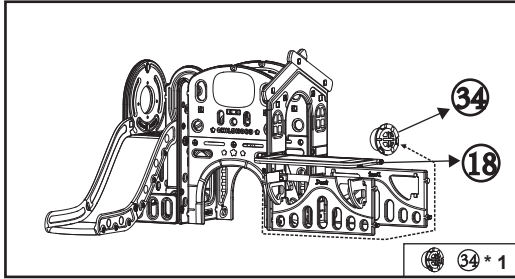

Place the desktop on the two supports and tighten the bayonet nuts.

STEP 20

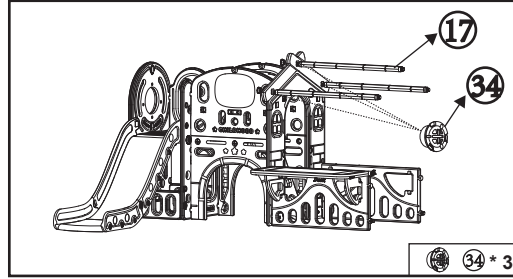

Insert the roof support rod into the corresponding hole in the roof.

ASSEMBLING

STEP 25

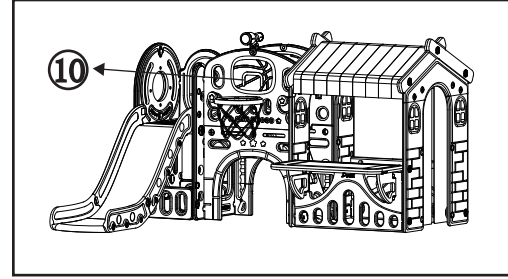

Attach the sticker and the installation is complete.

STEP 21

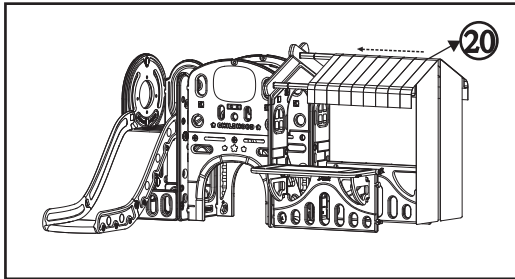

Put the tent fabric on the roof support poles.

STEP 22

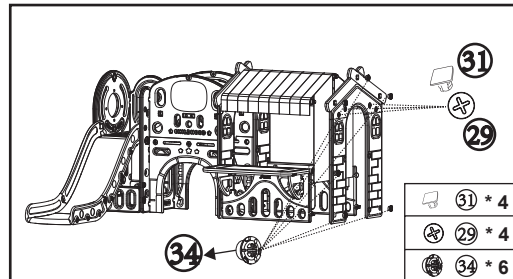

Fix side A/B of window riser to other side.

STEP 23

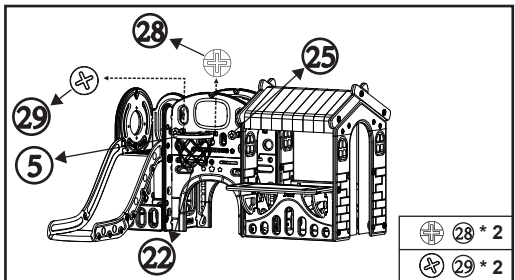

Install the nose, basketball hoop, and hang the ferrules and basketball net.

STEP 24

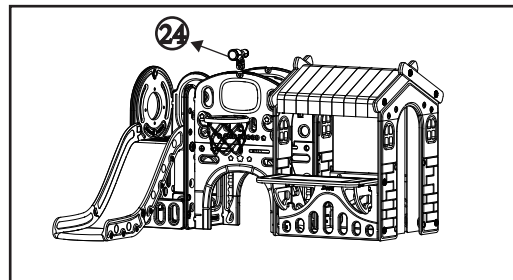

Snap the telescope into the corresponding position in the aisle.

BASKETBALL NET INSTALLATION STEPS

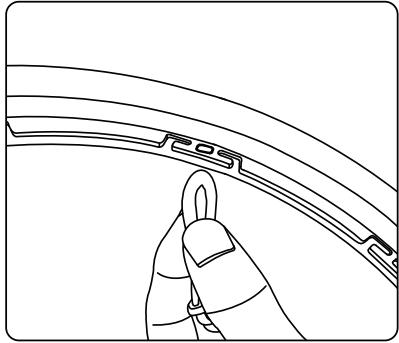

1 Pick up one end of the basketball net.

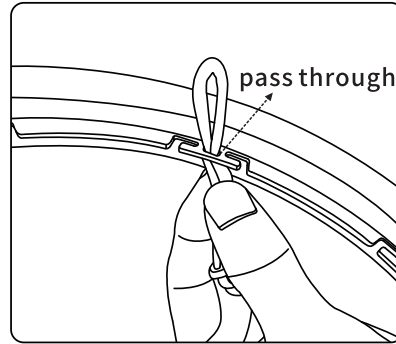

2 Pass the basketball net through the middle of the basketball hoop hanging hole.

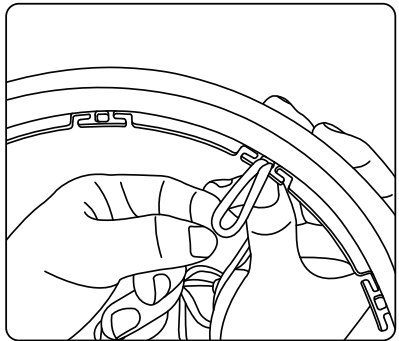

3 Reserve enough passed parts to facilitate subsequent operations.

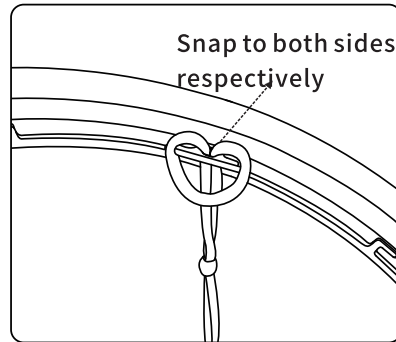

4 Snap the basketball net into the grooves on both sides of the hanging hole.

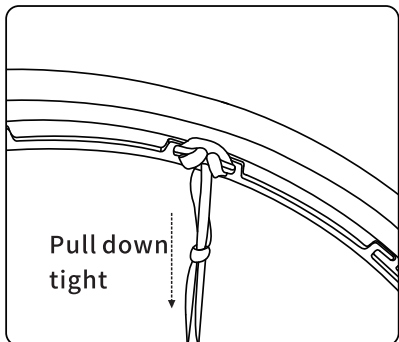

5 Tighten the basketball net downwards so that the ropes passing through the hanging holes form a double knot.

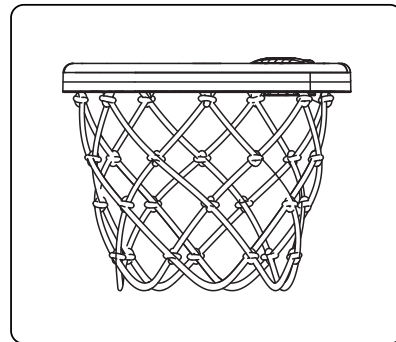

6 Use the same method to hang basketball nets in other directions to the corresponding holes.