

Gorgeous Starlight Blooms Crystal LED Chandelier

Caution: Please turn off power before installation and read the manual carefully, we advise you contact professional electricians to install for safety purpose.

Product Features

Style: Modern/Glam
Material: Stainless Steel, Crystals
Color: Silver

Base Type: Integrated LED
Light Source Included: Yes
Voltage: 120VAC
Wattage: 28.5W

Package includes

1 x Chandelier Light
1 x Accessories Kit
1 x User's Manual

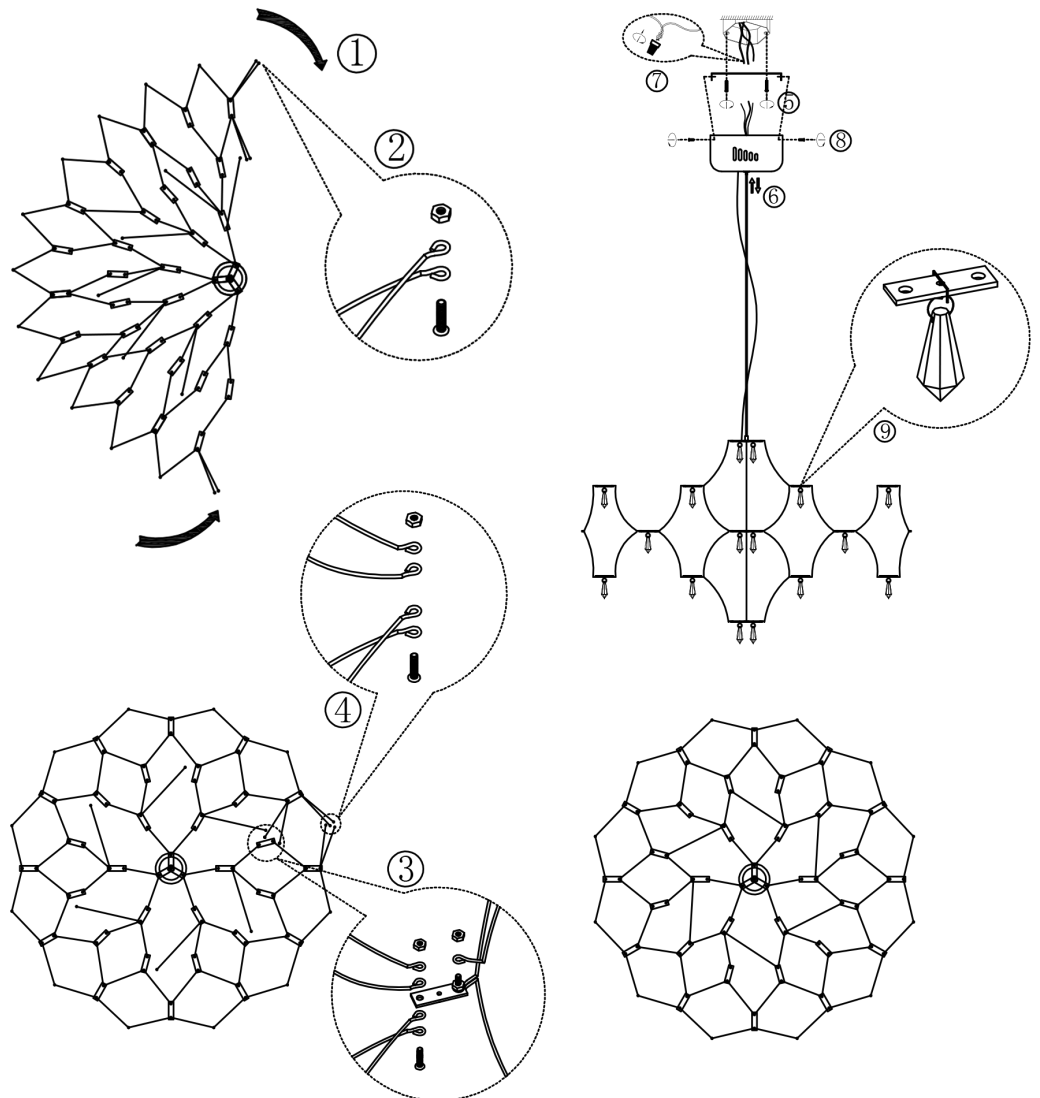

Installation Instructions

1. Carefully unfold the fixture frame into 12 equal sections.
2. Unscrew the fasteners at the connection points.
3. Place the iron wires over the holes on the light source board, as shown in the diagram. Secure them with the provided screws and nuts. (Refer to the pre-installed section for guidance.)
4. Pass the screws through the four iron wires and tighten the nuts firmly. (Again, refer to the pre-installed section for reference.)
5. Attach the mounting plate on the junction box using provided mounting screws.
6. Set the length of the stainless steel cord and electrical wire according to your installation needs.
7. Connect the wires (neutral, live and ground wire) from the fixture to the wires reserved in the junction box using wire nuts.
8. Position the canopy over the mounting plate, tighten the side nuts to firmly secure the canopy in place.
9. Insert the split pins into the holes on the light source board, ensuring that the ends of the split pins are positioned perpendicular to the board to prevent any risk of short-circuiting. Then fit the crystal drops.

Note: please use this product accordingly to its intended purpose, do not retrofit or remodeling the product. The warranty does not cover if the failure is caused by the third party product, or natural disasters.