

ASSEMBLY INSTRUCTIONS



WRITING DESK

ASSEMBLY INSTRUCTIONS

ASSEMBLY TIPS:

1. Remove hardware from box and sort by size.
2. Please check to see that all hardware and parts are present prior to start of assembly.
3. Please follow attached instructions in the same sequence as numbered to assure fast & easy assembly.



WARNING !

1. Don't attempt to repair or modify parts that are broken or defective. Please contact the store immediately.
2. This product is for home use only and not intended for commercial establishments.

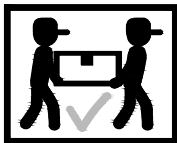

ASSEMBLY TIME 30 MINUTES

PARTS IDENTIFICATION

B1 (BOX 1):

C. TOP BOX

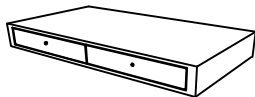

1PC

B2 (BOX 2):

A. GLASS

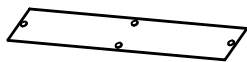

1PC

B. SHELF
FRAME



1PC

D. CROSSBAR



2PCS

E. BOTTOM
FRAME



1PC

F. RIGHT LEG

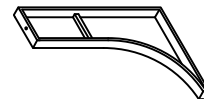

1PC

G. LEFT LEG



1PC

HARDWARE PACKAGE

1. ALLEN WRENCH
(Ø1/4"*57mm-SILVER)



1PC

2. BOLT
(Ø1/4"*8mm-SILVER)



2PCS

3. BOLT
(Ø1/4"*15mm-SILVER)



4PCS

4. BOLT
(Ø1/4"*20mm-SILVER)



3PCS

5. BOLT
(Ø1/4"*25mm-SILVER)



2PCS

6. BOLT
(Ø1/4"*32mm-SILVER)



10PCS

7. FLAT WRENCH
(Ø1/4"*16mm-SILVER)



18PCS

8. FLAT HEAD SCREW
M4"*15mm-SILVER)



2PCS

9. HANDLE TOP
(SILVER)



2PCS

10. HANDLE RING
(SILVER)



2PCS

ASSEMBLY INSTRUCTIONS

STEP 1: Don't tighten all bolts on this step

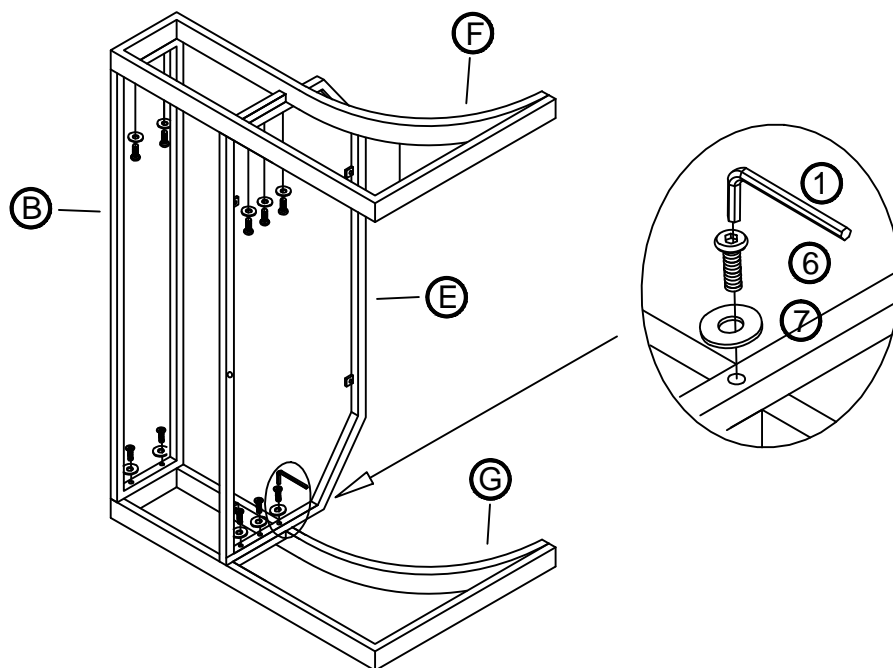

STEP 2

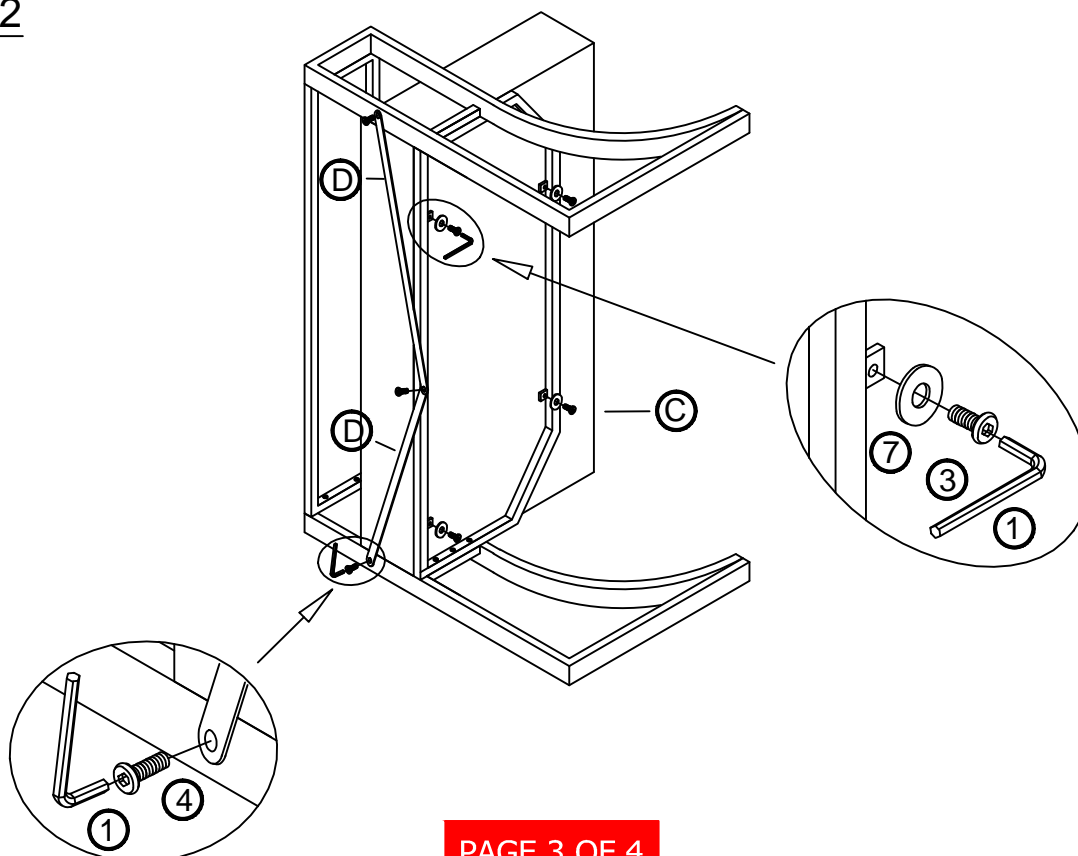

ASSEMBLY INSTRUCTIONS

STEP 3

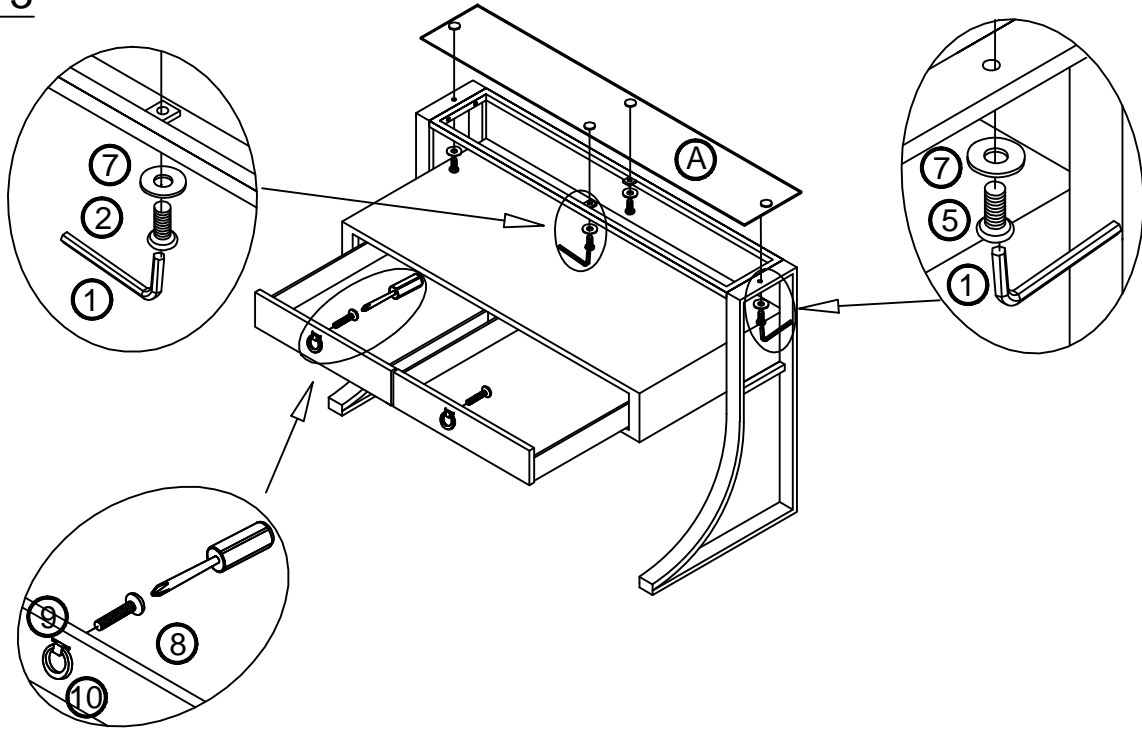

STEP 4: Tighten all screws on this step COMPLETE

