



INSTRUCTION MANUAL

■ SIT DOWN ON THE JOB IN CUSTOM COMFORT.

No two people are alike. But no matter what you're built like, there's one chair that's built for everyone's comfort chair. Take a look at the diagram below. It's packed with features that make it easy to fine-tune the comfort to meet your unique needs.

■ PRODUCT FEATURES

Pneumatic Seat Height Adjustment

Seat height adjusts to assure correct posture and relieves stress on back, thighs and legs.

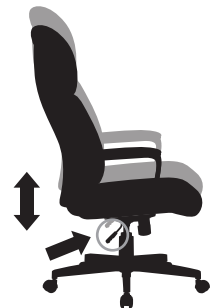
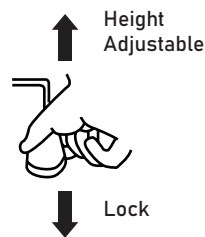

Tilt Tension

Easy adjustment of chair flexibility avoids heavy pushing and relaxes muscles.



Variable Seat Tilt Lock

Simple locking mechanism fixes seat in desired position to assure healthy posture.



PACKAGE LIST

A

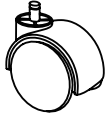

Casters *5

B



Star Base *1

C

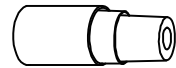

Lift Cover*1

D



Lift *1

E

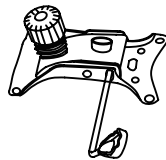

Seat Plate *1

F

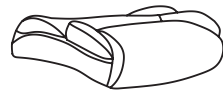

Seat Cushion *1

G

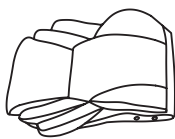

Back Cushion *1

H

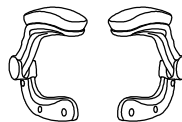

Arms *2

I

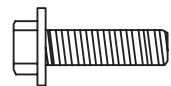

Bolts 1/4x25mm *10

J



Bolts 1/4x22mm *2

K



Plastic Caps *8

L

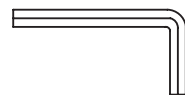

Wrench *1

ASSEMBLY INSTRUCTIONS

Step 1

Turn the Star Base(B) upside down, then press the Casters(A) into the holes at the end of each base leg, insert the Lift(D) into the center hole of the Star Base, the Lift Cover(C) should be placed over the Lift.

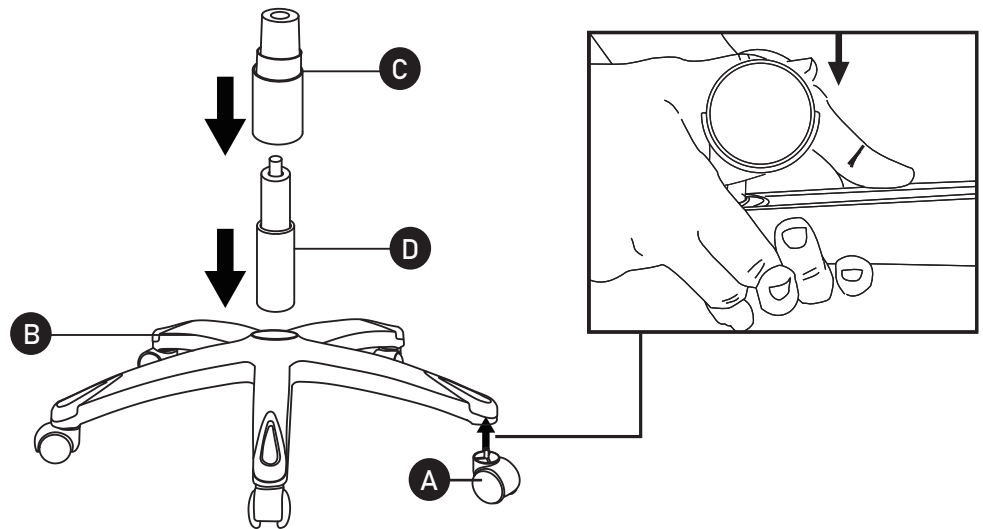

Step 2

Align the Seat Plate(E) over the pre-drilled holes underneath the Seat Cushion(F), make sure that the front of the seat plate is facing the front of the Seat Cushion. Attach the Seat Plate to the Seat Cushion using 2 Bolts (I) and 2 Bolts (J), tighten all the bolts with the Wrench(L), being careful not to miss-thread the bolts or damaged the seat.



Bolts 1/4x25mm *2



Bolts 1/4x22mm *2



Wrench *1

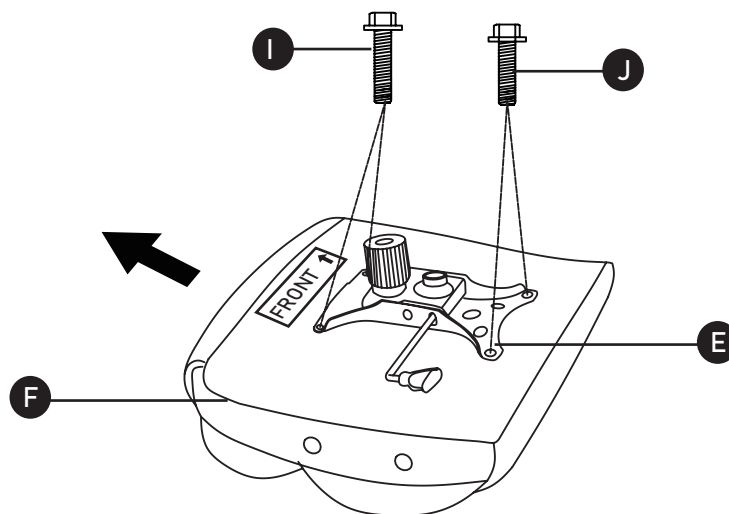

ASSEMBLY INSTRUCTIONS

Step 3

Turn the Seat Cushion(F) upright and align the center hole of the seat plate over the lift, then push the seat cushion down onto the lift firmly until the connection is secure.

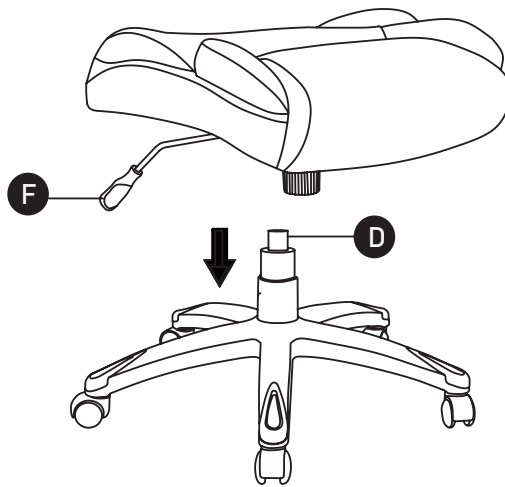

Step 4

Attach the Arms(H) to the Seat Cushion(F) with Four Bolts (I) , using the Wrench(L)

NOTE: Arm rests are labeled with an "L" (left) or "R" (right) to show which sides they should be placed on.

NOTE: Do not tighten all the bolts to 100%, make sure it have space to adjust in the next steps.

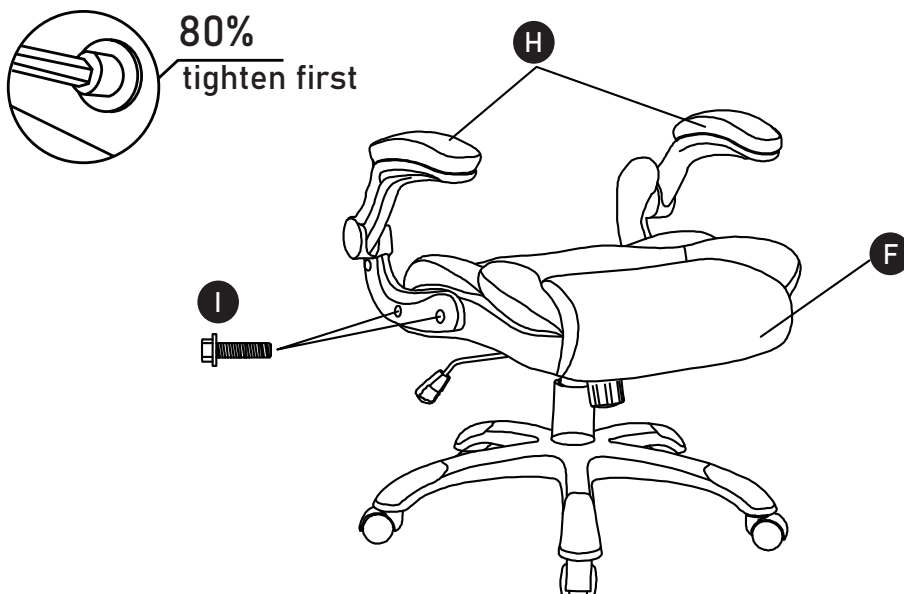
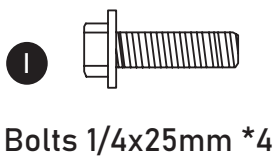

ASSEMBLY INSTRUCTIONS

Step 5

Lay the Back Cushion on the seat of the chair with the top of the cushion toward the front. Attach the Back Cushion(G) to the Arms by inserting Two Bolts (I) in the TOP holes with the Wrench(L).

NOTE: Do not tighten all the bolts to 100%, make sure it have space to adjust in the next steps.

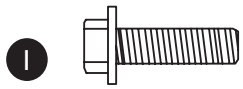

Bolts 1/4x25mm *2



Wrench *1

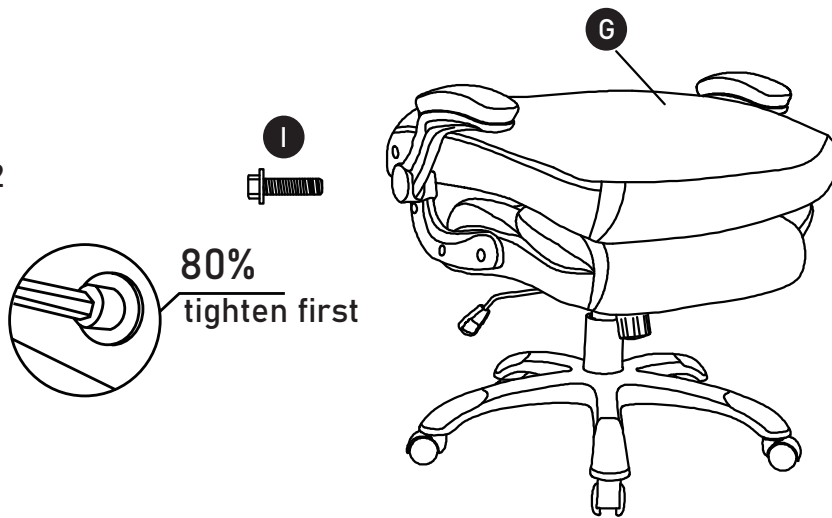

Step 6

Rotate the back of the chair up, then secure it with the LOWER hoels with Two Bolts (I) by using the Wrench(L). **ADJUST BALANCE ON EACH SIDE OF THE CHAIR, AND FULLY TIGHTEN ALL THE BOLTS AT THIS STEP.**

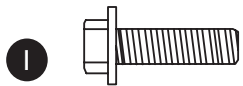

Bolts 1/4x25mm *2



Wrench *1

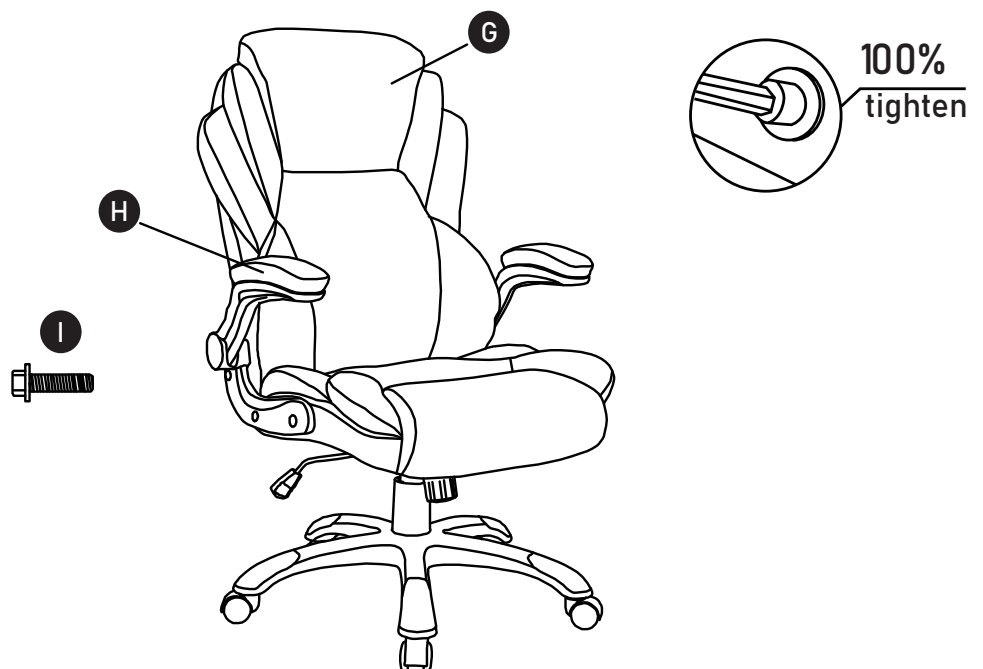

ASSEMBLY INSTRUCTIONS

Step 7

Press the Plastic Caps (K) into the Arms holes to cover the bolts.



Plastic Caps *8



■ SAFETY AND MAINTENANCE

- Do not stand on the chair, Do not use the chair as stepladder.
- Use this product for seating one person at a time.
- Do not use the chair unless all bolts and screws are firmly secured.
- Avoid contact with sharp objects to prevent puncturing the fabric.
- Every 6 months, check all bolts and screws to ensure they are tight.
- To clean, spot clean only using a damp towel and mild cleaner, first test on a small, obscure area of fabric.
- Chair weight limit not to exceed **250 lbs**

■ SAFETY INFORMATION



Sit in the center of the chair, with your back to the backrest



Do not sit at the front edge of the chair



Do not push the chair around when a person is sitting in it



Do not stand on the chair



Do not push down on the backrest when a person is reclined



Do not use the chair with more than one person



Do not place all your weight on the backrest only