

OVENTE®

NON-STICK
**DEEP
FRYER**

FDM1091 SERIES



Before use, please read this manual thoroughly and save for future reference.

ovente.com

OVENTE®

NON-STICK
**DEEP
FRYER**

FDM1091 SERIES

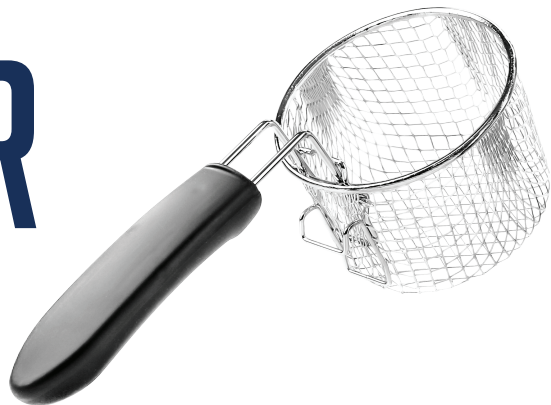

OVENTE

ovente.com

NON-STICK DEEP FRYER

FDM1091 SERIES

TABLE OF CONTENTS

IMPORTANT SAFEGUARDS	4
PARTS & FEATURES	6
USING YOUR DEEP FRYER	7
CARE & MAINTENANCE	9



IMPORTANT SAFEGUARDS

When using electrical appliances, basic safety precautions should always be followed to prevent the risk of fire, electric shock, burns, or other injuries or damages.

- ⚠ Read all instructions carefully before using the deep fryer.
- ⚠ Before connecting the deep fryer, check whether the voltage indicated on the bottom corresponds with the voltage in your home.
- ⚠ This deep fryer must be earthed/grounded.
- ⚠ To protect against electrical shock, do not put the deep fryer, cord or electrical plug in water or other liquids. If the deep fryer falls into a liquid, immediately unplug it.
- ⚠ Before using, please check whether all the parts of this deep fryer are in a good, safe condition. Never use an unsafe appliance.
- ⚠ Make sure that the temperature controller is in the OFF position before plugging it into an electrical outlet. After plugging in, the indicator light will turn on, showing that the deep fryer is powered on.
- ⚠ Do not open the lid when frying.
- ⚠ The surface is hot when frying. Never touch the fryer before it's cooled to avoid being scalded.
- ⚠ Do not operate any appliance with a damaged cord or plug or after it malfunctions, or is dropped or damaged in any manner.
- ⚠ Do not allow children to use the deep fryer without supervision.
- ⚠ This deep fryer is not intended for persons (including children) with reduced physical, sensory or mental capabilities, or lack of experience and knowledge, unless they have been given supervision or instruction concerning the use of the deep fryer by a person responsible for their safety.
- ⚠ Always place the deep fryer on a stable surface to avoid any spillage of hot liquids.



IMPORTANT SAFEGUARDS

When using electrical appliances, basic safety precautions should always be followed to prevent the risk of fire, electric shock, burns, or other injuries or damages.

- ⚠ Do not operate by means of an external timer or a separate remote control system.
- ⚠ The use of accessories or attachments not recommended by the manufacturer may cause hazards.
- ⚠ Do not use outdoors.
- ⚠ Do not let cord hang over edge of table or counter, or touch hot surfaces.
- ⚠ A fire may occur if surface is covered or touching flammable material such as curtains, draperies, walls and the like when in operation.
- ⚠ Do not use your deep fryer for other than its intended use.
- ⚠ Do not place on or near a hot gas or electric burner, or in a heated oven.
- ⚠ Use on a flat and stable, heat-resistant work surface, away from any splashing water or heat sources.
- ⚠ To unplug, grasp plug and pull from the electrical outlet. Never pull the cord.
- ⚠ Make sure the deep fryer is unplugged from the outlet before putting on or taking off attachments, and before cleaning.

PARTS & FEATURES

LOCKING COVER
Prevents spattering and reduces odor

STAINLESS STEEL HOUSING
Compact and stylish

REMOVABLE BASKET
For easy serving

0.9L NON-STICK CAPACITY
Fits 10-15 chicken nuggets with basket; 18-25 without basket

840-WATT POWER
Heats up instantly and cooks food quickly

COOL-TOUCH HANDLES
For safe use and a comfortable grip

LED INDICATOR LIGHT
Easy to see when unit is on

ROTARY TEMPERATURE CONTROL
Set cooking temperatures between 176°F and 374°F





USING YOUR DEEP FRYER

- Before first use, remove all packaging materials from your deep fryer, and wipe the base, bowl, lid and basket with a moist cloth. Never immerse in water; water should not penetrate the interior of the deep fryer.

ASSEMBLY

- Place base on a clean, flat surface where you intend to cook.
- To properly attach the handle to the basket, squeeze together both ends of the handle and insert both ends into the bracket holes (Figure 1). Keeping ends in bracket holes, gently release grip. Firmly pull back handle to snap into position (Figure 2).
- Make sure the unit is turned to MIN on the thermostat dial.
- Connect the magnetic power cord to the unit.

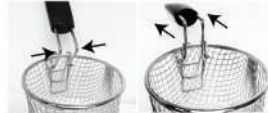

Figure 1

Figure 2

PREHEATING THE DEEP FRYER

- Open the lid.
- Remove the basket using the handle.
- Fill the fryer body with 20-30 oz of oil.
- NOTE: The level must always be between the min and max marks on the oil container wall.
- Close the lid.
- See assembly instructions regarding the power cord. Always attach the cord to the fryer before plugging it into a standard electrical outlet.
- Plug the deep fryer into the power outlet.
- Set the temperature knob to 284°F (the red indicator light will turn on). To heat the oil takes around 7 minutes.



USING YOUR DEEP FRYER

OPERATING THE DEEP FRYER

- 1 Turn the temperature knob clockwise to your desired temperature setting. The indicator light will turn on.
- 2 When the indicator light turns off (after approx. 5-7 minutes) the fryer has reached the selected temperature.
- 3 Open the lid.
- 4 Attach the handle to the basket (refer to assembly instructions on Page 7).
- 5 Put the food in the basket.
- 6 Lower the basket into the oil slowly; watch the oil level and foam in order to keep them from reaching the rim of the oil container, confirming the oil level is appropriate.
- 7 You can detach the handle if you prefer then close the lid.
- 8 The temperature knob will heat or stop heating according to the selected temperature; the indicator light will flicker.
- 9 When the food is cooked, turn the temperature knob counterclockwise to "OFF"; the indicator light will go out.
- 10 Unplug the deep fryer from the power outlet.
- 11 Open the lid.
- 12 If the handle is detached, reattach it to the basket (refer to assembly instructions on Page 7), raise the basket and drain the oil.



CARE & MAINTENANCE

- Unplug the deep fryer before cleaning.
- Clean the outside of the deep fryer and the lid with a damp cloth.
- Never use harsh chemicals or abrasive cleaning agents as these may damage the finish of your deep fryer.
- Detach the handle from the basket.
- Wash the basket with hot water or dish soap. Rinse and dry carefully.
- Never immerse the base in water or wash it directly with water.



ELECTRICAL REQUIREMENTS

Voltage: 120V

Power: 840W

Hertz: 60Hz

OVENTE®

NON-STICK
**DEEP
FRYER**

FDM1091 SERIES





OVENTE WARRANTY

LIMITED ONE (1) YEAR WARRANTY

At Ovente, we aim to make your life easier by producing top-quality housewares, designed with you in mind. We have pledged to uphold all our offerings to the highest standards, and we back all our deep fryers with a one-(1) year warranty from the date of purchase from an authorized retailer. This warranty covers defects in workmanship and materials. It does not include damage due to abuse, misuse, commercial use, accidents or natural wear and tear. In case of replacement, shipping and handling fees may apply.

LIMITATIONS

The warranty stated above is the only warranty applicable to this product. Other expressed or implied warranties are hereby disclaimed. No verbal or written information given by the Manufacturer, its agents or employees shall create a guarantee or in any way increase the scope and duration of this warranty. Repair or replacement as provided under this warranty is the exclusive remedy of the consumer. The manufacturer shall not be liable for incidental or consequential damages resulting from the use of this product. Any implied warranty of merchantability or fitness for a particular purpose on this product is limited to the applicable warranty period set forth above except to the extent prohibited by law. Proof of purchase may be required to validate the order. Promotional items may not be covered under any warranty. Consumer rights may vary from state to state.

For product support email support@ovente.com or call **1-855-926-2626**.

Visit us at ovente.com



[Facebook.com/ovente](https://www.facebook.com/ovente)



[@oventeTweets](https://twitter.com/oventeTweets)



[@Ovente](https://www.instagram.com/Ovente)



[youtube.com/ovente](https://www.youtube.com/ovente)

ovente.com

OVENTE®

Defining Housewares