

|                |
|----------------|
| Catalog Number |
| Notes          |
| Type           |

## FEATURES & SPECIFICATIONS

**INTENDED USE** — Provides a minimum of 90 minutes illumination for the rated wattage upon loss of AC power to meet and exceed code required emergency lighting. Ideal for applications requiring attractive LED unit equipment with quick installation and unparalleled performance for lower mounting heights.

**Certain airborne contaminants can diminish the integrity of acrylic and/or polycarbonate.**  
[Click here for Acrylic-Polycarbonate Compatibility table for suitable uses.](#)

**CONSTRUCTION** — The housing is a standard white (black optional) thermoplastic with a compact and low-profile contemporary design. It is SVA flame rated, impact-resistant, scratch-resistant and corrosion proof. The UV-stable resin resists discoloration from natural and man-made light sources. There is a low-profile, integrated and back-lit test switch with an easily visible multi-color LED status indicator. The back-plate contains a universal j-box mounting pattern to facilitate ease of installation on a wide variety of j-boxes and the front housing allows tool-less access for ease of maintenance. **US Patents Pending.**

**ELM2LF:** Fixed lamp head arrangement for ease of installation and maximum path of egress aiming coverage with no aiming required for wall mount applications.

**ELM2L:** Unique track and swivel arrangement permits full range of direction for lamp head adjustment.

**OPTICS** — Both the ELM2L and ELM2LF feature two, high performance LEDs with acrylic lens' rated at 1.2 watts each and delivering a total of 220 lumens in a linear pattern (LP220L). The typical life of an LED is 10 years. The LED light sources typically never need to be replaced under normal conditions for normal off applications.

**ELECTRICAL** — CCT: 5000K. Orderable in multiple voltages (see ordering tree for specific voltages).

Current-limiting charger maximizes battery life and minimizes energy consumption to meet California Energy Commission Title 20 requirements for small battery charger systems and provides low operating costs.

Short-circuit protection — current-limiting charger circuitry protects printed circuit board from shorts.

Regulated charge voltage maintains constant-charge voltage over a wide range of line voltages.

Prevents over/undercharging that shortens battery life and reduces capacity. Filtered charger input minimizes charge voltage ripple and extends battery life.

**BATTERY:** Sealed, maintenance-free nickel-cadmium or Lithium Iron Phosphate.

Lithium Iron Phosphate battery powers both on board LEDs and up to 2.4W additional LED remote lamp heads simultaneously or offers extended run-time up to 3 hours.

### SELF-DIAGNOSTICS and REMOTE TEST (SDRT option):

Automatic 24-hour recharge after a 90-minute discharge.

Advanced electrical design provides constant light output throughout the entire discharge period.

Brownout protection is automatically switched to emergency mode when supply voltage drops below approximately 80 percent nominal of 120, 220, 277 or 347. Other input voltages may vary.

AC/LVD reset allows battery connection before AC power is applied and prevents battery damage from deep discharge.

Self-Diagnostics: Continuously monitors AC functionality. Test switch and remote tester (ELA LRT accessory) provides manual activation of 30-second diagnostic testing for on-demand visual inspection. Standard derangement monitoring will indicate disconnected battery, charger failure and displays green flashing indicator light while in emergency mode. Single multi-chromatic LED indicator to display two-state charging, test activation and three-state self-diagnostics.

Self-diagnostic testing: Five minutes every 30 days and 90 minutes annually. Diagnostic evaluation of lamps, AC to DC transfer, battery charging and condition of microprocessor. Automatic test is easily postponed for eight hours by activating manual test switch or use of remote tester (ELA LRT accessory).

**INSTALLATION** — Wall mount and ceiling mount standard for ELM2L. Wall mount only for ELM2LF. Blind-mate connector ensures easy installation and safe maintenance. 7/8" entrance provision at top of unit for standard 1/2" conduit entry. Tool-less removal of front cover from back-plate for ease of installation and maintenance.

**LISTINGS** — UL damp location listed standard and wet location listed when used with the WPVS accessory, all at 50-104°F (10-40°C). Meets or exceeds all applicable requirements for UL 924, NFPA 101 (current Life Safety Code), NFPA 70 (NEC), NOM (Norma Oficial Mexicana), California Energy Commission Title 20 section 1605.3 (W)(4), FCC and OSHA. List and labeled to comply with Canadian Standards C22.2 No. 141-10.

**WARRANTY** — 5-year limited warranty. Complete warranty terms located at:

[www.acuitybrands.com/CustomerResources/Terms\\_and\\_conditions.aspx](http://www.acuitybrands.com/CustomerResources/Terms_and_conditions.aspx)

**NOTE:** Actual performance may differ as a result of end-user environment and application.

All values are design or typical values, measured under laboratory conditions at 25 °C.

Specifications subject to change without notice.



Contemporary Commercial LED Emergency Light



**ELM2L**  
Aimable Optics



**ELM2LF**  
Fixed Optics

LITHIUM IRON PHOSPHATE

Nickel Cadmium

## MOUNTING AND SPECIFICATIONS

All dimensions are inches (centimeters) unless otherwise indicated.

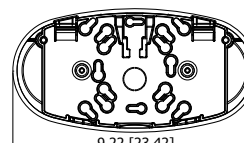
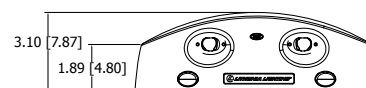
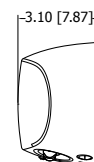
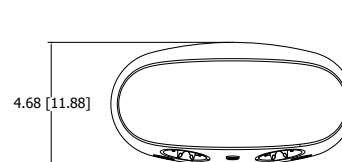
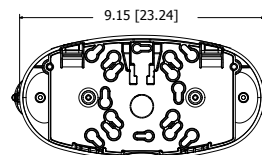
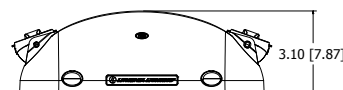
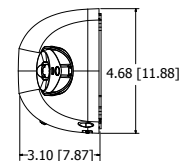
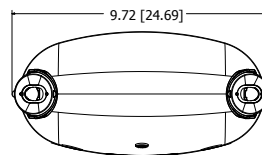

### ELM2L Specifications

Length: 9.72 (24.69)

Depth: 3.10 (7.87)

Height: 4.68 (11.88)

Weight: 1.31lbs (0.59kg)

### ELM2LF Specifications

Length: 9.22 (23.42)

Depth: 3.10 (7.87)

Height: 4.68 (11.88)

Weight: 1.25lbs (0.57kg)



# ELM2L\_ELM2LF Quantum® Contemporary Commercial LED Emergency Light

## NICKEL CADMIUM BATTERY MODELS

### ORDERING INFORMATION

For shortest lead times, configure product using **bolded options**.

**Example:** ELM2LF

| Series                                      | Lamp type  | Housing color                   | Voltage   | Battery type         | Automatic Testing   | Options  |
|---|--|---------------------------------|---|----------------------|---------------------|--|
| ELM2L Aimable optics<br>ELM2LF Fixed optics | <b>(blank)</b> LP220L 220 lumen, 2.4 watt, linear pattern, two lamps | <b>(blank)</b> White<br>B Black | <b>(blank)</b> 120/277 VAC/60Hz<br>120/347 120/347 VAC/60Hz<br>SVOLT 220-240/50-60 Hz | <b>(blank)</b> Nicad | <b>(blank)</b> None | <b>(blank)</b> None<br>RRL RELOC® Ready luminaire<br>WPVS Wet protective vandal shield <sup>1</sup><br>USPOM Assembled in the US |

### Notes

- 1 WPVS breaks out and ships separately and color will match (ex: WPVS SML B). Must be ordered when using for wet location applications. See spec sheet [WPVS](#) for more information.

## LITHIUM IRON PHOSPHATE BATTERY MODELS

### ORDERING INFORMATION

For shortest lead times, configure product using **bolded options**.

**Example:** ELM2LF UVOLT LTP

| Series <sup>1</sup>                         | Lamp type  | Housing color                   | Voltage                      | Battery type                                   | Automatic Testing  | Options  |
|---|--|---------------------------------|------------------------------|--|--|--|
| ELM2L Aimable Optics<br>ELM2LF Fixed Optics | <b>(blank)</b> LP220L 220 lumen, 2.4 Watt, Linear Pattern, two lamps | <b>(blank)</b> White<br>B Black | UVOLT 120 - 347 VAC/50-60 Hz | <b>LTP</b> Lithium Iron Phosphate <sup>1</sup> | <b>(blank)</b> None<br>SDRT Self-diagnostics, remote test <sup>1,2</sup> | <b>(blank)</b> None<br>RRL RELOC® Ready luminaire<br>WPVS Wet protective vandal shield <sup>3</sup><br>USPOM Assembled in the US |

### Notes

- 1 Extended run-time or remote capacity is standard. There are no compatible remotes with SDRT at this time. Non-SDRT models are only compatible with remotes listed in the compatible remote accessories listed on this page.
- 2 SDRT not compatible to run remote heads.
- 3 WPVS breaks out and ships separately and color will match (ex: WPVS SML B). Must be ordered when using for wet location applications. See spec sheet [WPVS](#) for more information.

### BATTERY CAPACITY AND LOADING

| Battery Option | Total Capacity | Maximum# Remote lamp heads* |
|----------------|----------------|-----------------------------|
| LTP            | 4.8W           | 2 - ELA LED M12             |
|                |                | 2 - ELA LED WP M12          |
|                |                | 1 - ELA Q L0309             |
|                |                | 1 - ELA QWP L0309           |

\* These are in addition to the lamp heads on the product.

### LTP Compatible Remote Accessories<sup>3</sup>: Order as separate catalog number.

|                  |   |
|------------------|---|
| ELA Q L0309      | Single LED indoor remote head, white. See spec sheet <a href="#">ELA-Q-LED</a> .                              |
| ELA QWP L0309    | Single LED weather-proof remote head, gray. See spec sheet <a href="#">ELA-Q-LED</a> .                        |
| ELA LED M12      | Single LED remote lamp. See spec sheet <a href="#">ELA LED</a> (Contractor Select LED Remotes).               |
| ELA LED WP M12   | Single LED Weather proof remote lamp. See spec sheet <a href="#">ELA LED</a> (Contractor Select LED Remotes). |
| ELA LED T M12    | Twin LED remote lamp. See spec sheet <a href="#">ELA LED</a> (Contractor Select LED Remotes).                 |
| ELA LED T WP M12 | Twin LED Weather proof remote lamp. See spec sheet <a href="#">ELA LED</a> (Contractor Select LED Remotes).   |

### LTP EXTENDED RUN-TIMES

| Products   | Total Run-time with no remotes |
|------------|--------------------------------|
| ELM2L LTP  | 3 hours                        |
| ELM2LF LTP | 3 hours                        |

### Other Accessories: Order as separate catalog number.

|            |  |
|------------|--|
| WPVS SML W | Wet protective vandal shield (must be used for wet location applications)        |
| WPVS SML B | Wet protective vandal shield, black (must be used for wet location applications) |
| ELA WG1    | Wireguard, 15" W x 13-1/2" H x 6" D (see spec sheet <a href="#">ELA-WG</a> )     |
| ELA LRT    | Remote test (laser) for distances up to 30'                                      |



ELA Q



ELA LED



ELA LED T



ELA QWP



ELA LED WP



ELA LED T WP



ELM2L mounted inside the WPVS (white)



ELM2LF mounted inside WPVS (white)

# ELM2L\_ELM2LF Quantum® Contemporary Commercial LED Emergency Light

## SPECIFICATIONS

| ELECTRICAL             |       |            |       |
|------------------------|-------|------------|-------|
| Primary Circuit        |       |            |       |
| Type                   | Volts | Input amps | Watts |
| Nicaid                 | 120   | 0.018      | 1.09  |
|                        | 347   | 0.012      | 1.34  |
| Lithium Iron Phosphate | 120   | 0.022      | 1.35  |
|                        | 347   | 0.014      | 1.64  |

| BATTERY                       |               |              |                      |
|-------------------------------|---------------|--------------|----------------------|
| Nicaid (6V)                   |               |              |                      |
| Typical Shelf life¹           | Typical life¹ | Maintenance² | Temperature Range³,⁴ |
| 3 years                       | 7-9 years     | none         | 50°-104°F (10-40°C)  |
| Lithium Iron Phosphate (3.6V) |               |              |                      |
| Typical Shelf life¹           | Typical life¹ | Maintenance² | Temperature Range³,⁴ |
| 1 years                       | 7-9 years     | none         | 50°-104°F (10-40°C)  |

### Notes

- At 77°F (25°C) ambient temperature, charge/discharge cycles and prolonged full discharge may reduce useful life.
- All life safety equipment, including emergency lighting for path of egress must be tested in accordance with all National Fire Protection Association (NFPA) and local codes. Failure to perform the required testing could jeopardize the safety of occupants and will void all warranties.
- Ambient temperature range where unit will provide capacity for 90 minutes. Higher and lower temperatures affect life and capacity.
- Battery life is negatively impacted by many variables including temperature, charging rates, number of cycles and deep discharges due to long periods of time without AC power.

## SPACING GUIDELINES

\*Note: To see complete photometric report or download the .ies file for this product, visit Lithonia Lighting ELM2L or ELM2LF home page.

| Maximum Spacing Guidelines — ELM2LF |                    |                           |                   |                            |                   |   |
|-------------------------------------|--------------------|---------------------------|-------------------|----------------------------|-------------------|---|
| Mounting Height                     | Illumination Level | Single Luminaire Coverage |                   | Multiple Luminaire Spacing |                   | Application Notes   |
|                                     |                    | 3' Path of Egress         | 6' Path of Egress | 3' Path of Egress          | 6' Path of Egress |   |
| 7.5'                                | 1FC Avg¹           | 32'                       | 20'               | 35'                        | 28'               | 100' Corridor, 8' wide, and 12' high with 80/50/20 reflectances |
| 10'                                 | 1FC Avg¹           | 20'                       | NA                | 27'                        | 24'               |   |

### Notes:

- Also meets the additional illumination requirements of NFPA 101: .1FC minimum and max/min ration of 40:1.

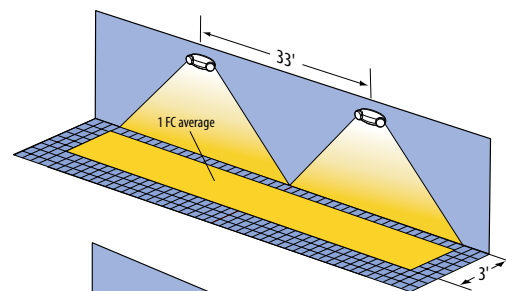

Example of multiple ELM2L luminaires illuminating a 3' path of egress.

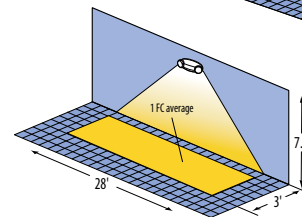

Example of single ELM2L illuminating a 3' path of egress.

\* Application image examples are using LP220L lamp.

| Maximum Spacing Guidelines — ELM2L |                    |                           |                   |                            |                   |   |
|------------------------------------|--------------------|---------------------------|-------------------|----------------------------|-------------------|---|
| Mounting Height                    | Illumination Level | Single Luminaire Coverage |                   | Multiple Luminaire Spacing |                   | Application Notes   |
|                                    |                    | 3' Path of Egress         | 6' Path of Egress | 3' Path of Egress          | 6' Path of Egress |   |
| 7.5'                               | 1FC Avg¹           | 28'                       | 20'               | 33'                        | 27'               | 100' Corridor, 8' wide, and 12' high with 80/50/20 reflectances |
| 10'                                | 1FC Avg¹           | 20'                       | 14'               | 27'                        | 23'               |   |

### Notes:

- Also meets the additional illumination requirements of NFPA 101: .1FC minimum and max/min ration of 40:1.