

INSTRUCTION MANUAL

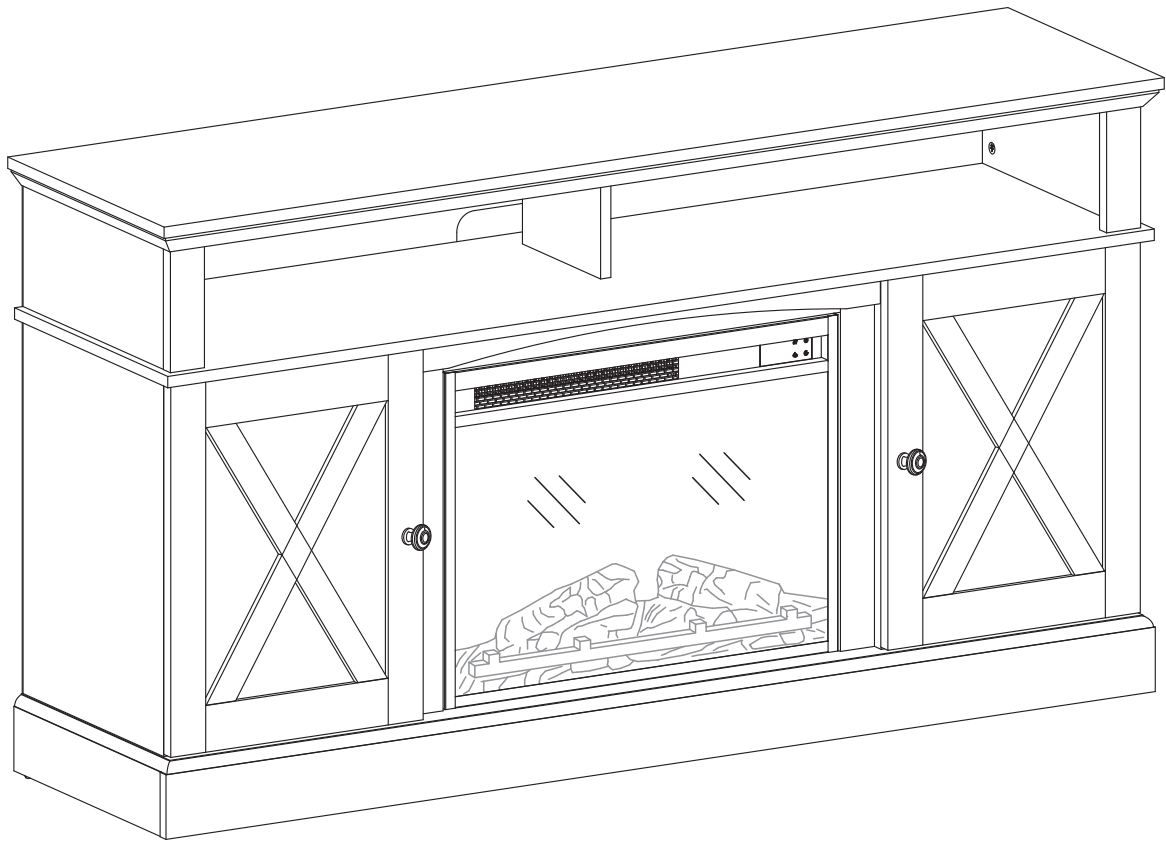

TV Console

Important Safety Information

- Please carefully read all instructions before attempting installation. If you DO NOT understand the instructions or have any questions or concerns, please call technical support or email customer service.

CAUTION: Avoid potential injuries and property damage!

- DO NOT use this product for any purpose that is NOT explicitly specified in this manual. We are NOT liable for damage or injury caused by improper mounting, incorrect assembly or inappropriate use.

WARNING: This product contains small parts that may pose a choking hazard.

- Before starting assembly, verify all parts are included and undamaged. DO NOT use damaged or defective parts. If you require replacement parts, please call technical support or email customer service.
- To prevent the TV console from tipping over, use the wall attachment device provided with this product.

Fits most flat-back TVs up to
65" / 165cm diagonally.

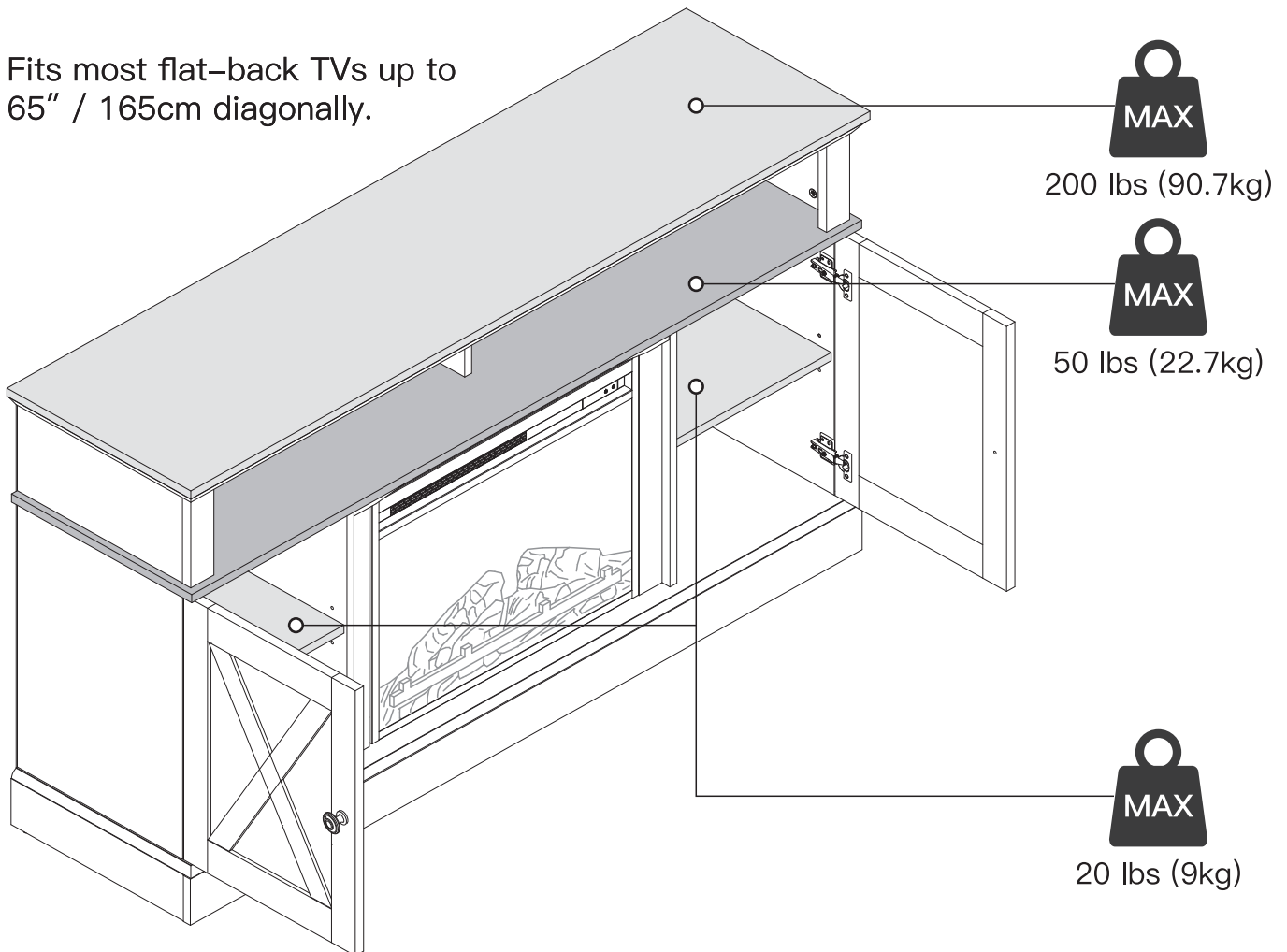

Tools Needed (Not Included)

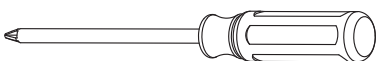

Phillips Screwdriver

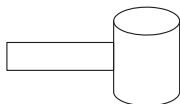

Rubber Mallet

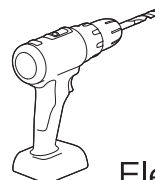

Electric Drill



Hammer

How the Assembly System Works

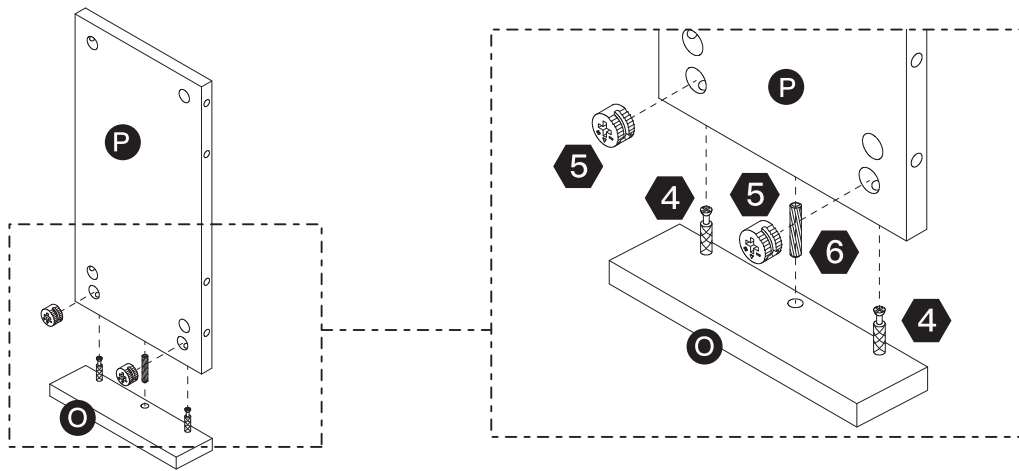

Using the Wood Dowels

Insert the wood dowel [6] at least halfway into the hole. IF NECESSARY, lightly tap the wood dowel with a self-supplied rubber mallet.

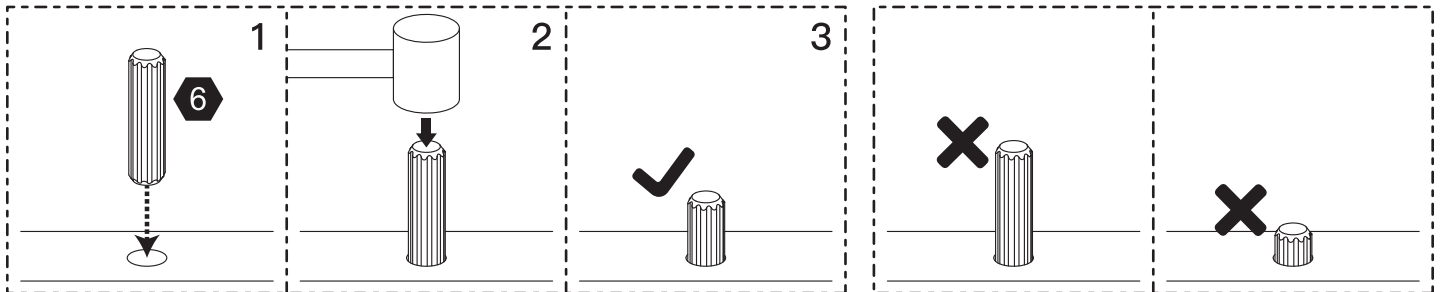

Using the Cam Lock System

1. Screw cam bolt [4] into the threaded hole on the panel.
2. Connect both panels together. Make sure cam bolt [4] goes into the pre-drilled hole on the end of the panel for cam lock [5].
3. Insert cam lock [5] into the large hole on the panel. Make sure the open slot on cam lock [5] faces the head of cam bolt [4].
4. Turn cam lock [5] clockwise to tighten.

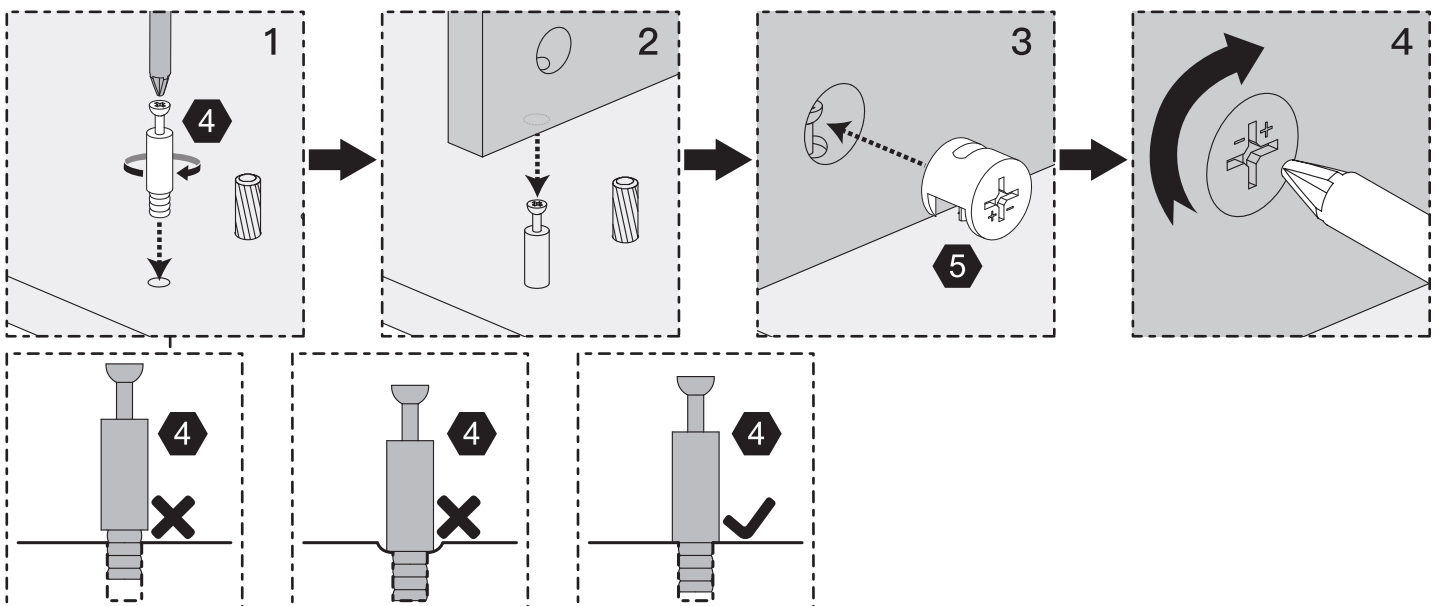

You are now ready to assemble the TV console.

Exploded Drawing

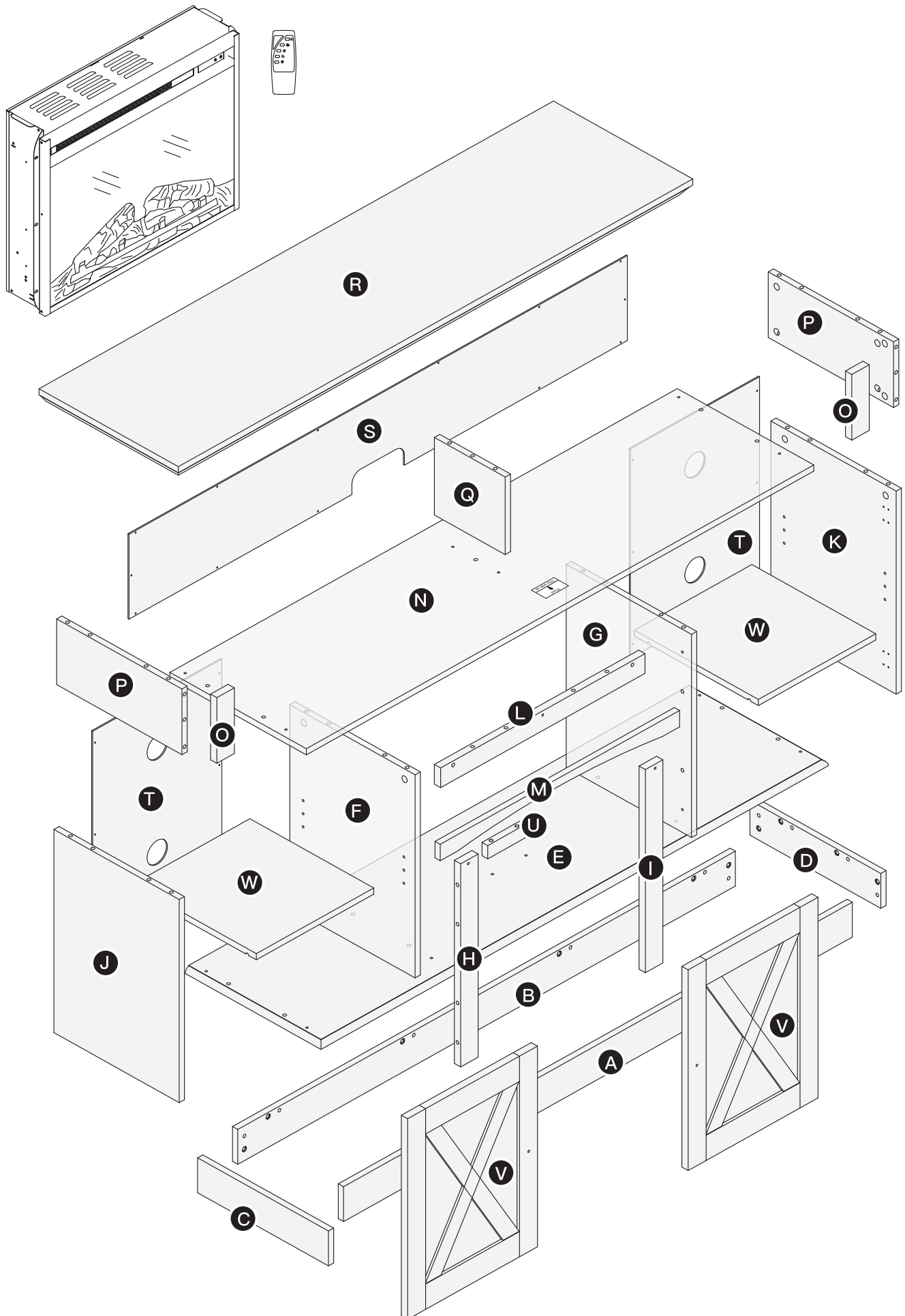

Supplied Parts and Hardware

A

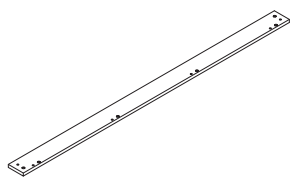

Bottom Front Panel
x 1

B

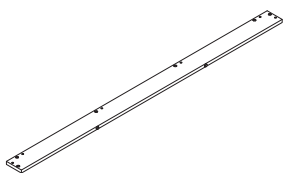

Bottom Back Panel
x 1

C

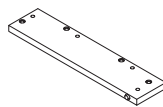

Left Bottom
End Panel
x 1

D

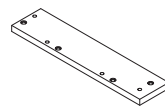

Right Bottom
End Panel
x 1

E

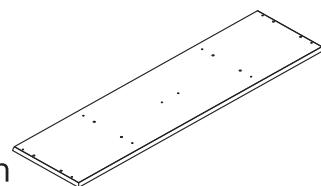

Bottom Panel
x 1

F

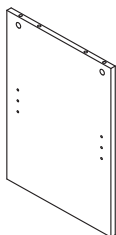

Left Inside Panel
x 1

G

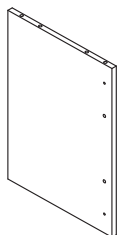

Right Inside Panel
x 1

H



Left Rail
x 1

I



Right Rail
x 1

J

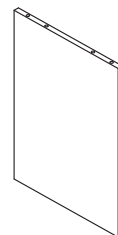

Left Middle End Panel
x 1

K

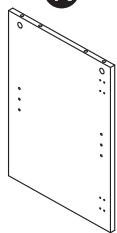

Right Middle End Panel
x 1

L

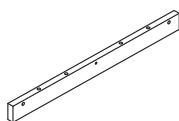

Center Rail
x 1

M

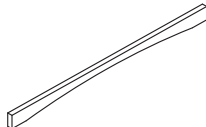

Front Trim
x 1

N

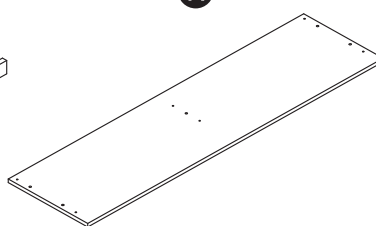

Middle Panel
x 1

O



Panel Connector
x 2

P

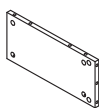

Upper End Panel
x 2

Q



Divider
x 1

R

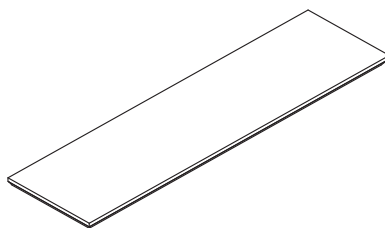

Top Panel
x 1

S

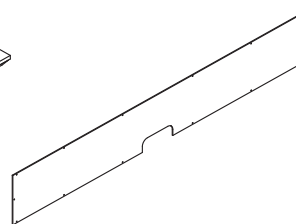

Back Center Panel
x 1

T

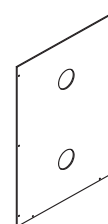

Back Panel
x 2

U



Wood Stopper
x 1

V

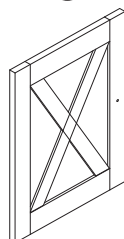

Door
x 2

W

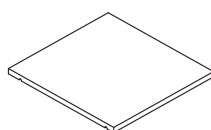

Shelf
x 2

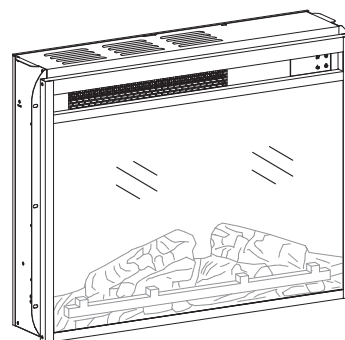

Fireplace



Supplied Parts and Hardware

1

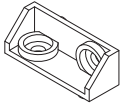

Connector
x 16

2



M6 x 12mm

Bolt
x 32

3



4mm

Allen Key
x 1

4



M6 x 35mm

Cam Bolt
x 30

5



Ø15 x 12mm

Cam Lock
x 30

6

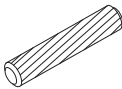

Ø8 x 30mm

Wood Dowel
x 34

7

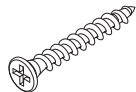

M5 x 35mm

Screw
x 8

8

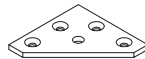

Washer
x 2

9



M3 x 15mm

Screw
x 8

10



1/4-20 x 5/8"

Foot Pad
x 2

11



Ø8 x 20mm

Wood Dowel
x 2

12

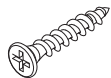

M4 x 28mm

Screw
x 3

13



M3 x 15mm

Screw
x 30

14

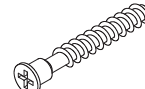

M6 x 50mm

Bolt
x 2

15

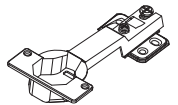

Hinge
x 4

16



M3.5 x 12mm

Screw
x 24

17



Door Pull
x 2

18



M4 x 28mm

Bolt
x 2

19



Ø5 x 16mm

Shelf Support
x 8

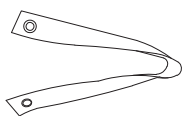

Fixing Kit
x 2 Sets

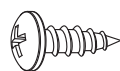

Ø4 x 12mm

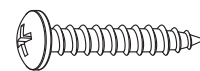

Ø4 x 25mm

⚠ CAUTION!

This wall anchor is for solid concrete ONLY.
DO NOT use them in drywall or wood studs.



Step 1

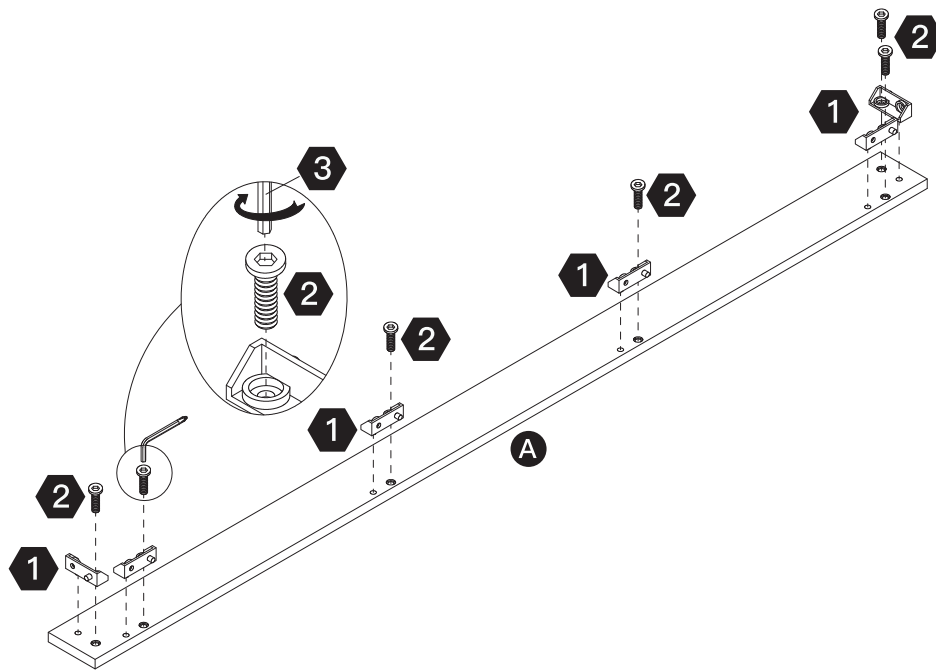

Step 2

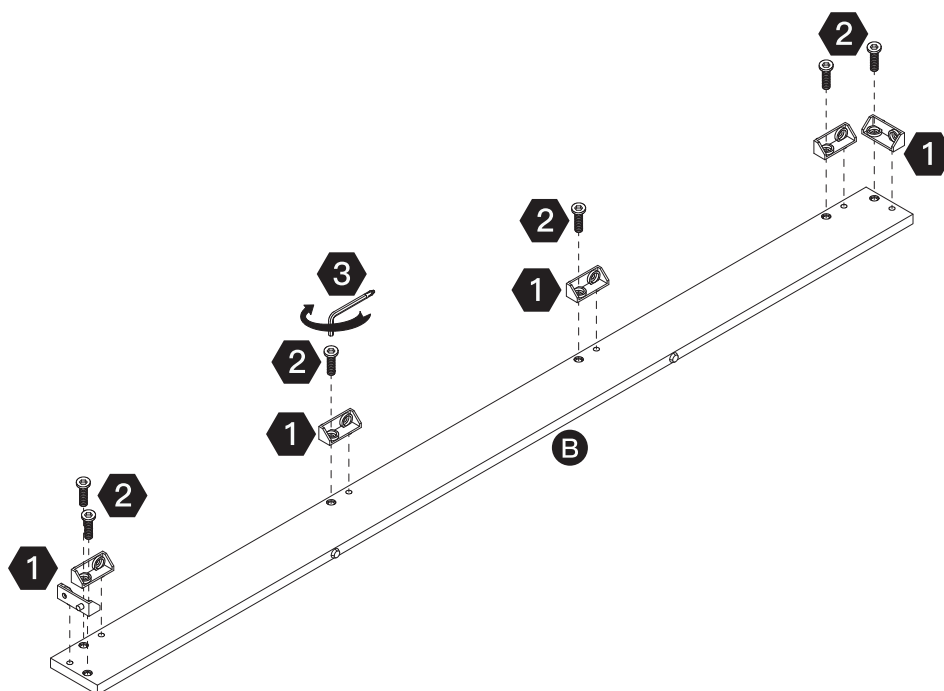
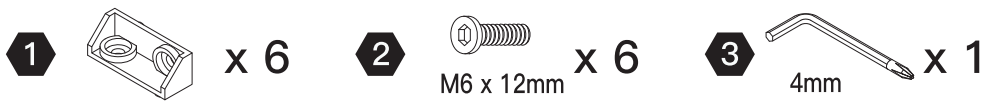

Step 3

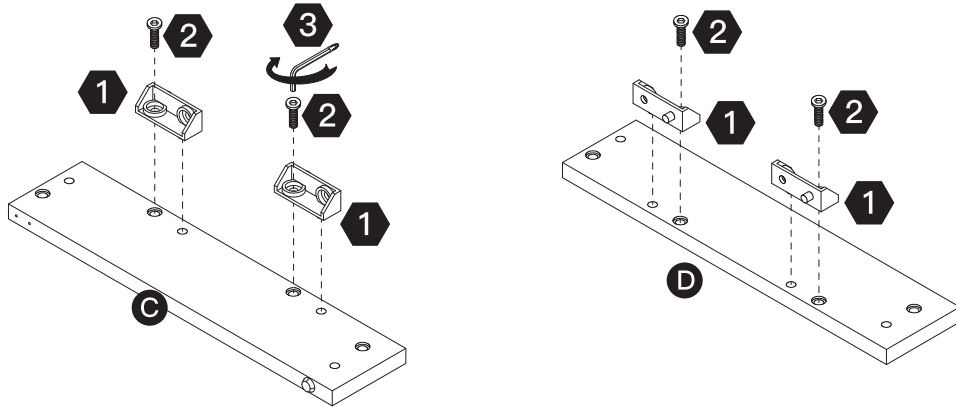
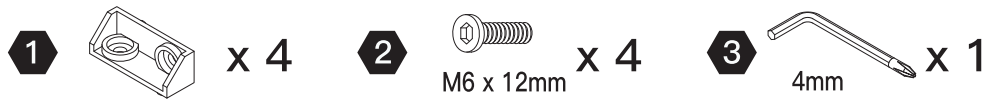

Step 4

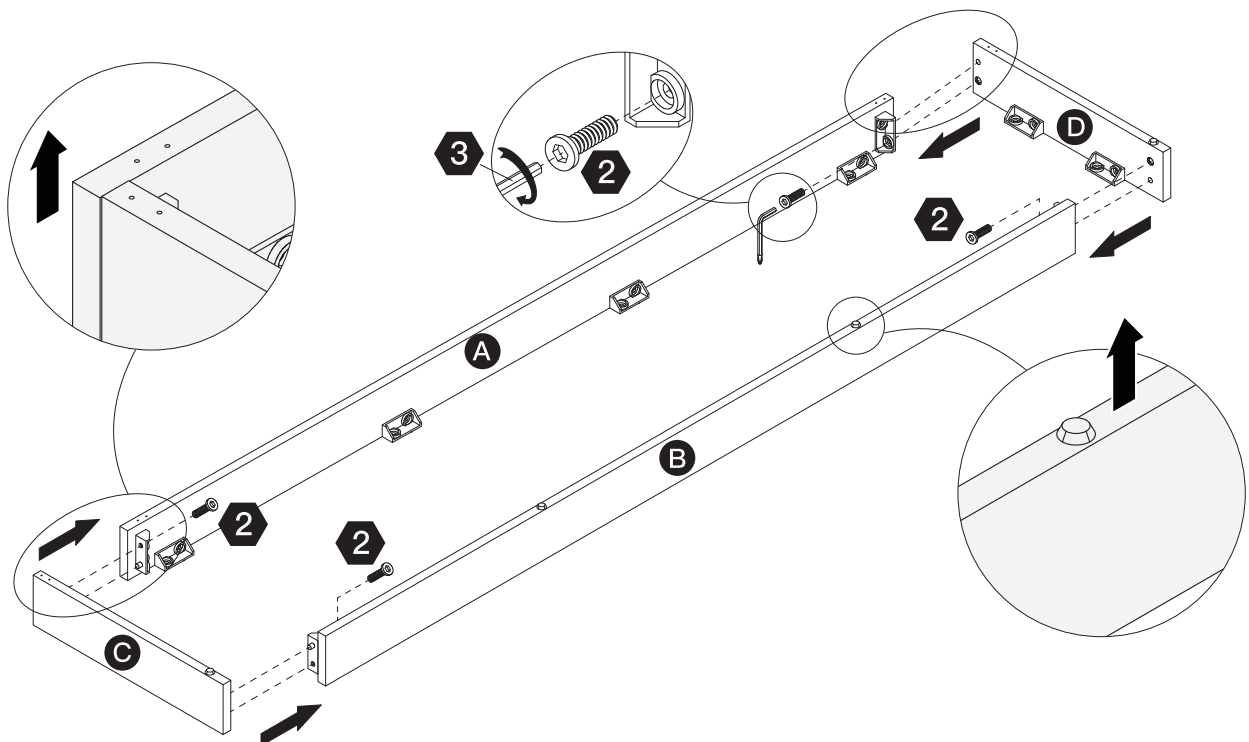

Step 5

2  x 12 **3**  x 1

NOTE: Panel [A] and the round edge of panel [E] should be positioned on the same side.

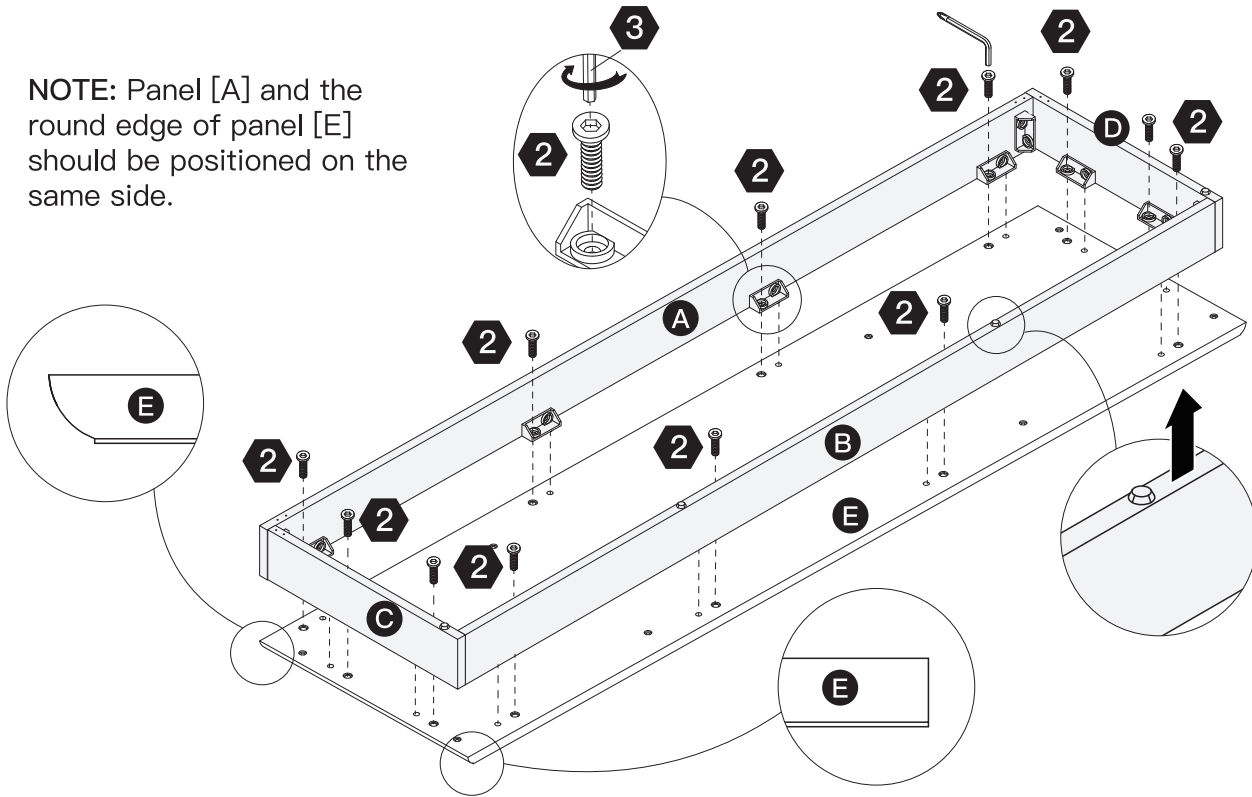

Step 6

4  x 4

 Phillips
Screwdriver
(not included)

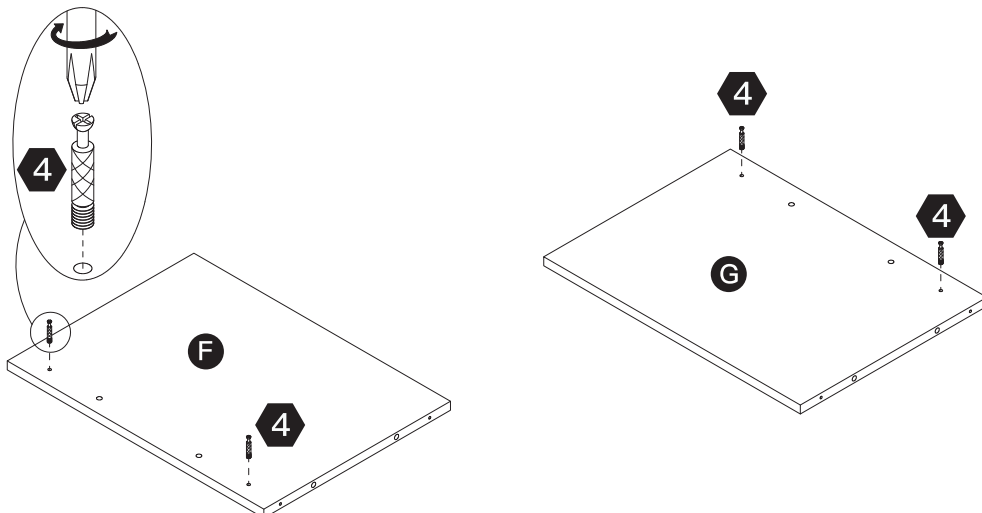

Step 7



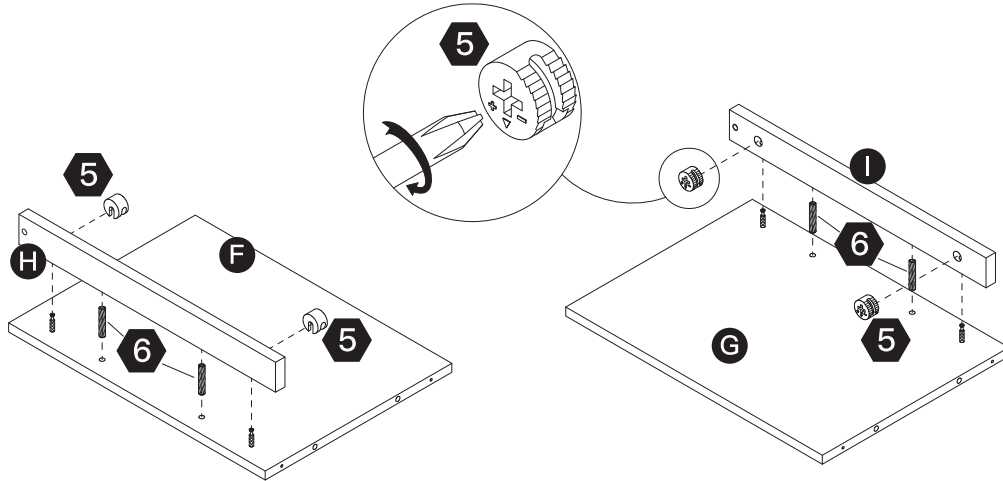

 Phillips
 Screwdriver
 (not included)



Step 8



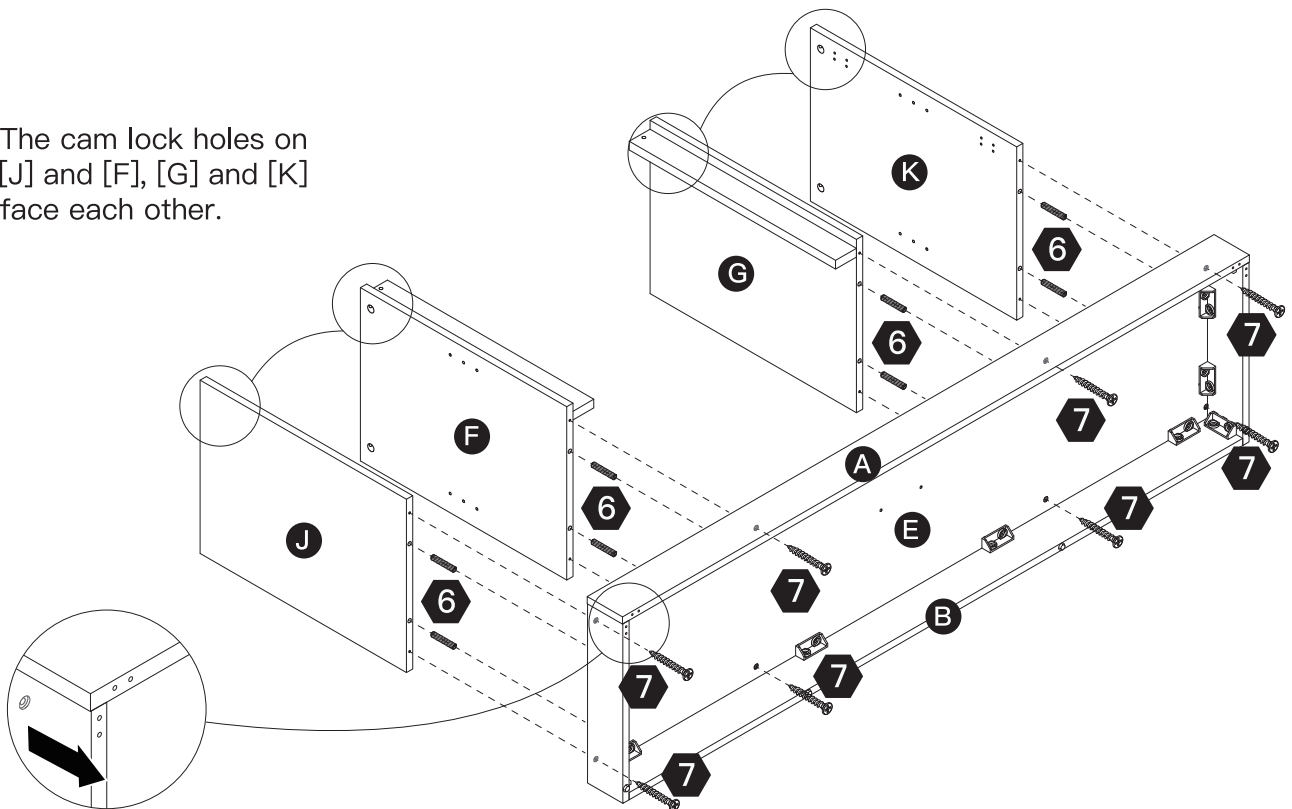

 Phillips
 Screwdriver
 (not included)

NOTE: The cam lock holes on panels [J] and [F], [G] and [K] should face each other.

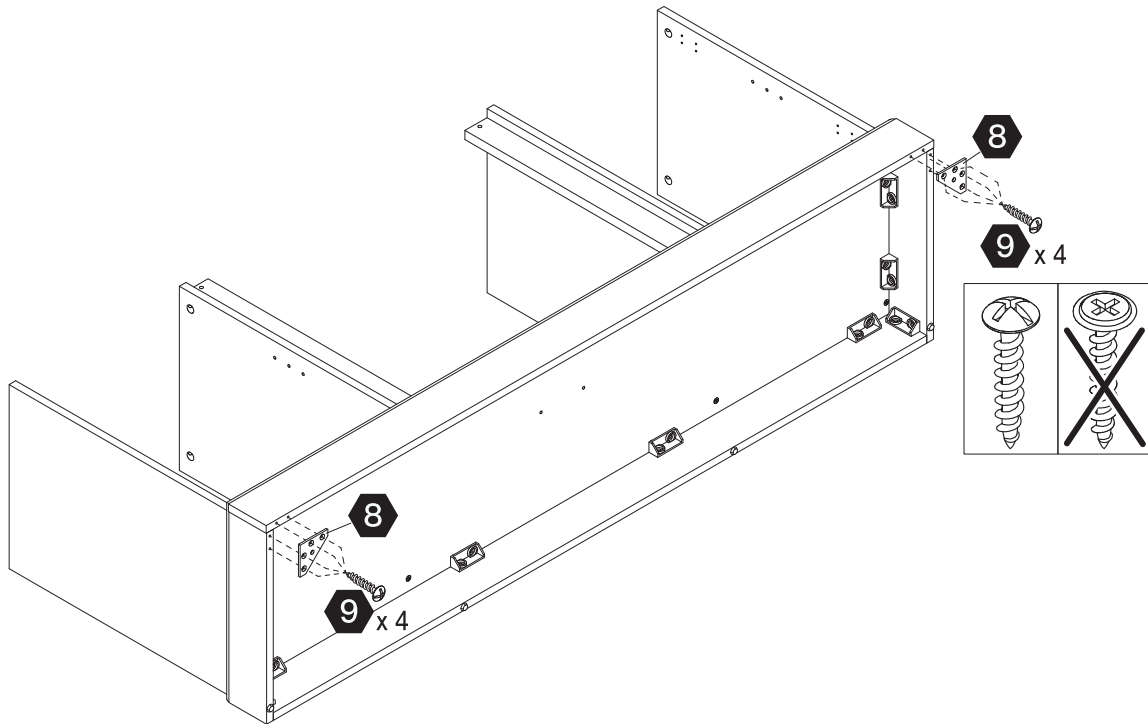
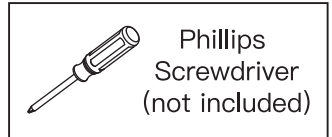

Step 9



Step 10

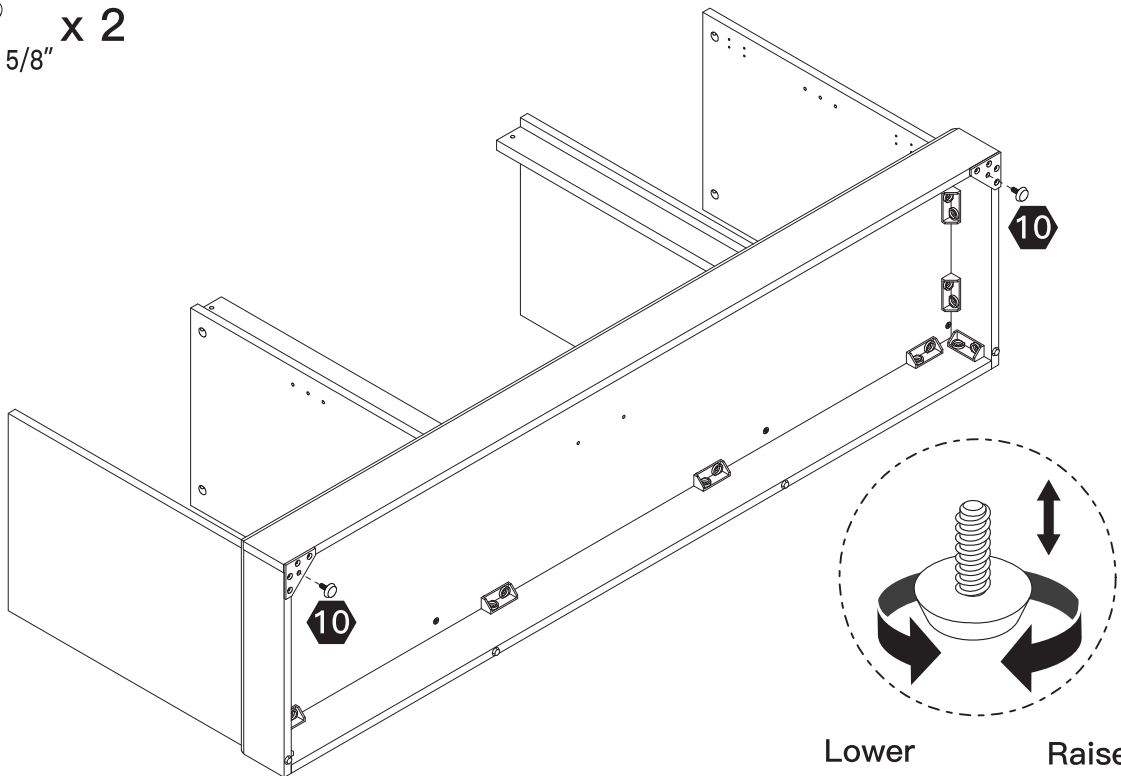
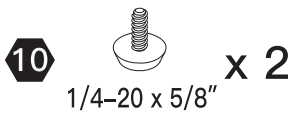

NOTE: Raise the front corners slightly taller than the back to prevent your TV from tipping forward.

Step 11

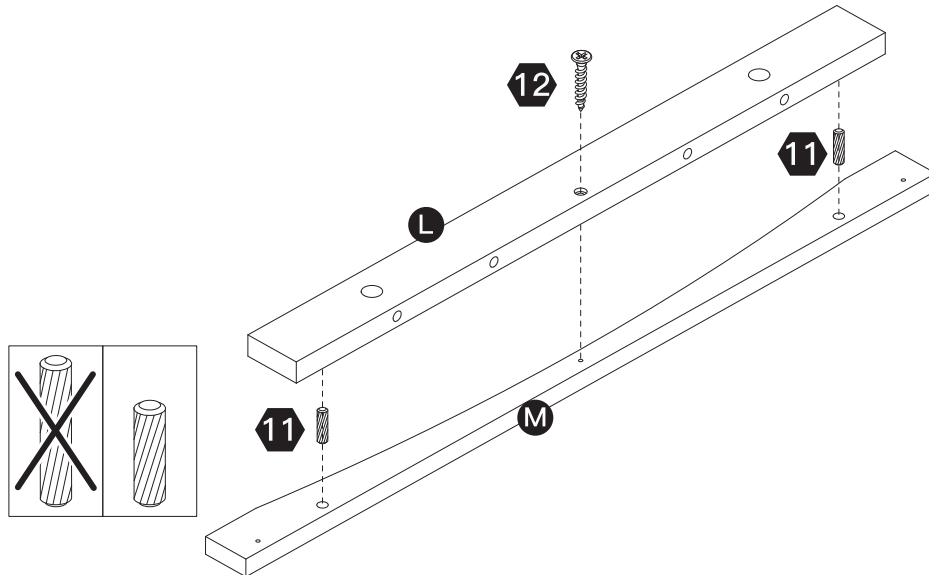
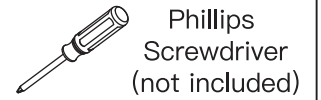

Step 12

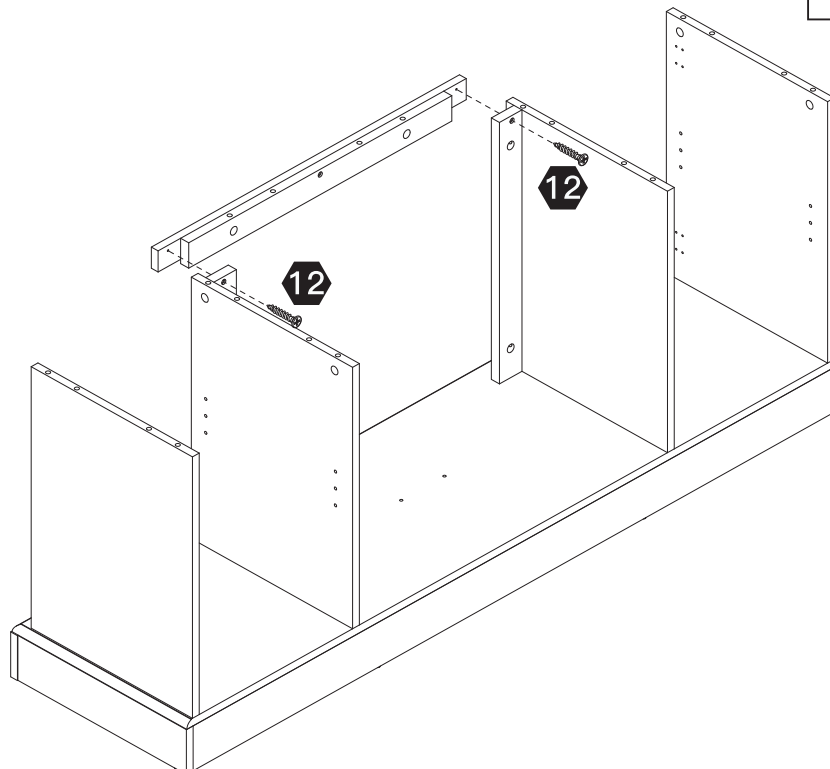
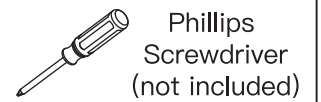

Step 13

4  **M6 x 35mm x 10**

 **Phillips
Screwdriver
(not included)**

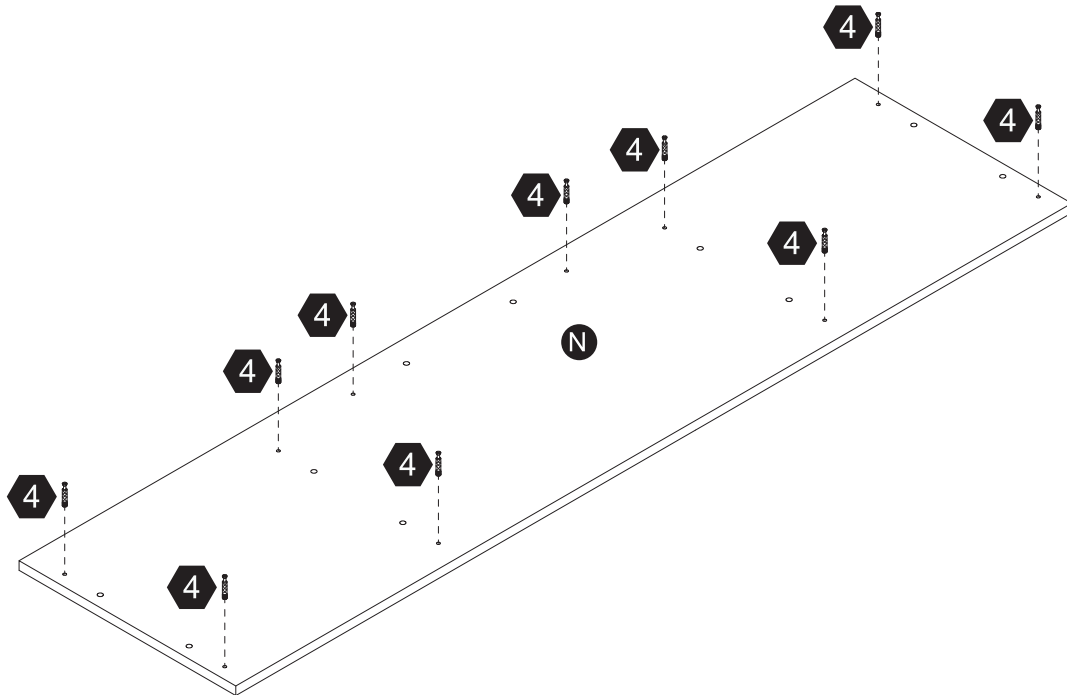



Step 14

5  **x 10**
Ø15 x 12mm

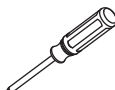
6  **x 10**
Ø8 x 30mm

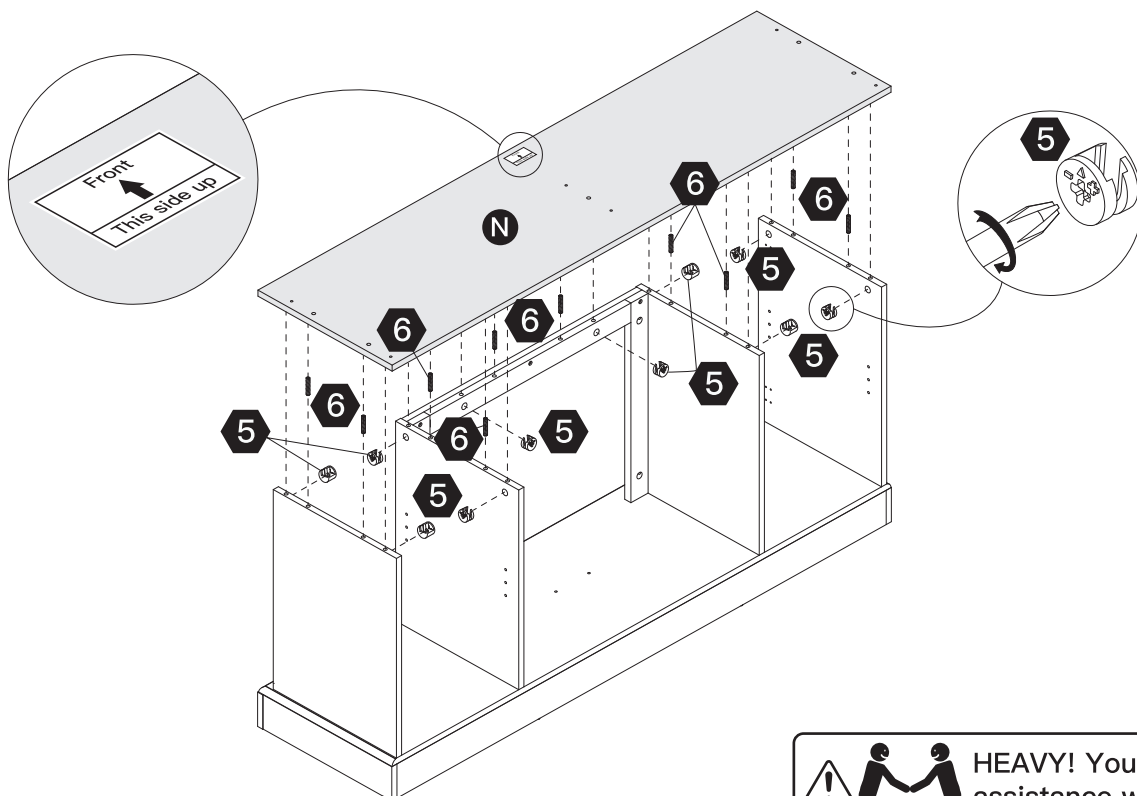
 **Phillips
Screwdriver
(not included)**



 **HEAVY! You may need
assistance with this step.**

Step 15

4  **x 6**
M6 x 35mm

6  **x 5**
Ø8 x 30mm



Phillips
Screwdriver
(not included)

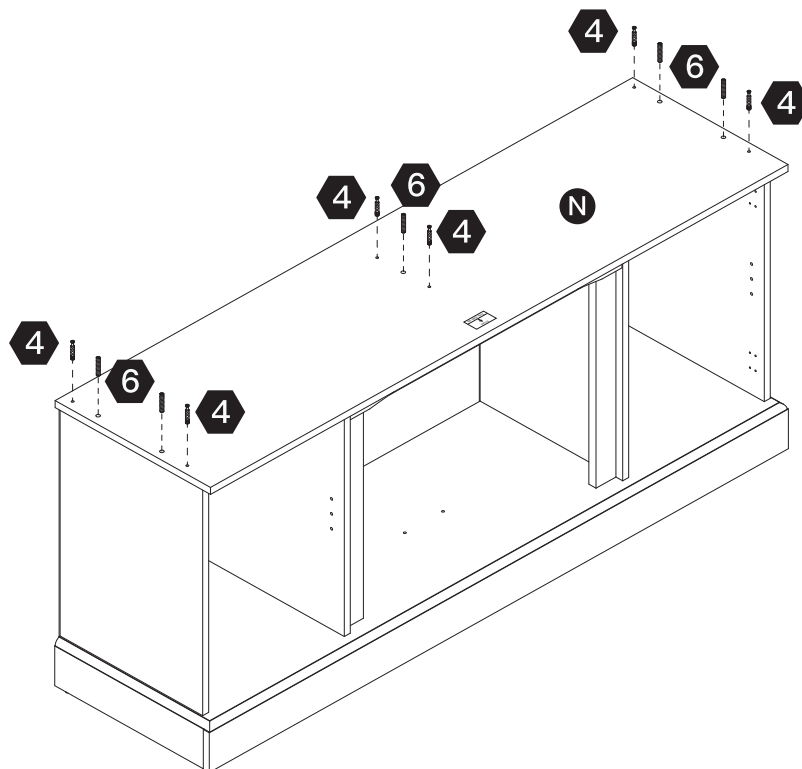

Step 16

4  **x 4**
M6 x 35mm



Phillips
Screwdriver
(not included)

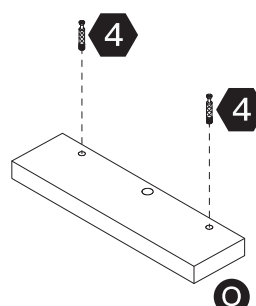
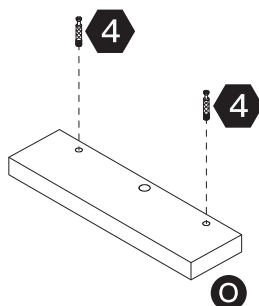

Step 17

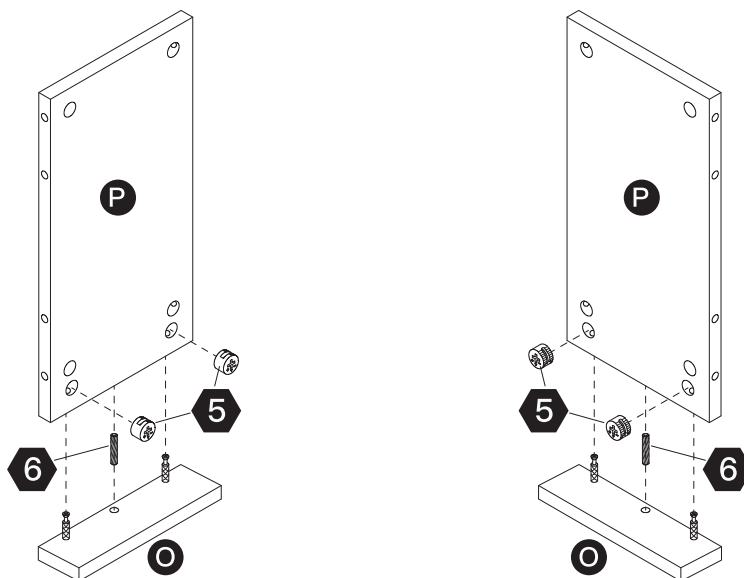
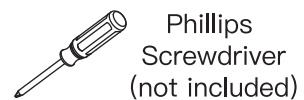
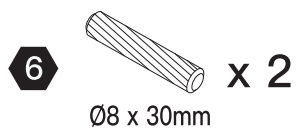
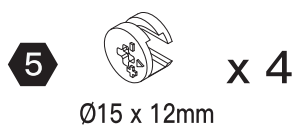

Step 18

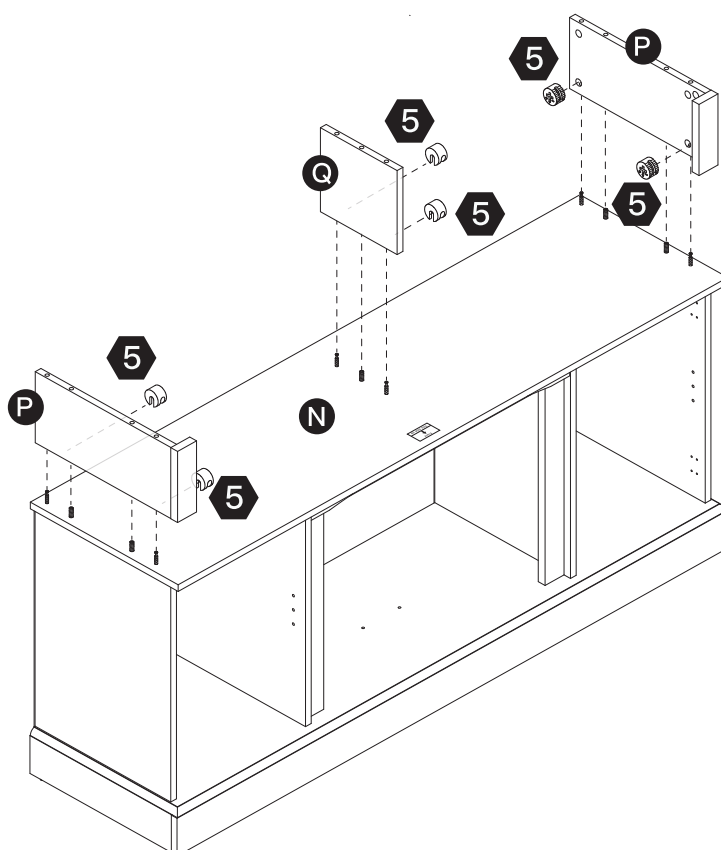
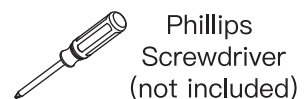
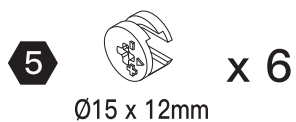

Step 19

4  x 6
M6 x 35mm

 Phillips
Screwdriver
(not included)

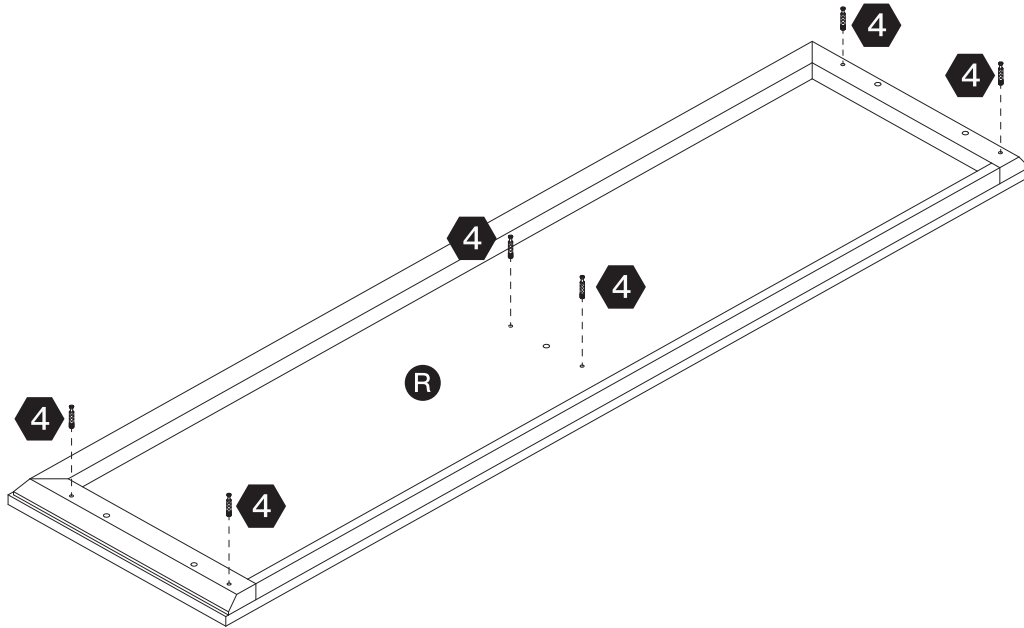

Step 20



5  x 6
Ø15 x 12mm

6  x 5
Ø8 x 30mm

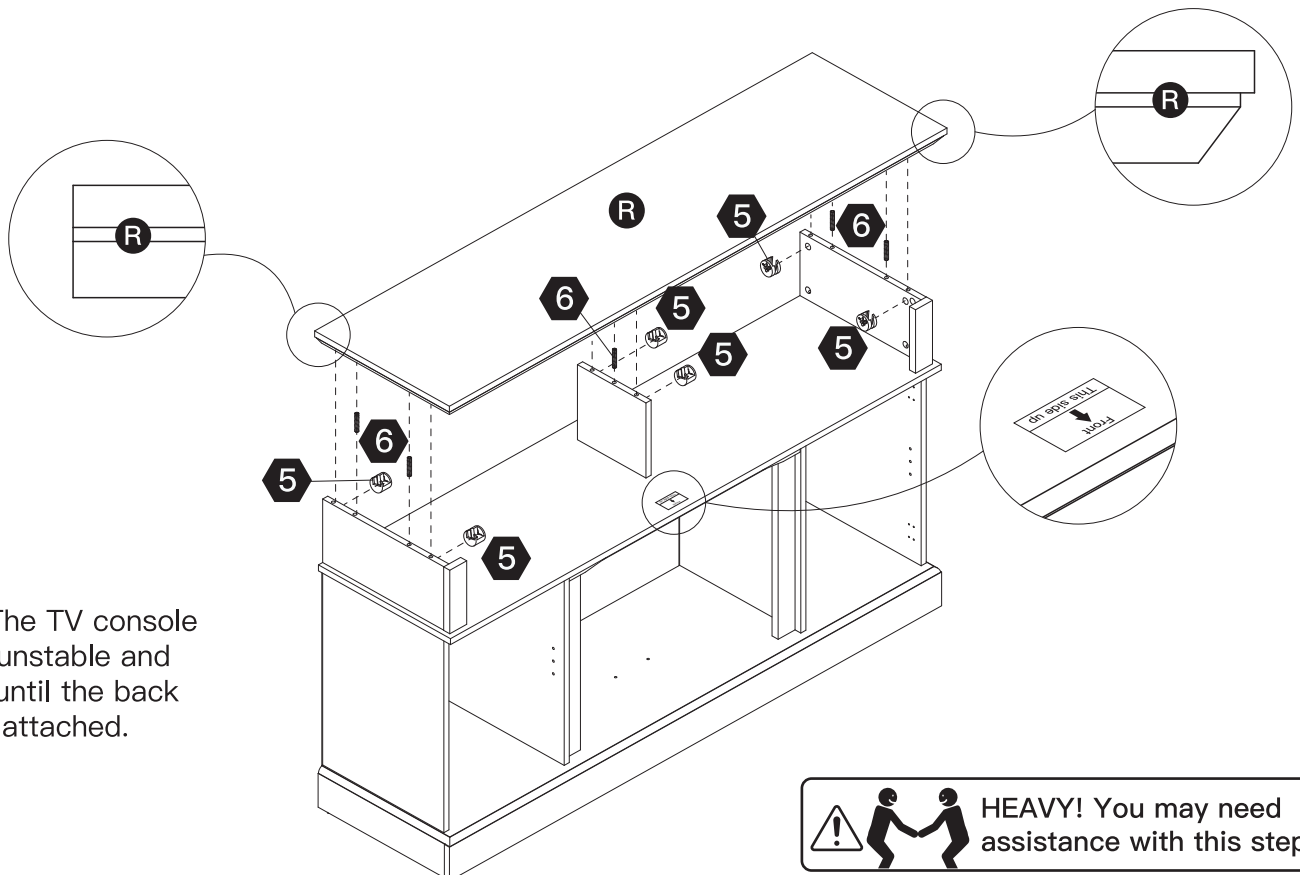
 Phillips
Screwdriver
(not included)



NOTE: The TV console may be unstable and wobble until the back panel is attached.

  **HEAVY!** You may need assistance with this step.

Step 21

13  **x 14**
M3 x 15mm

 Phillips
Screwdriver
(not included)

Tip: There are only 2 pilot holes on the top panel for the screws [13]. Attach the back panel [S] first using the 2 pilot holes. Loosely thread the remaining screws [13] into place before fully tightening them one by one.

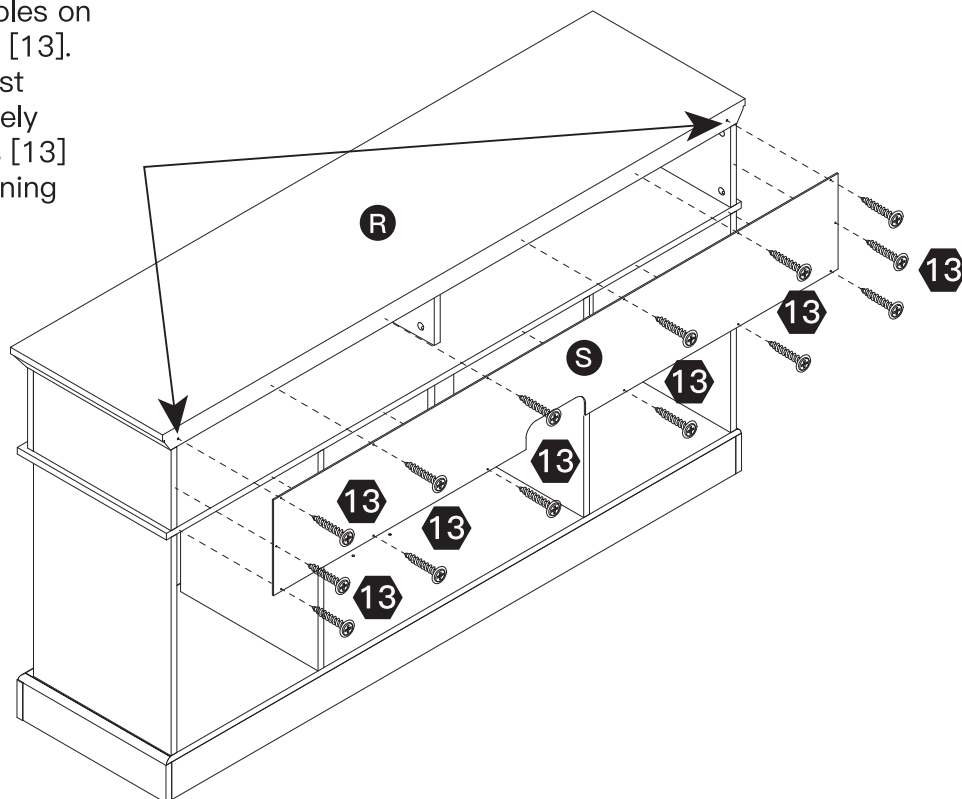

Step 22

13  **x 16**
M3 x 15mm

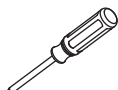
 Phillips
Screwdriver
(not included)

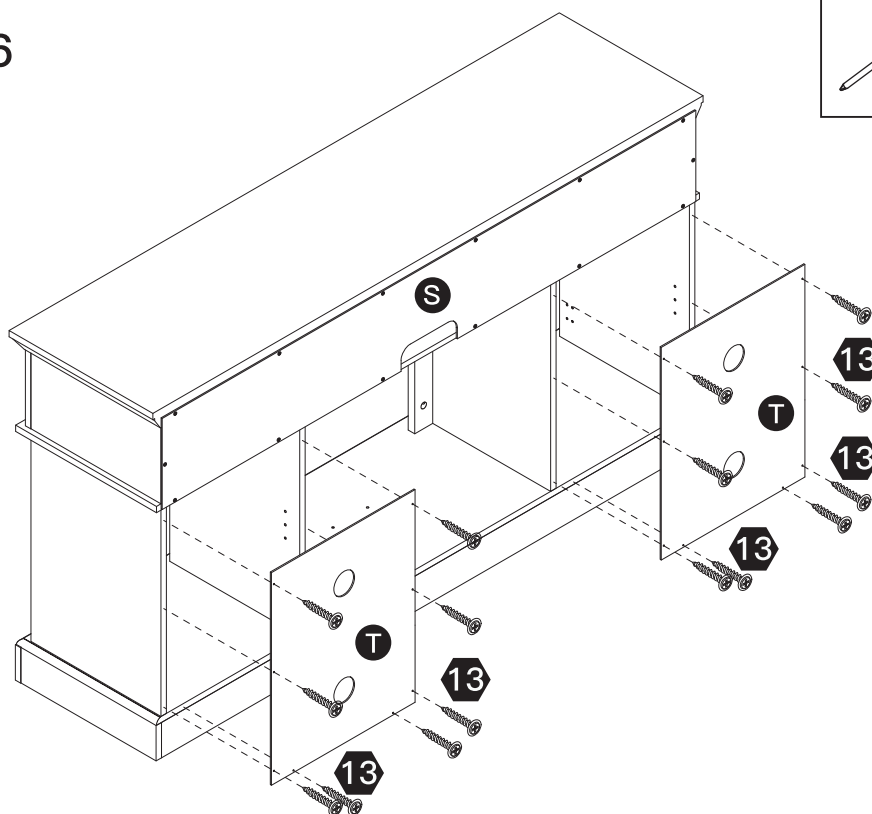

Step 23

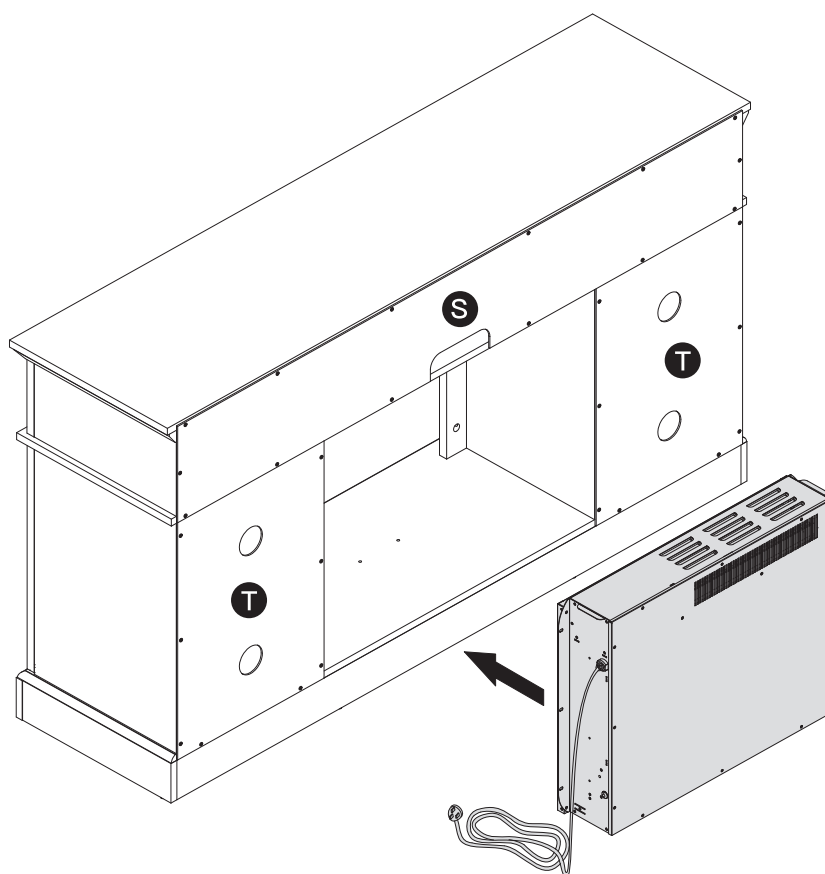

Step 24

14  x 2
M6 x 50mm

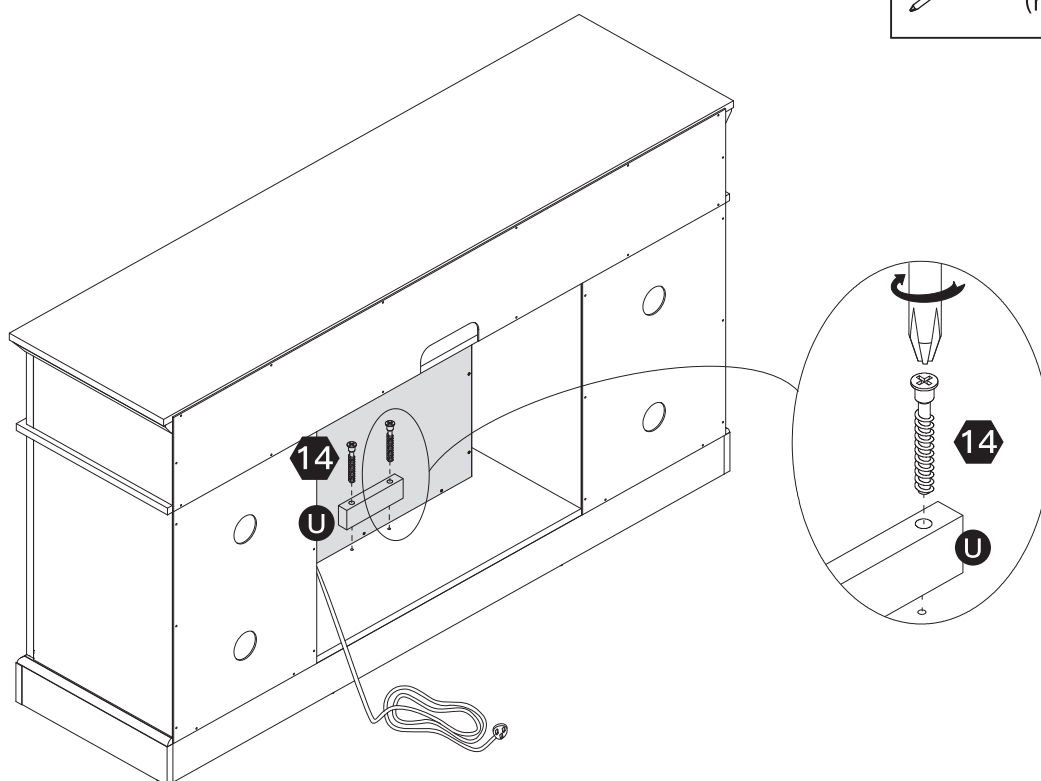

Step 25

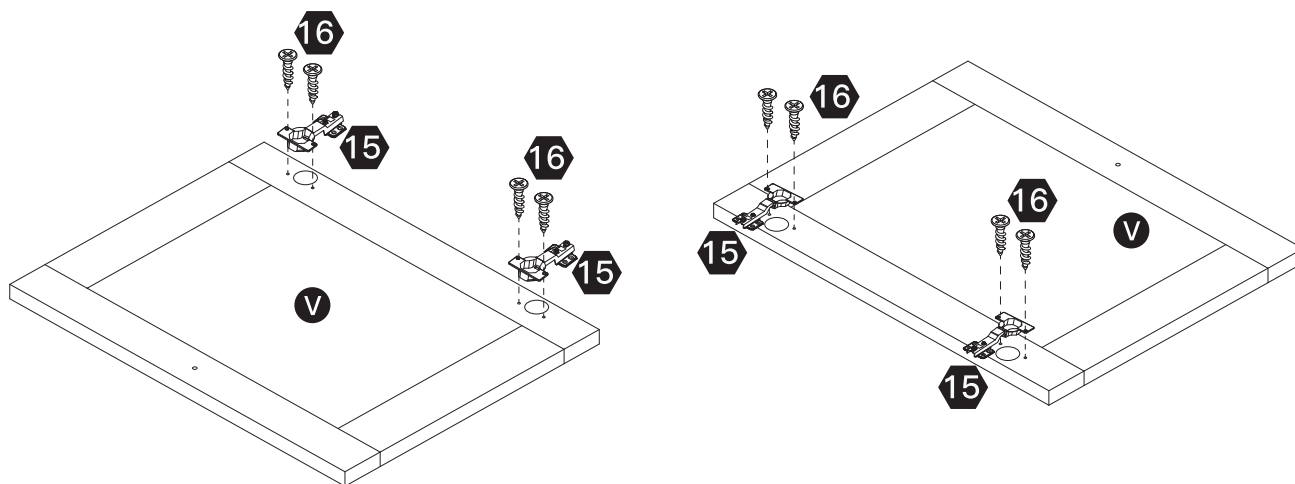
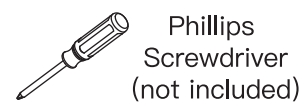

Step 26

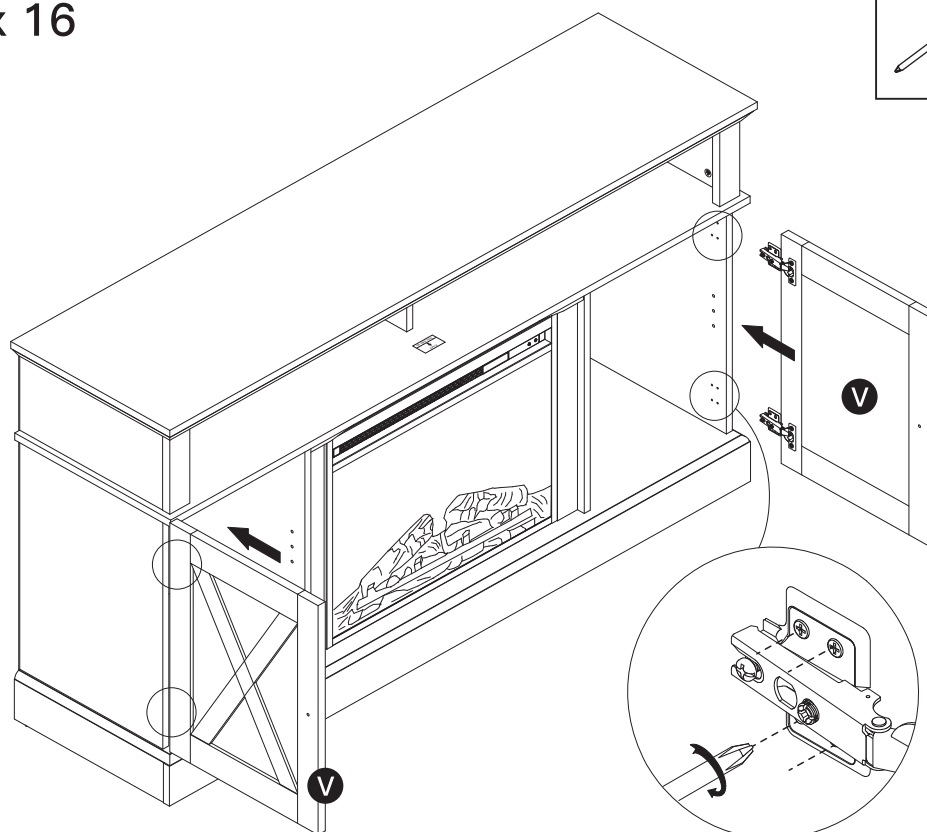
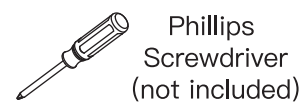

Step 27

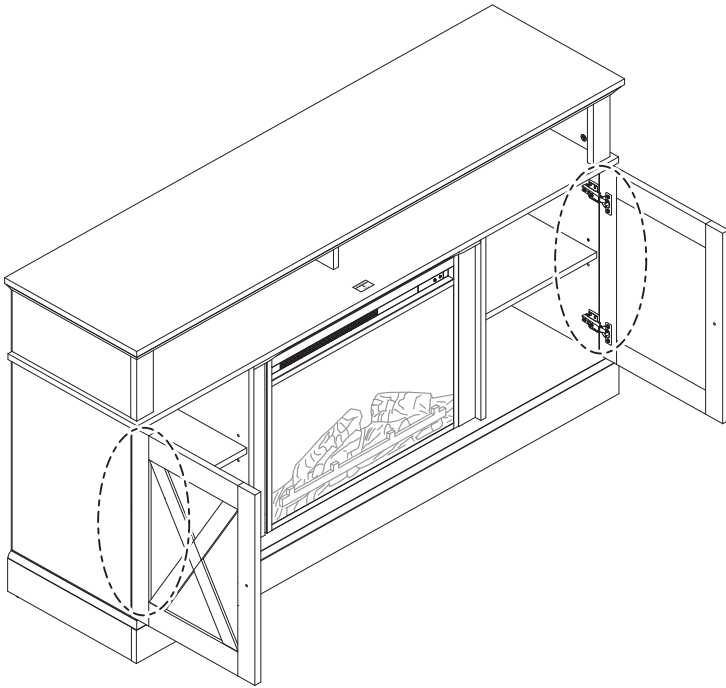

The doors may go out of alignment during shipping. Open and close the doors to make sure they are aligned correctly. If you find that the doors need to be adjusted, turn the screws as demonstrated.

The hinges are adjustable in three directions for perfect alignment.

To adjust door up or down

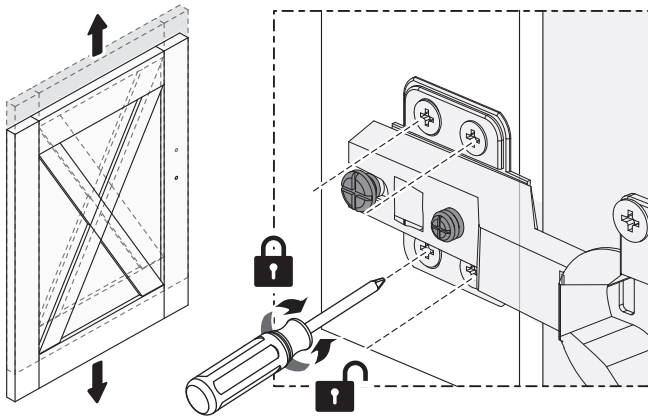

To adjust door forward or backward

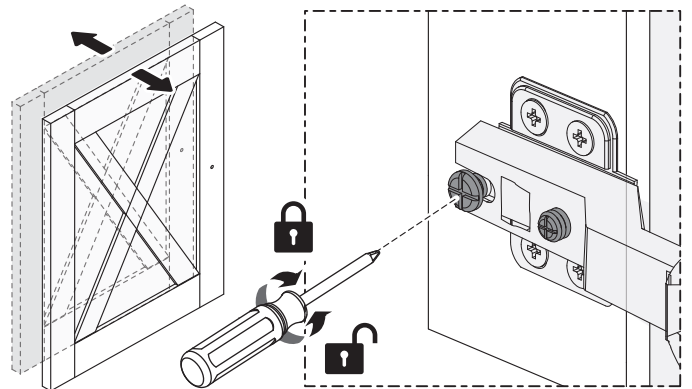

To adjust door left or right

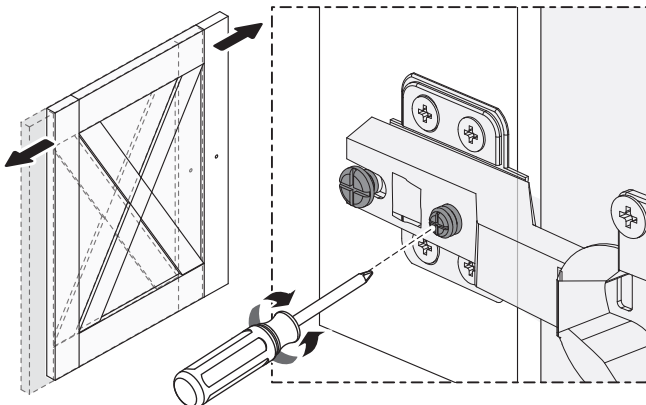

Turn the set screw clockwise to narrow the gap between the door and the side panel.

Turn the set screw counterclockwise to enlarge the gap between the door and the side panel.

Step 28

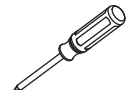

 Phillips
Screwdriver
(not included)

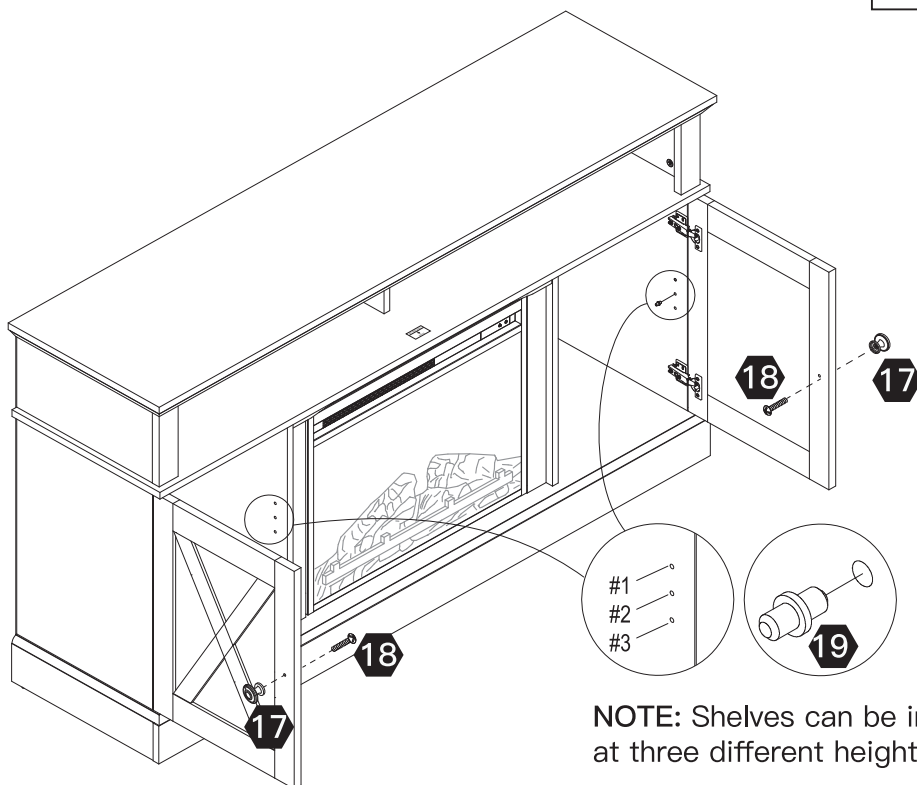

Step 29

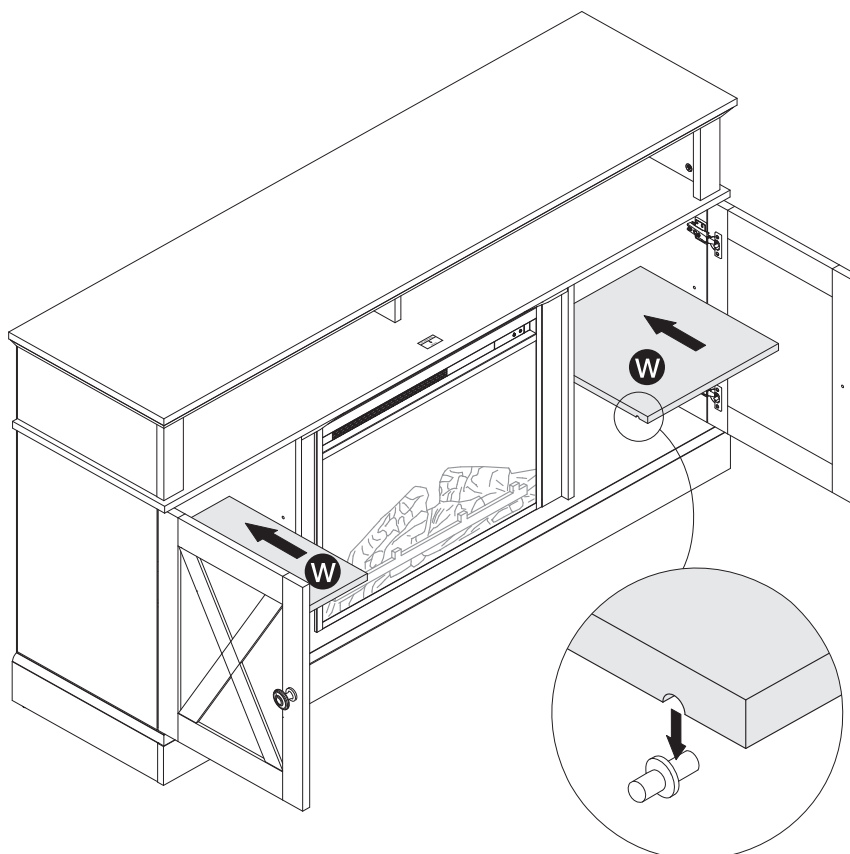

Step 30

Tools Needed
(Not Included)

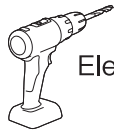

Electric Drill

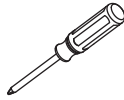

Phillips
Screwdriver

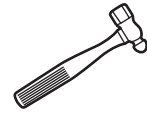

Hammer

