



Instruction Sheet

User Manual

Inflatable castle for kids (Inflate it in one minute)

Thank you for using inflatable castle.
Please read the follow instruction carefully, before setting up and using our product.

| Introduction

You will have a playground at home if you get a castle that is giant toy suitable for various occasions with full of surprise.

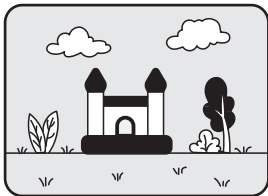

Garden, backyard and outdoor scene

Suitable for large size models or products with water playing feature

For parties, kids activities, summer water sprayer

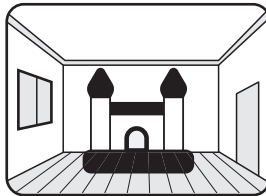

Indoor use

Small size bouncer

For parties, family indoor activities and kids exercises



Commercial use to attract clients

Suitable for specially designed styles or models with unique themes

To attract visitors and clients

| Product Includes:

Note: The product with water playing design comes with water pipe accessories, the products without water splashing function does not have.



INFLATABLE CASTLE



BLOWER



STAKES



STORAGE BAG

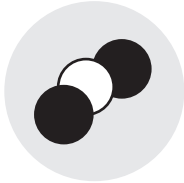

REPAIR KIT



USER MANUAL



WATER PIPE FITTINGS

| Contents:

Product Introduction	-----	P2
Warning	-----	P4
Site Restrictions	-----	P5
Precautions for stakes	-----	P5
Precautions for playing	-----	P5-6
Precautions for blower	-----	P6
Installation Instruction	-----	P7-8
★ Water Pipe Installation	-----	P8-9
Maintenance Instruction	-----	P9-10
Repair and Disposal Instructions	-----	P10
Common Problem	-----	P11

★ For castle without water playing design, just skip the water pipe installation part.

| Warning



If the product comes with water playing function or pool function, please read the following guidelines and warnings carefully.



Never leave your child unattended -drowning hazard! Please keep your children under adult supervision at all time!

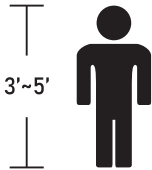

- **For safety concern, the weight limit should be strictly observed; maximum weight of 45KG(99LBS) for individual.**
- **The height of player shall not exceed 5 feet(150cm).**

- Minimum errors in size is normal.
 - Not suitable for adults, applicable age is 3 to 8 years old children. For safety concern, not recommended for children under 3 years old.
 - Children must have adult supervision when playing with this product. Small parts may cause choking hazards; Long cords and wires may present a risk of strangulation accidents.
 - It can be used for indoor or outdoor upon the actual environment and area size.
 - Please keep the instruction sheet for further reference. You must read all safety rules and installation, operation manuals before setting up the product.
 - The product should be used under adult supervision.
-
- **Warning! Failure to follow the instructions and operating instructions may present a risk of serious injury or even death! So please follow all operating rules whenever product is in use.**

Site Restrictions for the product installation and use.



Do not use it outdoors when it rains or when in other bad weather conditions.



Playing with the bouncer outdoor in windy condition with over 32 kilometers/hour, which is not allowed. Because the gusts may lift the stakes and blow the bouncer off the ground.



Please do not set up the product on a slope or uneven ground.



Do not place the product near any water source or puddle.



Warning! Never place it on hard ground surface, such as concrete or asphalt, because a fall into the hard ground will cause severe injury. For extra protection, it is highly recommended to place an impact absorbing cushion, soft pad or mat underneath.

| Precautions For Stakes

- The ground support stakes are used for lawn ground surfaces to maintain stability of the structure.
- To prevent overturn or lift in use, make sure to apply enough stakes and firmly push them into the ground.
- Make sure the ground condition meets the basic requirement of installation(soil, weather and environment conditions).
- Carefully check and remove all the obstructs and objects that may affect the installation of the stakes.
- To maintain the stability of the structure and to prevent possible shift, overturn or lift because of external force or horrible weather condition, you must make sure the straps are being tied with stakes properly and push every stake into the ground firmly with vertical angle.
- Do not drive stakes at an angle(keep vertical). For best holding strength, push states into hard and dry soil. Pushing them into soft and wet soil may weaken the stability of the installation.
- The stakes should be placed level with or under ground in order to avoid tripping hazards.

| Precautions For Playing

- No upside down(head down) sliding, it might lead to serious head injury. Always slide with your feet down. Also, adult supervision is required at all time.
- Please strictly observe the operation rules in the function areas, such as slide and climbing wall.

- Keep pets away from the inflatable product or the blower while in use.
- Do not attach items to inflatable device that are not specifically designed for use with the inflatable device, such as, but not limited to jump ropes, clothesline, pet leashes, cables, wires and chains, as such items may cause serious suffocation accidents.
- Please ensure that children play in the activity area of the product and under supervision of the adults at all time.
- Ensure that the entrance and exit of the castle remain unobstructed at all times, not blocked by any obstacles and objects.
- Dress Code for Users - Please avoid wearing any headgear or loose clothing when children are playing in the bouncer. Also, please remove all hard, sharp, or dangerous objects, such as jewelry, capes, scarves, helmets, etc., before entering the bounce house.
- When playing, please separate the children with large age gap to avoid danger.
- Users are prohibited from climbing or hanging on the support parts of the castle, such as: support pillars.
- Prevention of inappropriate activities(for example, roll, shake, collide, wrestle, chase and other intense and rough plays).
- Food, drink and chewing gum are strictly prohibited while playing on the bouncer.

| Precautions for blower

- Warning-Electrocution Hazard!
To avoid circuit overload , do not use extension cord in the operation of blower.
- Adult supervision is required at all time! It is not recommended for children under 12. As with all electric products, the operation and moving of electrical product require more detailed manual and precautions, and precautions should be strictly observed all time while in operating. To avoid electric shock or even severe injury, please carefully read the following guidelines.
- Keep all electrical lines, radios, speakers and other electrical appliances away from the inflatable bouncer.
- Warning-Electrocution Hazard! Do not set up the bouncer near or under electrical wires.
- To prevent electric shock, do not immerse the blower in water, or do not wipe with damp cloth.
- Do not run cord under carpeting. Do not cover the energized wires with blankets, carpets, wires and similar items.
- Do not route cord under furniture or appliances. Arrange cord away from traffic and walking zone where people will not be tripped over.
- Keep away from fire.
- Do not disconnect the blower during use.
- Do not use in bad weather condition.
- Check general condition of the device and the power sources before each use, do not operate blower with a damaged cord or plug. If you notice a defect, do not use it under any circumstances. In this case, you should immediately stop using it and get a professional to carry out maintenance checks.
- Warning! To reduce the risk of fire or electric shock, do not use blower with any solid-state speed control device. Unplug or disconnect the blower from the power supply while not in servicing.

| Installation instructions

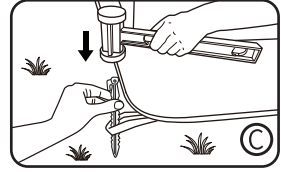
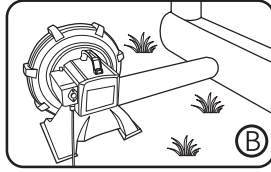

- ① Carefully check the ground first, and make sure the place you want to set up is clean from any hard object and debris. Then, unfold the main structure and set it up on a flat and tender ground surface. Remember to keep at least 2 meters safe distance in surroundings.
- ② Place the electrical blower in a dry place, and please keep it away from the water source while in use. Stretch the inflation tube and attach it to the nozzle of the blower and must keep the inflation tube smooth and untwisted. Plug the blower into the 220V voltage power supply, then turn on the power switch, the product will inflate and expand quickly. But you must keep the blower activated and maintain its operation whenever the bouncer is in use.
- ③ Attention! When using outdoors, please ensure that all ground stakes can be driven into the ground using a rubber mallet to ensure secure and stable usage without displacement. The ground stakes should be perpendicular to the ground and driven into the ground as much as possible to minimize tripping hazards and other risks. Secure the product and blower according to the number of ground stakes provided for each model.
- Open the packaging box and take out the inflatable castle and other accessories. Unfold and lay on a smooth, level and unobstructed area on grass or dirt. The surface should be free of rocks, bumps, depressions, sticks or glasses or any debris. Avoid any objects that might rip/tear the material. Be sure there are no pipelines, sprinkler systems, electrical wires or other public facilities under the ground before setting the inflatable in the desired area.
- To protect the bottom of the inflatable from tearing or damaging, place a tarp or a mat underneath.
- Put an impact absorbing cushion, such as EVA foam pad on the ground next to the climbing wall and the end of slide, that is to protect children in case of accidental fall.
- Note: Considering the size difference after inflation, the castle should be set up in a location that has a minimum distance of 10 ft(3m) from any free-standing structures or obstructions, including but not limited to houses, garages, fences, trees, clotheslines, electrical wires, playground equipment and large rocks around the unit. The minimum clearance of at least 2 meters around the unit while in playing.

Response To Emergency

- In playing and the operation of the product, adult guardian must carry a mobile phone with saved emergency phone numbers list, this is to assure immediate assistance in case of emergency and accident.
- It is highly recommended that the adult guardians should be certified in the operation of cardiopulmonary resuscitation(CPR). In the event of an emergency, immediate application of CPR can make a lifesaving difference.

Deflate And Fold

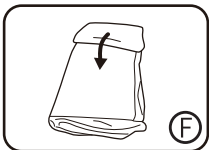
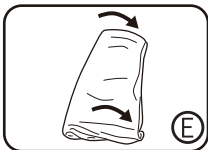
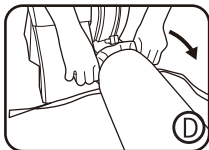

Deflate:

- Make sure all children are out of the structure and the blower, before deflation.
- Turn off the blower switch and unplug the power cord. The structure will collapse quickly.
- Detach the inflation tube from the blower and leave it on the side of the bouncer(D).
- Remove all the ground stakes.

Fold:

- Fold the product from outer part to inward, driving out as much air as possible, then try to fold it into a long rectangle(E).
- Finishing folding from the end opposite of the inflation port to the side of inflation tube, make sure to cover the surface properly(F).
- In the end, now you can put the folded bouncer into the storage bag that is provided(G).

Response To Emergency

- In playing and the operation of the product, adult guardian must carry a mobile phone with saved emergency phone numbers list, this is to assure immediate assistance in case of emergency and accident.
- It is highly recommended that the adult guardians should be certified in the operation of cardiopulmonary resuscitation(CPR). In the event of an emergency, immediate application of CPR can make a lifesaving difference.

| Water Pipe Installation

- The water pipe components and accessories are shown as below(The numbers of sprinklers are subject to different models, our installation example has 2 sprinklers) :

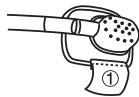
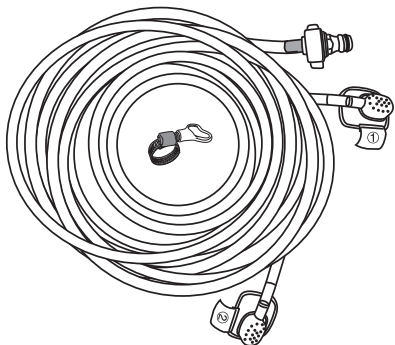

Sprinkler head ①

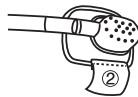

Sprinkler head ②

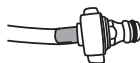

Water pipe joint



Pipe clamp

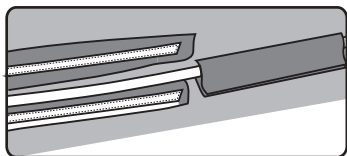

- The numbers of sprinklers are subject to different product categories. So each sprinkler has its own unique serial numbers to match up. For instance, sprinkler 1 match No. 1, sprinkler 2 match No. 2, etc. After confirming the right position of each sprinkler, please bind the water pipe along with the fixed Velcros in the structure.

Installation Of The Water Pipe Connector:

- After fixing the water pipe by Velcros, then find the pipe connector(joint).
- Connect the pipe connector(hose connector) to the end of a standard home water pipe, as shown in the following detailed instruction.

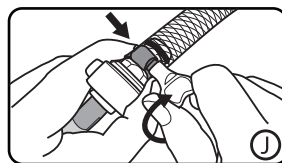
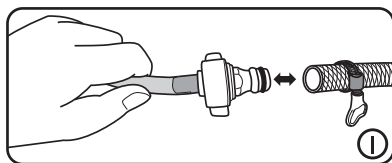
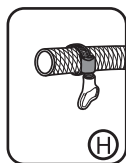

- Tie the pipe clamp (hose clamp) to your own water pipe, like pics H shows.
- Connect the water pipe connector to your own water pipe with pipe clamp, like the illustration of pics I. In order to avoid water spillage or leakage due to high water pressure, make sure your water pipe completely covers the very front part of the pipe connector properly.
- After binding the water pipe with the connector, then please screw and lock the hose clam(pipe clamp)to the pipe, like pics J shows.
- For the proper installation, you need to pinch the ring part of the clamp with one hand and clockwise tighten the hose clamp(pipe clamp) handle with other hand until they are being fixed tightly and unable to rotate.

Maintenance Instructions

- Inspection and routine maintenance must be carried out at regular intervals on the structure, that is to avoid the risk of accident that cracks or leakage may cause.
- Make sure the bouncer is absolute dry before you storing it because residual water may damage the material; never store the inflatable when the unit is still wet or damp.
- Allow the inflatable to dry outdoor completely before storage.
- Store the product and the blower in dry conditions indoors when not in use.
- Check general condition of the product regularly before, during and after each use for tears, holes and other damages, or signs of deterioration. Do not use damaged or deteriorated product. A damaged, cracked or deteriorated inflatable will affect its' performance and stability, which may present a risk of serious safety problems.
- Check the ground stakes holding the inflatable in place regularly. Damaged or loosened stakes will affect the stability and how they anchoring the ground, and may result in the shift, overturn or lift of bouncer, which will present a risk of severe injuries.
- Conduct a careful check on the surface and gaps after each use, make sure to remove all the debris in the product. Allow to dry before storage.
- The inflatable is made from a Oxford fabric material, you can clean the surface by a cloth with neutral, non-flammable, non-toxic cleaners and sanitizing solutions, or just rinse it with water. Allow to dry before storage.
- Do not use chlorine based or bleach based cleaners as it may damage the surfaces. Do not apply any bathroom detergents. Do not use any cleaners that with a warning of "Do not use on soft vinyl". Do not use any abrasive cleaners to avoid the damages and deterioration on the surface.
- The most important thing is that since children are going to have close contact with the product, so make sure to use a cleaner that is safe and non-toxic.
- Food or drinks on the inflatable or the blower, which is strictly prohibited.

Blower Maintenance:

- Please properly turn off and unplug the blower after operation.
- Check blower regularly for unsafe conditions including damaged cord, plug or extension cord. If damage is found, do not use the blower and find a professional to do the repair.

- Blower is equipped with thermal auto-rest production. If motor is overheated, the protector will trip to protect your safety. Then, turn off the blower and let it cool down. Please follow blower instruction and check for wrong operations that may cause overheating.
- The blower does not require lubrication oil and has no serviceable parts for users to repair.
- To maintain the service lifespan of the cords and other electrical components, never leave the blower outside or in wet weather condition when not in use.
- To prevent electric shock, do not immerse the blower in water, do not wipe with damp cloth. Make sure the blower is turned off and unplugged before the cleaning, use a wring cloth to clean the surface of the blower. Allow to dry before storage.
- Do not clean the blower with chemical solutions or cleaners as they may corrode the coating and plastic parts.
- Store the blower indoor in a safety and dry location away from children when not in use.
- Loosely coil the cord when storing the blower.

| Repair and Disposal Instructions

_All products come with a repair kit. If you notice any surface damage on the product, you can manually repair it.

-Attention:It is generally not recommended to repair the same damaged area more than twice.

Method 1: Coil repair

- For small cracks on the surface of the product, you can stitch them together with a needle and thread. Attention that the stitching should be limited to the surface fabric of the product and avoid piercing the bottom fabric to prevent structural damage. Needles used for repair must be stored properly and avoided to be left on the product.
- Sewing needles are not provided, please purchase your own (3# sewing needle is suggested).

Method 2: Repair subsidy

- If small holes appear on the surface of the product, they can be repaired with repair subsidies.
- If there is extensive damage or structural damage to internal parts, stop using the product immediately or seek professional help for repair.
- Deflate the product, make sure to clean the surface and keep it thoroughly dry. (A)
- Cut an appropriate portion of the patch to fit in the damaged area. (B)
- Remove the adhesive backing of the patch, and stick it on the patching area. (C)
- Remember to press the patch firmly and make sure to smooth out all the air bubbles. (D)
- Put aside the product and allow to glue for at least 30 minutes, before re-inflating.

WARNING: For Adult's operation Only

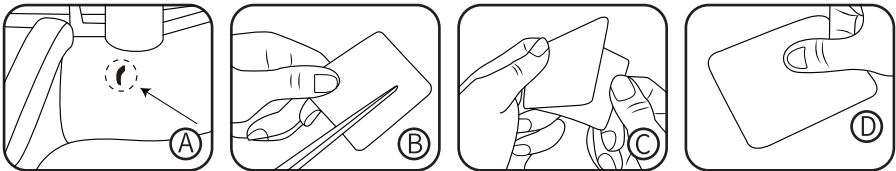

Disposal

- Ensure there are no hazardous conditions or not to create any dangerous situations while you are trying to dispose the product. For instance, the place where you discard the product shall not be near any fire source or be obstacle to exit.
- Blower should only be discarded in special disposal centers that are specialized in dealing electrical products and electronic waste.
- Button cell batteries should be disposed in special household or battery collection program as hazardous wastes.

| Common Problem



What if there is air leakage at the suture of the product?

- The air leakages from the pinholes and parts conjunctions are considered as a normal. This is to ensure balanced pressure and to avoid over-inflation.



Found pinholes in some parts of the product?

- The product may contain some pinholes (less than 6mm), which are used for positioning the stitches in the production process and do not affect normal use.



Do you need to turn off the blower after the product is inflated?

- Do not turn off the blower while in use. Otherwise, the castle will be shrinking.



If it is a product with the function of playing with water, how to store it?

- Water seeping inside castle is common. Dry at an angle to empty it if it happens. Make sure the bouncer is absolute dry before storing it. For general storage, keep in a dry and well-ventilated space.



When playing with water, you find bubbles in the pool or at the bottom of the needle suture?

- The products have passed the chemical test of formal laboratory when leaving the factory.
- As it is a sewing inflatable product, when playing with water, bubbles appear in the bottom pinhole, which is a physical phenomenon. Please rest assured to use it.

MADE IN CHINA