

# 2 tier stainless steel drainer







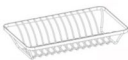

After-sales Connect (ENONLY) :

(1) 6468202494 Monday to Saturday 9:00 am to 6:00 pm CST

## DRAINING RACK

### INFORMATION FOR USER

Part List	A. Upper basket 1pc	B. Lower basket 1pc	C. Joint poles 2pcs	D. Draining tray 1pc	E. Utensil holder 2pcs	F. Cup holder 1pc
						

Care Instructions: Wipe clean with a damp cloth  
No need tool for assembling

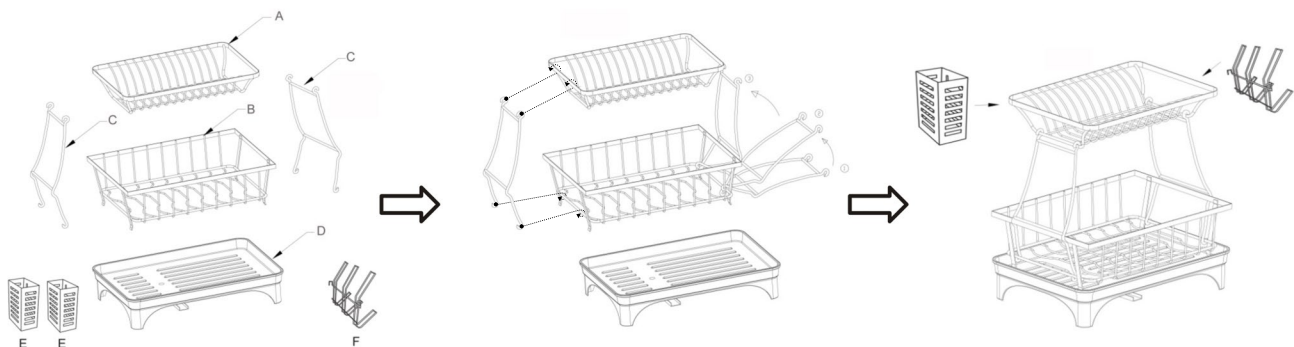

Step 1: unpack all parts and check to make sure they are accounted for.

Step 2: As shown in above drawing, insert the pole and assemble. Re-do the same for another pole.

Step 3: Put the rack on D. the draining tray. Put E. utensil holders and F. cup holder on the rim of the upper basket.