

ELECTRIC FIREPLACE

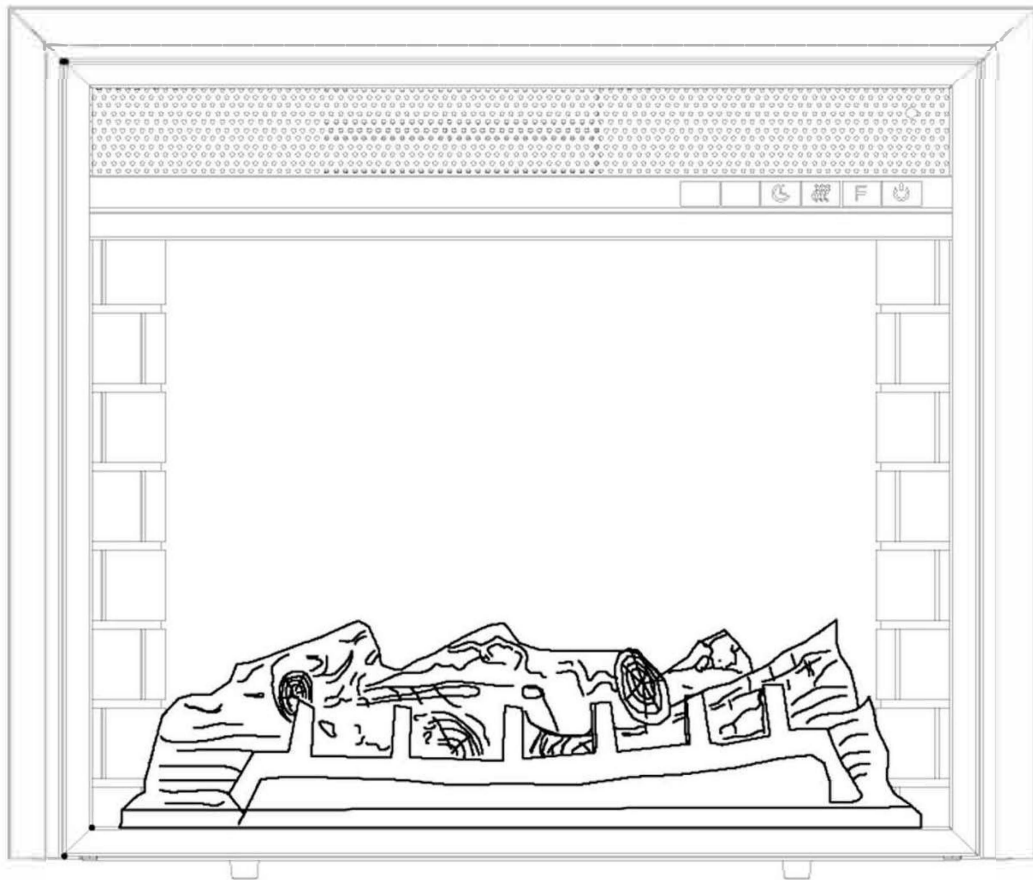

TABLE OF CONTENTS

Safety Information.....3
Preparation.....4
Preparation(Trim Kit Installation).....5
Operating Instruction.....6
Care and Maintenance.....7
Troubleshooting.....8

SAFETY INSTRUCTION

⚠️ WARNING: Any use of this appliance other than that recommended by the manufacturer in this owners manual may cause fire, burns, electric shock and/or other serious injuries or death. When using electrical appliances, basic precautions should always be followed to reduce the risk of fire, electric shock and injury to persons including the following:

1. **Read all instructions before using this appliance.**
2. This appliance is hot when in use. To avoid burns, do not let bare skin touch hot surface. If provided, use handles when moving this heater. Keep combustible materials, such as furniture, pillows, bedding, papers, clothes, and curtains at least 3 feet (0.9 m) from the front of the heater and keep them away from the sides and rear.
3. Extreme caution is necessary when any heater is used by or near children or invalids and whenever the heater is left operating and unattended.
4. Always unplug heater when not in use.
5. Do not operate any heater with a damaged cord or plug or after the heater malfunctions, has been dropped or damaged in any manner. Return heater to authorized service facility for examination, electrical or mechanical adjustment, or repair.
6. Do not use outdoors.
7. This heater is not intended for use in bathrooms, laundry areas and similar indoor locations. Never locate heater where it may fall into a bathtub or other water container.
8. Do not run cord under carpeting. Do not cover cord with throw rugs, runners, or the like. Arrange cord away from traffic area and where it will not be tripped over.
9. To disconnect heater, turn controls to off, then remove plug from outlet.
10. This appliance comes equipped with a 3 prong-grounding plug. Do not cut the grounding prong. Connect to properly grounded 120V outlets only.
11. Do not insert or allow foreign objects to enter any ventilation or exhaust opening as this may cause an electric shock or fire, or damage the heater.
12. To prevent a possible fire, do not block air intakes or exhaust in any manner. Do not use on soft surfaces, like a bed, where openings may become blocked.
13. A heater has hot and arcing or sparking parts inside. Do not use it in areas where gasoline, paint, or flammable liquids are used or stored.
14. Use this heater only as described in this manual. Any other use not recommended by the manufacturer may cause fire, electric shock, or injury to persons.
15. Avoid the use of an extension cord because the extension cord may overheat and cause a risk of fire. However, if you have to use an extension cord, the cord shall be 3-wire cord with grounding type plug, No. 14 AWG minimum size and rated not less than 1875 watts.
16. Do not attempt to burn wood or other materials in this heater.

SAVE THESE INSTRUCTIONS

PREPARATION

⚠ CAUTION: This heater has front panel made of GLASS! Always use extreme caution when handling glass. Failure to do so could result in personal injury or personal damage.

This heater is for use on 120 Volts. The heater has a 3-prong grounded plug (Figure 2.A). If your electrical outlet has only 2 slots (Figure 2.B), you will have to use an adapter (Figure 2.C) to convert from the 3-prong power cord to a 2-slot receptacle. The green grounding plug extending from the adapter must be securely connected to a permanent ground such as a properly grounded outlet box. The adapter should only be used if a proper 3-slot receptacle is not available.

NOTE: Adapters are not allowed for use in Canada.

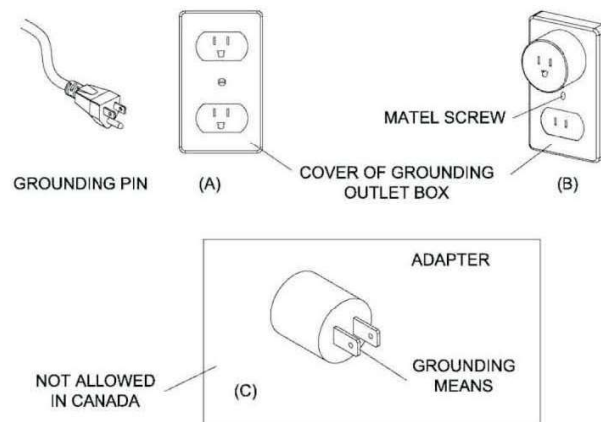

A 15 AMP circuit is required to operate this appliance. If the breaker trips when the appliance is running, you may need to move the appliance to another location or unplug other appliances that are on the same circuit.

PREPARATION

Trim Kits Installation:

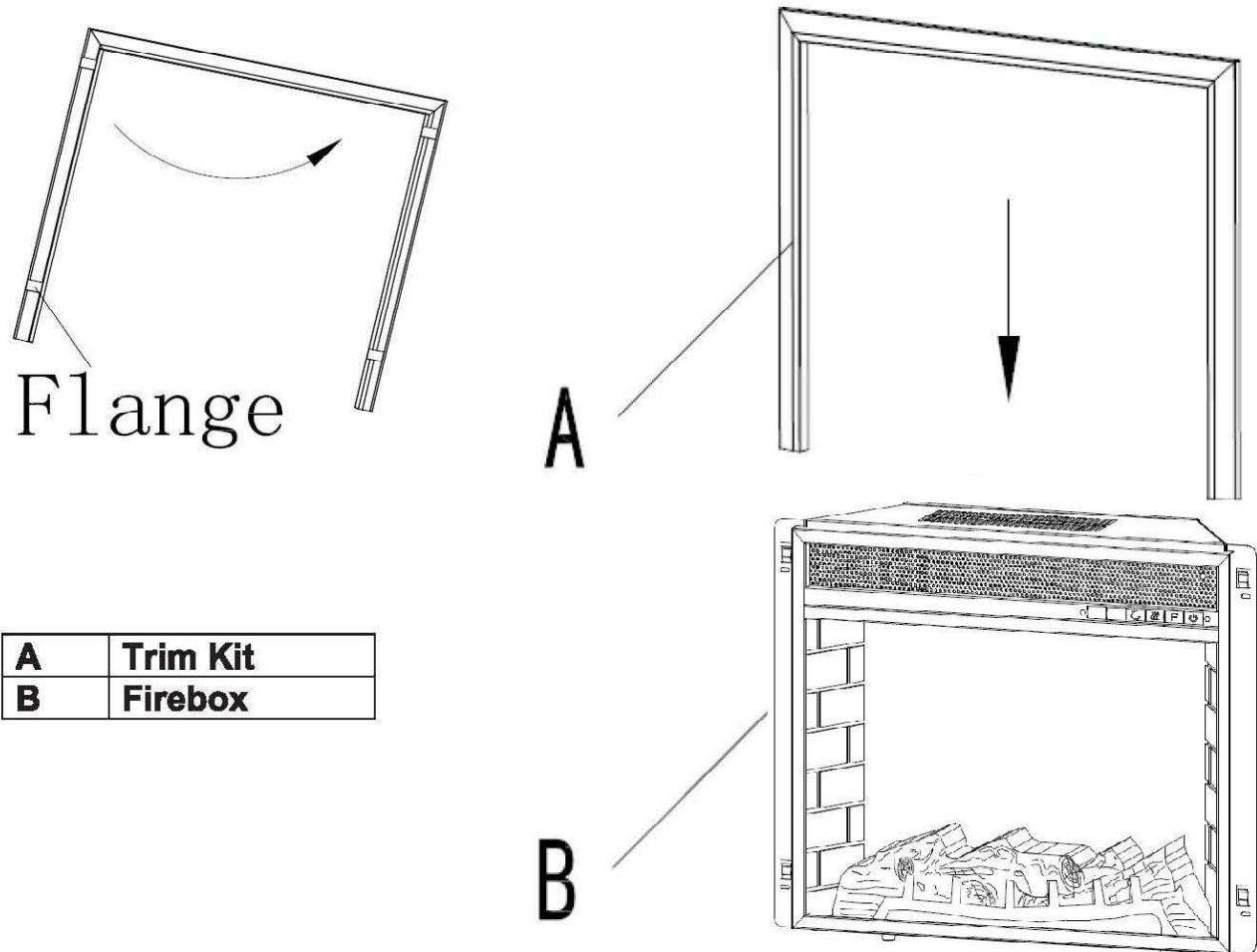

1. There are 4 brackets on side of the firebox cabinet frame front, to fit and secure the flange on trim kit.
2. Attach the trim kit to the frame, making sure that the flange is a little bit higher than the brackets, then slide the trim kit (A) down gently until the trim kit is fully seated

OPERATING INSTRUCTION

Read all instructions and warning prior to operating the appliance. Ensure that all controls are in the "OFF" position before plugging the appliance in to a properly grounded electrical outlet. Flame and heater can be presenting separately or at the same time.

The Fireplace control functions can be accessed in two ways:

1. Using the touchpad control panel, located on the upper right-hand of the fireplace(Figure 4)
2. Using the multi-function remote control(Figure 5), functions same as control panel

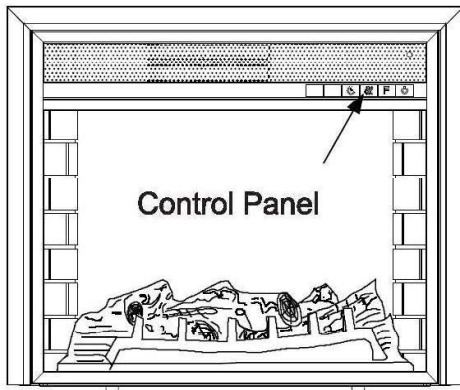

Figure 4



Figure 5

Using the Control Panel

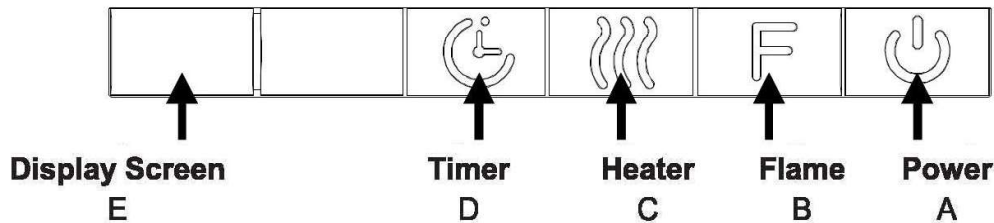

Figure 6

Power(Figure 6.A):

Press the POWER button to turn on the unit; Press again to turn off the unit. As long as the unit is powered on, the log-set will be alight and all functions are accessible.

Flame(Figure 6.B):

FLAME button controls the brightness of flame effect from the highest to lowest setting. There are totally 9 levels of the flame brightness.

Heater(Figure 6.C):

Press once to activate the Low Heat Setting("L"), presss the button the Second time to activate the High Heat Setting(H), and the Third time to activate the "Auto" function(A), after that the thermostat starts to work and to setup desired setting before the BLUE indicator light fading away;the highest temperature of thermostat is 95° F and the lowest is 65° F. Once activate the HEATER , the display screen(Figure 6.E), will display the heater setting in using accordingly shortly. You may turn off the HEATER by this button as well.

Timer(Figure 6.D):

Press once to activate the TIMER. Using the TIMER to have the unit turn off automatically after 30 minutes or up to 9 hours.The display screen(Figure 6.E) will present the setting shortly.

CARE AND MAINTENANCE

⚠ WARNING: Before attempting to perform any maintenance on this unit, turn all controls to the “OFF” position and unplug. Allow the unit to be “OFF” for at least 10 minutes before any maintenance applied in order to allow all components to cool down properly.

Cleaning:

1. To remove dust, fingerprints or other marks from glass window, use clean damp cloth. Do not spray glass cleaner or other liquids directly onto the glass.
2. Clean metal surfaces with a clean damp cloth making sure not to push dust or debris into any air intake or exhaust vents.
3. Do not use abrasive cleaners or spray liquids on any part of the appliance.
4. Periodic cleaning/vacuuming of the fan/heater unit is strongly recommended to ensure that no dirt or foreign objects build up.

Replacing Remote Control Battery

If the remote controls stops functioning or operate poorly, the battery should be replaced with new one

1. The battery compartment can be found on the back side of the remote control.
2. Press and slide the battery door to open and remove the old battery.
3. Insert a new CR2025 coin battery, making sure that the polarity “+” and “-” matches properly as illustration showing.
4. Close the battery door.

Replacing Light Bulb

Note: The flame effect on this electric fireplace insert is created by LED Bulbs
The life of these LED bulbs will be 100,000 hours. The users are not recommend to Replace the LED Bulbs. For any reason should the bulbs stop working properly, contact a qualified technical.

Trouble Shooting

⚠️ WARNING: Turn off the unit, unplug and allow the unit to cool for at least 10 minutes before attempting to perform any service. Only a qualified professional should attempt to service or repair the unit.

PROBLEM	POSSIBLE CAUSE	SOLUTION
Simulated flame is dim or not presenting	<ol style="list-style-type: none"> 1. flame setting improperly 2. "Flame wand" has come loose from bracket. 3. "Flame wand" driving motor is not functioning. 4. Light bulb are burnt out 	<ol style="list-style-type: none"> 1. Reset flame 2. Remove screws holding back panel in place and remove back panel. Secure end of "Flame wand" back into the support bracket. 3. Call for Technical Service. 4. Call for Technical Service.
The appliance turns off and will not turn back on	<ol style="list-style-type: none"> 1. The overheat protection device in the appliance has been triggered. 2. House circuit breaker has been tripped. 	<ol style="list-style-type: none"> 1. Turn off and unplug the appliance, allow the insert to cool down for at least 10 minutes, then plug in and restart. 2. Reset house circuit breaker.
The appliance does not turn on when the appliance setup to be "ON"	<ol style="list-style-type: none"> 1. The overheat protection device in the appliance has been triggered. 	<ol style="list-style-type: none"> 1. Turn off and unplug the appliance, allow the insert to cool down for at least 10 minutes, then plug in and restart.
Remote Control does not work	<ol style="list-style-type: none"> 1. Low batteries. 2. Turn on the unit by control panel manually before using remote control 	<ol style="list-style-type: none"> 1. Replacing with new battery 2. Turn on the unit by control panel manually before using remote control