

Specification

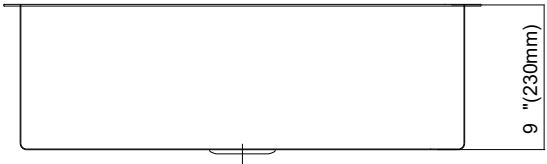

TS3322R9-075R000

- Outer Sizes: 33" x 22" x 9"
- Inner Sizes: 31" x 18" x 9"
- Material thickness: 16 Gauge/ 1.5mm
- Material: Type304
- Recommended Installation Type: Drop in

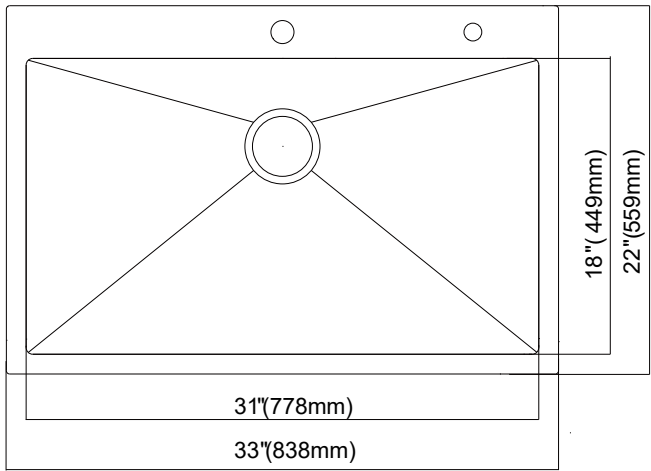
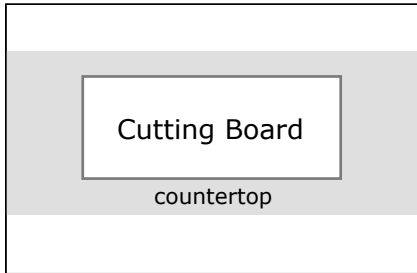

Step 1

Place the cutting board flat on the table, making sure that the edge of the cutting board is parallel to the edge of the table

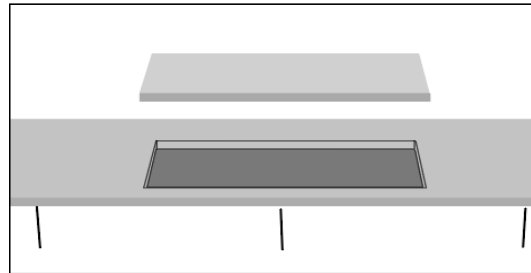

Step 2

Use a suitable tool to extend the line cutting table shown on the cutting board. (be careful)

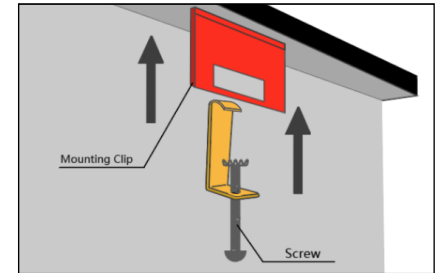

Step 3

Attach mounting clips to the prongs protruding from the underside of the sink rim. Make sure the hooked side of the mounting clip is facing away from the sink.

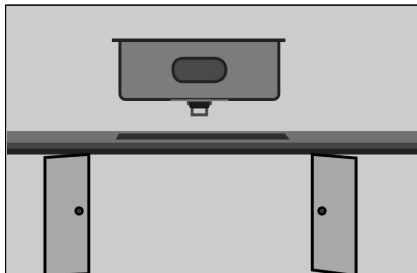

Step 4

Using a good quality silicone caulk, Apply a generous bead of silicone to the perimeter of the sink's rim. Place the sink carefully on the countertop.

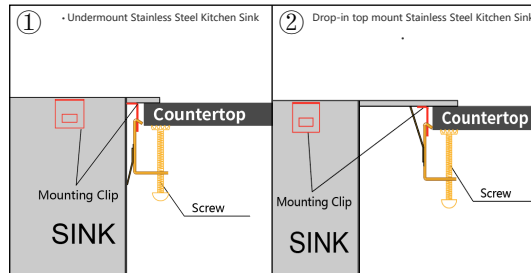

Step 5

Position the bottom of the mounting clip so that it is gripping the countertop. Use a screwdriver to tighten the screws until the mounting clip is snug against the countertop.

* Please refer to this diagram for the sink with hook accessories



Step 6

Remove excess silicone caulk, put some water or somethings in the sink, apply some downward weight to the sink, and stay still overnight. Installation complete.