

# series installation schematic

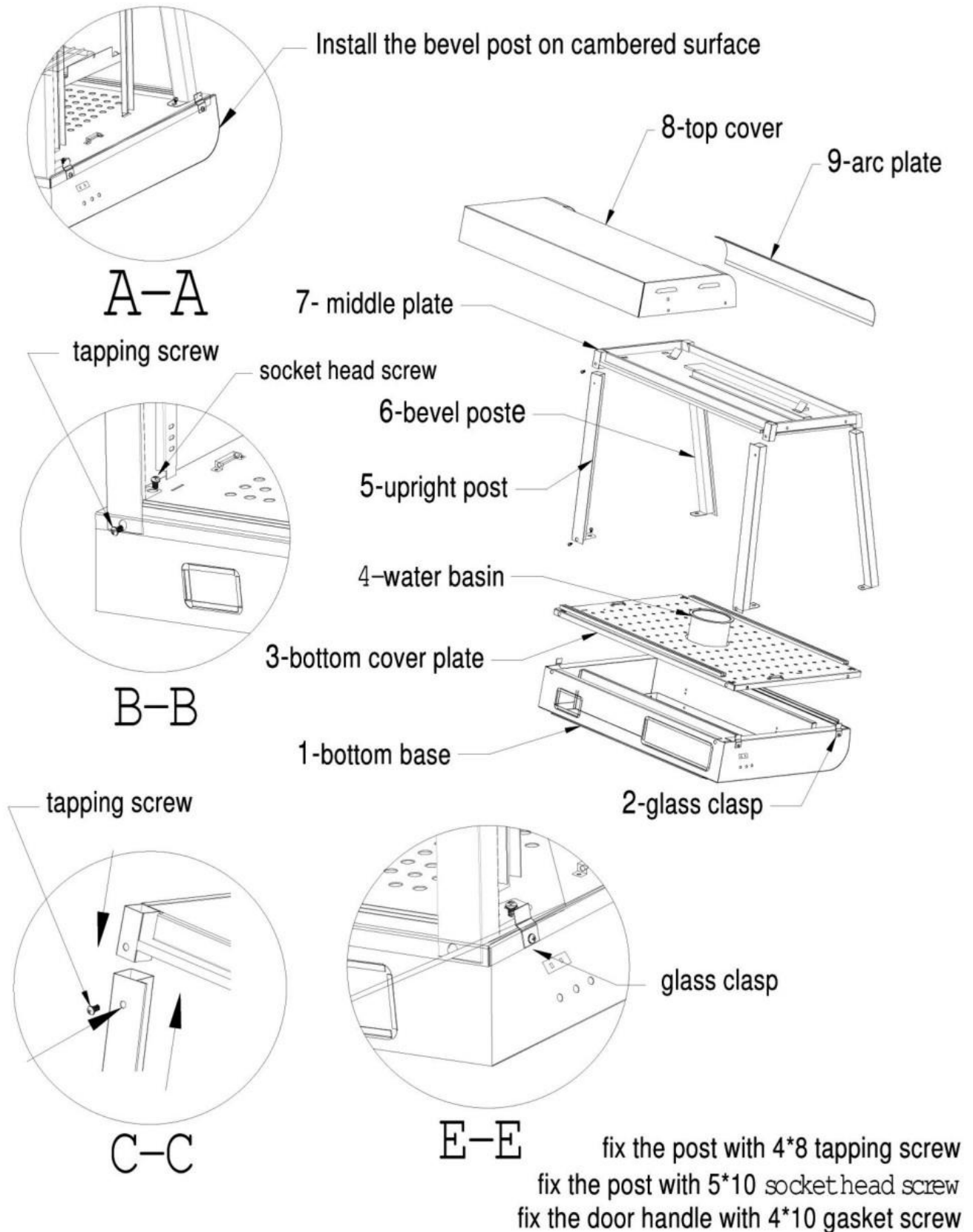

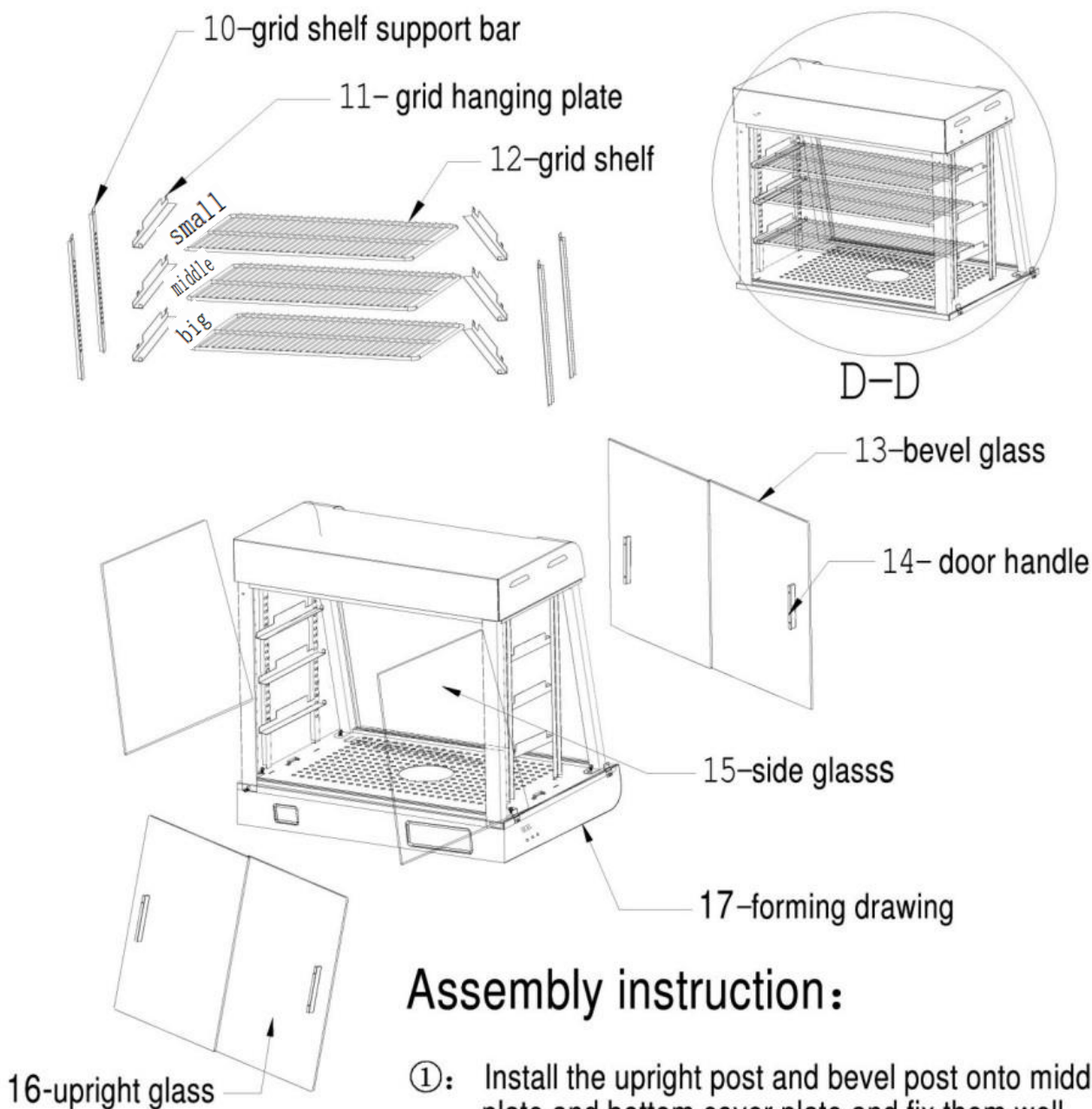

## Assembly instruction:

- ①: Install the upright post and bevel post onto middle plate and bottom cover plate and fix them well ( See picture A-A,B-B,C-C )
- ②: Assemble the grid shelf with support bars and hanging plates( See picture D-D )
- ③: Install the side glass, twsit the glass clasp, unscrew the screw, put glass inside and lock with screw tightly. ( See picture E-E )
- ④: Install the door handle, then install the upright glass door and bevel glass from up to down, inside to outside. (Notice: bevel glass is taller than upright glass)