

Installation diagram

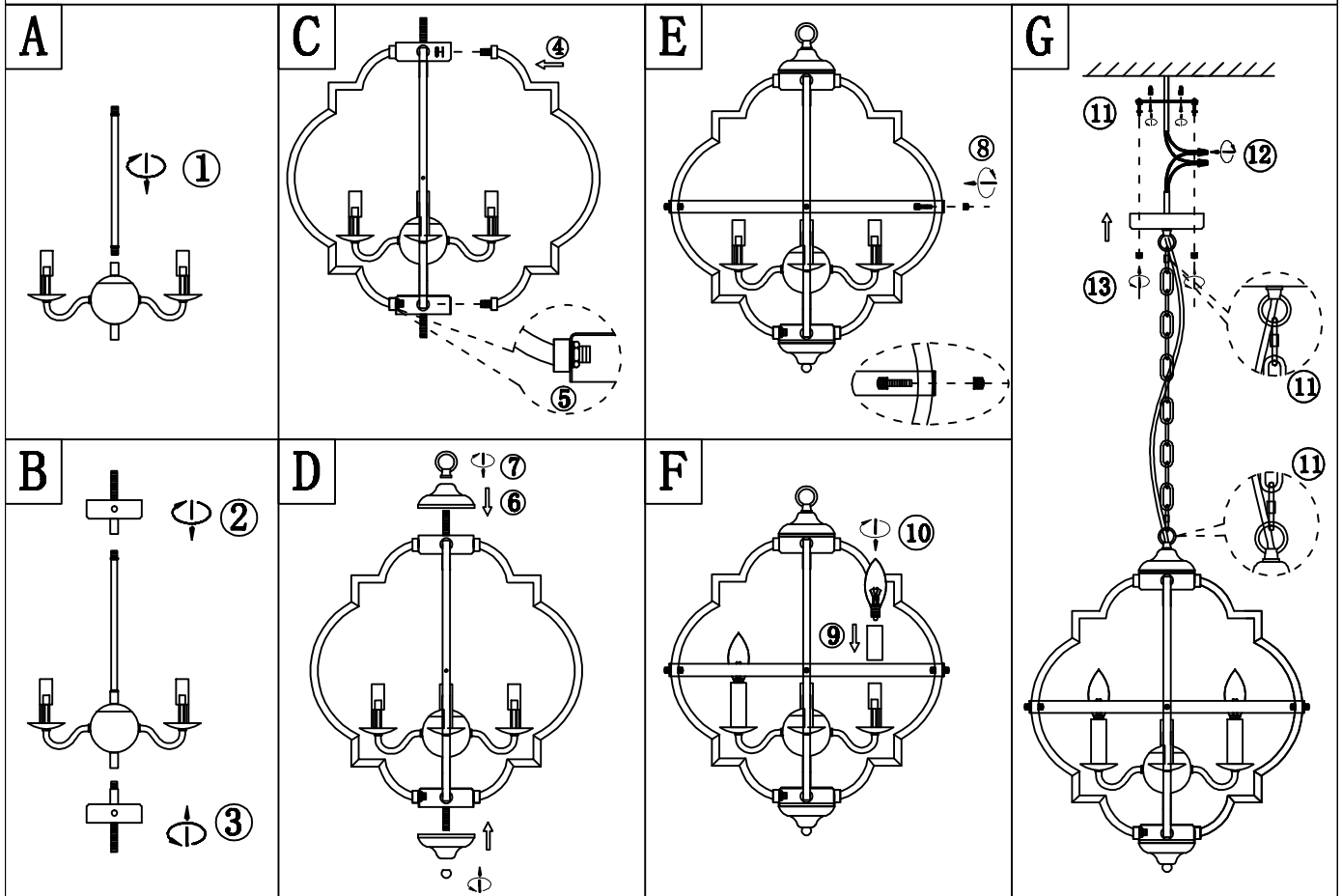

Installation instruction

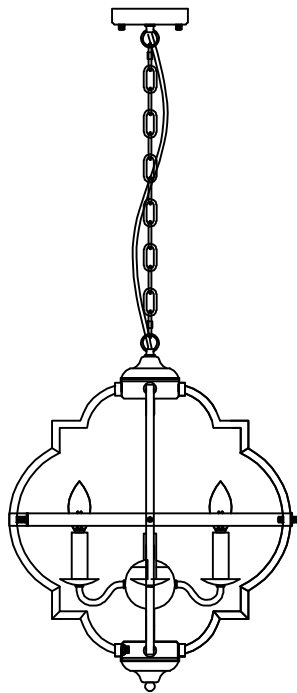

Installation steps

First of all, open the box, find out the various accessories and carefully placed on a clean platform to prevent scratches and collisions with the lamp body.

A: Screw the pipe over the ball and tighten it.

B: Screw the two lamps on to align the holes.

C: Lock the elbow with the nut.

D: Cover the metal multilayer cover and lock tightly.

E: Lock 4 decorative arc iron plates.

F: Put on the cap tube and screw on the bulb.

G: Connect the lamp body with the suction top plate with the lifting chain. Remove the hanging plate and use gecko nails and expansion screws for the hanging plate. Secure the light cable and power cable in the required position. Caution Turn off the power before connecting cables. And connect with the correct polarity.

Notes:

It is strictly prohibited to wipe the surface of lamp body with tianna and other chemical solvents. Cotton cloth is recommended. Glue a small amount of water to gently wipe the lamp.

Warm tips: this lamp is only for indoor installation and is strictly prohibited for outdoor use.