

## Notice



Move this stand gently with 2 persons.



Protect finishes by placing furniture pieces on a soft carpeted surface during assembly.



Do not place very hot/cold objects on top of any surface. Always use a coaster or mat. Never leave liquids on the surface: Clean immediately with a mild soap and a damp cloth. Never use scouring powder based cleanser. Don't touch the MDF surface with a hard/acute object it may cause the glass to shatter.



**DO NOT ASSUME CHILD SAFETY WITH ANY PIECE OF FURNITURE!**

Do not allow children to climb on furniture. Improper use can cause death or serious injury. If you are placing a TV on top use safety straps on your TV to prevent the risk of a toppling television. Furniture straps fastened to a wall can also be used to help ensure safety. Damaged parts or furniture put together incorrectly can lead to serious injuries. Make sure to follow instructions correctly.

## Parts list

① x1	② x1	③ x1	④ x1	⑤ x2	
⑥ x1	⑦ x1	⑧ x1			
A <sub>1</sub> x8	A <sub>2</sub> x4	B <sub>1</sub> x3	C <sub>1</sub> x4	C <sub>2</sub> x4	C <sub>3</sub> x4
M6 x16		M8 x45	M6 x60	Ø14	
D <sub>1</sub> x3	D <sub>2</sub> x3	E <sub>1</sub> x4	E <sub>2</sub> x2	F <sub>1</sub> x2	F <sub>2</sub> x2
M6 x8	Ø14	M6 x55			
F <sub>3</sub> x2	G <sub>1</sub> x1	G <sub>2</sub> x1	G <sub>3</sub> x1	S	
		(4mm)	(5mm)	S <sub>1</sub> ... S <sub>6</sub>	Tools Required (Not included)

## Pedestal Floor Stand ASSEMBLY INSTRUCTIONS

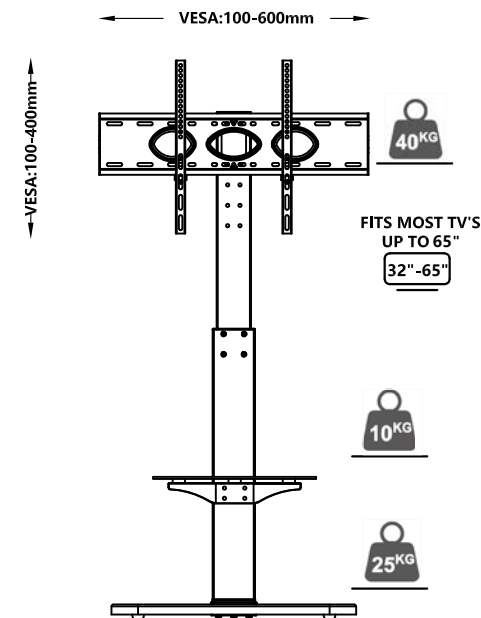

1



- 1.1 Pull out the inner metal pole a.  
1.2 Fix part ② inner pole a to you need height ( see online image show ) and lock by screw A<sub>1</sub>.

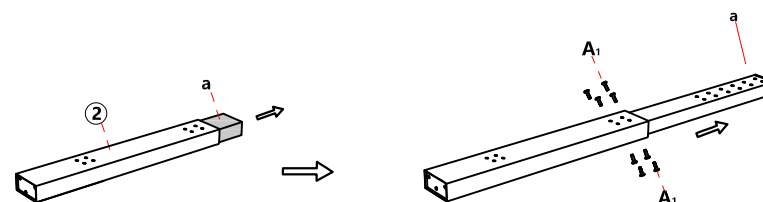

②		x1
A <sub>1</sub>		x8
G <sub>1</sub>		

2



Please do not fully tighten before screwing into the right holes.

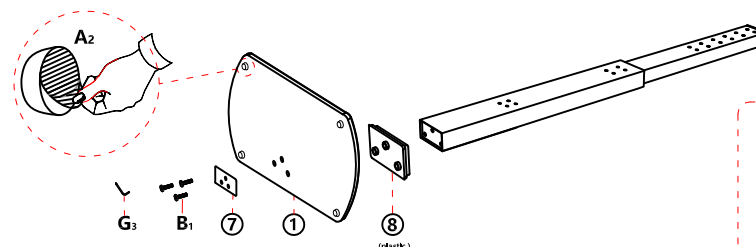

A <sub>2</sub>		x4	①		x1
B <sub>1</sub>		x3	⑦		x1
G <sub>1</sub>			⑧		x1

Team Work



3

⚠ Please do not fully tighten before screwing into the right holes.

⑥		x1
C1		x4
C2		x4
C3		x4
G1		
G2		

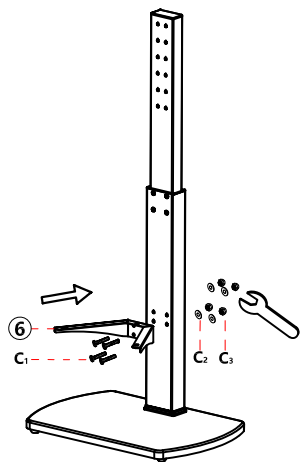

Team Work



4

⚠ Please do not fully tighten before screwing into the right holes.

③		x1
D1		x3
D2		x3
G3		

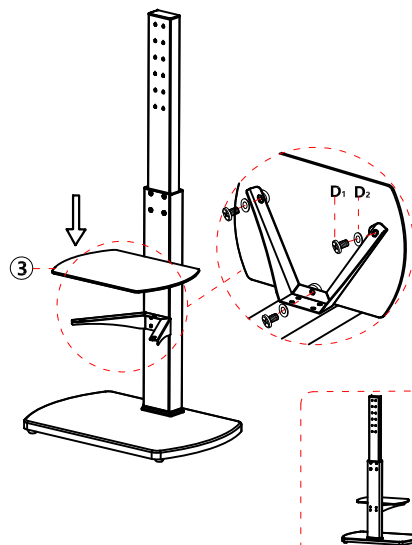

7

Choose the bolts suitable for your TV warning: In some cases TV's with shallow VESA holes may require shorter screws than those provided.

S1		M6x25	x4
S2		M6x35	x4
S3		M8x16	x4
S4		M8x50	x4
S5		Square Washer	x4
S6		Space 16x20	x4
S7		Space 16x5	x8
S8			x2

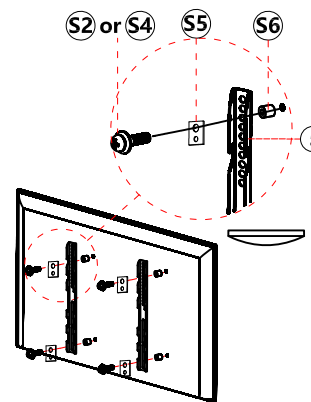

Curved or Recessed TV

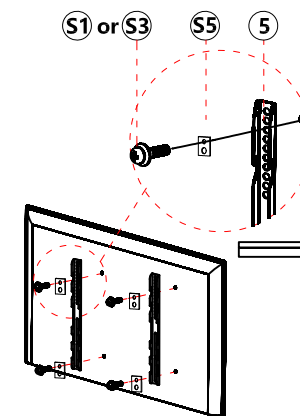

Flat Panel TV

5

⚠ Please do not fully tighten before screwing into the right holes.

Please choose TV height position before assembly, see Fig.6

④		x1
E1		x4
E2		x2
G4		

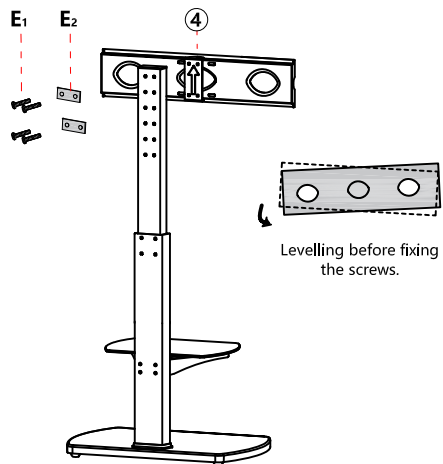

Levelling before fixing the screws.

6

⚠ The back support offer 4 height options for TVs

⚠ The mount hook offer 3 height options for TVs

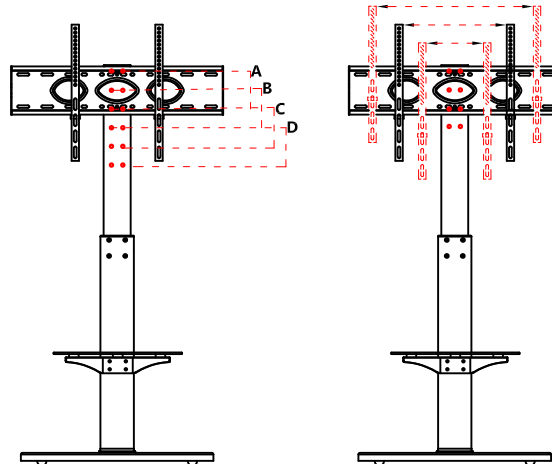

8

⚠ Important: Lock your TV before using

F1		x2
F2		x2

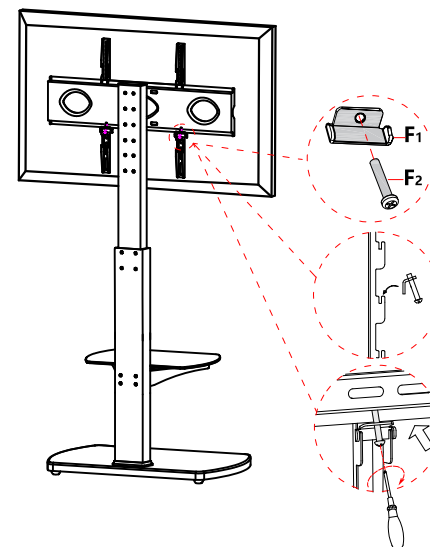

9

⚠ Please stick F3 on suitable position to manage cables.

