

# Summer Nightstand

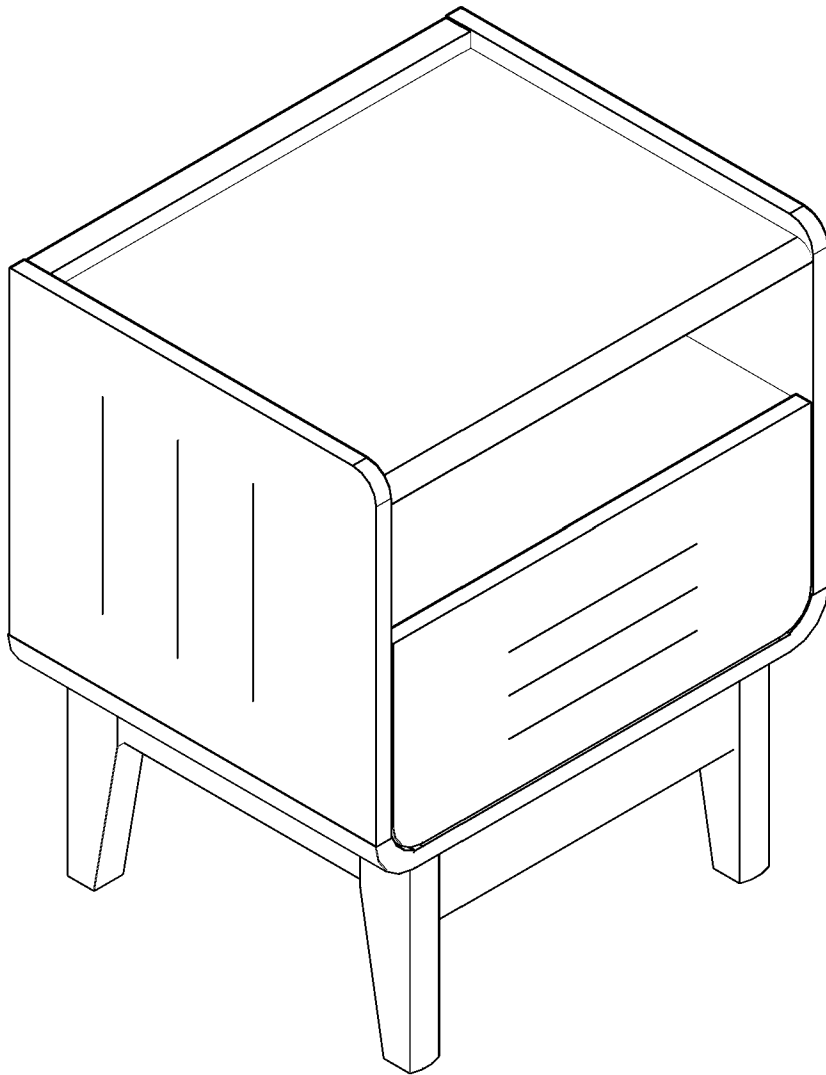

## ASSEMBLY INSTRUCTIONS



**60 min. assembly**  
**2 person**

\* The estimated assembly time may vary depending on the individual.

# Hey, there

- Now is assembly time!

Deeeeeeep breathe.... and again....

Tools ready,  
Easy peasy!

## Estimated



60 min. assembly  
2 person

## Tools Required

- Allen Wrench (Included)
- Phillips screwdriver ( not included)
- Hammer (not included)

*important: Cautious when you use power tools*

Thank you for purchasing . This product has been manufactured with the highest standards of safety and quality.

**PLEASE READ ALL INSTRUCTIONS CAREFULLY BEFORE ASSEMBLY.**

Unpack all parts from the packaging inside the carton to ensure there are no missing or damaged parts. Layout all the night table parts on a clean, flat, and soft surface to prevent scratches. Refer to the steps provided as assembling guide.

Do not attempt to assemble or use the product if any parts are missing or damaged.

Please save this manual for future reference.

### REMINDERS

#### SAFE USAGE IS KEY

Your well-being is our top priority when you use our product. Please prioritize your safety by diligently following the assembly guidelines and inspecting the product carefully both when it arrives and before each use. Please be aware that we can not be held liable for any injuries or fatalities that occur due to not adhering to the provided instructions or misuse of the product.

#### DO NOT MODIFY

Our products undergo rigorous testing to ensure they meet established safety standards before being released for sale. Altering the product in any way can lead to serious safety concerns, for which we cannot assume responsibility.

## Furniture components:

- ① Top Panel x1
- ② Bottom Panel x1
- ③ Side Panel (L) x1
- ④ Side Panel (R) x1
- ⑤ Back Mdf Board x1
- ⑥ Shelf Panel x1
- ⑦ Drawer Face Panel x1
- ⑧ Drawer Side Panel x2
- ⑨ Drawer Back Panel x1
- ⑩ Drawer Mdf Board x1
- ⑪ Complete Leg Frame x2
- ⑫ Long Back Leg Frame x1
- ⑬ Long Front Leg Frame x1

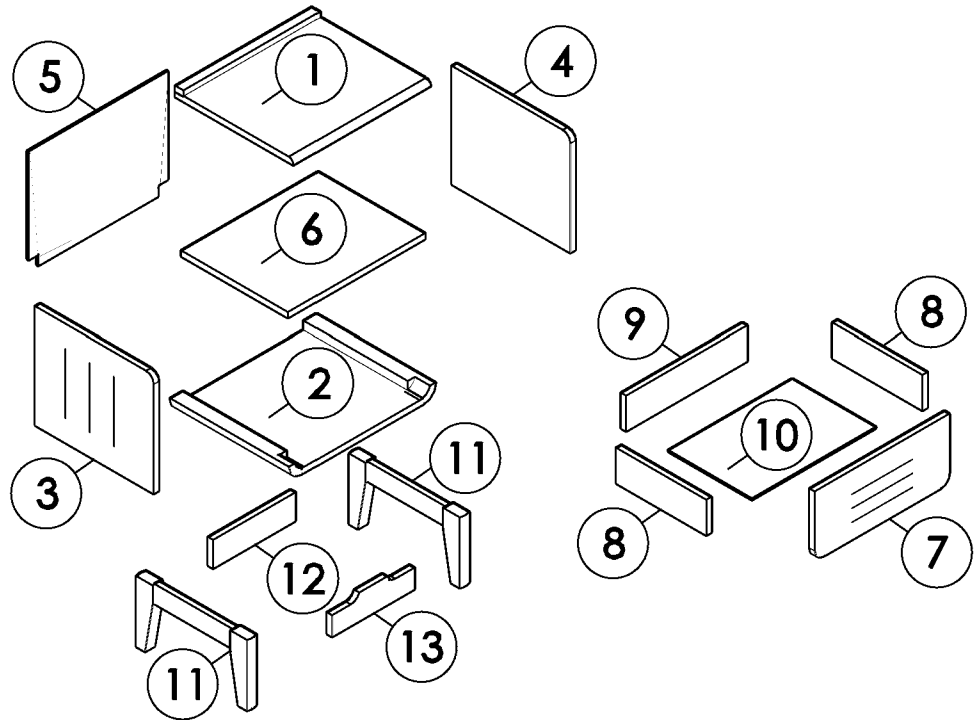

## Provided hardware:

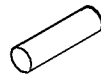

- A** Cam Pin x14   
 **B** Cam Lock x14   
 **C** Wood Dowel M8x30MM x16   
 **D** Screw M4x38MM x8   
 **E** White Leg Pin x4



- F** Screw M6x50MM x4   
 **G1** Ball Bearing 12" (Left) x1   
 **G2** Ball Bearing 12" (Right) x1   
 **G3** Screw M3.5x16MM x6   
 **H** Allen Key x1



- I i** Stub x4   
 **I ii** Screw M3x20MM x4

# Step 1

## HARDWARE :

- G1 Ball Bearing with Holder 12" (LEFT)x1
- G2 Ball Bearing with Holder 12" (RIGHT)x1
- G3 Screw M3.5x16MM x6

## COMPONENTS :

- 3 Side Panel (L) x1
- 4 Side Panel (R) x1

### Step 1: Separate the Slide:

**Release the Lock:** Inside the slide, locate a lock.

Move part A down, and part B up.

Push the lock device down to release the lock. Separate the two parts.

**Identify the Parts:** This will result in two separate components, now referred to as Part A (left) and Part B (right).

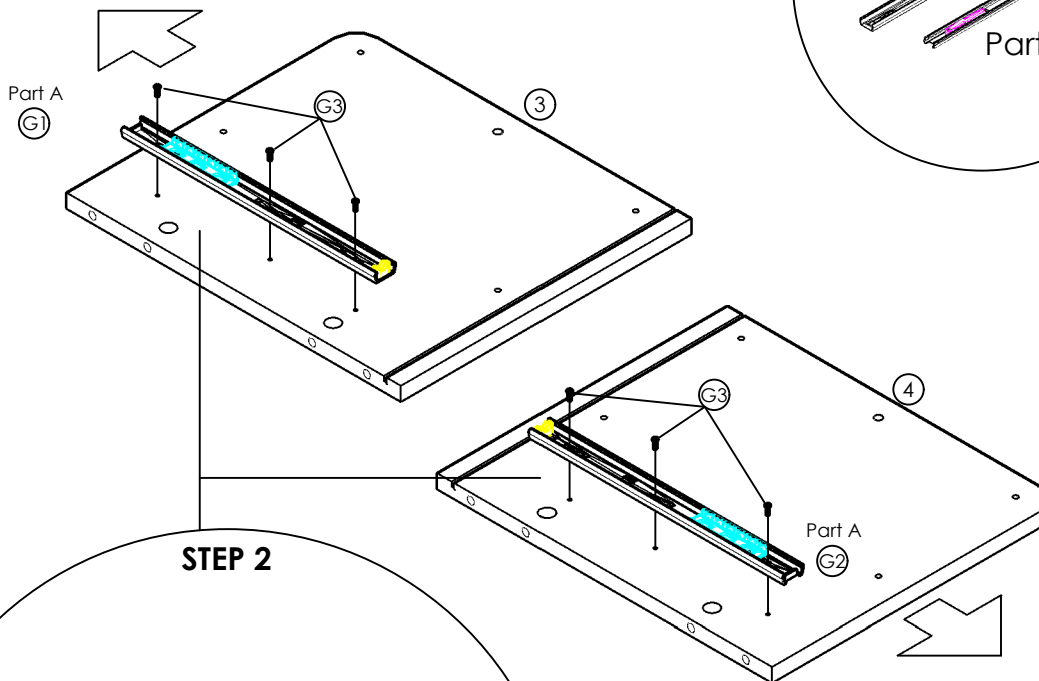
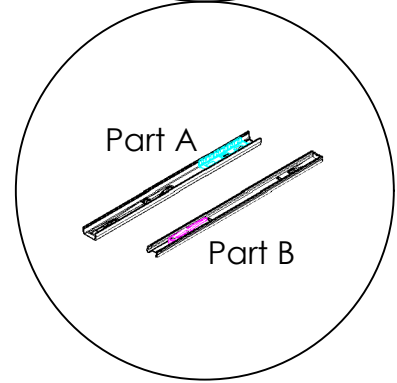
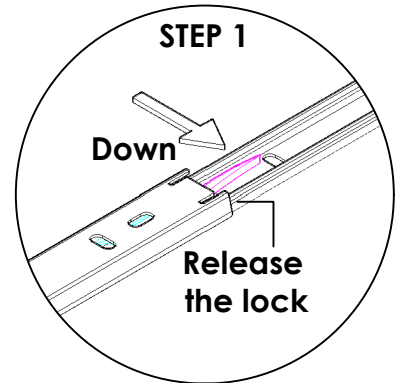

## STEP 2

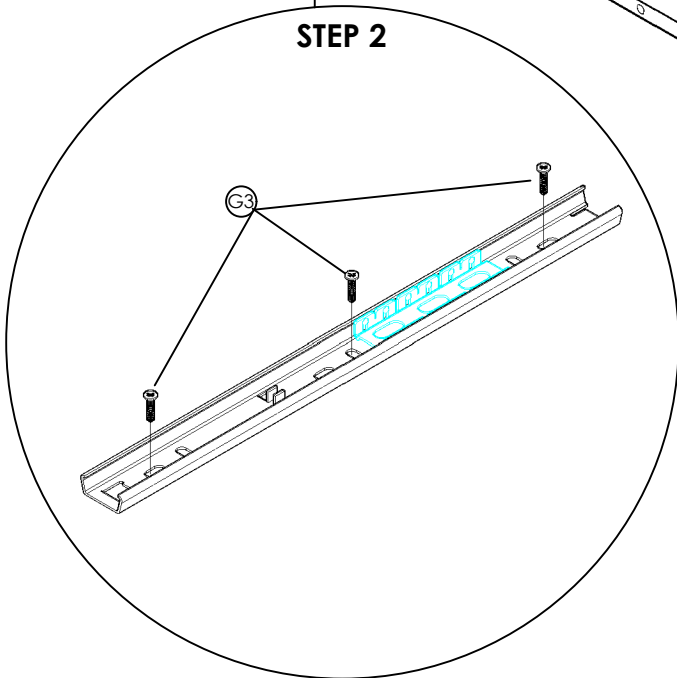

### Step 2: Attaching Part A of the Ball Bearing to the drawer support:

- **Insert Part A:** Place Part A of the ball bearing into the drawer support.
- **Align the Holes:** Ensure that Hole No. 1 from the front of Part A aligns with the pre-drilled hole on the drawer support.
- **Secure with Screw:** Use the screwdriver to fix an M3.5x16mm screw into the aligned holes.

## Step 2

### HARDWARE :

- (A) Cam Pin M5x24MM x14
- (B) Cam Lock x14
- (C) Wood Dowel M8x30MM x16
- (E) White Leg Pin x4

### COMPONENTS :

- (1) Top Panel x1
- (2) Bottom Panel x1
- (3) Side Panel (L) x1
- (4) Side Panel (R) x1
- (6) Shelf Panel x1
- (11) Complete Leg Frame x2
- (12) Long Back Leg Frame x1
- (13) Long Front Leg Frame x1

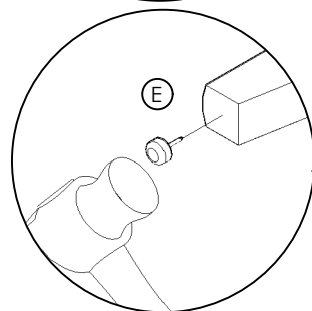
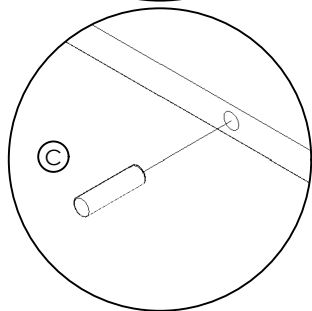
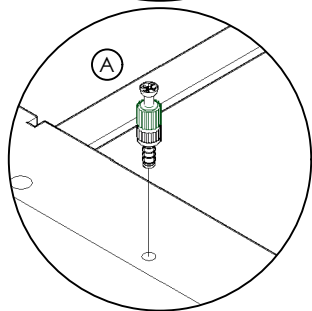
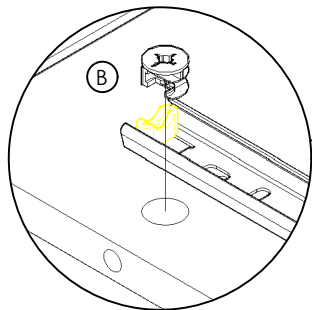

**Installation Cam Pin:**  
Please using a screwdriver.

**Installation Hardware:**  
Please using hammer to insert hardware (C) and (E)

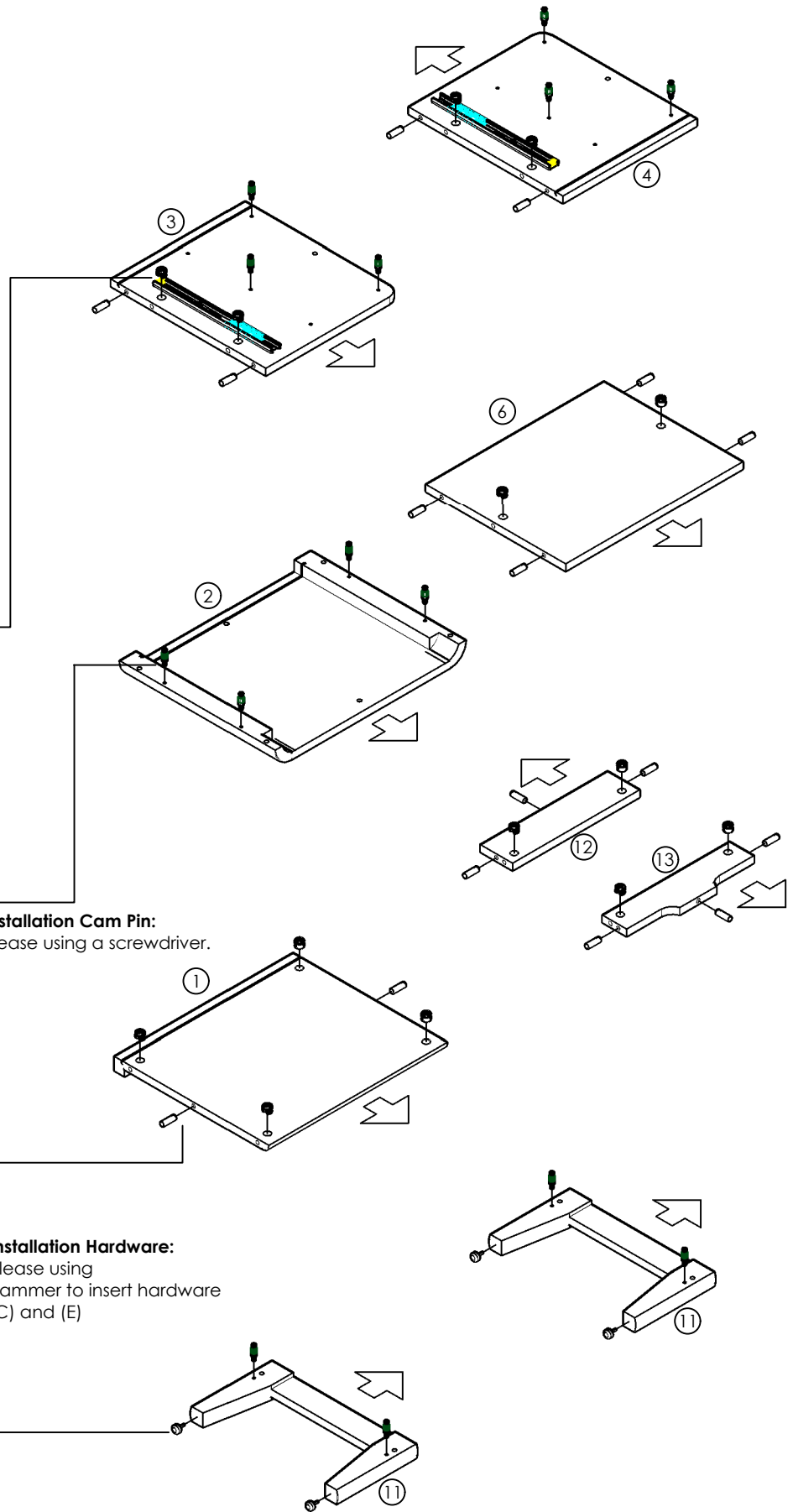

## Step 3

### HARDWARE :

(H) Allen Key x1

### COMPONENTS :

(1) Top Panel x1

(3) Side Panel (L) x1

(4) Side Panel (R) x1

(6) Shelf Panel x1

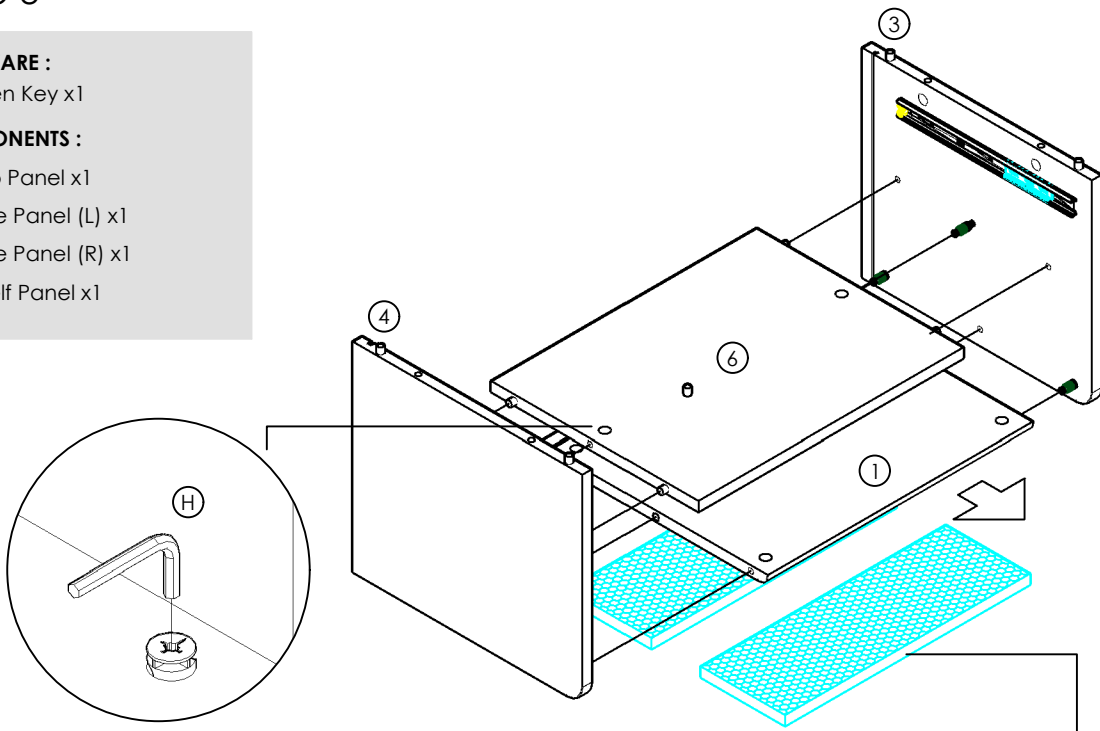

### Installation:

As shown, the head of minifix housing goes into the open mouth of the mini fix bolt. Use Allen Key then turn the minifix housing so it tightens over the mini fix bolt.

Place foam to support the panel during the installation process. Use foam in the box.

## Step 4

### HARDWARE :

(H) Allen Key x1

### COMPONENTS :

(11) Complete Leg Frame x2

(12) Long Back Leg Frame x1

(13) Long Front Leg Frame x1

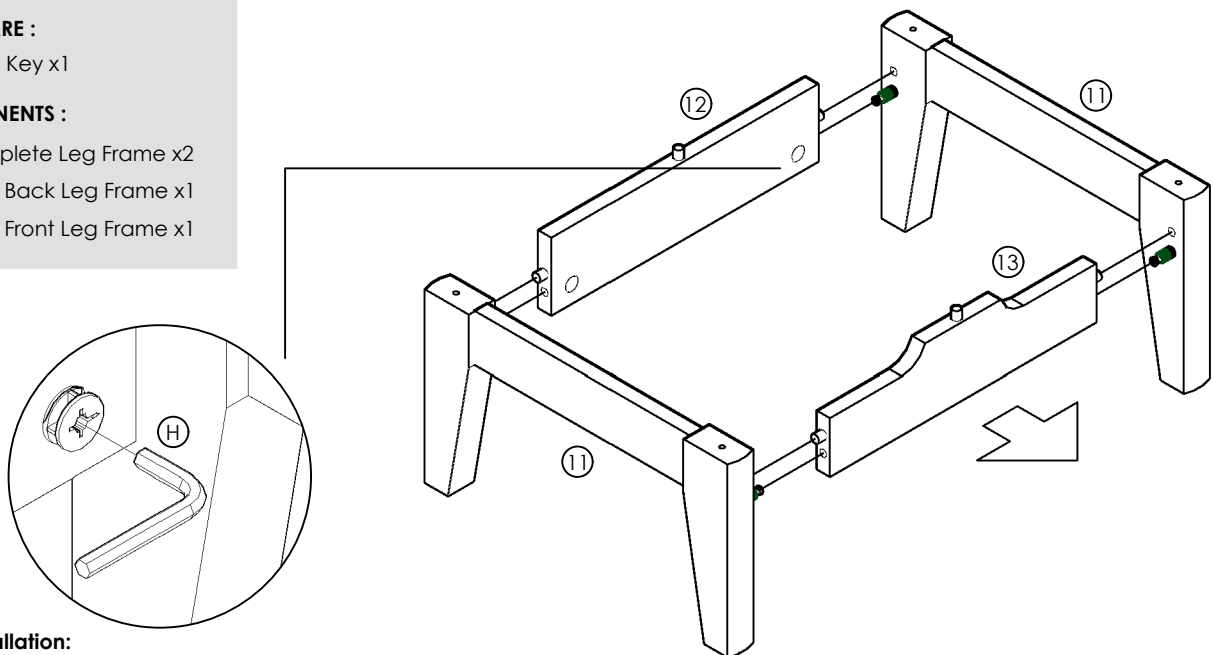

### Installation:

As shown, the head of minifix housing goes into the open mouth of the mini fix bolt. Use Allen Key then turn the minifix housing so it tightens over the mini fix bolt.

## Step 5

### HARDWARE :

(F) Screw M6x50MM x4

(H) Allen Key x1

### COMPONENTS :

(2) Bottom Panel x1

#### Installation Screw:

Please insert the screw (I) on panel using a allen key.

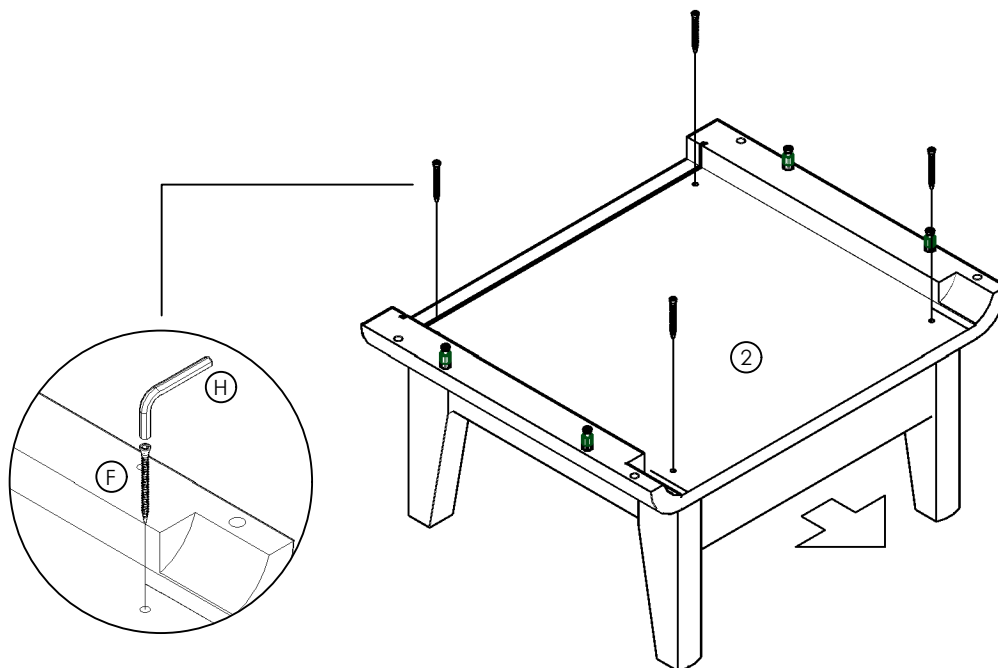

## Step 6 (combine step 3 and step 5)

### HARDWARE :

(H) Allen Key x1

### COMPONENTS :

(5) Back Mdf Board x1

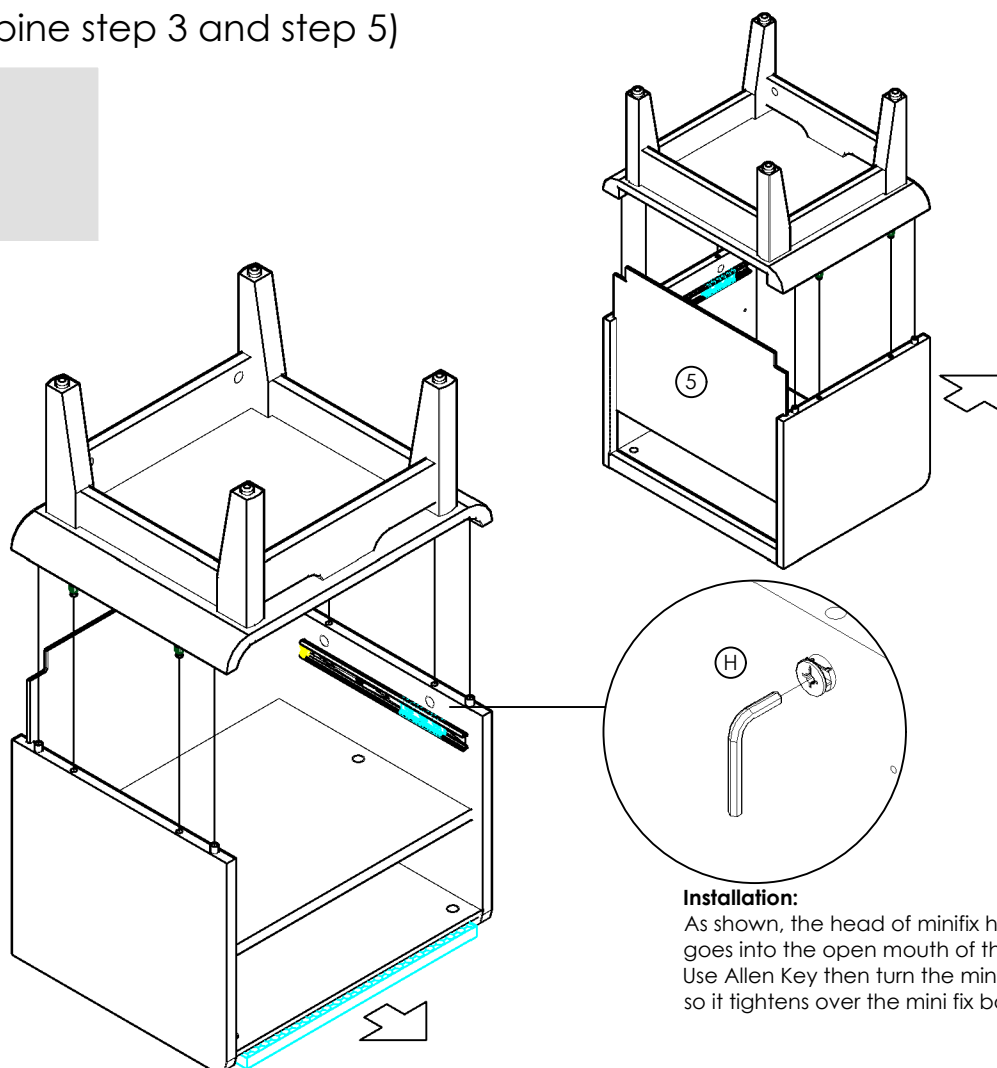

#### Installation:

As shown, the head of minifix housing goes into the open mouth of the mini fix bolt. Use Allen Key then turn the minifix housing so it tightens over the mini fix bolt.

## Step 7

### HARDWARE :

- (I i) Stub x4
- (I ii) Screw M3.5x16MM x4

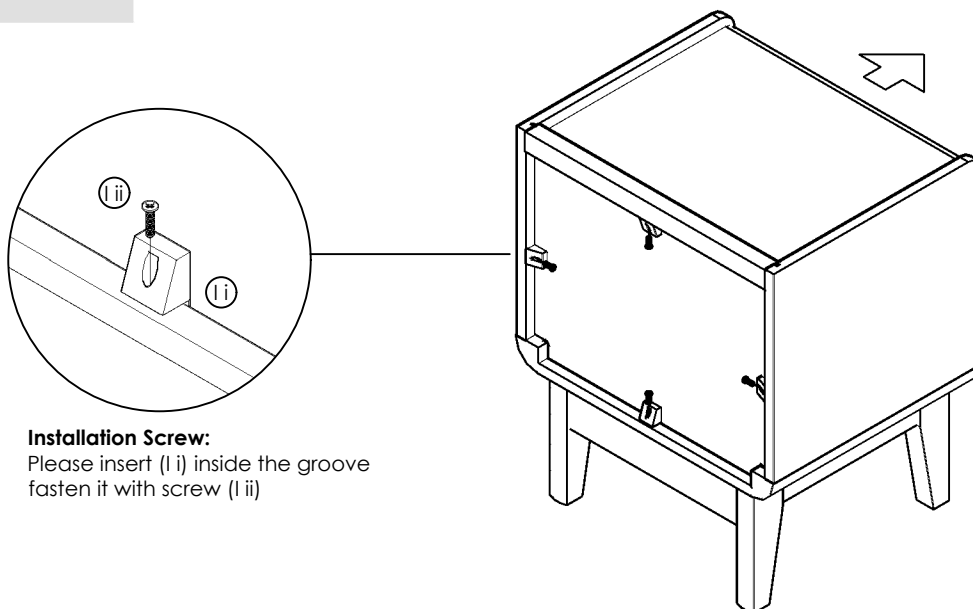

#### Installation Screw:

Please insert (I i) inside the groove  
fasten it with screw (I ii)

## Step 8

### HARDWARE :

- (D) Screw M4x38MM x8

### COMPONENTS :

- (7) Drawer Face Panel x1
- (8) Drawer Side Panel x2
- (9) Drawer Back Panel x1
- (10) Drawer Mdf Board x1

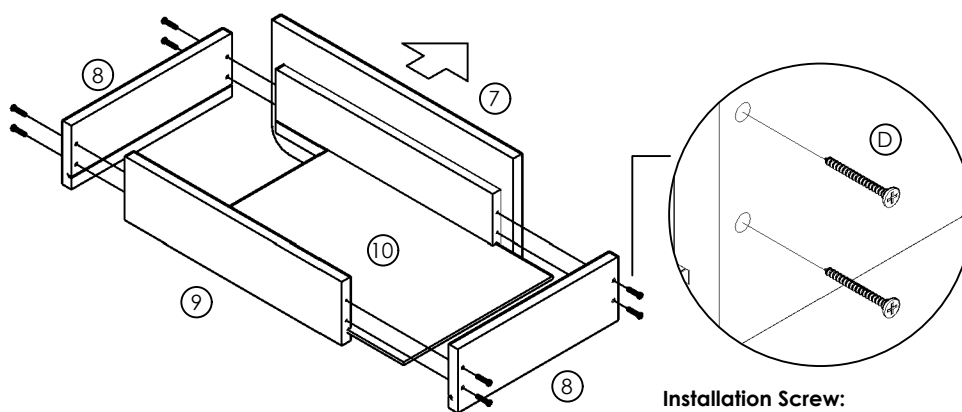

#### Installation Screw:

Please insert the screw (F)  
on panel using a screwdriver.

## Step 9

### HARDWARE :

- Ⓒ1 Ball Bearing with Holder (LEFT) 12" x1
- Ⓒ2 Ball Bearing with Holder (RIGHT) 12" x1
- Ⓒ3 Screw M3.5x16MM x4

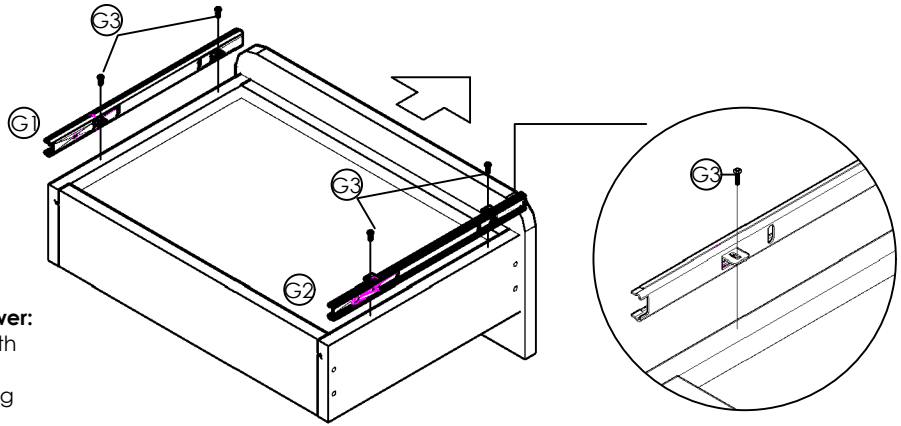

### Installing Ball Bearing Slide Part B on the Drawer:

**Prepare Drawer Bottom:** Place the drawer with its bottom side facing up.

**Position Ball Bearing Slide:** Set the ball bearing slide Part B on the drawer.

**Align with Drawer Face:** Ensure Part B is aligned with the drawer face.

**Secure with Screws:** Use an M3.5 x 16mm screw and a screwdriver to fasten the slide securely to the drawer.

## Step 10 (combine step 7 and step step 9)

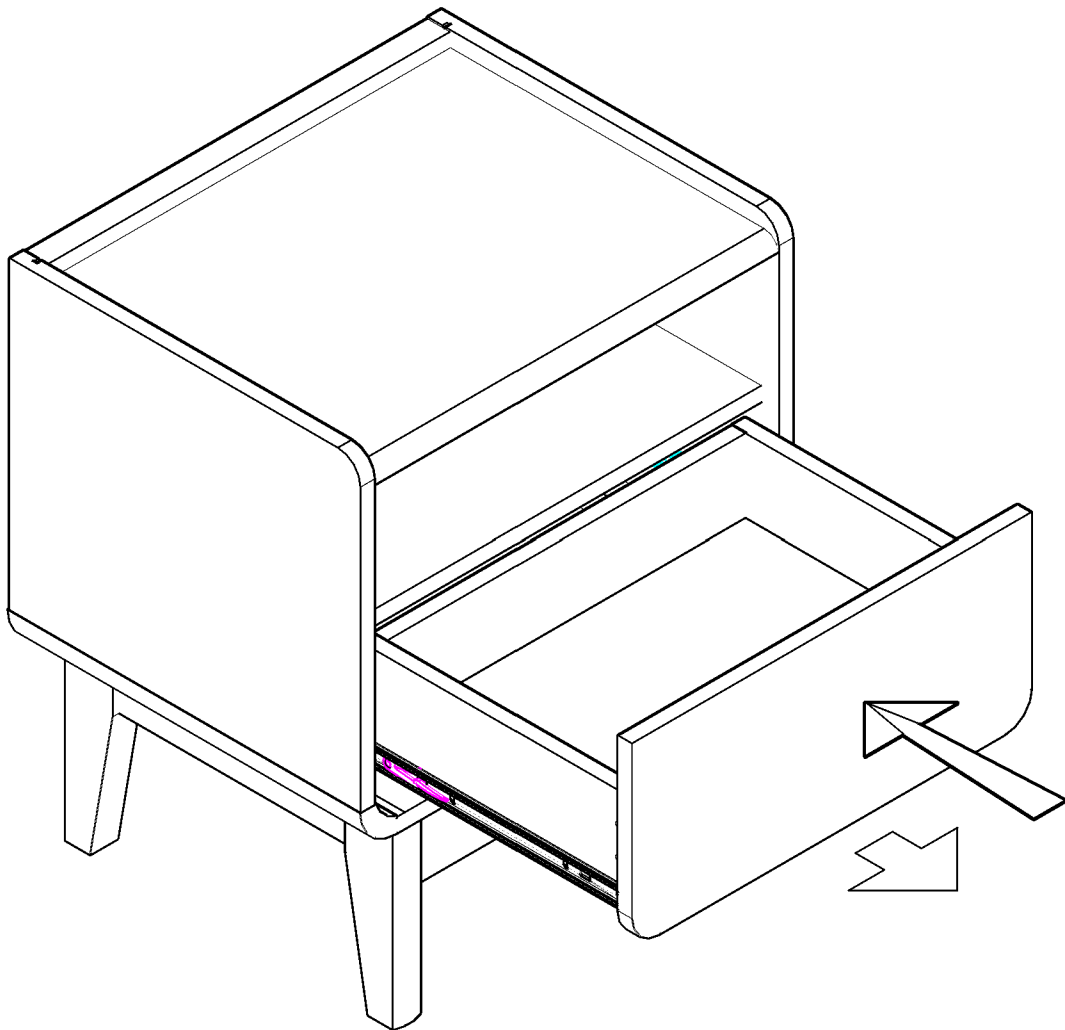

# VOILA!

Now enjoy.

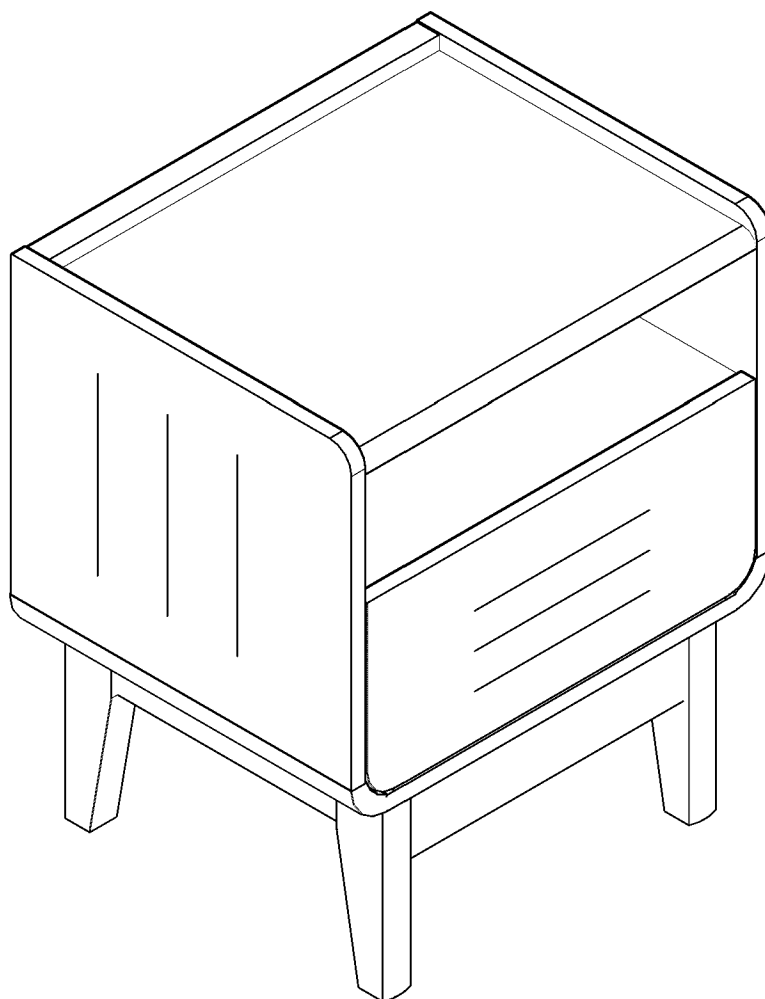

## Warning !!!

DO NOT stand on the table as this may damage the product and cause serious bodily injury.

# Something not right?

We are always here to help.

We make mistakes like every human does. Though we always strive to provide the best possible products at competitive prices and the best service in the industry, it's not possible to completely eliminate mistakes. If you experience any dissatisfaction, feel free to contact us immediately. Our in-house customer care team will respond ASAP.

## Things to do to expedite the process

- Have your order# ready
- Take photos/videos to help us better identify the issues
- DO NOT throw away the packaging

# Happy with our product?

## Leave us a review

It really help us as a small business

Find the product you purchased on our website (tip: search by SKU) and leave us a review.

Alternatively, you can always return to the marketplace where you purchased it and leave a review there.

# Please save this manual for future reference.