

Assembly Instructions

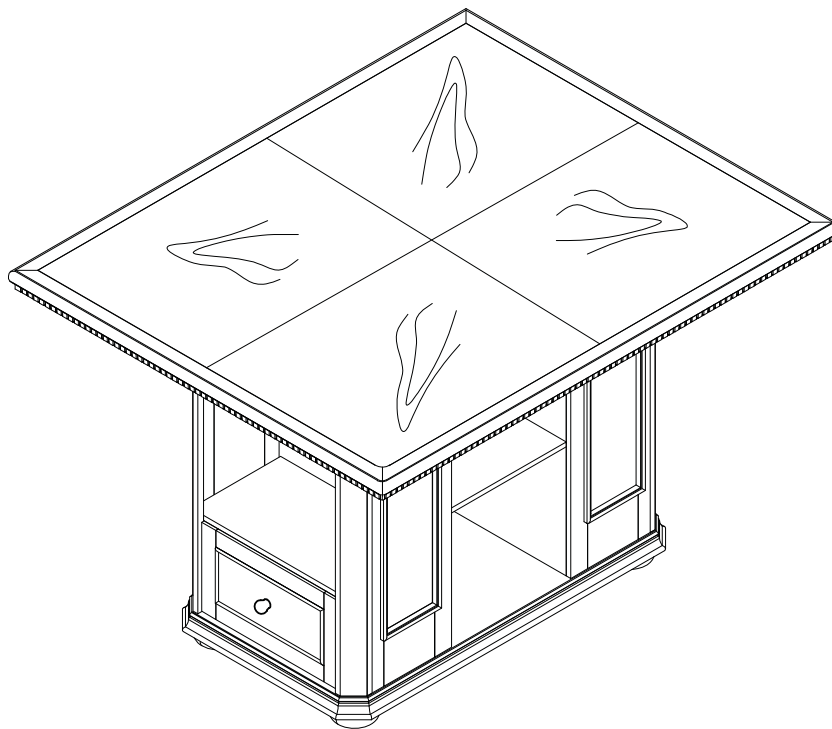

ASSEMBLY RATING

The Assembly Rating is a 5-point system that shows the degree of effort needed in assembling a specific product (with 1 being easy and 5 being difficult). For some products, two persons are recommended.

EASY  DIFFICULT

Tools Required For Assembly:

Allen Wrench

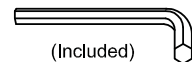

(Included)

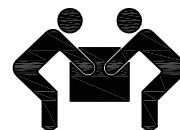

2 PERSONS RECOMMENDED

ASSEMBLY & CARE ADVICE

FOR YOUR FURNITURE TO LAST, CORRECT ASSEMBLY AND PROPER MAINTENANCE ARE NECESSARY. PLEASE FOLLOW THE INFORMATION PROVIDED BELOW TO FULLY ENJOY YOUR FURNITURE.

BASIC ASSEMBLY TECHNIQUES



1
When lock or spring washer is used in an assembly, please make sure the lock or spring washer is placed between the larger flat washer and the head of the screw or bolt.



2
Position each part correctly and insert screws or bolts into their respective holes by hand tighten or using the proper hand tool. Only tighten when step is completed or when instructed to do so.



3
Use cardboard or carpet area when assembling furniture to prevent scratches. Make sure the furniture rests on a flat and level surface with each leg evenly touching the floor.



4
Some furniture comes with height adjustment knobs underneath each leg. To lower or to raise each leg, you need to turn clockwise or counterclockwise, respectively.



5
Make sure all parts are properly aligned, then use the appropriate hand tool to completely tighten the bolts or screws. Do not use power tools and do not overtighten.

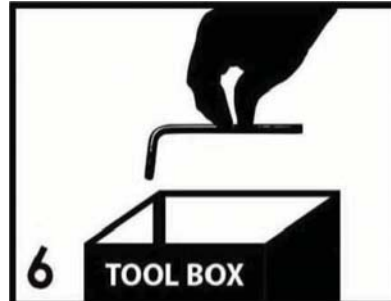

6
Save the instructions and store the Allen wrench or any supplied tool for later maintenance. After two weeks, check and tighten any loose hardware and repeat again every six months thereafter.

IT IS THE USER'S RESPONSIBILITY TO MAINTAIN THE FURNITURE. THE HARDWARE MAY LOOSEN OVER TIME AND MAY CAUSE THE FURNITURE TO BE WOBBLY AND UNABLE TO SUPPORT ITS INTENDED WEIGHT CAPACITY. THIS MAY LEAD TO COLLAPSE AND MAY CAUSE SERIOUS INJURY.

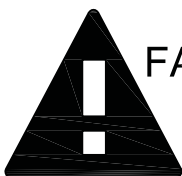

FAILURE TO FOLLOW THE GUIDELINES ABOVE MAY RESULT IN INJURY AND/OR PROPERTY DAMAGE.



Before you begin, please read Page 2 of "Assembly and Care Advice".

And remember, do not tighten until each step is completed or instructed.

Parts List



#1 x 1pc
Top Table

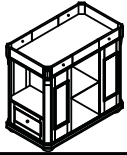

#2 x 1pc
Cabinet Body



#3 x 4pcs
Foot



#4 x 1pc
Center leg

Hardware List

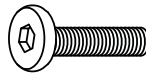

#A x 4pcs
Bolt 5/16"X1-3/4"

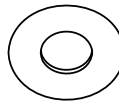

#B x 4pcs
Flat Washer (Ø5/16")



#Cx 4pcs
Lock Washer(Ø5/16")



#D x 1pc
Allen Wrench M4

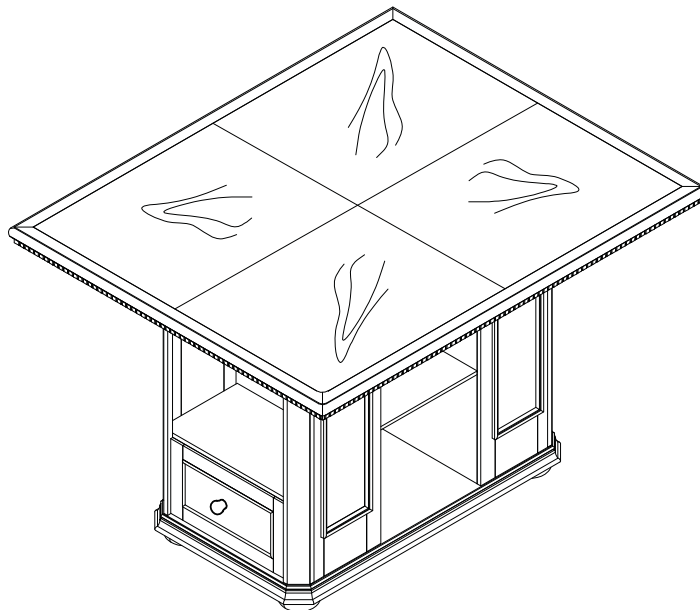

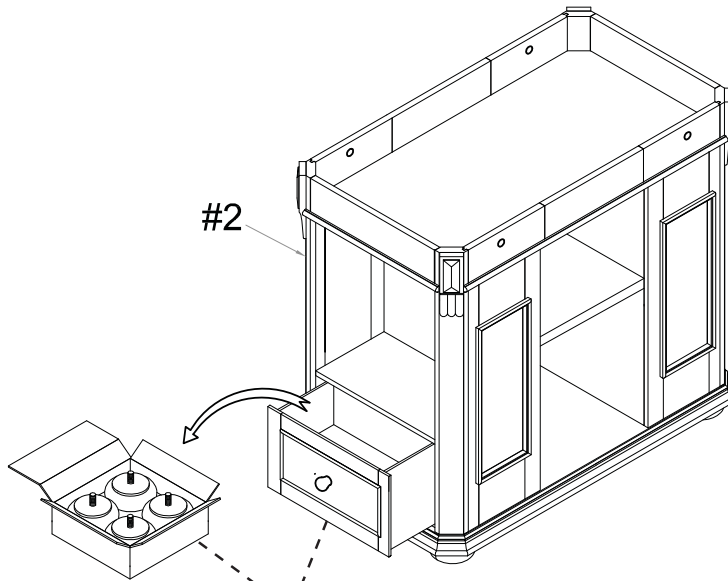

Open the bottom drawer to find a box with the foot (#3).



Adjust leveler according to ground level.

1. Place the cabinet body (#2) face down onto a protected surface, then insert the threaded ends of the foot (#3) into the holes along each corner. Turn right to tighten.

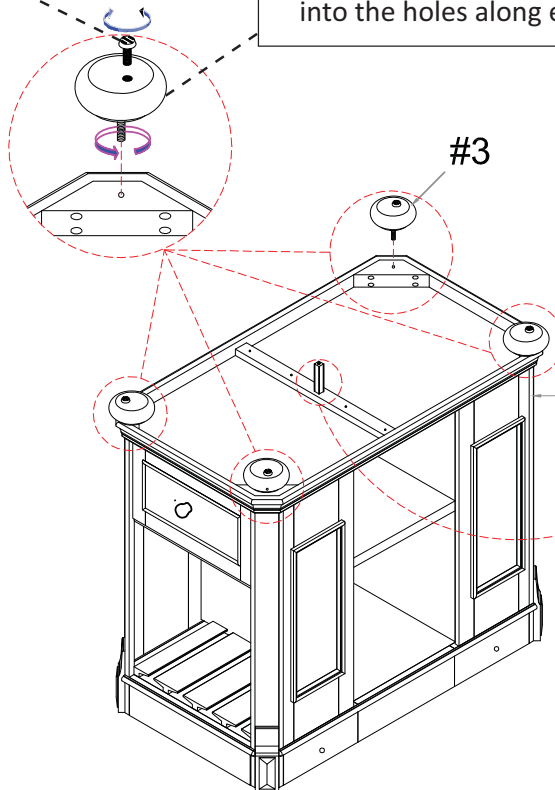

2. Insert the threaded end of the center leg (#4) into the hole along the bottom center of the cabinet. Turn right to secure.

Adjust the leveler according to the ground level. To lower or to raise the leg, you need to turn the leveler clockwise or counter-clockwise, respectively.



1. Carefully place the table top (#1) onto the cabinet body (#2), and make sure to align the holes.

2. Prepare 4 bolt assemblies by first inserting a lock washer (#C) onto the bolt (#A) then a flat washer (#B) onto that same bolt (#A). Insert a bolt into each hole. Secure using the Allen wrench (#D).

#A x 4 pcs
#B x 4 pcs
#C x 4 pcs

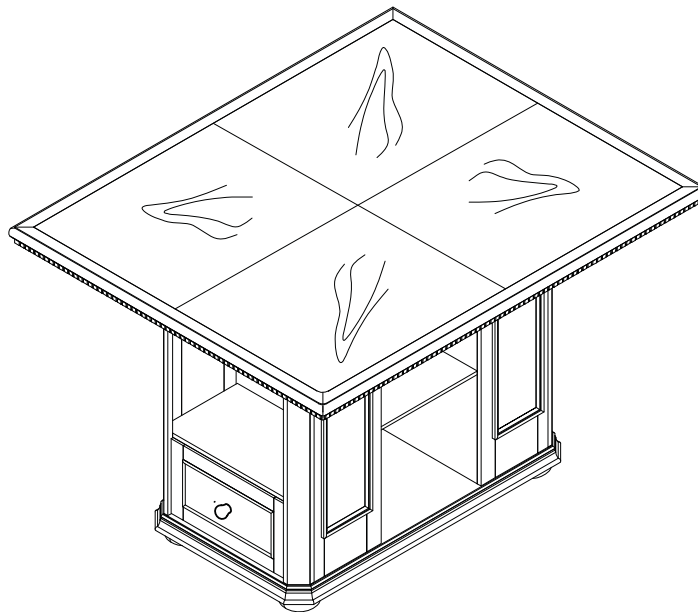
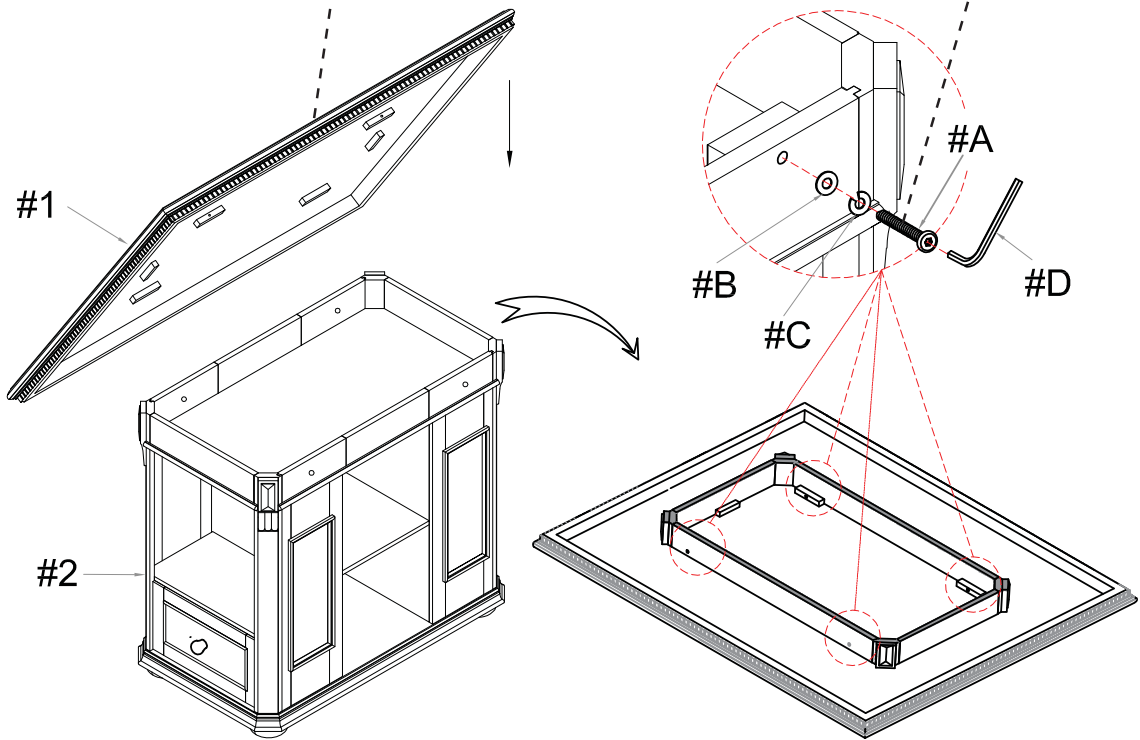

ASSEMBLY IS COMPLETED