

# 精品航空箱 portable pet carrier

**STEP 1:** 打开包装，配件如图，将隔尿踏板放在底座盒里。

Take out the three parts, and match the mesh right with the bottom part.

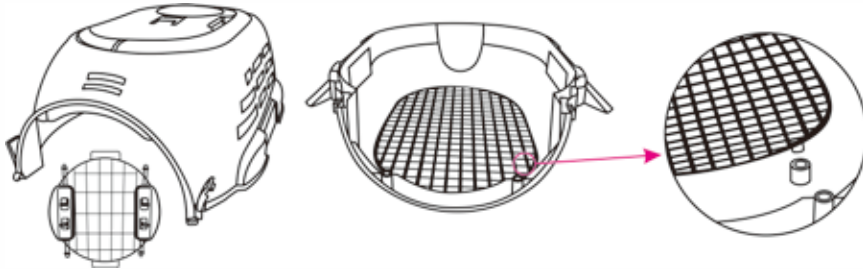

**STEP 2:** 上下槽对准后，用手压着合紧，不分先后依次扣好五个卡扣

Match the two parts in the right place, then buckle the five clips in three sides.

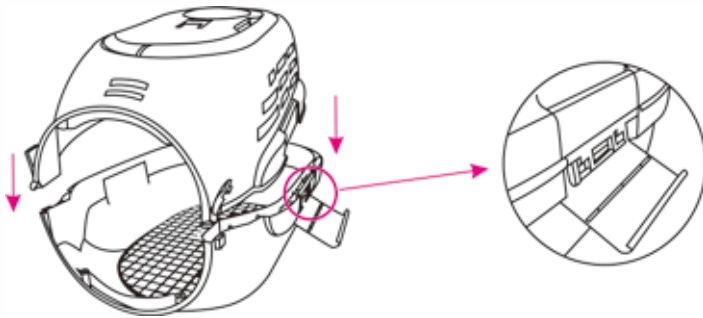

**STEP 3:** 门上左右两边各有两个按钮，两边同时按住，上下孔对准，卡进去即可。

Push the two buttons together in opposite direction, then match the door aim to the up and down hole and release.

