



Household Use Only

Stainless Steel Vacuum Carafe SH-HB Instruction Manual

Name of Each Part

- Be sure that all parts are attached firmly before each use.

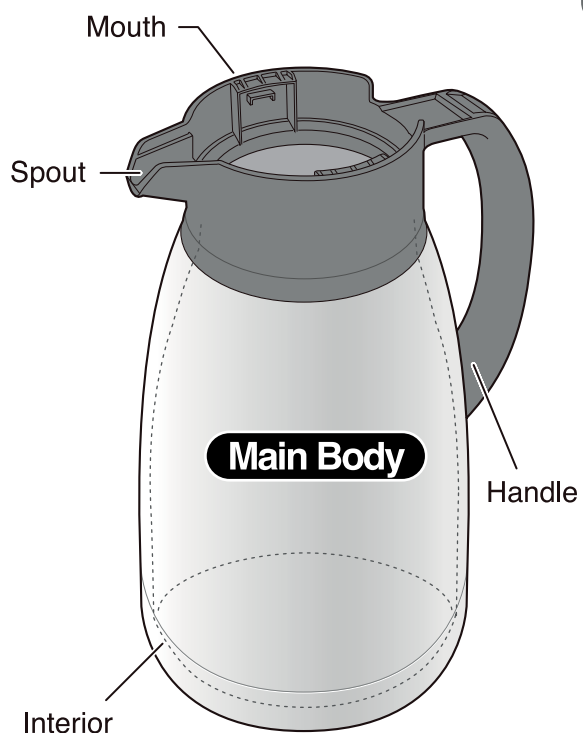

Stopper Set

Upper Stopper Set

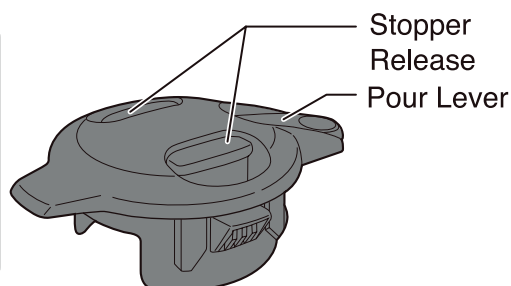

Lower Stopper Set

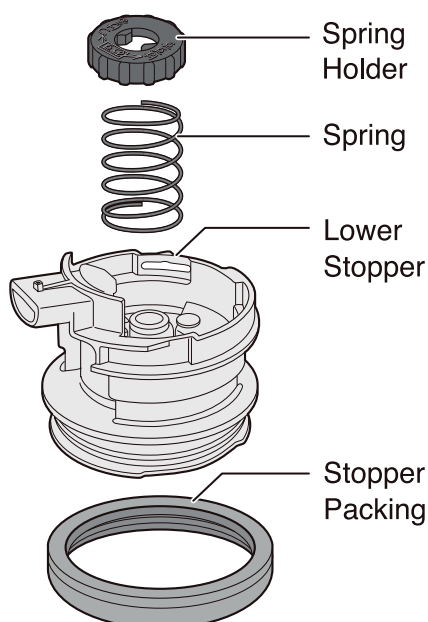

Stopper Valve Set

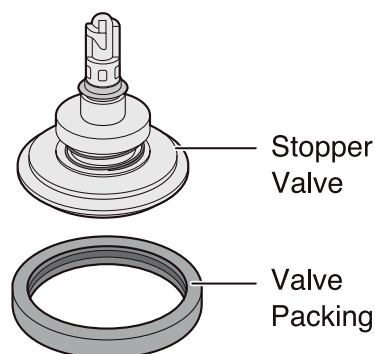

Please read these instructions before use, and keep for future reference.

SH-HB(E/K) / A

Important Safeguards

Please follow these instructions to prevent scalding, deterioration and discoloration of beverages, as well as malfunction and staining of the Carafe.

Keep out of the reach of infants and small children. Do not allow them to play with this product.

Mishandling may cause injury or scalding.

Do not use under direct sunlight or near open flames from sources such as stoves.

Doing so may cause deformation or discoloration of the Carafe.

Leave 1cm (1/2-inch) room on top when filling the Carafe.

Be careful not to over fill the Main Body.

Over filling may cause leakage.

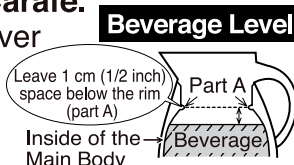

Do not place inside moving vehicles when filled.

Doing so may cause burns, stains, or damage.

Do not turn the Carafe on its side when filled with beverages.

Hot beverages may leak and cause scalding, even if the Pour Lever is closed.

When removing the Stopper Set, press the Pour Lever once to release steam before removing the Stopper Set.

Not doing so may cause the Stopper Set to pop off and release steam, which may lead to injuries and burns.

Do not press the Pour Lever with the Carafe close to your face or tilted toward you.

Hot beverages may suddenly come out or spew out and may cause scalding.

After attaching the Stopper Set to the Main Body, make sure that the Lower Stopper Set is mounted correctly by pressing the Pour Lever several times.

If the Stopper Set is not properly attached, beverages may leak and cause burns or stain clothes.

Hold the handle firmly when carrying the Carafe.

● **Do not tilt the Carafe or carry it on its side.**

Doing so may cause burns or stains.

● **Do not hold the Carafe by the Stopper Set or Pour Lever.**

The Carafe may fall and be dangerous.

● **Do not press the Pour Lever while carrying.**

Beverages may spill out and cause burns or stain clothes.

Do not use the Carafe if it loses its heat retention properties.

The outside of the Main Body may become very hot if hot beverages are poured inside.

Always close the Stopper Set securely.

If the Stopper Set comes off, beverages may spill and cause burns.

Always make sure that all packings and valves are attached.

Hot beverages may leak and cause scalding. They may also cause stains.

Avoid dropping or hitting against hard surfaces.

Damage to plastic parts or the stainless steel surface of the Carafe may reduce its ability to retain heat.

Do not place near open flames (from gas stoves) or on top of electric heaters or IH cooking devices.

Doing so may cause fires, burns, or damage.

Clean the Main Body after every use.

Not cleaning thoroughly may cause the Main Body to rust, beverages to spoil, or cause pinholes.

Do not use for other than intended purposes.

This Carafe is for keeping beverages hot or cold.

Do not disassemble the Main Body.

Important Safeguards

Please follow these instructions to prevent scalding, deterioration and discoloration of beverages, as well as malfunction and staining of the Carafe.

Consume beverages within the same day to prevent from spoiling.

If left inside for a long period of time, the Carafe may deteriorate or corrode. Also, beverages left inside may spoil and produce gas which increases the pressure inside the Main Body, causing the Stopper Set to pop off and beverages to spill, causing injuries.

Do not fill the Carafe with the following:

●Dry ice and carbonated drinks:

Contents may spill out or the pressure may cause the Stopper Set to burst, causing injuries.

●Liquids high in sodium such as soup and Kobu-cha:

Although the liner is made of 18/8 stainless steel, salt may cause rust resulting in loss of thermal insulation.

●Dairy products and fruit juice:

If left inside for a long period of time, contents may spoil and produce gas that may cause the Stopper Set to burst, causing injuries.

●Fruit pulp and tea leaves:

May become caught on the Stopper Packing and cause contents to spoil.

Warnings & Cautions

Do not allow hot kettles to touch the mouth of the Main Body.

Doing so may cause burns if the Carafe is tipped over. It may also cause scratches or deformation of the product.



Do not force large ice cubes in.

Doing so may cause deformation or damage to the product.

Do not rub the design on the outside of the Main Body strongly.

It may come off.

Do not place cans or bottles inside the Main Body.

Doing so may cause deformation or damage to the Carafe.

Hot tea may discolor when stored for a long period of time.

We recommend filling the Main Body with hot water, and using a small teapot or tea bags to brew tea, or to drink brewed tea as quickly as possible.

After cleaning the Stopper Set, shake it well to remove excess water then wipe it thoroughly.

Water left inside may leak out.

When keeping hot drinks warm, the pressure inside may rise and steam may escape slightly from the Stopper Set while making a sound. Release steam by pressing the Pour Lever to stop the sound. Releasing pressure is for safety purposes, and does not indicate a malfunction.

Always wash the Stopper Set, Valve, and all Packings after using the Carafe.

Not doing so may cause decay, mold, odor or discoloration. It may also cause leaks.

Do not attach parts other than those specifically for this product.

Doing so may cause leaks or breakage.

The rattling noise that may be heard when the Carafe is shaken comes from the copper or aluminum foil in the vacuum insulation to increase heat (cold) retention and does not indicate a malfunction.

The illustrations used in this instruction manual may vary from the actual product you have purchased.

How to Use

Before use, rinse the Stopper Set and the interior of the Main Body thoroughly with lukewarm water.

Always make sure that all parts of the Stopper Set are properly attached before using. See pg. 7-8 “How to Assemble the Stopper Set” for details. (Beverages may leak if the parts are not attached properly.)

1 Remove the Stopper Set.

① Hold the handle with one hand and pinch the Stopper Release.

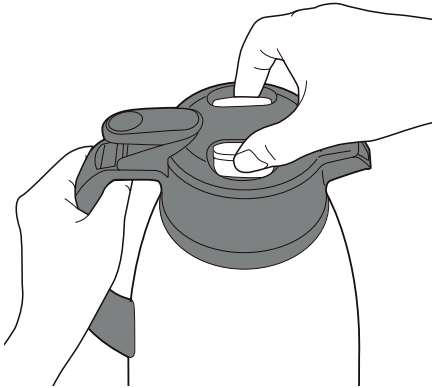

② Pull the Stopper Set out while pinching.

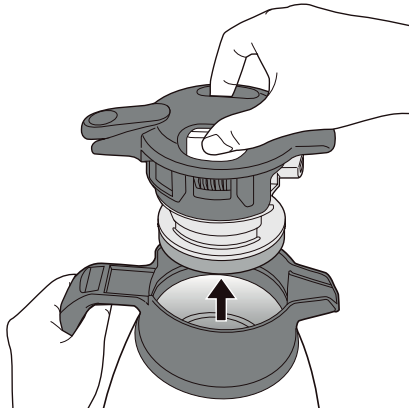

2 Fill with beverage and attach the Stopper Set.

Press the center of the Stopper Set straight down.

- Firmly push the Stopper Set until the Stopper Release on both sides click into place.

【Caution】

Make sure to press down the center of the Stopper Set. You may pinch or injure your finger or hand between the Stopper Set and the Main Body.



3 Pour beverage.

① Hold the handle and press the Pour Lever with the Main Body standing upright.



② While holding and pressing the Pour Lever, tilt the Carafe to pour.

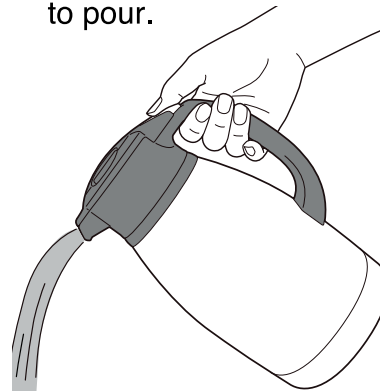

How to Use, continued

4 After pouring:

① While holding and pressing the Pour Lever, stand the Carafe upright.

② Release the Pour Lever.

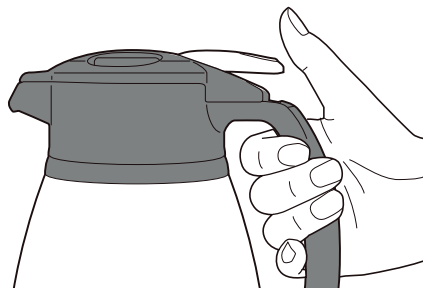
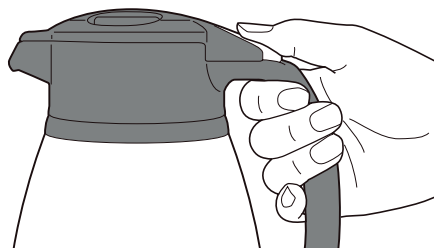

[Caution]

Stand the Carafe upright while releasing the Pour Lever.

● If the Pour Lever is released while the Carafe is tilted, beverages may remain in the Stopper Set and cause leaks while in use, resulting in burns or stains.

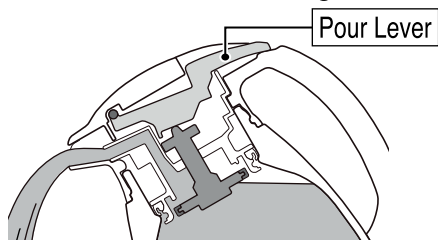

If the Pour Lever is released while tilted



Beverages remain in the Stopper Set

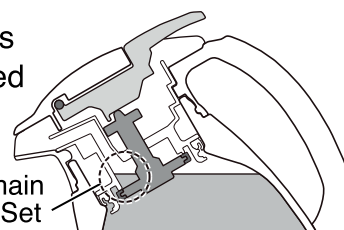

Preheat or precool the Main Body before filling with your beverage for better heat retention.

Beverage Level.

Leave 1 cm (1/2 inch) space below the rim (part A)

Inside of the Main Body

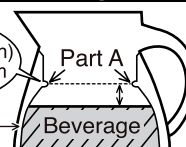

How to Disassemble the Stopper Set

1 Remove the Upper Stopper Set.

① Hold the Upper Stopper Set and turn the Lower Stopper Set in the direction indicated by the arrow.

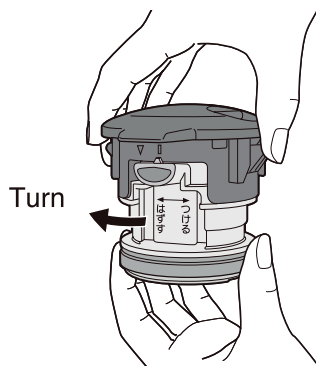

② Lift the Upper Stopper Set to remove.

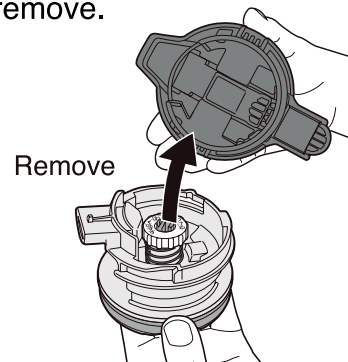

How to Disassemble the Stopper Set, continued

2 Remove the Spring Holder.

① Hold the bottom of the Stopper Valve Set with your finger so it does not move.

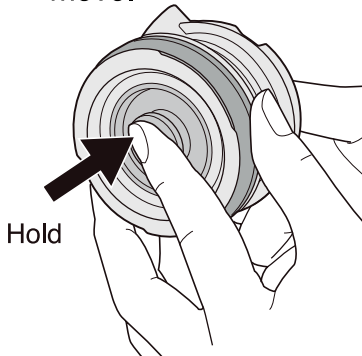

② While holding the bottom of the Stopper Valve Set, firmly hold and push down on the Spring Holder, turn it 90 degrees in the direction indicated by the arrow, and remove the Spring Holder and Spring.

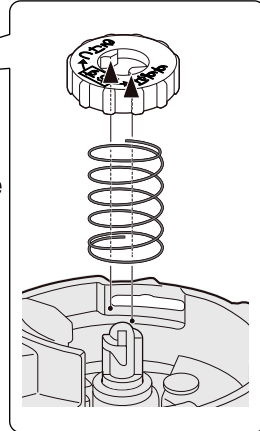
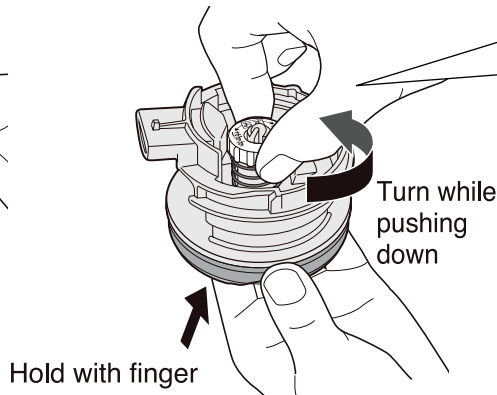

● The Spring may fly out if you do not hold the Spring Holder firmly.

3 Remove the Stopper Valve Set.

Pull out the Stopper Valve Set from the bottom.

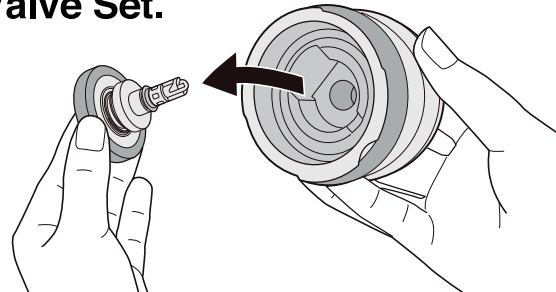

4 Remove the Lower Stopper Gasket and Stopper Valve Packing.

① Pinch the Stopper Packing and push it so that it is loosened at the notch.

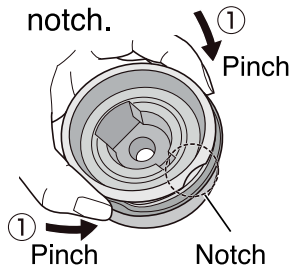

② Pinch the Stopper Packing at the notch and remove the Stopper Packing.

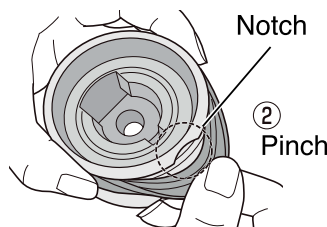

* Do not remove the smaller packing on top of the Stopper Valve Set.

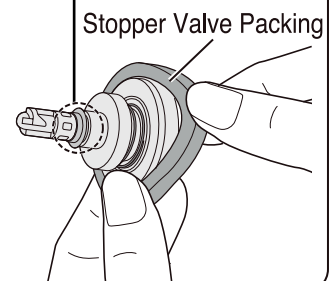

How to Assemble the Stopper Set

1 Attach the packings.

Stopper Packing

Note the top and bottom of the Packing.

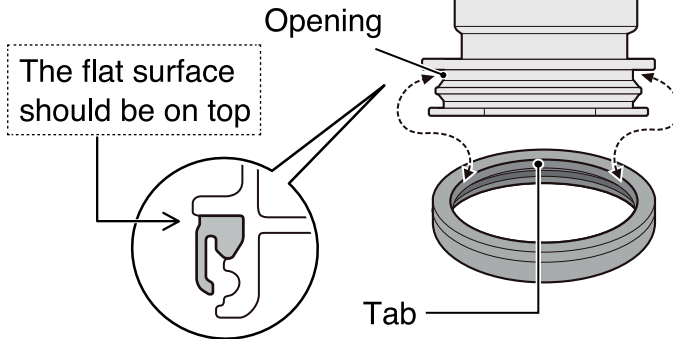

Valve Packing

There is no top or bottom.

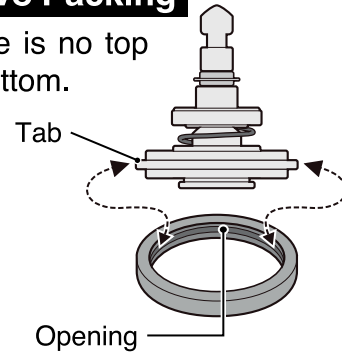

- After attaching the packings, press them with your fingers from the outside toward the center.
(The Carafe may not function properly or beverages may leak if the parts are not attached properly.)

2 Attach the Stopper Valve Set.

- ① Insert the Stopper Valve Set into the Lower Stopper Set, place the spring, then the Spring Holder.

* Make sure to set the Spring Holder so that the writing is on top.

- ② While holding the bottom of the Stopper Valve Set, push in the Spring Holder and turn it 90 degrees in the direction indicated by the arrow, and attach it to the Stopper Valve Set.

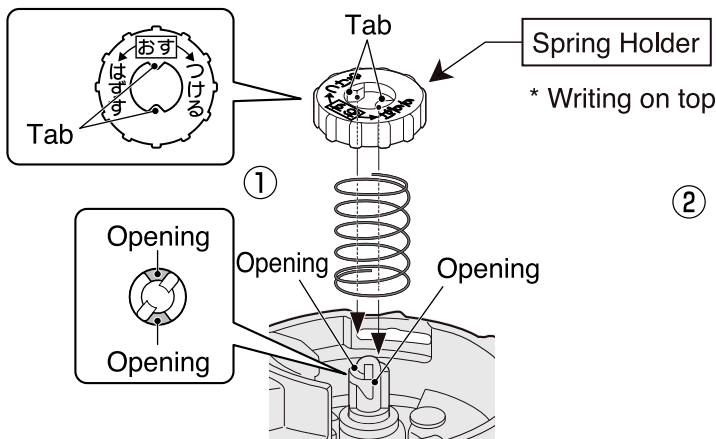

Align the Tabs on the Spring Holder with the Opening on the Stopper Valve.

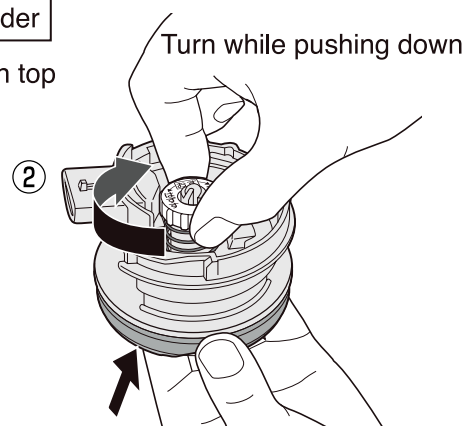

Hold with finger

How to Assemble the Stopper Set, continued

3 Attach the Upper Stopper Set.

- ① Align the ▼ symbol on the Upper Stopper Set with the Tab on the Lower Stopper Set, and attach.
- ② Turn the Lower Stopper Set in the direction indicated by the arrow and align the I symbol with the Tab on the Lower Stopper Set to attach.

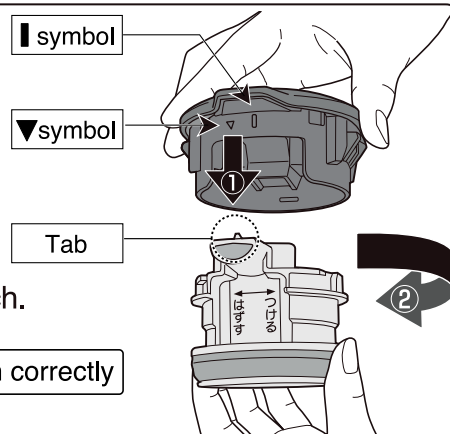
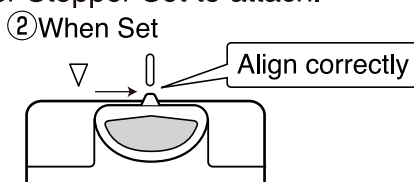
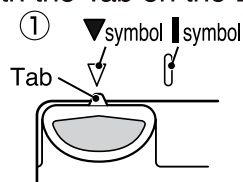

How to Take Care of Your Carafe

Clean the product after each use to prevent odors, dirt and mold, and to keep the product sanitary.

- Always disassemble the Carafe before cleaning. (See pg. 5-6)

Exterior Stopper Set

- ① Wash with warm water and mild dishwashing liquid using a soft sponge.
 - ② Rinse, shake a few times, and wipe dry.
- Disassemble the Stopper Set and remove the Stopper Packing and Valve Packing before cleaning and drying. See pg. 5-6 "How to Disassemble the Stopper Set" for details.
 - Please use a small brush (sold in stores) if necessary.

Interior

- ① Wash with warm water and mild dishwashing liquid using a soft sponge with a handle.
- ② Then rinse and wipe moisture out to dry.

When Cleaning Your Product:

- To protect the paint, print or stickers on the outside of the Main Body:
 - Do not use a dishwasher or dish-dryer. Do not boil to sanitize.
 - Do not use bleach on the outside of the Main Body.
 - Do not clean with thinner, benzene, abrasive cleaners or other harsh cleaners.
 - Do not use chlorine type bleach.
 - The product is washable, but do not soak it in water for an extended period of time.
 - Wipe moisture off thoroughly to prevent water stains or rusting.
- When storing the Carafe, place it inside a plastic bag before placing it in the box. Keep the box away from places with high temperature and humidity. Make sure that the product is clean and dried thoroughly before storing.

How to Take Care of Your Carafe, continued

To Remove Rust Spots and Water Stains:

You may find rust spots or water stains caused by impurities in the water. To remove these stains, fill the Main Body with hot water with 10% vinegar and let it stand for 30 minutes to an hour without attaching the Stopper Set then wash the interior thoroughly.

To Remove Coffee and Tea Stains:

To remove coffee and tea stains from the interior and the Stopper Set, we recommend using Zojirushi's cleaning detergent SB-ZA01/SB-ZA01E. Always remove the Stopper Set when using SB-ZA01/SB-ZA01E.

● Contact Zojirushi Customer Service or your local dealer for further information.

Replacement Parts (Stopper Set, Stopper Valve Set, Stopper Packing)

We take care in only using materials that are safe and hygienic for food contact. However, if plastic parts become damaged or its surface becomes rough, please replace them for optimum performance. The Stopper Set, Stopper Valve Set, Stopper Packing may need to be replaced due to time and wear. Please check them about once a year. When replacing parts, please record the model number and part name beforehand. Then contact either the store where you purchased the product or Zojirushi Customer Service. Replacement parts may be available for an additional charge.

SPECIFICATIONS:

PRODUCT: STAINLESS STEEL VACUUM CARAFE

Model No.	Capacity	Weight	Heat Retention	Cold Retention
SH-HB10	1.0 liter (33.8 oz.)	0.7 kg (24.7 oz.)	49°C (120°F) @ 24 hrs. / 67°C (152°F) @ 10 hrs.	9°C (49°F) @ 10 hrs.
SH-HB15	1.5 liters (50.7 oz.)	0.8 kg (28.2 oz.)	58°C (136°F) @ 24 hrs. / 73°C (163°F) @ 10 hrs.	8°C (47°F) @ 10 hrs.
SH-HB19	1.9 liters (64.2 oz.)	0.9 kg (31.7 oz.)	62°C (143°F) @ 24 hrs. / 76°C (168°F) @ 10 hrs.	8°C (47°F) @ 10 hrs.

Heat/Cold Retention Testing Conditions:

At a room temperature of 20°C±2°C (68°F±4°F), the Main Body is filled to the neck with hot or cold water and left standing in an upright position. For heat retention, once the hot water reaches 95°C±1°C (203°F±2°F), the temperature is measured after 24 hours and 10 hours. For cold retention, once the cold water reaches 4°C±1°C (39°F±2°F), the temperature is measured after 10 hours.

Materials: Inner Liner
Exterior

Stainless Steel
Stainless Steel
(Acrylic Resin Painted)*

Mouth
Lower Stopper
Packing

Polypropylene
Polypropylene
Silicon

* The stainless (XA) color is not coated with Acrylic Resin.

Manufacturer: Zojirushi Corporation

Address: 1-20-5 Tenma, Kita-ku, Osaka 530-8511, Japan