

# FRAMED MIRROR

Colors/Finishes: Matte Black(MB),White(WT), Brushed Gold(BG)

Nominal Dimension:24W\*1.5D\*24H inches    28W\*1.5D\*28H inches  
32W\*1.5D\*32H inches    36W\*1.5D\*36H inches

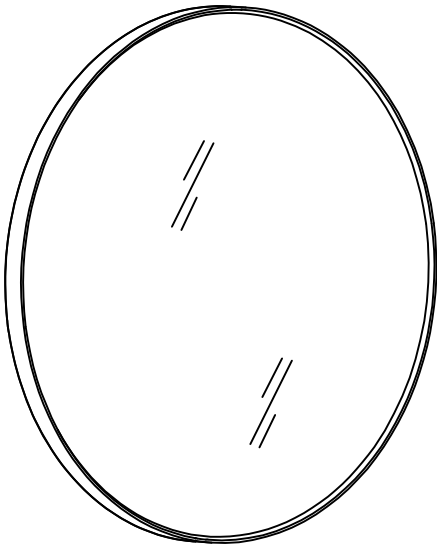

## FEATURES:

- Durable aluminum frame
- Modern sloping edge design
- Eco-friendly coating mirror glass
- Long lasting color finish

## PRODUCT DIAGRAMS:

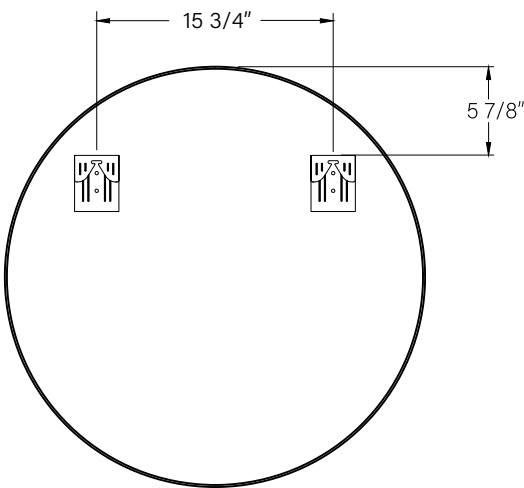
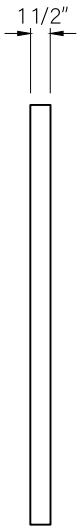
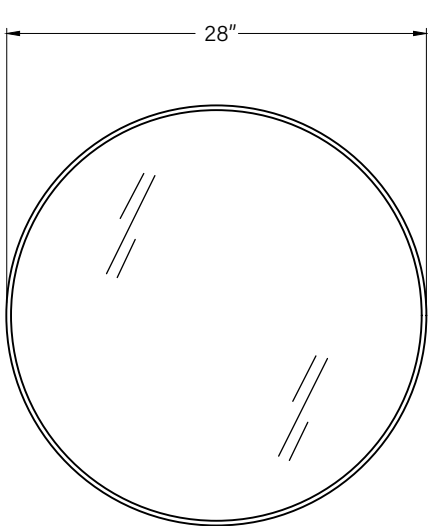
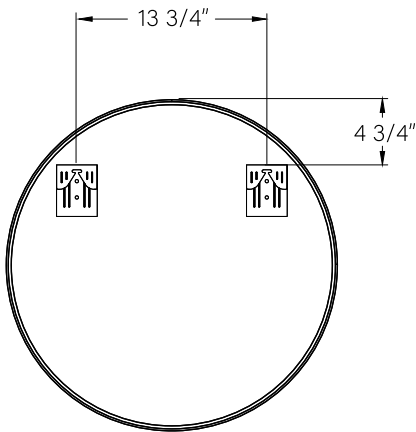
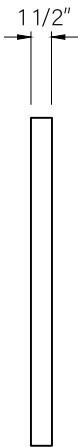
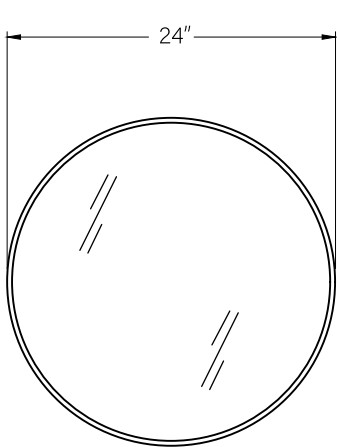

All dimensions and specifications are nominal and may vary.Use actual products for accuracy in critical situations.

# FRAMED MIRROR

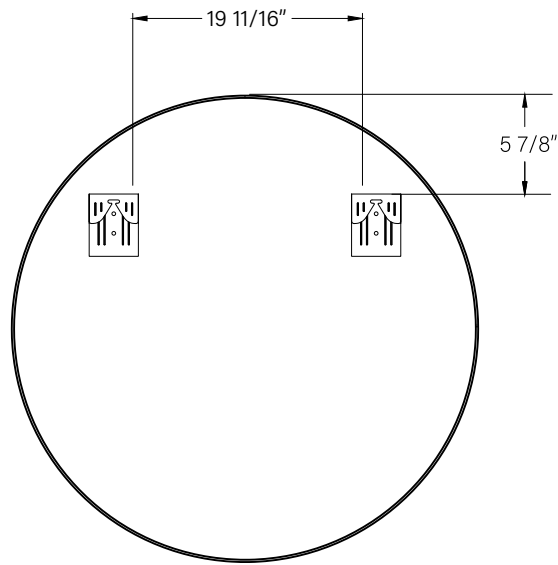
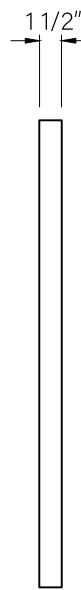
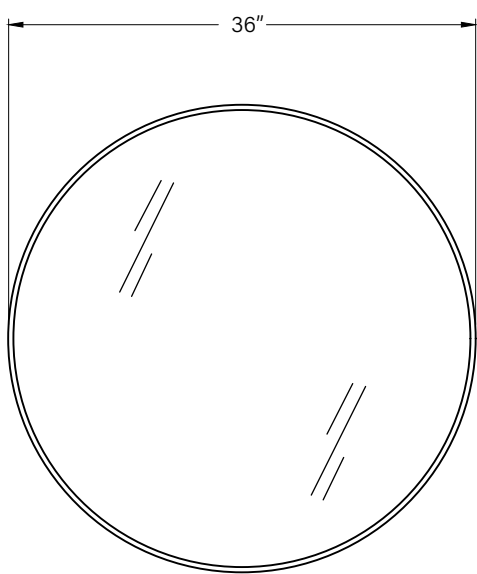
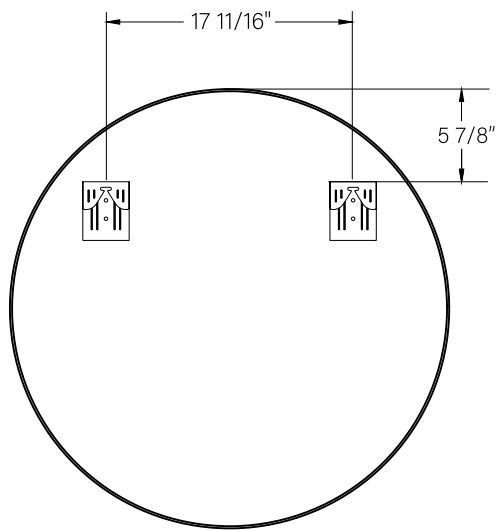
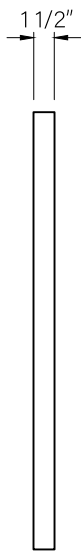
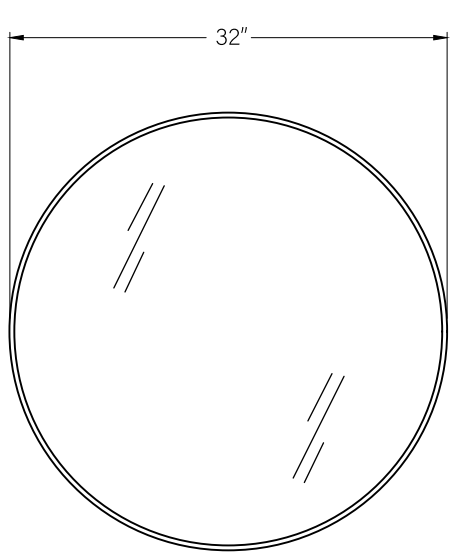

# Mirror Installation

## SUGGESTED TOOLS AND MATERIALS

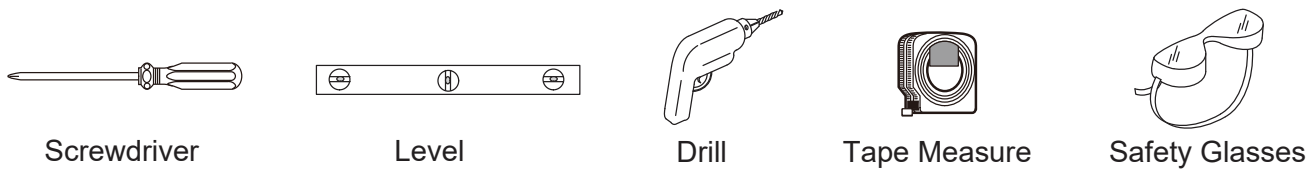

## PARTS

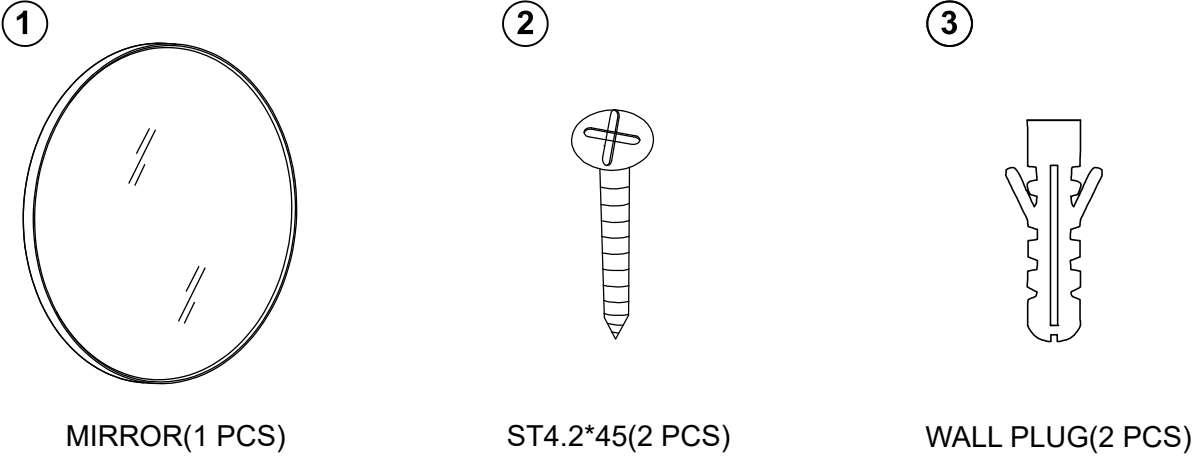

## INSTALLATION INSTRUCTIONS

### STEP 1

Select the desired position of the mirror. Level and mark the mounting holes on the wall.

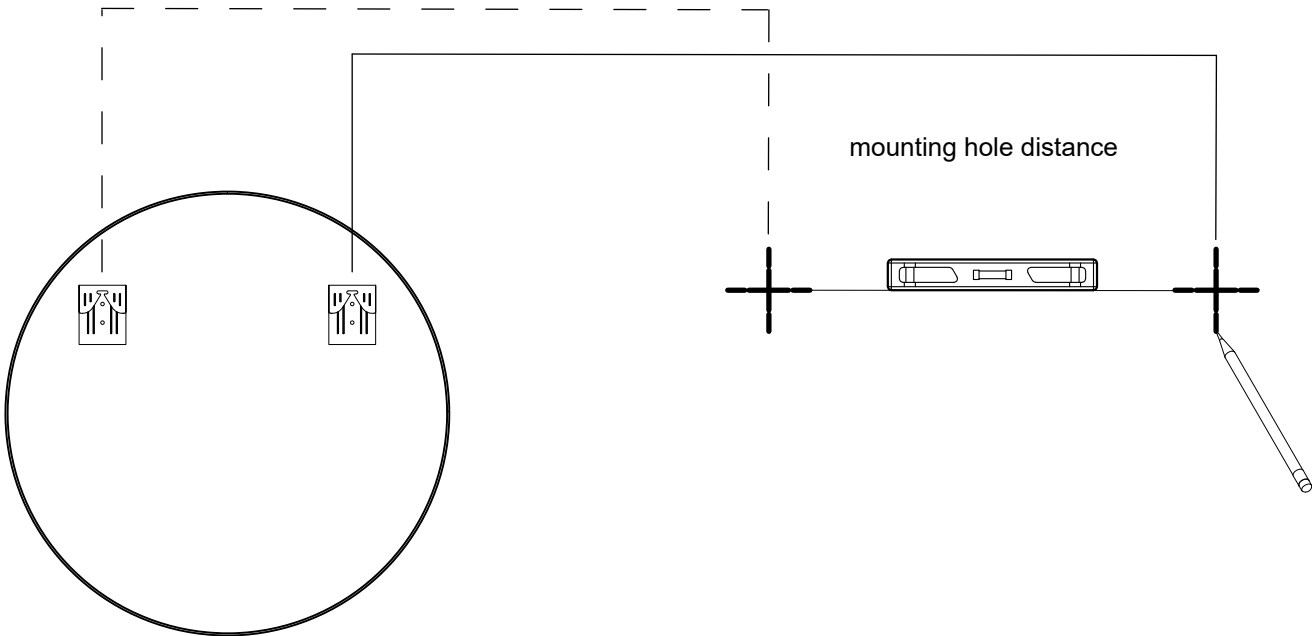

# Mirror Installation

## STEP 2

2.1 Drill holes about 2" deep at each of the marked locations.

2.2 Insert wall plugs ③.

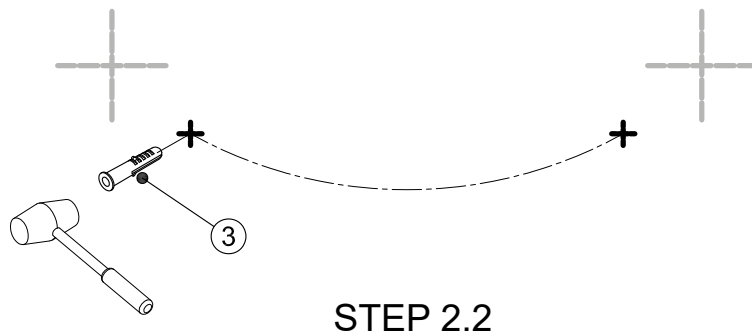
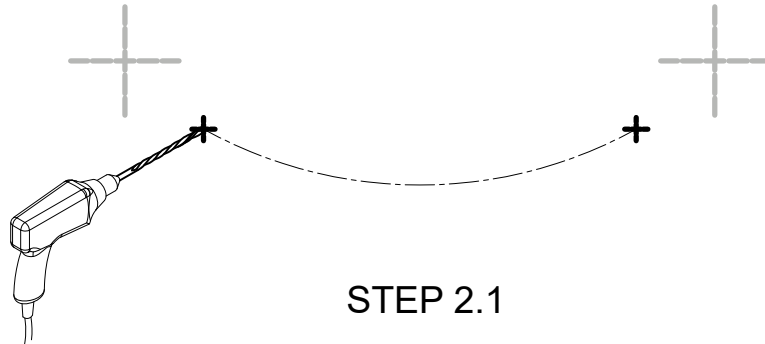

## STEP 3

Install Screw ②. Leave a gap of 1/4" between the head of the screw and the wall.

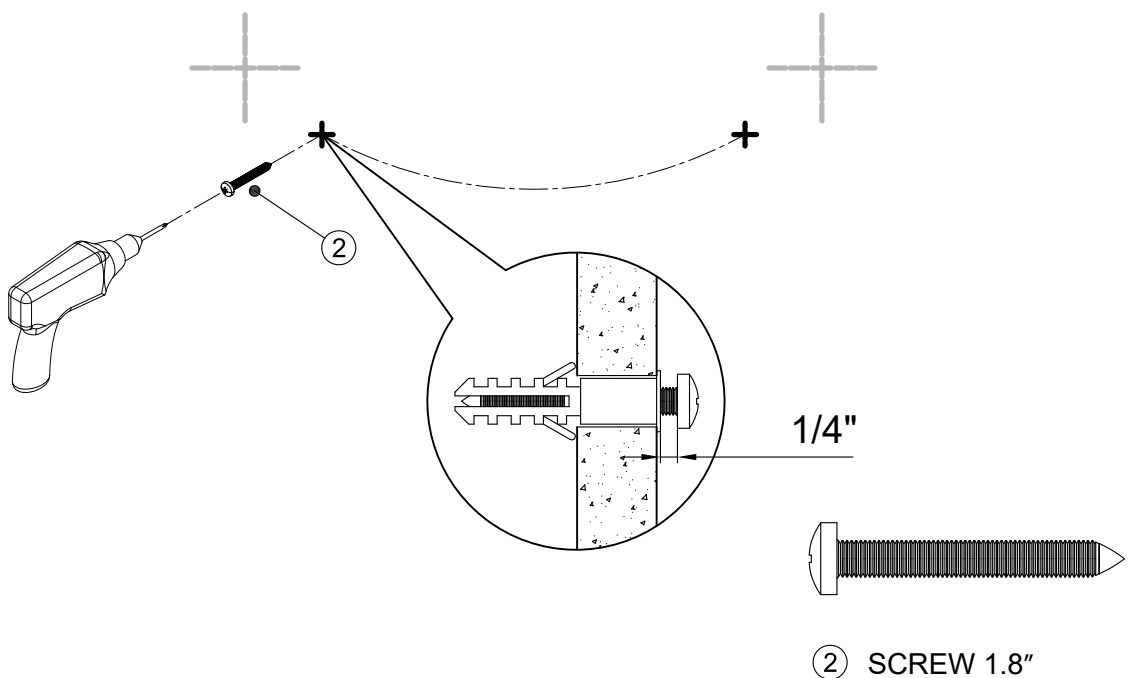

# Mirror Installation

---

## STEP 4

Place the mirror against the wall and slide it down, as shown in Figure 2.

