



# Mont Alpi

Peak Performance

## Natural Gas Conversion Process



**The following guide will help you convert your new Mont Alpi Grill from propane to natural gas.**

**If you have any questions throughout the process, please do not hesitate to call us to help guide you through.**

**(949) 207-9595**

**Monday-Friday 9-5pm PST**



Each burner on your grill has a propane and natural gas orifice out of the packaging. The idea behind the conversion is to remove the propane orifice from each burner. There is no need to add a natural gas orifice, as the natural gas orifice is already installed and situated right behind the propane orifice.

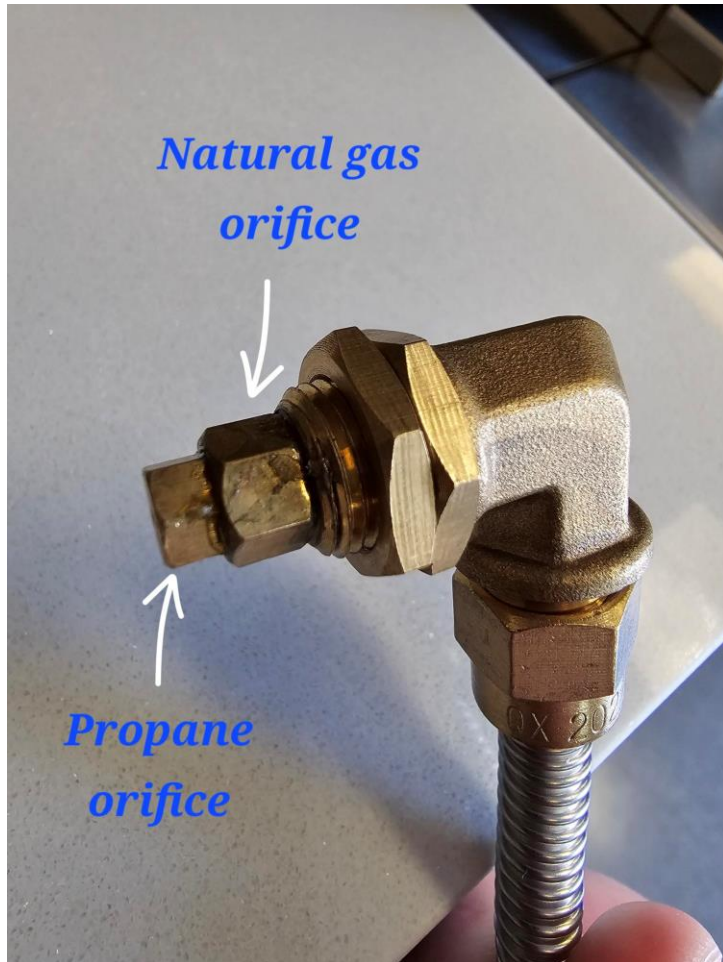

**Read Carefully**

**WARNING**

**Convert from LPG to NG**

1. Conversions are to be done by and authorized person only.
2. Make sure all control knob and cylinder valves are in the OFF position.
3. The appliance must be isolated from the gas supply piping system by closing its individual manual shut-off valve during any pressure testing of the gas supply piping system at test pressures equal to or less than 1/2 psi (3.4kPa).

This grill is certified with either Liquid Propane Gas (LPG) or Natural Gas (NG) and comes complete with the necessary parts to convert the grill for use with a NG hose and regulator. The process of converting is relatively simple.

Both the LP Orifice and NG Orifice have been combined on the valves by the manufacturer.

The conversion is to take away the LP Orifice and leave the NG Orifice

NG Orifice

LPG Orifice

**Orifice Chart**

The different burner valves in this grill have different orifice sizes. Different holes in the orifice are drilled to different sizes so as to allow the proper amount of the gas to flow through them. Please note the chart below to give an easy reference for various opening sizes for the different valves in the grill.

Burner	LPG		NG	
	Injector (mm)	BTU/Each	Injector (mm)	BTU/Each
Main Burner	1.0	12,000	1.50	10,000
Infrared Rear Burner	1.0	12,000	1.67	12,000
Infrared Side Burner	1.0	12,000	1.72	14,000

19

# Tools Needed:



- 6mm Nut Driver – used for removing propane orifices (included)
- Phillips Screwdriver – to remove burners and panels (not included)
- Adjustable Wrench – used to remove propane hose/regulator (not included)

# Step 1: Remove packaging



**Step 2: Remove burner screws – Each burner is held onto the firebox frame by two screws. Remove both screws from each burner to free burner from firebox frame.**

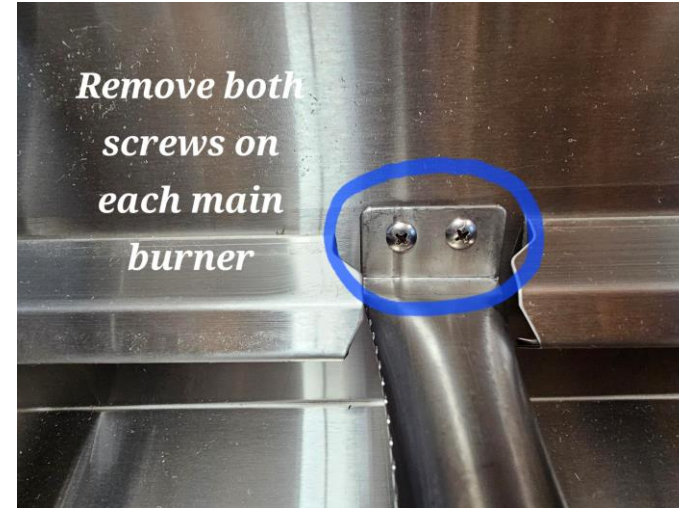

**Step 3: Remove propane orifices from main burners – With the provided 6mm nut driver, remove each propane orifice from each burner. Note \* some models have 4 main burners, while others have 6. Make sure to remove the orifices from each burner.**

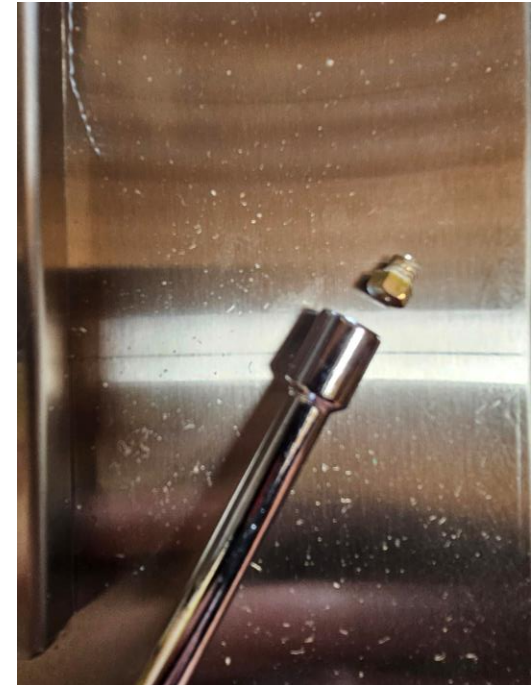
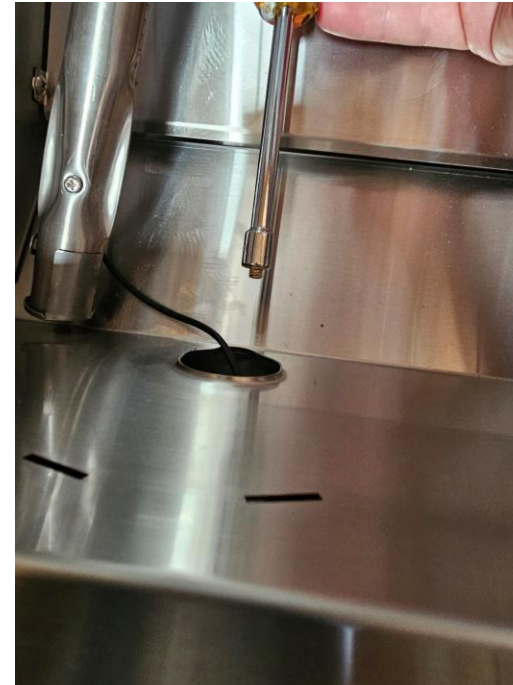
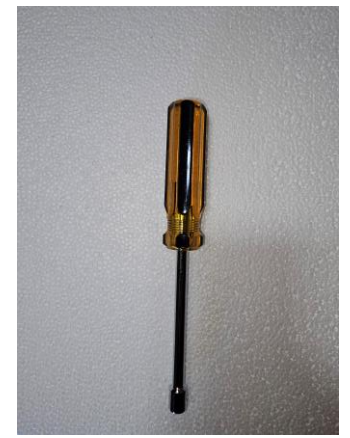

**Step 4: Re-insert burners and tighten screws – Make sure the burner is installed correctly back into place. The natural gas needs to be shooting into the tubular burner.**



**Step 5: Convert side burner – The side burner gas line protrudes out of the left side wall of the grill module. Remove the packaging to expose the side burner and main gas line, and remove the propane orifice from the brass elbow. Note \* Be careful to not remove the natural gas orifice as well. You can back up the NG orifice with the 8mm wrench if available.**

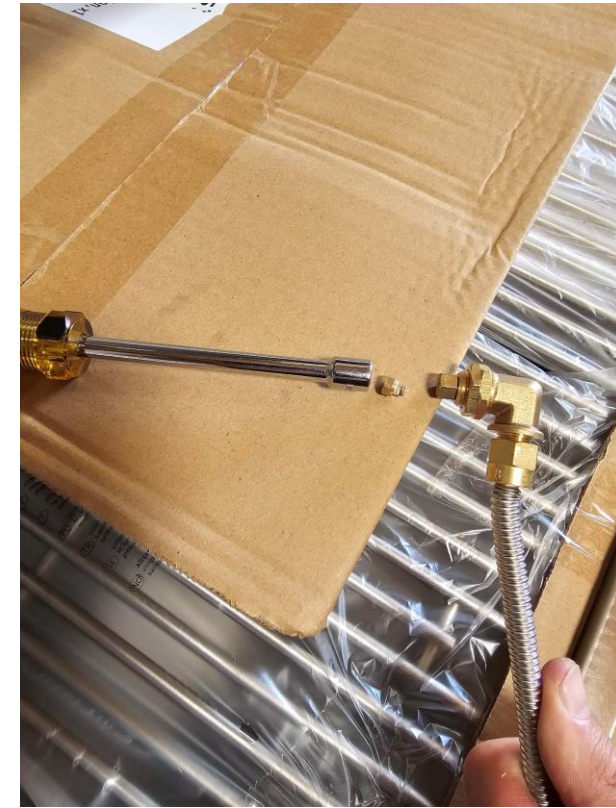
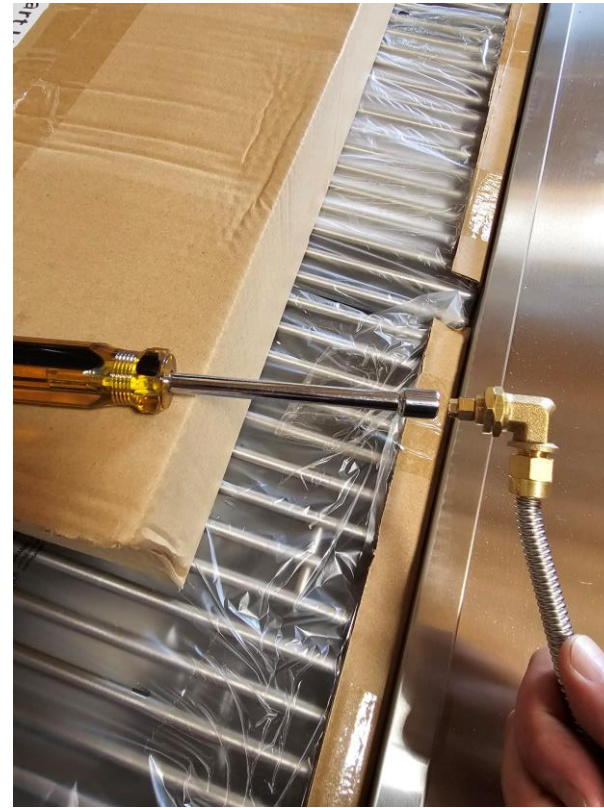

**Step 6: Remove propane hose and regulator – Since you are using natural gas, there is no need for the black propane hose and regulator. Using your adjustable wrenches, remove the propane hose AND the brass hex nipple that connects to the main gas line. Note \* this is the main gas line that feeds the main burners, side burner, and back burner.**

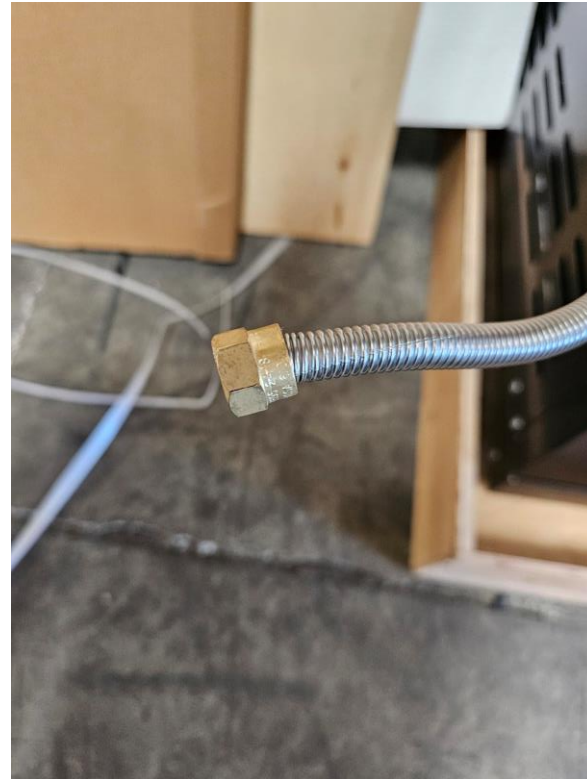

**Step 7: Remove rear burner panel – The rear panel is removed from the backside of the unit. It is held onto the frame via four screws; two on each side. Remove these screws to gain access to the back burner.**

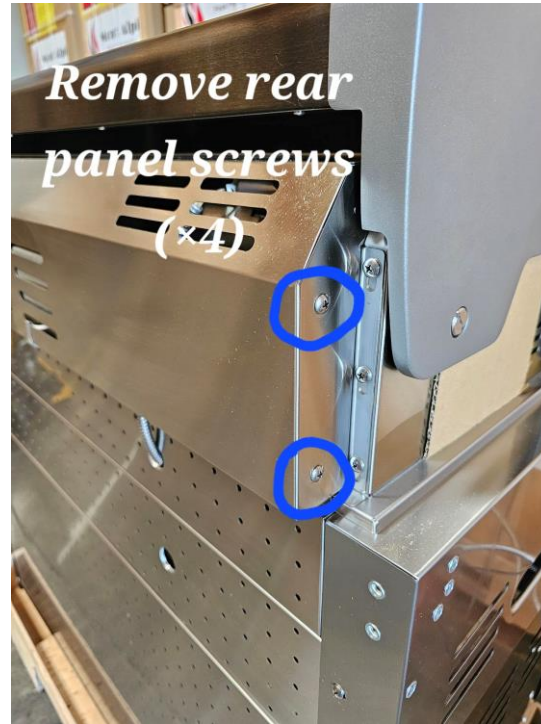

**Step 8: Remove propane orifice from back burner – You'll find the back burner orifices on the left side (pictured below). If you have a 6mm wrench, simply remove the propane orifice like as before.**

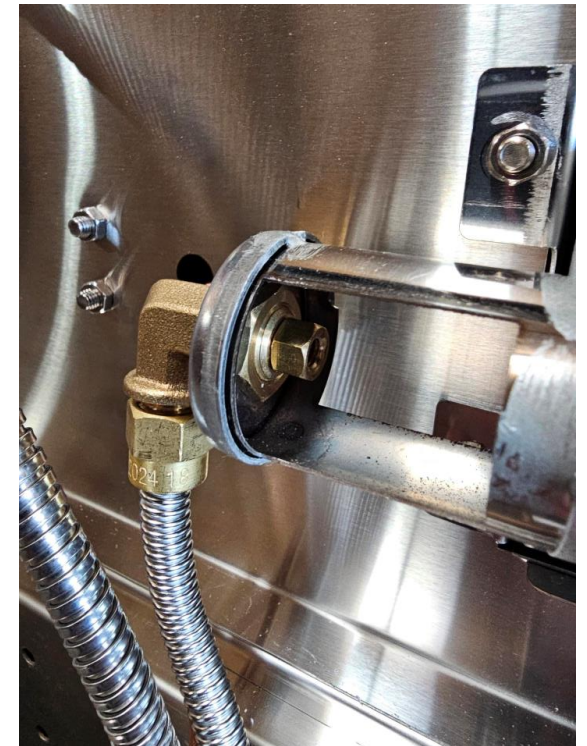

**Step 8 (cont): If no 6mm wrench, use adjustable wrench to loosen brass nut (nearest the elbow) to give wiggle room. Then remove the brass nut furthest from the elbow and put it aside.**

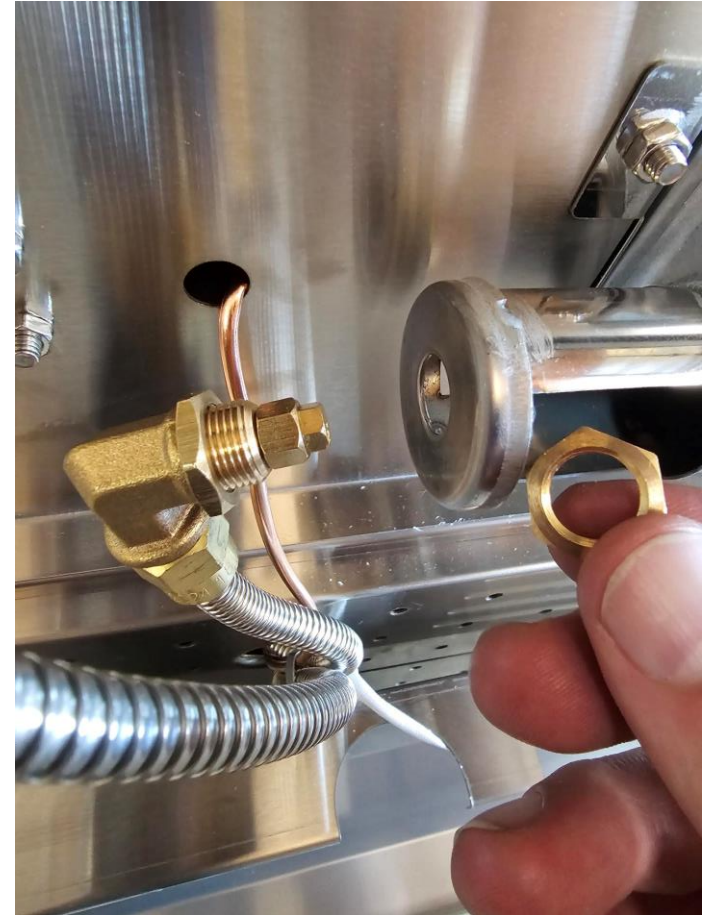
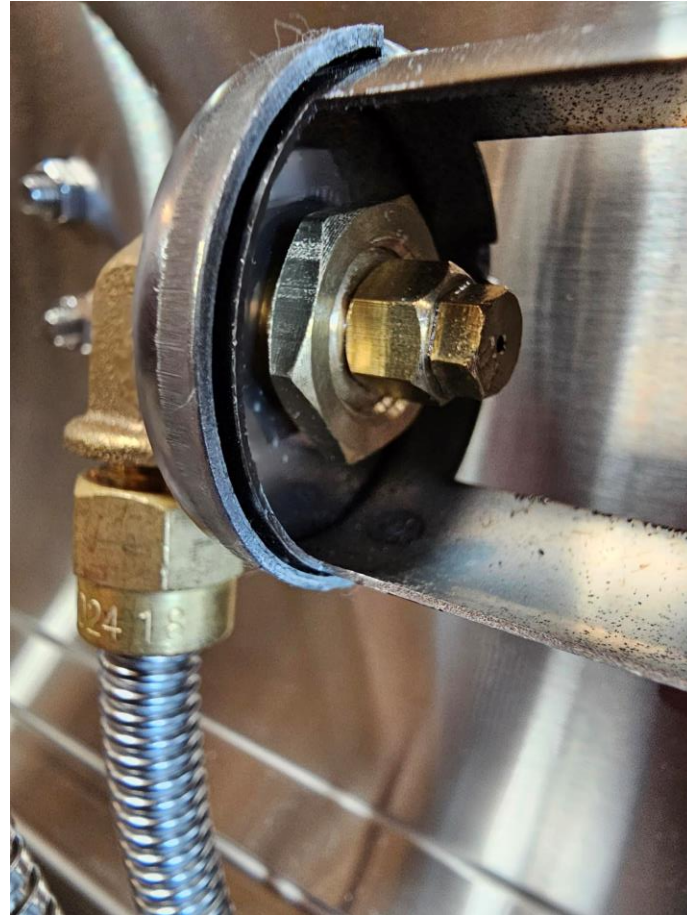

**Step 8 (cont): Remove propane orifice, and secure elbow back onto back burner cylindrical housing with brass nuts.**

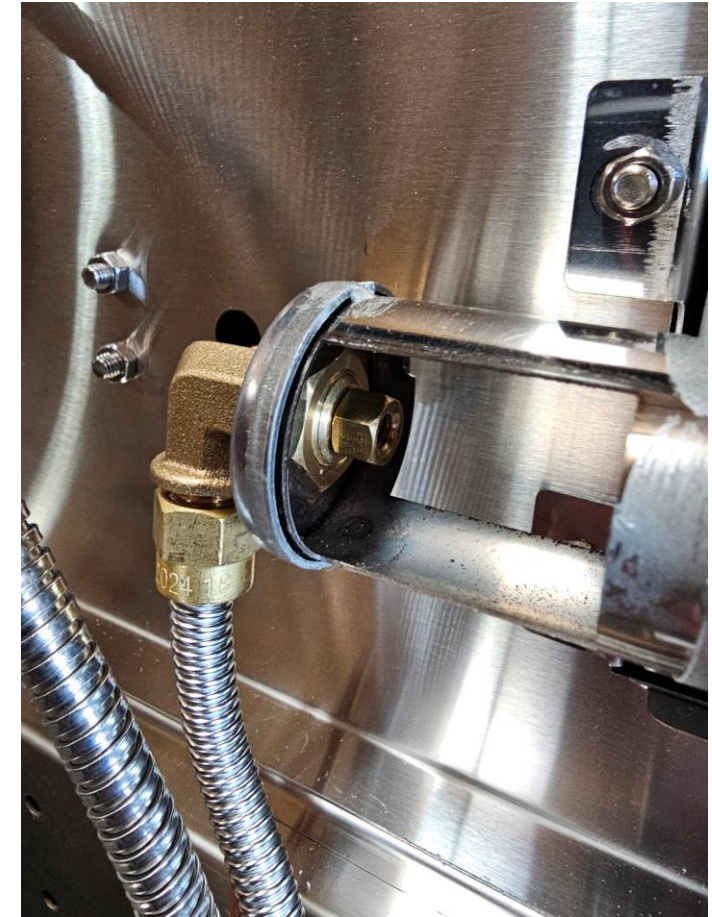

**Step 9: Install back burner panel – Use the four screws from step 7 to re-secure back panel onto grill. There are cut-outs to accommodate back burner gas lines, lighting, and ignition wiring. Make sure these wires and gas lines are not pinched by the back panel when re-installing.**

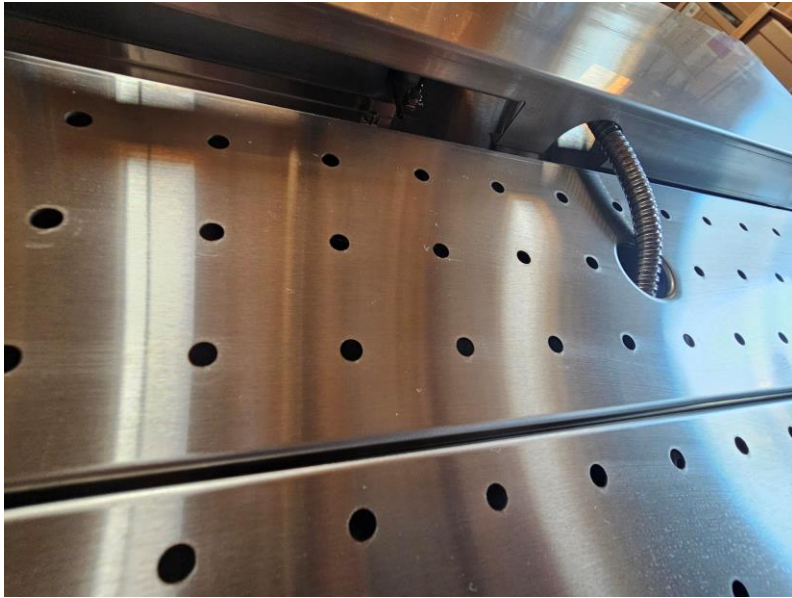

**Job complete! Make sure to also look through your owner's manual on page 19-23 for additional information.**



## Read Carefully

### WARNING

#### Convert from LPG to NG

1. Conversions are to be done by and authorized person only.
2. Make sure all control knob and cylinder valves are in the OFF position.
3. The appliance must be isolated from the gas supply piping system by closing its individual manual shut-off valve during any pressure testing of the gas supply piping system at test pressures equal to or less than 1/2 psi (3.4kPa).

This grill is certified with either Liquid Propane Gas (LPG) or Natural Gas (NG) and comes complete with the necessary parts to convert the grill for use with a NG hose and regulator. The process of converting is relatively simple.

Both the LP Orifice and NG Orifice have been combined on the valves by the manufacturer.



The conversion is to take away the LP Orifice and leave the NG Orifice.

#### Orifice Chart

The different burner valves in this grill have different orifice sizes. Different holes in the orifice are drilled to different sizes so as to allow the proper amount of the gas to flow through them. Please note the chart below to give an easy reference for various opening sizes for the different valves in the grill.

Burner	LPG		NG	
	Injector (mm)	BTU/Each	Injector (mm)	BTU/Each
Main Burner	1.0	12,000	1.50	10,000
Infrared Rear Burner	1.0	12,000	1.67	12,000
Infrared Side Burner	1.0	12,000	1.72	14,000

#### Tools Required for Converting from LPG to NG

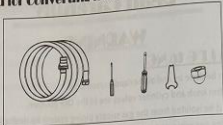

#### Main Burner Conversion

1. Unscrew the main burner securing screws.

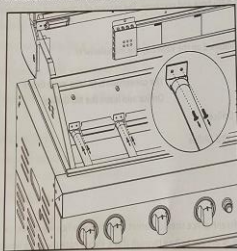

2. Remove the burner.



#### Main Burner Conversion

1. Unscrew the valve.
2. Using the trim driver supplied, unscrew the jet/LPG jet while repeating the inner (NG) jet.
3. Assemble 2 locking pins.

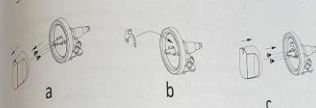

4. Reassemble the burner.

Connect the QDD to the Natural Gas Supply, then connect the grey hose to the QDD.

#### Connect the Grey Hose to the Grill

1. Unscrew the bracket fixing the gas supply piping.
2. Unscrew the LPG gas hose and regulator.
3. Connect the NG hose.

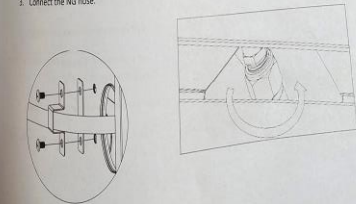

## Read Carefully

### WARNING

Please make sure you locate the burner properly with respect to the orifice as shown, otherwise it may result in gas leakage and fire accident.

#### Rear Burner Conversion

1. Remove the back burner cover.

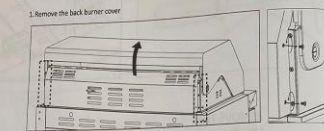

2. Remove the LPG jet from the elbow shaped brass injector assembly.

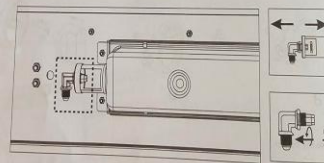

#### LPG INJECTOR

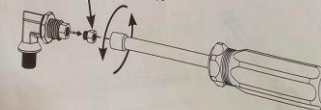

4. Assemble 2 locking pins.

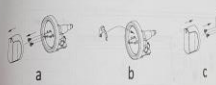

5. Reassemble the burner.

