

## Step 1: How to carry the massage chair

- ① Lifting out of the body: The body, pillow cushion, seat cushion, back cushion and power cord are removed from the main box and it is recommended that they are carried by 2 people. When they are removed from the box, two people with two hands hold the left and right side of the base at the iron frame and then slowly lift it out.



Massage chair body



Pillow cushion



Seat cushion



Power cord



Back cushion

- ② The left and right armrests are lifted out of the armrest box. When lifting out, hold the left and right side of the armrests and lift them out slowly before placing them flat on the table or floor. (Take care to prevent scratching of the armrests)



Airbag side facing up



Left armrest



Right armrest

## Step 2: Opening the body

- Open the back of the body backwards. When you have turned it over approximately 120° and you hear a click, the restriction buckle will be triggered and the seat back will be successfully secured. (If you do not hear this, please check the condition of the stopper at the back seat or contact customer service.)



## Step 3: Installation of the left and right handrails

- ① Take out the 2 screws and spacers from the accessory box and put them aside.
- ② Connect the air hose between the body and the armrest in turn and check that they are tightly connected.
- ③ Hold the armrest upright, with the airbag side facing upwards, and slowly lift the armrest from the front side to the side of the fuselage, with the armrest slightly higher than the fuselage and the inner fixing clips sliding downwards diagonally against the fuselage to lock the fixing shaft.
- ④ Place the armrests into the seat frame, check that the armrests are aligned with the body frame and adjust them appropriately to align the holes. Use 2 screws and spacers, screw in 5 turns each for initial fixing and tighten with a hexagonal spanner.
- ⑤ Repeat ① - ④ to install the other side armrest.

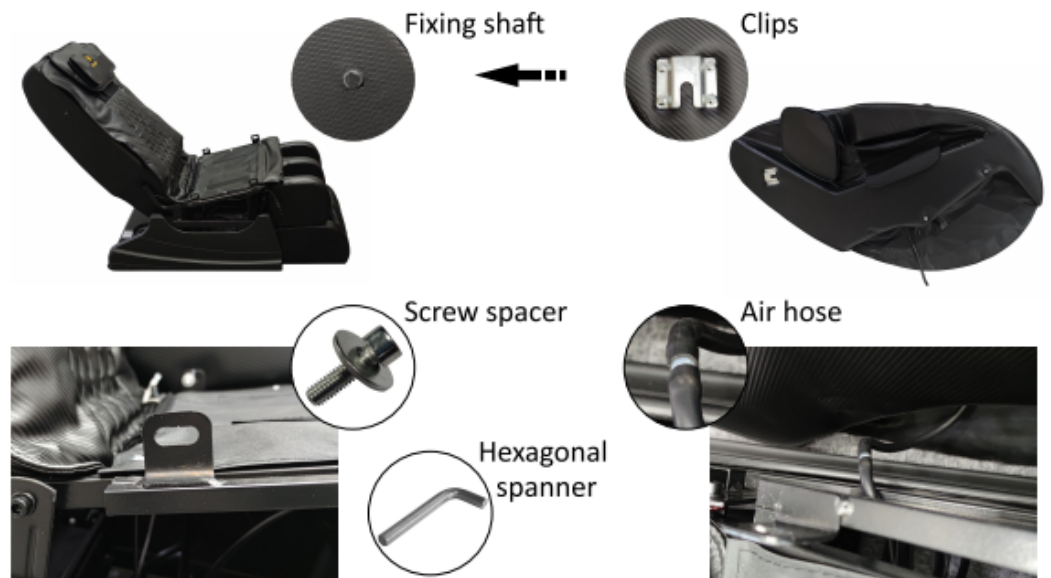

Screw holes & Seat frame