

① light fixture 1pcs

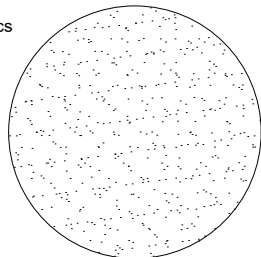

⑥ bottom plate 1pcs



③ hanging tube 1pcs

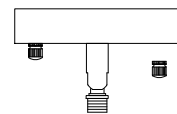

④ canopy 1pcs

⑤ cap nut 2pcs



X 1PCS



X 3PCS



X 2PCS



X 3PCS



X 3PCS

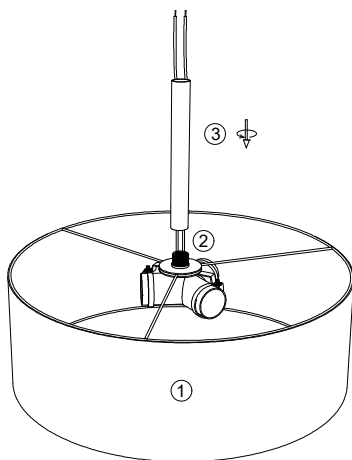

1. Let the wire go through the hanging tube ③, rotate to fix the tube ③ to the fixture.

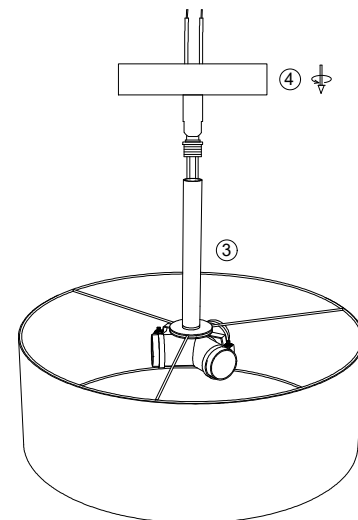

2. Let the wire go through the canopy ④, rotate to fix the canopy ④ to the fixture.

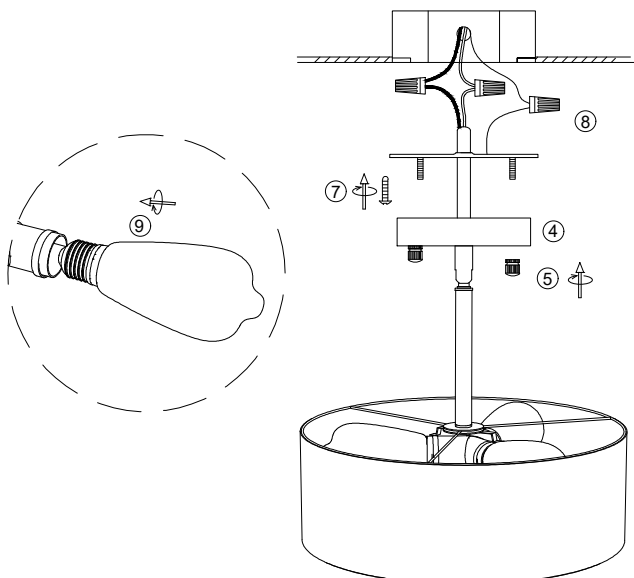

3. Install the bracket to the ceiling junction box with screw ⑦.
4. Connect the wire to your home line with cap connector ⑧.
5. Install the fixture to the bracket with cap nut ⑤.
6. Install the bulb ⑨.

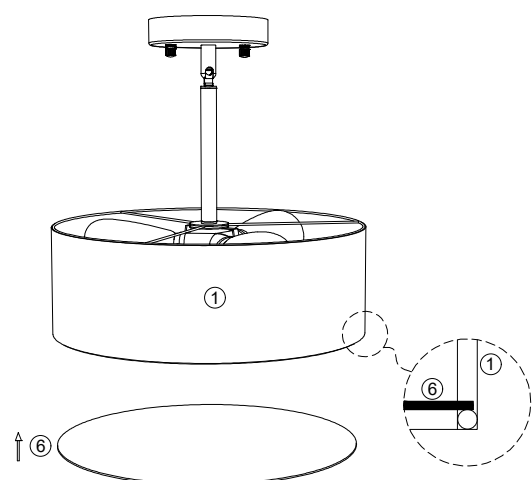

7. Close the bottom plate to the fixture, installation finished.

Please read carefully before installation!!!

Note : Please make sure that the electricity is powered off during installation !
Only a professional electrician should install this kind of product !