

Storage End Table

- a. Opening, please check the parts, any defect or missing, contact us in time.
 b. Advisable to assemble on the mat to avoid wear and tear. Avoid all sharp objects touching the product surface. Do not allow the children to play around.
 c. Do not tighten all screws entirely until assemble is completed. Power tools are available, don't over-tighten for strip threads.

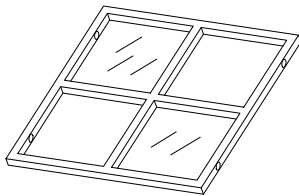

A: table bottom(outside)
1 pcs

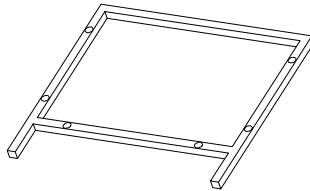

B: table part1
2 pcs

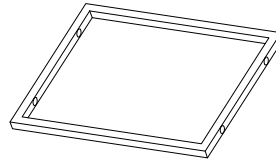

C: table part2
2 pcs

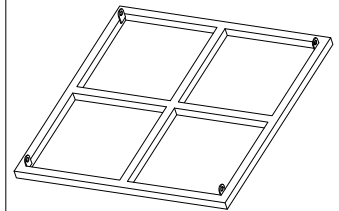

D: table top
1 pcs

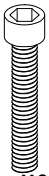

R: screw M6*30mm
4 pcs



S: shim $\varnothing 16 \times 6.4 \times 1$
12 pcs

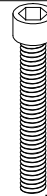

T: screw M6*35mm
8 pcs

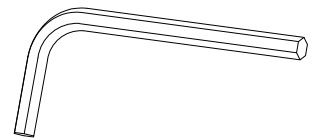

Inner hexagon spanner
1 pcs

Step 1

A x 1, B x 2



R: screw M6*30mm
4 pcs



S: shim $\varnothing 16 \times 6.4 \times 1$
4 pcs

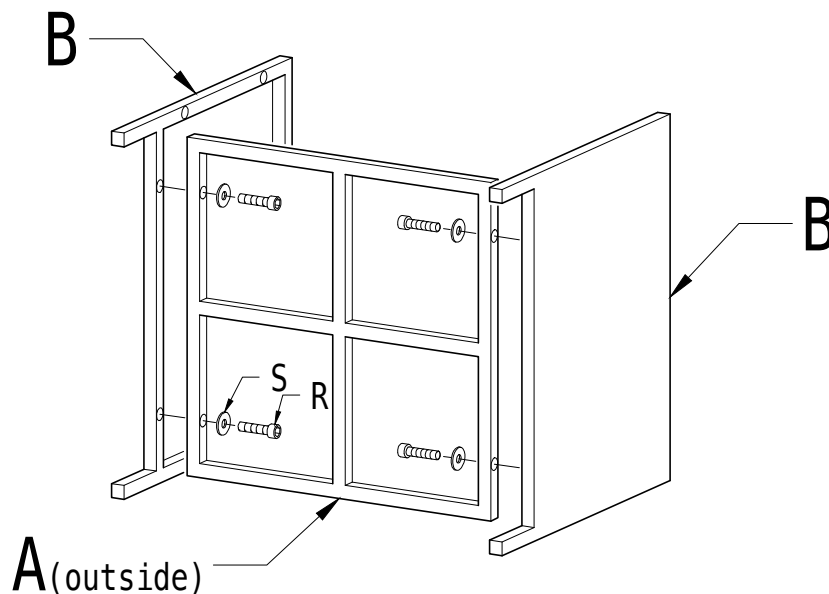

Step 2

C x 2

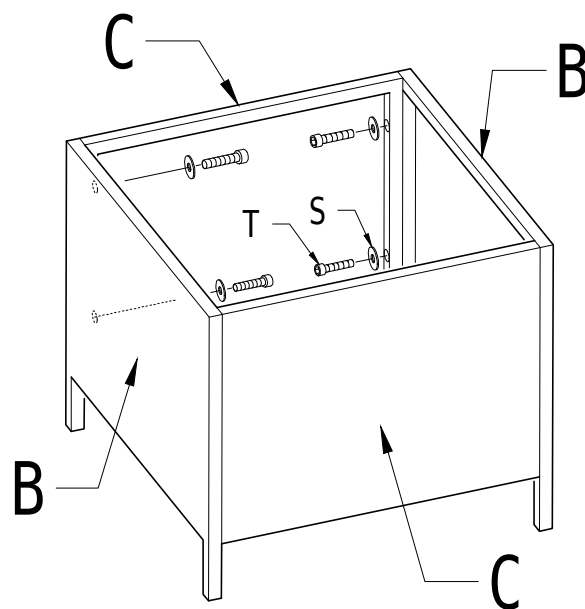
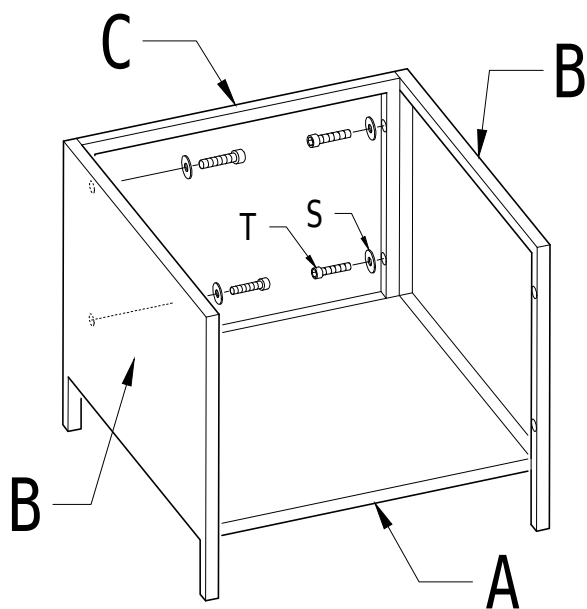
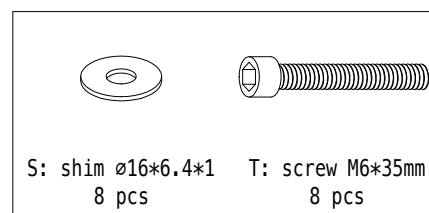

Step 3

D x 1

