

20X20FT PARTY TENT

ASSEMBLY MANUAL

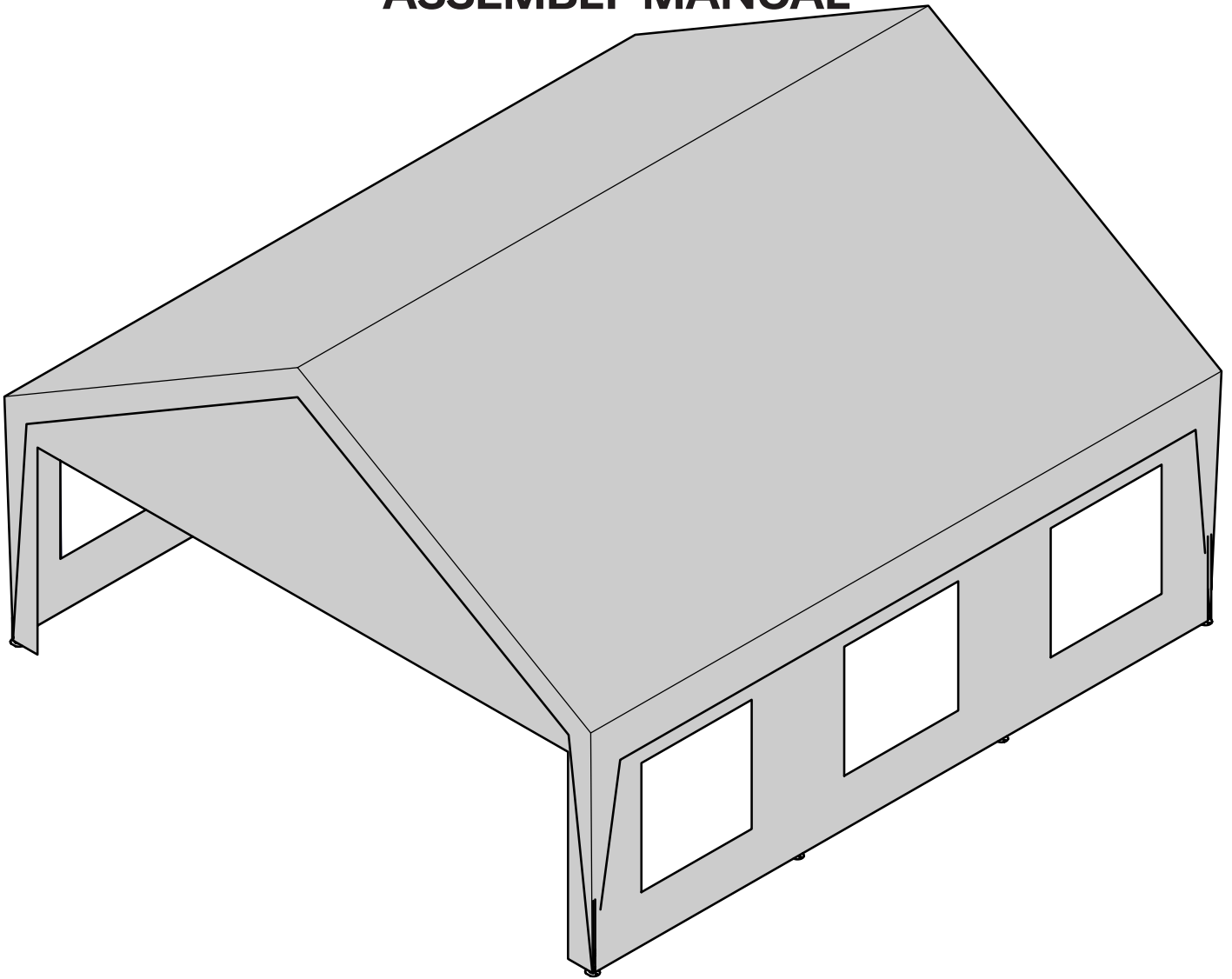

SAFETY

- Read all the safety information and instructions.
- Make sure you have all the parts before the assembling
- Do not assemble the tent on a stormy day. It will be damaged.
- Always wear work gloves, long sleeves, and safety goggles when assembling.
- Keep children and pets away from the assembly site.
- When using a ladder, make sure the ground is stable enough to hold the ladder.
- Remove snow from the roof after each snowfall.

TOOLS

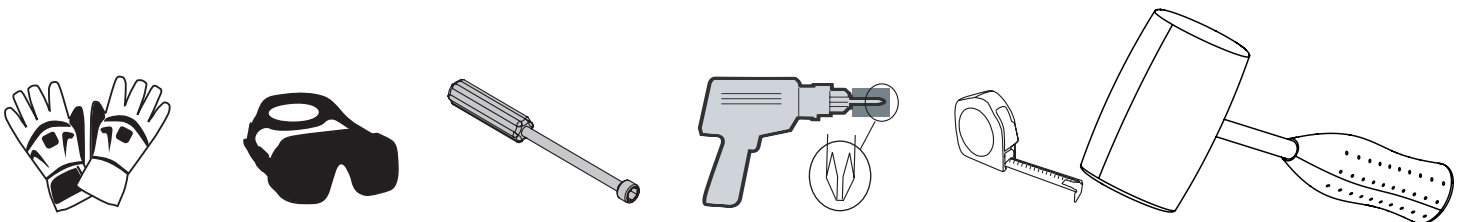

PART LIST

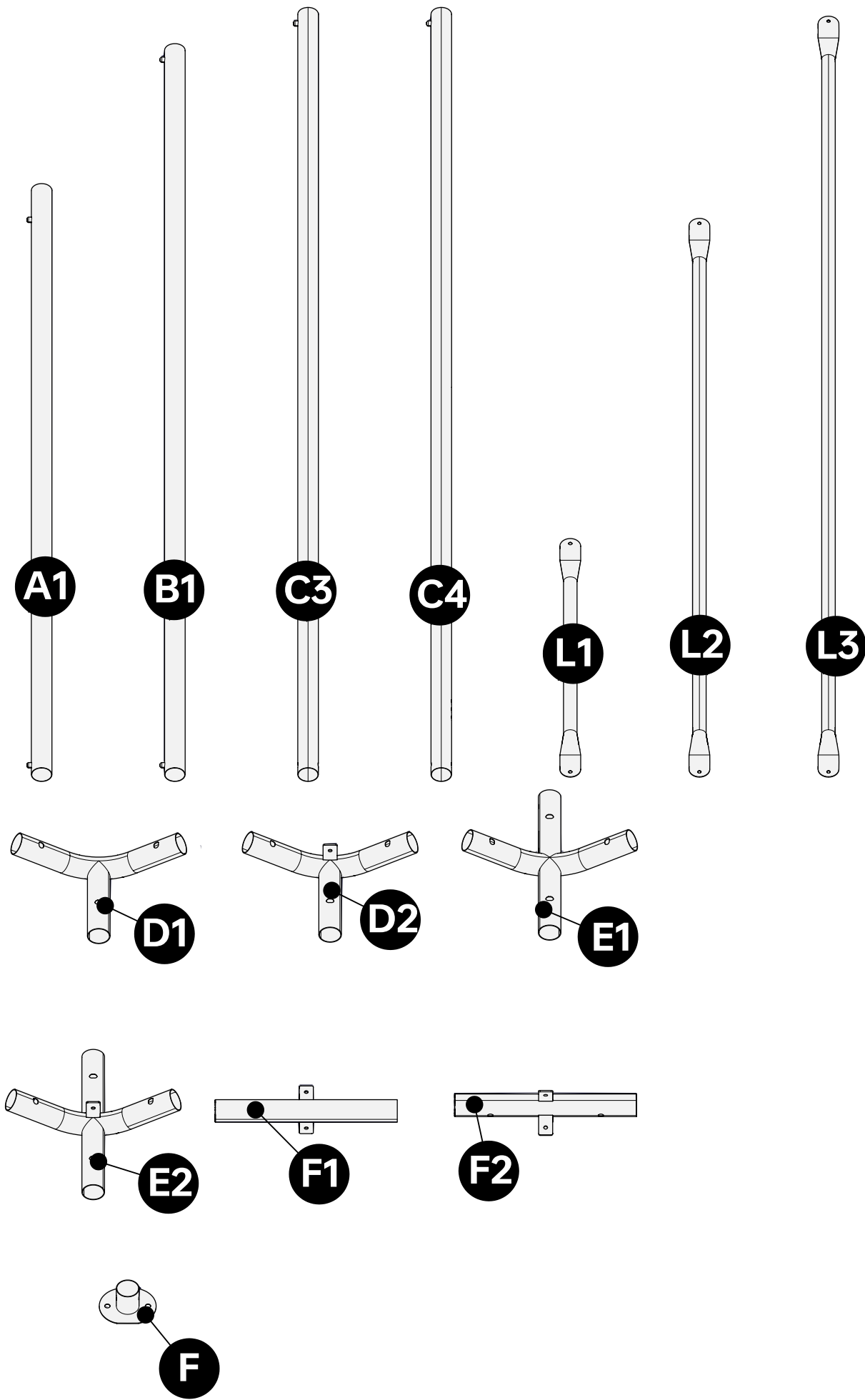

Part	Qty
A1	16
B1	9
C3	4
C4	4
L1	8
L2	8
L3	6
D1	4
D2	2
E1	4
E2	2
F1	4
F2	4
F	8

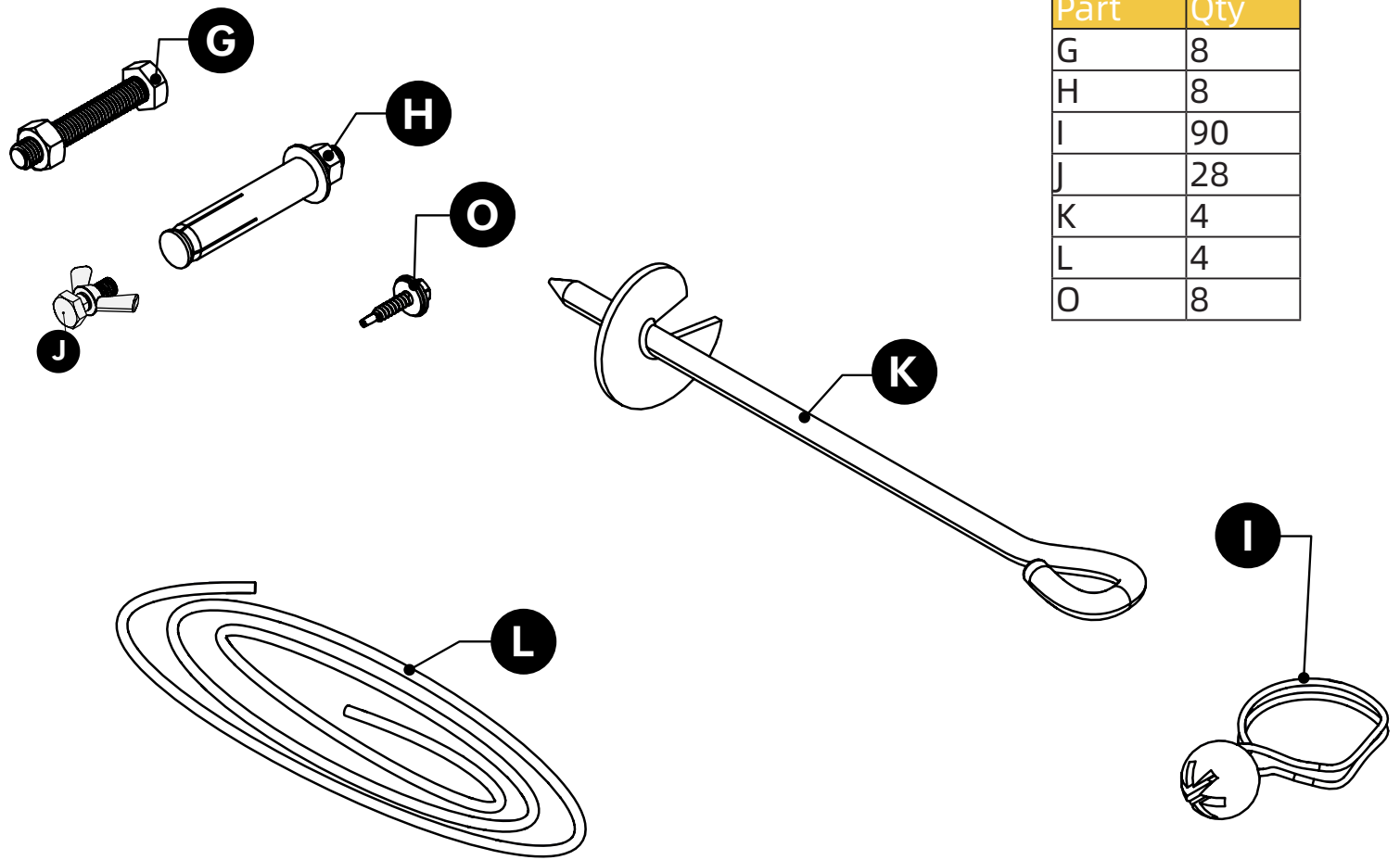

Part	Qty
Front/back Cover	2
Side Cover	2
Top Cover	1

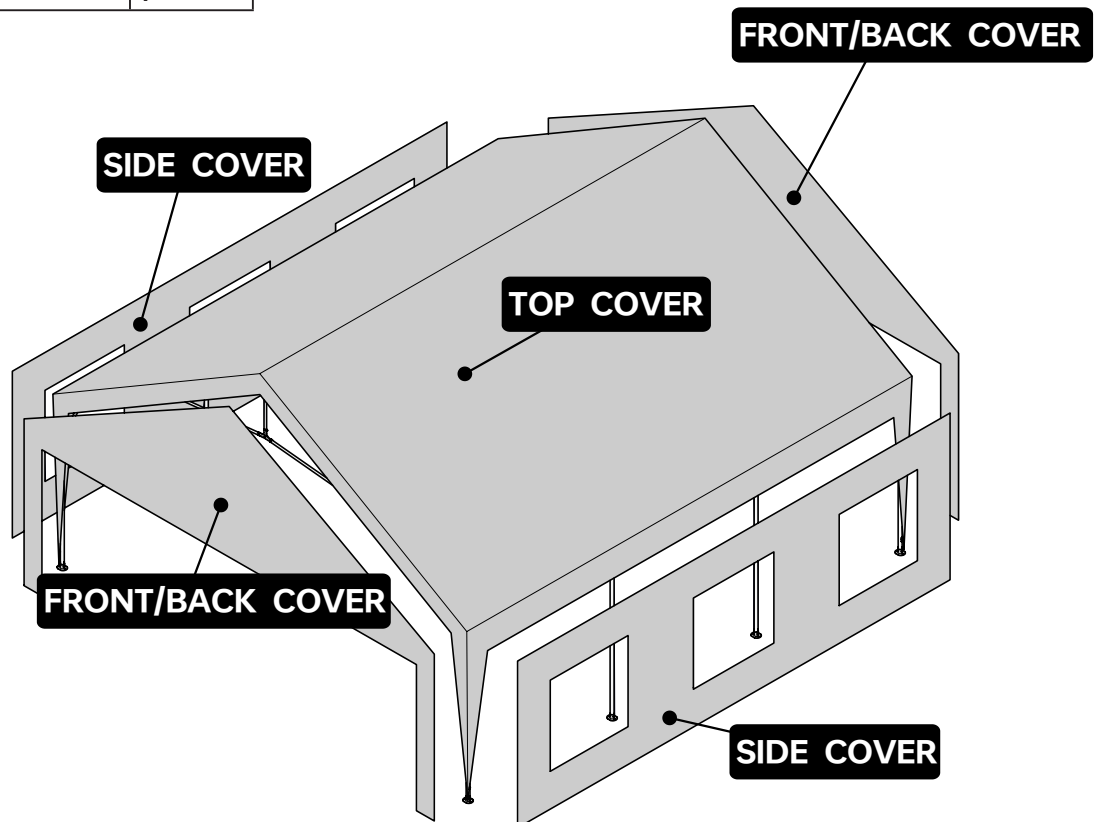

1

Part	Qty
A1	8
D2	2
D1	4
F1	4
J	8
L1	2
L2	4

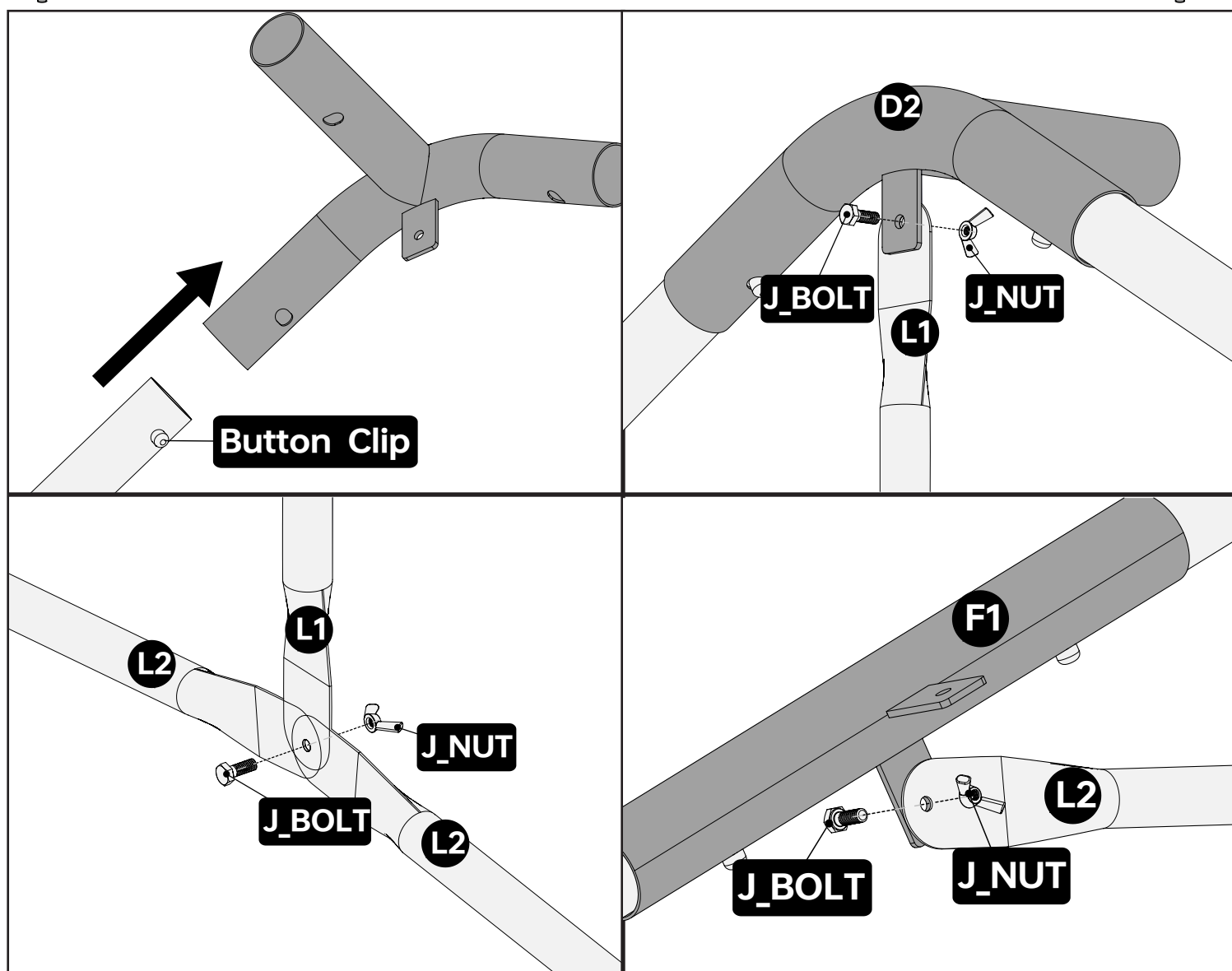
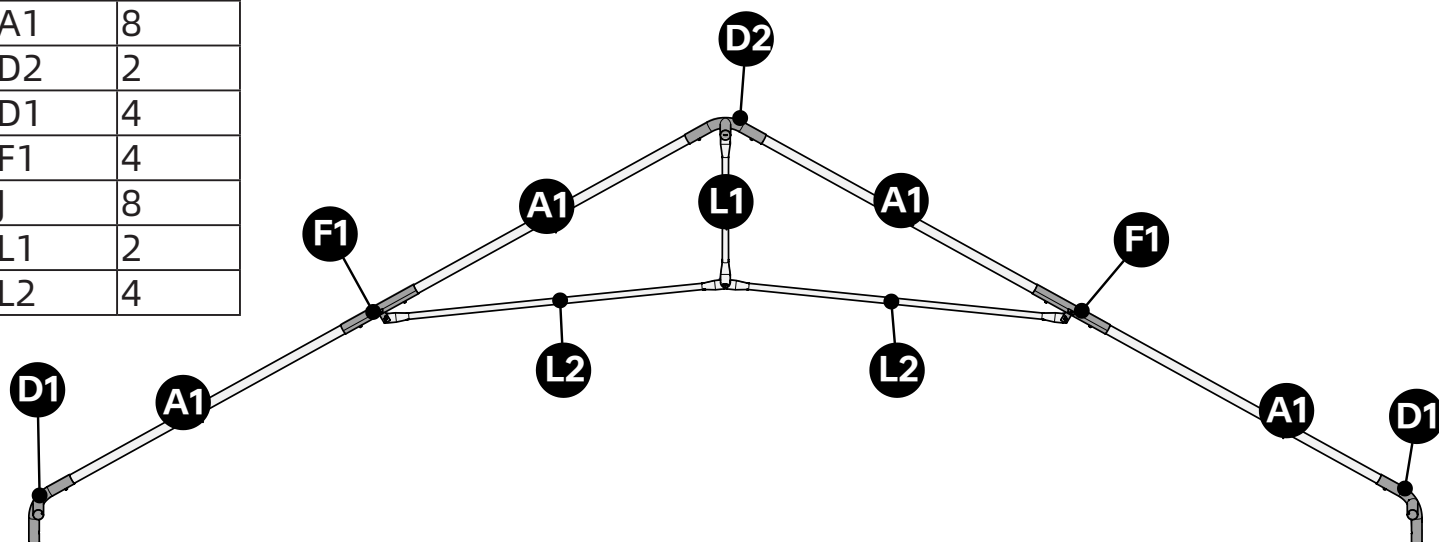

Note

For this product, tubes and joints are connected using button clips. Button clips are already inserted inside tubes. When connecting, press the button clip and insert one tube into the joint. Forcing the tubes in might also work but you are risking damaging the Clip.

Repeat this step till you get **two sets** of this structure.

Part	Qty
A1	8
E1	4
E2	2
F2	4
J	8
L1	2
L2	4

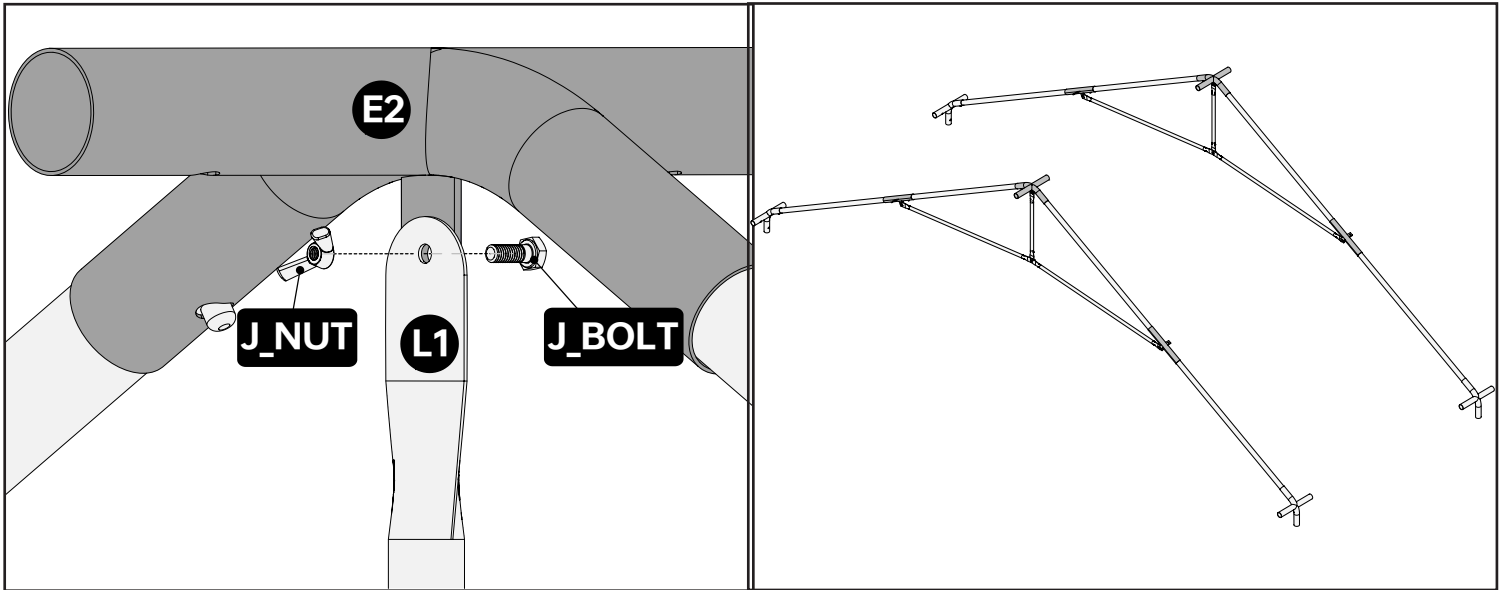
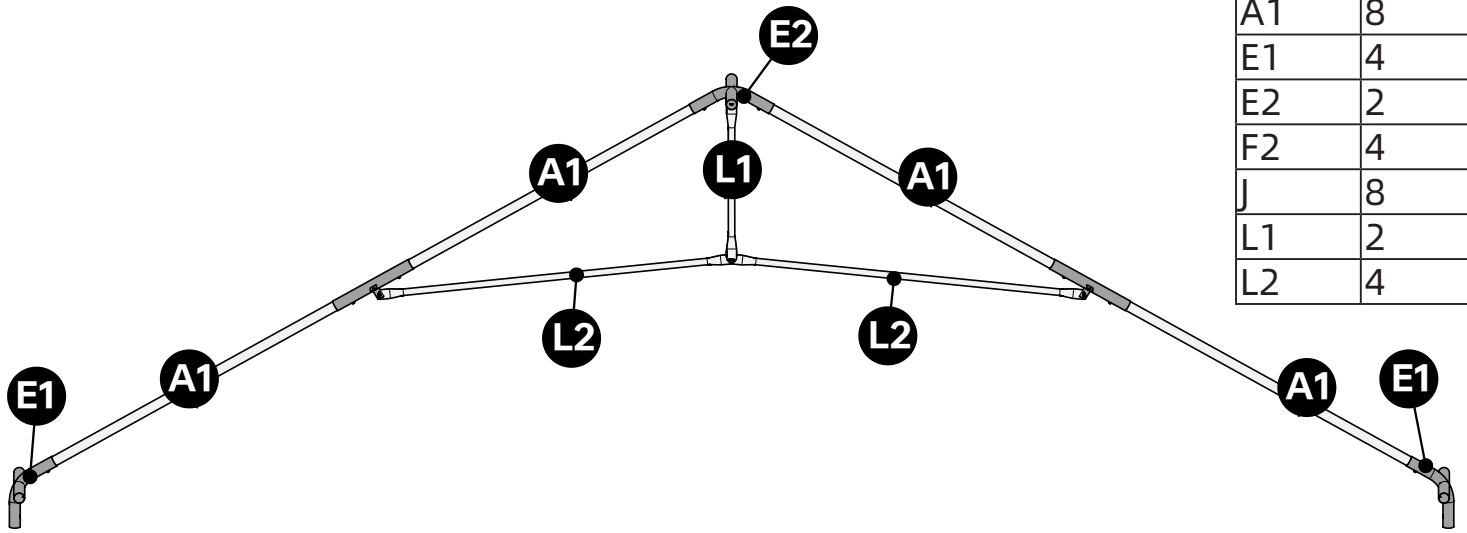

Note

Repeat this step till you get **two sets** of this structure.

3

Part	Qty
B1	9
J	12
L3	6

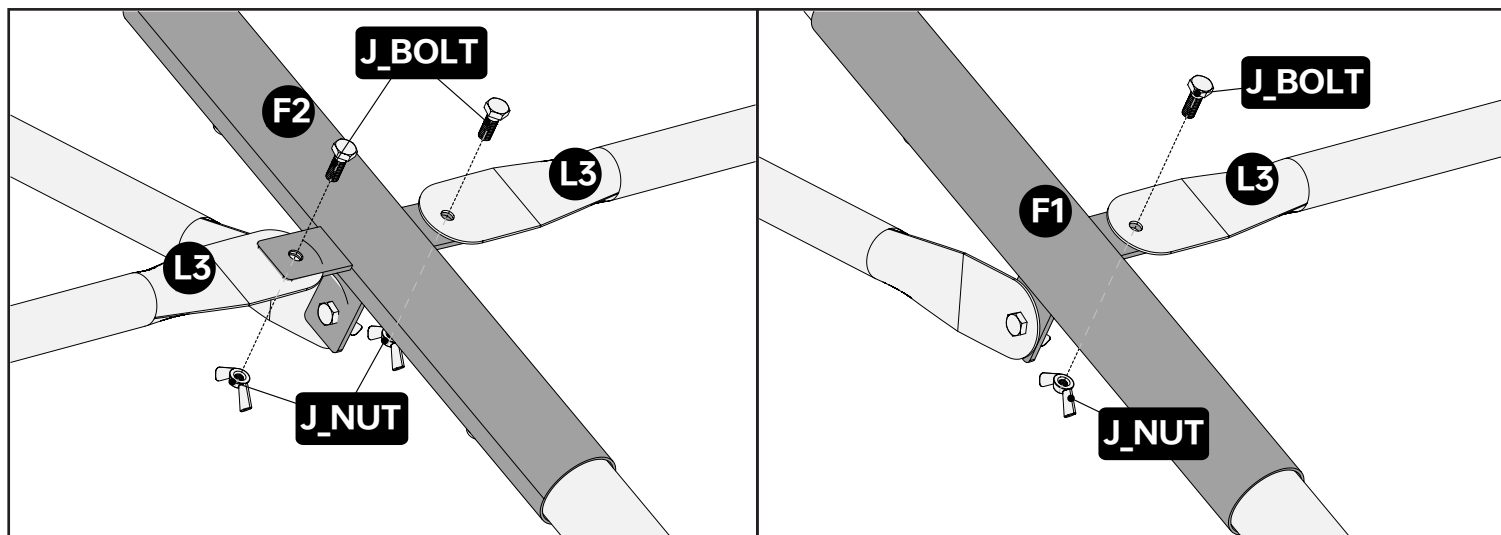
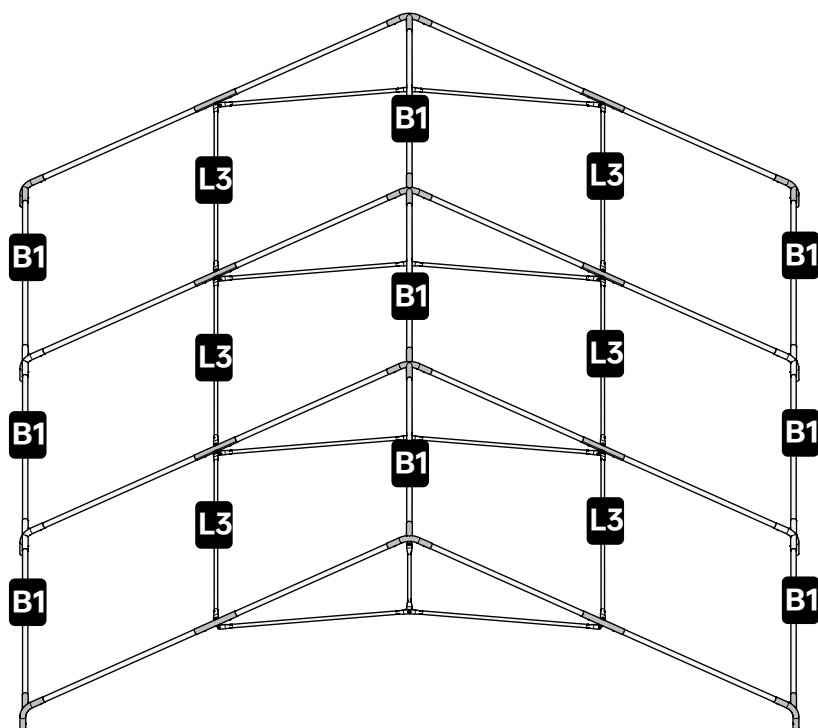
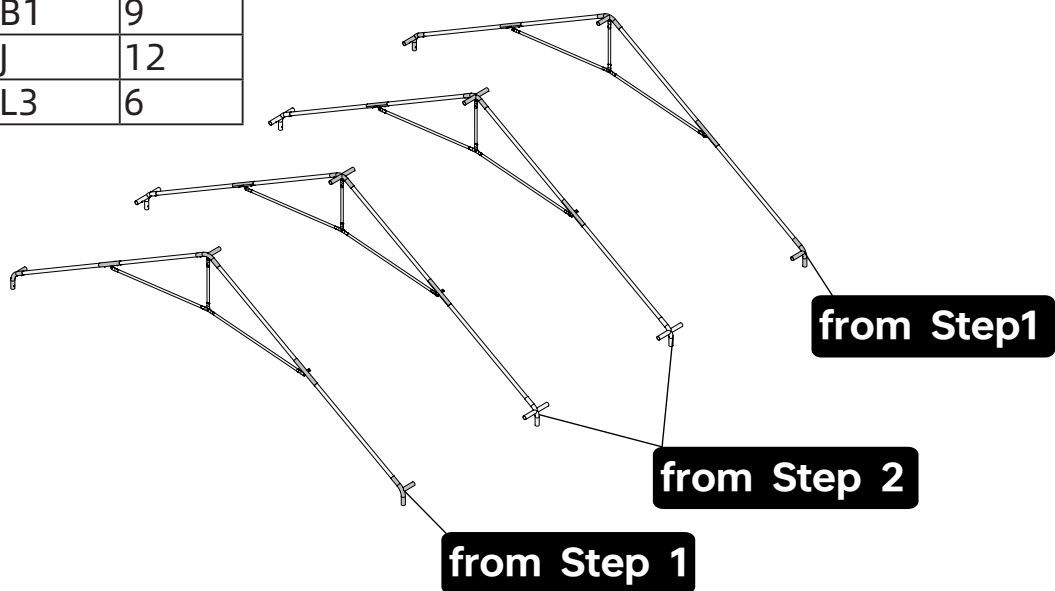

Part	Qty
C3	4
C4	4
F	8
G	8



Note

Repeat this step till you have used up all C3 and C4.

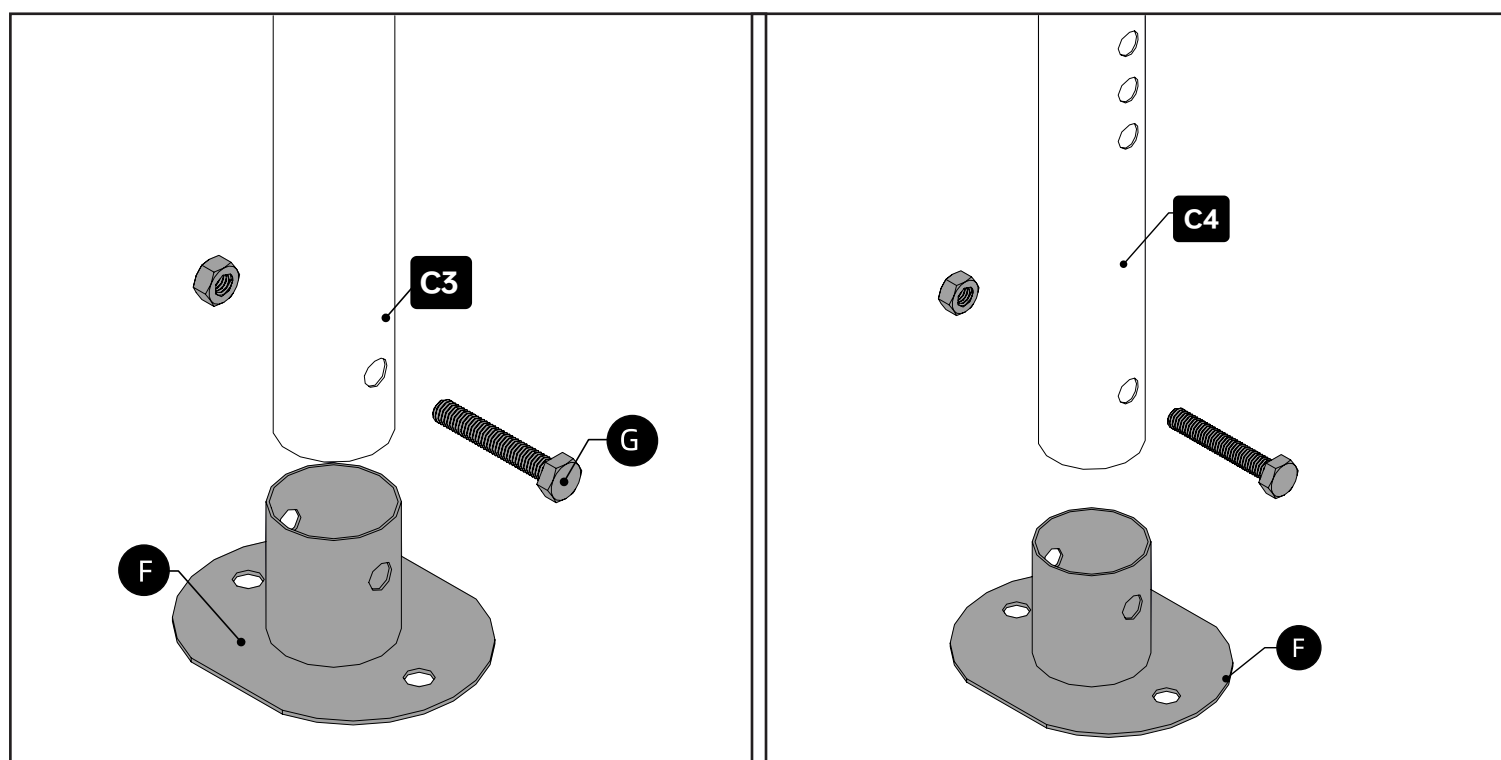
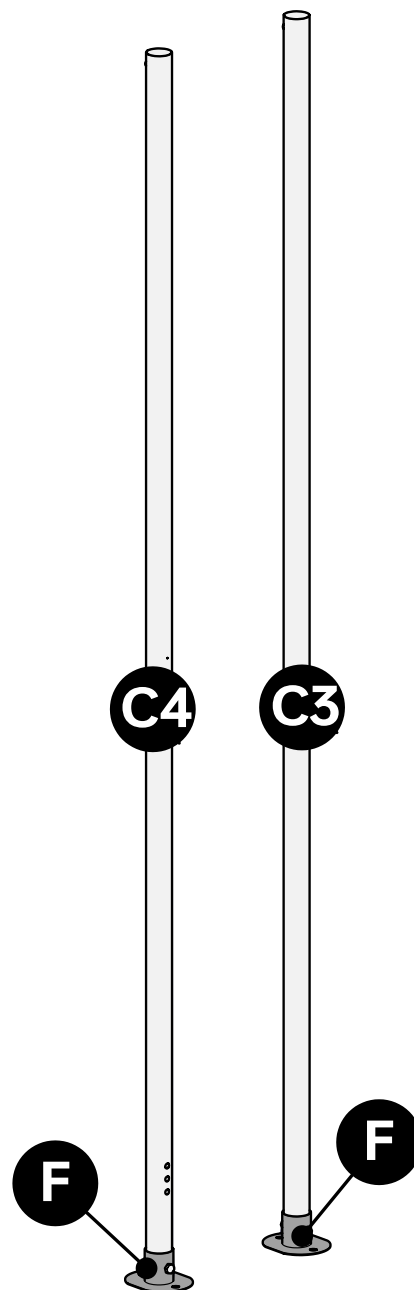

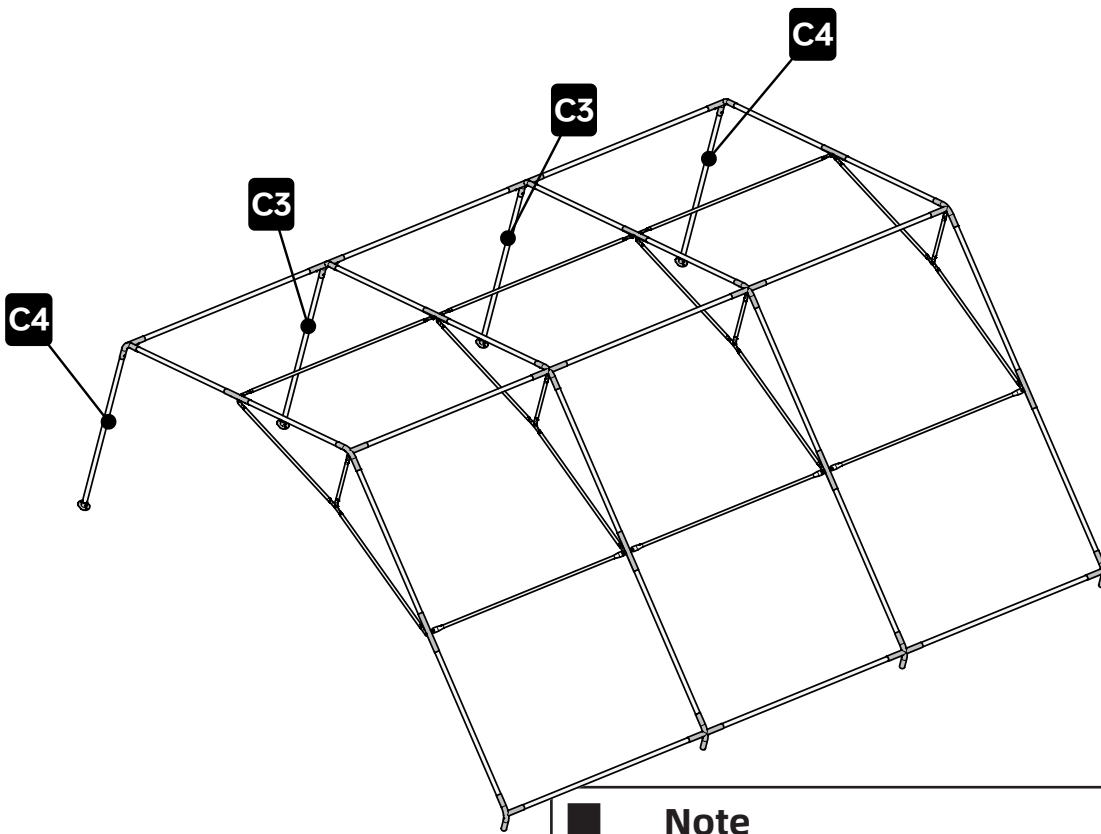

Note

Temporarily lay the frame down and attach C4+F and C3+F created in last step to the frame.
Make sure that C4 are placed at the front and back of the frame with the three holes facing outwards.

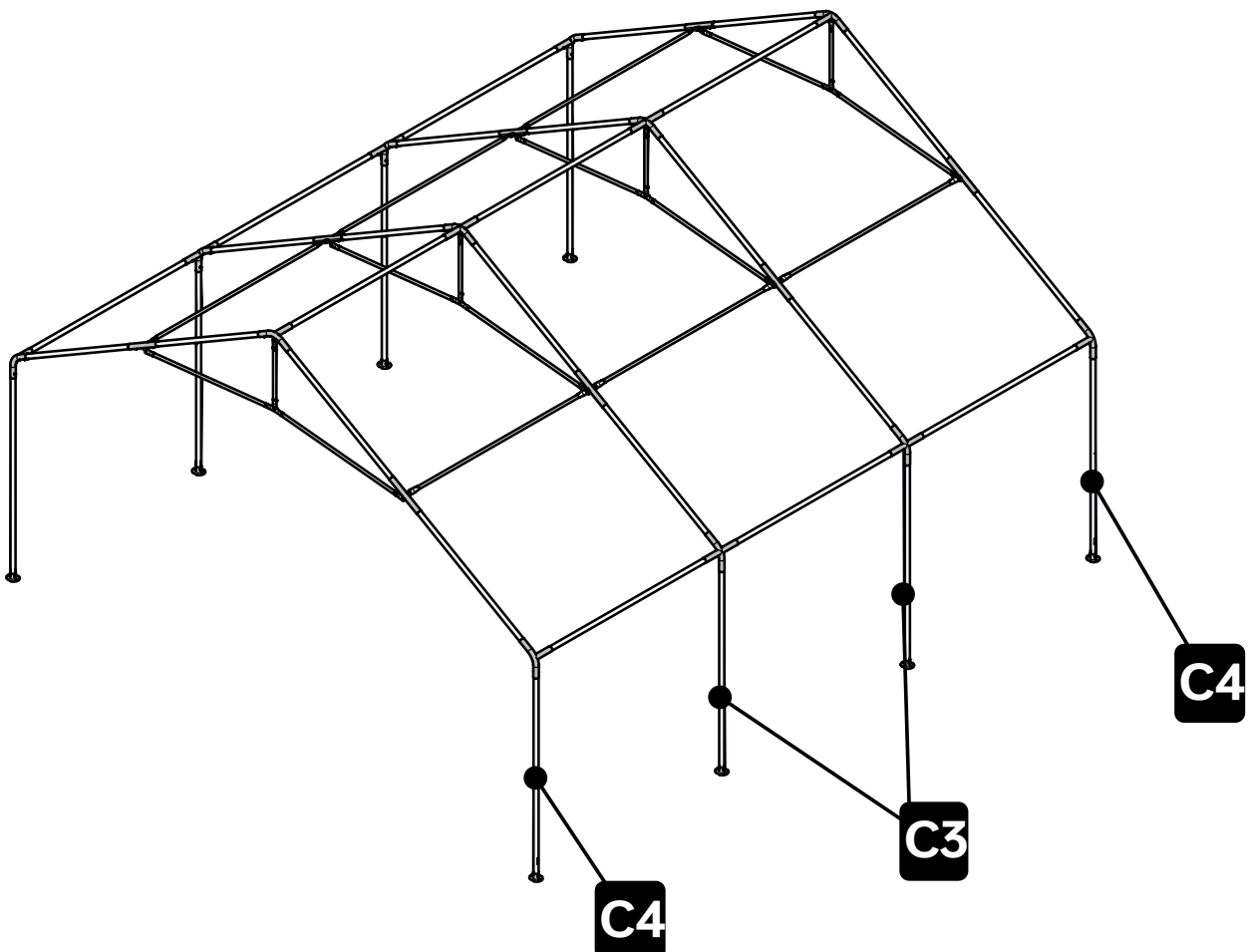

Part	Qty
L1	4
O	8

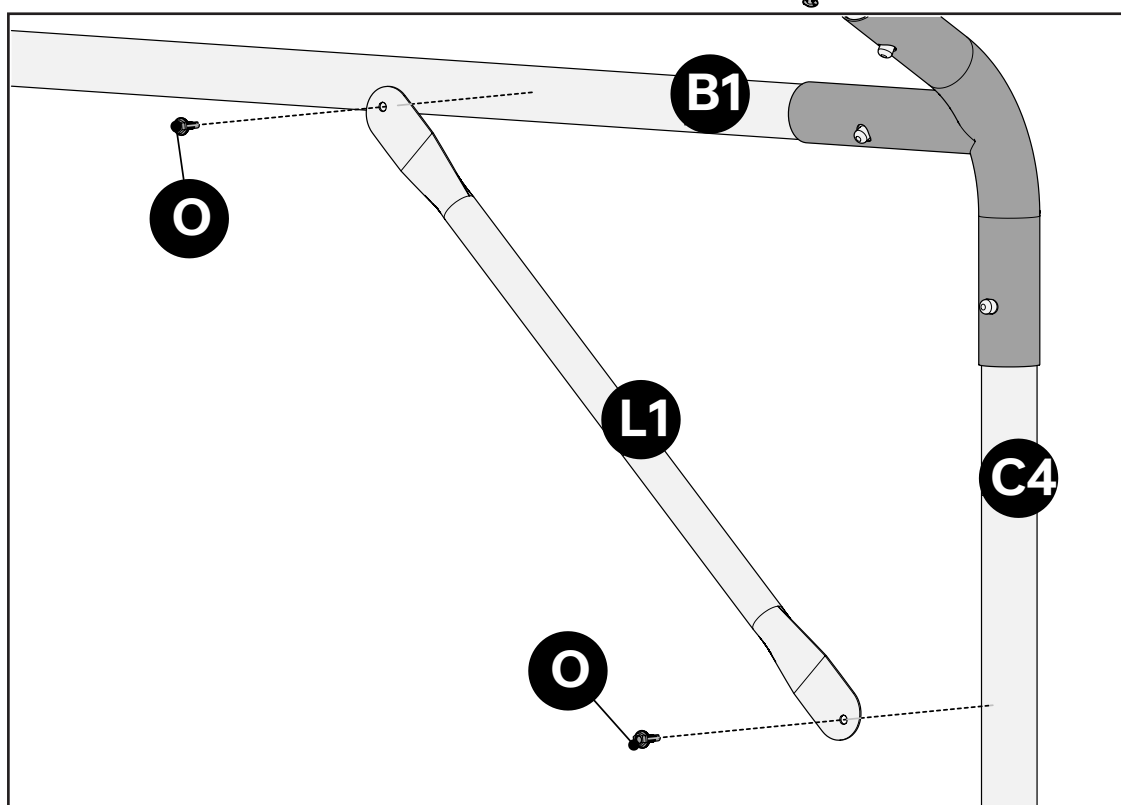
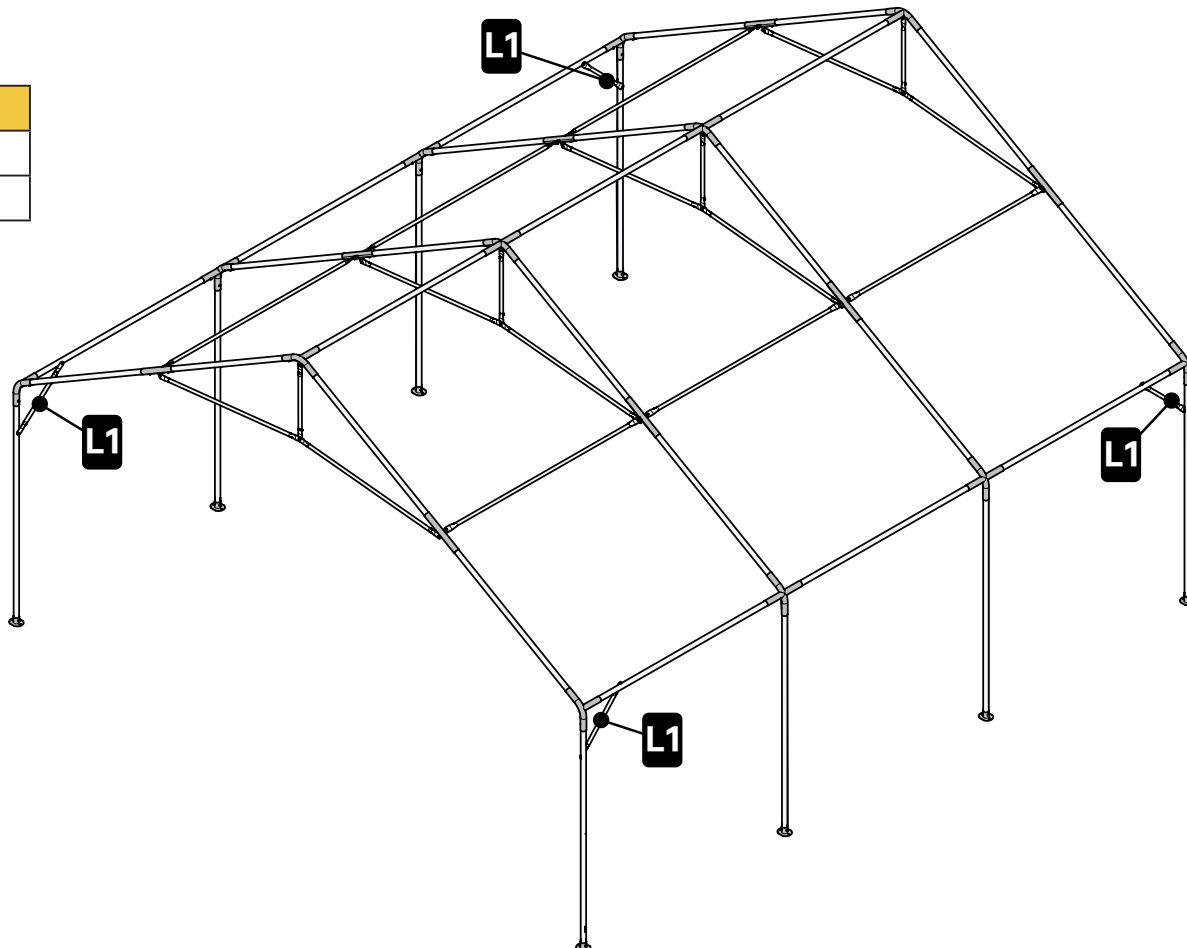

Note

You will need a power tool drive O into the tubes. Notice that you will not find predrilled holes on the tubes for O. Do not worry too much about pinpointing the exact location for L1. The location contributes little to the stability.

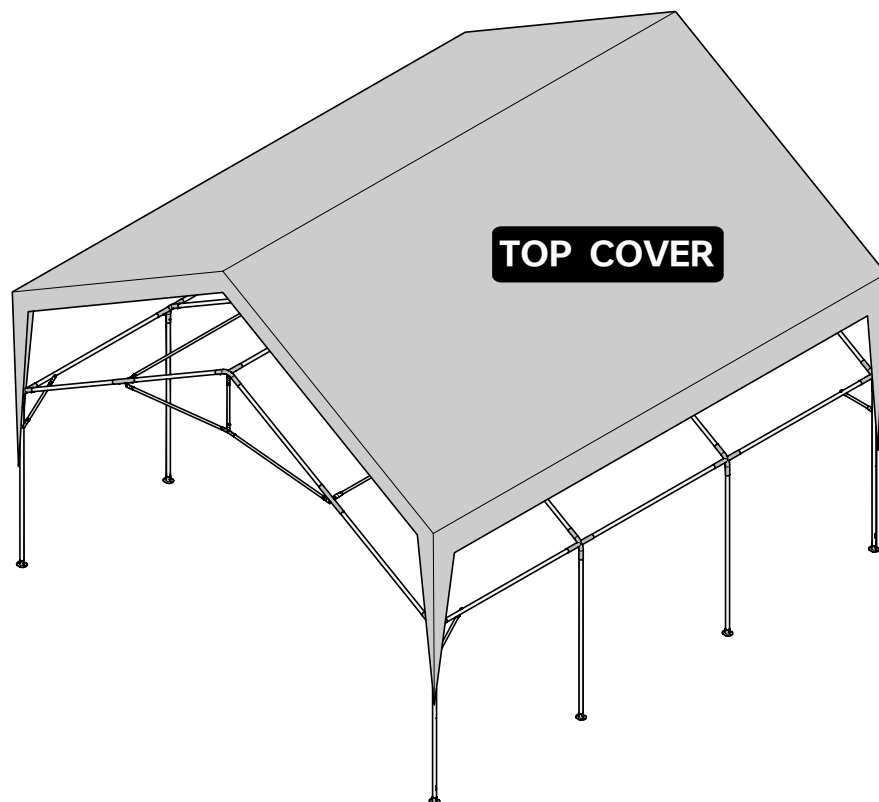

Part	Qty
Top Cover	1

Note

When pulling the top cover down onto the frames, depending on how you assemble the tent, you might find the cover too tight or loose. If it feels too tight, do not pull the four legs of the top cover. Instead, pull and drag the top part of the cover. This helps avoid tearing the cover.

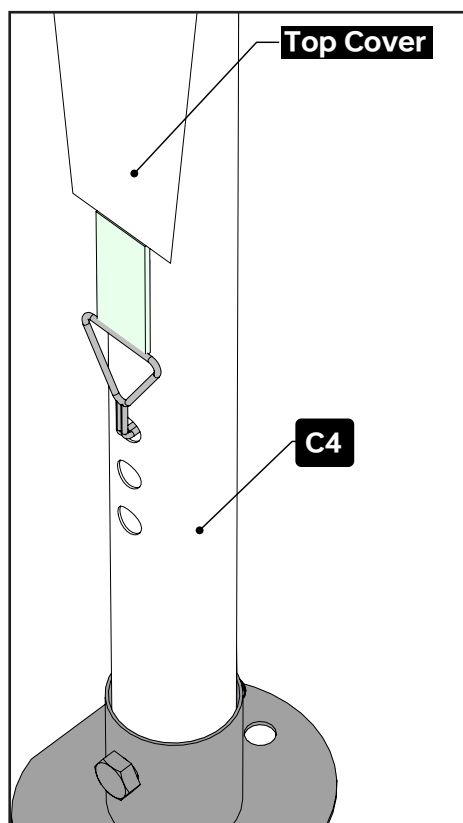

Note

Find the hooks at the end of Top Cover's feet and place the hook inside the hole at the bottom of C4.

Part	Qty
Side Cover	2
Front/back Cover	2
I	90

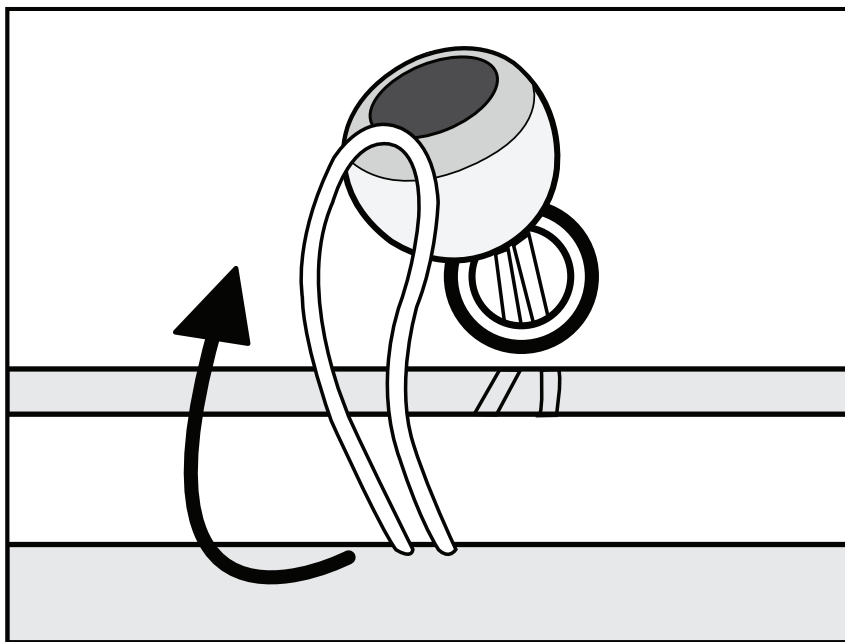
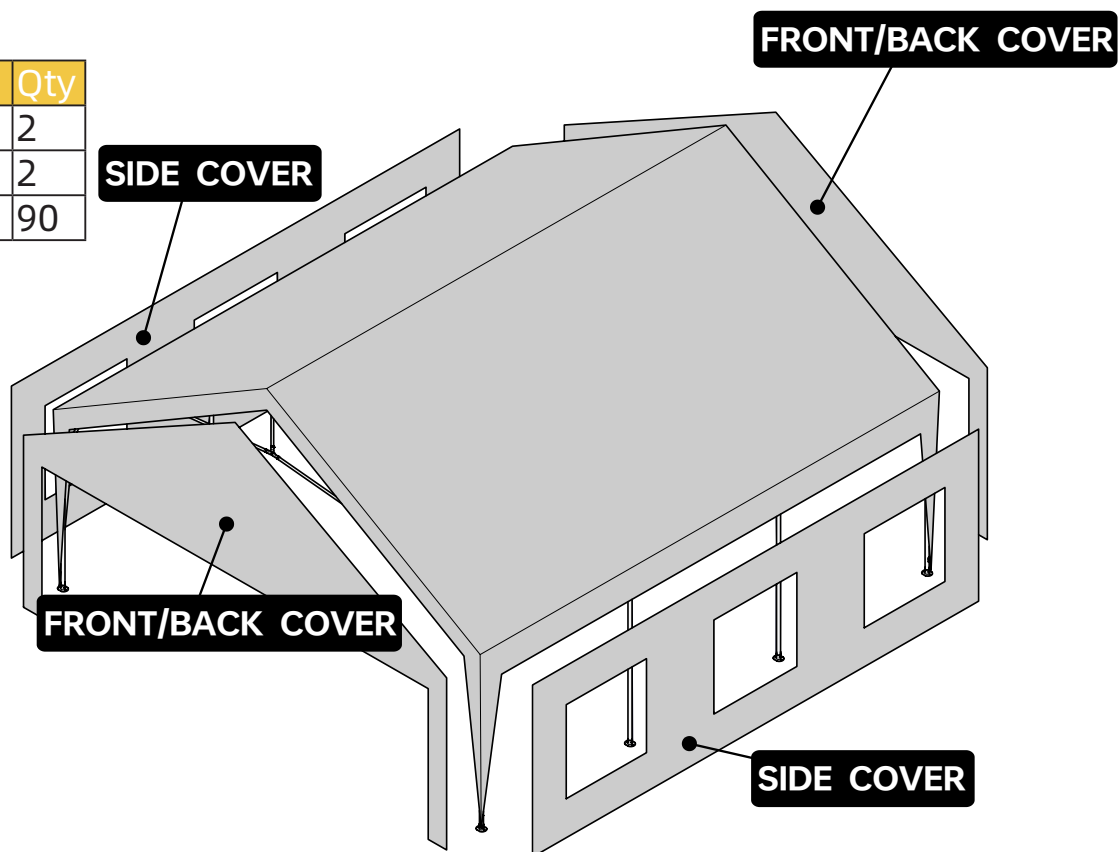

Note

Use bungee cord, Part No. I, to fasten the covers onto the tubes.

On the eaves of the carport, where the grommet of Top Cover overlaps with the grommet of Side Cover, use one I with two grommets. On the legs of the carport, where the grommet of the top cover overlaps with the grommet of Front and Back Cover, use one I with two grommets.

Part	Qty
K	4
L	4

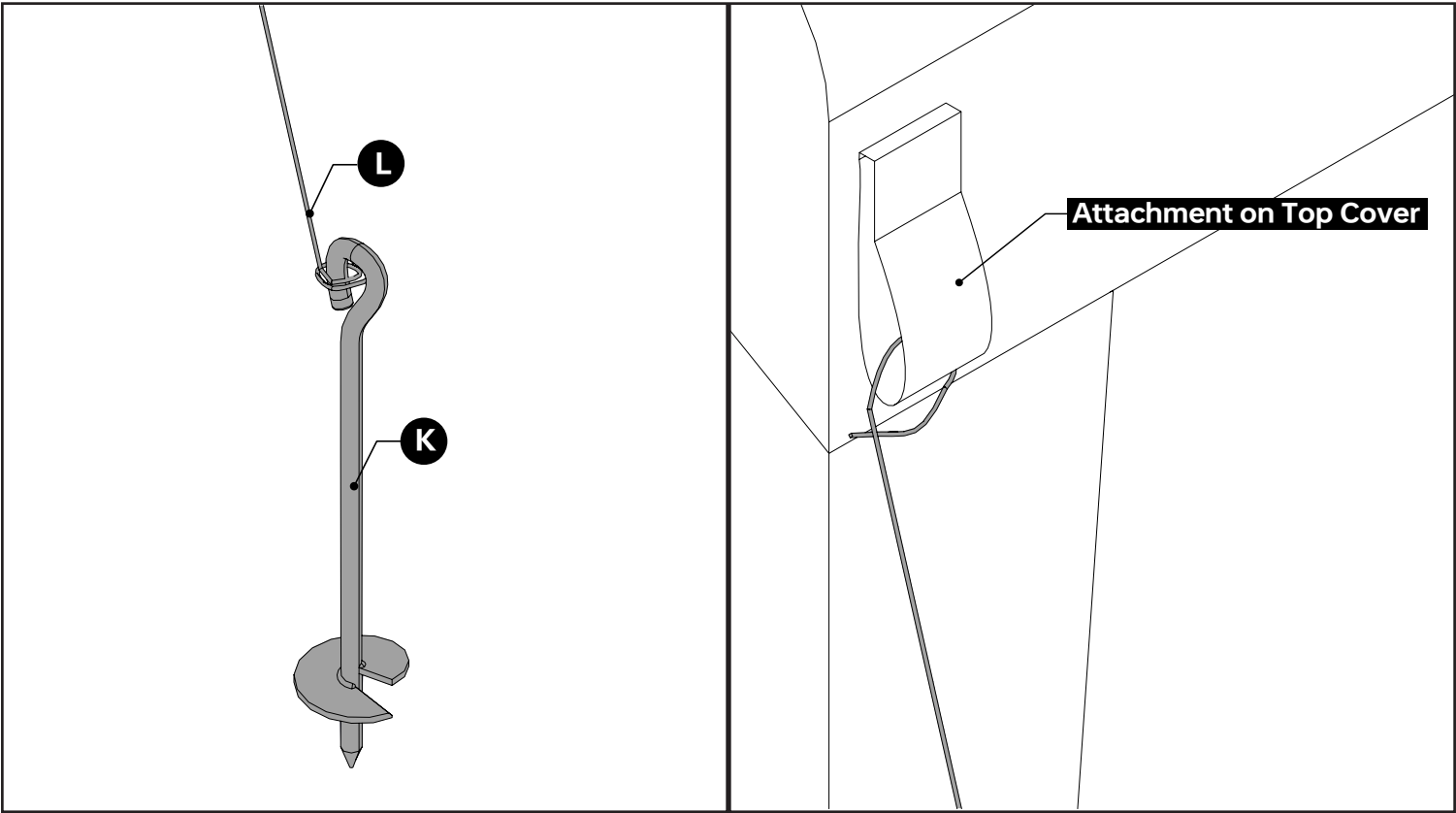
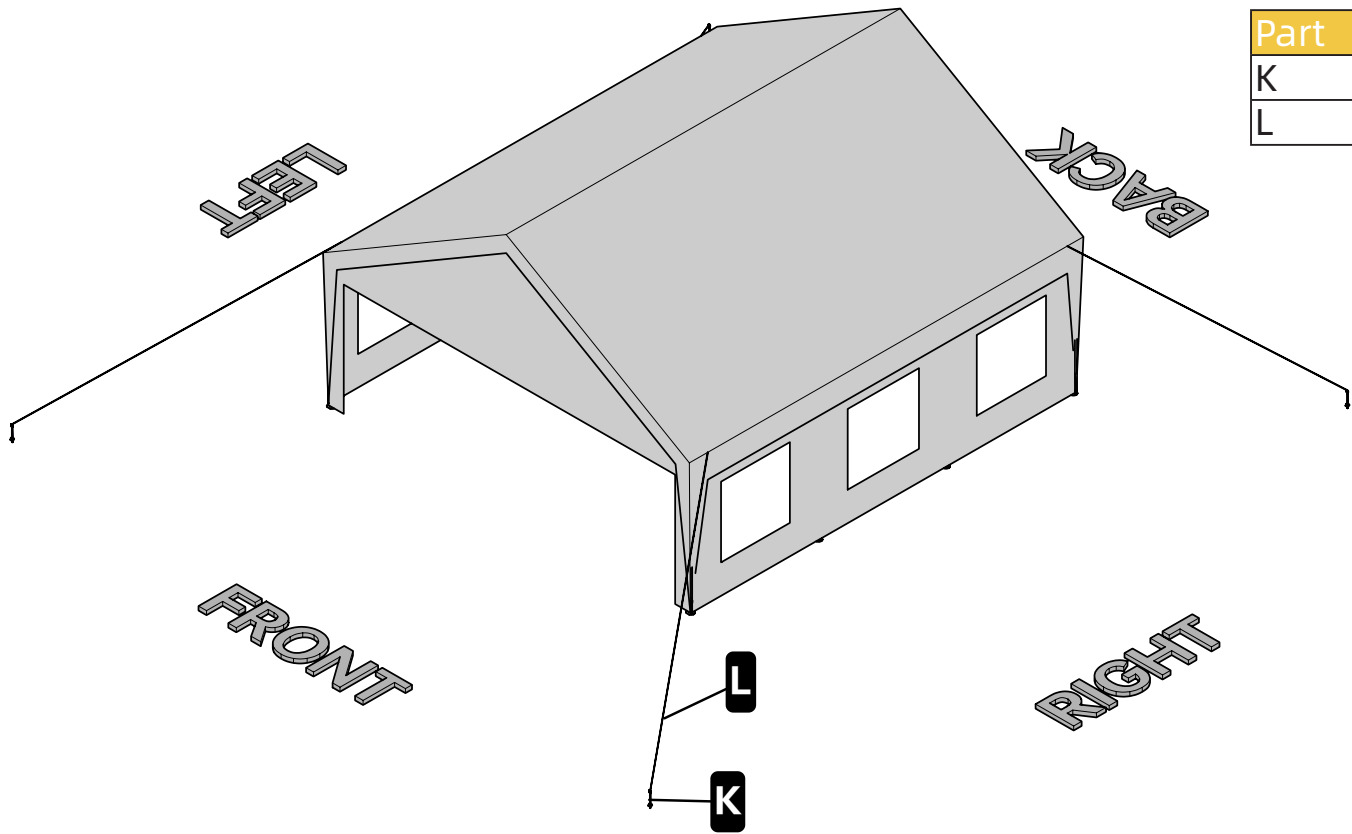

Part	Qty
H	8

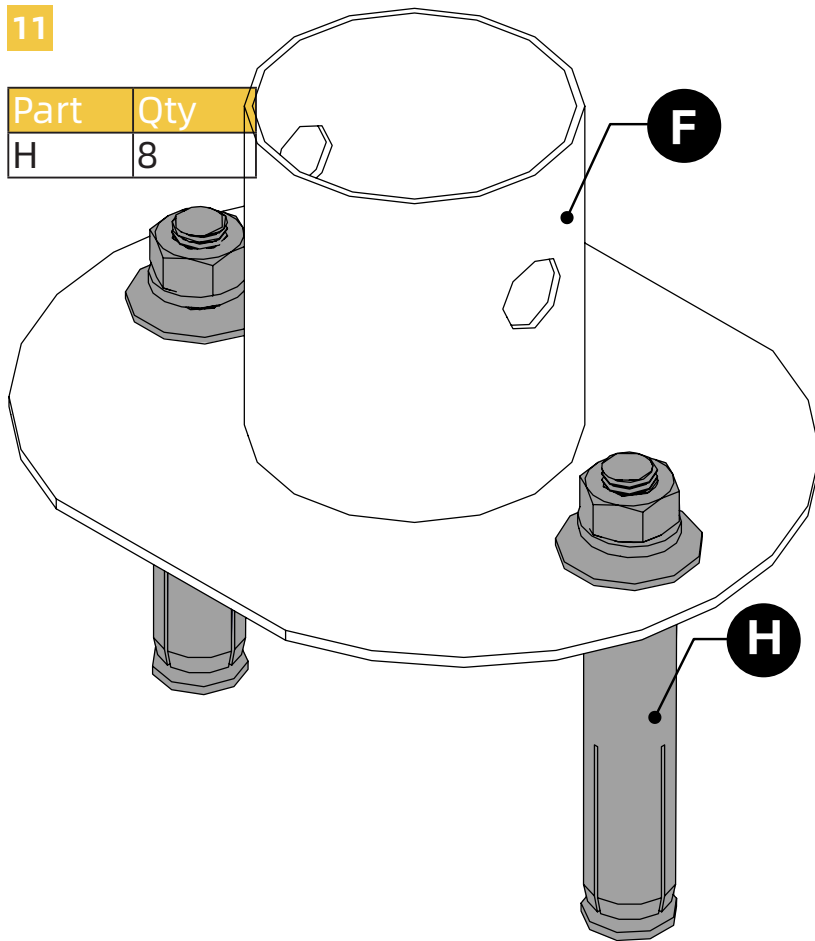

Note

If you prefer to secure the carport onto a concrete surface then use the concrete anchor H. You will need a M12, or 1/2 inch drill bit to drill into the concrete a hole which is 5.1cm, or 2inch deep. Remove the carport when hammering the H_Bolt and H_Sleeve into the concrete. Notice that once the Bolts and Sleeves are in, it is almost impossible to get them out. So plan where you want to use them carefully.

There are 8 pcs of H in the package. You can use one H per F, or choose seven F and use two H per F.

