

# ASSEMBLY INSTRUCTIONS

MODEL #

**FGI-2087C35-TR**

## Questions?

GIVE US A CALL: 1-888-980-5122  
MON – FRI 8:30AM – 5:30PM (PST)

## TOOLS REQUIRED



### Hammer

(Not Included)



### Philips Screwdriver

(Not Included)

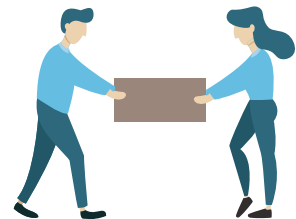

**2 - People  
Recommended**

## ASSEMBLY RATING



EASY —————> DIFFICULT

The Assembly Rating is a 5-point system showing the level of effort needed to assemble a specific product.

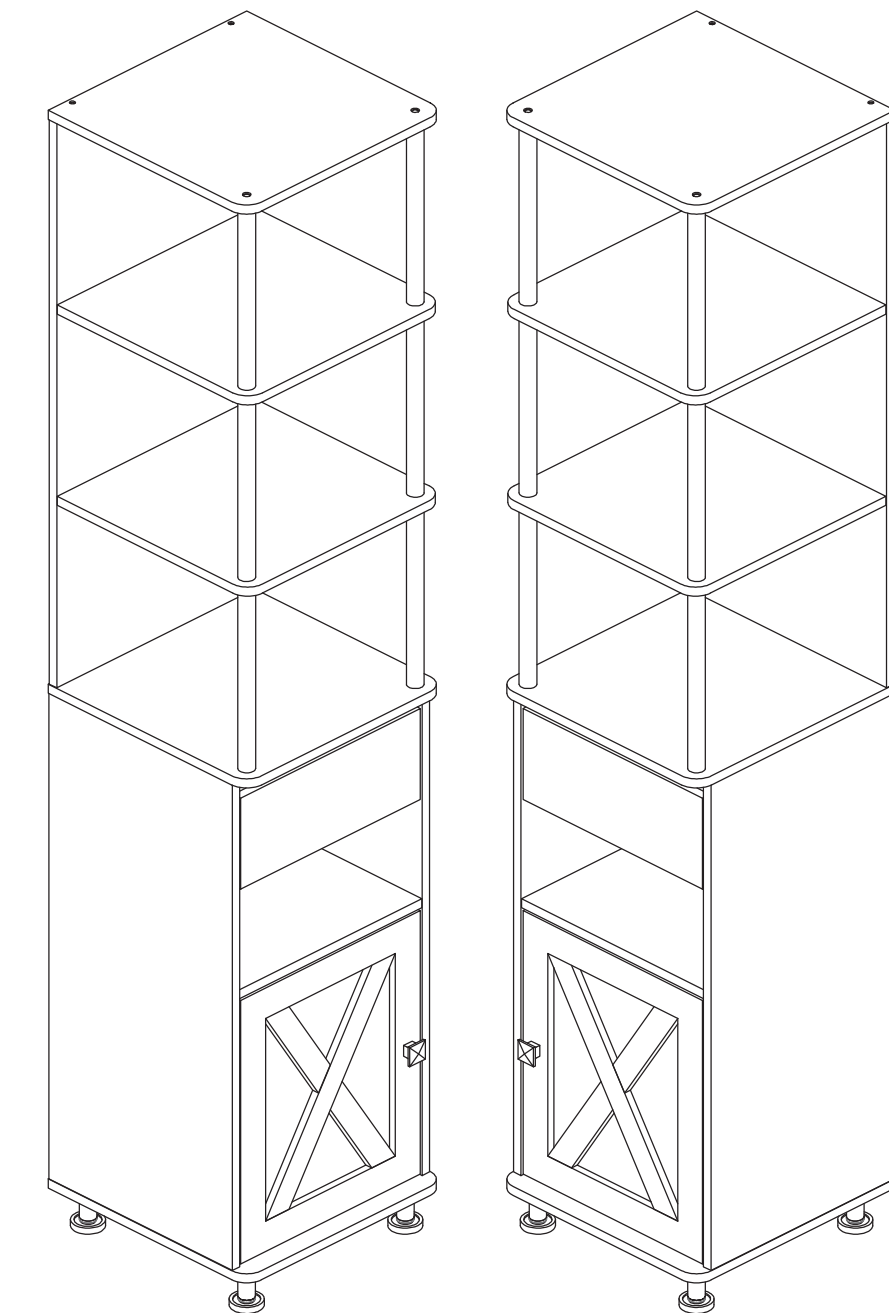



**Thank you for your purchase!**

We hope you enjoy this new addition to your home for many years to come.

Our commitment to providing quality products does not simply end when you purchase our product. We fully stand behind our products from start to finish. Our customer service department is available Monday – Friday 8:30 AM – 5:30 PM Pacific and can help with assembly questions as well as, if necessary, replacing damaged or missing parts. To help expedite our service, please have these assembly instructions readily available, along with your order receipt.

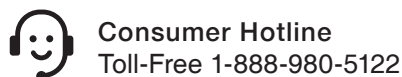

**Consumer Hotline**  
Toll-Free 1-888-980-5122



**WEBSITE**  
[www.foagroup.com](http://www.foagroup.com)



**Monday to Friday**  
8:30AM- 5:30PM (PST)



**E-MAIL**  
[cs.ec@foagroup.com](mailto:cs.ec@foagroup.com)



foagroup



FurnitureOfAmerica



## **CHECK BEFORE STARTING**



### **Are you missing anything?**

Double-check all parts, hardware and accessories listed on Page 6 are accounted for.



### **Check out our Quick Tips!**

We recommend reviewing the pre-assembly handouts. Even experts need a refresher now and then!



### **Should we send any replacements?**

Are there any irregularities or flaws in the parts? We can send replacements!



### **Prep Time!**

Please review the assembly instructions and all diagrams prior to assembling. Arrange parts as recommended on Page 7 and group identical hardware together to make assembling easier.

# PRE ASSEMBLY INTRODUCTION

We understand building ready-to-assemble furniture can be a challenging experience for some. To help avoid confusion, we have provided some helpful tips that may speed up the process.

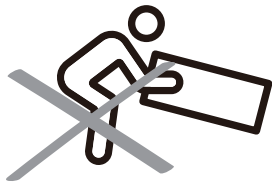

## Teamwork

ALWAYS have at least two people to help with transporting and assembling the product to avoid potential injury and/or damage.

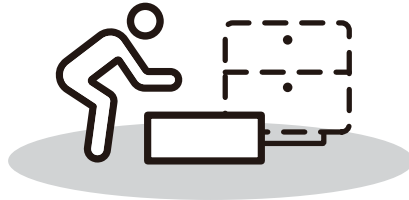
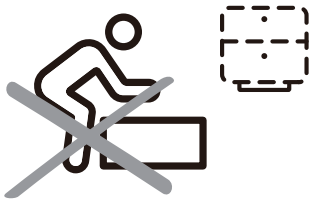

## Suitable Location

Assembling near the area of the intended location is highly recommended.



## Sufficient Space

Make sure you have enough space to move around during the assembly.



## Avoid Scratches

Use cardboard, blankets or a carpeted area while assembling furniture to prevent scratches.

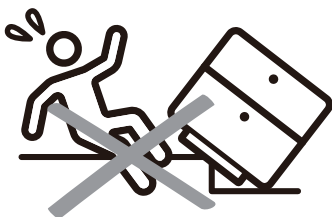

## Flat Surface

Make sure the furniture rests on a flat and level surface with each leg evenly touching the floor.

# ASSEMBLY AND CARE ADVICE



**FAILURE TO FOLLOW THE GUIDELINES BELOW MAY  
RESULT IN INJURY AND/OR PROPERTY DAMAGE.**



Position each part correctly  
and insert screws or bolts into  
their respective holes.

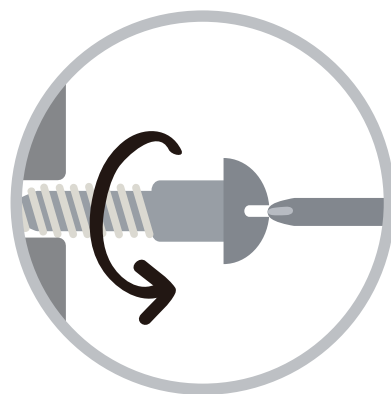

Turn clockwise to tighten and  
only tighten when step is  
completed or when instructed  
to do so.



Save the instructions and store  
any supplied tools for later  
maintenance.

Use the appropriate hand tools  
or power tools for assembly.  
Select steps, such as tightening  
screws and/or bolts, may require  
hand tools to avoid causing  
damage during assembly.

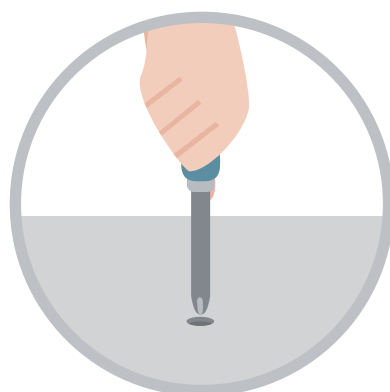

After two weeks, check and  
tighten any loose hardware and  
repeat again every six months  
thereafter.

**IT IS THE USER'S RESPONSIBILITY TO MAINTAIN THE FURNITURE. THE HARDWARE MAY LOOSEN OVER TIME AND MAY CAUSE THE FURNITURE TO BE WOBBLY AND UNABLE TO SUPPORT ITS INTENDED WEIGHT CAPACITY. THIS MAY LEAD TO COLLAPSE AND MAY CAUSE SERIOUS INJURY.**

# CAM LOCK FASTENER ASSEMBLY INSTRUCTIONS

## Note :

Every cam lock bolt must have a cam lock connector in order to fasten the parts together.

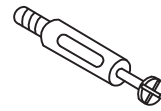

cam bolt



cam lock

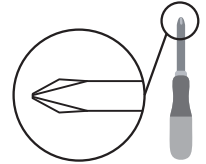

screwdriver

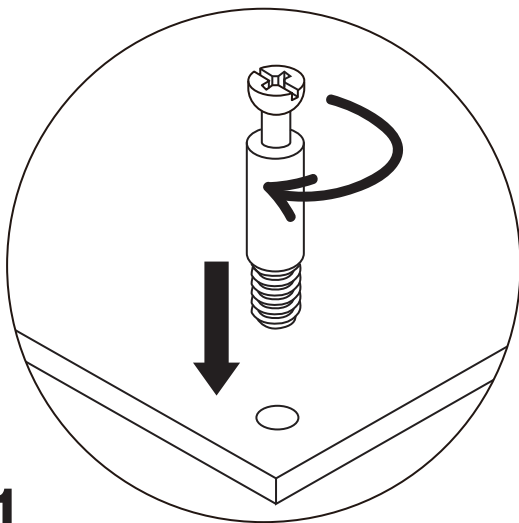

**1**

Screw the cam bolt into panel.

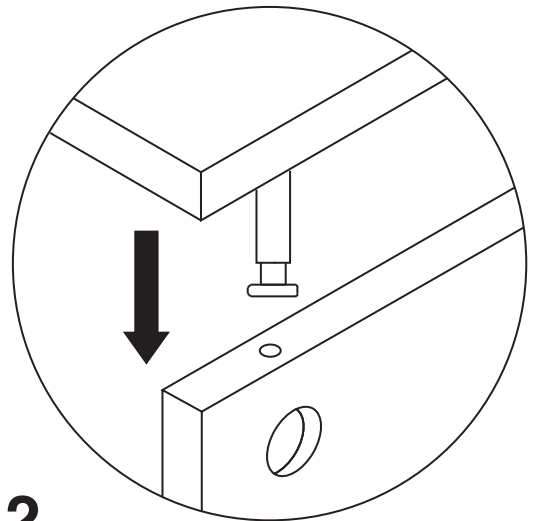

**2**

Insert the cam bolt into the bolt hole of joint panel.

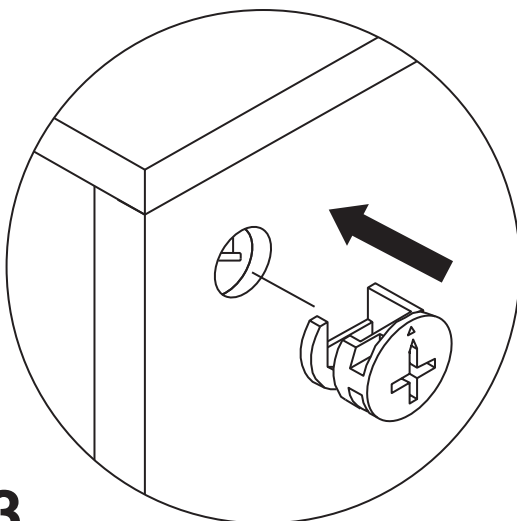

**3**

Align the cam lock with its side opening (or arrow) pointing to cam bolt.

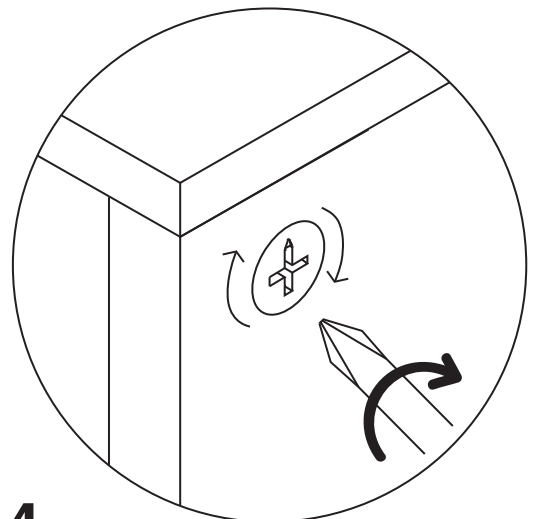

**4**

Turn the cam lock clockwise gently until it will not turn any more.

# TV TOWER

FGI-2087C35-TR

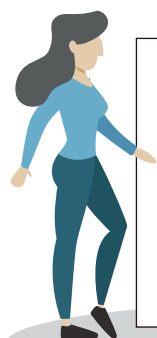

- Please keep instructions for future reference.
- Check the quantity and irregularity of parts and hardware before you start.

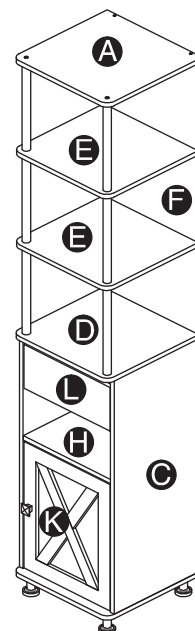

## PARTS

A1PC

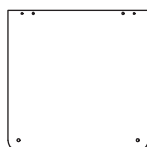

B1PC

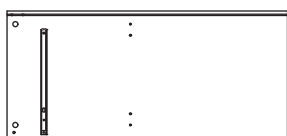

C1PC

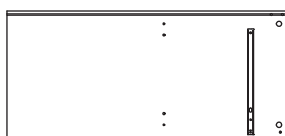

D1PC

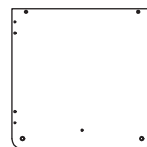

E2PCS

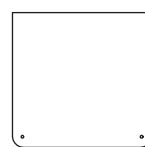

F1PC

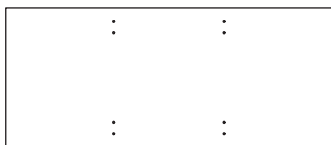

G1PC

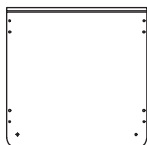

H1PC

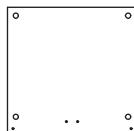

I1PC



J1PC



K1PC

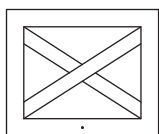

L1PC



M1PC



N1PC



O1PC



P1PC



Q1PC



## HARDWARE

① 10PCS ② 10PCS ③ 29PCS ④ 16PCS

0.47"

0.98"

1.49"



⑤ 4PCS

⑥ 4PCS

⑦ 1PC

⑧ 1PC



⑨ 1PC

⑩ 1PC

⑪ 2PCS

⑫ 6PCS

Fixed



## ACCESSORIES

A1 4PCS



A2 16PCS



A3 4PCS



A4 1PC



A5 1PC



A6 6SETS



A7 1PC

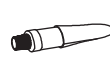

A8 1PC



A9 1PC



A10 1PC



A11 1PC



A12 1PC



A13 2PCS



A14 1PC



# GET READY

Please group boards as below.

**L**1PC



**M**1PC



**N**1PC



**O**1PC



**P**1PC



Drawer

**B**1PC

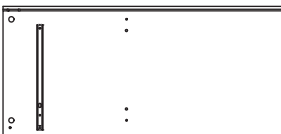

**C**1PC

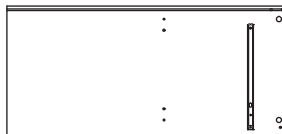

**H**1PC

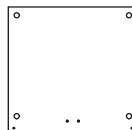

**I**1PC

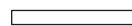

**J**1PC



**Q**1PC

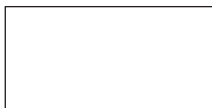

**G**1PC

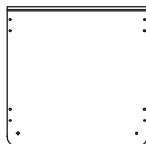

**E**2PCS

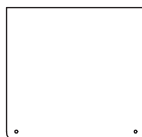

**F**1PC

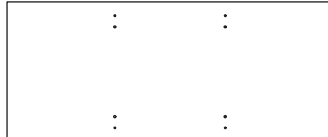

**A**1PC

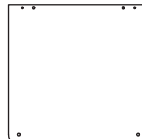

**D**1PC

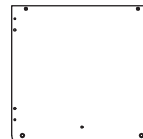

Body

**K**1PC

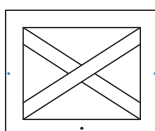

Doors

# ASSEMBLY INSTRUCTIONS

## 1

Hardware ① x 2PCS

Hardware ③ x 2PCS

Accessory A7 x 1PC

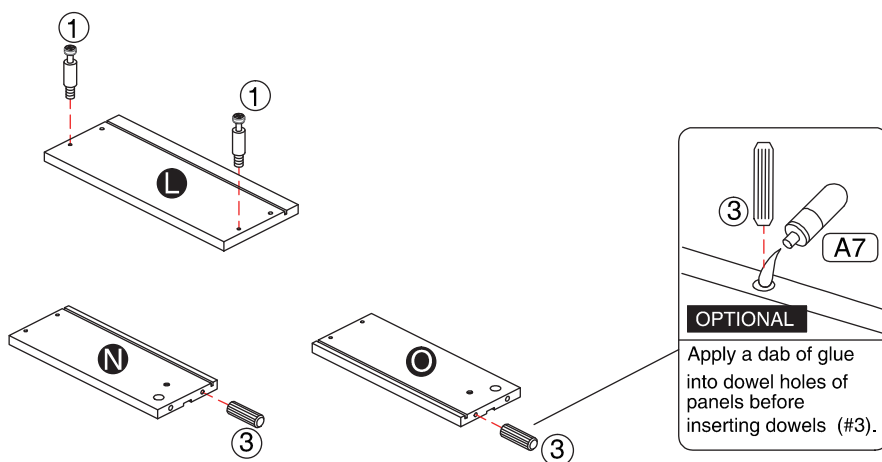

## 2

Part L x1PC

Part M x1PC

Part N x1PC

Part O x1PC

Part P x1PC

Hardware ② x 2PCS

Hardware ④ x 4PCS

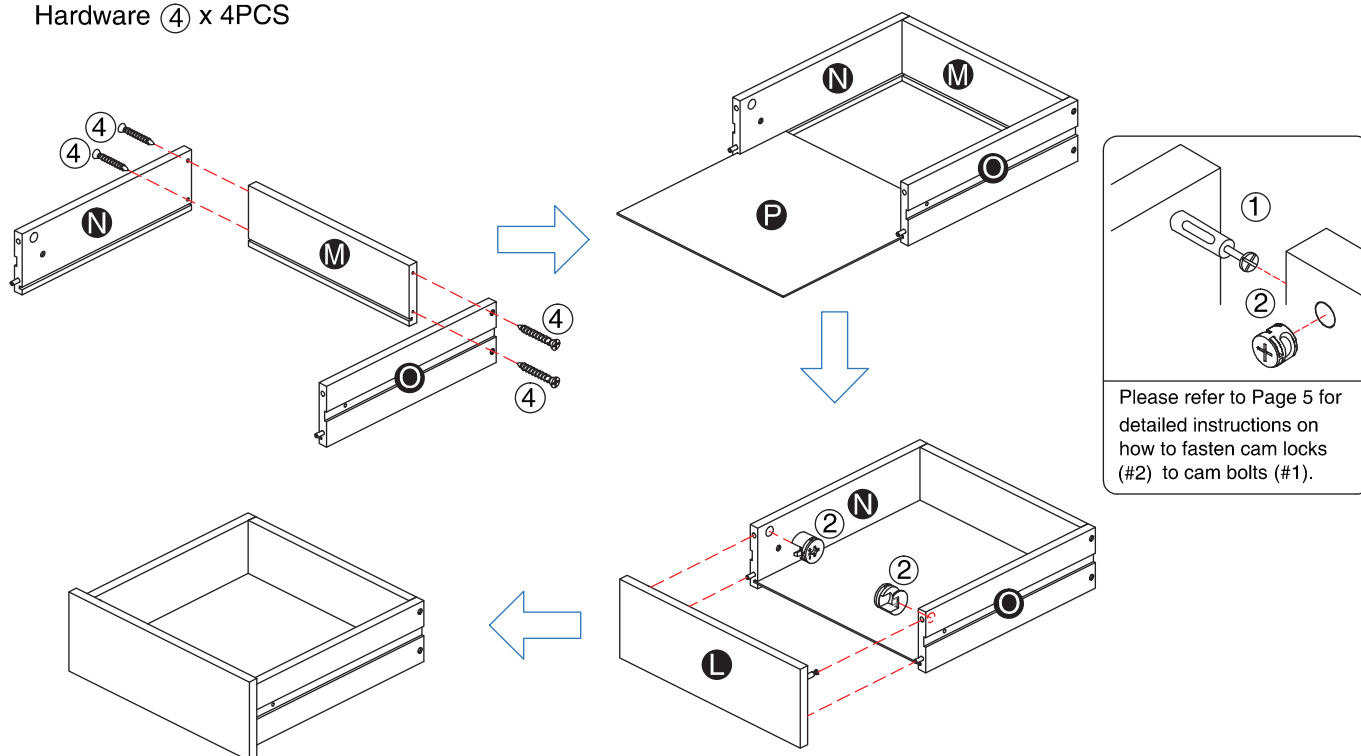

# ASSEMBLY INSTRUCTIONS

## 3

Hardware ① x 8PCS

Hardware ③ x 27PCS

Hardware ⑦ x 1PC

Accessory [A7] x 1PC

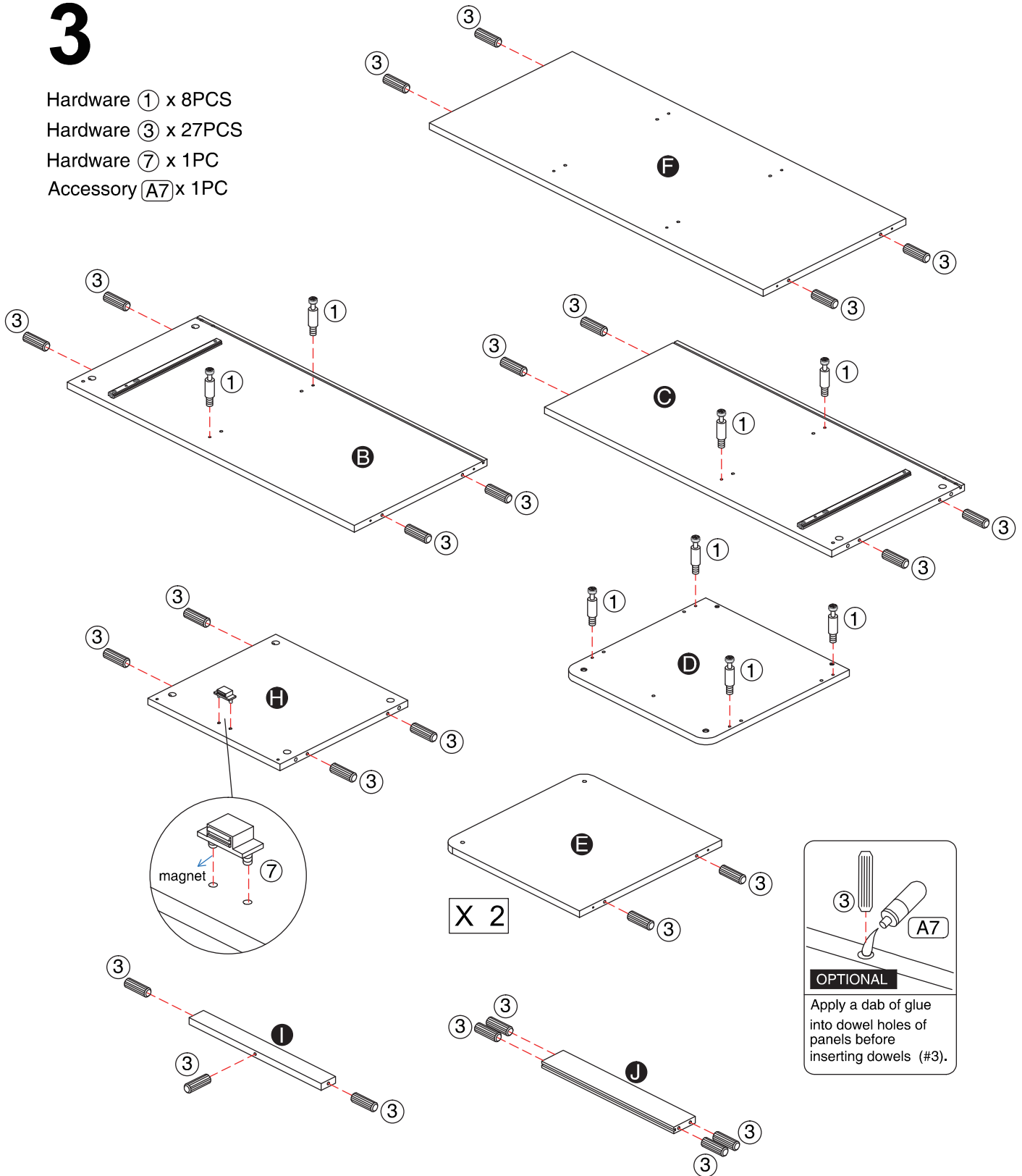

# ASSEMBLY INSTRUCTIONS

## 4

- Hardware ⑨ x 1PC
- Hardware ⑩ x 1PC
- Accessory A4 x 1PC
- Accessory A5 x 1PC

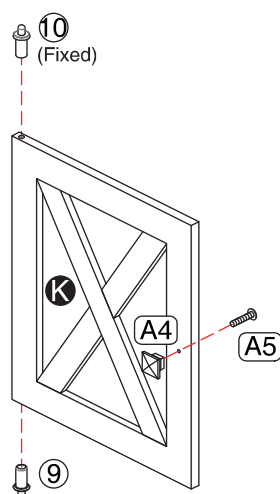

## 5

- Part B x1PC
- Part C x1PC
- Part H x1PC
- Part I x1PC
- Part J x1PC
- Hardware ② x 4PCS
- Accessory A7 x 1PC

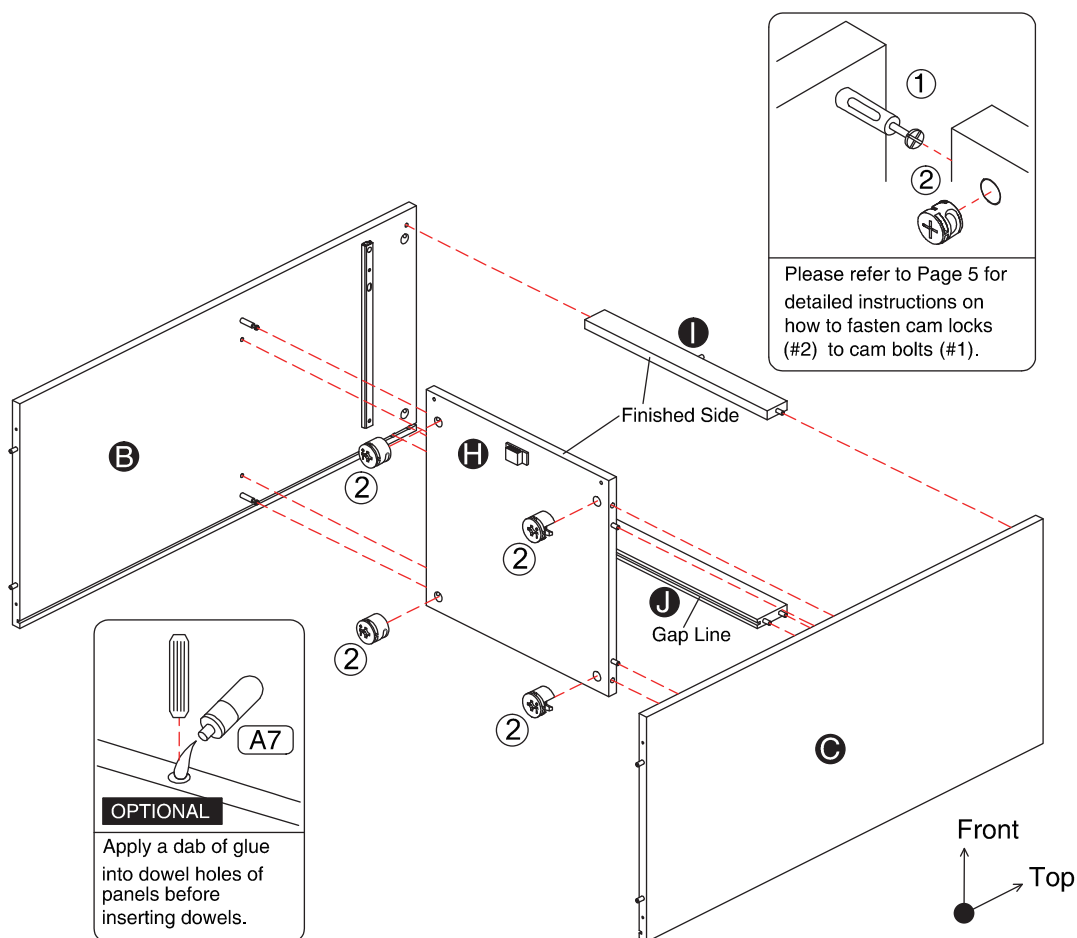

# ASSEMBLY INSTRUCTIONS

## 6

Part **Q** x1PC

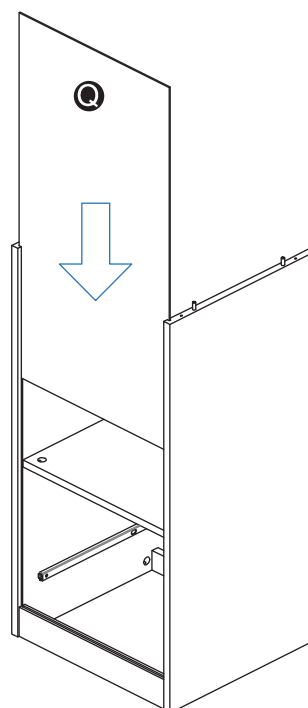

## 7

Part **G** x1PC

Hardware **4** x 4PCS

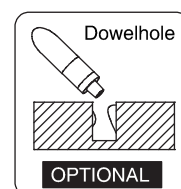
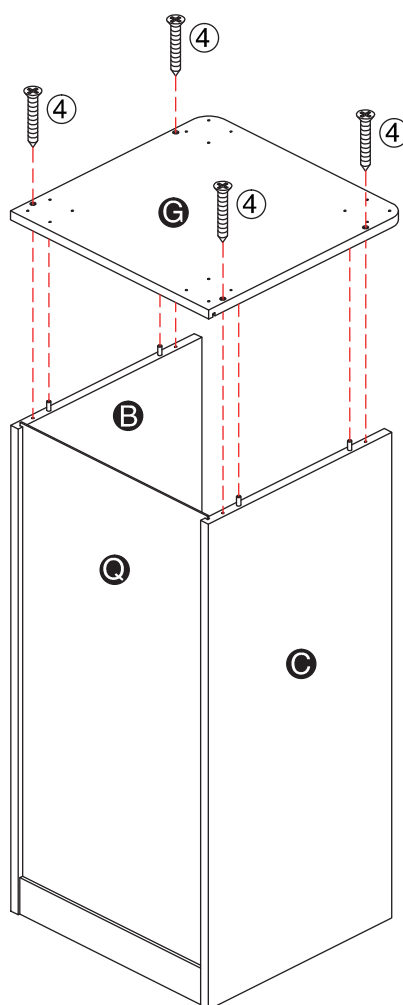

# ASSEMBLY INSTRUCTIONS

## 8

Accessory **A1** x 4PCS

Accessory **A2** x 16PCS

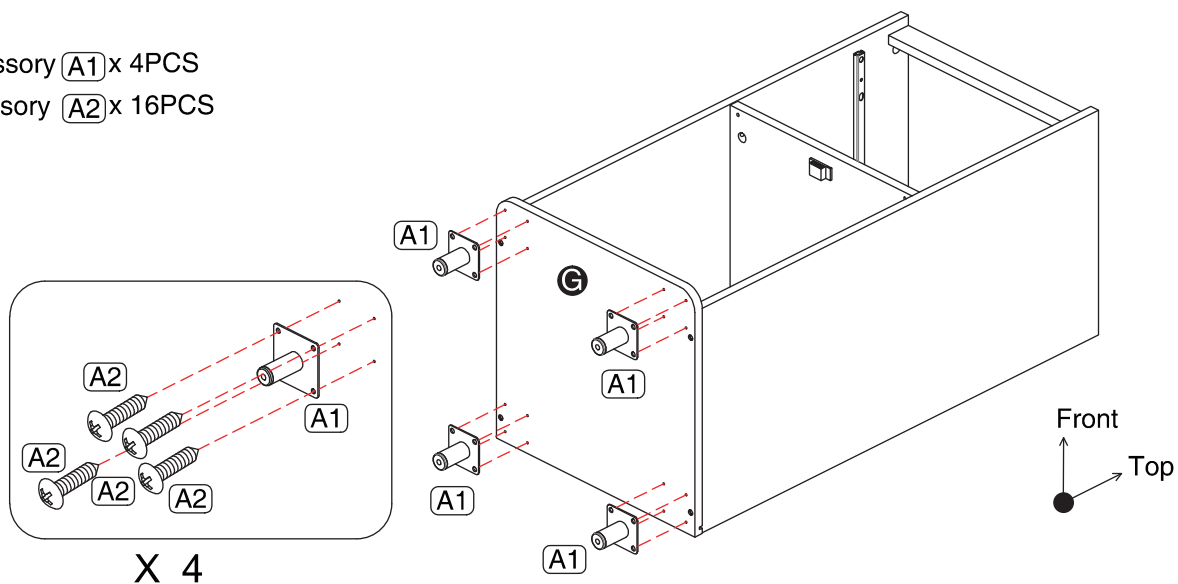

## 9

Accessory **A3** x 4PCS

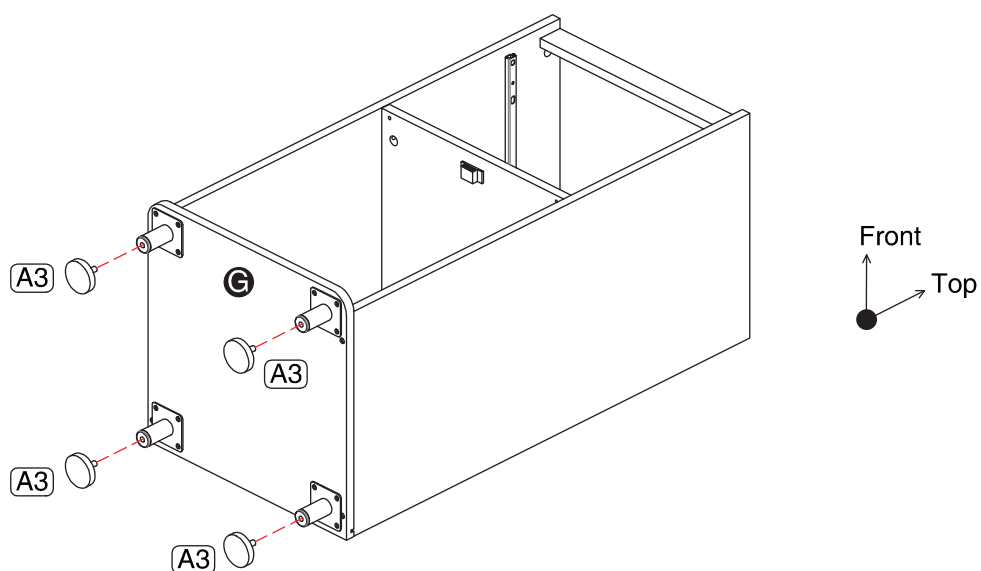

# ASSEMBLY INSTRUCTIONS

## 10

Part **E** x2PCS

Hardware **6** x 4PCS

Hardware **12** x 6PCS

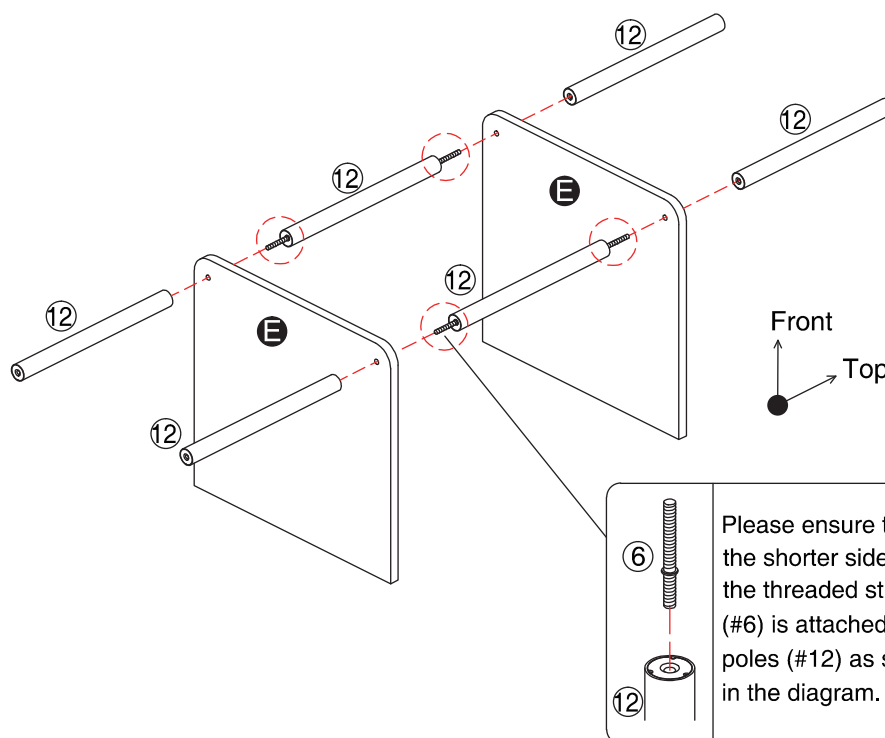

## 11

Part **F** x1PC

Hardware **4** x 4PCS

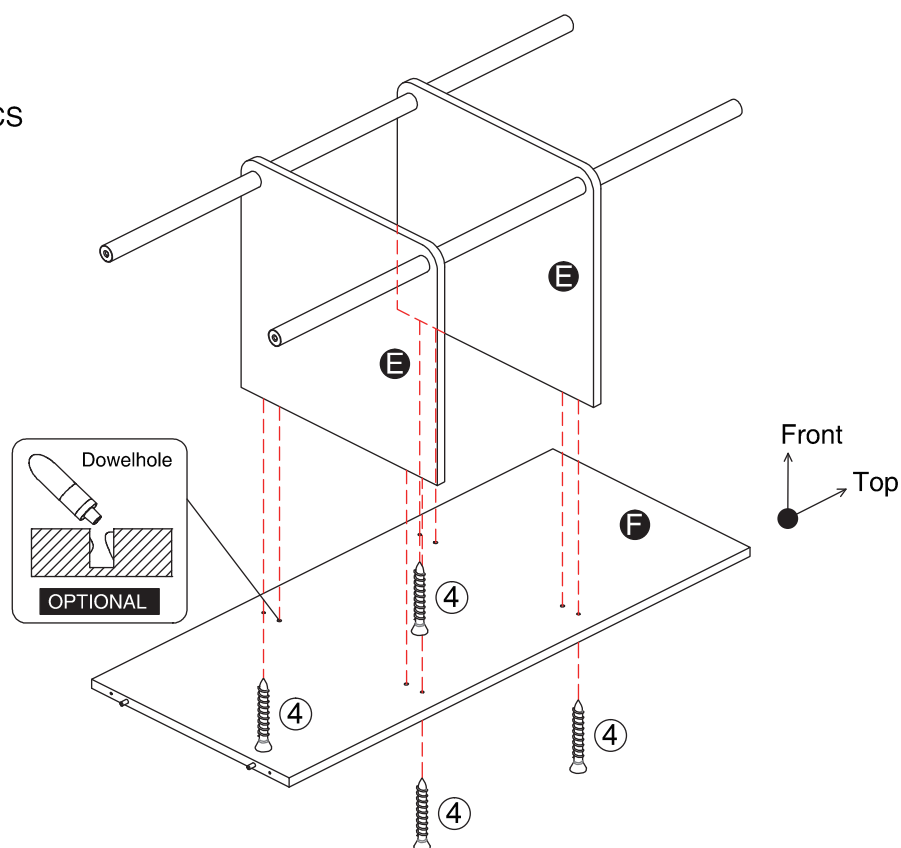

# ASSEMBLY INSTRUCTIONS

## 12

Part **A** x1PC

Part **D** x1PC

Hardware **④** x 4PCS

Hardware **⑤** x 4PCS

Accessory **A8** x 1PC

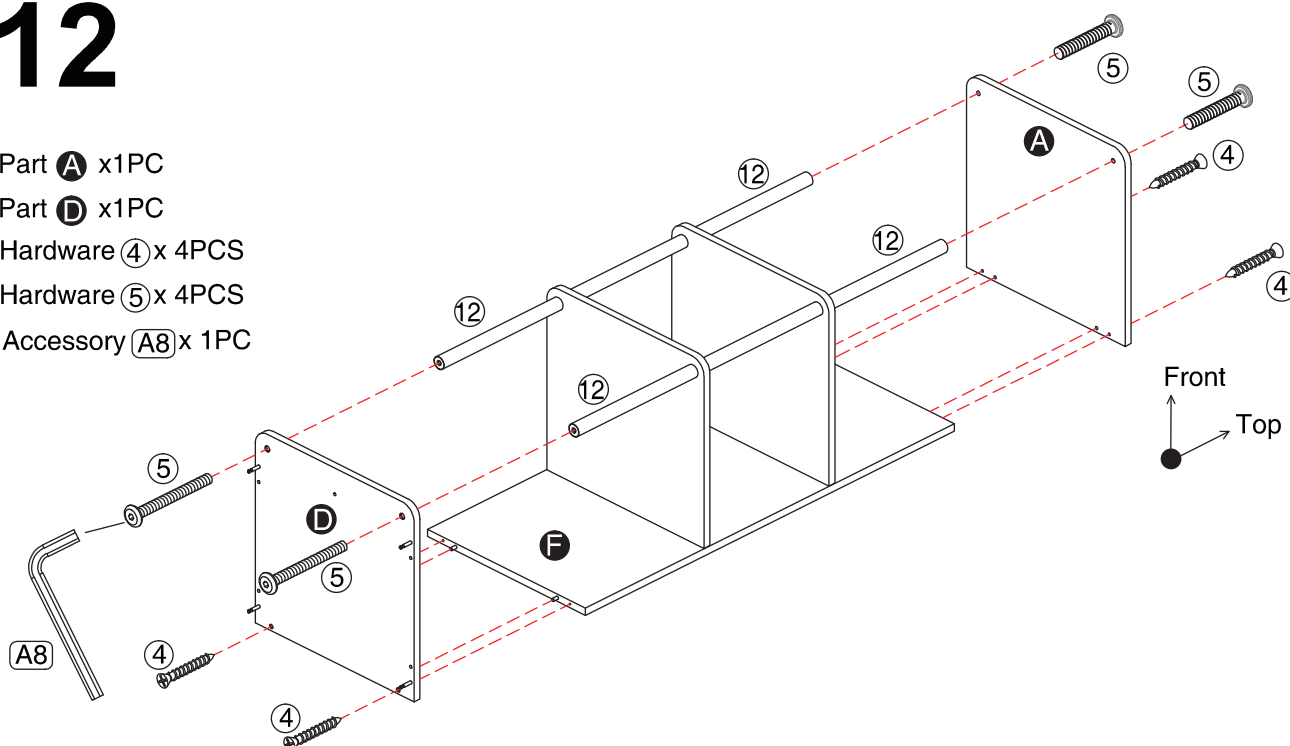

## 13

Hardware **②** x 4PCS

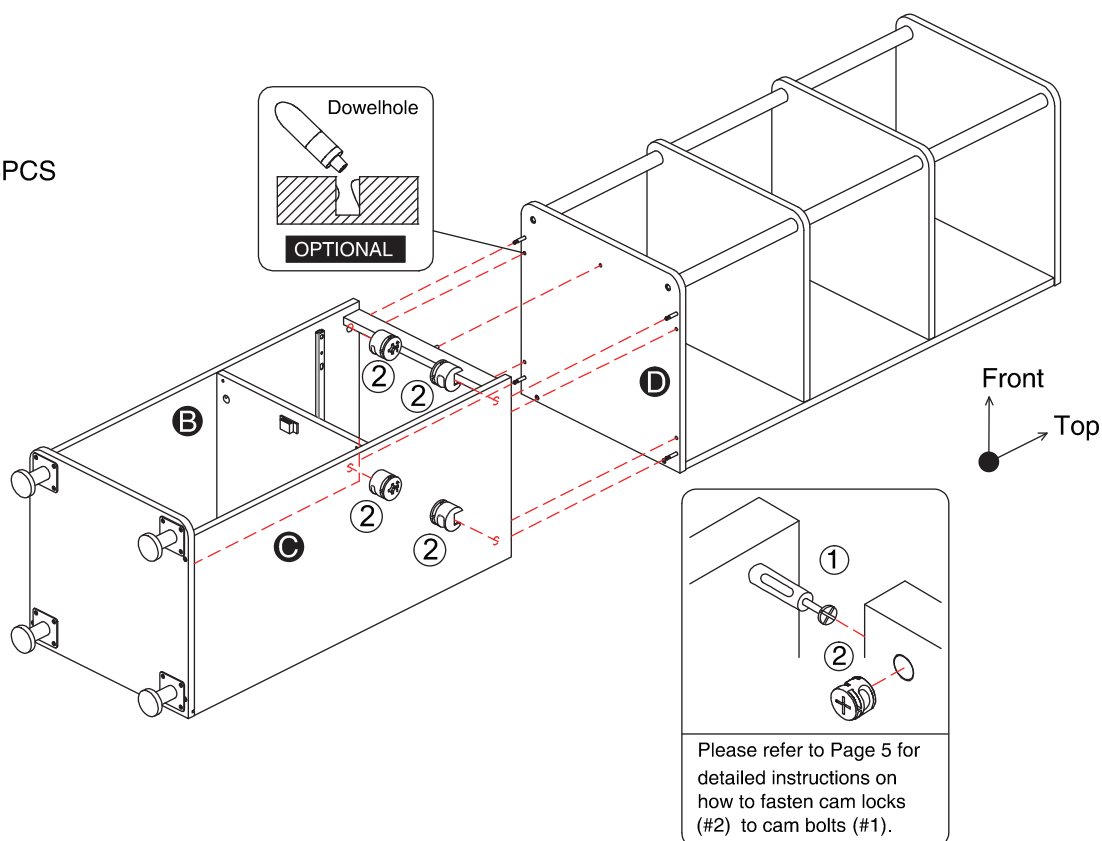

# ASSEMBLY INSTRUCTIONS

## 14

Accessory **A6** x 6 SETS

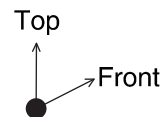
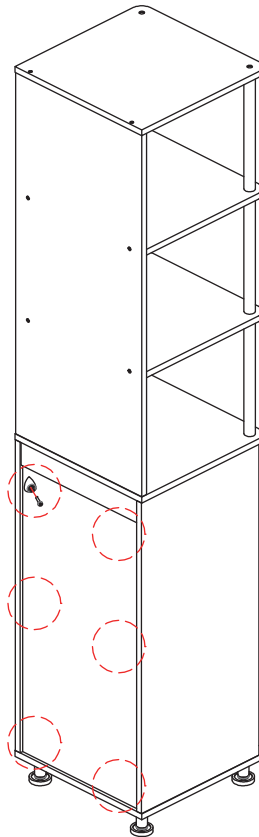
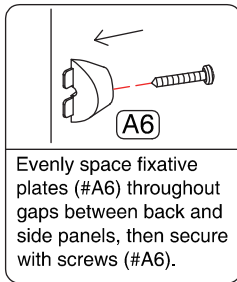

## 15

Accessory **A9** x 1PC

Accessory **A10** x 1PC

Accessory **A11** x 1PC

Accessory **A12** x 1PC

Accessory **A13** x 2PCS

Accessory **A14** x 1PC

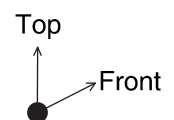
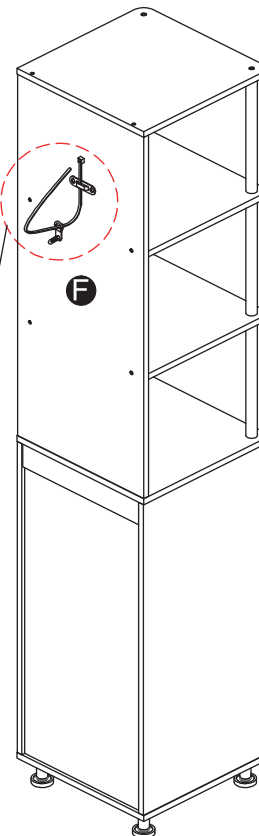
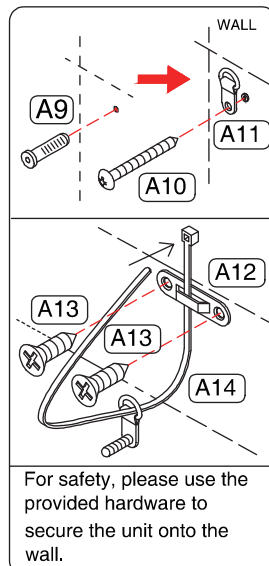

# ASSEMBLY INSTRUCTIONS

# 16

Hardware ⑪ x 2PCS

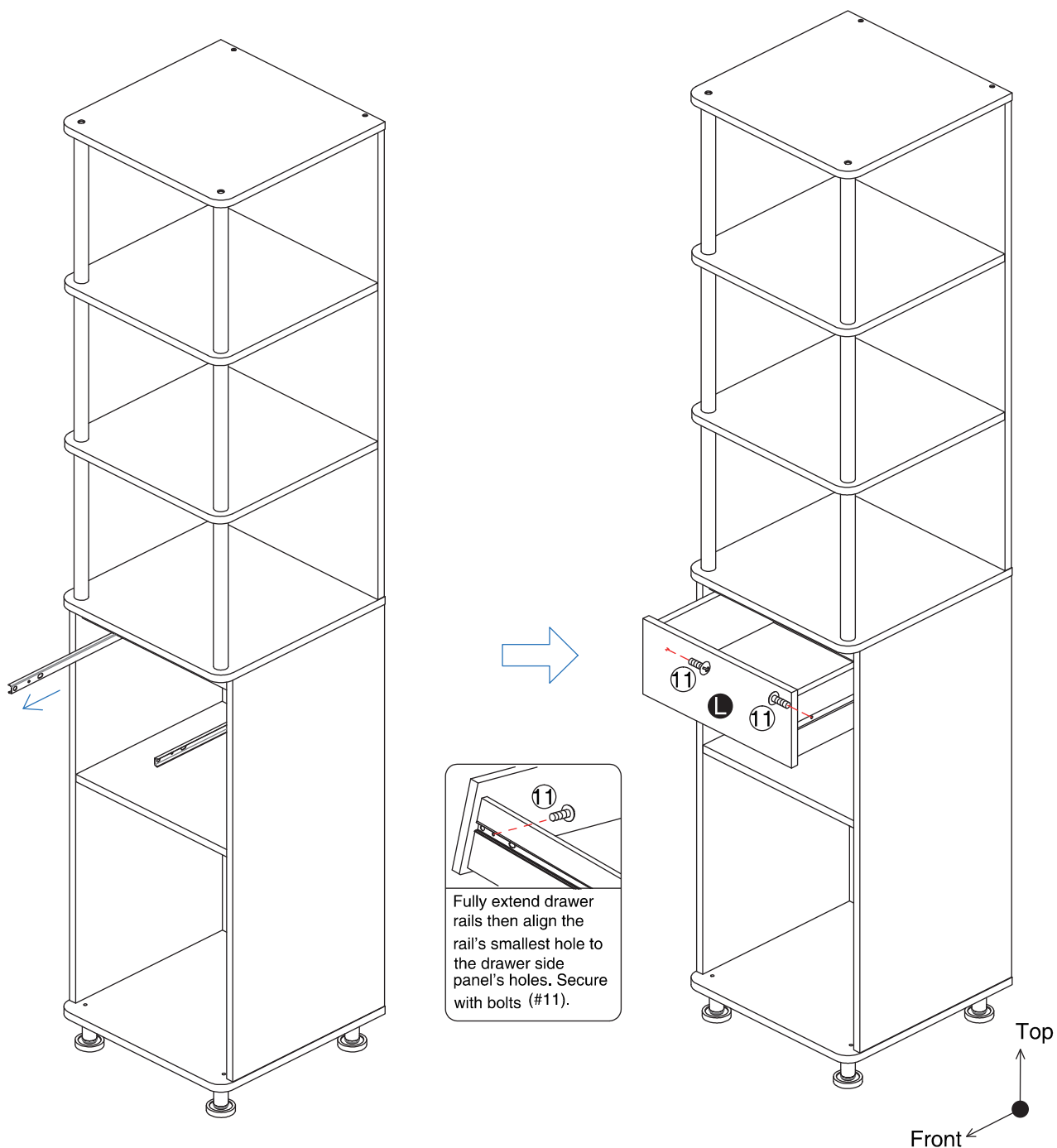

# ASSEMBLY INSTRUCTIONS

# 17

Hardware ⑧x 1PC

Optional: You can have the door open from the left side or the right side. Please ensure that once the doors are locked in place, you may not remove the door to fit it the other way around.

Left -open Door

Right -open Door

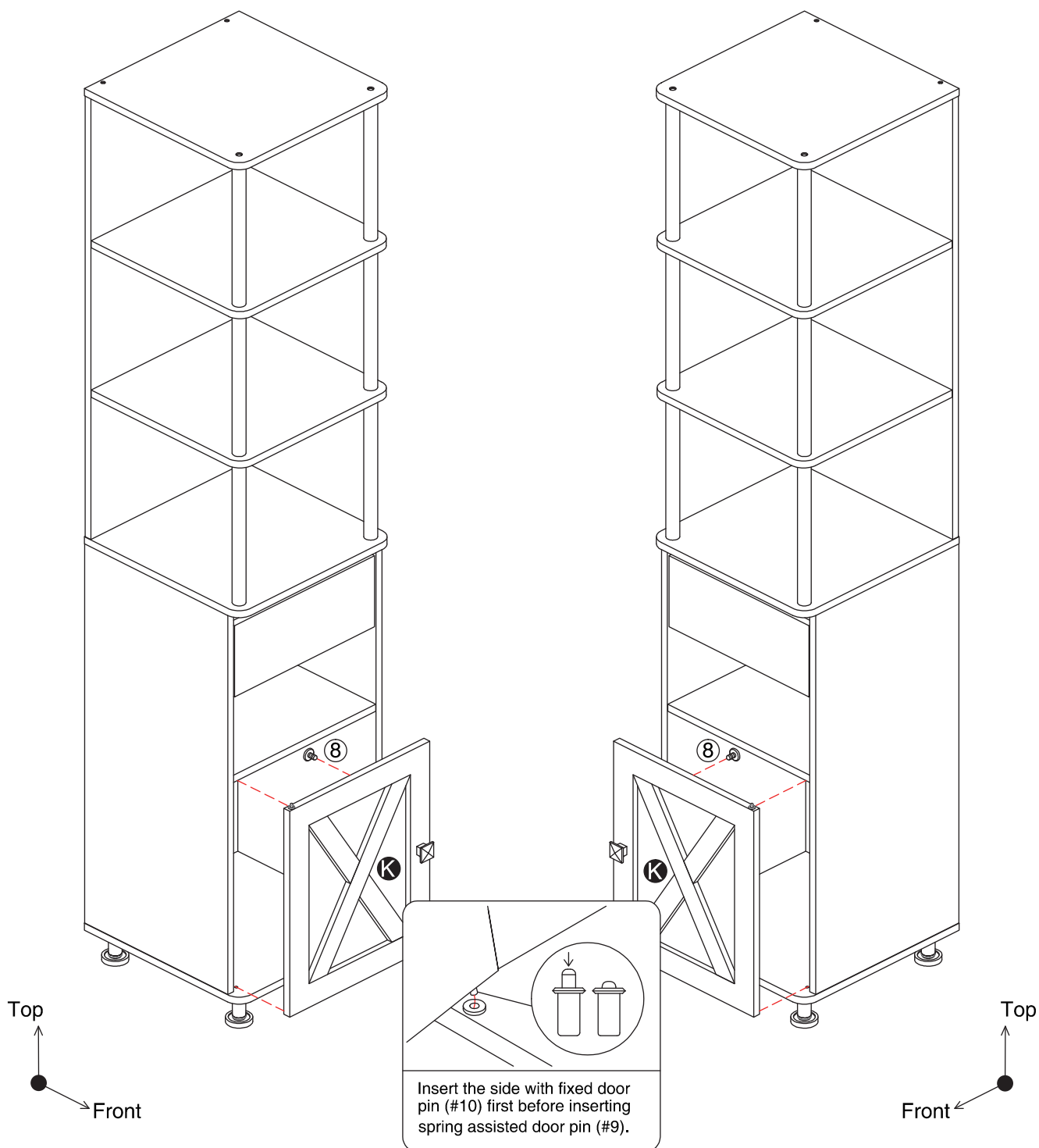

# ASSEMBLY INSTRUCTIONS

## 18

### ASSEMBLY COMPLETED



Please ensure the furniture rests on an even and flat surface. If the product wobbles or feels loose, double-check all bolts and/or screws are properly tightened and secured.



#### **Keep this handy!**

Please retain this instruction manual and any order-related information for future reference.



#### **Lift, don't drag!**

To avoid damage to product please always LIFT the product when transporting or adjusting the placement.

