

BUNKIE 9 x 10
9 Ft x 10 Ft
MODEL BKE910

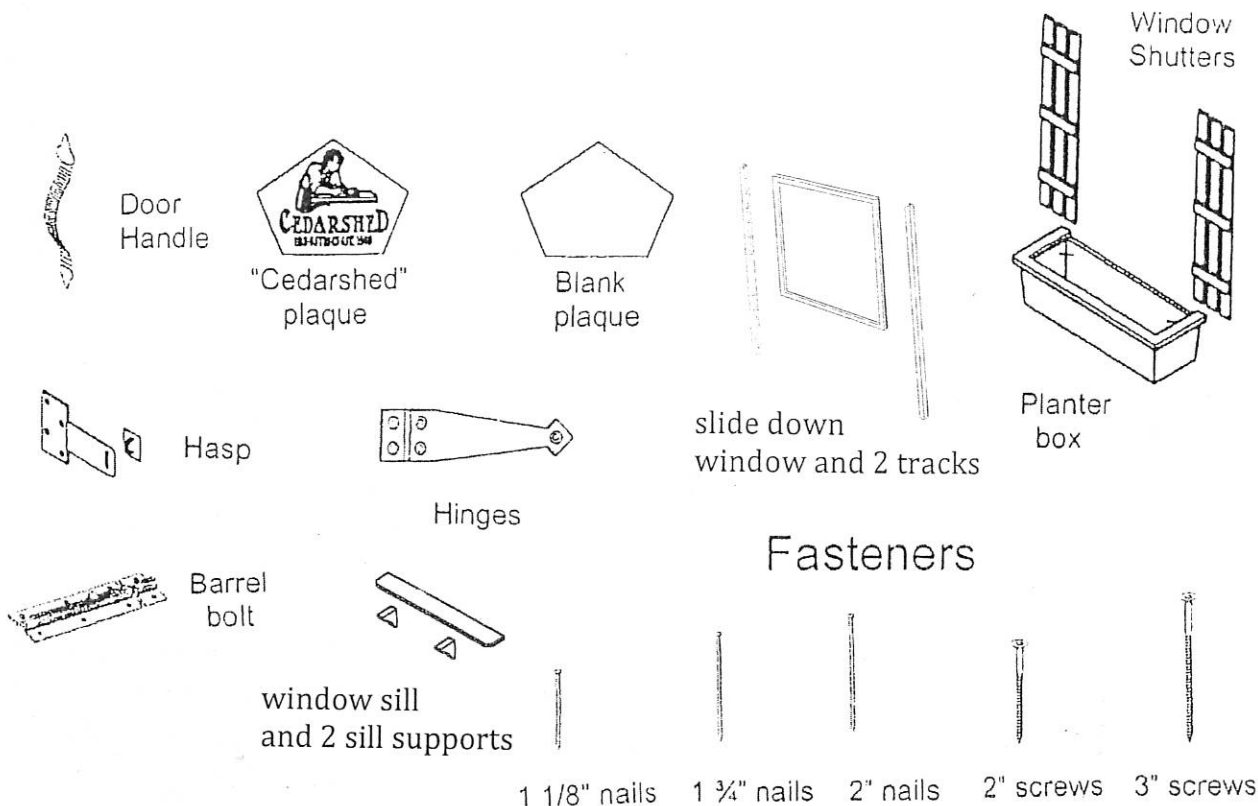

ACCESSORIES AND HARDWARE

BKE910



PART #	DESCRIPTION	DIMENSIONS (where app.)	# OF PCS
ACCESSORIES			
P-H-PLAQSL	square CS plaque	square CS plaque	1
P-H-PLAQNL	peak plaque	peak plaque	2
P-1640F	window sill	1 x 6 x 40 7/16	1
P-WSS-001	sill support	3 x 5	2
P-WIN-015	slide down window	34 1/4 x 26 1/2	1
P-2275C	sliding window track	2 x 2 x 75 1/4	2
P-H-RFLT12	roofing felt	1 ft x 5 ft	5 sq ft
P-H-MFLASS	roof flashing	3 x 12	26
FASTENERS			
P-H-NL1.125	nails	1 1/8" nails	25
P-H-NL1.75	nails	1 3/4" nails	300
P-H-NL2	nails	2" nails	40
P-H-SC2	2" screws	2" Screws	280
P-H-SC3	3" screw	3 " Screws	325
DOOR AND HARDWARE			
C-DR-001	double doors (incl. Hinges)	double doors	2
C-DR-008	single door	single door	1
P-1371C	door stop	1 x 3 x 71 1/4	1
P-1262G	door stop	1 x 2 x 62 1/2	1
P1271I	door stop	1 x 2 x 71 5/8	2
P-H-THING6	T-Hinges	6 " T-hinges	2
P-H-BBLT4	barrel bolt	4 " barrel bolt	4
P-H-DHAND	door handle	door handle	3
P-H-BHAND	window handle	window handle	1
P-H-HASP	hasp	hasp	2
Instruction manual, questionnaire and driver bit			

Ridge Porch Models

To build this model of shed, please use this Model Specific Instruction Manual along with the "ASSEMBLY INSTRUCTIONS FOR THE RIDGE PORCH OPTION, and the "STANDARD SHED INSTRUCTION MANUAL".

These three documents will give you all the information necessary to complete this project.

This manual outlines the specific parts needed to complete each stage, while the other manuals will give specific details on how to perform each stage. If you should have any questions please contact us at 1-800-830-8033 or sales@cedarshed.com.

DO NOT CUT any parts until you check with a CedarShed support team member.

For this model the stages of construction are as follows:

1. JOIST BOX ASSEMBLY
2. JOIST STRUCTURE ASSEMBLY
3. LEVELING OF JOIST STRUCTURE
4. INSTALLATION OF PLYWOOD FLOORING AND DECK BOARDS
5. STAGE 1 - WALL INSTALLATION
6. STAGE 1 - TRIM INSTALLATION
7. STAGE 2 - WALL INSTALLATION
8. TOP PLATE INSTALLATION
9. STAGE 1 - ROOF INSTALLATION
10. STAGE 2 - ROOF INSTALLATION
11. STAGE 2 - TRIM INSTALLATION
12. STAGE 3 - TRIM INSTALLATION
13. FINISHING TOUCHES

BEARING POINTS FOR 910

AND BUILDING THE FLOOR JOIST BOXES

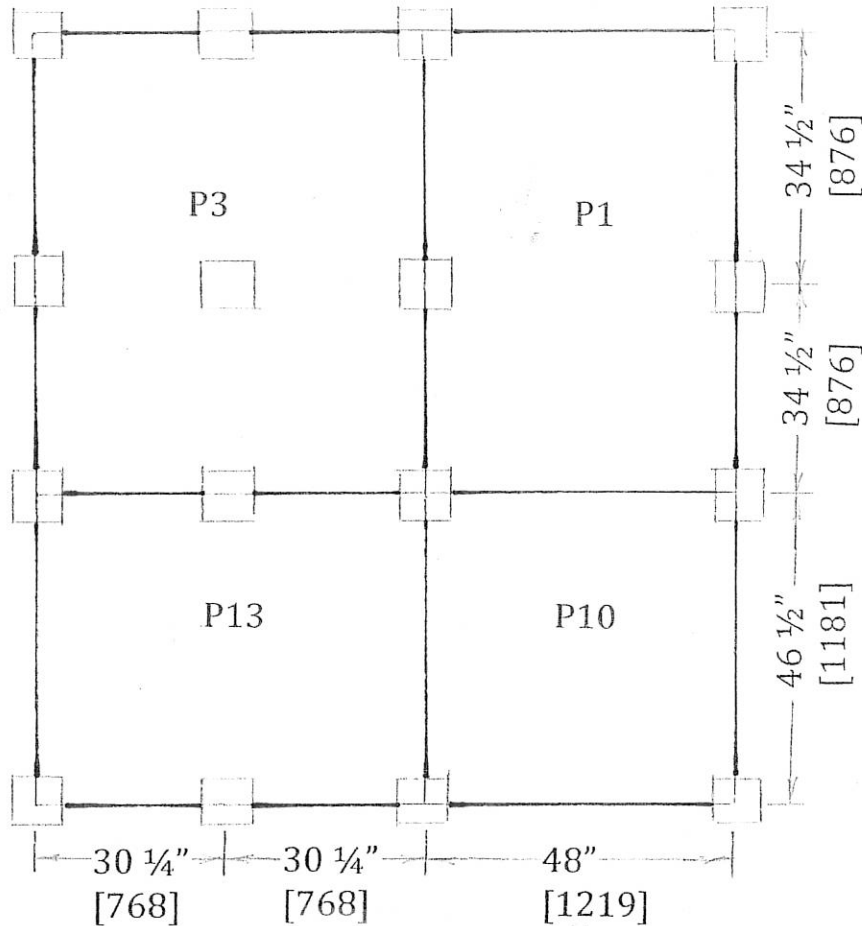

RIDGE PORCH SIDE

Each bearing point represents a spot where the joist boxes intersect each other. Using a cement block at each of these points, level the joist structure once the joist boxes have been affixed together. Use the diagram above to plot the bearing points on your building site. Please note these are the minimum number of bearing points and you may wish to use additional cements blocks as need would justify.

FLOOR JOIST PARTS

PART #	DESCRIPTION	DIMENSIONS (where app.)	# OF PCS
FLOOR PARTS			
P-2445	floor joist	2 x 4 x 45	10
P-2446G	rim joist	2 x 4 x 46 1/2	4
P-2457G	rim joist	2 x 4 x 57 1/2	10
P-2469	rim joist	2 x 4 x 69	4

BUILDING JOIST BOXES

By using the joists parts outlined above and the instructions in the next few pages, assemble the joist boxes accordingly. There are various sizes of joist boxes that make up the joist structure. The number of each joist box is outlined in the table below.

JOIST BOXES REQUIRED FOR THIS MODEL		
JOIST BOX #	Joist Box Size	# of Boxes Req'd
P1	69" x 48"	1
P3	69" x 60 1/2"	1
P10	46 1/2" x 48	1
P13	46 1/2" x 60 1/2"	1

JOIST BOX ASSEMBLY

Lay the joist parts out as per Fig P1 - 1. Using 2 - 3" screws per joint, assemble the joist box together as per Fig P1 - 2. The completed joist box is pictured in Fig P1 - 3.

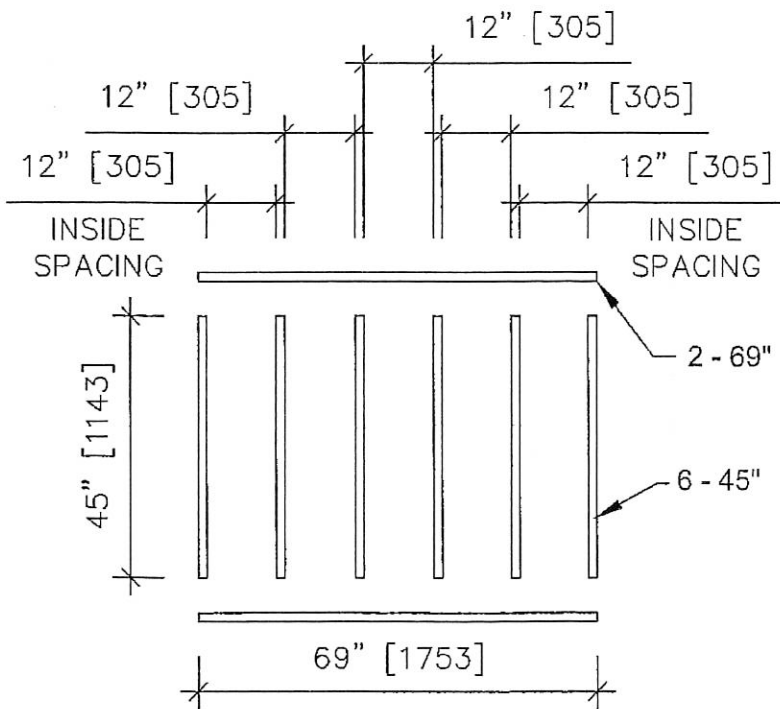

69" x 45" floor panel layout.

Fig. P1 - 1

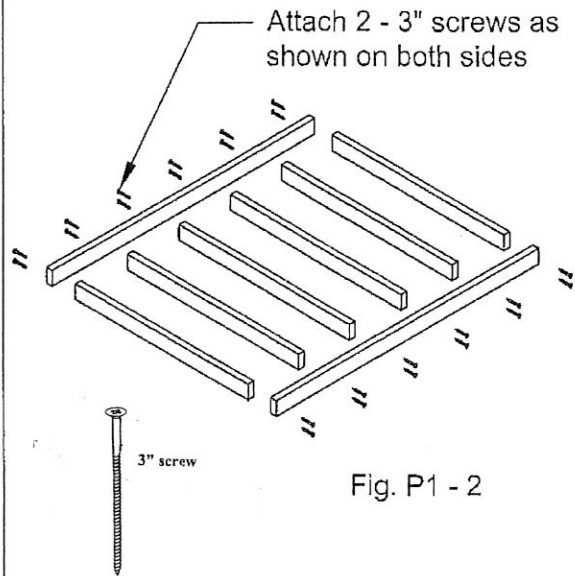

Completed floor panel

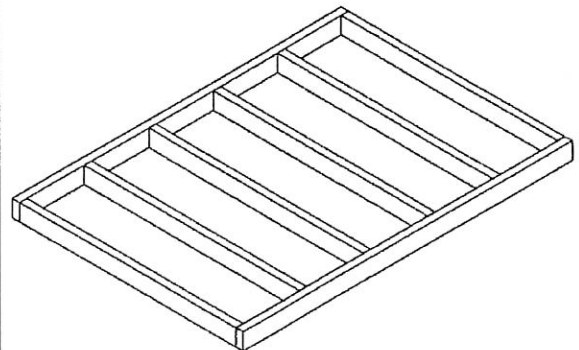
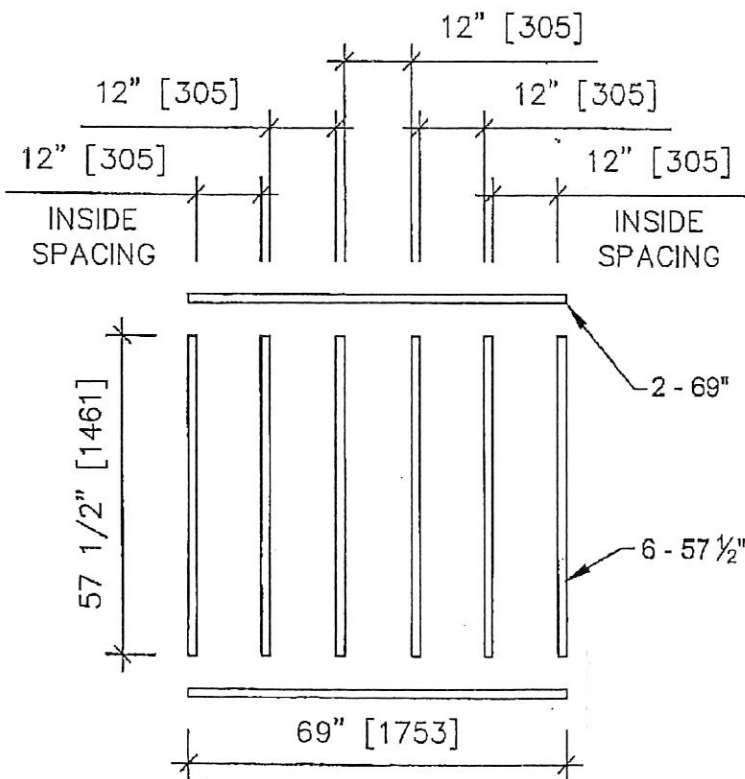

Fig. P1-3

JOIST BOX ASSEMBLY

Lay the joist parts out as per Fig P3 - 1. Using 2 - 3" screws per joint, assemble the joist box together as per Fig P3 - 2. The completed joist box is pictured in Fig P3 - 3.



69" x 60 1/2" floor panel layout.

Fig. P3 - 1

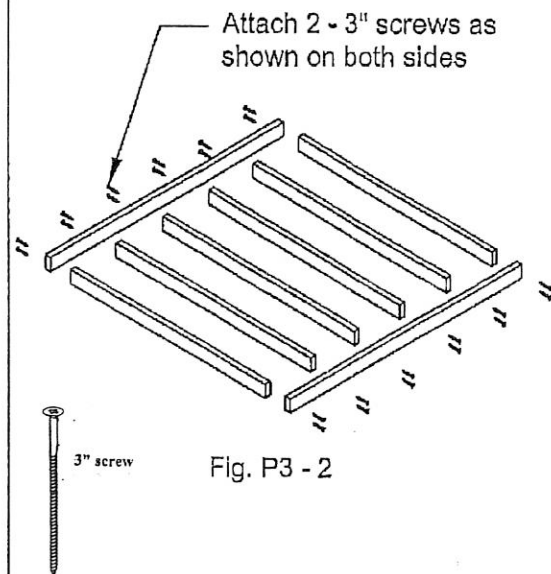

Fig. P3 - 2

Completed floor panel

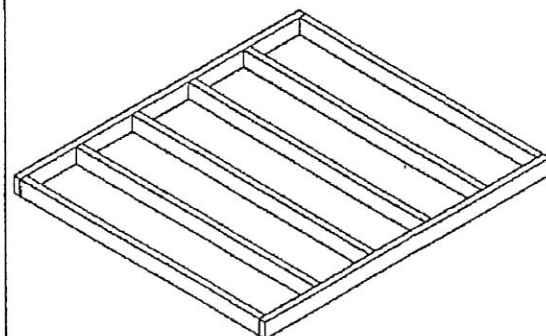
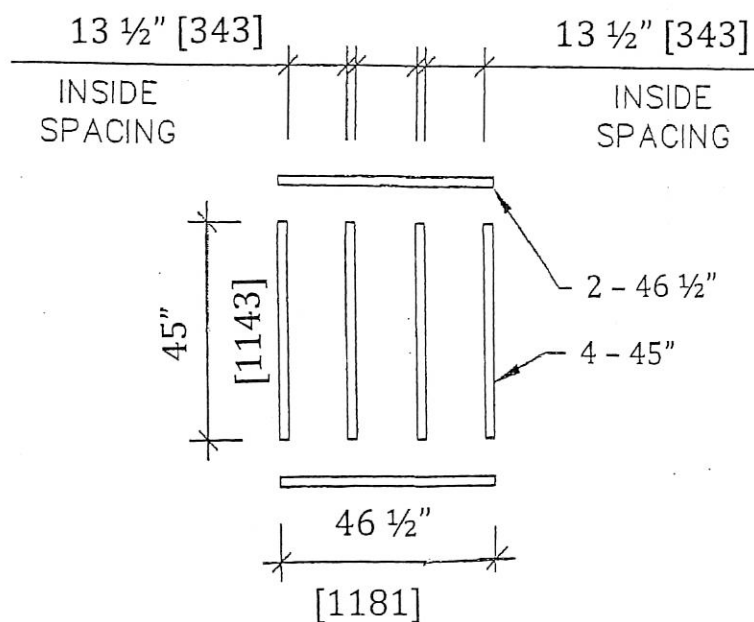

Fig. P3 - 3

JOIST BOX ASSEMBLY

Lay the joist parts out as per Fig. P10-1. Using 2- 3" screws per joint, assemble the joist box together as per Fig P10-2. The completed joist box is pictured in Fig. P10-3.



46 1/2" x 48" joist box layout

Fig P10-1

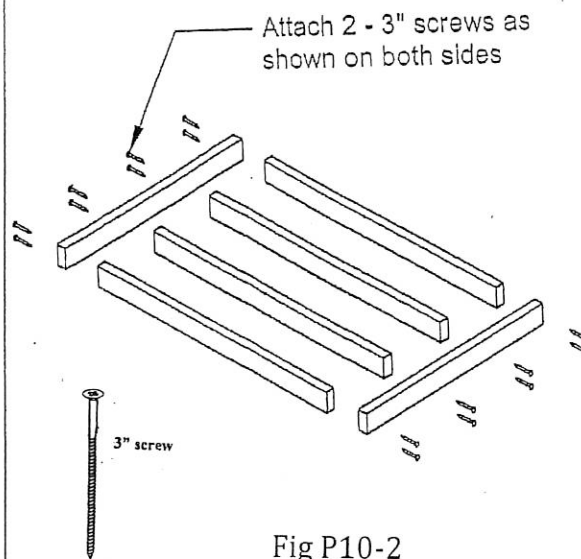

Fig P10-2

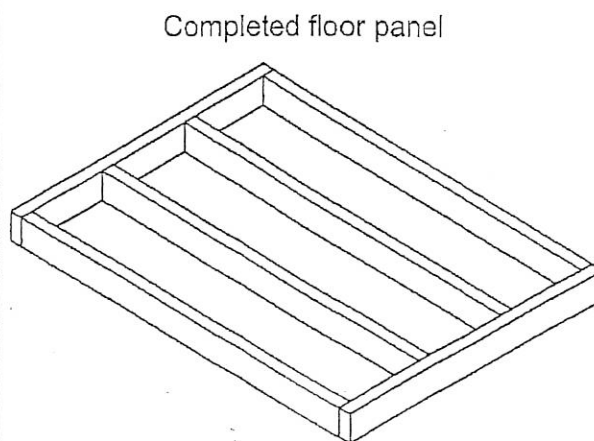
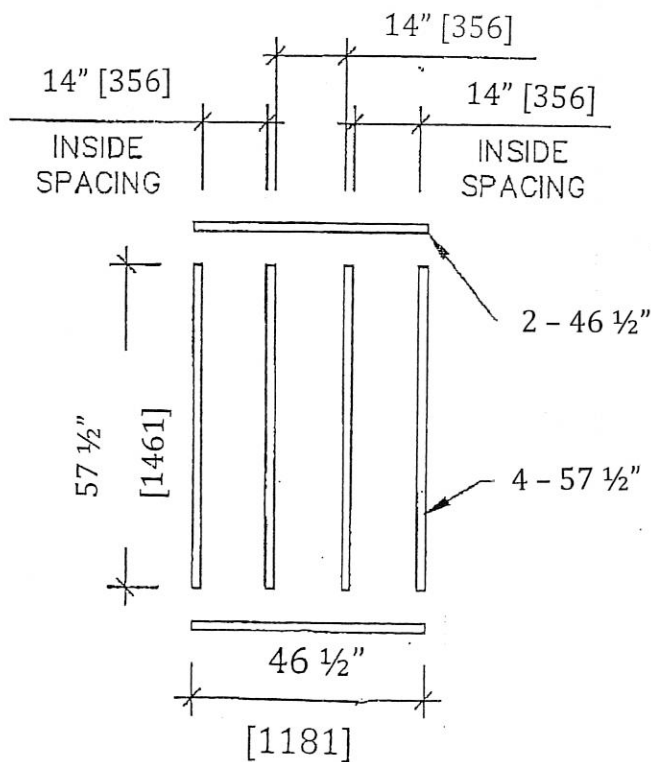

Fig P10-3

JOIST BOX ASSEMBLY

Lay the joist parts out as per Fig. P13-1. Using 2- 3" screws per joint, assemble the joist box together as per Fig P13-2. The completed joist box is pictured in Fig. P13-3.



46 1/2" x 60 1/2" joist box layout

Fig P13-1

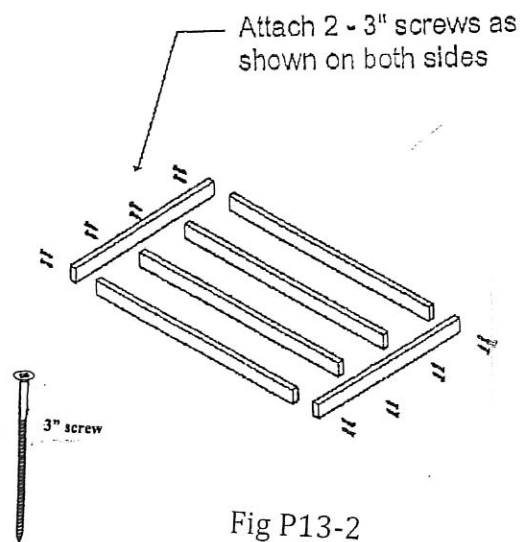

Fig P13-2

Completed floor panel

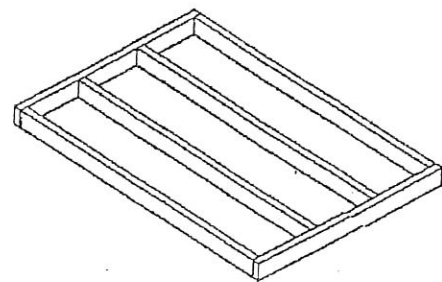
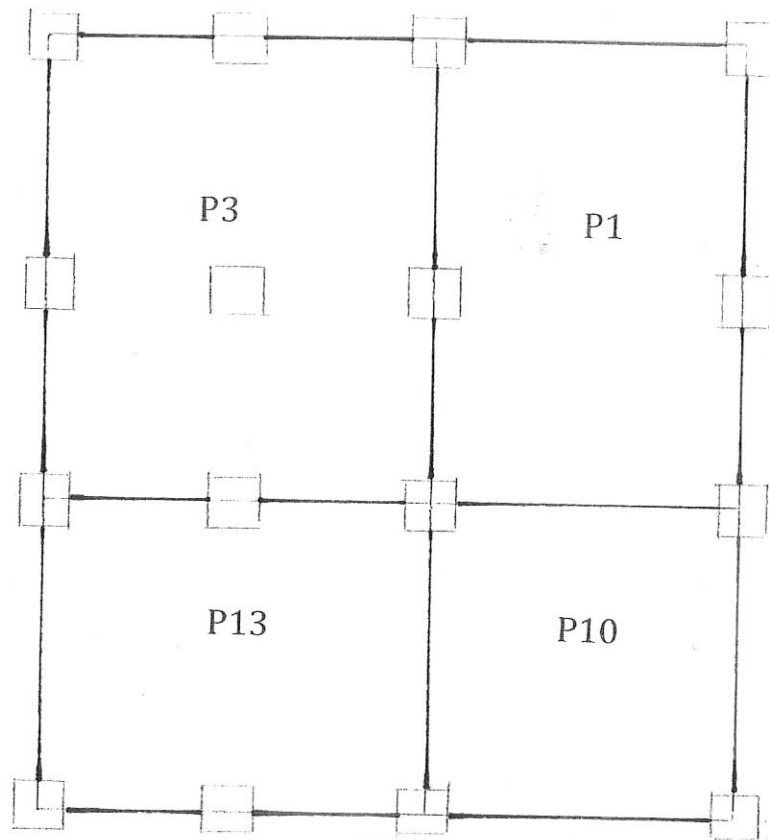

Fig P13-3



RIDGE PORCH SIDE

COMPLETING THE FLOOR JOIST STRUCTURE

Take the joist boxes and affix them as per the diagram above by using 3" screws every 12". Once complete, lay the joist structure on top of the building site and level the joist structure on top of the cements blocks. Please use the cedar packaging materials to assist in the levelling process. Make sure when level the joist structure clears the ground. This will allow the proper air circulation to prevent dry rot from occurring on the joist members. Also make sure the joist structure does not make soil contact as this will promote premature deterioration of the wood.

INSTALLATION OF PLYWOOD FLOORING AND RIDGE PORCH DECKING

The next few pages outline the steps to install the plywood flooring and the deck boards.

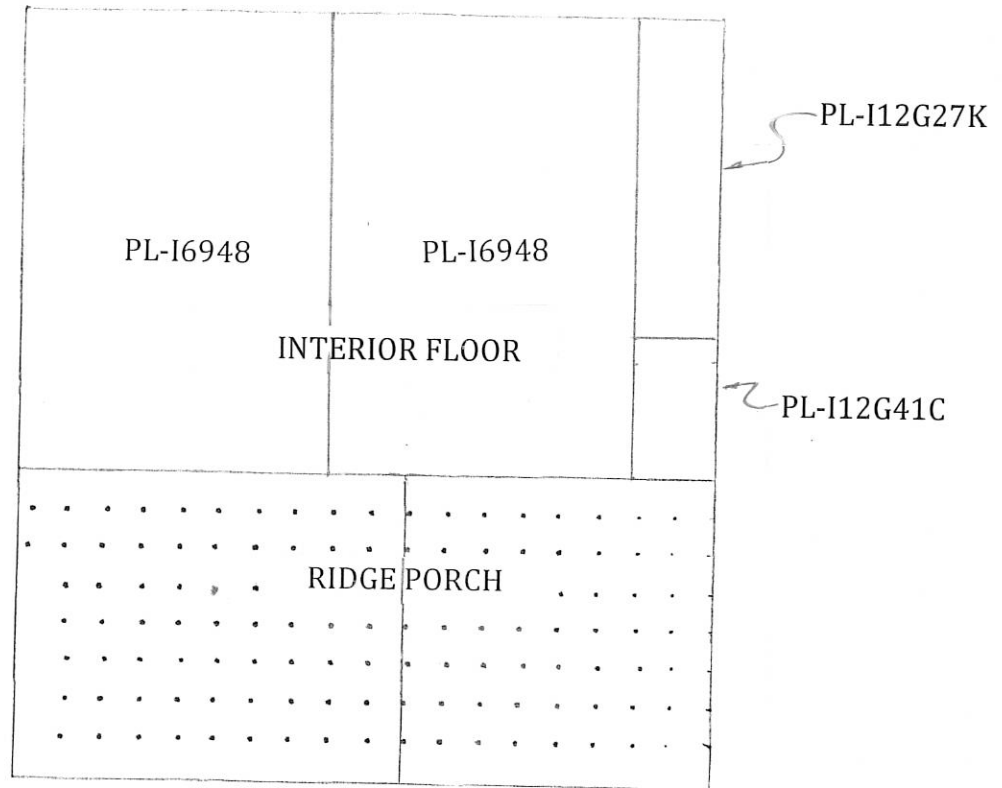

PART #	DESCRIPTION	DIMENSIONS (where app.)	# OF PCS
FLOOR PLYWOOD AND DECK BOARD PARTS			
P-PL-I6948	plywood	5/8 x 69 x 48	2
P-PL-I12G41C	plywood	5/8 x 12 1/2 x 41 1/4	1
P-PL-I12G27K	floor board	8/8 x 12 1/2 x 12 3/4	1
P-1446G	floor board	1 x 4 x 46 1/2	30

INSTALLATION OF PLYWOOD FLOORING & ADDITIONAL JOIST FOR GABLE PORCH SECTIONS

Now lay the plywood sheets over top of the joist frame. Each sheet of plywood (based on size) will lay over top of the various floor boxes that have been built and attached together. Then by using the 2" screws provided, affix each sheet using a screw every 12" on centre on each of the joist members (rows). As an example, to affix a 69" by 48" sheet to the joist frame would require 30 screws (6 joist members by 5 screws per row. See Fig 3 for details

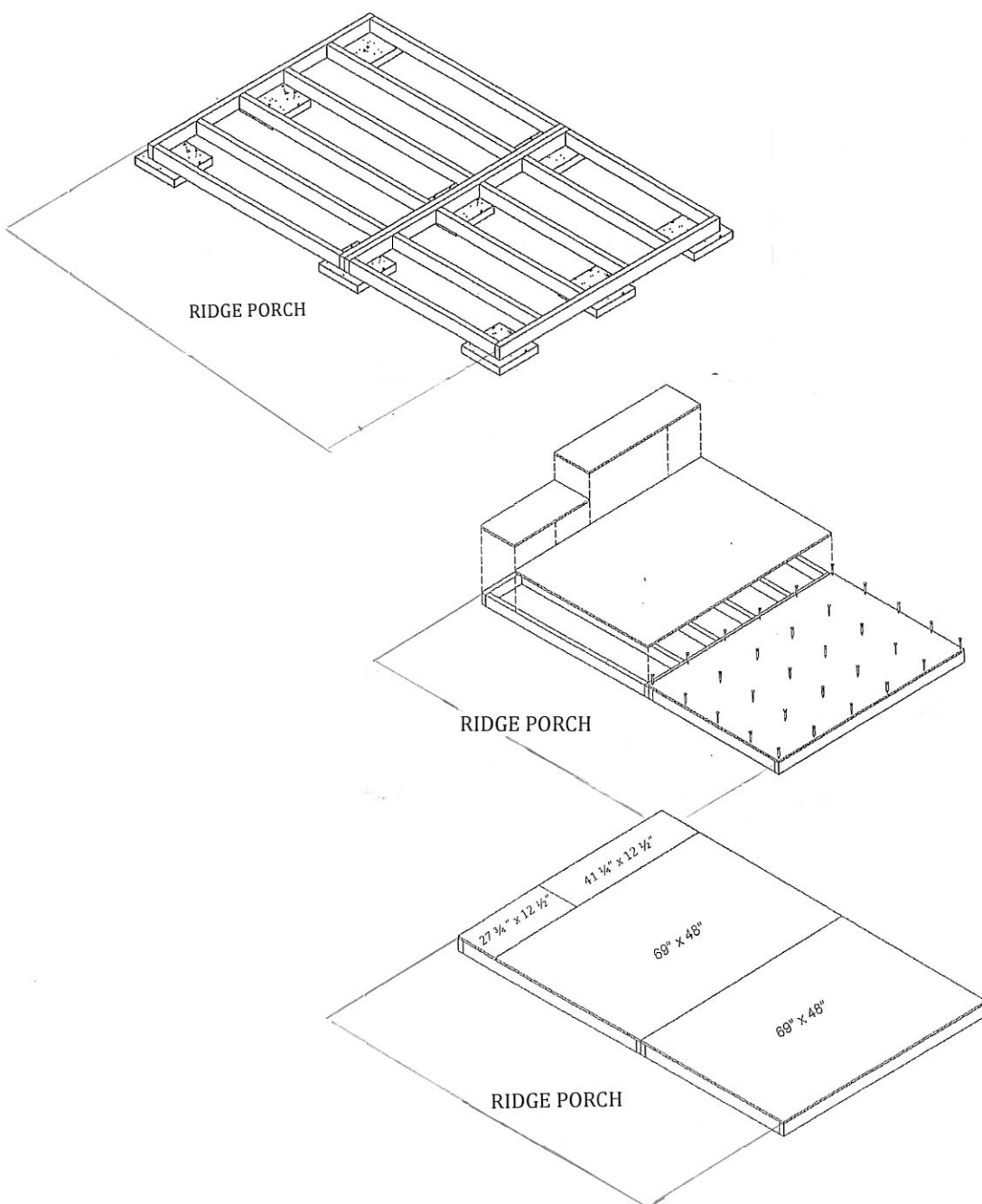
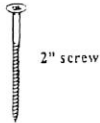
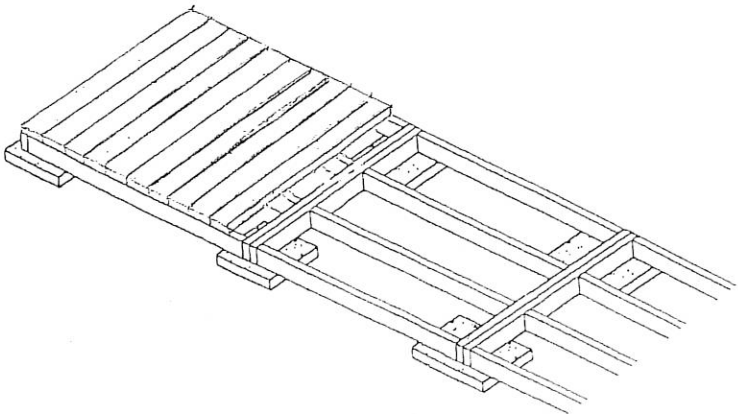
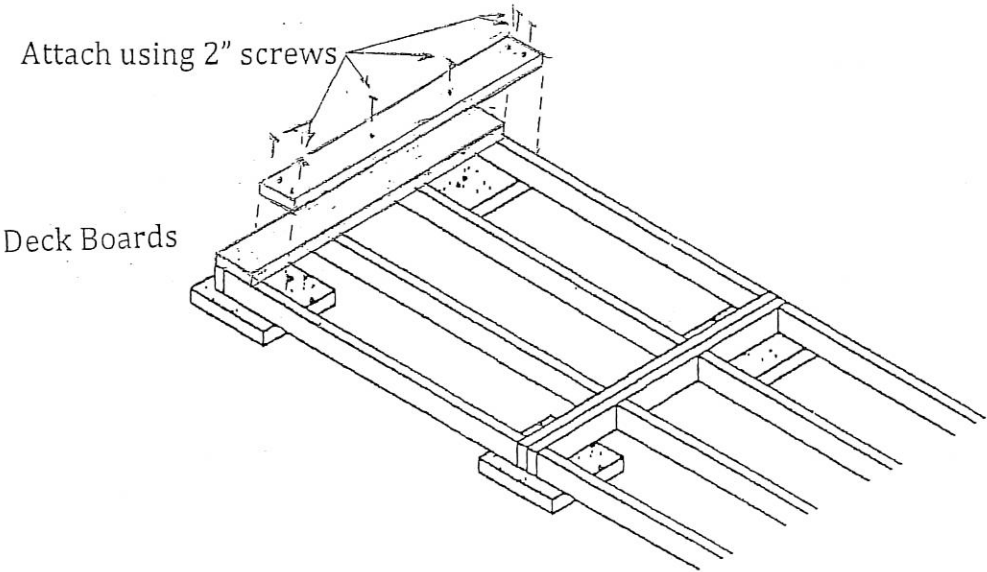
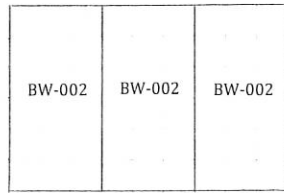

Fig 3.

Lay the 46 1/2" long deck boards over top of the level floor joist structure. Use 2- 2" screws to attach the ends of each board and 1-2" screw to affix to the interior joist. The number of deck boards will vary based on the width of each board.

Size of deck	No of boards in 2 1/2" width	No. of boards in 3 1/2" width
9x4	44	31
12x4 (6)	57	41
12x4 (8)	57	41
16x4	76	54
20x4	95	67





WALL C

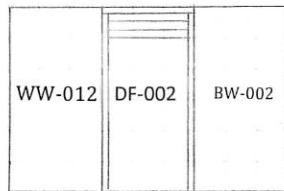
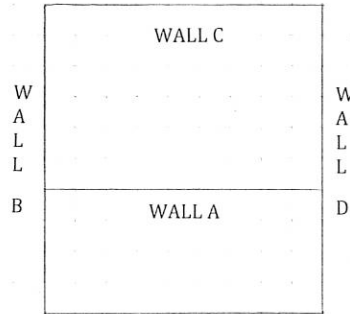

WALL A

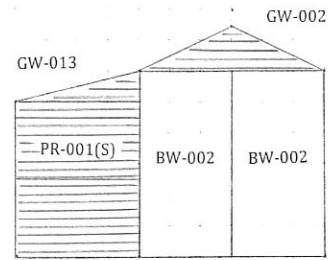

WALL D

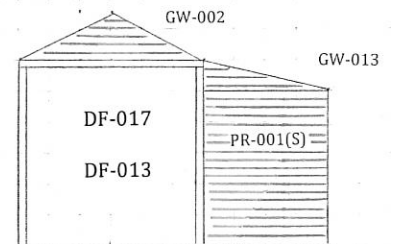

WALL B

SHADED PANELS WILL BE INSTALLED
IN WALL INSTALLATION - STAGE 2

WALL INSTALLATION - STAGE 1

PART #	DESCRIPTION	DIMENSIONS (where app.)	# OF PCS	CODE
P-2334G	header	2 x 3 x 34 1/2	6	not shown
C-BW-002	wall panel	34 1/2" wall panel	6	BW-002
C-DF-002	door frame (single door)	door frame for 5 ft door	1	DF-002
C-DF-013	door frame (vertical)	door frame	2	DF-013
C-DF-017	door frame (horizontal)	door frame	1	DF-017
C-WW-012	slide down window wall	34 1/2" window wall	1	WW-012

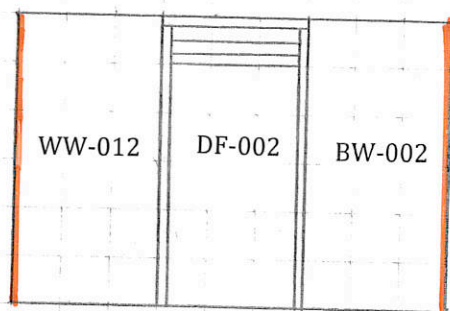

WALL A

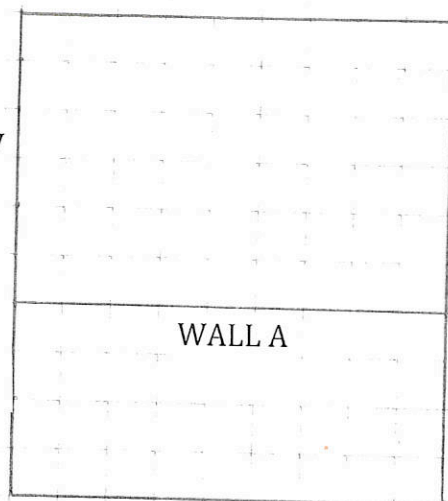
W
A
L
L
B

WALL A

WALL E

W
A
L
L
D**TRIM INSTALLATION - STAGE 1**

PART #	DESCRIPTION	DIMENSIONS (where app.)	# OF PCS	CODE
P-13C75C	corner trim	1 x 3 1/4 x 75 1/4	2	

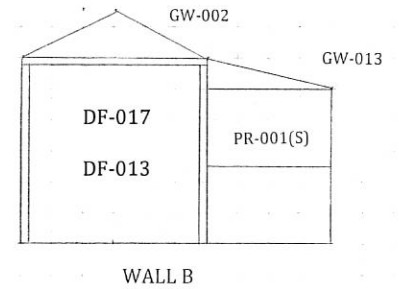
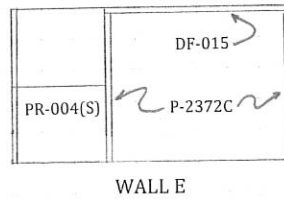
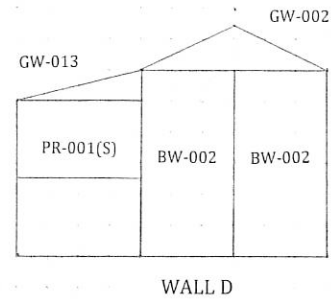
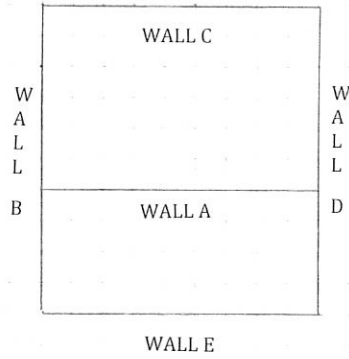

STAGE 2 - WALL INSTALLATION

PART #	DESCRIPTION	DIMENSIONS (where app.)	# OF PCS	CODE
C-PR-001(S)	porch section	45 3/4 x 62	2	PR-001(S)
C-PR-004(S)	porch section	33 3/4 x 62	1	PR-004(S)
P-2372C	door post	2 x 3 x 62	2	P-2372C
C-DF-015	horizontal door frame	2 1/2 x 69 3/4	1	DF-015

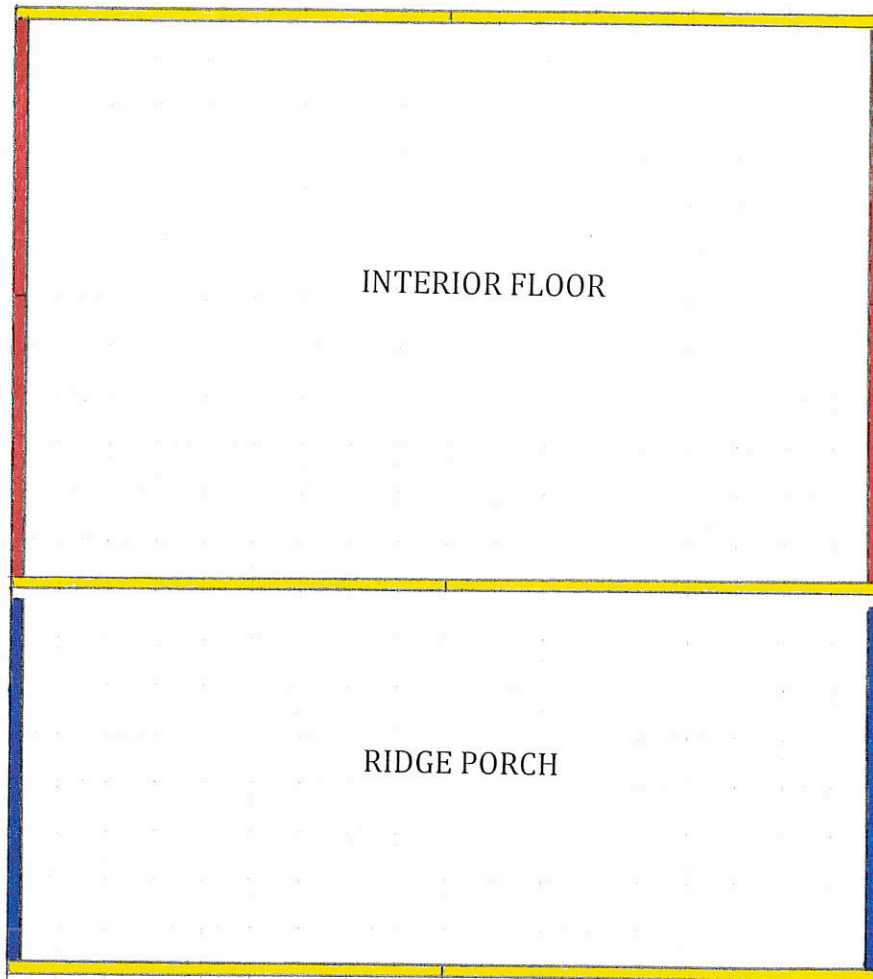

TOP PLATE INSTALLATION

PART #	DESCRIPTION	DIMENSIONS (where app.)	# OF PCS	CODE
TOP PLATES				
P-2343C	top plates	2 x 3 x 43 1/4	2	
P-2357C	top plate	2 x 3 x 54 1/4	6	
P-2364	top plate	2 x 3 x 64	2	

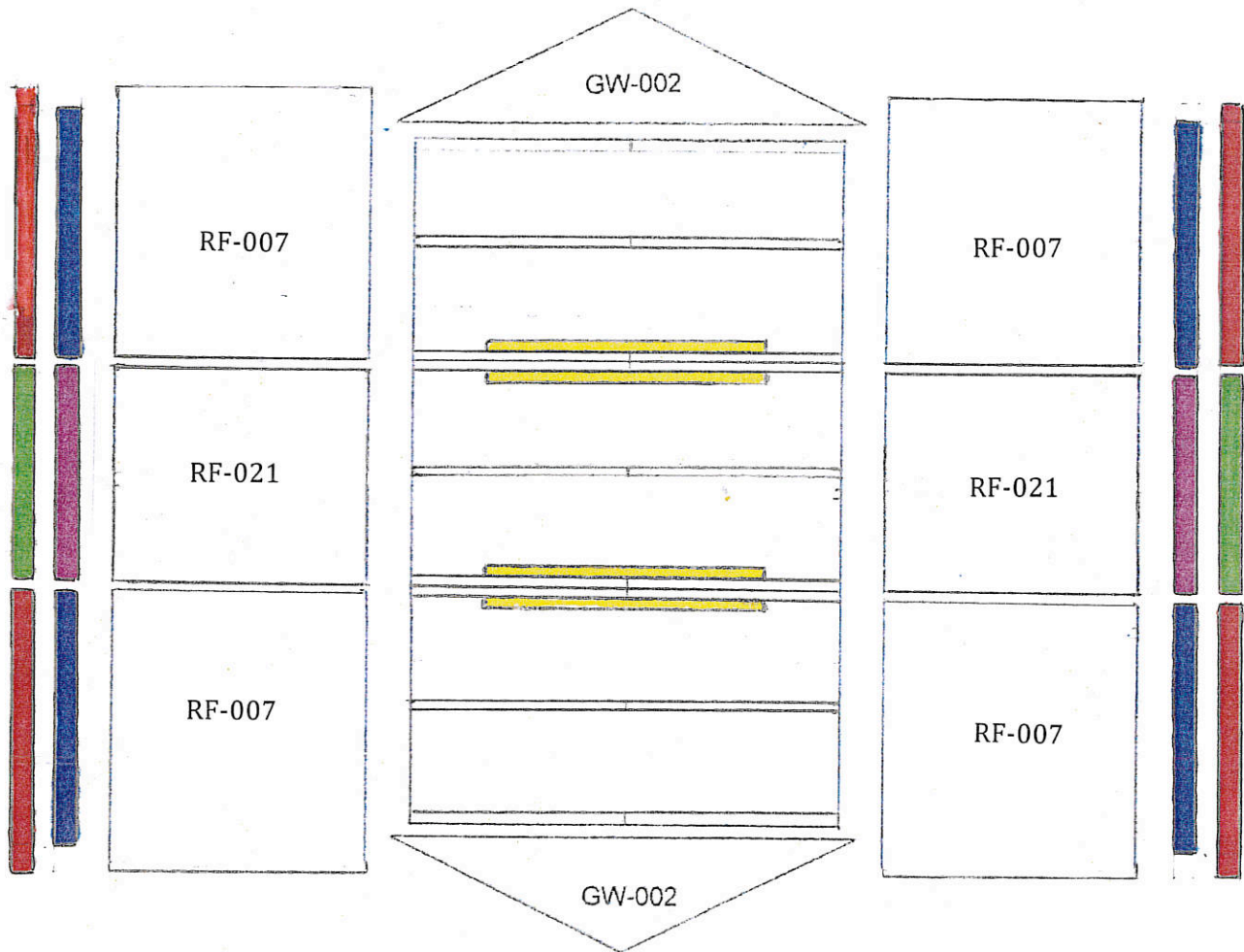

Gusset Details

**ROOF INSTALLATION - STAGE 1**

PART #	DESCRIPTION	DIMENSIONS (where app.)	# OF PCS	CODE
ROOF PARTS				
P-2342Yb	gusset	2 x 3 x 42	4	
C-GW-002	gable wall	gable walls	2	GW-002
P-RF-007	wood roof panel	42 x 42 3/4	4	RF-007
P-RF-021	wood roof panel	42 x 34 1/2	2	RF-021
P-B-G437	soffit	1/2 x 4 x 37	4	
P-B-G434G	soffit	1/2 x 4 x 34 1/2	2	
P-1434G	fascia	1 x 4 x 34 1/2	2	
P-1442	fascia	1 x 4 x 42	4	
P-H-RCAP24	ridge caps	24 "	16	not shown

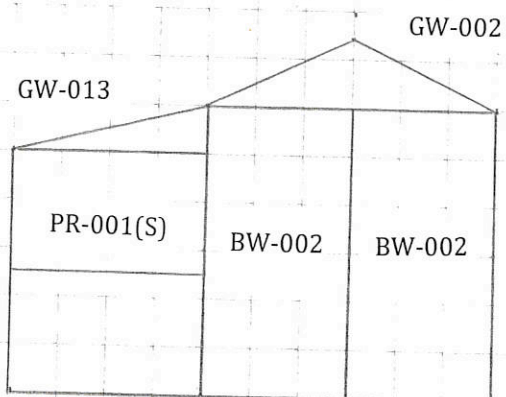

WALL D

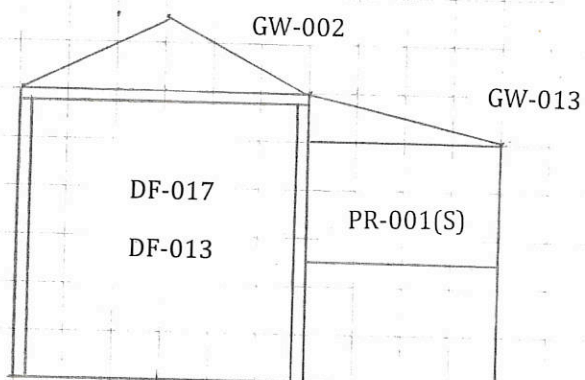
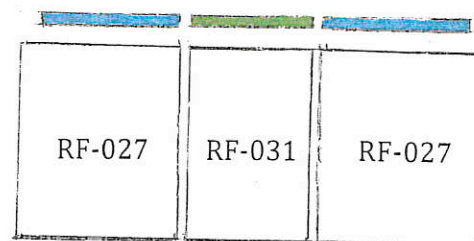

WALL B

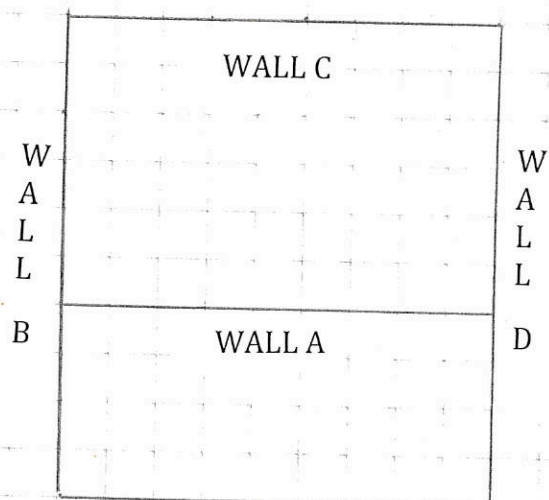

WALL E

ROOF INSTALLATION - STAGE 2

PART #	DESCRIPTION	DIMENSIONS (where app.)	# OF PCS	CODE
C-GW-013	gable wall	11 1/2 x 47	2	GW-013
C-RF-027	roof panel	42 3/4 x 47	2	RF-027
C-RF-031	roof panel	34 1/2 x 47	1	RF-031
P-1442	fascia	1 x 4 x 42	2	
P-1434G	fascia	1 x 4 x 34 1/2	1	

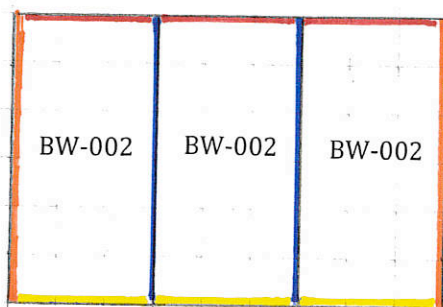

WALL C

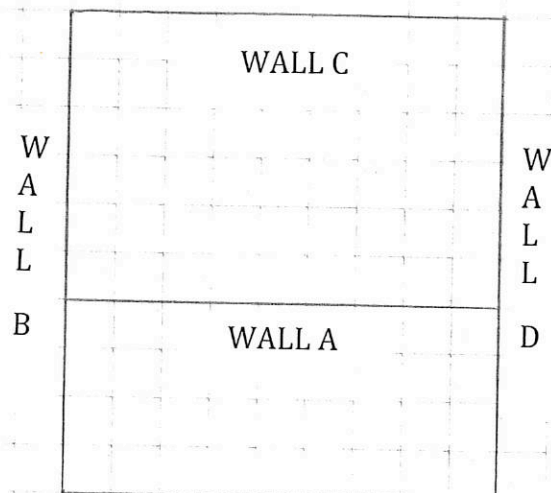

WALL E

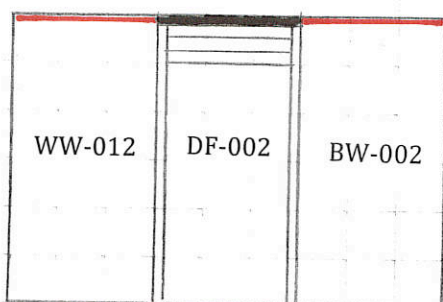

WALL A

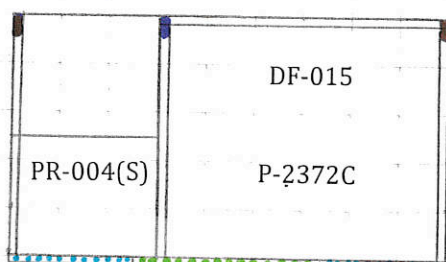

WALL E

TRIM INSTALLATION - STAGE 2

PART #	DESCRIPTION	DIMENSIONS (where app.)	# OF PCS	CODE
P-1312XF	trim	1 x 3 x 12	1	
P-1412XF	trim	1 x 4 x 12	2	
P-13C79C	corner trim	1 x 3 1/4 x 79 1/4	2	
P-1279C	trim	1 x 2 x 79 1/4	2	
P-B-G433	skirting	1/2 x 4 x 33	5	
P-B-G633	skirting	1/2 x 6 x 33	3	
P-1336	top door trim	1 x 3F x 36	1	
P-14B41	bottom skirting	1 x 4 1/8 x 41	1	
P-14B34G	bottom skirting	1 x 4 1/8 x 34 1/2	2	

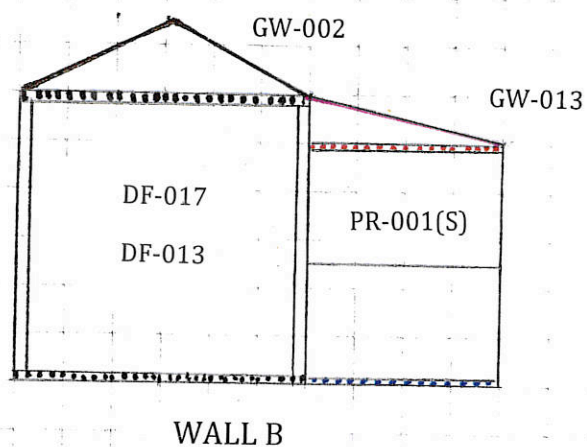
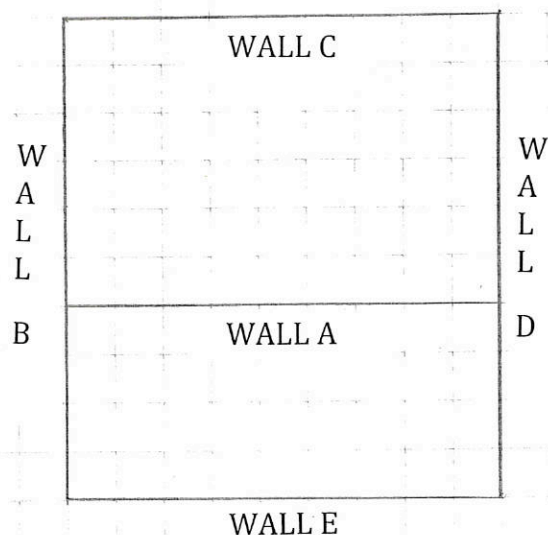
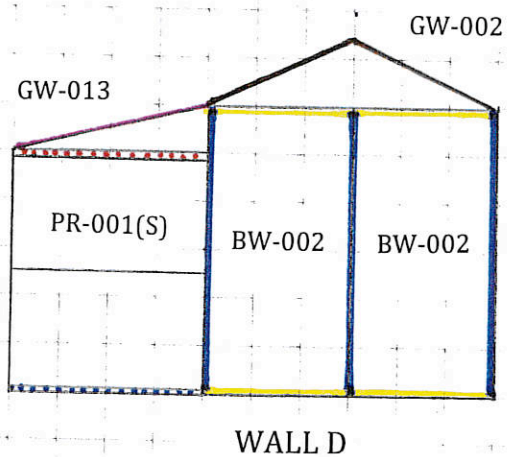

TRIM INSTALLATION - STAGE 3

PART #	DESCRIPTION	DIMENSIONS (where app.)	# OF PCS	CODE
P-1280G	trim	1 x 2 x 80 1/2	3	
P-B-G633	skirting	1/2 x 6 x 33	4	
P-B-G646G	skirting	1/2 x 6 x 46 1/2	2	
P-14B45K	bottom skirting	1 x 4 1/8 x 45 3/4	2	
P-1470G	door trim (top & bottom)	1 x 4F x 70 1/2	2	
P-1446Ya	gable fascia	1 x 4 x 46	4	
P-1448GYg	fascia	1 x 4 x 48 1/2	2	