

ASSEMBLY & INSTALLATION INSTRUCTIONS

A793

Mobius Tall Pendant 134505

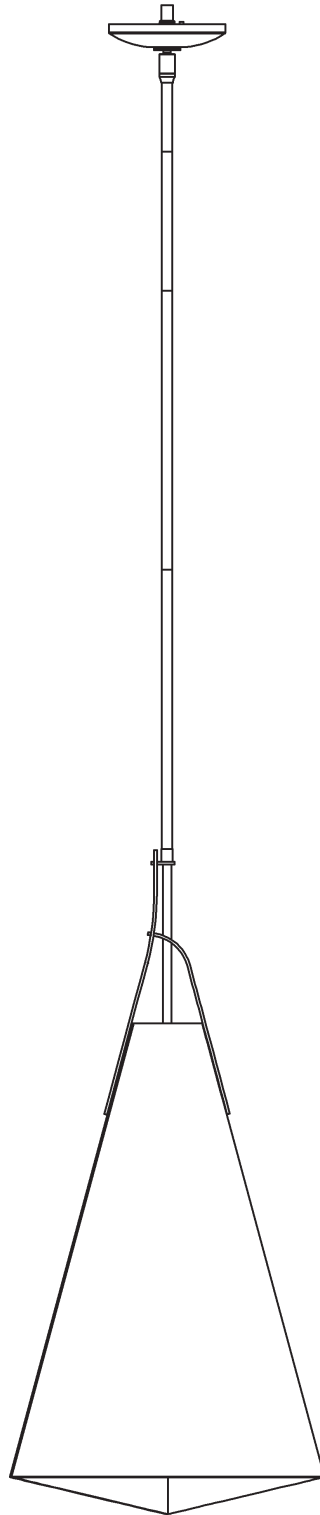

Component Parts

- A Fixture**
- B Crossbar**
- C Jam Nut**
- D Threaded Nipple**
- E Ground Screw**
- F Canopy Ring**
- G Canopy**
- H Swivel**
- I 3" Fixture Pipe (1)**
- J 6" Fixture Pipe (1)**
- K 12" Fixture Pipe (2)**
- L Stem Nipple (5)**
- M Socket**
- N Bulb (not included)**
- O Retaining Ring**
- P Shade Spider**
- Q Shade Assembly**
- R Flat Shade Panel**
- S Bracket with Studs (2)**
- T Knurled Balls (4)**



ASSEMBLY & INSTALLATION INSTRUCTIONS

A793

Mobius Tall Pendant 134505

CAUTION: FAILURE TO INSTALL THIS FIXTURE PROPERLY MAY RESULT IN SERIOUS PERSONAL INJURY OR DEATH AND PROPERTY DAMAGE. We recommend installation by a licensed electrician. This product must be installed in accordance with applicable installation code(s), by a person familiar with the construction and operation of the product and the hazards involved.*

Caution: Do not exceed maximum wattage noted on fixture. Use only recommended bulbs with fixture.

Please Note: After installation extra hardware and accessories are possible due to our kits are used on multiple products and options.

To Install Fixture (Figure 1 & 2) on following page

CAUTION: BE SURE POWER IS OFF AT THE MAIN BREAKER BOX PRIOR TO INSTALLATION.

1. Carefully unpack fixture (A) from the carton.
2. Thread jam nut (C) and crossbar (B) onto threaded nipple (D) with ground screw (E) facing towards swivel (HI); leave both parts loose.
3. Using two machine screws (not provided), temporarily fasten crossbar (B) to the electric box.

NOTE: A NEW ELECTRIC BOX COMES WITH SCREWS. WHEN REPLACING A FIXTURE, RETAIN THE EXISTING SCREWS FOR USE WITH THE NEW FIXTURE.

4. Adjust the length of threaded nipple (D) in crossbar (B) so that canopy ring (F) will hold canopy (G) against the ceiling with no threads showing for best appearance. When the correct adjustment is established, tighten jam nut (C) against crossbar (B) to secure the adjustment.
5. Remove crossbar (B) from the electrical box and proceed with the assembly instructions.
6. Locate fixture pipes (I, J, K), fixture (A), stem nipples (L) . Stem nipples (L) can be found in the kit bag.
7. Provided are multiple fixture pipes in three different lengths. Choose the combination that will achieve the overall height desired. Refer to the table below to determine the pipes required to reach the desired overall height. Once you have determined the components necessary, feed the wires that exit fixture (A) through the individual components and thread pipes and nipples together. Wires will slip easier through loose components than through pipes and nipples that are pre-assembled. Once wires are run, apply thread locking compound to all the connection points and assemble the pipes and nipples.

		Overall Height of Fixture											
		31.1	34.1	37.1	40.1	43.1	46.1	49.1	52.1	55.1	58.1	61.1	64.1
# of Pipes Required	3" Pipe (J)		1		1		1		1		1		1
	6" Pipe (K)			1	1			1	1			1	1
	12" Pipe (L)					1	1	1	1	2	2	2	2

NOTE: APPLICATION OF THE THREAD LOCKING COMPOUND IS NECESSARY TO PREVENT THE PIPE FROM LOOSENING DURING REGULAR MAINTENANCE AND CLEANING OF THE FIXTURE. BE CERTAIN TO APPLY THE COMPOUND.

8. Carefully slide canopy ring (F) and canopy (G) over wires and fixture pipes (I, J, K) until they rest on fixture (A).
9. Slip wires from the fixture (A) through assembled swivel (H) and threaded nipple (D).
10. Refer to instructions on next page to continue installation.

ASSEMBLY & INSTALLATION INSTRUCTIONS

A793

Mobius Tall Pendant 134505

11. Using two machine screws (not provided), fasten crossbar (B) to the electric box.
12. Using suitable wire connectors (not provided) connect fixture wires to supply (white/ribbed to white and black/smooth to black). Attach a pigtail lead to crossbar ground screw (E). Hold canopy (G) close, connect all ground wires (bare copper or green to bare copper or green).

CAUTION: MAKE SURE WIRE CONNECTORS ARE TWISTED ON SECURELY, AND NO BARE WIRE IS EXPOSED.

13. Slide canopy (G) against ceiling, and secure with canopy ring (F).

CAUTION: BE SURE NO WIRES ARE PINCHED BETWEEN CANOPY (H) AND THE CEILING.

14. Retaining ring (O) and shade spider (P) are shipped installed on socket (M); remove retaining ring (O) and shade spider (P) from socket (M) and store both parts for later use.
15. Refer to instructions on next page to assemble shade.
16. Slip shade assembly (Q) over socket (M) (Figure 2).
17. Thread retaining ring (O) onto socket (M).
18. Install light bulb (N) (Not Included) into socket (M).
19. Restore electricity at the main breaker.

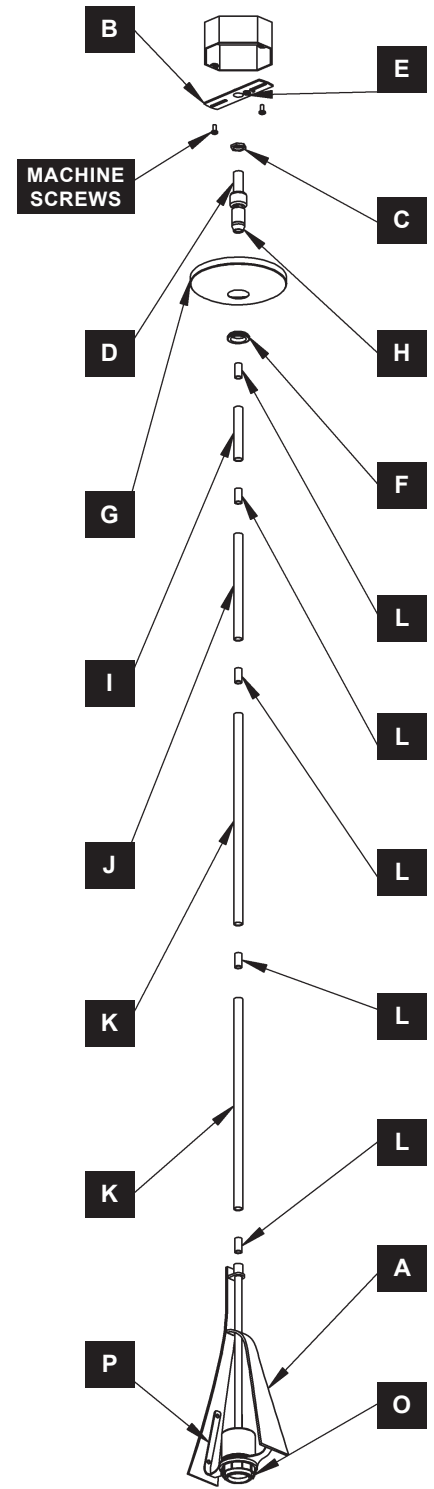

(Figure 1)

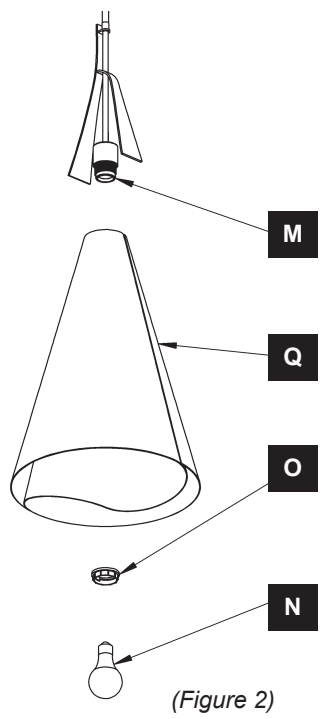

(Figure 2)

ASSEMBLY & INSTALLATION INSTRUCTIONS

A793

Mobius Tall Pendant 134505

To Assemble Shade

 To see a video on how to assemble the Mobius shade, go to:
<http://www.youtube.com/user/HubbardtonForge?v=ue3yX8f4iKc>

Step 1 Identify all parts needed.

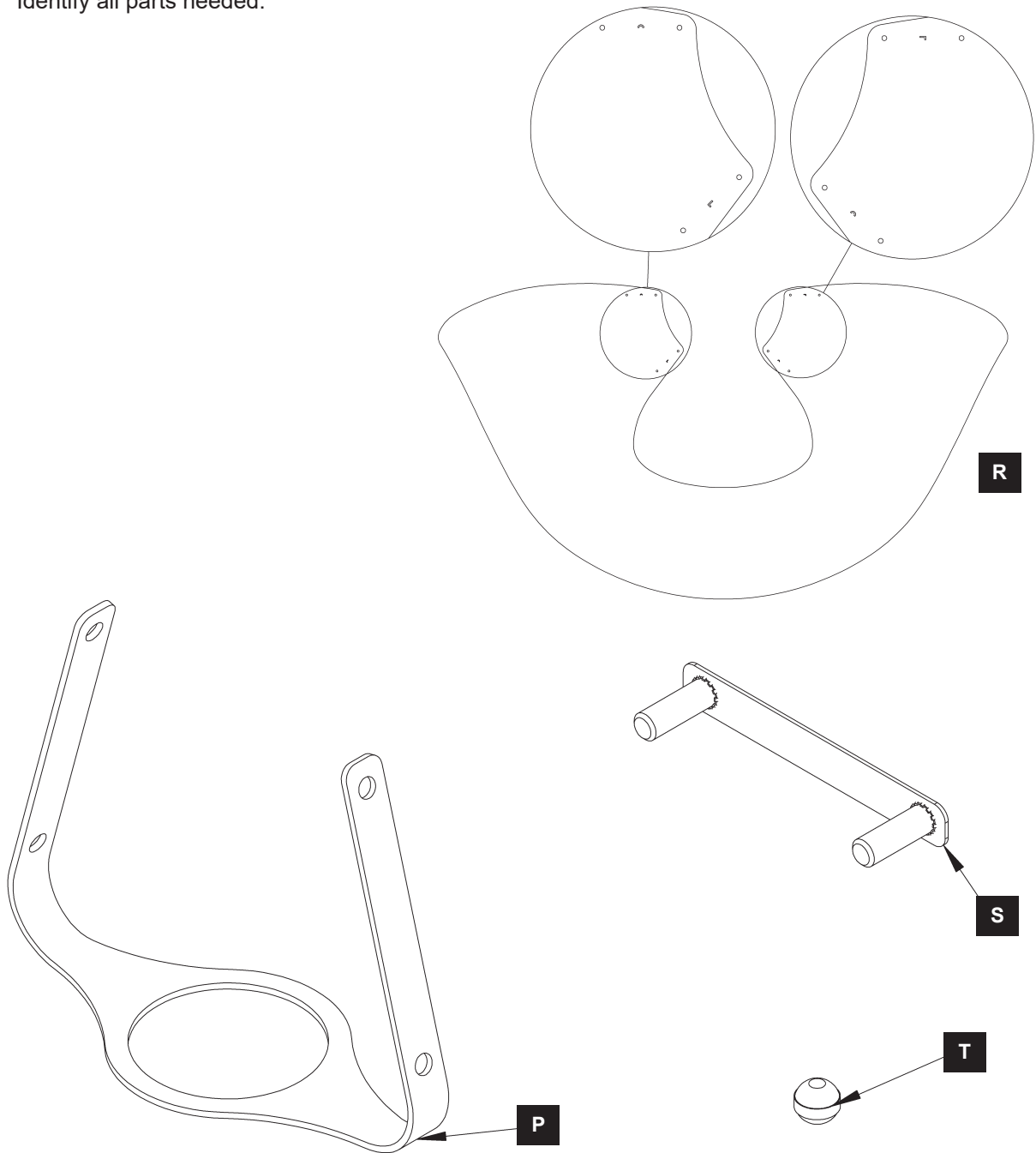

ASSEMBLY & INSTALLATION INSTRUCTIONS

A793

Mobius Tall Pendant 134505

- Step 2 Fold shade panel over and align letter designations "C".

NOTE: Top letter "C" should be oriented the same as the bottom letter "C".



- Step 3 Slip bracket with studs (S) through the "C" sides of the flat shade panel (R).



- Step 4 Flip over flat shade panel (R) and slip shade spider (P) onto the studs as shown.



ASSEMBLY & INSTALLATION INSTRUCTIONS

A793

Mobius Tall Pendant 134505

- Step 5 Thread two knurled balls (T) onto the studs until snug.



- Step 6 Take second bracket with studs (S) and fold flat shade panel (R) towards shade bracket.

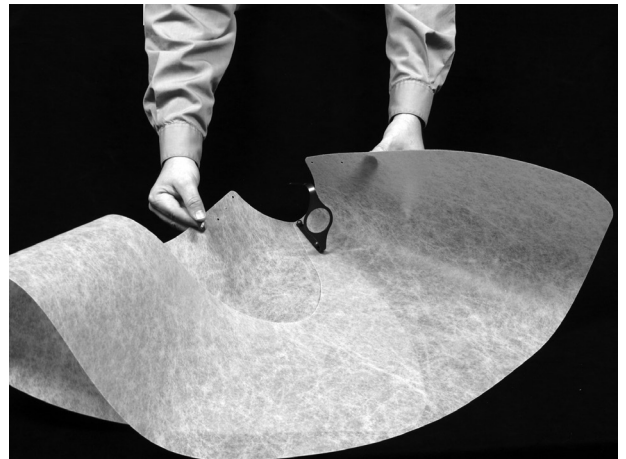

- Step 7 Slip second bracket (S) with studs through the "L" side of the shade panel.

NOTE: Top letter "L" should be oriented the same as bottom letter "L".

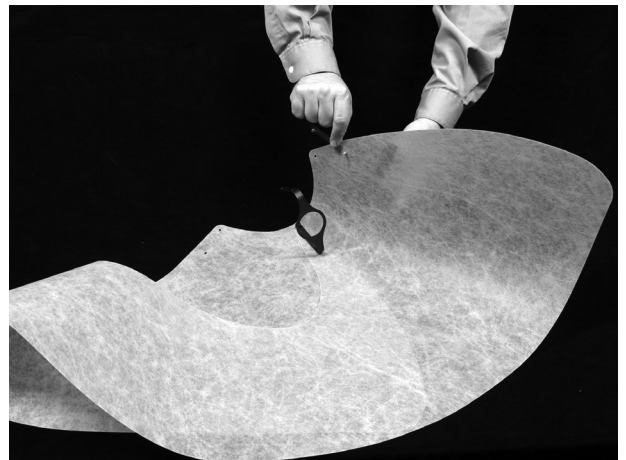

HUBBARDTON FORGE.

MODERN AMERICAN BLACKSMITHS | FINE, HAND CRAFTED LIGHTING
CASTLETON, VERMONT USA | HUBBARDTONFORGE.COM

50412

7 OF 9

ASSEMBLY & INSTALLATION INSTRUCTIONS

A793

Mobius Tall Pendant 134505

- Step 8 Fold the other side of the flat shade panel (R) towards the shade spider (P) aligning with the holes in the bracket.



- Step 9 Fold the flat shade panel (R) with the bracket and studs (S) towards the shade spider (P) and push the studs through the holes in the flat shade panel (R) and out through the spider on the inside.



- Step 10 Install knurled balls (T).



ASSEMBLY & INSTALLATION INSTRUCTIONS

A793

Mobius Tall Pendant 134505

Top View Assembled Shade (Q)

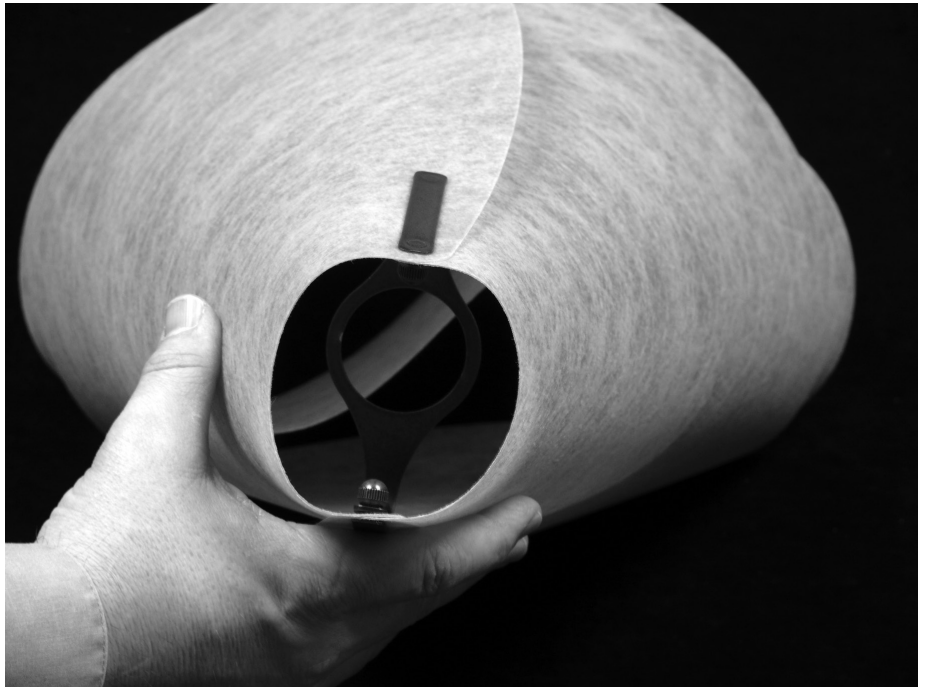

Bottom View Assembled Shade (Q)



If you need further assistance, or find that you are missing any parts, please contact the dealer from which you purchased this product. We hope you enjoy your fixture!

** Hubbardton Forge will not be liable for injury or damage caused by improper installation, lamping or use of this fixture.*