

# Assembly Instruction

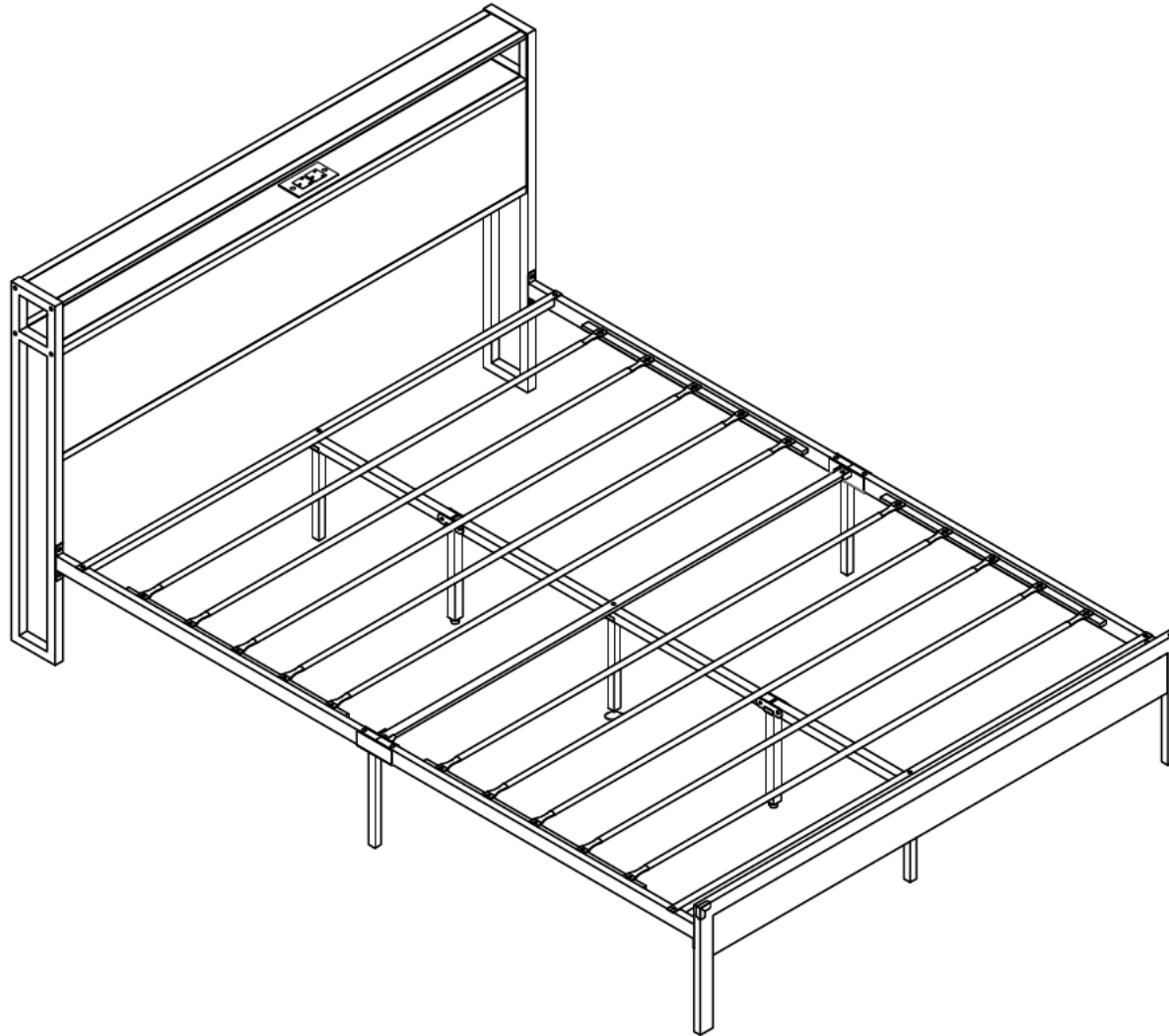

**Please don't tighten the screws completely and go back later for a final tightening of all the screws after pieces are aligned with each other.**

# Assembly Instruction

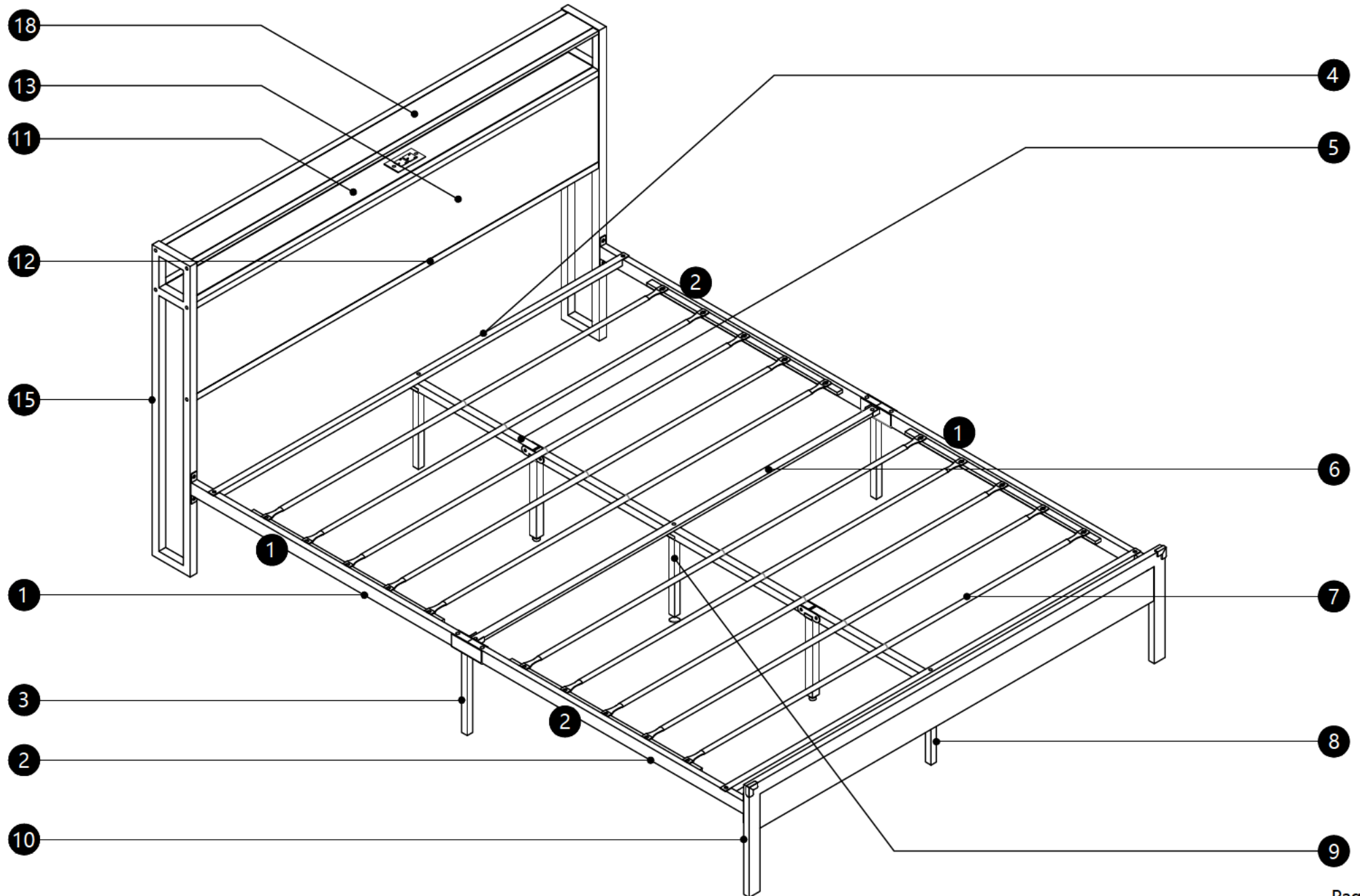

# Assembly Instruction

## Hardware arts



M6\*15

**A** 20PCS



M6\*45

**B** 10PCS



M8\*13

**C** 8PCS



M8\*20

**D** 14PCS



M8\*55

**E** 7PCS



M8

**F** 1PC



M6

**G** 1PC

## Part list



**1** 2PCS



**2** 2PCS



**3** 2PCS



**4** 2PCS

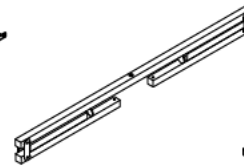

**5** 1 PC



**6** 1PC



**7** 10PCS

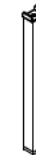

**8** 2PCS

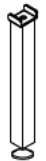

**9** 1PC

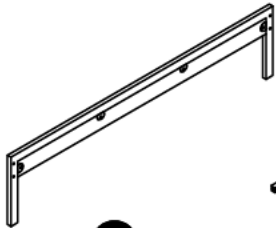

**10** 1PC

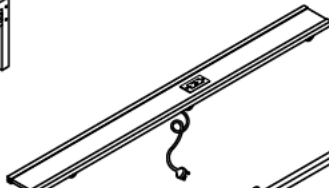

**11** 1PC

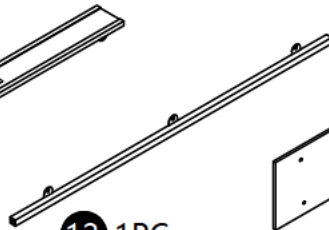

**12** 1PC

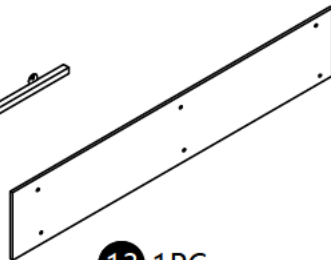

**13** 1PC



**15** 2PCS



Crash pads

**16** 2PCS



Double faced  
adhesive tape

**17** 4PCS

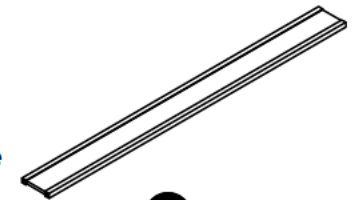

**18** 1PC

# Assembly Instruction

Step:1

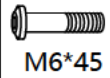

M6\*45

**B** X 6PCS

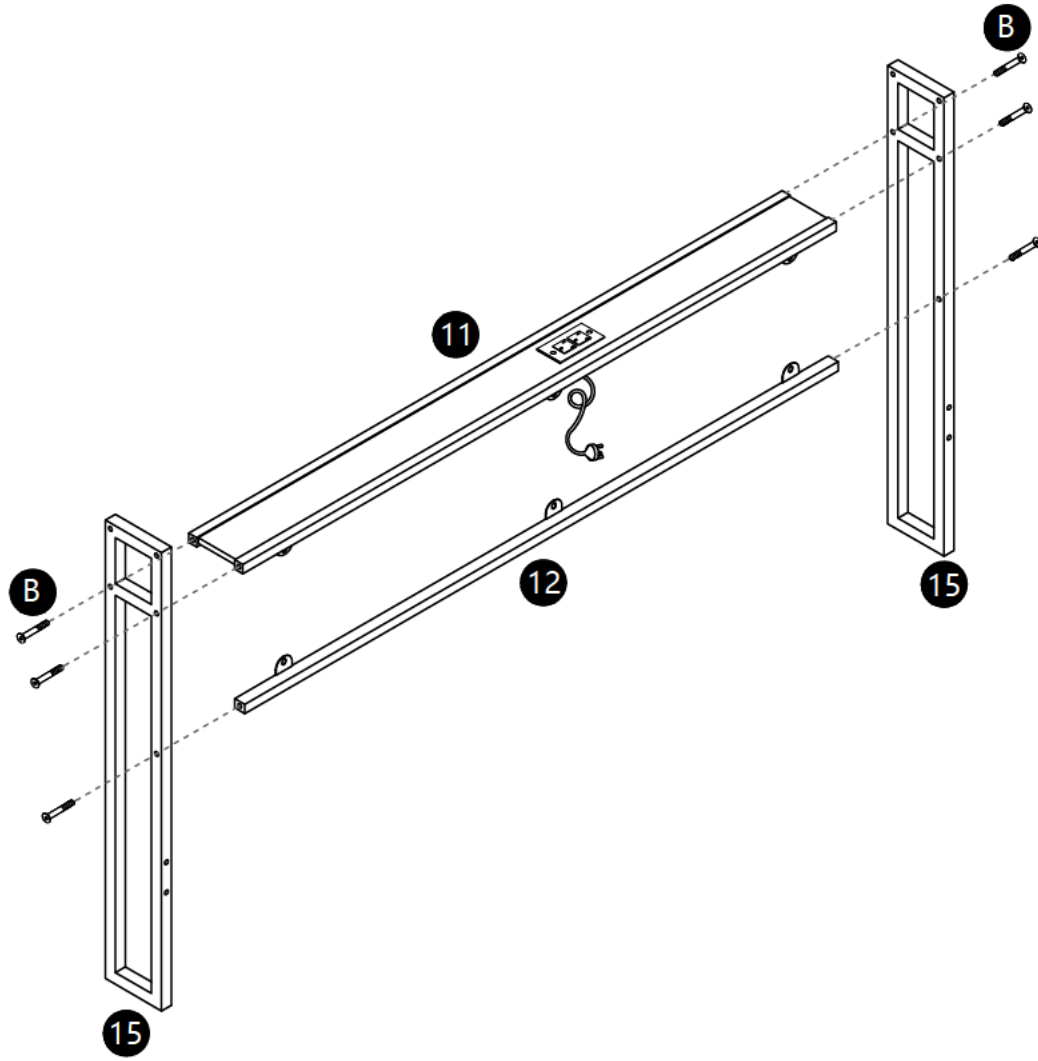

Step:2



M8\*13

**C** X 6PCS

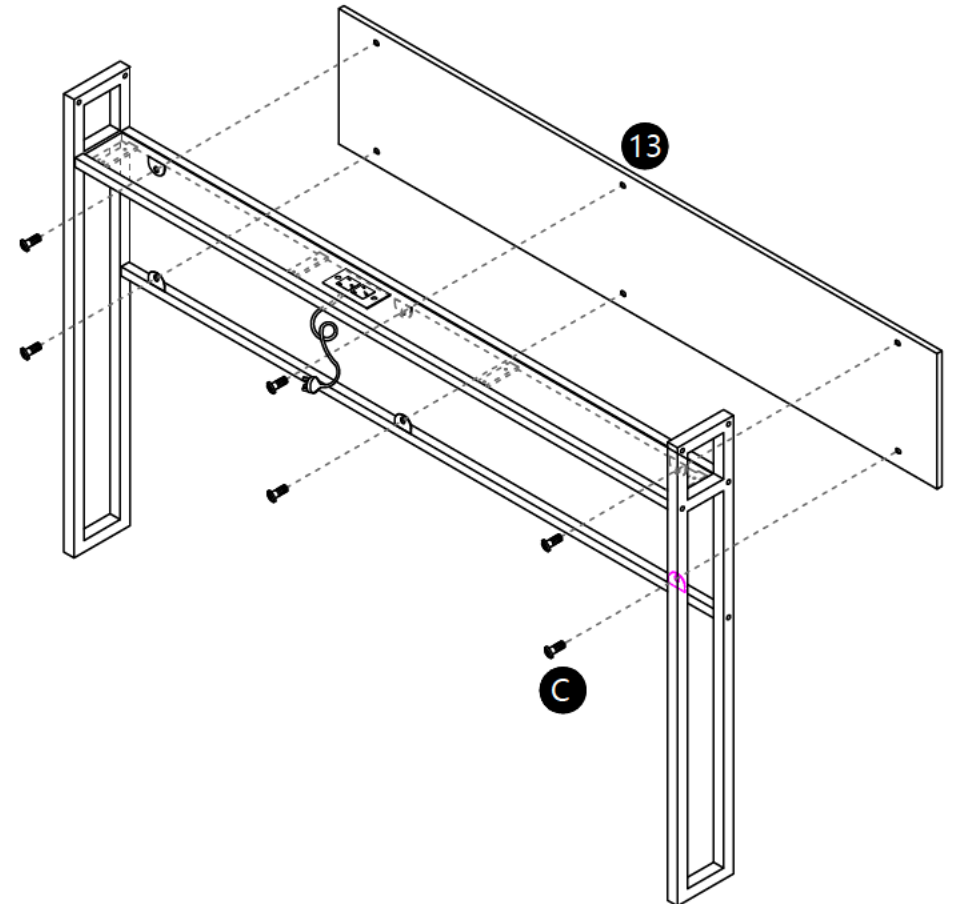

# Assembly Instruction

Step:3

 M6\*45 **B** X 4PCS

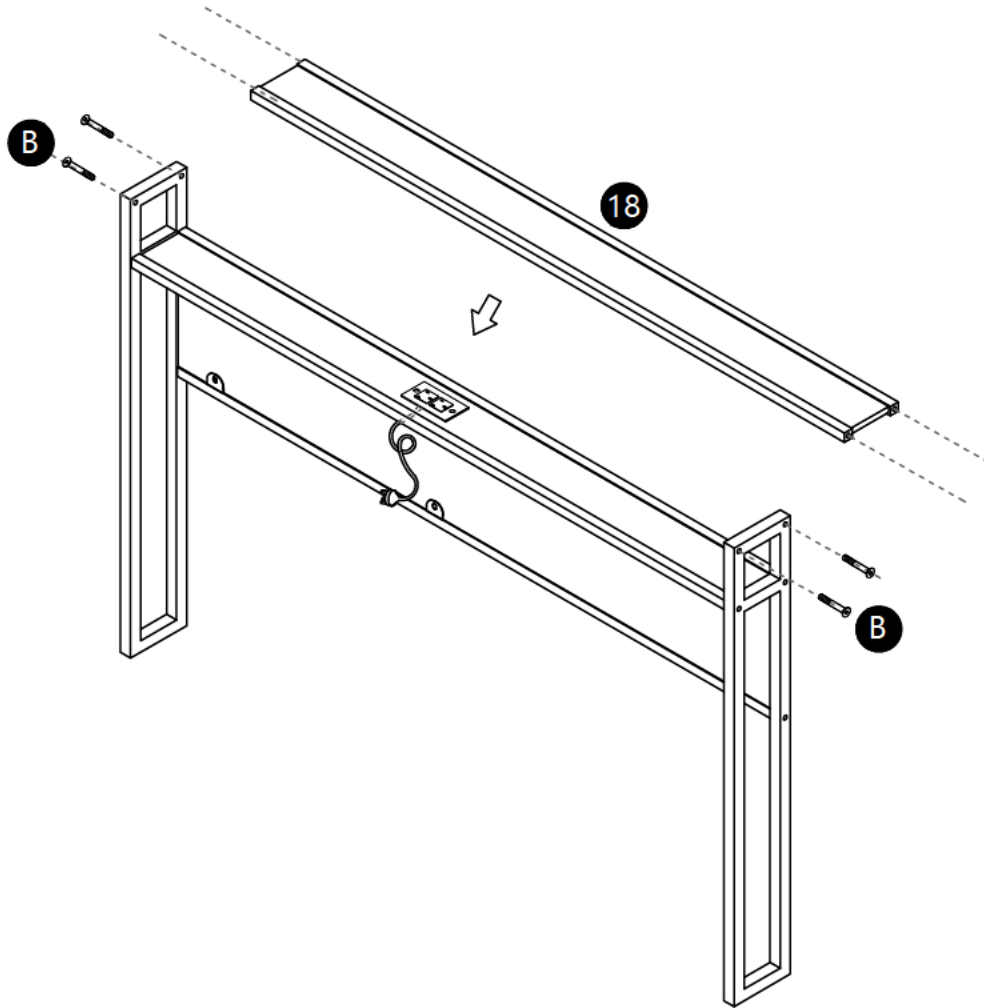

Step:4

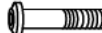
 M8\*55 **E** X 4PCS



**Please pay attention to the direction arrow in the illustration to avoid reverse installation**

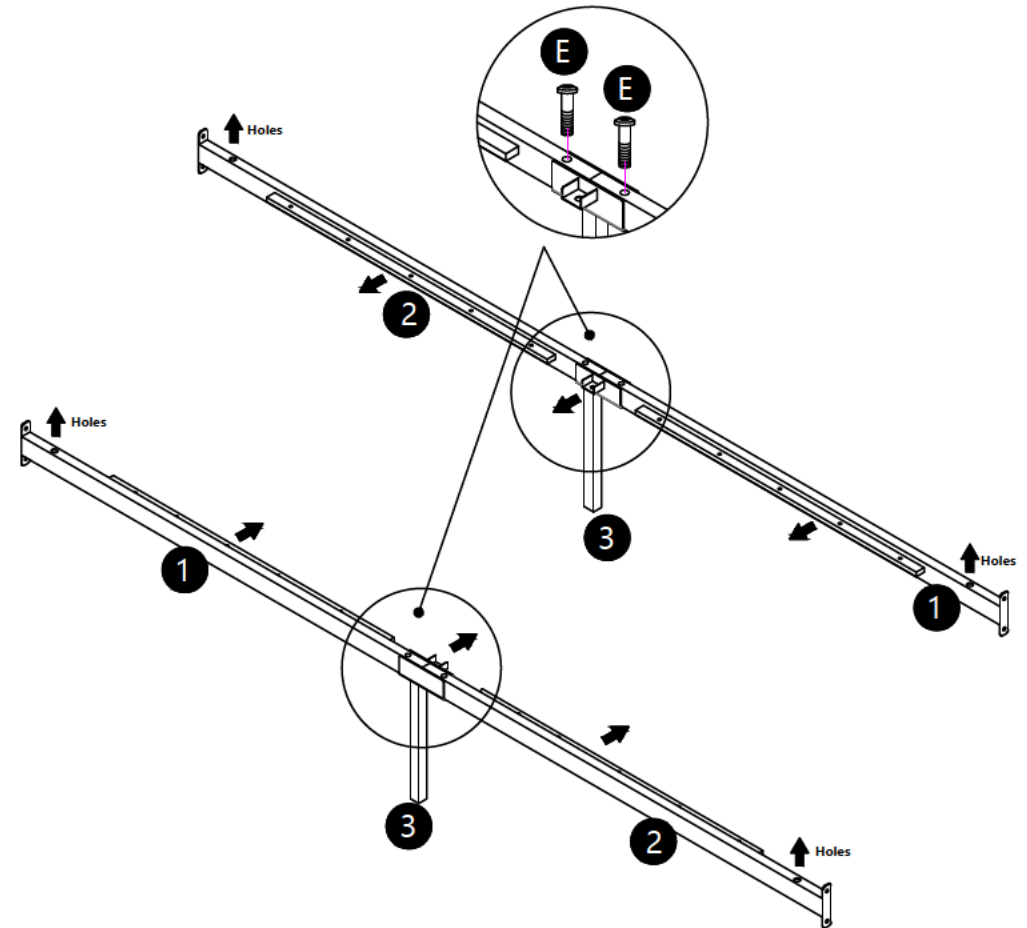

# Assembly Instruction

Step:5

 M8\*20 **D** X 8PCS

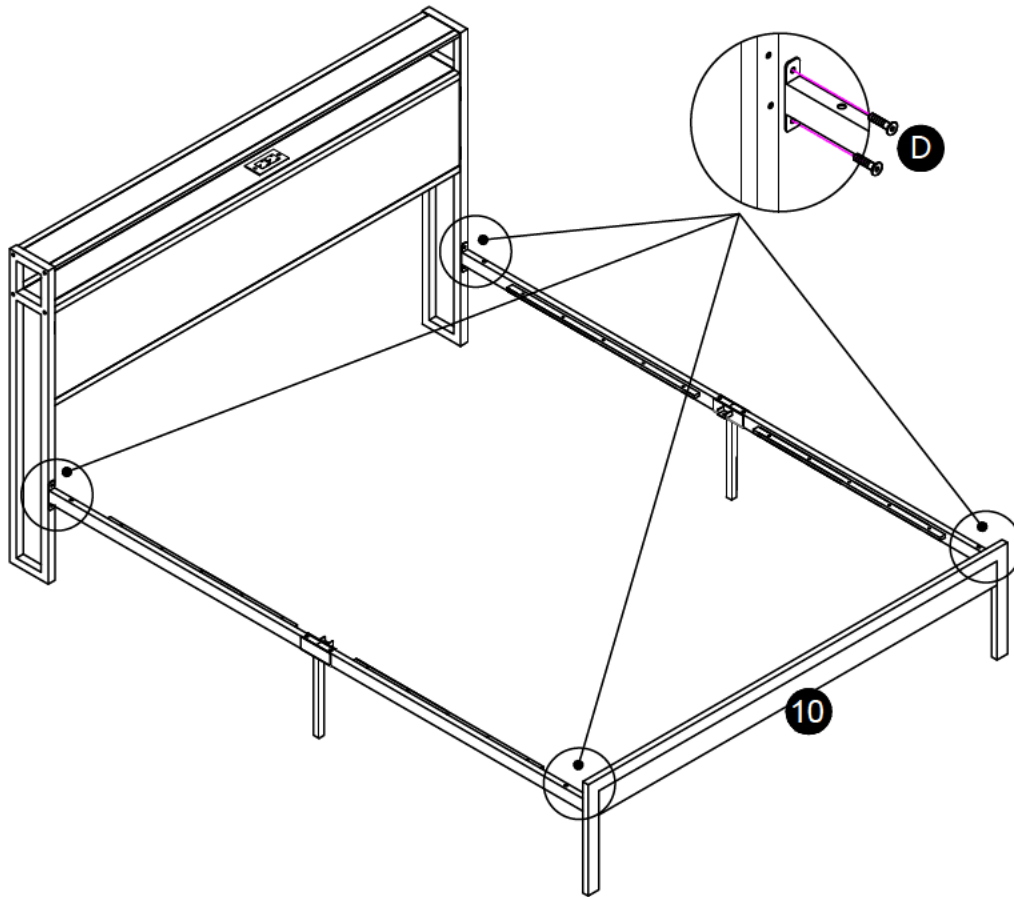

Step:6

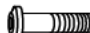
 M8\*20 **D** X 6PCS

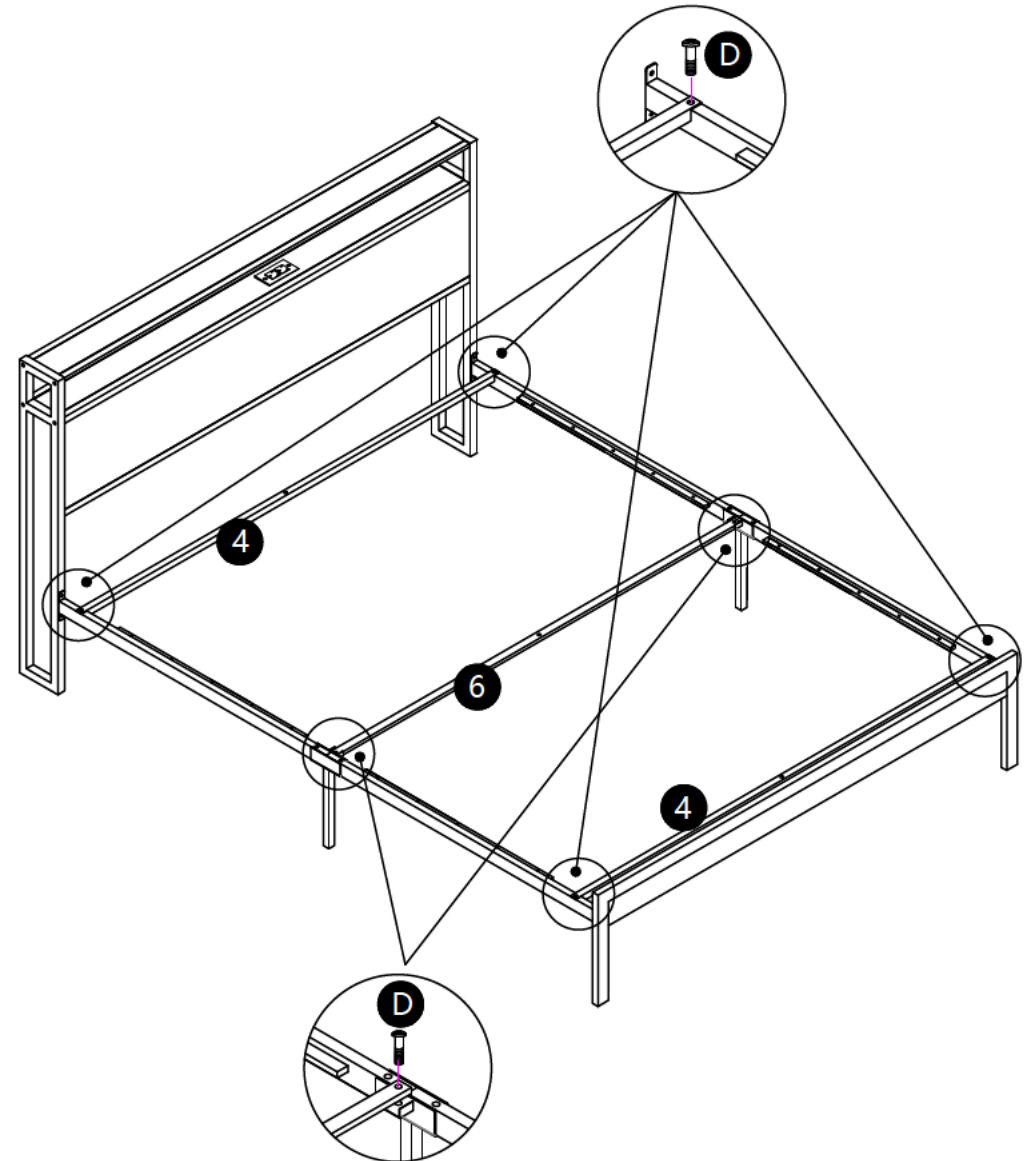





# Assembly Instruction

Step:7

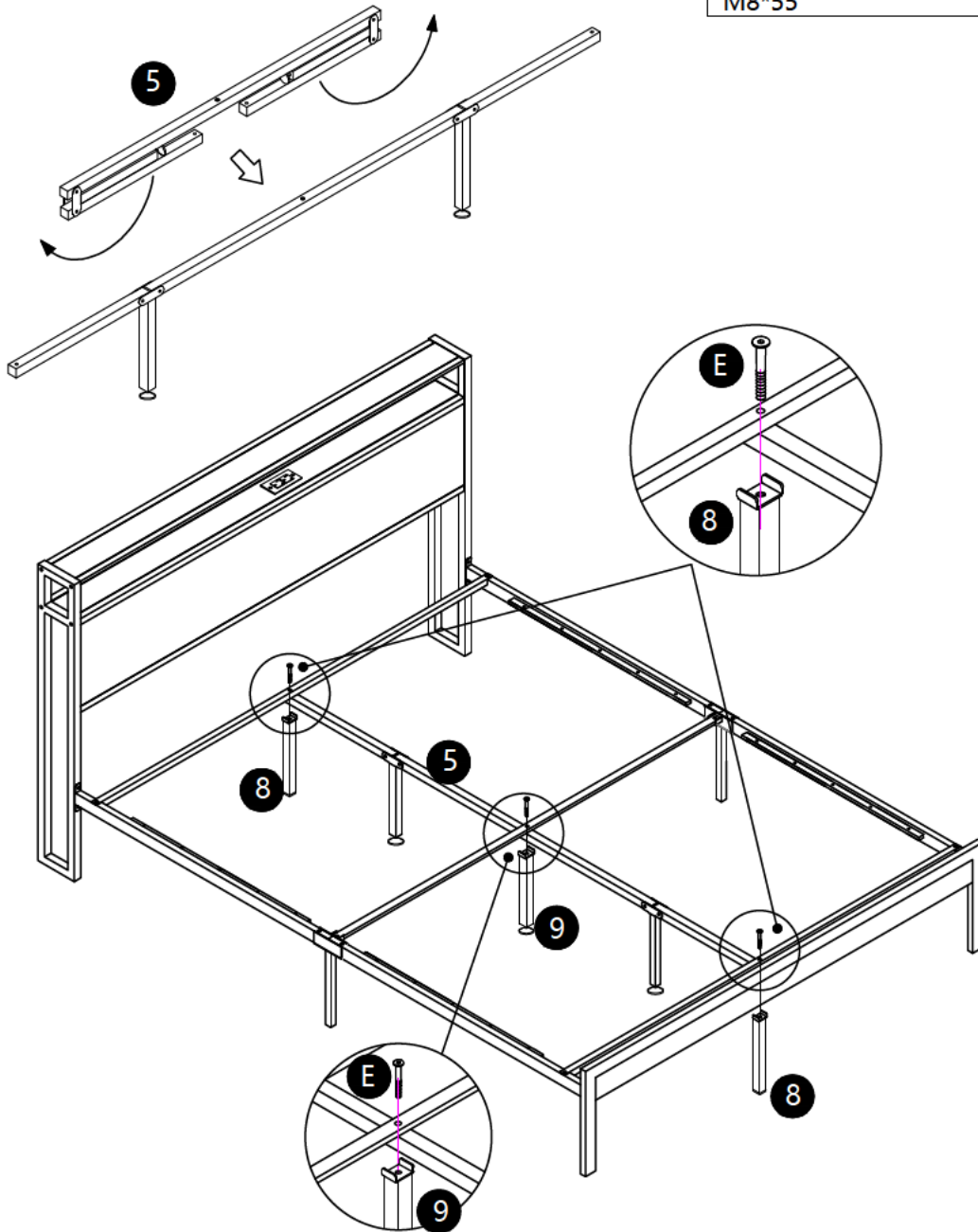
 **E** X 3PCS  
M8\*55



Step:8

 **A** X 20PCS  
M6\*15

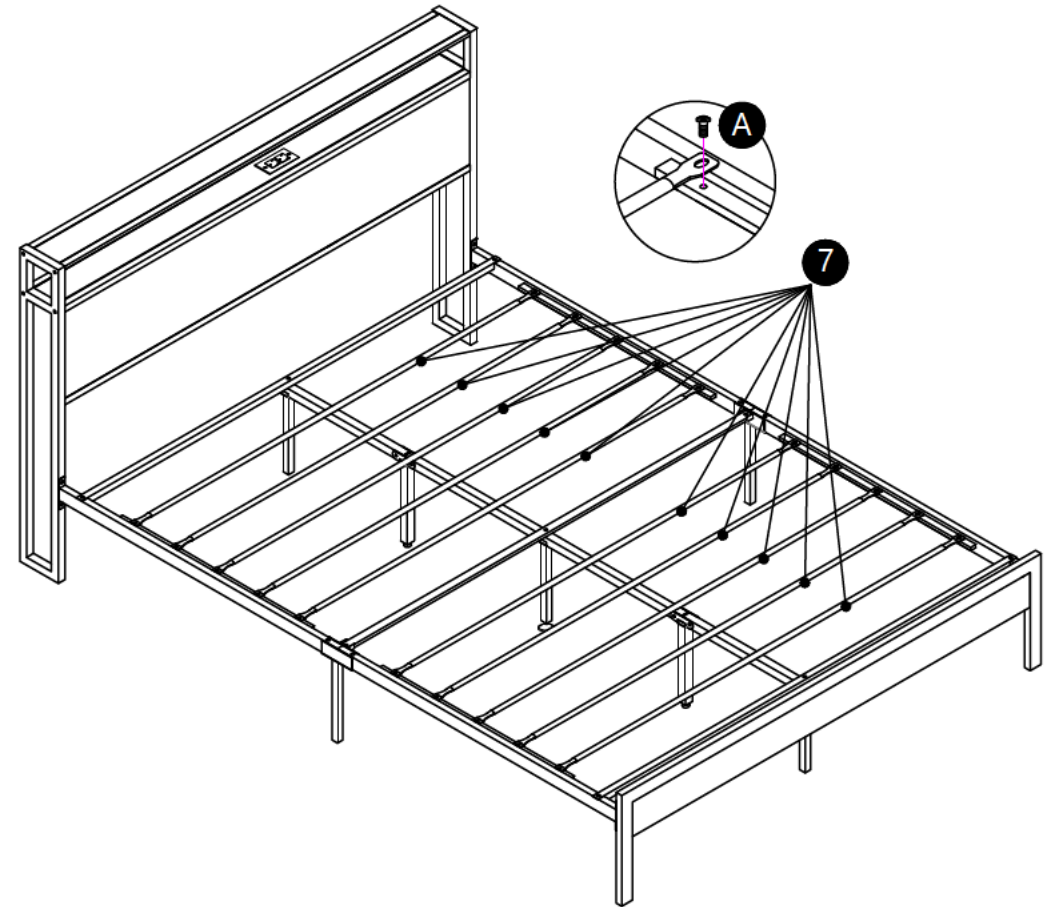

# Assembly Instruction

There is a small sealing pocket in the package. There are two pieces of double-sided adhesive tape and two crash pads in the sealing pocket. As shown in the figure below.

