

## **INSTALLATION MANUAL**



## PARTS LIST

1. M8 X 60MM (5/16" X 2 3/8") X 5\*
2. BLACK ACORN NUTS X 4
3. SHORT BLACK WOOD SCREWS X 4
4. PLASTIC EXPANSION BOLT (NOT USED)
5. BLACK PHILLIPS MACHINE SCREW 4" X 5\*
- (USE WITH #18 HOLLOWWALL ANCHORS)
6. ANTI JUMP BLOCKS (NOT USED)
7. METAL EXPANSION BOLT X 5\*
8. FLOOR GUIDE (NOT USED)
9. WASHER X 5
10. M10 X 60MM (3/8" X 2 3/8") (NOT USED)
11. LAG BOLTS X 5\*
12. SPACER X 5\*
13. MIRROR ROLLER STOPPER X 2
14. MIRROR ROLLER HANGER X 2
15. SLIDING TRACK LEFT\*
16. SLIDING TRACK RIGHT\*
17. ALLEN WRENCH
18. HOLLOW WALL ANCHORS X 5\*
19. M10 X 40MM (SILVER BOLTS) X 4

\*Items shipped/used in installation will differ for the 36"-3 foot variation of the product\*

## TOOLS NEEDED (NOT INCLUDED)



- 1.) TAPE MEASURE
- 2.) PENCIL
- 3.) DRILL
- 4.) LEVEL
- 5.) RATCHET
- 6.) WRENCH
- 7.) STUD FINDER
- 8.) 7/16" DRILL BIT  
(HOLLOW WALL INSTALLATION)







#12 + #11 are used for stud wall applications (the preferred method)

If you aren't able to hit wall studs, or have concrete/masonry type walls we provide these alternate options



#5 + #18 are used for hollow wall applications



#1, #7 + #9 are used for masonry/concrete wall applications

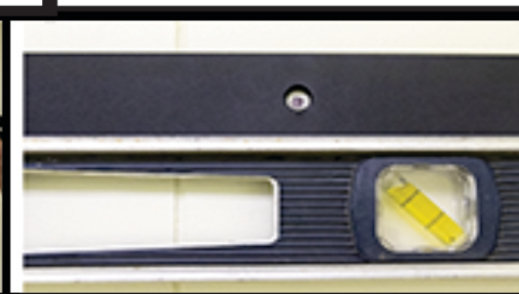

Using a level, layout the centers of your #15 + #16 sliding track mounting holes at your desired location. (this step is used for all mounting applications)

For hollow wall applications #18 hollow wall anchors along with the #5 black machine bolts are used. This process is the same principle for masonry applications. Drill a 7/16" hole on your track layout marks & insert anchors, tighten the phillips set screw carefully until you feel it tighten. You will swap out and use the #5 4" black phillips head machine screws to mount your track as shown. The following steps are universal with all mounting options

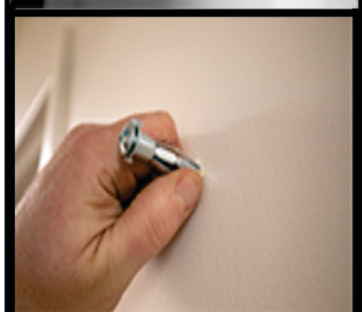



Starting at the center hole using your drill or ratchet you will drill the center layout hole, then set your spacer and bolt, but don't tighten the bolt completely yet. You'll leave approximately a 1/4" space between the spacer & bolt head for now. Slide the #16 sliding track onto the bolt.



Locate your intersecting center line and start the same process in the center hole of the sliding track. Make sure to drill directly on your center line to ensure a level mount

Don't over tighten but ensure a snug connection



After installing #16 sliding track, connect the #15 sliding track as shown above.

Don't forget to tighten up your center bolt







The #14 rollers can now be attached to your mirror through the pre-drilled holes.

Remove the #2 black acorn nuts from the #14 mirror roller hangers.

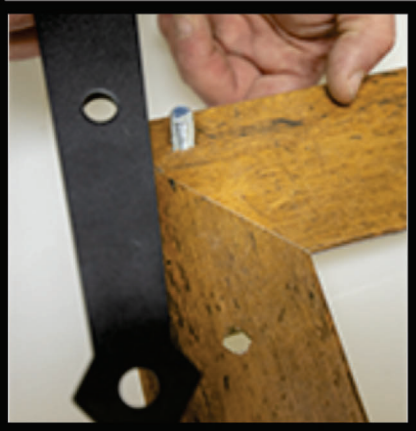

The #19 M10 x40mm silver bolts will be slid through the back of your mirror so the threads are in the front

Tighten the #2 black acorn nuts and washer onto the #19 bolts, don't over tighten but ensure a snug connection



To hang your mirror on the sliding track, lift it up at a slight angle as shown and set the groove of the roller wheel onto the track.

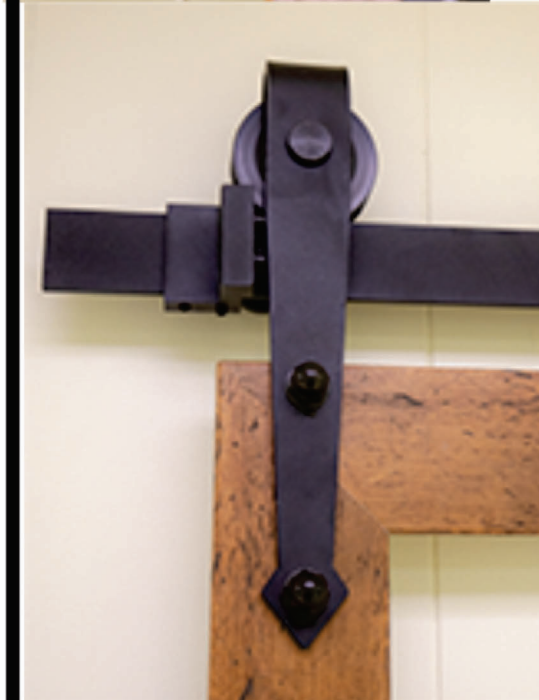
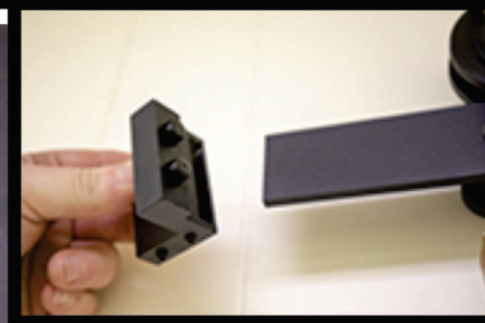

Now position the mirror to your desired placement and slide the #13 mirror stoppers with the rubber bumpers onto the track as shown

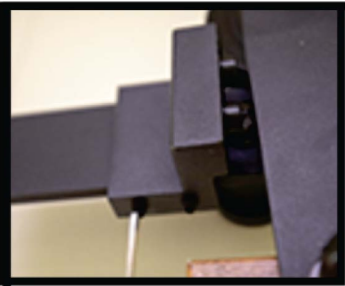

The #13 stoppers can be put at the far ends of the sliding tracks if you wish for your mirror to slide left and right. However, if you would prefer your mirror to be stationary without movement, slide the #13 stopper all the way to the #14 mirror roller hanger as shown. You will use the included #17 allen wrench to tighten and lock down placement as shown.

Another view of a properly mounted application



## GROUP A 72"-58"

CONTAINS:

- 2 PIECE BAR
- 5 HOLLOW WALL ANCHORS
- 5 LAG BOLTS
- 5 SPACERS
- 5 BLACK MACHINE SCREWS

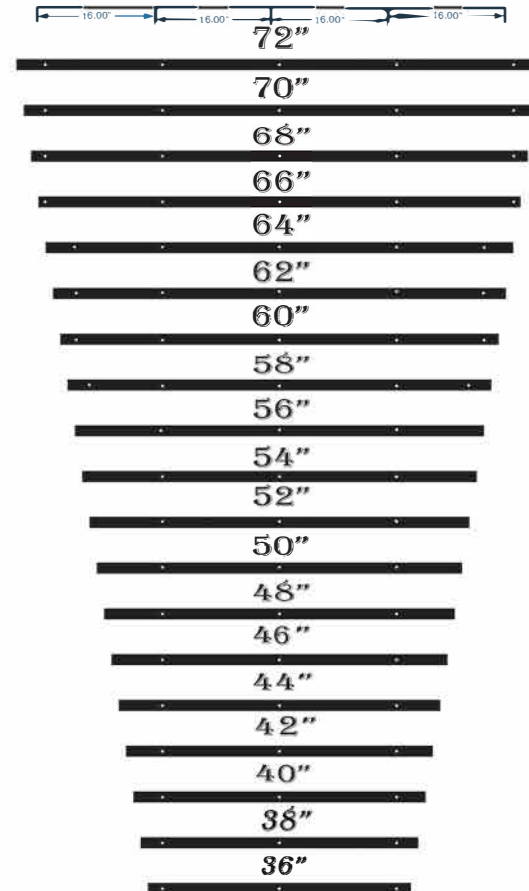

## GROUP B 56"-38"

CONTAINS:

- 2 PIECE BAR
- 4 HOLLOW WALL ANCHORS
- 4 LAG BOLTS
- 4 SPACERS
- 4 BLACK MACHINE SCREWS

## GROUP B 54"-38"

CONTAINS:

- 1 PIECE BAR
- 3 HOLLOW WALL ANCHORS
- 3 LAG BOLTS
- 3 SPACERS
- 3 BLACK MACHINE SCREWS