

Installation Instruction

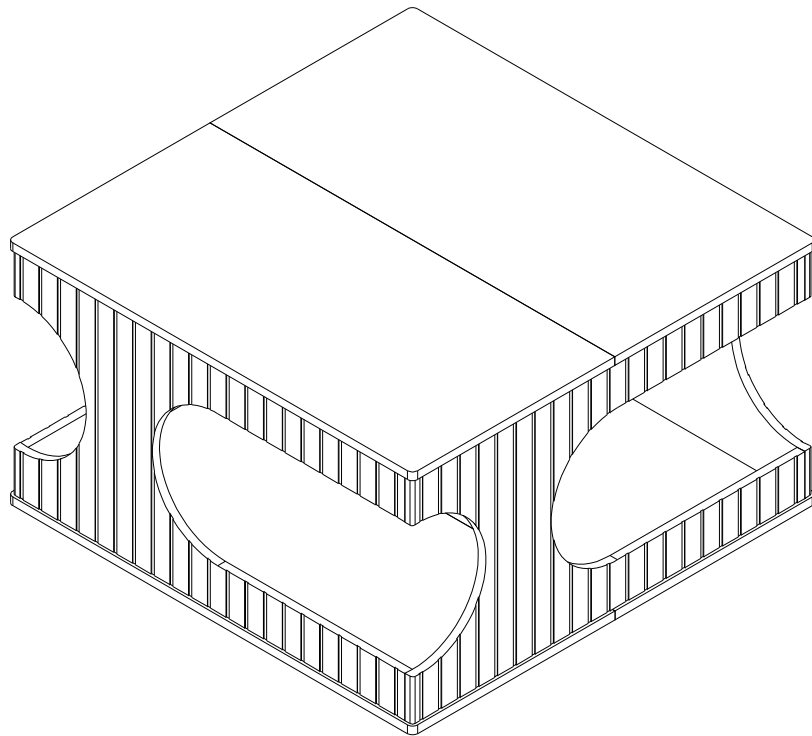

Assembling

What you need

- Use the packaging carton as a working surface to prevent product damage during assembly
- Phillips head screwdriver

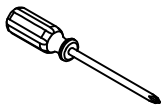

Weight Limitation

 **100** | **35**
lbs table top lbs per

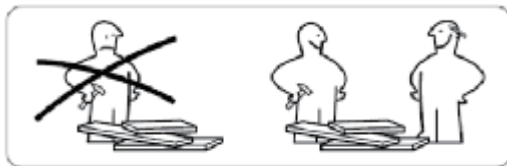

What' included

Code	Description	Qty
A	Cam Bolt M6X35MM	30
B	Cam Lock 15X9MM	30
C	Wooden Dowel M8X30MM	32
D	Screw M4X40MM	16
E	Hole position sticker	30
F	EVA	8

The Hardwares

Ⓐ

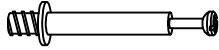

Ⓑ



Ⓒ

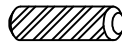

Ⓓ

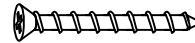

Ⓔ

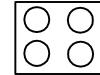

Ⓕ

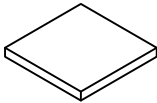

IMPORTANT:

1. Do not tighten bolts / screws completely until all bolts / screws are lined up and inserted into holes.
2. Do not over tighten screws and bolts to avoid stripping
3. Please use hand tools to assemble this product, you can also use power tools (please use power tools carefully)

Included Accessories

Code	Description	Qty
1	Left Cabinet Top	1
2	Left Bottom Panel	1
3	Side Panel	4
4	Right Cabinet Top	1
5	Right Bottom Panel	1

The Accessoriess

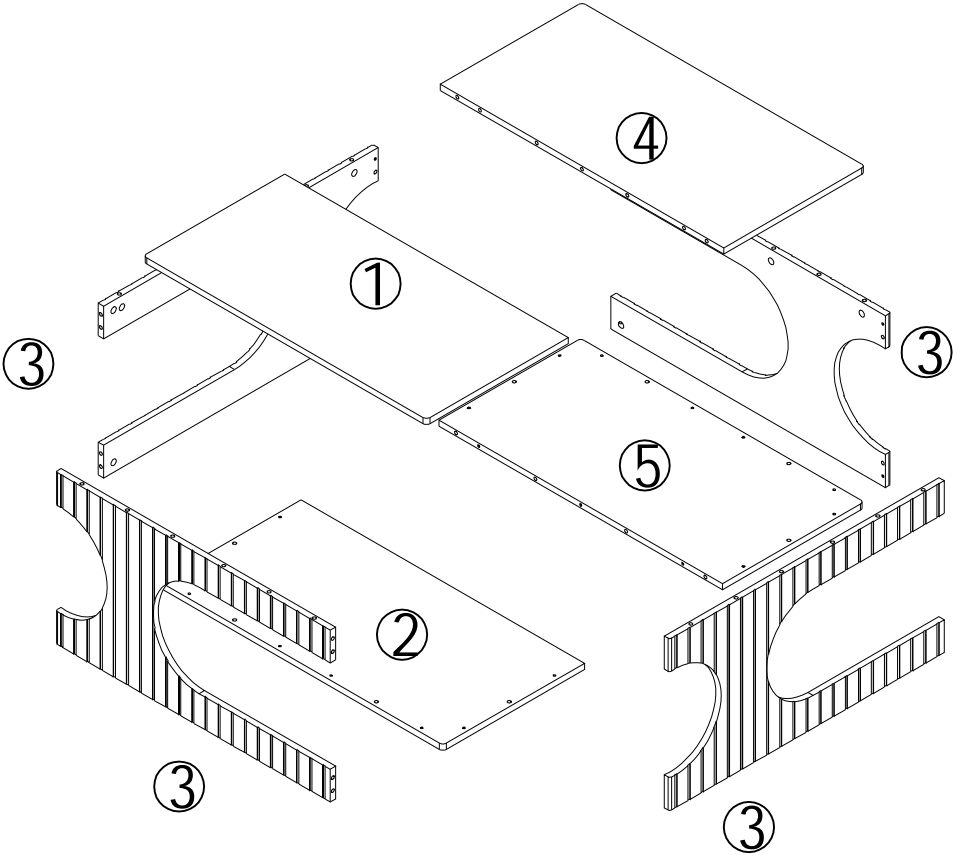

Step 1

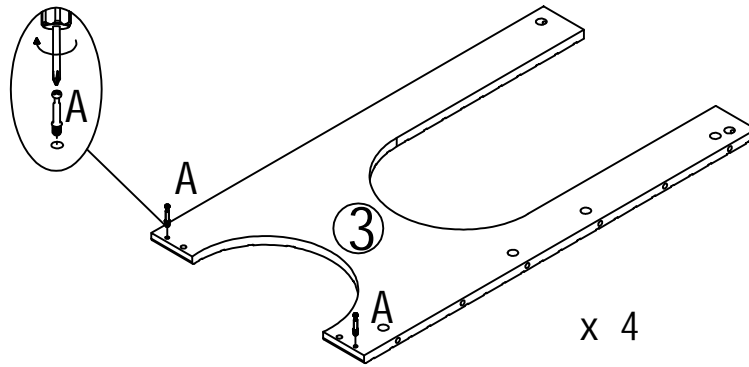
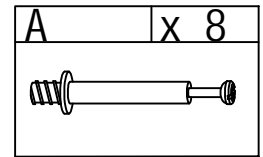

Step 2

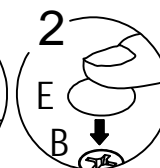
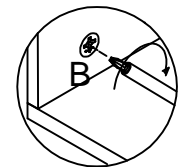
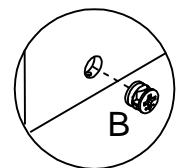
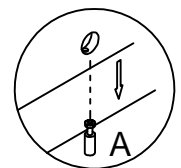
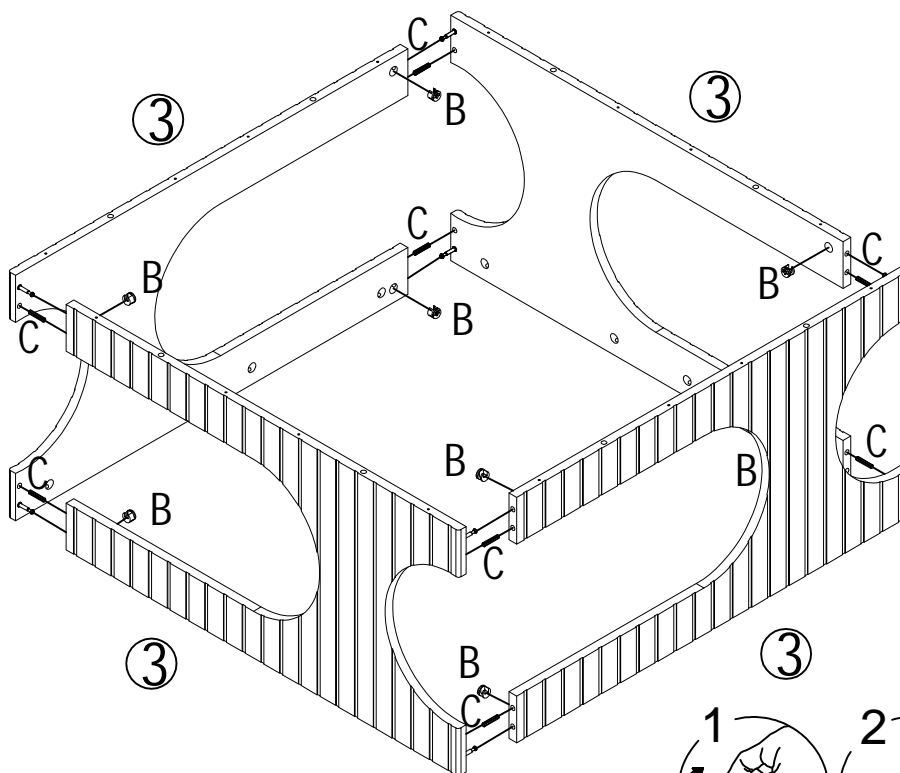
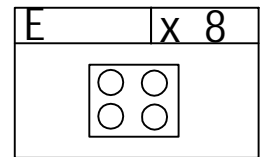
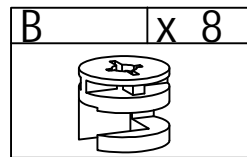
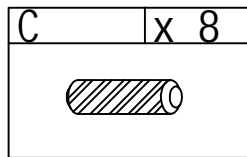

Step 3

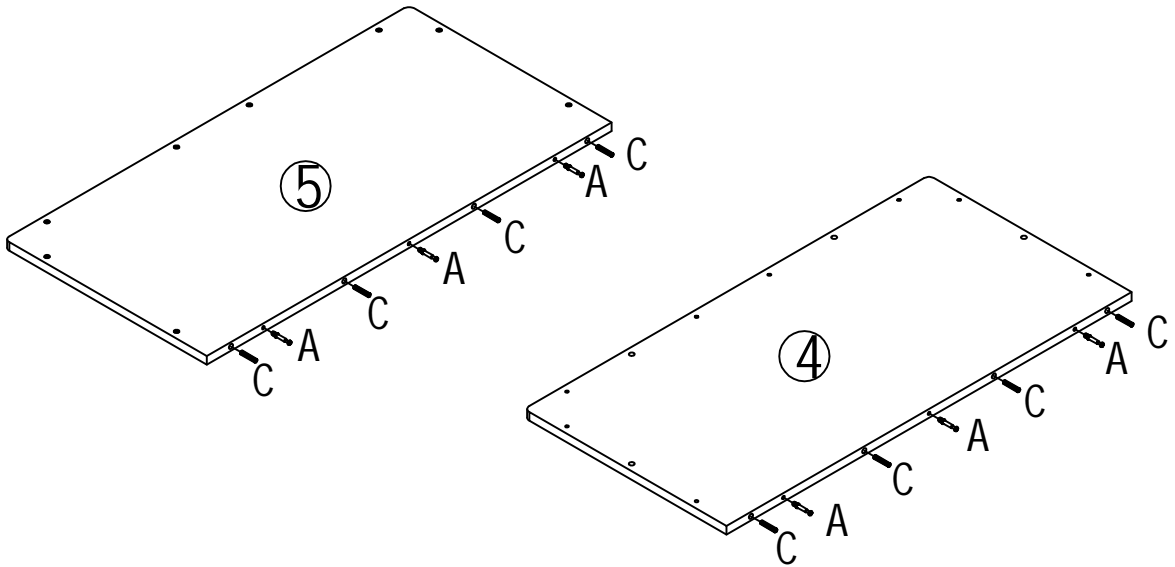
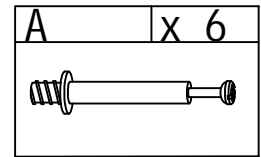
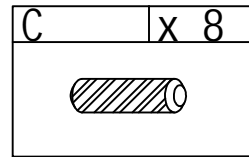

Step 4

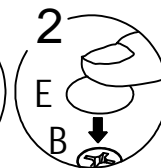
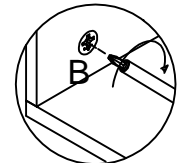
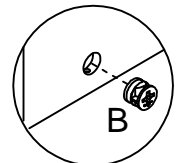
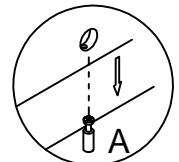
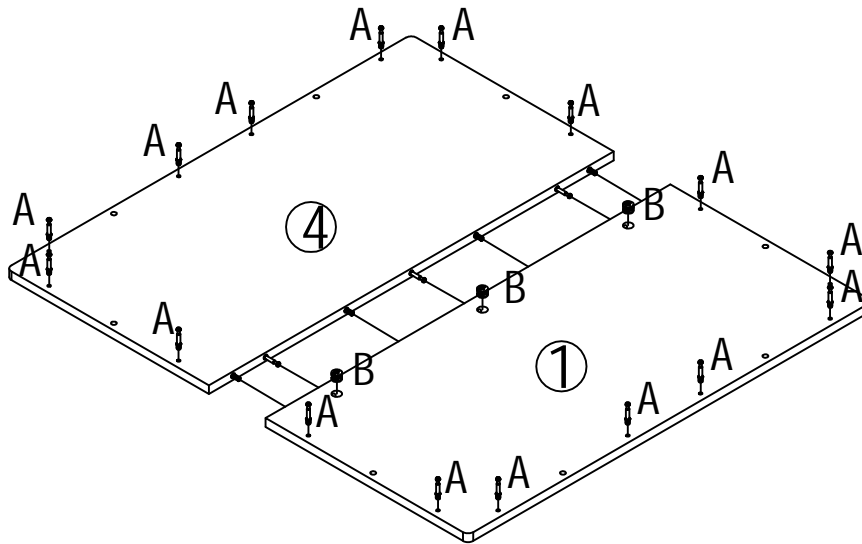
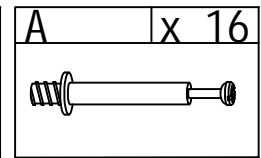
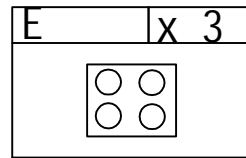
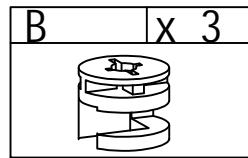

Step 5

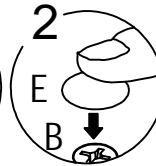
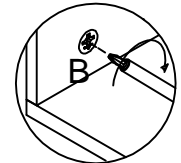
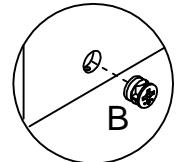
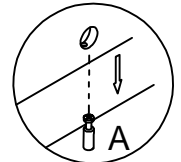
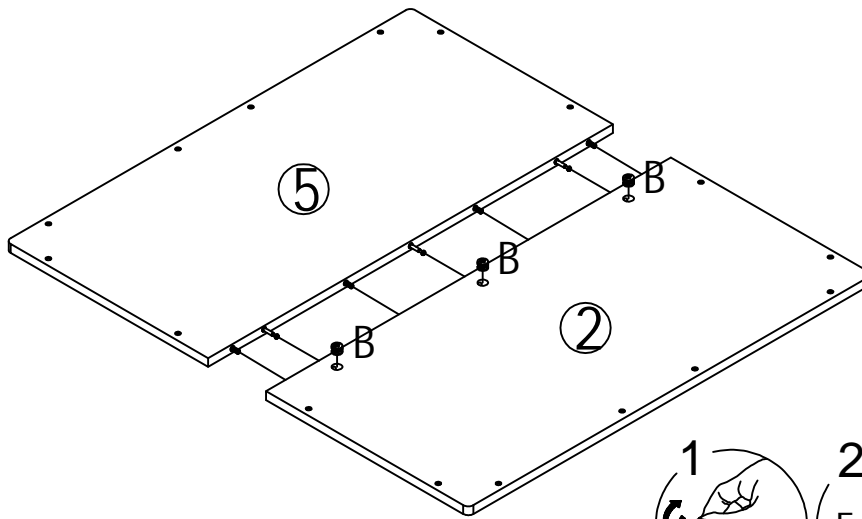
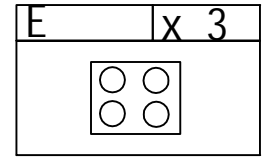
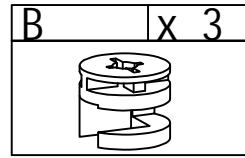

Step 6

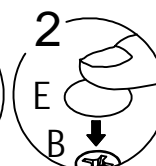
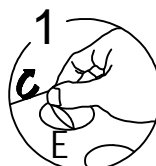
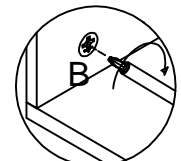
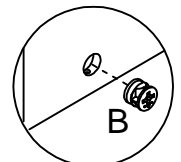
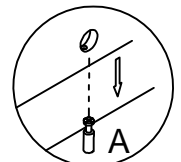
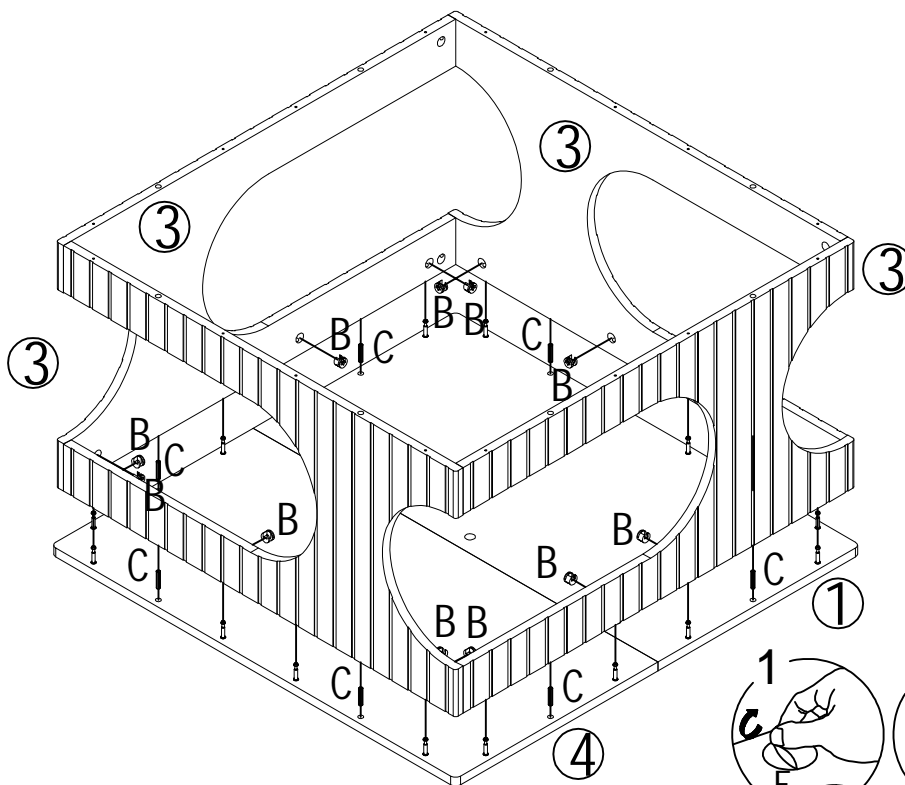
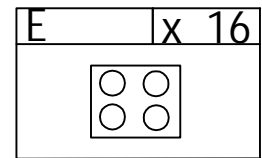
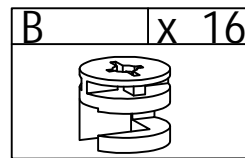
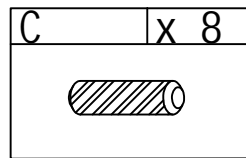

Step 7

Keep the lines on board 1 and 4 in the same direction as those on board 2 and 5.

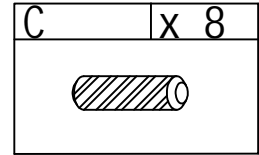
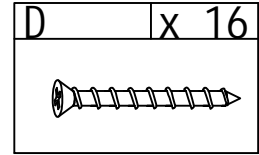
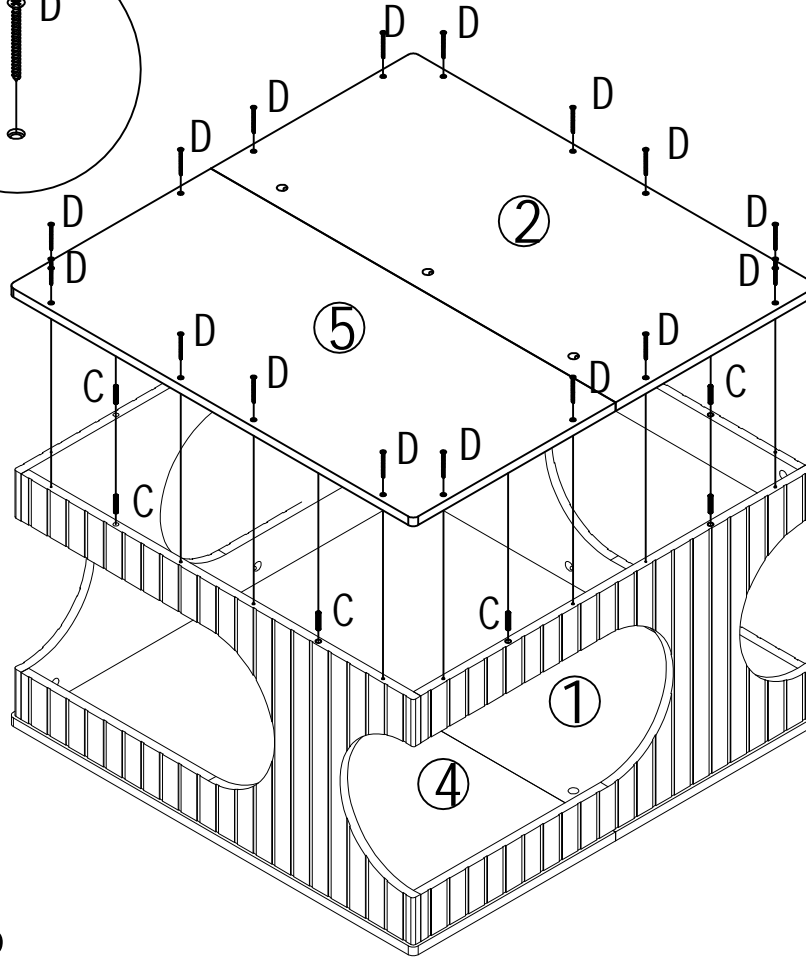
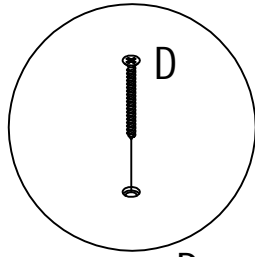

Step 8

